



Location, ownership and detail must be correct, complete and legible. Separate application required for every building. Plans must be filed with this application.

Know the law, where you know the requirements or not.

APPLICATION FOR PERMIT TO BUILD
(3D CLASS BUILDING)

This Application and
Get All Questions Settled
BEFORE Commencing Work.
Failure To Do So

Portland, Me., November 6, 1919

TO THE MAYOR
CITY INSPECTOR OF BUILDINGS

The undersigned hereby applies for a permit to build, according to the following Specifications:—

Location 99 101 87 Alba Street Ward 9 Fire Limits? 110
 Name of owner is? Irving L Pike Address 87 Concord Street
 Name of mechanic is? Clough & Maxim Co Address Chapman Bldg
 Name of architect is? _____ Address _____
 Proposed occupancy of building (purpose)? dwelling
 If a dwelling or tenement house, for how many families? 1
 Are there to be stores in the lower story? _____
 Size of lot, No. of feet front? _____; No. of feet rear? _____; No. of feet deep? _____
 Size of building, No. of feet front? 22ft; No. of feet rear? 22ft; No. of feet deep? 24ft
 No. of stories, front? 1 1/2; rear? _____
 No. of feet in height from the mean grade of street to the highest part of the roof? 20ft
 Distance from lot lines, front? _____ feet; side? _____ feet; side? _____ feet; rear? _____
 Firestop to be used? yes
 Will the building be erected on solid or filled land? _____
 Will the foundation be laid on earth, rock or piles? _____
 If on piles, No. of rows? _____ distance on centers? _____ length of? _____
 Diameter, top of? _____ diameter, bottom of? _____
 Size of posts, 4 x 6 Studding 2 x 4 16 O. C. Sills 4 x 8 Roof Rafters 2 x 6 24 O. C. Girders 6 x 8
 Size of girts 4 x 4
 Size of floor timbers? 1st floor 2x8, 2d 2x8, 3d _____, 4th _____
 O. C. " " " " 16, 2d 16, 3d _____, 4th _____
 Span " " "not over 16", 2d not over 16, 3d _____, 4th _____
 Will the building be properly braced? yes, Bridging in every floor span over 8ft
 During construction Sills and posts will be all one piece in cross section
 Material of foundation? concrete thickness of? 12in laid with mortar? _____
 Underpinning, material of? concrete height of? 3ft thickness of? 8in
 Will the roof be flat, pitch, mansard or hip? pitch Material of roofing? asphalt
 Will the building be heated by steam, furnaces, stoves or grates? stove Will the flues be lined? yes
 Will the building conform to the requirements of the law? yes
 Means of egress? _____
 The above construction will not require the removal of or disturbing of any shade tree on the public street.

Plans must be submitted in duplicate, one set to be filed with the Department and the duplicate set thereof (bearing the approval of the Inspector of Buildings) shall be kept on the work and exhibited on demand.

PERMIT MUST BE RECEIVED BEFORE BEGINNING WORK

If the building is to be occupied as a Tenement House, give the following particulars

What is the height of cellar or basement? _____
 What will be the clear height of first story? _____ second? _____ third? _____
 State what means of egress is to be provided _____
 _____ Scuttle and step ladder to roof? _____

Estimated Cost, \$ 4,000. Signature of owner or authorized representative, Wm McHenry
 Address, _____
 Plans submitted? _____ Received by? _____

FILL IN COMPLETELY AND SIGN WITH INK



APPLICATION FOR PERMIT FOR HEATING, COOKING OR POWER EQUIPMENT

Portland, Maine, Oct 6 - 7 1939

PERMIT NO. 2257
OCT 7 1939

To the INSPECTOR OF BUILDINGS, PORTLAND, ME.

The undersigned hereby applies for a permit to install the following heating, cooking or power equipment in accordance with the Laws of Maine, the Building Code of the City of Portland, and the following specifications:

Location 101 Albany St. Use of Building Private Dwelling

Name and address of owner J L Pike Ward 9

Contractor's name and address J L Pike 101 Albany St. Telephone For 8113 W

General Description of Work

To install Hot Water Heater

IF HEATER, POWER BOILER OR COOKING DEVICE

Is heater or source of heat to be in cellar? yes If not, which story _____ Kind of Fuel coal

Material of supports of heater or equipment (concrete floor or what kind) concrete

Minimum distance to wood or combustible material, from top of boiler or casing top of furnace, 9 1/2'
from top of smoke pipe 10', from front of heater 6' from sides or back of heater 12'

IF OIL BURNER

Name and type of burner _____ Approved by Underwriters' Laboratories? _____

Location oil storage _____ No. and capacity of tanks _____

Will all tanks be more than seven feet from any flame? _____ How many tanks fireproofed? _____

Amount of fee enclosed? _____ (\$1.00 for one heater, etc., 50 cents additional for each additional heater, etc., in same building at same time.)

Signature of contractor J L Pike

INSPECTION COPY

3299A



(RC) RESIDENCE ZONE - C
APPLICATION FOR PERMIT
 Class of Building or Type of Structure Third Class

PERMIT ISSUED
 Permit No. 01374

Portland, Maine, July 25, 1946 **JUL 27 1946**

To the INSPECTOR OF BUILDINGS, PORTLAND, ME.

The undersigned hereby applies for a permit to erect ~~alter~~ the following building structure equipment in accordance with the Laws of the State of Maine, the Building Code of the City of Portland, plans and specifications, if any, submitted herewith and the following specifications:

Location 101 Alba Street Within Fire Limits? no Dist. No. _____
 Owner's or Lessee's name and address Irving Pike, 101 Alba Street Telephone _____
 Contractor's name and address J. H. Jackson & Son, 71 Alba Street Telephone _____
 Architect _____ Plans filed yes No. of sheets 1
 Proposed use of building 1 car garage No. families _____
 Other buildings on same lot Dwelling
 Estimated cost \$ 375 Fee \$ 1.00

Description of Present Building to be Altered

Material _____ No. stories _____ Heat _____ Style of roof _____ Roofing _____
 Last use _____ No. families _____

General Description of New Work

To construct 1 story frame building 12'x20'

NOTIFICATION BEFORE LATHING
 OR CLOSING-IN IS WAIVED

CERTIFICATE OF OCCUPANCY
 REQUIREMENT IS WAIVED

It is understood that this permit does not include installation of heating apparatus which is to be taken out separately by and in the name of the heating contractor.

Details of New Work

Is any plumbing work involved in this work? no
 Is any electrical work involved in this work? no Height average grade to top of plate 7'4"
 Size, front 12' depth 20' No. stories 1 Height average grade to highest point of roof 12'
 To be erected on solid or filled land? solid earth or rock? earth
 Material of foundation concrete slab Thickness, top _____ bottom _____ cellar _____
 Material of underpinning _____ Height _____ Thickness _____
 Kind of roof pitch-gable Rise per foot 9" Roof covering asphalt roofing class C Und. Lab. _____
 No. of chimneys _____ Material of chimneys _____ of lining _____
 Kind of heat none Type of fuel _____ Is gas fitting involved? _____
 Framing lumber—Kind hemlock Dressed or full size? dressed
 Corner posts 4x4 Sills 4x4 Bolted to concrete _____ Girt or ledger board? _____ Size _____
 Material columns under girders _____ Size _____ Max. on centers _____
 Studs (outside walls and carrying partitions) 2x4-16" O. C. Girders 6x8 or larger. Bridging in every floor and flat roof span over 8 feet. Sills and corner posts all one piece in cross section.
 Joists and rafters: 1st floor concrete, 2nd _____, 3rd _____, roof 2x4
 On centers: 1st floor _____, 2nd _____, 3rd _____, roof 2x2
 Maximum span: 1st floor _____, 2nd _____, 3rd _____, roof 6'
 If one story building with masonry walls, thickness of walls? _____ height? _____

If a Garage

No. cars now accommodated on same lot none, to be accommodated 1
 Total number commercial cars to be accommodated none
 Will automobile repairing be done other than minor repairs to cars habitually stored in the proposed building? no

Miscellaneous

Will above work require removal or disturbing of any shade tree on a public street? no
 Will there be in charge of the above work a person competent to see that the State and City requirements pertaining thereto are observed? yes

Original

Signature of owner

Irving Pike
Ralph C. Jackson



FILL IN AND SIGN WITH INK

APPLICATION FOR PERMIT FOR HEATING, COOKING OR POWER EQUIPMENT

Portland, Maine, Sept. 28, 1954

PERMIT NO. 101180
SEP 29 1954
CITY OF PORTLAND

To the INSPECTOR OF BUILDINGS, PORTLAND, MAINE

The undersigned hereby applies for a permit to install the following heating, cooking or power equipment in accordance with the Laws of Maine, the Building Code of the City of Portland, and the following specifications:

Location 101 Alba St. Use of Building 1-family dwelling No. Stories New Building
Name and address of owner of appliance Irving L. Pike, 101 Alba St. Existing
Installer's name and address Randall & McAllister, 54 Commercial St. Telephone 3-2951

General Description of Work

To install gravity hot water heating system and oil burning equipment in place of coal-fired hot water heating system

IF HEATER, OR POWER BOILER

Location of appliance basement Any burnable material in floor surface or beneath? no
If so, how protected? _____ Kind of fuel? oil
Minimum distance to burnable material, from top of appliance or casing top of furnace 36"
From top of smoke pipe 36" From front of appliance over 4' From sides or back of appliance over 3'
Size of chimney flue 8x12 Other connections to same flue none
If gas fired, how vented? _____ Rated maximum demand per hour _____
Will sufficient fresh air be supplied to the appliance to insure proper and safe combustion? yes

IF OIL BURNER

Name and type of burner Timken Labeled by underwriter's laboratories? yes
Will operator be always in attendance? _____ Does oil supply line feed from top or bottom of tank? bottom
Type of floor beneath burner concrete Size of vent pipe 1 1/2"
Location of oil storage basement Number and capacity of tanks 1-275 gal.
Low water shut off _____ Make _____ No. _____
Will all tanks be more than five feet from any flame? yes How many tanks enclosed? _____
Total capacity of any existing storage tanks for furnace burners none

IF COOKING APPLIANCE

Location of appliance _____ Any burnable material in floor surface or beneath? _____
If so, how protected? _____ Height of Legs, if any _____
Skirting at bottom of appliance? _____ Distance to combustible material from top of appliance? _____
From front of appliance _____ From sides and back _____ From top of smokepipe _____
Size of chimney flue _____ Other connections to same flue _____
Is hood to be provided? _____ If so, how vented? _____ Forced or gravity? _____
If gas fired, how vented? _____ Rated maximum demand per hour _____

MISCELLANEOUS EQUIPMENT OR SPECIAL INFORMATION

Amount of fee enclosed? 2.00 (\$2.00 for one heater, etc., 50 cents additional for each additional heater, etc., in same building at same time.)

APPROVED:
92954

Will there be in charge of the above work a person competent to see that the State and City requirements pertaining thereto are observed? yes

Randall & McAllister

Signature of Installer BY: J. C. Randall

INSPECTION COPY



(RC) RESIDENCE ZONE - C

APPLICATION FOR PERMIT

Class of Building or Type of Structure...Third Class

Portland, Maine, June 22, 1956

PERMIT ISSUED

00895 JUN 23 1956

CITY of PORTLAND

To the INSPECTOR OF BUILDINGS, PORTLAND, MAINE

The undersigned hereby applies for a permit to ~~erect~~ alter ~~and~~ ~~construct~~ the following building ~~structure~~ ~~in~~ accordance with the Laws of the State of Maine, the Building Code and Zoning Ordinance of the City of Portland, plans and specifications, if any, submitted herewith and the following specifications:

Location 101 Alba St. Within Fire Limits? no Dist. No. Telephone
Owner's name and address Irving L. & Nettie C. Pike, 101 Alba St. Telephone
Lessee's name and address Telephone
Contractor's name and address owner Telephone
Architect Specifications Plans yes No. of sheets 1
Proposed use of building ~~dwelling~~ garage No. families
Last use * * " No. families
Material wood No. stories 1 Heat Style of roof Roofing
Other building on same lot
Estimated cost \$ 100. Fee \$.50

General Description of New Work

To construct 1-story open piazza 6' x 12' on rear of garage.

30'± to rear lot line.

Permit issued with Memo

4x6 plate - 6' span

CERTIFICATE OF OCCUPANCY REQUIREMENT IS WAIVED

It is understood that this permit does not include installation of heating apparatus which is to be taken out separately by and in the name of the heating contractor. PERMIT TO BE ISSUED TO owner

Details of New Work

Is any plumbing involved in this work? Is any electrical work involved in this work?
Is connection to be made to public sewer? If not, what is proposed for sewage?
Has septic tank notice been sent? Form notice sent?
Height average grade to top of plate Height average grade to highest point of roof
Size, front depth No. stories solid or filled land? earth or rock?
Material of foundation concrete piers at least 4' below grade Thickness, top 9" bottom Sonotubes cellar
Material of underpinning Height Thickness
Kind of roof shed Rise per foot Roof covering Asphalt Class C Und Lab
No. of chimneys Material of chimneys of lining Kind of heat fuel
Framing lumber—Kind hemlock Dressed or full size? dressed
Corner posts 4x4 Sills 4x6 Girt or ledger board? Size
Girders Size Columns under girders Size Max. on centers
Studs (outside walls and carrying partitions) 2x4-16" O. C. Bridging in every floor and flat roof span over 8 feet.
Joists and rafters: 1st floor 2x6 2nd 3rd roof 2x6
On centers: 1st floor 16" 2nd 3rd roof 16"
Maximum span: 1st floor 6' 2nd 3rd roof
If one story building with masonry walls, thickness of walls? height?

If a Garage

No. cars now accommodated on same lot to be accommodated number commercial cars to be accommodated
Will automobile repairing be done other than minor repairs to cars habitually stored in the proposed building?

APPROVED:

with memo by AGJ

Miscellaneous

Will work require disturbing of any tree on a public street? no
Will there be in charge of the above work a person competent to see that the State and City requirements pertaining thereto are observed? YES

INSPECT ON COPY Signature of owner Nettie C. Pike City of Portland

Memorandum from Department of Building Inspection, Portland, Maine

101 Alba St. - Building permit to construct one story open piazza on rear of garage
for and by Irving L. & Nettie C. Pike - 6/25/56

Permit for construction of one story open piazza on rear of garage at the
above location is issued herewith subject to the following conditions:-

1. The 4x6 sills are to be all one piece in cross section (not made up of two pieces of 2x6) and are to be set with the 6-inch dimension upright.
2. The floor joists either are to rest on top of the sills or are to be notched over 2x3 nailing strips spiked to the sides of the sills.

AJS/G

(Signed) Warren McDonald
Inspector of Buildings

CS-27

PERMIT NUMBER 10089		PERMIT TO INSTALL PLUMBING																																																																												
Date Issued 5/9/61		Address 101 Alba Street																																																																												
PORTLAND PLUMBING INSPECTOR		Installation For: Irving Pike																																																																												
By J. P. Welch		Owner of Bldg.: Irving Pike																																																																												
APPROVED FIRST INSPECTION		Owner's Address: 101 Alba Street																																																																												
Date May 8-1961		Plumber: Waynard Walz	Date: 5/9/61																																																																											
By JOSEPH P. WELCH		<table border="1"> <thead> <tr> <th>NEW</th> <th>REP'L</th> <th>PROPOSED INSTALLATIONS</th> <th>NUMBER</th> <th>FEE</th> </tr> </thead> <tbody> <tr> <td></td> <td></td> <td>SINKS</td> <td></td> <td></td> </tr> <tr> <td></td> <td></td> <td>LAVATORIES</td> <td></td> <td></td> </tr> <tr> <td></td> <td></td> <td>TOILETS</td> <td></td> <td></td> </tr> <tr> <td></td> <td>1</td> <td>BATH TUBS</td> <td>1</td> <td>\$ 2.00</td> </tr> <tr> <td></td> <td></td> <td>SHOWERS</td> <td></td> <td></td> </tr> <tr> <td></td> <td></td> <td>DRAINS</td> <td></td> <td></td> </tr> <tr> <td></td> <td></td> <td>HOT WATER TANKS</td> <td></td> <td></td> </tr> <tr> <td></td> <td></td> <td>TANKLESS WATER HEATERS</td> <td>3</td> <td></td> </tr> <tr> <td></td> <td></td> <td>GARBAGE GRINDERS</td> <td></td> <td></td> </tr> <tr> <td></td> <td></td> <td>SEPTIC TANKS</td> <td></td> <td></td> </tr> <tr> <td></td> <td></td> <td>HOUSE SEWERS</td> <td></td> <td></td> </tr> <tr> <td></td> <td></td> <td>ROOF LEADERS (conn. to house drain)</td> <td></td> <td></td> </tr> <tr> <td></td> <td></td> <td></td> <td>1</td> <td>\$ 2.00</td> </tr> <tr> <td></td> <td></td> <td></td> <td>Total</td> <td></td> </tr> </tbody> </table>		NEW	REP'L	PROPOSED INSTALLATIONS	NUMBER	FEE			SINKS					LAVATORIES					TOILETS				1	BATH TUBS	1	\$ 2.00			SHOWERS					DRAINS					HOT WATER TANKS					TANKLESS WATER HEATERS	3				GARBAGE GRINDERS					SEPTIC TANKS					HOUSE SEWERS					ROOF LEADERS (conn. to house drain)						1	\$ 2.00				Total	
NEW	REP'L	PROPOSED INSTALLATIONS	NUMBER	FEE																																																																										
		SINKS																																																																												
		LAVATORIES																																																																												
		TOILETS																																																																												
	1	BATH TUBS	1	\$ 2.00																																																																										
		SHOWERS																																																																												
		DRAINS																																																																												
		HOT WATER TANKS																																																																												
		TANKLESS WATER HEATERS	3																																																																											
		GARBAGE GRINDERS																																																																												
		SEPTIC TANKS																																																																												
		HOUSE SEWERS																																																																												
		ROOF LEADERS (conn. to house drain)																																																																												
			1	\$ 2.00																																																																										
			Total																																																																											
APPROVED FINAL INSPECTION																																																																														
Date May 9-1961																																																																														
By JOSEPH P. WELCH																																																																														
TYPE OF BUILDING																																																																														
<input type="checkbox"/> COMMERCIAL																																																																														
<input type="checkbox"/> RESIDENTIAL																																																																														
<input type="checkbox"/> SINGLE																																																																														
<input type="checkbox"/> MULTI FAMILY																																																																														
<input type="checkbox"/> NEW CONSTRUCTION																																																																														
<input type="checkbox"/> REMODELING																																																																														
5M 12-53	PORTLAND HEALTH DEPT.	PLUMBING INSPECTION																																																																												

99-101 ALBA STREET





APPLICATION FOR PERMIT
DEPARTMENT OF BUILDING INSPECTIONS SERVICES
ELECTRICAL INSTALLATIONS

filmed

Date Jan. 5, 19 84
Receipt and Permit number B 19732

To the CHIEF ELECTRICAL INSPECTOR, Portland, Maine:

The undersigned hereby applies for a permit to make electrical installations in accordance with the laws of Maine, the Portland Electrical Ordinance, the National Electrical Code and the following specifications:

LOCATION OF WORK: 101 Alba Street
OWNER'S NAME: Michael Peters ADDRESS: lives there

OUTLETS: _____ FEES _____

Receptacles _____ Switches _____ Plugmold _____ ft. TOTAL _____

FIXTURES: (number of) _____

Incandescent _____ Flourescent _____ (not strip) TOTAL _____

Strip Flourescent _____ ft. _____

SERVICES: _____

Overhead Underground _____ Temporary _____ TOTAL amperes 100 3.00

METERS: (number of) 1 _____ .50

MOTORS: (number of) _____

Fractional _____

1 HP or over _____

RESIDENTIAL HEATING: _____

Oil or Gas (number of units) _____

Electric (number of rooms) 1 1.00

COMMERCIAL OR INDUSTRIAL HEATING: _____

Oil or Gas (by a main boiler) _____

Oil or Gas (by separate units) _____

Electric Under 20 kws _____ Over 20 kws _____

APPLIANCES: (number of) _____

Ranges _____ Water Heaters _____

Cook Tops _____ Disposals _____

Wall Ovens _____ Dishwashers _____

Dryers _____ Compactors _____

Fans _____ Others (denote) _____

TOTAL _____

MISCELLANEOUS: (number of) _____

Branch Panels _____

Transformers _____

Air Conditioners Central Unit _____

Separate Units (windows) _____

Signs 20 sq. ft. and under _____

Over 20 sq. ft. _____

Swimming Pools Above Ground _____

In Ground _____

Fire/Burglar Alarms Residential _____

Commercial _____

Heavy Duty Outlets, 220 Volt (such as welders) 30 amps and under _____

over 30 amps _____

Circus, Fairs, etc. _____

Alterations to wires _____

Repairs after fire _____

Emergency Lights, battery _____

Emergency Generators _____

FOR ADDITIONAL WORK NOT ON ORIGINAL PERMIT _____ INSTALLATION FEE DUE: _____

FOR REMOVAL OF A "STOP ORDER" (304-16.b) _____ DOUBLE FEE DUE: _____

TOTAL AMOUNT DUE: 4.50

min 5.00

INSPECTION: _____

Will be ready on ready, 19 84; or Will Call _____

CONTRACTOR'S NAME: Piamond Electric

ADDRESS: 247 Alfred St. Biddeford

TEL.: 282-24248

MASTER LICENSE NO.: 4088 SIGNATURE OF CONTRACTOR: _____

LIMITED LICENSE NO.: _____

INSPECTOR'S COPY — WHITE
OFFICE COPY — CANARY
CONTRACTOR'S COPY — GREEN



APPLICATION FOR PERMIT
DEPARTMENT OF BUILDING INSPECTIONS SERVICES
ELECTRICAL INSTALLATIONS

filmed

Date Jan. 5, 19 84
 Receipt and Permit number B 19732

To the CHIEF ELECTRICAL INSPECTOR, Portland, Maine:

The undersigned hereby applies for a permit to make electrical installations in accordance with the laws of Maine, the Portland Electrical Ordinance, the National Electrical Code and the following specifications:

LOCATION OF WORK: 101 Alba Street

OWNER'S NAME: Michael Peters ADDRESS: lives there

OUTLETS: Receptacles _____ Switches _____ Plugmold _____ ft. TOTAL _____ FEES

FIXTURES: (number of) Incandescent _____ Fluorescent _____ (not strip) TOTAL _____
 Strip Fluorescent _____ ft. _____

SERVICES: Overhead Underground _____ Temporary _____ TOTAL amperes 100 3.00

METERS: (number of) 1 _____ .50

MOTORS: (number of) Fractional _____
 1 HP or over _____

RESIDENTIAL HEATING: Oil or Gas (number of units) _____
 Electric (number of rooms) 1 1.00

COMMERCIAL OR INDUSTRIAL HEATING: Oil or Gas (by a main boiler) _____
 Oil or Gas (by separate units) _____
 Electric Under 20 kws _____ Over 20 kws _____

APPLIANCES: (number of) Ranges _____ Water Heaters _____
 Cook Tops _____ Disposals _____
 Wall Ovens _____ Dishwashers _____
 Dryers _____ Compactors _____
 Fans _____ Others (denote) _____

TOTAL _____

MISCELLANEOUS: (number of) Branch Panels _____
 Transformers _____
 Air Conditioners Central Unit _____
 Separate Units (windows) _____
 Signs 20 sq. ft. and under _____
 Over 20 sq. ft. _____
 Swimming Pools Above Ground _____
 In Ground _____
 Fire/Burglar Alarms Residential _____
 Commercial _____
 Heavy Duty Outlets, 220 Volt (such as welders) 30 amps and under _____
 over 30 amps _____
 Circus, Fairs, etc. _____
 Alterations to wires _____
 Repairs after fire _____
 Emergency Lights, battery _____
 Emergency Generators _____

FOR ADDITIONAL WORK NOT ON ORIGINAL PERMIT INSTALLATION FEE DUE: _____
 FOR REMOVAL OF A "STOP ORDER" (304-16.b) DOUBLE FEE DUE: _____
 TOTAL AMOUNT DUE: 4.50
 min 5.00

INSPECTION: Will be ready on ready, 19 84; or Will Call _____
 CONTRACTOR'S NAME: Plamondon Electric
 ADDRESS: 247 Alfred St. Biddeford
 TEL.: 282-2424
 MASTER LICENSE NO.: 4088 SIGNATURE OF CONTRACTOR: _____
 LIMITED LICENSE NO.: _____

INSPECTOR'S COPY — WHITE
 OFFICE COPY — CANARY
 CONTRACTOR'S COPY — GREEN



APPLICATION FOR PERMIT
 DEPARTMENT OF BUILDING INSPECTIONS SERVICES
 ELECTRICAL INSTALLATIONS

Date October 4, 1984
 Receipt and Permit number 05499

To the CHIEF ELECTRICAL INSPECTOR, Portland, Maine:

The undersigned hereby applies for a permit to make electrical installations in accordance with the laws of Maine, the Portland Electrical Ordinance, the National Electrical Code and the following specifications:

LOCATION OF WORK: 101 Alba Street

OWNER'S NAME: Greg Carbone ADDRESS: same

COMPLETED
 COMPLETED FEES

OUTLETS: Receptacles _____ Switches _____ Plugmold _____ ft. TOTAL _____

FIXTURES: (number of) Incandescent _____ Fluorescent _____ (not strip) TOTAL _____
 Strip Fluorescent _____ ft. _____

SERVICES: Overhead Underground _____ Temporary _____ TOTAL amperes 100 3.00

METERS: (number of) 1 _____ .50

MOTORS: (number of) Fractional _____
 1 HP or over _____

RESIDENTIAL HEATING: Oil or Gas (number of units) _____
 Electric (number of rooms) _____

COMMERCIAL OR INDUSTRIAL HEATING: Oil or Gas (by a main boiler) _____
 Oil or Gas (by separate units) _____
 Electric Under 20 kws _____ Over 20 kws _____

APPLIANCES: (number of) Ranges _____ Water Heaters _____
 Cook Tops _____ Disposals _____
 Wall Ovens _____ Dishwashers _____
 Dryers 1 _____ Compactors _____
 Fans _____ Others (denote) _____
 TOTAL _____ 1.50

MISCELLANEOUS: (number of) Branch Panels _____
 Transformers _____
 Air Conditioners Central Unit _____
 Separate Units (windows) _____
 Signs 20 sq. ft. and under _____
 Over 20 sq. ft. _____
 Swimming Pools Above Ground _____
 In Ground _____
 Fire/Burglar Alarms Residential _____
 Commercial _____
 Heavy Duty Outlets, 220 Volt (such as welders) 30 amps and under _____
 over 30 amps _____
 Circus, Fairs, etc. _____
 Alterations to wires _____
 Repairs after fire _____
 Emergency Lights, battery _____
 Emergency Generators _____

INSTALLATION FEE DUE: _____
 FOR ADDITIONAL WORK NOT ON ORIGINAL PERMIT DOUBLE FEE DUE: _____
 FOR REMOVAL OF A "STOP ORDER" (304-16.b)
 TOTAL AMOUNT DUE: 5.00

INSPECTION: Will be ready on _____, 19__; or Will Call
 CONTRACTOR'S NAME: Heritage Electric
 ADDRESS: Route 302, No. Windham ME 04062
 TEL: 892-1756
 MASTER LICENSE NO.: 00726 SIGNATURE OF CONTRACTOR: Paul M. ...
 LIMITED LICENSE NO.: _____

INSPECTOR'S COPY --- WHITE
 OFFICE COPY --- CANARY
 CONTRACTOR'S COPY --- GREEN

PERMIT # 002039 CITY OF Portland BUILDING PERMIT APPLICATION MAP # _____ LOT# _____

Please fill out any part which applies to job. Proper plans must accompany form.

Applicant: Michael Peter - 772-4417

Address: 101 Alba St., Portland, 08103

LOCATION OF CONSTRUCTION: 101 Alba St.

CONTRACTOR: owner SUBCONTRACTORS: _____

ADDRESS: _____

Estimated Construction Cost: \$650.00 Type of Use: single family

Building Dimensions: L _____ W _____ Sq. Ft. _____ # Stories: _____ Lot Size: _____

Proposed Use: _____ Seasonal _____ Condominium _____ Apartment _____

Conversion - Explain: construct new deck as per attached plans.

COMPLETE ONLY IF THE NUMBER OF UNITS WILL CHANGE (DECK ALREADY UP)

Residential Buildings Only: _____

Of Dwelling Units _____ # Of New Dwelling Units _____

Foundation: _____

1. Type of Soil: _____

2. Set Backs - Front _____ Rear _____ Side(s) _____

3. Footings Size: _____

4. Foundation Size: _____

5. Other _____

Floor: _____

1. Sills Size: _____ Sills must be anchored.

2. Girder Size: _____

3. Lally Column Spacing: _____ Size: _____

4. Joists Size: _____ Spacing 16" O.C.

5. Bridging Type: _____ Size: _____

6. Floor Sheathing Type: _____ Size: _____

7. Other Material: _____

Exterior Walls: _____

1. Studding Size _____ Spacing _____

2. No. windows _____

3. No. Doors _____

4. Header Sizes _____ Span(s) _____

5. Bracing: Yes _____ No _____

6. Corner Posts Size _____

7. Insulation Type _____ Size _____

8. Sheathing Type _____ Size _____

9. Siding Type _____ Weather Exposure _____

10. Masonry Materials _____

11. Metal Materials _____

Interior Walls: _____

1. Studding Size _____ Spacing _____

2. Header Sizes _____ Span(s) _____

3. Wall Covering Type _____

4. Fire Wall if required _____

5. Other Materials _____

For Official Use Only

Date: April 25, 1989 Subdivision: Yes / No _____

Inside Fire Limits _____ Name _____

Bldg Code _____ Lot _____

Time Limit _____ Block _____

Estimated Cost: \$650.00 Permit Expiration: _____

Value/Structure _____ Ownership: _____ Public _____ Private _____

Fee: \$25.00

Ceiling:

1. Ceiling Joists Size: _____

2. Ceiling Strapping Size _____ Spacing _____

3. Type Ceilings: _____

4. Insulation Type _____ Size _____

5. Ceiling Height: _____

Roof:

1. Truss or Rafter Size _____ Span _____

2. Sheathing Type _____ Size _____

3. Roof Covering Type _____

4. Other _____

Chimneys:

Type: _____ Number of Fire Places _____

Heating:

Type of Heat: _____

Electrical:

Service Entrance Size _____ Smoke Detector Required Yes _____ No _____

Plumbing:

1. Approval of soil test if required Yes _____ No _____

2. No. of Tubs or Showers _____

3. No. of Flushes _____

4. No. of Lavatories _____

5. No. of Other Fixtures _____

Swimming Pools:

1. Type: _____

2. Pool Size: _____ Square Footage _____

3. Must conform to National Electrical Code and State Law.

Zoning:

District: R-3 Street Frontage Req. _____ Provided _____

Required Setbacks: Front _____ Back _____ Side _____

Review Required:

Zoning Board Approval: Yes _____ No _____ Date: _____

Planning Board Approval: Yes _____ No _____ Date: _____

Conditional Use: _____ Variance _____ Site Plan _____ Subdivision _____

Shore and Floodplain Mgmt. _____ Special Exception _____

Other (Explain): _____

Date Approved: 4/25/89

Permit Received By Nancy Grossman

Signature of Applicant [Signature] Date 4/25/89

Signature of CEO _____ Date _____

Inspection Dates _____

PERMIT ISSUED WITH LETTER

19/28/89

White-Tax Assesor

Yellow-GPCOG

White Tag-CEO

© Copyright GPCOG 1987

PLOT PLAN

Deck already built ok

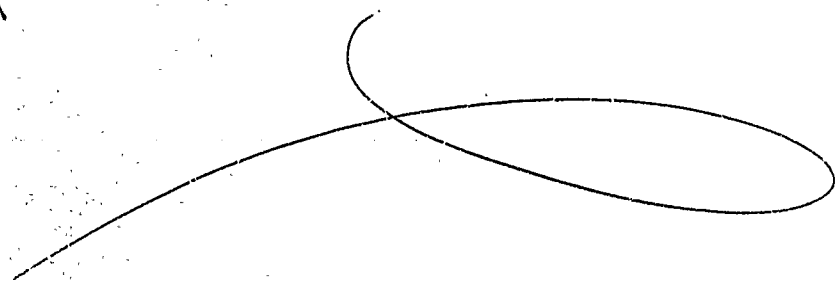

FEES (Breakdown From Front)

Base Fee \$ 25.00 _____
 Subdivision Fee \$ _____
 Site Plan Review Fee \$ _____
 Other Fees \$ _____
 (Explain) _____
 Late Fee \$ _____

Inspection Record

Type	Date
_____	____/____/____
_____	____/____/____
_____	____/____/____
_____	____/____/____

COMMENTS

Signature of Applicant *Michael H. [Signature]*

Date *4/25/89*

BUILDING PERMIT REPORT

ADDRESS: 161 ALBA ST. DATE: 8/may/89

REASON FOR PERMIT: deck 12'x22'

BUILDING OWNER: Michael Peters

CONTRACTOR: 11

PERMIT APPLICANT: 11

APPROVED: X9 DENIED: _____

CONDITION OF APPROVAL OR DENIAL:

- 1.) Before concrete for foundation is placed, approvals from Public Works and Inspection Services must be obtained.
- 2.) Precaution must be taken to protect concrete from freezing.
- 3.) All vertical openings shall be enclosed with construction having a fire rating of at least one(1) hour, including fire doors with self-closers.
- 4.) Each apartment shall have access to two(2) separate, remote and approved means of egress. A single exit is acceptable when it exits directly from the apartment to the building exterior with no communications to other apartment units.
- 5.) The boiler shall be protected by enclosing with one(1) hour fire rated construction including fire doors and ceiling, or by placing over the boiler, two(2) residential sprinkler heads supplied from the domestic water.
- 6.) Every sleeping room below the fourth story in buildings of Use Groups R and I-1 shall have at least one operable window or exterior door approved for emergency egress or rescue. The units must be operable from the inside opening without the use of separate tools. Where windows are provided as a means of egress or rescue, they shall have a sill height not more than 44 inches (1118 mm) above the floor. All egress or rescue windows from sleeping rooms must have minimum net clear openings of 5.7 square feet (0.53m²). The minimum net clear opening height dimension shall be 24 inches (610 mm). The minimum net clear opening width dimension shall be 20 inches (508 mm).
- 7.) In addition to any automatic fire alarm system required by Sections 1018.3.5, a minimum of one single station smoke detector shall be installed in each guest room, suite of sleeping area in buildings of Use Groups R-1 and I-1 and in dwelling units in the immediate vicinity of the bedrooms in buildings of Use Group R-2 or R-3. When actuated, the detector shall provide an alarm suitable to warn the occupants within the individual unit (see Section 1717.3.1).

In buildings of Use Groups R-1 and R-2 which have basements, an additional smoke detector shall be installed in the basement. In buildings of Use Group R-3, smoke detectors shall be required on every story of the dwelling unit, including basements

In dwelling units with split levels, a smoke detector installed on the upper level shall suffice for the adjacent lower level provided the lower level is less than one full story below the upper level. If there is an intervening door between the adjacent levels, a smoke detector shall be installed on both levels.

All detectors shall be installed in an approved location. Where more than one detector is required to be installed within an individual dwelling unit, the detectors shall be wired in such a manner that the actuation of one alarm will actuate all the alarms in the individual unit.

8.) Private garages located beneath rooms in buildings of Use Groups R-1, R-2, R-3 or I-1 shall have walls, partitions, floors and ceilings separating the garage space from the adjacent interior spaces constructed of not less than 1-hour fire-resistance rating. Attached private garages shall be completely separated from the adjacent interior spaces and the attic area by means of 1/2-inch gypsum board or equivalent applied to the garage side. The sills of all door openings between the garage and adjacent interior spaces shall be raised not less than 4 inches (102 mm) above the garage floor. The door opening protectives shall be 1 3/4-inch solid core wood doors or approved equivalent.

9.) A guardrail system located near the open side of deck or elevated walking surfaces shall be constructed. Guards in buildings of Use Group R-3 shall be not less than 36 inches in height. Open guards shall have intermediate rails, balusters or other construction such that a sphere with a diameter of 6 inches cannot pass through any opening.

10.) Section 25-135 of the Municipal Code for the City of Portland states: "No person or utility shall be granted a permit to excavate or open any street or sidewalk from the time of November 15 of each year to April 15 of the following year.

11.) The builder of a facility to which Section 4594-C of the Maine State Human Rights Act, Title 5 M.R.S.A. refers, shall obtain a certification from a design professional that the plans of the facility meet the standards of construction required by this section. Prior to commencing construction of the facility, the builder shall submit the certification to the Division of Inspection Services.

Sincerely,

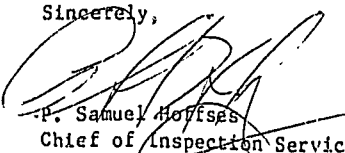
P. Samuel Hoffses
Chief of Inspection Services

/el
11/16/88

DECK TO CONSIST OF ALL 2x8 CONSTRUCTION W/
POSTS AT 16" ON CENTER. DECKING IS FULL 5/4 P.T.
Red denotes POSTS WHICH ARE 4x4'S - IN CEMENT DOWN 4"

HOUSE

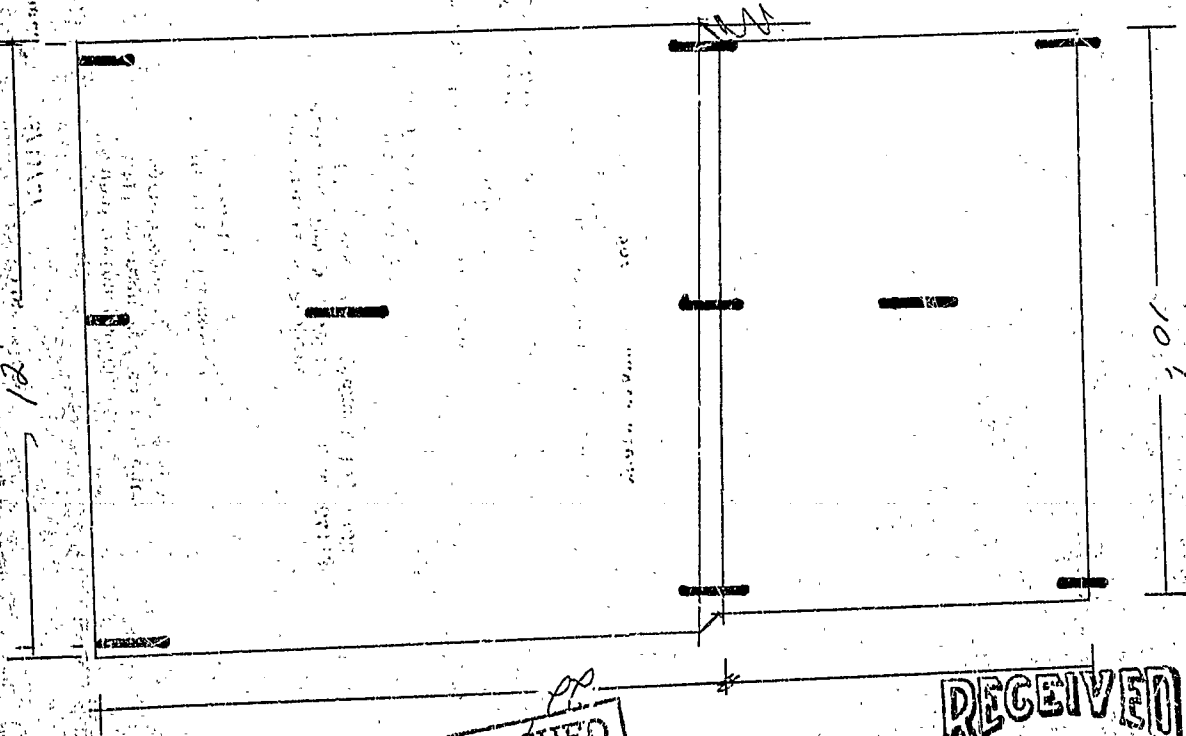

PP
PERMIT ISSUED
WITH LETTER
10% *Allen SA*

RECEIVED

APR 25 1989

DEPT. OF BUILDING INSPECTIONS
CITY OF PORTLAND

MIF 1

THIS IS NOT A BOUNDARY SURVEY

MORTGAGE LOAN INSPECTION PLAN

101 ALBA STREET
FORTLAND, MAINE

No. 601-41

TO THE LENDING INSTITUTION AND ITS TITLE INSURER
I hereby certify that the location of the dwelling shown
on this plan did conform with the local zoning
laws in effect at the time of construction. The property
does not fall within a special flood hazard zone.

OWNER: MICHAEL H AND LISA A
PETERS

BOOK _____ PAGE _____ COUNTY CUMBERLAND

PLAN BOOK 8 PAGE 7 LOT 32

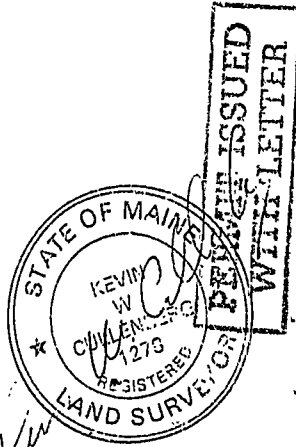
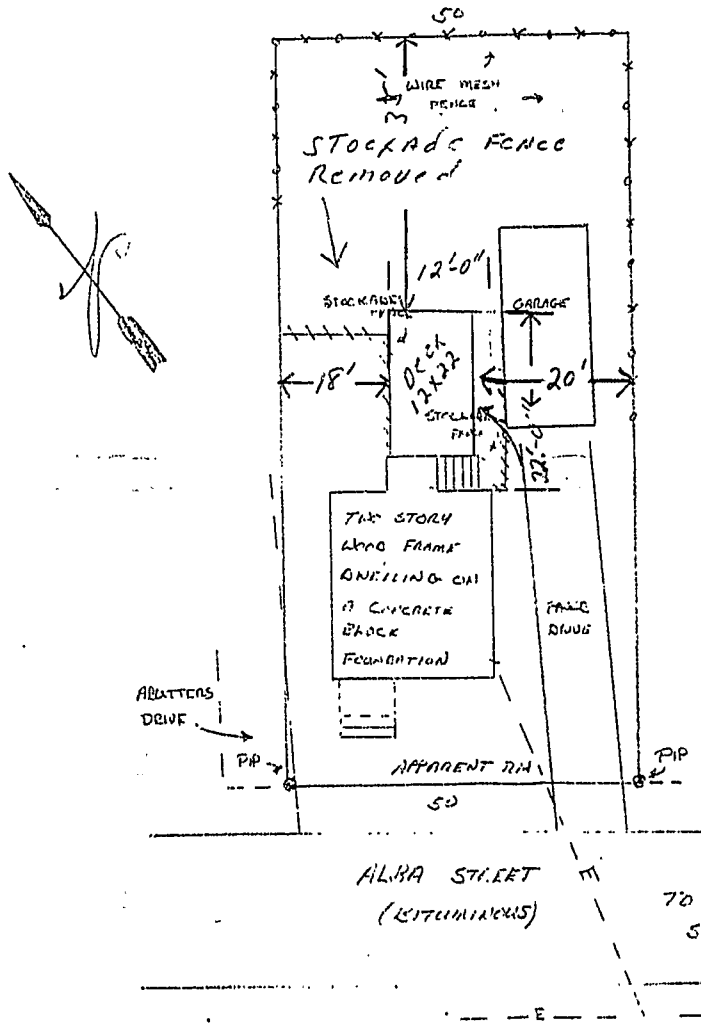

RECEIVED
APR 25 1989

DEPT. OF BUILDING INSPECTIONS
CITY OF PORTLAND

THIS IS NOT A BOUNDARY SURVEY. This plan is based strictly on information provided by others and does not take into consideration any conflicts which abutting descriptions may contain. This plan was not made from an instrument survey. The certifications are for mortgage purposes only. This plan applies only to conditions existing as of the date shown hereon. This plan is not for recording.

Date 2-26-89 Scale 1"=20'

R.P. TITCOMB ASSOCIATES, INC. Falmouth, Maine Drawn By VFK

PERMIT # 002039 CITY OF Portland BUILDING PERMIT APPLICATION MAP # _____ LOT# _____

Please fill out any part which applies to job. Proper plans must accompany form.

Owner: Michael Peters - 772-4417

Address: 101 Alba St., Portland, 08103

LOCATION OF CONSTRUCTION 101 Alba St.

CONTRACTOR: owner SUBCONTRACTORS: _____

ADDRESS: _____

Est. Construction Cost: \$650.00 Type of Use: single family

Past Use: _____

Building Dimensions L W Sq. Ft. # Stories: Lot Size:

Is Proposed Use: Seasonal Condominium Apartment

Conversion - Explain construct new deck as HMM per attached plans.

COMPLETE ONLY IF THE NUMBER OF UNITS WILL CHANGE (DECK ALREADY UP)

Residential Buildings Only: # Of Dwelling Units # Of New Dwelling Units

Foundation:

1. Type of Soil: _____
2. Set Backs - Front _____ Rear _____ Side(s) _____
3. Footings Size: _____
4. Foundation Size: _____
5. Other _____

Floor:

1. Sills Size: _____ Sills must be anchored.
2. Girder Size: _____
3. Lally Column Spacing: _____ Size: _____
4. Joists Size: _____ Spacing 16" O.C.
5. Bridging Type: _____ Size: _____
6. Floor Sheathing Type: _____ Size: _____
7. Other Material: _____

Exterior Walls:

1. Studding Size _____ Spacing _____
2. No. windows _____
3. No. Doors _____
4. Header Sizes _____ (Specify) _____
5. Bracing: Yes _____ No _____
6. Corner Posts Size _____
7. Insulation Type _____ Size _____
8. Sheathing Type _____ Size _____
9. Siding Type _____ Weather Exposure _____
10. Masonry Materials _____
11. Metal Materials _____

Interior Walls:

1. Studding Size _____ Spacing _____
2. Header Sizes _____ Span(s) _____
3. Wall Covering Type _____
4. Fire Wall if required _____
5. Other Materials _____

For Official Use Only	
Date <u>April 25, 1989</u>	Subdivision: Yes / No _____
Inside Fire Limits _____	Name _____
Blgd Code _____	Lot _____
Time Limit _____	Block _____
Estimated Cost <u>\$650.00</u>	Permit Expiration: _____
Value/Structure _____	Ownership: _____ Public _____ Private _____
Fee <u>\$25.00</u>	

Ceiling:

1. Ceiling Joists Size: _____
2. Ceiling Strapping Size _____ Spacing _____
3. Type Ceilings: _____
4. Insulation Type _____ Size MAY 8 1989
5. Ceiling Height: _____

Roof:

1. Truss or Rafter Size _____ City Of Portland
2. Sheathing Type _____ Size _____
3. Roof Covering Type _____
4. Other _____

Chimneys:

Type: _____ Number of Fire Place: _____

Heating:

Type of Heat: _____

Electrical:

Service Entrance Size: _____ Smoke Detector Required Yes _____ No _____

Plumbing:

1. Approval of soil test if required Yes _____ No _____
2. No. of Tubs or Showers _____
3. No. of Flushes _____
4. No. of Lavatories _____
5. No. of Other Fixtures _____

Swimming Pools:

1. Type: _____
2. Pool Size: _____ x _____ Square Footage _____
3. Must conform to National Electrical Code and State Law.

Zoning:

District _____ Street Frontage Req. _____ Provided _____

Required Setbacks: Front _____ Back _____ Side _____ Side _____

Review Required:

Zoning Board Approval: Yes _____ No _____ Date: _____
 Planning Board Approval: Yes _____ No _____ Date: _____
 Conditional Use: _____ Variance _____ Site Plan _____ Subdivision _____
 Shore and Floodplain Mgmt. _____ Special Exception _____
 Other (Explain) _____
 Date Approved _____

Permit Received By Nancy Grossman

Signature of Applicant Michael H. Peters Date 4/25/89

Signature of CEO _____ Date _____

Inspection Dates (2) CT