

88-90 EAST KIDDER ST.

SHAW-WALKER
MADE IN U.S.A.
#9203-1R



FILL IN AND SIGN WITH INK

APPLICATION FOR PERMIT FOR HEATING, COOKING OR POWER EQUIPMENT

PERMIT ISSUED

JAN 9 1956

Portland, Maine, Jan 9, 1956

TYPE OF EQUIPMENT

HEATING

To the INSPECTOR OF BUILDINGS, PORTLAND, ME.

The undersigned hereby applies for a permit to install the following heating, cooking or power equipment in accordance with the Laws of Maine, the Building Code of the City of Portland, and the following specifications:

Location 88-90 East Kidder St. Use of Building 1-family dwelling. No. Stories 1 New Building EXISTING
Name and address of owner of appliance Malcolm C. Reed, 14 Ocean Ave.
Installer's name and address B. G. Pride Co., Inc., 15 Dudley St. Telephone 2-6123

General Description of Work

To install forced warm air heating system and oil burning equipment

IF HEATER, OR POWER BOILER

Location of appliance basement Any burnable material in floor surface or beneath? no.
If so, how protected? Kind of fuel? oil from plenum chamber with shield
Minimum distance to burnable material, from top of appliance or casing top of furnace 6"
From top of smoke pipe 18" From front of appliance over 4" From sides or back of appliance over 3"
Size of chimney flue 8x10 Other connections to same flue none
If gas fired, how vented? Rated maximum demand per hour
Will sufficient fresh air be supplied to the appliance to insure proper and safe combustion? YES

IF OIL BURNER

Name and type of burner Chrysler Airtemp Labelled by underwriters' laboratories? yes
Will operator be always in attendance? Does oil supply line feed from top or bottom of tank? bottom
Type of floor beneath burner concrete Size of vent pipe 1 1/2"
Location of oil storage basement Number and capacity of tanks 1-275 gal.
Low water shut off Make No.
Will all tanks be more than five feet from any flame? yes How many tanks enclosed?
Total capacity of any existing storage tanks for furnace burners

IF COOKING APPLIANCE

Location of appliance Any burnable material in floor surface or beneath?
If so, how protected? Height of Legs, if any
Skirting at bottom of appliance? Distance to combustible material from top of appliance?
From front of appliance From sides and back From top of smokepipe
Size of chimney flue Other connections to same flue
Is hood to be provided? If so, how vented? Forced or gravity?
If gas fired, how vented? Rated maximum demand per hour

MISCELLANEOUS EQUIPMENT OR SPECIAL INFORMATION

Blank lines for miscellaneous information

Amount of fee enclosed? 2.00 (\$2.00 for one heater, etc., 50 cents additional for each additional heater, etc., in same building at same time.)

APPROVED

Signature: E. J. R. 1/9/56

Will there be in charge of the above work a person competent to see that the State and City requirements pertaining thereto are observed? YES

B. G. Pride Co., Inc.

617 100 IN MAINE PRINTING CO.

INSPECTION COPY

Signature of Installer: R. H. White

- 1 Fill Pipe
- 2 Vent Pipe
- 3 Rod of Heat
- 4 Riser Rigidity & supports
- 5 Name & Label
- 6 Stack Control
- 7 High Limit Control
- 8 Remote Control
- 9 Piping supports or protection
- 10 Valves in supply lines
- 11 Capacity of Tanks
- 12 Tank Height & supports
- 13 Tank Ventilation
- 14 (HI) Gaskets
- 16 Instruction Card
- 18 Low Water Shut-off

NOTES

Permit No. 56/21
Location 8290 E. 2nd St
Owner MacLellan Co. Good
Date of permit 1/9/56
Approved 2/15/56 E.R.R.

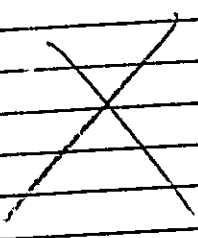
| | |
|--|--|
|  | |
|--|--|



APPLICATION FOR PERMIT

Class of Building or Type of Structure Third Class
Portland, Maine, Oct. 12, 1955

PERMIT ISSUED

0183
OCT 13 1955

CITY of PORTLAND

To the INSPECTOR OF BUILDINGS, PORTLAND, MAINE

The undersigned hereby applies for a permit to erect ~~and install~~ and install the following building ~~structure~~ structure in accordance with the Laws of the State of Maine, the Building Code and Zoning Ordinance of the City of Portland, plans and specifications, if any, submitted herewith and the following specifications:

Location 88-90 East Kidder St. Within Fire Limits? yes Dist. No. _____
 Owner's name and address Malcolm C. Reed, 44 Ocean Ave. Telephone _____
 Lessee's name and address _____ Telephone _____
 Contractor's name and address Arthur O. Soule, 15 Dudley St. Telephone _____
 Architect _____ Specifications _____ Plans yes Telephone 2-6193
 Proposed use of building _____ No. of sheets 2
 Last use _____ No. families 1
 Material _____ No. stories _____ Heat _____ Style of roof _____ No. families _____
 Other buildings on same lot _____ Roofing _____
 Estimated cost \$ 8,000. Fee \$ 8.00

General Description of New Work

To construct 1-story frame dwelling house 29' x 24' 6".

Permit Issued with Letter

It is understood that this permit does not include installation of heating apparatus which is to be taken out separately by and in the name of the heating contractor. PERMIT TO BE ISSUED TO Arthur O. Soule

Details of New Work

Is any plumbing involved in this work? yes Is any electrical work involved in this work? yes
 Is connection to be made to public sewer? yes If not, what is proposed for sewage? _____
 Has septic tank notice been sent? _____ Form notice sent? yes
 Height average grade to top of plate 10' Height average grade to highest point of roof 15'
 Size, front 29' depth 24' 6" No. stories 1 solid or filled land? solid earth or rock? earth
 Material of foundation concrete at least 4' below grade Thickness, top 10" bottom 12" cellar yes
 Material of underpinning _____ to sill _____ Height _____ Thickness _____
 Kind of roof pitch-gable Rise per foot 5" Roof covering Asphalt Class C Und Lab
 No. of chimneys 1 Material of chimneys brick of lining tile Kind of heat f w air fuel oil
 Framing lumber—Kind hemlock Dressed or full size? dressed
 Corner posts 2x6 Sills box (girt or ledger board?) _____ Size _____
 Girders yes Size 6x8 Columns under girders Lally Size 3 1/2" Max. on centers 7'
 Studs (outside walls and carrying partitions) 2x4-16" O. C. Bridging in every floor and flat roof span over 8 feet.
 Joists and rafters: 1st floor 2x8, 2nd 2x6, 3rd _____, roof 2x6
 On centers: 1st floor 16", 2nd 16", 3rd _____, roof 16"
 Maximum span: 1st floor 12', 2nd 12', 3rd _____, roof _____
 If one story building with masonry walls, thickness of walls? _____ height? _____

If a Garage

No. cars now accommodated on same lot _____, to be accommodated _____ number commercial cars to be accommodated _____
Will automobile repairing be done other than minor repairs to cars habitually stored in the proposed building? _____

APPROVED:

011-10/10/55 - ajs

Miscellaneous

Will work require disturbing of any tree on a public street? no
Will there be in charge of the above work a person competent to see that the State and City requirements pertaining thereto are observed? yes

Malcolm C. Reed

INSPECTION COPY

Signature of owner

Arthur O. Soule

NOTES

11/7/55 - Mr. Brown says
 he allowed a ft. sign +
 came on, on proposed street
 on St. Lawrence 196 to
 back of street in.

11/3/55 - From check 015
 = 5.8.

12/1/55 - Framing
 under way 5.8.

1/4/56 - Framing about
 completed 5.8.

1/16/56 - Set + C. T.
 to close in back.

2/1/56 - Wall done,
 Certificate to
 be removed. 0.1

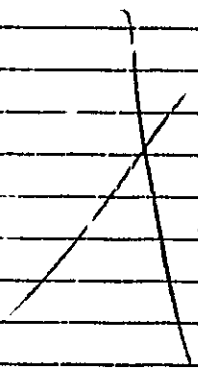

Permit No. 55/1867
 Location: 85 St. Lawrence St.
 Owner: McLaughlin Co. Inc.
 Date of permit: 10/13/55
 Notif. closing: 11/1/56
 Inspn. closing: 11/16/56
 Inspn. Final Inspection: 11/17/56
 Final Notif. 11/17/56
 Final Inspn. 2/1/56
 Cert. of Occupancy issued 1/16/56
 Sinking Out Notice
 Form Check Notice 11/3/55

11/8/55
 11/2/55

CS-124-50-Marks

(COPY)



CITY OF PORTLAND, MAINE
Department of Building Inspection

Certificate of Occupancy

LOCATION 88-90 East Kidder St.

Issued to **Malcolm G. Reed**

Date of Issue **Feb. 15, 1956**

This is to certify that the building, premises, or part thereof, at the above location, built ~~under~~
~~under~~ Building Permit No. **55/1867**, has had final inspection, has been found to conform
substantially to requirements of Zoning Ordinance and Building Code of the City, and is hereby approved for
occupancy or use, limited or otherwise, as indicated below.

PORTION OF BUILDING OR PREMISES

Entire

APPROVED OCCUPANCY

One-family Dwelling House

Limiting Conditions:

This certificate supersedes
certificate issued

Approved:

2/15/56 *Carl S. Smith*

(Date)

Inspector

Warren
Inspector of Building

Notice: This certificate identifies lawful use of building or premises, and ought to be transferred from
owner to owner when property changes hands. Copy will be furnished to owner or lessee for one dollar.

VACANT LOT

STREET LINE AND GRADE
PROCURED FROM DEPT. OF
PUBLIC WORKS.

APPLICANT TAKES FULL
RESPONSIBILITY FOR ACCURACY
OF LOT BOUNDARY MARKINGS.

ST. CHARLES ST.

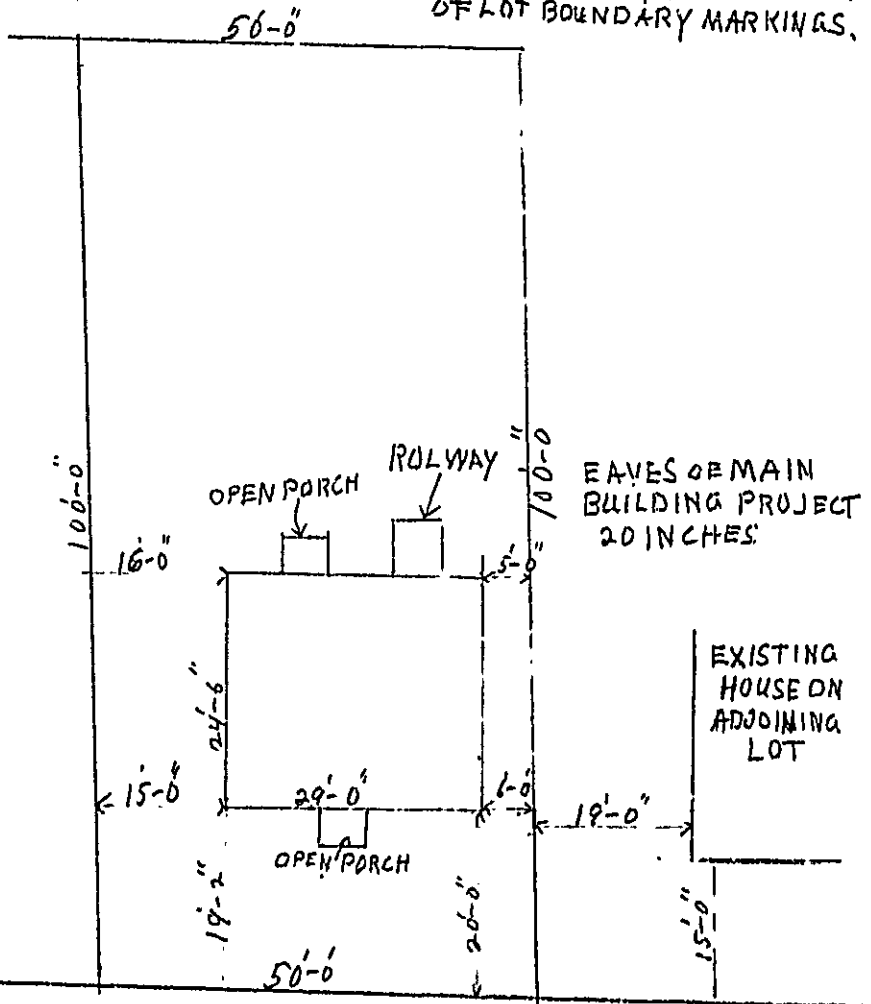

EAVES OF MAIN
BUILDING PROJECT
20 INCHES

EXISTING
HOUSE ON
ADJOINING
LOT

RECEIVED
NOV - 3 1955
DEPT. OF BLD'G. INSP.
CTY OF PORTLAND

85-88 KIDDER ST.

VACANT LOT

STREET LINE AND GRADE
PROCURED FROM DEPT. OF
PUBLIC WORKS.

APPLICANT TAKES FULL
RESPONSIBILITY FOR
ACCURACY OF LOT BOUNDARY
MARKINGS.

ST. CHARLES STREET

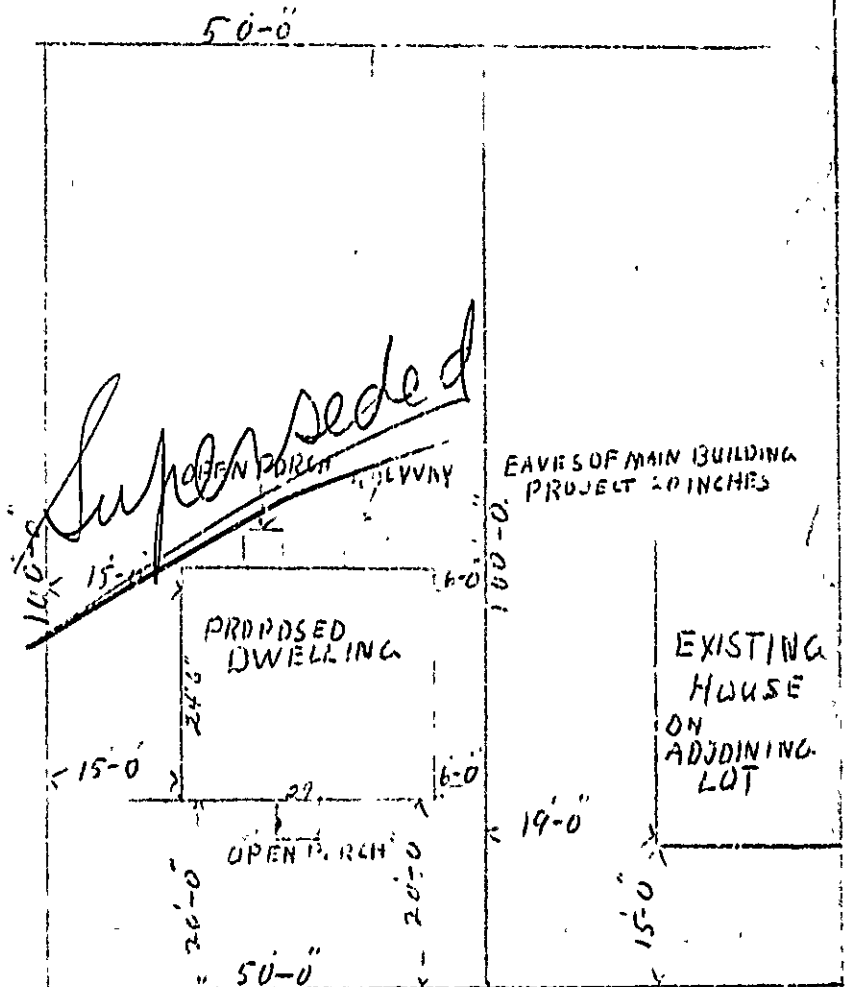

~~86-38~~
88-90

KINDER STREET



APPLICATION FOR PERMIT
DEPARTMENT OF BUILDING INSPECTIONS SERVICE,
ELECTRICAL INSTALLATIONS

Date October 1, 1988
 Receipt and Permit number 27663

To the CHIEF ELECTRICAL INSPECTOR Portland Maine

The undersigned hereby applies for a permit to make electrical installations in accordance with the laws of Maine, the Portland Electrical Ordinance, the National Electrical Code and the following specifications

LOCATION OF WORK 88 East Kidder
 OWNER'S NAME Mallo'na Reed ADDRESS same

| | | | | | |
|-----------------------------------|--|-------------------|-----------------|---------------|------|
| OUTLETS | Receptacles | Switches | Plugs/mole | ft. TOTAL | |
| FIXTURES (number of) | Incandescent | Flourescent | (not strip) | TOTAL | |
| | Strip Flourescent | ft. | | | |
| SERVICES: | Overhead | Underground | Temporary | TOTAL amperes | |
| METERS: (number of) | | | | | |
| MOTORS: (number of) | Fractional | | | | |
| | 1 HP or over | | | | |
| RESIDENTIAL HEATING: | Oil or Gas (number of units) | | | | |
| | Electric (number of rooms) | | | | |
| COMMERCIAL OR INDUSTRIAL HEATING: | Oil or Gas (by a main boiler) | | | | |
| | Oil or Gas (by separate units) | | | | |
| | Electric Under 20 kws | Over 20 kws | | | |
| APPLIANCES: (number of) | Rt ges | | Water Heaters | | |
| | Cook Tops | | Disposals | | |
| | Wall Ovens | | Dishwashers | | |
| | Drivers | | Compactors | | |
| | Fans | | Others (denote) | | |
| | TOTAL | | | | |
| MISCELLANEOUS: (number of) | Branch Panels <u>X 1</u> | | | | 1.00 |
| | Transformers | | | | |
| | Air Conditioners Central Unit | | | | |
| | Separate Units (windows) | | | | |
| | Signs 20 sq. ft. and under | | | | |
| | Over 20 sq. ft. | | | | |
| | Swimming Pools Above Ground | | | | |
| | In Ground | | | | |
| | Fire/Burglar Alarms Residential | | | | |
| | Commercial | | | | |
| | Heavy Duty Outlets, 220 Volt (such as welder) | 30 amps and under | | | |
| | | over 30 amps | | | |
| | Circus, Fairs, etc. | | | | |
| | Alterations to wires <u>2.00</u> (Fuse Panel to Breaker) | | | | 2.00 |
| | Repairs after fire | | | | |
| | Emergency Lights, battery | | | | |
| | Emergency Generators | | | | |

FOR ADDITIONAL WORK NOT ON ORIGINAL PERMIT INSTALLATION FEE DUE:
 FOR REMOVAL OF A "STOP ORDER" (304-16.b) DOUBLE FEE DUE:
 TOTAL AMOUNT DUE: 5.00

INSPECTION: Will be ready on Oct. 11, 1988, or Will Call _____
 CONTRACTOR'S NAME: Robert Bradley
 ADDRESS: RR1 Box 314 Yarmouth Me. 04096
 TEL: 66-30147
 MASTER LICENSE NO.: 03134 SIGNATURE OF CONTRACTOR: Robert Bradley
 LIMITED LICENSE NO.: _____

INSPECTOR'S COPY — WHITE
 OFFICE COPY — CANARY
 CONTRACTOR'S COPY — GREEN

