

572-574 OCEAN AVENUE

SMITHSONIAN INSTITUTION
WASHINGTON, D.C. 20540



(L) LOCAL ORDINANCES & RULES
APPLICATION FOR PERMIT

Class of Building or Type of Structure Second Class

Portland, Maine, December 15, 1950

To the INSPECTOR OF BUILDINGS, PORTLAND, ME.

This undersigned hereby applies for a permit to erect alter repair demolish install the following building structure equipment in accordance with the Laws of the State of Maine, the Building Code and Zoning Ordinance of the City of Portland, plans and specifications, if any, submitted herewith and the following specifications:

Location 574-574 Oce Avenue Within Fire Limits? no Dist. No. _____

Owner's name and address corner Lunt St. Joseph Phillippi, 805 Washington Ave. Telephone _____

Lessee's name and address _____ Telephone _____

Contractor's name and address J. Ernest Roberts, 124 Washington Ave. Telephone _____

Architect _____ Specifications _____ Plans yes No. of sheets 1

Proposed use of building Retail store No. families _____

Last use _____ No. families _____

Material _____ No. stories _____ Heat _____ Style of roof _____ Roofing _____

Other buildings on same lot _____

Estimated cost \$ _____ Fee \$ _____

General Description of New Work

To construct 1 story cinder block store 50'x100'

This application is preliminary to get settled the question of zoning appeal. In event the appeal is sustained the applicant will furnish complete information, estimated cost of the work and pay legal fee.

It is understood that this permit does not include installation of heating apparatus which is to be taken out separately by and in the name of the heating contractor.

Details of New Work

Is any plumbing work involved in this work? _____ Is any electrical work involved in this work? _____

Height average grade to top of plate _____ Height average grade to highest point of roof _____

Size, front _____ depth _____ No. stories _____ solid or filled land? _____ earth or rock? _____

Material of foundation _____ Thickness, top _____ bottom _____ cellar _____

Material of underpinning _____ Height _____ Thickness _____

Kind of roof _____ Rise per foot _____ Roof covering _____

No. of chimneys _____ Material of chimneys _____ of lining _____ Kind of heat _____ fuel _____

Framing lumber—Kind _____ Dressed or full size? _____

Corner posts _____ Sills _____ Girt or ledger board? _____ Size _____

Girders _____ Size _____ Columns under girders _____ Size _____ Max. on centers _____

Studs (outside walls and carrying partitions) 2x4-16" O. C. Bridging in every floor and flat roof span over 8 feet.

Joists and rafters: 1st floor _____, 2nd _____, 3rd _____, roof _____

On centers: 1st floor _____, 2nd _____, 3rd _____, roof _____

Maximum span: 1st floor _____, 2nd _____, 3rd _____, roof _____

If one story building with masonry walls, thickness of walls? _____ height? _____

If a Garage

No. cars now accommodated on same lot _____, to be accommodated _____ number commercial cars to be accommodated _____

Will automobile repairing be done other than minor repairs? _____ No cars habitually stored in the proposed building? _____

Miscellaneous

Will work require disturbing of any tree on a public street? no

Will there be in charge of the above work a person competent to see that the State and City requirements pertaining thereto are observed? yes

APPROVED:

Signature of owner: Joseph Phillippi

Joseph Phillippi

INSPECTION COPY

Permit No. 1
Location 572-574 Ocean Ave
Owner Joseph Philippe
Date of permit 1/16/68
Notif. closing-in _____
Inspn. closing-in _____
Final Notif _____
Final Inspn _____
Cert. of Occupancy issued _____

NOTES

Handwritten signature

Permit No 1
Location 572-574 Ocean Ave
Owner Joseph Philippe
Date of permit 1/10/76
Notif. closing-in _____
Inspn. closing-in _____
Final Notif _____
Final Inspn _____
Cert. of Occupancy issued _____

NOTES

Handwritten signature

LINTE ST

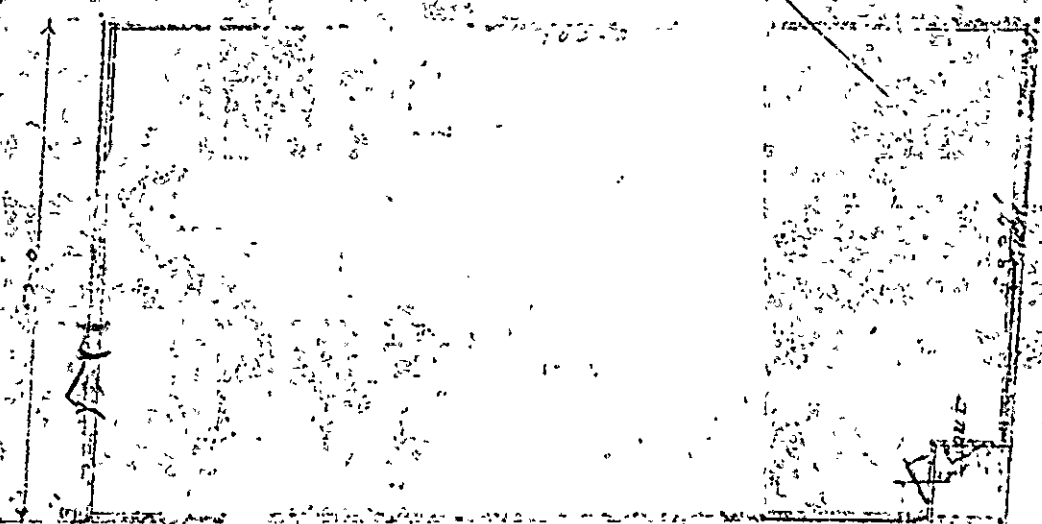

PHILIPPI LAND

OCEANA AVE

PLOT PLAN	
PROPOSED	
TRUTH D.M.C. & SONS	
JOSEPH PHILIPPI	
Scale	Date
1" = 15'-0"	12/12/50
Drawn by	Ernest Rodert

COLLECTED LAND

MONT. ST.

10.77

77.8

PHILIPPI LAND

JOSEPH PHILIPPI
LAND

98.00

PHILIPPI

72.71

GEORGE COOPER



APPLICATION FOR PERMIT
DEPARTMENT OF BUILDING INSPECTIONS SERVICES
ELECTRICAL INSTALLATIONS

Date 4/13/90, 19
 Receipt and Permit number 01277

To the CHIEF ELECTRICAL INSPECTOR, Portland, Maine:

The undersigned hereby applies for a permit to make electrical installations in accordance with the laws of Maine, the Portland Electrical Ordinance, the National Electrical Code and the following specifications:

LOCATION OF WORK: 574 Ocean Ave. (Engine 11- Fire Station)

OWNER'S NAME: City/Build ADDRESS: City Hall

OUTLETS: Receptacles 5 Switches 03 Plugmold _____ ft. TOTAL _____ FEES _____

FIXTURES: (number of) Incandescent _____ Fluorescent _____ (not strip) TOTAL _____
 Strip Fluorescent _____ ft. _____

SERVICES: Overhead x Underground _____ Temporary _____ TOTAL amperes 200 .. waived

METERS: (number of) _____

MOTORS: (number of) Fractional _____
 1 HP or over _____

RESIDENTIAL HEATING: Oil or Gas (number of units) _____
 Electric (number of rooms) _____

COMMERCIAL OR INDUSTRIAL HEATING: Oil or Gas (by a main boiler) _____
 Oil or Gas (by separate units) _____
 Electric Under 20 kws _____ Over 20 kws _____

APPLIANCES: (number of) Ranges _____ Water Heaters _____
 Cook Tops _____ Disposals _____
 Wall Ovens _____ Dishwashers _____
 Dryers _____ Compactors _____
 Fans _____ Others (Janets) _____
 TOTAL _____

MISCELLANEOUS: (number of) Branch Panels _____
 Transformers _____
 Air Conditioners Central Unit _____
 Separate Units (windows) _____
 Signs 20 sq. ft. and under _____
 Over 20 sq. ft. _____
 Swimming Pools Above Ground _____
 In Ground _____
 Fire/Burglar Alarms Residential _____
 Commercial _____
 Heavy Duty Outlets, 220 Volt (such as welders) 30 amps and under _____
 over 30 amps _____
 Circus, Fairs, etc. _____
 Alterations to wires _____
 Repairs after fire _____
 Emergency Lights, battery _____
 Emergency Generators _____

FOR ADDITIONAL WORK NOT ON ORIGINAL PERMIT DOUBLE FEE DUE:
 FOR REMOVAL OF A "STOP ORDER" (304-18.b)

INSTALLATION FEE DUE: _____

TOTAL AMOUNT DUE: waived

INSPECTION: Will be ready on today, 19___; or Will Call _____ per S. Hoffses

CONTRACTOR'S NAME: Freemina Cleaves, Dir. Comm. (Fire Dept.)

ADDRESS: _____

TEL: _____

MASTER LICENSE NO.: 402957 SIGNATURE OF CONTRACTOR: _____

LIMITED LICENSE NO.: _____

INSPECTOR'S COPY — WHITE
 OFFICE COPY — CANARY
 CONTRACTOR'S COPY — GREEN

