

LOT 2 PYA ROAD  
63-69





FILL IN AND SIGN WITH INK

APPLICATION FOR PERMIT FOR  
HEATING, COOKING OR POWER EQUIPMENTPortland, Maine, 9/28/53

PERMIT ISSUED

01679  
SEP 28 1953

CITY OF PORTLAND

N-ESS

To the INSPECTOR OF BUILDINGS, PORTLAND, MAINE

The undersigned hereby applies for a permit to install the following heating, cooking or power equipment in accordance with the Laws of Maine, the Building Code of the City of Portland, and the following specifications:

Location 607 2 Bx Rd Use of Building Dwelling No. Stories 1 New Building Existing  
Name and address of owner of appliance Minat Corp  
Installer's name Pallotta Oil Co Telephone 4-2671General Description of Work  
To install New Forced Hot Water Boiler & Burner

## IF HEATER, OR POWER BOILER

Location of appliance Basement Any burnable material in floor surface or beneath? No  
If so, how protected? \_\_\_\_\_ Kind of fuel? oil  
Minimum distance to burnable material, from top of appliance or casing top of furnace 25"  
From top of smoke pipe 25" From front of appliance 10ft From sides or back of appliance 20'  
Size of chimney flue 8X10 Other connections to same flue No  
If gas fired, how vented? \_\_\_\_\_ Rated maximum demand per hour \_\_\_\_\_  
Will sufficient fresh air be supplied to the appliance to insure proper and safe combustion? Yes

## IF OIL BURNER

Name and type of burner Fluid heat Labelled by underwriter's laboratories? Yes  
Will operator be always in attendance? No Does oil supply line feed from top or bottom of tank? Bottom  
Type of floor beneath burner concrete  
Location of oil storage Basement Number and capacity of tanks 1-275  
If two 275-gallon tanks, will three-way valve be provided? \_\_\_\_\_  
Will all tanks be more than five feet from any flame? Yes How many tanks fire protected? \_\_\_\_\_  
Total capacity of any existing storage tanks for furnace burners \_\_\_\_\_

## IF COOKING APPLIANCE

Location of appliance \_\_\_\_\_ Any burnable material in floor surface or beneath? \_\_\_\_\_  
If so, how protected? \_\_\_\_\_ Kind of fuel? \_\_\_\_\_  
Minimum distance to wood or combustible material from top of appliance \_\_\_\_\_  
From front of appliance \_\_\_\_\_ From sides and back \_\_\_\_\_ From top of smokepipe \_\_\_\_\_  
Size of chimney flue \_\_\_\_\_ Other connections to same flue \_\_\_\_\_  
Is hood to be provided? \_\_\_\_\_ If so, how vented? \_\_\_\_\_ Forced or gravity? \_\_\_\_\_  
If gas fired, how vented? \_\_\_\_\_ Rated maximum demand per hour \_\_\_\_\_

## MISCELLANEOUS EQUIPMENT OR SPECIAL INFORMATION

1 1/4" VentAmount of fee enclosed? 2.00 (\$2.00 for one heater, etc., 50 cents additional for each additional heater, etc., in same building at same time.)

## APPROVED:

A. E. S. S. 9/28/53Will there be in charge of the above work a person competent to see that the State and City requirements pertaining thereto are observed? Yes

INSPECTION COPY

Signature of Installer

Pallotta Oil Co  
S. J. Pallotta

## NOTES.

Permit No.	53/1679
Location	Lot 2 Oge Road
Owner	Frederick Corp.
Date of permit	9/28/53
Approved	12/3/53 P. J. 88



# APPLICATION FOR AMENDMENT TO PERMIT

Amendment No. 2

Portland, Maine, Sept. 2, 1953

PERMIT ISSUED

SEP 2 1953

CITY of PORTLAND

To the INSPECTOR OF BUILDINGS, PORTLAND, MAINE

The undersigned hereby applies for amendment to Permit No. 53/1169 pertaining to the building or structure comprised in the original application in accordance with the Laws of the State of Maine, the Building Code and Zoning Ordinance of the City of Portland, plans and specifications, if any, submitted herewith, and the following specifications:

Location Lot 2 Fyn Road Within Fire Limits? no Dist. No. \_\_\_\_\_  
Owner's name and address The Minat Corp., 220 Cumberland Ave. Telephone \_\_\_\_\_  
Lessee's name and address \_\_\_\_\_ Telephone \_\_\_\_\_  
Contractor's name and address owners Telephone \_\_\_\_\_  
Architect \_\_\_\_\_ Plans filed no No. of sheets \_\_\_\_\_  
Proposed use of building dwelling and garage No. families 1  
Last use \_\_\_\_\_ No. families \_\_\_\_\_  
Increased cost of work \_\_\_\_\_ Additional fee 50

## Description of Proposed Work

To change 6x10 fir girder to a 10" I-beam and eliminate Lally column, 16' span.

## Details of New Work

Is any plumbing involved in this work? \_\_\_\_\_ Is any electrical work involved in this work? \_\_\_\_\_  
Height average grade to top of plate \_\_\_\_\_ Height average grade to highest point of roof \_\_\_\_\_  
Size, front \_\_\_\_\_ depth \_\_\_\_\_ No. stories \_\_\_\_\_ solid or filled land? \_\_\_\_\_ earth or rock? \_\_\_\_\_  
Material of foundation \_\_\_\_\_ Thickness, top \_\_\_\_\_ bottom \_\_\_\_\_ cellar \_\_\_\_\_  
Material of underpinning \_\_\_\_\_ Height \_\_\_\_\_ Thickness \_\_\_\_\_  
Kind of roof \_\_\_\_\_ Rise per foot \_\_\_\_\_ Roof covering \_\_\_\_\_  
No. of chimneys \_\_\_\_\_ Material of chimneys \_\_\_\_\_ of lining \_\_\_\_\_  
Framing lumber—Kind \_\_\_\_\_ Dressed or full size? \_\_\_\_\_  
Corner posts \_\_\_\_\_ Sills \_\_\_\_\_ Girt or ledger board? \_\_\_\_\_ Size \_\_\_\_\_  
Girders \_\_\_\_\_ Size \_\_\_\_\_ Columns under girders \_\_\_\_\_ Size \_\_\_\_\_ Max. on centers \_\_\_\_\_  
Studs (outside walls and carrying partitions) 2x4-16" O. C. Bridging in every floor and flat roof span over 8 feet.  
Joists and rafters: 1st floor \_\_\_\_\_, 2nd \_\_\_\_\_, 3rd \_\_\_\_\_, roof \_\_\_\_\_  
On centers: 1st floor \_\_\_\_\_, 2nd \_\_\_\_\_, 3rd \_\_\_\_\_, roof \_\_\_\_\_  
Maximum span: 1st floor \_\_\_\_\_, 2nd \_\_\_\_\_, 3rd \_\_\_\_\_, roof \_\_\_\_\_

Approved:

The Minat Corp.

Signature of Owner by:

Approved:

9/2/53 *W. A. W. W.*

Inspector of Buildings

APPLICANT'S COPY



# APPLICATION FOR AMENDMENT TO PERMIT

Amendment No. 11

Portland, Maine, July 24, 1953

PERMIT ISSUED

JUL 27 1953

CITY of PORTLAND

To the INSPECTOR OF BUILDINGS, PORTLAND, MAINE

The undersigned hereby applies for amendment to Permit No. 53/1169 pertaining to the building or structure comprised in the original application in accordance with the Laws of the State of Maine, the Building Code and Zoning Ordinance of the City of Portland, plans and specifications, if any, submitted herewith, and the following specifications:

Location Lot 2 Pva Road Within Fire Limits? no Dist. No. \_\_\_\_\_  
Owner's name and address The Minat Corp., 220 Cumberland Ave. Telephone \_\_\_\_\_  
Lessee's name and address \_\_\_\_\_ Telephone \_\_\_\_\_  
Contractor's name and address omers Telephone \_\_\_\_\_  
Architect \_\_\_\_\_ Plans filed yes No. of sheets 1  
Proposed use of building Dwelling and garage No. families 1  
Last use Dwelling No. families 1  
Increased cost of work 1500 Additional fee 2.00

## Description of Proposed Work

To construct 2-car frame garage attached to dwelling 24'x26'

The inside of the garage will be covered, where required by law, with metal lath and plaster. Class C fire door in opening between dwelling and garage. Concrete floor in garage

## Details of New Work

Is any plumbing involved in this work? \_\_\_\_\_ Is any electrical work involved in this work? \_\_\_\_\_  
Height average grade to top of plate 8' 1/2" Height average grade to highest point of roof 14'  
Size, front \_\_\_\_\_ depth \_\_\_\_\_ No. stories 1 solid or filled land? solid earth or rock? earth  
Material of foundation concrete at least 4' below grade Thickness, top 8" bottom 10" cellar no  
Material of underpinning \_\_\_\_\_ Height \_\_\_\_\_ Thickness \_\_\_\_\_  
Kind of roof pitch-gable Rise per foot 5" - 6" Roof covering asphalt roofing Class C Und. Lab.  
No. of chimneys \_\_\_\_\_ Material of chimneys \_\_\_\_\_ of lining \_\_\_\_\_  
Framing lumber—Kind hemlock Dressed or full size? dressed  
Corner posts 1x6 Sills 4x6 Girt or ledger board? \_\_\_\_\_ Size \_\_\_\_\_  
Girders \_\_\_\_\_ Size \_\_\_\_\_ Columns under girders \_\_\_\_\_ Size \_\_\_\_\_ Max. on centers \_\_\_\_\_  
Studs (outside walls and carrying partitions) 2x4-16" O. C. Bridging in every floor and flat roof span over 8 feet.  
Joists and rafters: 1st floor concrete, 2nd \_\_\_\_\_, 3rd \_\_\_\_\_, roof 2x8  
On centers: 1st floor \_\_\_\_\_, 2nd \_\_\_\_\_, 3rd \_\_\_\_\_, roof 16"  
Maximum span: 1st floor \_\_\_\_\_, 2nd \_\_\_\_\_, 3rd \_\_\_\_\_, roof \_\_\_\_\_

Approved:

OK-7/27/53-ags

The Minat Corp.

Signature of Owner By [Signature]

Approved: 7/27/53 [Signature]  
Inspector of Buildings

INSPECTION COPY



(RAA) RESIDENCE ZONE - AA

## APPLICATION FOR PERMIT

Class of Building or Type of Structure Third Class  
Portland, Maine, July 20, 1953PERMIT ISSUED  
01169  
JUL 22 1953  
CITY of PORTLAND

To the INSPECTOR OF BUILDINGS, PORTLAND, MAINE

The undersigned hereby applies for a permit to erect after repair demolition, install the following building structure equipment in accordance with the Laws of the State of Maine, the Building Code and Zoning Ordinance of the City of Portland, plans and specifications, if any, submitted herewith and the following specifications:

Location 2 Pys Road Within Fire Limits?            Dist. No.             
Owner's name and address The Minat Corporation, 220 Cumberland Ave. Telephone             
Lessee's name and address            Telephone             
Contractor's name and address Owners Telephone             
Architect            Specifications            Plans yes No. of sheets 4  
Proposed use of building 1-family dwelling No. families             
Last use            No. families             
Material wood No. stories 1 Heat Hot water Style of roof pitch Roofing asphalt  
Other buildings on same lot            Fee \$ 11.00  
Estimated cost \$ 11,000

## General Description of New Work

To construct wooden frame dwelling 42' x 36' as per plan

It is understood that this permit does not include installation of heating apparatus which is to be taken out separately by and in the name of the heating contractor. **PERMIT TO BE ISSUED TO** Owners

## Details of New Work

Is any plumbing involved in this work? yes Is any electrical work involved in this work? yes  
Is connection to be made to public sewer? yes If not, what is proposed for sewage?             
Height average grade to top of plate 10' Height average grade to highest point of roof 16'  
Size, front 42' depth 36' at least 4' below grade solid earth or rock? earth  
Material of foundation concrete Thickness, top 10 bottom 12 cellar yes  
Material of underpinning            Height            Thickness             
Kind of roof pitch Rise per foot 6" Roof covering asphalt  
No. of chimneys 1 Material of chimneys brick of lining tile Kind of heat hw fuel oil  
Framing lumber—Kind hemlock Dressed or full size?             
Corner posts 4x6 Sills box Girt or ledger board?            Size             
Girders yes Size 6x10 Columns under girders lally Size 3x3 3 1/2" Max. on centers 8' 1"  
Studs (outside walls and carrying partitions) 2x4-16" O. C. Bridging in every floor and flat roof span over 8 feet.  
Joists and rafters: 1st floor 2x8, 2nd 2x8, 3rd           , roof 2x8  
On centers: 1st floor 16", 2nd 24", 3rd           , roof 24"  
Maximum span: 1st floor 12', 2nd 12', 3rd           , roof 12'  
If one story building with masonry walls, thickness of walls?            height?           

## If a Garage

No. cars now accommodated on same lot           , to be accommodated            number commercial cars to be accommodated             
Will automobile repairing be done other than minor repairs to cars habitually stored in the proposed building?           

## Miscellaneous

Will work require disturbing of any tree on a public street? no  
Will there be in charge of the above work a person competent to see that the State and City requirements pertaining thereto are observed? yes

APPROVED:

OK-7/22/53-AGJ

The Minat Corporation

Signature of owner By:           

INSPECTION COPY

— ۱۲۸ —

Cons. of Int. 288.

4/5/58 7017  
 Permit No. 53/17639  
 Location 220 1st Street  
 Owner The Mercant Corp  
 Date of permit 7/22/53  
 Noft. closing in 9/3/53 10:30 PM  
 Inspn. closing in 9/3/53 3:45 PM  
 Final. Pass inspection 9/4/53  
 Final Noft. 12/31/53  
 Final Inspn. 12/31/53  
 Cert. of Occupancy issued 1/4/54

SECRET

(COPY)



CITY OF PORTLAND, MAINE  
Department of Building Inspection

## Certificate of Occupancy

LOCATION Lot 2 Fya Road

Issued to The Minat. Corp.

Date of Issue Jan. 5, 1954

This is to certify that the building, premises, or part thereof, at the above location, built ~~under~~  
~~under~~ under Building Permit No. 53/1169, has had final inspection, has been found to  
conform substantially to requirements of Zoning Ordinance and Building Code of the City, and is hereby  
approved for occupancy or use, limited or otherwise, as indicated below.

PORTION OF BUILDING OR PREMISES

APPROVED OCCUPANCY

Entire

One-family Dwelling House and  
attached garage

Limiting Conditions:

This certificate supersedes  
certificate issued

Appr. by:

1/5/54 Earle Smith  
(Date) Inspector

Wm. J. White  
Inspector of Buildings

Notice: This certificate identifies lawful use of building or premises, and ought to be transferred from  
owner to owner when property changes hands. Copy will be furnished to owner or lessee for one dollar.



STATEMENT ACCOMPANYING APPLICATION FOR BUILDING PERMIT

for Dwelling  
at Lot 2 Pva Road Date July 20, 1953

1. In whose name is the title of the property now recorded? The Minat Corporation
2. Are the boundaries of the property in the vicinity of the proposed work shown clearly on the ground, and how? stakes
3. Is the outline of the proposed work now staked out upon the ground?         
If not, will you notify the Inspection Office when the work is staked out and before any of the work is commenced?
4. What is to be maximum projection or overhang of eaves or drip? 8"
5. Do you assume full responsibility for the correctness of the location plan or statement of location filed with this application, and does it show the complete outline of the proposed work on the ground, including bay windows, porches and other projections? yes
6. Do you assume full responsibility for the correctness of all statements in the application concerning the sizes, design and use of the proposed building? yes
7. Do you understand that in case changes are proposed in the location of the work or in any of the details specified in the application that a revised plan and application must be submitted to this office before the changes are made? yes

James J. Board

Mixed Corp.  
July 20, 1953

F/H Plan

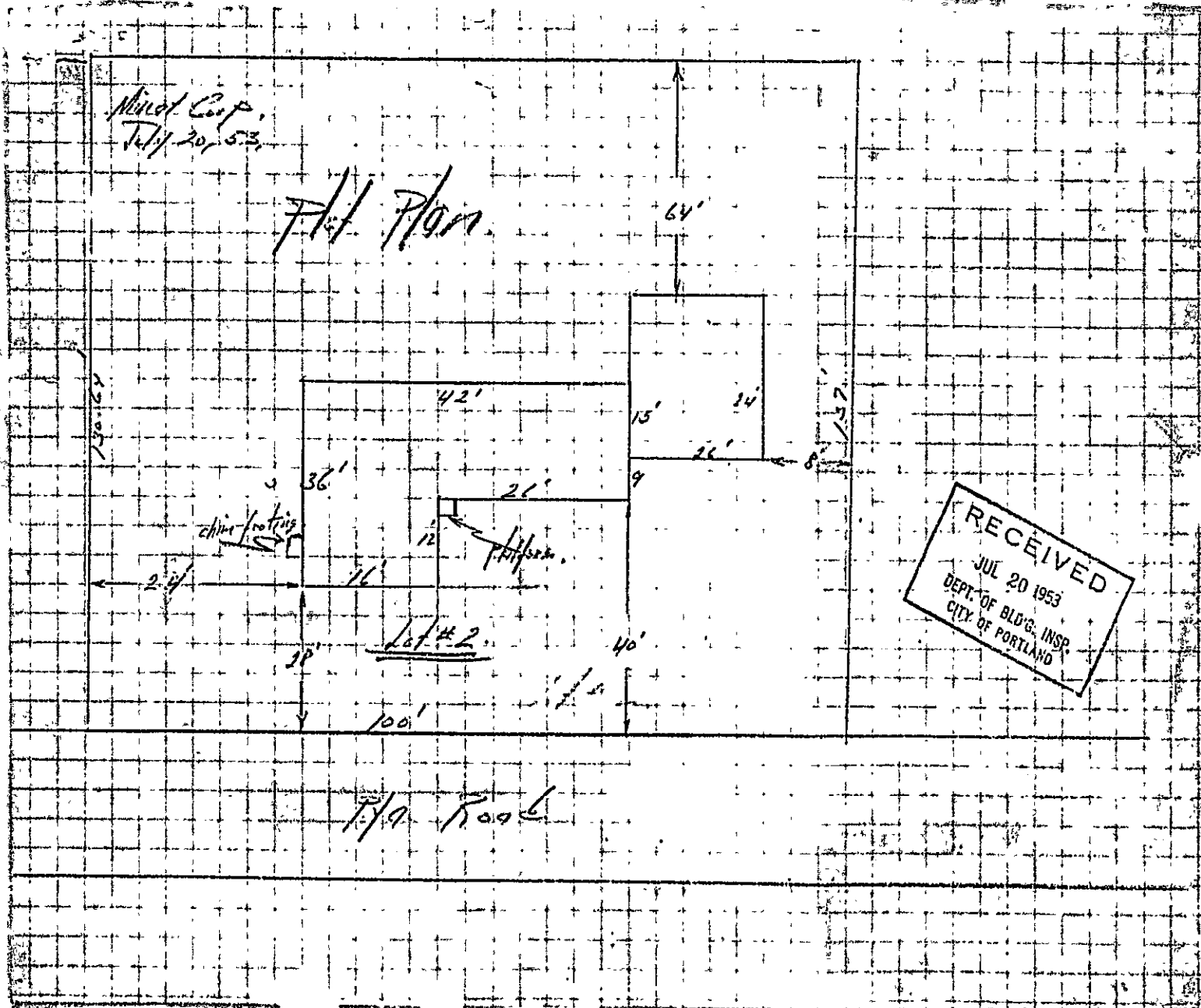



# APPLICATION FOR AMENDMENT TO PERMIT

Amendment No. 1  
Portland, Maine, July 20, 1953

PERMIT ISSUED

JUL 29 1953

CITY of PORTLAND

To the INSPECTOR OF BUILDINGS, PORTLAND, MAINE

The undersigned hereby applies for amendment to Permit No. 53/1136 pertaining to the building or structure comprised in the original application in accordance with the Laws of the State of Maine, the Building Code and Zoning Ordinance of the City of Portland, plans and specifications, if any, submitted herewith, and the following specifications:

Location Lot 2 Fya Road Within Fire Limits? \_\_\_\_\_ Dist. No. \_\_\_\_\_  
Owner's name and address The Minat Corporation, 220 Cumberland Ave. Telephone \_\_\_\_\_  
Lessee's name and address \_\_\_\_\_ Telephone \_\_\_\_\_  
Contractor's name and address Owners Telephone \_\_\_\_\_  
Architect \_\_\_\_\_ Telephone \_\_\_\_\_  
Proposed use of building dwelling house and garage Plans filed \_\_\_\_\_ No. of sheets \_\_\_\_\_  
Last use \_\_\_\_\_ No. families \_\_\_\_\_  
Increased cost of work \_\_\_\_\_ No. families \_\_\_\_\_  
Additional fee .50

## Description of Proposed Work

To change location of building on lot

## Details of New Work

Is any plumbing involved in this work? \_\_\_\_\_ Is any electrical work involved in this work? \_\_\_\_\_  
Height average grade to top of plate \_\_\_\_\_ Height average grade to highest point of roof \_\_\_\_\_  
Size, front \_\_\_\_\_ depth \_\_\_\_\_ No. stories \_\_\_\_\_ solid or filled land? \_\_\_\_\_ earth or rock? \_\_\_\_\_  
Material of foundation \_\_\_\_\_ Thickness, top \_\_\_\_\_ bottom \_\_\_\_\_ cellar \_\_\_\_\_  
Material of underpinning \_\_\_\_\_ Height \_\_\_\_\_ Thickness \_\_\_\_\_  
Kind of roof \_\_\_\_\_ Rise per foot \_\_\_\_\_ Roof covering \_\_\_\_\_  
No. of chimneys \_\_\_\_\_ Material of chimneys \_\_\_\_\_ of lining \_\_\_\_\_  
Framing lumber—Kind \_\_\_\_\_ Dressed or full size? \_\_\_\_\_  
Corner posts \_\_\_\_\_ Sills \_\_\_\_\_ Girt or ledger board? \_\_\_\_\_  
Girders \_\_\_\_\_ Size \_\_\_\_\_ Columns under girders \_\_\_\_\_ Size \_\_\_\_\_ Max. on centers \_\_\_\_\_  
Studs (outside walls and carrying partitions) 2x4-16" O. C. Bridging in every floor and flat roof span over 8 feet.  
Joists and rafters: 1st floor \_\_\_\_\_, 2nd \_\_\_\_\_, 3rd \_\_\_\_\_, roof \_\_\_\_\_  
On centers: 1st floor \_\_\_\_\_, 2nd \_\_\_\_\_, 3rd \_\_\_\_\_, roof \_\_\_\_\_  
Maximum span: 1st floor \_\_\_\_\_, 2nd \_\_\_\_\_, 3rd \_\_\_\_\_, roof \_\_\_\_\_

Approved:

OK- 7/21/53-AGS

The Minat Corporation

Signature of Owner

By:

Approved:

7/21/53

Inspector of Buildings

INSPECTION COPY



# APPLICATION FOR PERMIT

Class of Building or Type of Structure Excavation

Portland, Maine, July 17, 1953

RECEIVED

JUL 17 1953

CITY OF PORTLAND

To the INSPECTOR OF BUILDINGS, PORTLAND, MAINE

The undersigned hereby applies for a permit to erect ~~alter~~ excavate and construct the following building ~~structure~~ in accordance with the Laws of the State of Maine, the Building Code and Zoning Ordinance of the City of Portland, plans and specifications, if any, submitted herewith and the following specifications:

Location Lot 2 Pys Road Within Fire Limits? no Dist. No.       
Owner's name and address The Minat Corp., 220 Cumberland Ave. Telephone 4-8013  
Lessee's name and address      Telephone       
Contractor's name and address owners Telephone       
Architect      Specifications      Plans yes No. of sheets 1  
Proposed use of building dwelling house and garage No. families 1-3  
Last use      No. families       
Material      No. stories      Heat      Style of roof      Roofing       
Other buildings on same lot       
Estimated cost \$      Fee \$ 1.00

## General Description of New Work

forms for

To ~~excavate~~ excavate and construct/foundation only for proposed 1-story frame dwelling house 40' x 36' plus 16' x 16' and 2-car garage 22' x 24'.

## Permit Issued with Memo

Location plan filed with this application for advance permit shows all projections from the main walls of the building such as open or enclosed porches, outside chimneys, cellarway bulkheads, projecting upper story, etc. Finished plans of the building are underway and will be filed with application for general construction about July 24, 1953.

*Warning + Important notice sent*  
It is understood that this permit does not include installation of heating apparatus which is to be taken out separately by and in the name of the heating contractor. PERMIT TO BE ISSUED TO The Minat Corp.

## Details of New Work

Is any plumbing involved in this work?      Is any electrical work involved in this work?       
Is connection to be made to public sewer? yes If not, what is proposed for sewage?       
Height average grade to top of plate      Height average grade to highest point of roof       
Size, front 40' depth 36' at least 4' below grade No. stories 1 solid or filled land? solid earth or rock? earth  
Material of foundation concrete Thickness, top 10" bottom 12" cellar yes  
Material of underpinning " to sill garage Height 8" bottom 10" Thickness no  
Kind of roof      Rise per foot      Roof covering       
No. of chimneys      Material of chimneys      of lining      Kind of heat      fuel       
Framing lumber—Kind      Dressed or full size?       
Corner posts      Sills box Girt or ledger board?      Size       
Girders      Size      Columns under girders      Size      Max. on centers       
Studs (outside walls and carrying partitions) 2x4-16" O. C. Bridging in every floor and flat roof span over 8 feet.  
Joists and rafters: 1st floor     , 2nd     , 3rd     , roof       
On centers: 1st floor     , 2nd     , 3rd     , roof       
Maximum span: 1st floor     , 2nd     , 3rd     , roof       
If one story building with masonry walls, thickness of walls?      height?     

## If a Garage

No. cars now accommodated on same lot     , to be accommodated      number commercial cars to be accommodated       
Will automobile repairing be done other than minor repairs to cars habitually stored in the proposed building?     

APPROVED:

*with memo enj. AGS*

## Miscellaneous

Will work require disturbing of any tree on a public street? no  
Will there be in charge of the above work a person competent to see that the State and City requirements pertaining thereto are observed? yes

The Minat Corp.

Signature of owner by: *[Signature]*

INSPECTION COPY

Permit No.	53/1136
Location	Plot 2, Gya Road
Owner	Mr. Michael Ayip
Date of permit	7/17/53
Notif. closing-in	
Inspn. closing-in	
Final Notif.	
Final Inspn.	7/22/53
Cert. of Occupancy issued	none

7/17/53 - Location 015. E. S. S.  
7/21/53 - New location 015. E. S. S.  
7/22/53 - From electrical. E. S. S.  
7/23/53 - General construction permit issued. E. S. S.

Hand-drawn site plan on grid paper showing a property layout. The main area is a rectangle with dimensions 40' by 40'. To the right is a smaller rectangle labeled 'GARAGE' with dimensions 20' by 12'. A handwritten note 'Supermarket' is written across the main area. Dimensions around the perimeter include 16', 28', 20', 92', 20', 99', 28', 16', 20', 40', 130.00', 132.22', and 92'. A handwritten note 'Lot # 2' is written below the main area.

— 100 —

Memorandum from Department of Building Inspection, Portland, Maine

Lot 2 Pya Road--To excavate and construct forms for foundation only for proposed dwelling and garage for and by the Minat Corporation--  
July 17, 1953

Advance permit in connection with construction of a single family dwelling house and attached garage on Lot 2 Pya Road is issued herewith. It should be noted that the work covered by this permit is limited to excavation and construction of forms for foundation only. No concrete is to be poured until after the general construction permit has been issued and the usual form check has been made.

AJS/B

(Signed) Warren McDonald  
Inspector of Buildings

STATEMENT ACCOMPANYING APPLICATION FOR BUILDING PERMIT

for dwelling and garage  
at July 17, 1953 Date 7/17/53

1. In whose name is the title of the property now recorded? The Minat Corp.
2. Are the boundaries of the property in the vicinity of the proposed work shown clearly on the ground, and how? stakes
3. Is the outline of the proposed work now staked out upon the ground? yes  
If not, will you notify the Inspection Office when the work is staked out and before any of the work is commenced? \_\_\_\_\_
4. What is to be maximum projection or overhang of eaves or drip? \_\_\_\_\_
5. Do you assume full responsibility for the correctness of the location plan or statement of location filed with this application, and does it show the complete outline of the proposed work on the ground, including bay windows, porches and other projections? yes
6. Do you assume full responsibility for the correctness of all statements in the application concerning the sizes, design and use of the proposed building? yes
7. Do you understand that in case changes are proposed in the location of the work or in any of the details specified in the application that a revised plan and application must be submitted to this office before the changes are made? yes

Thomas J. Brown





APPLICATION FOR PERMIT  
DEPARTMENT OF BUILDING INSPECTIONS SERVICES  
ELECTRICAL INSTALLATIONS

Date April 18, 1989 19  
Receipt and Permit number 00229

To the CHIEF ELECTRICAL INSPECTOR, Portland, Maine:

The undersigned hereby applies for a permit to make electrical installations in accordance with the laws of  
Maine, the Portland Electrical Ordinance, the National Electrical Code and the following specifications:

LOCATION OF WORK: 65 Pyer

OWNER'S NAME: Mr. Slorsky ADDRESS: \_\_\_\_\_

OUTLETS: \_\_\_\_\_ FEES \_\_\_\_\_

Receptacles \_\_\_\_\_ Switches \_\_\_\_\_ Plugmold \_\_\_\_\_ ft. TOTAL \_\_\_\_\_

FIXTURES: (number of) \_\_\_\_\_

Incandescent \_\_\_\_\_ Fluorescent \_\_\_\_\_ (not strip) TOTAL \_\_\_\_\_

Strip Fluorescent \_\_\_\_\_ ft. \_\_\_\_\_

SERVICES: \_\_\_\_\_

Overhead XX Underground up upgrade 60 to 100 Temporary \_\_\_\_\_ TOTAL amperes 100 3.00

METERS: (number of) 1 \_\_\_\_\_ °0

MOTORS: (number of) \_\_\_\_\_

Fractional \_\_\_\_\_

1 HP or over \_\_\_\_\_

RESIDENTIAL HEATING: \_\_\_\_\_

Oil or Gas (number of units) \_\_\_\_\_

Electric (number of rooms) \_\_\_\_\_

COMMERCIAL OR INDUSTRIAL HEATING: \_\_\_\_\_

Oil or Gas (by a main boiler) \_\_\_\_\_

Oil or Gas (by separate units) \_\_\_\_\_

Electric Under 20 kws \_\_\_\_\_ Over 20 kws \_\_\_\_\_

APPLIANCES: (number of) \_\_\_\_\_

Ranges \_\_\_\_\_

Cook Tops \_\_\_\_\_

Wall Ovens \_\_\_\_\_

Dryers \_\_\_\_\_

Fans \_\_\_\_\_

Water Heaters \_\_\_\_\_

Disposals \_\_\_\_\_

Dishwashers \_\_\_\_\_

Compactors \_\_\_\_\_

Others (denote) \_\_\_\_\_

TOTAL \_\_\_\_\_

MISCELLANEOUS: (number of) \_\_\_\_\_

Branch Panels \_\_\_\_\_

Transformers \_\_\_\_\_

Air Conditioners Central Unit \_\_\_\_\_

Separate Units (windows) \_\_\_\_\_

Signs 20 sq. ft. and under \_\_\_\_\_

Over 20 sq. ft. \_\_\_\_\_

Swimming Pools Above Ground \_\_\_\_\_

In Ground \_\_\_\_\_

Fire/Burglar Alarms Residential \_\_\_\_\_

Commercial \_\_\_\_\_

Heavy Duty Outlets, 220 Volt (such as welders) 30 amps and under \_\_\_\_\_

over 30 amps \_\_\_\_\_

Circus, Fairs, etc. \_\_\_\_\_

Alterations to wires \_\_\_\_\_

Repairs after fire \_\_\_\_\_

Emergency Lights, battery \_\_\_\_\_

Emergency Generators \_\_\_\_\_

INSTALLATION FEE DUE: \_\_\_\_\_

FOR ADDITIONAL WORK NOT ON ORIGINAL PERMIT ..... DOUBLE FEE DUE: \_\_\_\_\_

FOR REMOVAL OF A "STOP ORDER" (304-16.b) \_\_\_\_\_

TOTAL AMOUNT DUE: 5.00

min

INSPECTION: \_\_\_\_\_

Will be ready on \_\_\_\_\_, 19\_\_\_\_; or Will Call XX

CONTRACTOR'S NAME: Henry Griffin

ADDRESS: 70 Burwell Ave. So. Portland

TEL.: \_\_\_\_\_

MASTER LICENSE NO.: 650

LIMITED LICENSE NO.: \_\_\_\_\_

SIGNATURE OF CONTRACTOR: \_\_\_\_\_

INSPECTOR'S COPY — WHITE

OFFICE COPY — CANARY

CONTRACTOR'S COPY — GREEN

