

STATEMENT ACCOMPANYING APPLICATION FOR BUILDING PERMIT

for garage Date 6/12/50
at R 67 Morrill Street

1. In whose name is the title of the property now recorded? The Burt Co.
2. Are the boundaries of the property in the vicinity of the proposed work shown clearly on the ground, and how? STAKES
3. Is the outline of the proposed work now staked out upon the ground? yes
If not, will you notify the Inspection Office when the work is staked out and before any of the work is commenced? _____
4. What is to be maximum projection or overhang of eaves or drip? _____
5. Do you assume full responsibility for the correctness of the location plan or statement of location filed with this application, and does it show the complete outline of the proposed work on the ground, including bay windows, porches and other projections? yes
6. Do you assume full responsibility for the correctness of all statements in the application concerning the sizes, design and use of the proposed building? yes
7. Do you understand that in case changes are proposed in the location of the work or in any of the details specified in the application that a revised plan and application must be submitted to this office before the changes are made? yes

The Burt Co
Committee Burt



APPLICATION FOR PERMIT

Class of Building or Type of Structure Non-Combustible
Portland, Maine, May 3, 1950

PERMIT ISSUED
00466
MAY 4 1950

CITY OF PORTLAND

To the INSPECTOR OF BUILDINGS, PORTLAND, MAINE

The undersigned hereby applies for a permit to erect alter-repair-demolish install the following building structure equipment in accordance with the Laws of the State of Maine, the Building Code and Zoning Ordinance of the City of Portland, plans and specifications, if any, submitted herewith and the following specifications:

Location Morrill St. Within Fire Limits? Dist. No.
Owner's name and address The Burt Company, Morrill St. Telephone
Lessee's name and address Telephone
Contractor's name and address Peerless Welding Co. Inc. 41-45 Union St. Telephone 4-0825
Architect Specifications Plans no No. of sheets
Proposed use of building No. families
Last use No. families
Material none-comb No. stories 1 Heat Style of roof
Other buildings on same lot
Estimated cost \$ 500.00 Fee \$ 2.00

General Description of New Work

To provide 3/16" thick steel plate for stack on boiler -stack temp. not to exceed 750 deg. To erect steel ladder and walkway for access to top of boiler.

Metal building-steel roof.

It is understood that this permit does not include installation of heating apparatus which is to be taken out separately by and in the name of the heating contractor. PERMIT TO BE ISSUED TO contractor

Details of New Work

Is any plumbing involved in this work? Is any electrical work involved in this work?
Is connection to be made to public sewer? If not, what is proposed for sewage?
Has septic tank notice been sent? Form notice sent?
Height average grade to top of plate Height average grade to highest point of roof
Size, front depth No stories solid or filled land? earth or rock?
Material of foundation Thickness, top bottom cellar
Kind of roof Rise per foot Roof covering
No. of chimneys Material of chimneys of lining Kind of heat fuel
Framing Lumber-Kind Dressed or full size? Corner posts Sills
Size Girder Columns under girders Size Max. on centers
Studs (outside walls and carrying partitions) 2x4-16" O. C. Bridging in every floor and flat roof span over 8 feet.
Joists and rafters: 1st floor, 2nd, 3rd, roof
On centers: 1st floor, 2nd, 3rd, roof
Maximum span: 1st floor, 2nd, 3rd, roof
If one story building with masonry walls, thickness of walls? height?

If a Garage

No. cars now accommodated on same lot, to be accommodated number commercial cars to be accommodated
Will automobile repairing be done other than minor repairs to cars habitually stored in the proposed building?

APPROVED:

O.R. 5/4/60 - CJS

Miscellaneous

Will work require disturbing of any tree on a public street? no
Will there be in charge of the above work a person competent to see that the State and City requirements pertaining thereto are observed? YES
The Burt Co.
Peerless Welding Co. Inc.

CS 301

INSPECTION COPY

Signature of owner

by: Walter G. Blaisdell

F.M.

STATEMENT ACCOMPANYING APPLICATION FOR BUILDING PERMIT

for Storage shed

at Foot of Merrill Street

Date 5/22/17

- Brunswick. Walter Allen Co.
John D. [unclear]
1. In whose name is the title of the property now recorded? John D. [unclear]
 2. Are the boundaries of the property in the vicinity of the proposed work shown clearly on the ground, and how? Yes
 3. Is the outline of the proposed work now staked out upon the ground? Yes
If not, will you notify the Inspection Office when the work is staked out and before any of the work is commenced? _____
 4. What is to be maximum projection or overhang of eaves or drip? _____
 5. Do you assume full responsibility for the correctness of the location plan or statement of location filed with this application, and does it show the complete outline of the proposed work on the ground, including bay windows, porches and other projections? Yes
 6. Do you assume full responsibility for the correctness of all statements in the application concerning the sizes, design and use of the proposed building? Yes
 7. Do you understand that in case changes are proposed in the location of the work or in any of the details specified in the application that a revised plan and application must be submitted to this office before the changes are made? Yes

W. E. Burt

Memorandum

1947

Morrill Street—Application for permit for storage building
for the Burt Company--5/23/47

To Owner:

Permit for above work is issued herewith. Attention is called to the importance of providing proper bracing at corners of building. This type of construction is not ordinarily used for wood frame buildings and the bracing is needed for stiffening of frame of building which with usual construction is strengthened by the boarding on walls.

WMcB/S

(Signed) Warren McDonald
Inspector of Buildings



(1) INDUSTRIAL ZONE
APPLICATION FOR PERMIT

PERMIT ISSUED

01109
MAY 23 1947

Class of Building or Type of Structure _____

Portland, Maine, May 22, 1947

To the INSPECTOR OF BUILDINGS, PORTLAND, ME.

The undersigned hereby applies for a permit to erect ~~construct~~ ~~construct~~ the following building ~~structure~~ ~~structure~~ in accordance with the Laws of the State of Maine, the Building Code and Zoning Ordinance of the City of Portland, plans and specifications, if any, submitted herewith and the following specifications:

Location Foot of Morrill Street Within Fire Limits? no Dist. No. _____
 Owner's name and address The Burns Company, Morrill Street Telephone _____
 Lessee's name and address _____ Telephone _____
 Contractor's name and address not let Telephone _____
 Architect Earle Fenderson Specifications _____ Plans yes No. of sheets 1
 Proposed use of building Storage No. families _____
 Last use _____ No. families _____
 Material _____ No. stories _____ Heat _____ Style of roof _____ Roofing _____
 Other buildings on same lot _____
 Estimated cost \$ 500 Fee \$ 1.00

General Description of New Work

To construct one story storage shed 24' x 29', ~~xxx~~ metal covered,

Permit Issued with Memo

It is understood that this permit does not include installation of heating apparatus which is to be taken out separately by and in the name of the heating contractor.

Details of New Work

Is any plumbing work involved in this work? no Is any electrical work involved in this work? no
 Height average grade to top of plate 9' Height average grade to highest point of roof 15'
 Size, front 28' depth 24' No. stories 1 solid or filled land? solid earth or rock? earth
 Material of foundation mud sills 8x8 Thickness, top _____ bottom _____ cellar _____
 Material of underpinning _____ Height _____ Thickness _____
 Kind of roof Pitch Rise per foot 6" Roof covering Metal
 No. of chimneys none Material of chimneys _____ of lining _____ Kind of heat _____ fuel _____
 Framing lumber—Kind hemlock Dressed or full size? dressed
 Corner posts 4x6 Sills 6x6 Girt or ledger board? _____ Size _____
 Girders _____ Size _____ Columns under girders _____ Size _____ Max. on centers _____
 Studs (outside walls and carrying partitions) 2x4-16" O. C. Bridging in every floor and flat roof span over 8 feet.
 Joists and rafters: 1st floor dirt, 2nd _____, 3rd _____, roof 2x6
 On centers: 1st floor _____, 2nd _____, 3rd _____, roof 24"
 Maximum span: 1st floor _____, 2nd _____, 3rd _____, roof _____
 If one story building with masonry walls, thickness of walls? _____ height? _____

If a Garage

No cars now accommodated on same lot _____, to be accommodated _____ number commercial cars to be accommodated _____
 Will automobile repairing be done other than minor repairs to cars habitually stored in the proposed building? _____

APPROVED:

Miscellaneous

Will work require distasteful of any tree on a public street? _____
 Will there be in charge of the above work a person competent that the State and City requirements pertaining thereto observed? yes

INSPECTION COPY

The Burns Company
 Signature of owner by: [Signature]

STATEMENT ACCOMPANYING APPLICATION FOR BUILDING PERMIT

for Burt Co.
at Merrill St. Date Nov. 29

1. In whose name is the title of the property now recorded? Burt Co.
2. Are the boundaries of the property in the vicinity of the proposed work shown clearly on the ground, and how? Yes -
3. Is the outline of the proposed work now staked out upon the ground? Yes
If not, will you notify the Inspection Office when the work is staked out and before any of the work is commenced? Yes
4. What is to be maximum projection or overhang of eaves or drip? 6"
5. Do you assume full responsibility for the correctness of the location plan or statement of location filed with this application, and does it show the complete outline of the proposed work on the ground, including bay windows, porches and other projections? Yes
6. Do you assume full responsibility for the correctness of all statements in the application concerning the sizes, design and use of the proposed building? Yes
7. Do you understand that in case changes are proposed in the location of the work or in any of the details specified in the application that a revised plan and application must be submitted to this office before the changes are made? Yes

Sam Acator Co.

Reedman

Temporary Certificate only
Final to be issued later

CITY OF PORTLAND, MAINE
DEPARTMENT OF BUILDING INSPECTION
CERTIFICATE OF OCCUPANCY

This is to certify that the building at Morrill
Street (150-A-2) built under Building Permit No.
16/215 has been finally inspected and may now be oc-
cupied for the purpose of office.

Date 2/17/1935

Inspector of Buildings

Issued to The Burt Company

See reverse side for conditions



(1) INDUSTRIAL ZONE
APPLICATION FOR PERMIT

Class of Building or Type of Structure Second class

Portland, Maine, November 30, 1946

To the INSPECTOR OF BUILDINGS, PORTLAND, ME.

The undersigned hereby applies for a permit to erect ~~structure~~ the following building structure equipment in accordance with the laws of the State of Maine, the Building Code of the City of Portland, plans and specifications, if any, submitted herewith and the following specifications:

Location Morrill Street (150-8-2) Ward _____ Within Fire Limits? no Dist. No. _____
Owner's or Lessee's name and address The Burt Co., Morrill Street Telephone _____
Contractor's name and address Samuel Aceto & Co., 40 Preble Street Telephone 3-5961
Architect E. A. Henderson Plans filed yes No. of sheets 13
Proposed use of building Office No. families _____
Other buildings on same lot factory
Estimated cost \$ 2500. Fee \$ 2.50

Description of Present Building to be Altered

Material _____ No. stories _____ Heat _____ Style of roof _____ Roofing _____
Last use _____ No. families _____

General Description of New Work

To construct 1 story concrete block building 30'x16' as per p. 2.
5/9/56 - Plans transferred to application for 16'x24' addition.

It is understood that this permit does not include installation of heating apparatus which is to be taken out separately by and in the heating contractor. Framing Lumber

Details of New Work

Kind? _____ Dressed or Full Size? _____ Height average grade to top of plate 7'6"
Size, front _____ depth _____ No. stories 1 Height average grade to highest point of roof 12'6"
To be erected on solid or filled land? solid earth or rock? rock
Material of foundation concrete at least 4' below grade Thickness, top 10" bottom 12"
Material of underpinning _____ Height _____ Thickness _____
Kind of Roof hip Rise per foot 7 1/2" Roof covering asphalt roofing Class C Ind. Lab.
No. of chimneys none Material of chimneys _____ of lining _____
Kind of heat from main plant Type of fuel _____ Is gas fitting involved? _____
Corner posts _____ Sills _____ Girt or ledger board? _____ Size _____
Material columns under girders _____ Size _____ Max. on centers _____
Studs (outside walls and carrying partitions) 2x4-16" O. C. Girders 6x8 or larger. Bridging in every floor and flat roof span over 8 feet. Sills and corner posts all one piece in cross section.
Joists and rafters: 1st floor concrete, 2nd _____, 3rd _____, roof 2x6
On centers: 1st floor _____, 2nd _____, 3rd _____, roof 2x6
Maximum span: 1st floor _____, 2nd _____, 3rd _____, roof 16'
If one story building with masonry walls, thickness of walls? 8" height 8'

If a Garage

No. cars now accommodated on same lot _____, to be accommodated _____
Total number commercial cars to be accommodated _____
Will automobile repairing be done other than minor repairs to cars habitually stored in the proposed building? _____

Miscellaneous

Will above work require removal or disturbing of any shade tree on a public street? no
Will there be in charge of the above work a person competent to see that the State and City requirements pertaining thereto are observed? yes

Signature of owner The Burt Co. Samuel Aceto & Co.
By: *[Signature]*

Original

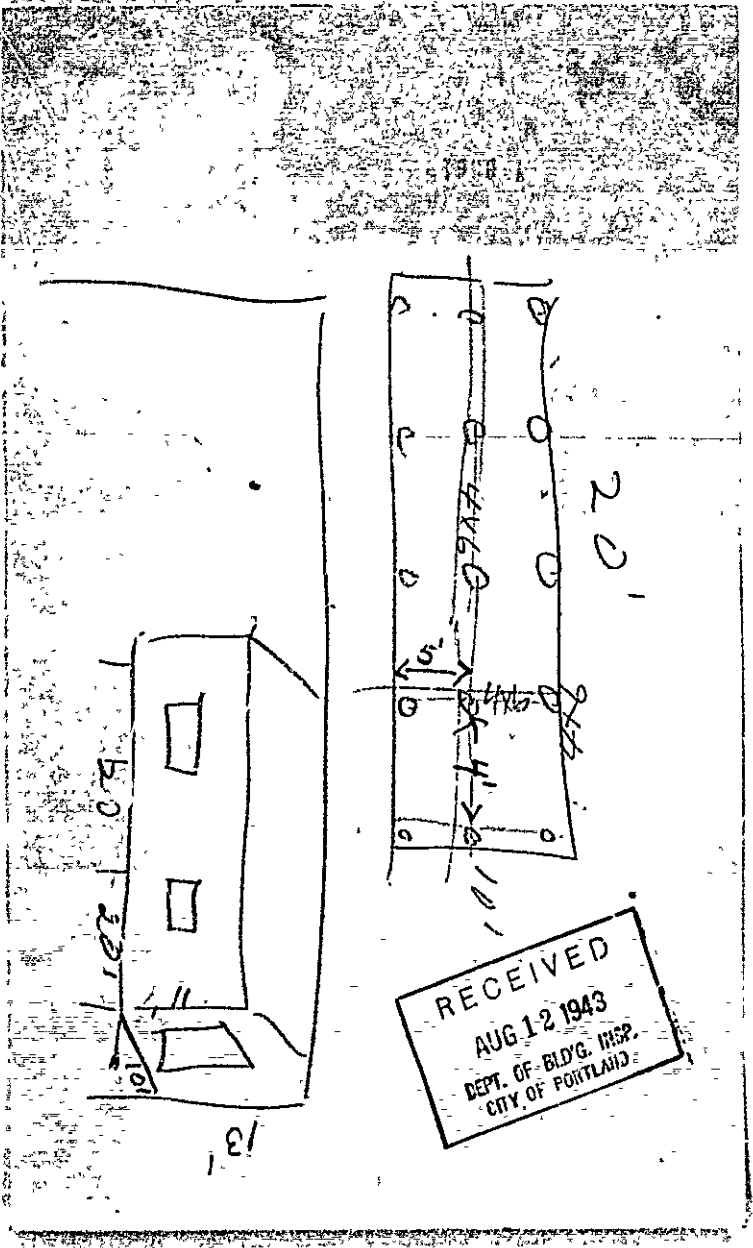

RECEIVED
AUG 12 1943
DEPT. OF BLDG. INSP.
CITY OF PORTLAND

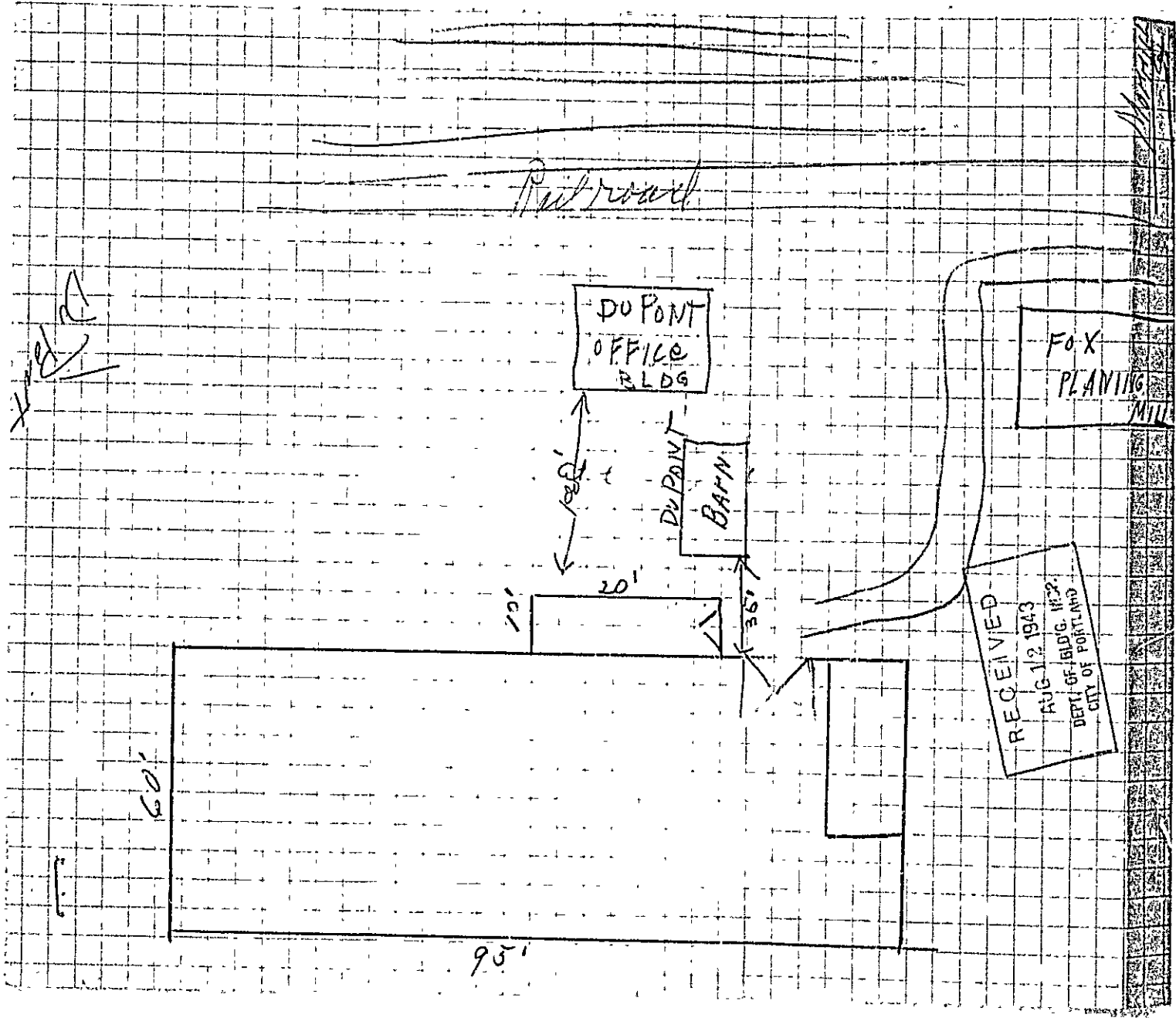



(1) INDUSTRIAL ZONE
APPLICATION FOR PERMIT
 Class of Building or Type of Structure Mill Const

PERMIT ISSUED
 Permit No. 0502

Portland, Maine, August 12, 1919 **AUG 19 1919**

To the INSPECTOR OF BUILDINGS, PORTLAND, ME.

The undersigned hereby applies for a permit to erect alter install the following building structure equipment, in accordance with the Laws of the State of Maine, the Building Code of the City of Portland, plans and specifications, if any, submitted herewith and the following specifications:

Location Morrill Street (Rca-) Within Fire Limit? no Dist. No. _____
 Assessor? 150A-2 and 151 E-1
 Owner's or Lessor's name and address The Burt Co., Morrill St. Telephone 2-1682
 Contractor's name and address _____ Telephone _____
 Architect _____
 Proposed use of building Manufacturing Plans filed yes No. of sheets 2
 Other buildings on same lot _____ No. families _____
 Estimated cost \$ 100 Fee \$ 2.00

Description of Present Building to be Altered

Material con. blk No. stories 1 Heat steam Style of roof flat Roofing Asphalt
 Last use Manufacturing No. families _____

General Description of New Work

To build enclosed loading stage 10' x 20' on westerly side of building
 To change million window to door to lead into (no change in width or existing header)
 Face plate of main building to be removed and new rafters to run in on top of main wall
 and spiked beside existing rafters
 Asphalt roofing on outside walls

It is understood that this permit does not include installation of heating apparatus which is to be taken out separately by and in the name of the heating contractor.

Details of New Work

Is any plumbing work involved in this work? _____
 Is any electrical work involved in this work? _____
 Height average grade to top of plate _____
 Size, front _____ depth _____ No. stories _____ Height average grade to highest point of roof 12'
 To be erected on solid or filled land? solid earth or rock? earth
 Material of foundation cedar posts Thickness, top _____ bottom _____ cellar _____
 Material of underpinning _____ Height _____ Thickness _____
 Kind of roof flat Rise per foot 2 1/2" Roof covering Asphalt roofing Class C Und. Lab.
 No. of chimneys _____ Material of chimneys _____ of lining _____
 Kind of heat _____ Type of fuel _____ Is gas fitting involved? _____
 Framing lumber—Kind spruce Dressed or full size? full size
 Corner posts 1x6 Sills 1x6 Girt or ledger board? _____ Size _____
 Material columns under girders _____ Size _____ Max. on centers _____
 Studs (outside walls and carrying partitions) 2x4-16" O. C. Girders 6x8 or larger. Bridging in every floor and flat roof
 span over 8 feet: Sills and corner posts all one piece in cross section.
 Joists and rafters: _____
 1st floor 1x6 _____ 2nd _____ 3rd _____ roof 2x8
 On centers: _____
 1st floor 4' _____ 2nd _____ 3rd _____ roof 16"
 Maximum span: _____
 1st floor 5' _____ 2nd 4x6 thru center 5' span _____ 3rd _____ roof 10'

If a Garage

No. cars now accommodated on same lot _____, to be accommodated _____
 Total number commercial cars to be accommodated _____
 Will automobile repairing be done other than minor repairs to cars habitually stored in the proposed building? _____

Miscellaneous

Will above work require removal or disturbing of any shade tree on a public street? no
 Will there be in charge of the above work a person competent to see that the State and City requirements pertaining thereto are observed? yes
 Signature of owner _____
 The Burt Co.

INSPECTION COPY

Edw. L. Burt

Permit No 43/802

Location Marshall St.

Owner The Burt Co

Date of permit 8/19/43

Notif. closing-in

Inspn closing-in

Final Notif.

Final Inspn. 12/6/43

Cert. of Occupancy issued None

NOTES

$4 \times 6 \text{ Sills} = 3520 \text{ ft}^2$

$W = \frac{2 \times 110 \text{ ft}^2}{5 \times 5} \times 4 \times 6 \text{ Sills} = 140 \text{ ft}^2$

$3520 - 140 \text{ ft}^2 = \text{Final}$

12/6/43 Work done.

16 X Sills + girder used.

OGS

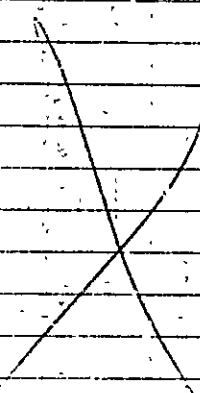



FILL IN COMPLETELY AND SIGN WITH INK

PERMIT ISSUED

Permit No.

0120

APPLICATION FOR PERMIT FOR HEATING, COOKING OR POWER-EQUIPMENT

February 8, 1932

To the INSPECTOR OF BUILDINGS, PORTLAND, ME.

Portland, Maine,

The undersigned hereby applies for a permit to install the following heating, cooking or power equipment in accordance with the Laws of Maine, the Building Code of the City of Portland, and the following specifications:

Location: Foot of Morrill Street Use of Building: Factory
Name and address of owner: Portland Billiard Ball Corp. Ward 9
Contractor's name and address: Portland Co. 58 Fore St. Telephone:

General Description of Work

30 H. P. horizontal boiler for heating and power, and including the erection of a steel stack or concrete foundation. the stack to consist of 3/16" plates welded together, total height 40' and to be about 30" from masonry building.

IF HEATER, POWER BOILER OR COOKING DEVICE

Is heater or source of heat to be in cellar? If not, which story Kind of Fuel Concrete floor OR CLOSING BEFORE LATHING OR CLOSING IN IS WAIVED
Material of supports of heater or equipment (concrete floor or what kind) Concrete floor no wood
Minimum distance to wood or combustible material, from top of boiler or casing top of furnace, no wood
from top of smoke pipe, from front of heater, from sides or back of heater no wood

IF OIL BURNER

Name and type of burner Labeled and approved by Underwriters' Laboratories
Will operator be always in attendance? Type of oil feed (gravity or pressure)
Location oil storage No. and capacity of tanks
Will all tanks be more than seven feet from any flame? How many tanks fireproofed?
Amount of fee enclosed? \$1.00 (\$1.00 for one heater, etc., 50 cents additional for each additional heater, etc., in same building at same time.)

INSPECTION COPY

Signature of contractor

The Portland Co.

by Wm E. Allen

CERTIFICATE OF OCCUPANCY REQUIRED IS WAIVED

Ward 9 Permit No. 321120

Location Fort of Merrill St.

Owner Portland Bellad Bell

Date of permit 2/8/32

Notif. closing-in

Inspn. closing-in

Final Notif. None

Final Inspn. 2/26/32. C.B.

Cert. of Occupancy issued None

see 34730
see 34732

NOTES

2/9/32. On my previous inspection of 2/25/32 I do not remember seeing any foundation bolts in this stack. At this time there is considerable snow so could not check up on it. C.B.

2/26/32. Mr. Bent of this Co. said that the anchor bolts have been put in the base of this stack fastening it to the concrete base. C.B.

IN REPLY TO CITY BOARD OF OPENING STACK

PERMISSION COPY

25th March 1932

NOT PROCEED



FILL IN COMPLETELY AND SIGN WITH INK

PERMIT ISSUED
0038

Permit No. _____

JAN 17 1932

APPLICATION FOR PERMIT FOR HEATING, COOKING OR POWER EQUIPMENT

To the INSPECTOR OF BUILDINGS, PORTLAND, ME.

Portland, Maine, January 9, 1932

The undersigned hereby applies for a permit to install the following heating, cooking or power equipment in accordance with the Laws of Maine, the Building Code of the City of Portland, and the following specifications:

Location Morrills Corner Use of Building Factory

Name and address of owner Portland Billiard Ball Corp., Morrills Corner Ward 9

Contractor's name and address Automatic Oil Heating Company Telephone Proble 907

General Description of Work

To install Oil Burner

IF HEATER, POWER BOILER OR COOKING DEVICE

Is heater or source of heat to be in cellar? no If not, which story ground Kind of Fuel oil

Material of supports of heater or equipment (concrete floor or what kind) Concrete

Minimum distance to wood or combustible material, from top of boiler or casing top of furnace, _____
from top of smoke pipe _____, from front of heater _____ from sides or back of heater _____

IF OIL BURNER

Name and type of burner Electrol Approved by Underwriters' Laboratories? Yes (labeled)

Location oil storage outside of building No. and capacity of tanks one 10,000 gallon

Will all tanks be more than seven feet from any wall? Yes How many tanks fireproofed? _____

Amount of fee enclosed? \$1.00 (\$1.00 for one heater, etc., 50 cents additional for each additional heater, etc., in same building at same time.)

Signature of contractor Automatic Oil Heating Company

INSPECTION COPY

B. F. Matthews 6781

NOTIFICATION BEFORE
OR CLOSING-IN IS WANTED.

CERTIFICATE OF OCCUPANCY
BY CITY IS WANTED.

P.C. 1/13/32



INDUSTRIAL ZONE PERMIT ISSUED
Permit No. 2572

APPLICATION FOR PERMIT

Class of Building or Type of Structure Second Class

Portland, Maine, December 28, 1931

To the INSPECTOR OF BUILDINGS, PORTLAND, ME:

The undersigned hereby applies for a permit to erect alter install the following building structure equipment in accordance with the Laws of the State of Maine, the Building Code of the City of Portland, plans and specifications, if any, submitted herewith and the following specifications:

Location Foot of Morrill Street Ward 9 Within Fire Limits? no Dist. No. _____
 Owner's or Lessee's name and address Portland Billiard Ball Corp. Telephone F 4828
 Contractor's name and address Owner Telephone _____
 Architect's name and address _____
 Proposed use of building Hfg. No. families _____
 Other buildings on same lot _____
 Plans filed as part of this application? no No. of sheets _____
 Estimated cost \$ 500 Ice \$.75

Description of Present Building to be Altered

Material concrete block No. stories 1 Heat steam Style of roof _____ Roofing _____
 Last use Hfg. No. families _____

General Description of New Work

To put in 12" concrete block partition in one corner of ~~new~~ building to provide heater room 12' x 20'

Outside steel stack to be covered under separate permit

It is understood that this permit does not include installation of heating apparatus which is to be taken out separately by and in the name of the heating contractor.

CERTIFICATE OF OCCUPANCY
REQUIREMENT IS WAIVED

Details of New Work

Size, front _____ depth _____ No. stories _____ Height average grade to top of plate _____
 Height average grade to highest point of roof _____
 To be erected on solid or filled land? _____ earth or rock? _____
 Material of foundation concrete Thickness, top _____ bottom _____
 Material of underpinning _____ Height _____ Thickness _____
 Kind of Roof _____ Rise per foot _____ Roof covering _____
 No. of chimneys _____ Material of chimneys _____ of lining _____
 Kind of heat steam (to be applied for) Type of fuel oil Is gas fitting involved? _____
 Corner posts _____ Sills _____ Girt or ledger board? _____ Size _____
 Material columns under girders _____ Size _____ Max. on centers _____
 Studs (outside walls and carrying partitions) 2x4-16" O. C. Girders 6x8 or larger. Bridging in every floor and flat roof span over 8 feet. Sills and corner posts all one piece in cross section.
 Joists and rafters: 1st floor _____, 2nd _____, 3rd _____, roof _____
 On centers: 1st floor _____, 2nd _____, 3rd _____, roof _____
 Maximum span: 1st floor _____, 2nd _____, 3rd _____, roof _____
 If one story building with masonry walls, thickness of walls? _____ height? _____

If a Garage

No. cars now accommodated on same lot _____, to be accommodated _____
 Total number commercial cars to be accommodated _____
 Will automobile repairing be done other than minor repairs to cars habitually stored in the proposed building? _____

Miscellaneous

Will above work require removal or disturbing of any shade tree on a public street? no
 Will there be in charge of the above work a person competent to see that the State and City requirements pertaining thereto are observed? yes

Portland Billiard Ball Corp.

Signature of owner by A. H. Bant

INSPECTION COPY

67281

Ward 9 Permit No. 31/2572
 Location Foot of Merrill St.
 Owner Portland Billiard Ball
 Date of permit 12/29/31
 Notif. closing-in
 Inspn. closing-in
 Final Notif.

Final Inspn. 2/9/32. OBB.

See 34/20 Ord.
 Cert. of Occupancy issued None
 C. O. 32/1000
 See 32/38

NOTES
 12/29/31 - On Jan. 1st this building will be discontinued for manufacture of billiard balls so that enclosure for heat is really not required by city code.

1/26/32. This partition is of brick etc. Stack has been set up and boiler being set up. Mr. Reynolds of the Portland Cr. will get permit to cover heat & stack etc.

2/2/32. Heater room about complete. Mr. Bunt said Mr. Cunningham will get permit to cover heat installation. OBB

2/5/32. Cunningham is connecting this work up but does not feel they are installing the boiler but is willing to obtain permit if it is up to them. OBB
 Letter to Portland Cr. 2/8/32
 OBB



IN THE CITY OF PORTLAND, MAINE

PERMIT ISSUED

Permit No. 0970
JUN 28 1927

APPLICATION FOR PERMIT

Class of Building or Type of Structure 1st.

Portland, Maine, June 24 1927

To the INSPECTOR OF BUILDINGS, PORTLAND, ME.

The undersigned hereby applies for a permit to ~~erect~~ alter install the following building ~~structure~~ erect in accordance with the Laws of the State of Maine, the Building Code of the City of Portland, plans and specifications, if any, submitted herewith and the following specifications:

Location Foot Morrill St. Morrill Co. Ward 2 Within Fire Limits? no Dist. No.

Owner's or Lessee's name and address Portland Billiard Ball Co. Telephone BU326

Contractor's name and address Herbert Barry Woodlawn Ave. Telephone

Architect's name and address

Proposed use of building Manufacturing No. families

Other buildings on same lot 10

Concrete Block Description of Present Building to be Altered
Material No. stories Heat Style of roof Pitch Roofing Paper
Last use Manufacturing No. families

General Description of New Work

Out in two skylights 5'-0 x 5'-0 as per code

CERTIFICATE OF OCCUPANCY
REQUIREMENT IS WAIVED.
NOTIFICATION FOR L.I.L.
OR CLOSING-IN IS WAIVED.

Details of New Work

Size, front depth No. stories Height average grade to highest point of roof

To be erected on solid or filled land? earth or rock?

Material of foundation Thickness, top bottom

Material of underpinning Height Thickness

Kind of roof Roof covering

No. of chimneys Material of chimneys of lining

Kind of heat Type of fuel Distance, heater to chimney

If oil burner, name and model

Capacity and location of oil tanks

Is gas fitting involved? Size of service

Corner posts Sills Girt or ledger board? Size

Material columns under girders Size Max. on centers

Studs (outside walls and carrying partitions) 2x4-16" O.C. Girders 6x8 or larger. Bridging in every floor and flat roof span over 8 feet. Sills and corner posts all one piece in cross section.

Joists and rafters: 1st floor 2nd 3rd roof

On centers: 1st floor 2nd 3rd roof

Maximum span: 1st floor 2nd 3rd roof

If one story building with masonry walls, thickness of walls? height?

If a Garage

No. cars now accommodated on same lot to be accommodated

Total number commercial cars to be accommodated

Will automobile repairing be done other than minor repairs to cars habitually stored in the proposed building?

Miscellaneous

Will above work require removal or disturbing of any shade tree on a public street? no

Plans filed as part of this application? no No. sheets

Estimated cost \$ 25 Fee \$ 25

Will there be in charge of the above work a person competent to see that the State and City requirements pertaining thereto are observed? yes

Signature of owner

INSPECTION COPY

3898H

Ward 9 Permit No. 27/970 A

Location Front of Mill St

Owner Ireland Billiard Ball Co.

Date of permit June 28/27

Notif. closing-in

Inspn. closing-in

Final Notif.

Final Inspn. [Signature]

Cert. of Occupancy issued

~~NOTES~~
~~WHICH IS VALID FOR PERMIT~~

General Inspection Report Form No. 1001
Inspection of building structure for permit



Location, Ownership and detail must be correct, complete and legible.
 Separate application required for every building.
 Plans must be filed with this application.

Application for Permit for Alterations, etc.

To the

Portland, Me., January 25, 1924

INSPECTOR OF BUILDINGS:

The undersigned applies for a permit to alter the following described building—

Location Foot of Morrill Street Ward 8 in fire-limits? no
 Name of Owner or Lessee, Portland Billiard Ball Co. Address Foot Morrill Street
 " " Contractor, Bert Berry " Woodlawn Ave
 " " Architect, "
 Material of Building is concrete Style of Roof, Ditch Material of Roofing, Asphalt
 Size of Building is 26ft feet long; 5ft feet wide. No. of Stories, 1
 Cellar Wall is constructed of stone is inches wide on bottom and batters to inches on top.
 Underpinning is concrete is inches thick; is feet in height.
 Height of Building 22ft Wall, if Brick; 1st, 2d, 3d, 4th, 5th,
 What was Building last used for? factory No. of Families?
 What will Building now be used for? factory

Description of Present Bldg.

RECORD

PERMIT MUST BE OBTAINED BEFORE BEGINNING WORK

Detail of Proposed Work

Repair after fire to former condition
all to comply with the building ordinance

 Estimated Cost \$1,000.

If Extended On Any Side

Size of Extension, No. of feet long?; No. of feet wide?; No. of feet high above sidewalk?
 No. of Stories high?; Style of Roof?; Material of Roofing?
 Of what material will the Extension be built? Foundation?
 If of brick, what will be the thickness of External Walls? inches; and Party Walls inches.
 How will the extension be occupied? How connected with Main Building?

When Moved, Raised or Built Upon

No. of Stories' height when Moved, Raised, or Built upon? Proposed Foundations
 No. of feet high from level of ground to highest part of Roof to be?
 How many feet will the External Walls be increased in height? Party Walls

If Any Portion of the External or Party Walls Are Removed

Will an opening be made in the Party or External Walls? in Story.
 Size of the opening? How protected?
 How will the remaining portion of the wall be supported?

Signature of Owner or Authorized Representative A. L. Runt
 Address 35 Richardson St.



Location, ownership and detail must be correct, complete and legible. Separate application required for every building. Plans must be filed with this application.

APPLICATION FOR PERMIT TO BUILD

(3D CLASS BUILDING)

Portland, Me., May 14, 1920 19

To THE
INSPECTOR OF BUILDINGS

The undersigned hereby applies for a permit to build, according to the following Specifications.—

Location Foot Morrill Street Wd. B

Name of owner is? Bart Billiard Ball Co Address Morrill Street

Name of mechanic is? Horace Winslow " 454 Auburn Street

Name of architect is? _____ " _____

Proposed occupancy of building (purpose) manufacturing (billiard balls) concrete

If a dwelling or tenement house, for how many families? _____

Are there to be stores in lower story? _____ No. _____

Size of lot, No. of feet front? _____, No. of feet rear? _____; No. of feet deep? _____

Size of building, No. of feet front? 125ft, No. of feet rear? 125ft; No. of feet deep? 28ft

No. of stories, front? 1 & 2; rear? _____

No. of feet in height from the mean grade of street to the highest part of the roof? 30ft

Distance from lot lines, front? _____ feet; side? _____ feet; rear? _____ feet

Firestop to be used? _____

Will the building be erected on solid or filled land? _____

Will the foundation be laid on earth, rock or piles? _____

If on piles, No. of rows? _____ distance on centres? _____ length of? _____

Diameter, top of? _____ diameter, bottom of? _____

Size of posts? _____

" girts? (12 inch wall)

" floor timbers? 1st floor concrete & wood, 3d _____, 4th _____

O. C. " " " " " " " " " " " "

Span " " " " " " " " " " " "

Braces, how put in? _____

Building, how framed? _____

Material of foundation? _____ thickness of? _____ laid with mortar? _____

Underpinning, material of? _____ height of? _____ thickness of? _____

Will the roof be flat, pitch, mansard, or hip? pitch Material of roofing? asphalt

Will the building be heated by steam, furnaces, stoves or grates? steam Will the flues be lined? yes

Will the building conform to the requirements of the law? yes

No. of brick walls? _____ and where placed? _____

Means of egress? _____

PERMIT MUST BE RECEIVED BEFORE BEGINNING WORK.

If the building is to be occupied as a Tenement House, give the following particulars:

What is the height of cellar or basement? _____

What will be the clear height of first story? _____ second? _____ third? _____

State what means of egress is to be provided? _____

_____ Scuttle and stepladder to roof? _____

Estimated Cost,

\$ 5,000.

Signature of owner or authorized representative,

Address,

Horace W. Winslow

Plans submitted? _____

Received by? _____

Plans must be submitted in duplicate, one set to be filed with the Department and the duplicate set thereof (bearing the approval of the Inspector of Buildings) shall be kept on the work and exhibited on demand.

Frost of Merrill St.
191

No. 5722 ^{157-11 2 11}
_{1 2 1 2 1}

APPLICATION FOR
PERMIT TO BUILD 3d CLASS BUILDING
LOCATION

No. Merrill

Ward 8

Inspector.

CONDITIONS

PERMIT GRANTED

May 14, 1920 191

Permit filled out by _____

Permit number _____

Plan number _____

FINAL REPORT

_____ 191

Has the work been completed in accordance with
this application and plans filed and approved?

Law been violated? _____

Nature of violation? _____

Violation removed when? _____ 191

Estimated cost of building, etc., \$ _____

Building Inspector.

APPROVAL



OFFICE HOURS
10 TO 12 M.
4 TO 5 P. M.

City of Portland.

OFFICE OF INSPECTOR OF BUILDINGS

4-24-13. 101

To the Inspector of Buildings of the City of Portland:

The undersigned respectfully makes application for a permit to erect enlarge a building on.....
Morrills Cor.....street, at number..... to be.....
One..... stories high. Forty..... feet long, Thirty-seven.....
feet wide, also an addition to be..... stories high,.....
feet long,..... feet wide, and to be used as a. Factory.....

CELLAR WALL—To be constructed of Stone..... to be 20..... inches wide on bottom and
batter to..... inches on top. Trench wall dry.
Concrete

UNDERPINNING—To be Blocks..... Height of underpinning from top of cellar wall to bottom of
sill.....ft..... inches to be 8..... inches in thickness.

EXTERIOR WALLS—To be constructed of Blocks... If of Brick, Stone, etc. Total length of wall
Fifteen..... ft..... inches. Thickness of 1st .. 9. 2d..... 31..... 4th.....
5th..... 6th..... story walls. If of reinforced concrete state mix and reinforcing system
to be used.

If wood construction, sills to be..... Girders.....
Posts..... Girts..... Studs..... to be spaced.....

This building will be used for the purposes of..... (If for apartments,
tenements, or other family uses state number of families accommodated and number on each floor.
If for manufacturing or mercantile purposes state character of business and amount of estimated
weight to be carried by the floor.)

Number of families on floor.....
Total number of families..... Concrete floor on hard pan.....

Manufacturing (state character).....
Estimated load on floors per sq. ft.....
Mercantile business (state character and load per sq. ft.).....

If building is used for tenement house or family use and more than one family, the following provis-
ions of the Building Laws regarding dividing partitions shall be adhered to (Quote Law re. this).

FIRESTOPS—All bearing and center partitions will have firestops cut in tight on top of each partition cap
and between each set of floor timbers. Where ledger boards are used there shall be firestops cut in
tight against bottom of ledger boards, of same size as wall studs. Also wherever the Inspector of
Buildings may consider necessary.

STAIRWAYS—No. in building..... location..... to be enclosed
with..... walls to be lathed with..... lathing.

ROOF—To be constructed of Wood..... Rafters to be 2-10..... inches to be spaced 16.....
..... inches on centers. Roof to be covered with Pattern Roofing.....

Gutters to be made of..... Cornices to be made of.....

Bay windows to be made of..... to be covered with.....

Dormer Windows to be made of..... to be covered.....

None Chimneys, Smoke flues to be lined with..... and provided with a 10 inch outside collar and an
inside collar to go to the inside of the flue.

Estimated Cost of Building \$5200

INSPECTION—The Inspector of Buildings is to be notified when building is ready for lathing and at least
24 hours before the lathing is begun.

The Builder is E. D. Libby & R. A. Winslow..... Address..... City.....

The Architect is..... Address.....

The Owner is Portland Billiard Ball Co..... Address..... Morrills Cor.....

No Deviation will be made from the above application without written permission from the Inspector of
Buildings.

The above petition was granted the 24..... day of April..... 1913.

(Applicant to sign here Portland Billiard Ball Co

By J. T. Miller, Treas.

Morrills St Corner

150-A-2-R
151-F-54

100

X

PERMIT NO. 3923

DATE OF ISSUE 4-25-13

LOCATION

Morrills Spr.