

Rear 239-READ STREET



SNICK WALKER

First cut #920R - Half cut #9202R - Third cut #9203R - Fifth cut #9205R

*in file
9-10-54
Rocky Hill*

Mr. Julian H. Orr, City Manager

March 18, 1954

Mr. Roger L. Creighton
Planning Director

Zoning - Rocky Hill
Mr. Orr's memorandum of
March 16, 1954

C
O
P
Y

1. According to Section 12, paragraph A-8, which covers the uses permitted in the Residential A zone, a quarry is permissible only if and as authorized by the Board of Appeals.

Because our zoning ordinance is a pyramid affair it would seem to me that a quarry is permissible in Industrial zones, if and as authorized by the Board of Appeals.

2. Section 3, paragraph A, which describes the uses permitted in the Industrial zone, does not specifically prohibit a quarry operation. The following sentence, however, might reasonably seem to cover quarry operations and might require that they be cleared through the Board of Appeals: "No premises shall be used for any of the following specified trades, industries or uses ... 3l. Any other trade, industry or use that is injurious, noxious or offensive to a neighborhood by reason of emission of odor, fumes, dust, smoke, vibration or noise or other cause . . ." While the preceding sentence seems categorically to exclude any use so described (and a quarry with blasting would seem to be such a use.) the general nature of the language seems to me that each specific case must be interpreted by the Board of Appeals.

3. I should recommend, therefore, that the use of Rocky Hill for a quarry should be cleared through the Board of Appeals.

Roger L. Creighton
Roger L. Creighton
Planning Director

rlc:yds

cc: Mr. Warren McDonald, Director ✓
Building Inspection

Mr. Lester Wallace
Purchasing Agent

RECEIVED
MAR 18 1954
DEPT OF CIVIL INSP.
PORTLAND

R 239

INQUIRY BLANK

ZONE I
FIRE DIST. No

CITY OF PORTLAND, MAINE
DEPARTMENT OF BUILDING INSPECTION

Verbal
By Telephone

DATE 4/4/46

LOCATION Rocky Hill OWNER City of Portland
MADE BY George H. May TEL. 2-4158

ADDRESS Dept. of Public Works

Proposed
PRESENT USE OF BUILDING Storage of tools, supplies, + equipment

CLASS OF CONSTRUCTION Third NO. OF STORIES 1

REMARKS:

INQUIRY: 1- Can a one story wood frame shed about
100' x 20' be built at the above location for
above use, no motor-driven vehicles to be stored
therein; this shed to take the place of an ex-
isting similar shed now located on Wewam
Avenue off Forest Avenue, in case this latter
property were to be sold?

W.P.
4/4/46

ANSWER: 1- Do not know of any reason why such
a building of this construction and use
cannot be built at the above location in
full compliance with Building Code and
Zoning Ordinance.

DATE OF REPLY 4/4/46 REPLY BY A. J. Sears

Rear 239 Road

RECEIVED
JUL 23 1940
DEPT. OF BLD'G. INSP.
CITY OF PORTLAND

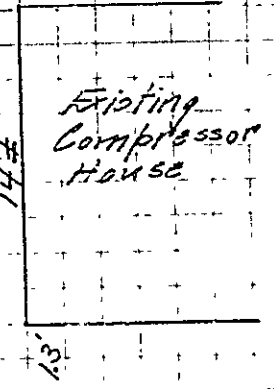
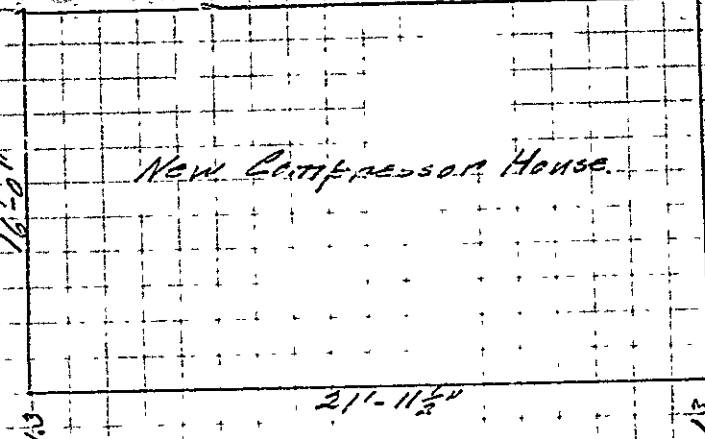

21'-11 1/2"

13'

8'-0"

13'

Right of Way

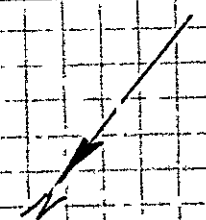

Recd 239 RR 2/4

RECEIVED
JUL 23 1940
DEPT. OF BLD'G. INSP.
CITY OF PORTLAND

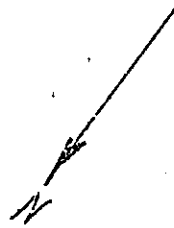
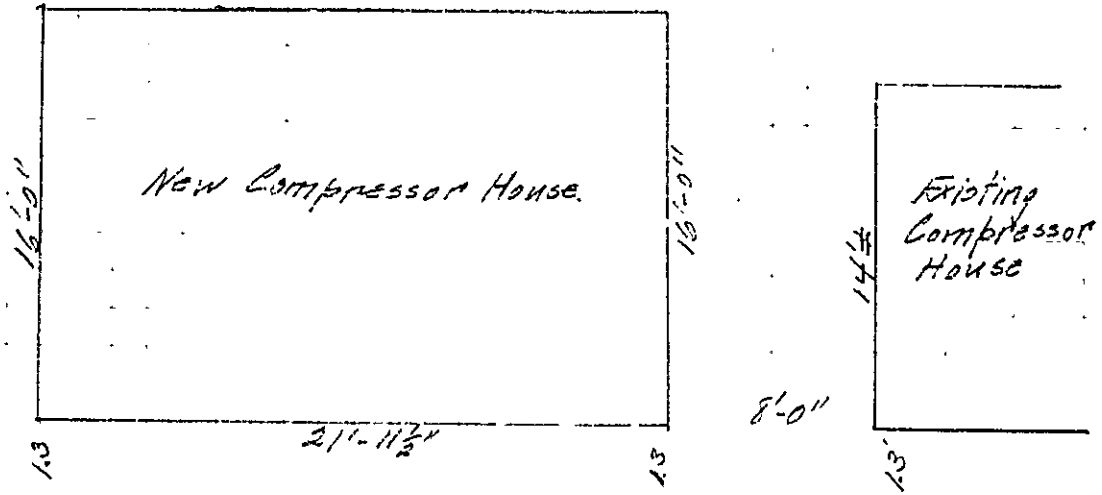



(2) INDUSTRIAL ZONE

APPLICATION FOR PERMIT

Class of Building or Type of Structure Third Class

Permit No. 10001
JUL 24 1940

Portland, Maine, July 23, 1940

To the, INSPECTOR OF BUILDINGS, PORTLAND, ME.

The undersigned hereby applies for a permit to erect alter or add the following building structure ~~structure~~ in accordance with the Laws of the State of Maine, the Building Code of the City of Portland, plans and specifications, if any, submitted herewith and the following specifications:

Location Rocky Hill Within Fire Limits? no Dist. No. _____
Owner's or lessee's name and address City of Portland Telephone _____
Contractor's name and address Owner Telephone _____
Architect _____ Plans filed yes No. of sheets 1
Proposed use of building Compressor House No. families _____
Other buildings on same lot _____
Estimated cost \$ 400. Fee \$ _____

Description of Present Building to be Altered

Material _____ No. stories _____ Heat _____ Style of roof _____ Roofing _____
Last use _____ No. families _____

General Description of New Work

To erect one story frame building 16' x 22'

NOTIFICATION BEFORE LATING
OR CLOSING IN IS WANTED
CERTIFICATE OF ALIENAGE
REQUIREMENT IS WANTED

It is understood that this permit does not include installation of heating apparatus which is to be taken out separately by the heating contractor.

Details of New Work

Is any plumbing work involved in this work? no
Is any electrical work involved in this work? yes Height average grade to top of plate 10'
Size, front 22' depth 16' No. stories 1 Height average grade to highest point of roof 13'
To be erected on solid or filled land? solid earth or rock? earth
Material of foundation concrete trench wall thickness, top 8" bottom 10" cellar no
Material of underpinning " to sill sill at least 8" above grade Height _____ Thickness _____
Kind of roof pitch Rise per foot 6" Roof covering Asphalt roofing Class C Und. Lab.
No. of chimneys no Material of chimneys _____ of lining _____
Kind of heat no Type of fuel _____ Is gas fitting involved? _____
Framing lumber—Kind spruce Dressed or full size? dressed
Corner posts 4x4 Sills 4x4 Girt or ledger board? none Size _____
Material columns under girders _____ Size _____ Max. on centers _____
Studs (outside walls and carrying partitions) 2x4-16" O. C. Girders 6x8 or larger. Bridging in every floor and flat roof span over 8 feet. Sills and corner posts all one piece in cross section.
Joists and rafters: 1st floor concrete, 2nd _____, 3rd _____, roof 2x6
On centers: 1st floor _____, 2nd _____, 3rd _____, roof 1.5"
Maximum span: 1st floor _____, 2nd _____, 3rd _____, roof _____

If one story building with masonry walls, thickness of walls? _____ height? _____

If a Garage

No. cars now accommodated on same lot _____, to be accommodated _____
Total number commercial cars to be accommodated _____
Will automobile repairing be done other than minor repairs to cars habitually stored in the proposed building? _____

Miscellaneous

Will above work require removal or disturbing of any shade tree on a public street? no
Will there be in charge of the above work a person competent to see that the State and City requirements pertaining thereto are observed? yes

Signature of owner By Edward M. Hunt
City of Portland

INSPECTION COPY

COMMISSIONER OF PUBLIC WORKS

Permit No 40/1000

Location Rocky Hill

Owner City of Portland

Date of permit 7/24/40

Notif. closing-in

Inspn. closing-in

Final Notif.

Final Inspn. 8/15/40

Cert of Occupancy issued

8/1/40 - Total - 22,000 sq ft

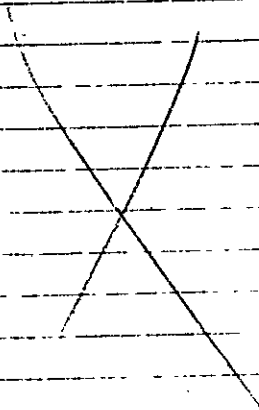



INDUSTRIAL ZONE

APPLICATION FOR PERMIT

Permit No. 2203 P
PERMIT ISSUED

Class of Building or Type of Structure Third Class

Portland, Maine, December 4, 1939 DEC 7 1939

To the INSPECTOR OF BUILDINGS, PORTLAND, ME.

The undersigned hereby applies for a permit to erect alter ~~install~~ the following building structure ~~equipment~~ in accordance with the Laws of the State of Maine, the Building Code of the City of Portland, plans and specifications, if any, submitted herewith and the following specifications:

Location Pony Hill Within Fire Limits? no Dist. No. _____
 Owner's or Lessee's name and address City of Portland, ME Telephone _____
 Contractor's name and address Dexter Telephone _____
 Architect _____ Plans filed yes No. of sheets 2
 Proposed use of building Asphalt mixing plant No. families _____
 Other buildings on same lot _____
 Estimated cost \$ 500. Fee \$ _____

Description of Present Building to be Altered

Material _____ No. stories _____ Heat _____ Style of roof _____ Roofing _____
 Last use _____ No. families _____

General Description of New Work

To erect one story frame building 14' x 23' as per plans submitted

CERTIFICATE OF OCCUPANCY
REQUIREMENT IS WAIVED
NOTIFICATION BEFORE
OR CLOSING-IN IS WAIVED

It is understood that this permit does not include installation of heating apparatus which is to be taken out separately by and in the name of the heating contractor.

Details of New Work

Is any plumbing work involved in this work? no
 Is any electrical work involved in this work? no Height average grade to top of plate 15'
 Size, front _____ depth _____ No. stories _____ Height average grade to highest point of roof 19' 3"
 To be erected on solid or filled land? solid earth or rock? earth
 Material of foundation concrete trench wall Thickness, top _____ bottom _____ cellar _____
 Material of underpinning _____ Height _____ Thickness _____
 Kind of Roof _____ Rise per foot _____ Roof covering Asphalt roofing Class B End Lab.
 No. of chimneys no Material of chimneys _____ of lining _____
 Kind of heat no Type of fuel _____ Is gas fitting involved? _____
 Framing Lumber—Kind spruce Dressed or Full Size? dressed
 Corner posts _____ Sills _____ Girt or ledger board? _____ Size _____
 Material columns under girders _____ Size _____ Max. on centers _____
 Studs (outside walls and carrying partitions) 2x4-16" O. C. Girders 6x8 or larger. Bridging in every floor and flat roof span over 8 feet. Sills and corner posts all one piece in cross section.
 Joists and rafters: 1st floor _____, 2nd _____, 3rd _____, roof _____
 On centers: 1st floor _____, 2nd _____, 3rd _____, roof _____
 Maximum spar.: 1st floor _____, 2nd _____, 3rd _____, roof _____

If one story building with masonry walls, thickness of walls? _____ height? _____

If a Garage

No. cars now accommodated on same lot _____, to be accommodated _____
 Total number commercial cars to be accommodated _____
 Will automobile repairing be done other than minor repairs to cars habitually stored in the proposed building? _____

Miscellaneous

Will above work require removal or disturbing of any shade tree on a public street? no
 Will there be in charge of the above work a person competent to see that the State and City requirements pertaining thereto are observed? yes

Signature of owner _____
 City of Portland
 Department of Public Works
 By Edward M. Hunt

INSTRUCTION COPY

Permit No. 39/2208 P

Location Near 229 Read St.

Owner City of Portland

Date of permit 12/7/39

Notif. closing-in

Inspn. closing-in

Final Notif.

Final Inspn. 1/5/40

Cert. of Occupancy issued None

NOTES

12/14/39 - No work started
O.G.S.

12/24/39 - Framing com-
pleted - O.G.S.

1/15/40 - Work nearly com-
pleted - O.G.S.

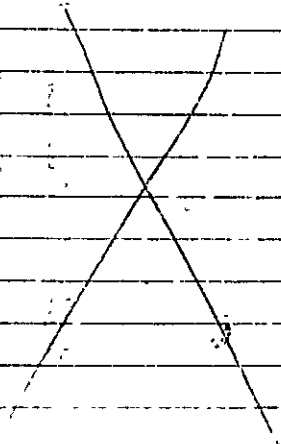



APPLICATION FOR PERMIT

PERMIT ISSUED
1294

Class of Building or Type of Structure Third Class

AUG 24 1916

Portland, Maine, August 24, 1916

To the INSPECTOR OF BUILDINGS, PORTLAND, ME.

The undersigned hereby applies for a permit to erect alter install the following building structure equipment in accordance with the Laws of the State of Maine, the Building Code of the City of Portland, plans and specifications, if any, submitted herewith and the following specifications:

Location Rocky Hill Ward 9 Within Fire Limits? no Dist. No. _____
 Rear 289 Road St.
 Owner's or Lessee's name and address City of Portland Telephone _____
 Contractor's name and address Owner Telephone _____
 Architect's name and address _____
 Proposed use of building Storage Bin for Crushed Stone No. families _____
 Other buildings on same lot _____
 Plans filed as part of this application? Refer to DEP Plan 890/17A No. of sheets _____
 Estimated cost \$ _____ Fee \$ _____

Description of Present Building to be Altered

Material _____ No. stories _____ Heat _____ Style of roof _____ Roofing _____
 Last use Storage Bin No. families _____

General Description of New Work

To construct a 1.5m addition about 10' x 16' about 25' above grade as per above plan in file # of Department of Public Works

It is understood that this permit does not include installation of heating apparatus which is to be taken out separately by and in the name of the heating contractor.

Details of New Work

Site, front _____ depth _____ No. stories _____ Height average grade to top of plate _____
 Height average grade to highest point of roof _____
 To be erected on solid or filled land? _____ earth or rock? _____
 Material of foundation _____ Thickness, t _____ bottom _____
 Material of underpinning _____ Height _____ Thickness _____
 Kind of Roof _____ Rise per foot _____ Roof covering _____
 No. of chimneys _____ Material of chimney _____ of lining _____
 Kind of heat _____ Type of fuel _____ Is gas fitting involved? _____
 Corner posts _____ Sills _____ Girt or ledger board? _____ Size _____
 Material columns under girders _____ Size _____ Max. on centers _____
 Studs (outside walls and carrying partitions) 3x4-16" O. C. Girders 6x8 or larger. Bridging in every floor and flat roof span over 8 feet. Sills and corner posts all one piece in cross section.
 Joist and rafters: 1st floor _____, 2nd _____, 3rd _____, roof _____
 On centers: 1st floor _____, 2nd _____, 3rd _____, roof _____
 Maximum span: 1st floor _____, 2nd _____, 3rd _____, roof _____
 If one story building with masonry walls, thickness of walls? _____ in.

If a Garage

No. cars now accommodated on same lot _____, to be accommodated _____
 Total number commercial cars to be accommodated _____
 Will automobile repairing be done other than minor repairs to cars habitually stored in the proposed building? _____

Miscellaneous

Will above work require removal or disturbing of any shade tree on a public street? no
 Will there be in charge of the above work a person competent to see that the State and City requirements pertaining are observed? yes

INSPECTION COPY

Signature of owner

City of Portland
Department of Public Works

By Edward M. Harris
Commissioner of Public Works

Waid 9 Permit No. 36/594

Location Pratt Hill Pier 237 Reg

Owner City of Portland

Date of permit 8/24/36.

Notif. closing-in

Inspn. closing-in

Final Notif.

Final Inspn. 2/4/37

Cert. of Occupancy issued None

NOTES
2/4/37 - Work done
2/28



APPLICATION FOR PERMIT

Permit No. 2765
DEC 28 1955

Class of Building or Type of Structure Third-Class

Portland, Maine, December 21, 1955

To the INSPECTOR OF BUILDINGS, PORTLAND, ME.

The undersigned hereby applies for a permit to erect ~~also install~~ the following building ~~structure equipment~~ in accordance with the Laws of the State of Maine, the Building Code of the City of Portland, plans and specifications, if any, submitted herewith and the following specifications:

Location Rocky Hill Ward 9 Within Fire Limits? no Dist. No. _____
 Owner's or Lessee's name and address City of Portland Telephone _____
 Contract name and address Dept. Public Works Telephone 2-4658
 Architect's name and address _____
 Proposed use of building Storage and headquarters for WPA crews N. families _____
 Other buildings on same lot Cushman, etc.
 Plans filed as part of this application? yes No. of sheets 1
 Estimated cost \$500.00 Fee \$ _____

Description of Present Building to be Altered

Material _____ No. stories _____ Heat _____ Style of roof _____ Roofing _____
 Last use _____ No. families _____

General Description of New Work

To erect one story building 16' x 50'
 Side walls to be covered with asphalt roofing
 Studs to be 2x4 - 24" O.C. & 8' reaction and 2x4 16" on center & 10' and 50' walls of building

It is understood that this permit does not include installation of heating apparatus which is to be taken out separately by and in the name of the heating contractor.

Details of New Work

Height average grade to top of plate 6'
 Size, front 15' depth 50' No. stories 1 Height average grade to highest point of roof 10'
 To be erected on solid or filled land? solid earth or rock? ledge
 Material of foundation l.t. rocks Thickness, top _____ bottom _____
 Material of underpinning _____ Height _____ Thickness _____
 Kind of Roof flat Rise per foot 1-2/52 Roof covering Class C Asphalt roofing
 No. of chimneys 1 Material of chimneys brick of lining tile
 Kind of heat gas stove Type of fuel coal Is gas fitting involved? _____
 Corner posts 4x4 Sills 6x8 Girt or ledger board? _____ Size _____
 Material columns under girders _____ Size _____ Max. on centers _____
 Studs (outside walls and carrying partitions) 2x4-16" O.C. Girders 6x8 or larger. Bridging in every floor and flat roof span over 3 feet. Sills and corner posts all one piece in cross section.
 Posts and rafters: 1st floor 2x8, 2nd _____, 3rd _____, roof 2x8
 On centers: 1st floor 6" / 8", 2nd _____, 3rd _____, roof 20"
 Maximum span: 1st floor 5', 2nd _____, 3rd _____, roof 15'
 Is one story building with masonry walls, thickness of walls? _____ height? _____

If a Garage

No. cars now accommodated on same lot _____, to be accommodated _____
 Total number commercial cars to be accommodated _____
 Will automobile repairing be done other than minor repairs to cars habitually stored in the proposed building? _____

Miscellaneous

Will above work require removal or disturbing of any shade tree on a public street? _____
 Will there be in charge of the above work a person competent to see that the State and City requirements pertaining thereto are observed? yes

INSPECTION COPY

Signature of owner _____
 By Edmond M. H. [Signature]
 City of Portland
 Department of Public Works
 COMMISSIONER OF PUBLIC WORKS

Ward 9 Permit No 35/2165
Location Rocky Hill
Owner City of Portland
Date of permit 12/28/35
Notif. closing-in _____
Inspn. closing-in _____
Final Notif. _____
Final Insp'n 2/11/36
Cert of Occupancy issued None

NOTES

~~12/21/35 - This flag is
8' high on one side and
10' on the other. It is
made to use 2x4
studs, 16" on high
side and ends
and 24" on center
on low side.~~

~~1/6/36 - No work~~

~~started~~
1/13/36 - Floor framed
A.G.S.

~~1/17/36 - Framing com-
pleted A.G.S.~~

~~1/25/36 - Siding in
completed A.G.S.~~