

215-239 READ STREET
1911-1950 # 1

**CERTIFICATE OF APPROVAL
FOR INTERNAL PLUMBING**

**CERTIFICATE OF APPROVAL
FOR INTERNAL PLUMBING**

THE TOWN/CITY OF Portland

TCWN/CITY CODE 05170 LPI NUMBER 00123 DATE PERMIT ISSUED 11/18/83
Month Day Year

№ 701541C

Installer's Name A A S K N W B B
Last Name F I M I

Owner Ventura Laboratories

Address 217 Glad. Hall
S/Lot Number Street, Road Name Subdivision
(Location where plumbing was done and inspected)

Installer Code 2

Certificate of App. Number

- 1 Owner
- 2 Licensed Master Plumber
- 3 Licensed Oil Burnerman
- 4 Employee of Public Utility
- 5 Manufactured Housing Dealer
- 6 Manufactured Housing Mechanic
- 7 Limited License

THE INTERNAL PLUMBING INSTALLED PURSUANT TO THE ABOVE CERTIFICATE OF APPROVAL NUMBER HAS BEEN TESTED IN MY PRESENCE, FOUND TO BE FREE FROM LEAKS, AND WAS INSTALLED IN COMPLIANCE WITH THE MUNICIPAL AND STATE PLUMBING RULES.

Arnold R. Goodman

OWNER'S COPY

Signature of LPI _____
Date Inspected JAN 11 1983

ORIGINAL—To be sent to: Department of Human Services
Division of Health Engineering

05170 00123 11/18/83 7347 701541P
nth Day Year License No

Address of Where Plumbing Is Done 217 Glad. Hall ETT
S/Lot Number Street/Road Name Subdivision

Name of Owner ALVIN S. L...
Last Name F I M I Mailing Address Zip Code

Installer Code 2

PERMIT NUMBER

- 1 Owner
- 2 Licensed Master Plumber
- 3 Licensed Oil Burnerman
- 4 Employee of Public Utility
- 5 Manufactured Housing Dealer
- 6 Manufactured Housing Mech
- 7 Limited License

Type of Construction: 1 New, 2 Remodeling, 3 Addition, 4 Remodeling & Addition, 5 Replacement of Hot Water Heater, 6 Hook up of Mobile Home, 7 Hook-up of Modular Home, 8 Other (Specify) 7

Plumbing To Serve: 1 Single (Res), 2 Multi-Fam(Res), 3 Mobile Home, 4 Modular Home, 5 Commercial, 6 School, 7 Other (Specify) 5

Number of Fixtures or Hook Ups: Sink(s) 3, Toilet(s) 1, Bath(s) 1, Lavatorie(s) 1, Shower(s) 1, Urinal(s) 1, Clothes Washer(s) 1, Dish Washer(s) 1, Hot Water Heater(s) 1, Floor Drain(s) 1, Hook Up(s) 1

TOWN'S COPY

IMPORTANT Note the following conditions:
1 This Permit is non-transferable to another person or party.
2 If construction has not started within 6 months from the Date of Issue this Permit becomes invalid.

Fixture Fee 172.00
Hook Up Fee 00.00
Total Fee 172.00

Dept of Human Services
Div of Health Engineering

Double Fee Check Box

Signature of I PI _____



APPLICATION FOR PERMIT
DEPARTMENT OF BUILDING INSPECTIONS SERVICES
ELECTRICAL INSTALLATIONS

Date Sept. 14, 19 81
 Receipt and Permit number 473151

To the CHIEF ELECTRICAL INSPECTOR, Portland, Maine:

The undersigned hereby applies for a permit to make electrical installations in accordance with the laws of Maine, the Portland Electrical Ordinance, the National Electrical Code and the following specifications:

LOCATION OF WORK: 217 Read St. - 1st & 3rd floors
 OWNER'S NAME: Ventyrex Laboratories ADDRESS: same

OUTLETS:	FEEES
Receptacles _____ Switches _____ Plugmold _____ ft. TOTAL <u>31-60</u>	<u>7.40</u>
FIXTURES: (number of)	<u>3x28</u>
Incandescent _____ Fluorescent <u>x</u> (not strip) TOTAL <u>28</u>	<u>4.80</u>
Strip Fluorescent _____ ft.	
SERVICES:	
Overhead _____ Underground _____ Temporary _____ TOTAL amperes _____	
METERS: (number of)	
MOTORS: (number of)	
Fractional	
1 HP or over	
RESIDENTIAL HEATING:	
Oil or Gas (number of units)	
Electric (number of rooms)	
COMMERCIAL OR INDUSTRIAL HEATING:	
Oil or Gas (by a main boiler)	
Oil or Gas (by separate units)	
Electric Under 20 kws _____ Over 20 kws _____	
APPLIANCES: (number of)	
Ranges _____ Water Heaters _____	
Cook Tops _____ Disposals _____	
Wall Ovens _____ Dishwashers _____	
Dryers _____ Compactors _____	
Fans _____ Others (denote) _____	
TOTAL	
MISCELLANEOUS: (number of)	
Branch Panels _____	
Transformers _____	
Air Conditioners Central Unit _____	
Separate Units (windows) _____	
Signs 20 sq. ft. and under _____	
Over 20 sq. ft. _____	
Swimming Pools Above Ground _____	
In Ground _____	
Fire/Burglar Alarms Residential _____	
Commercial _____	
Heavy Duty Outlets, 220 Volt (such as welders) 30 amps and under _____	
over 30 amps _____	
Circus, Fairs, etc. _____	
Alterations to wires _____	
Repairs after fire _____	
Emergency Lights, battery _____	
Emergency Generators _____	
	INSTALLATION FEE DUE:
FOR ADDITIONAL WORK NOT ON ORIGINAL PERMIT	DOUBLE FEE DUE:
FOR REMOVAL OF A "STOP ORDER" (304-16.b)	
	TOTAL AMOUNT DUE: <u>12.80</u>

INSPECTION:
 Will be ready on _____, 19 ____; or Will Call _____
CONTRACTOR'S NAME: Aladdin Electric
ADDRESS: 631 Forest ave.
TEL.: _____
MASTER LICENSE NO.: on file **SIGNATURE OF CONTRACTOR:** _____
LIMITED LICENSE NO.: _____

INSPECTOR'S COPY — WHITE
 OFFICE COPY — CANARY
 CONTRACTOR'S COPY — GREEN

ELECTRICAL INSTALLATIONS —

Permit Number 73151

Location 217 Reed St.

Owner Ventures Lab.

Date of Permit 9-14-81

Final Inspection 9-23-81

By Inspector Edley

Permit Application Register Page No. 98

INSPECTIONS: Service _____ by _____

Service called in _____

Closing-in _____ by _____

PROGRESS INSPECTIONS: 9-23-81 / _____

_____/_____/_____
_____/_____/_____
_____/_____/_____
_____/_____/_____
_____/_____/_____

DATE: 9-23-81

REMARKS:

Work done some time ago before permit taken

**CERTIFICATE OF APPROVAL
FOR INTERNAL PLUMBING**

THE TOWN/CITY OF Portland

TOWN/CITY CODE
05170

LPI NUMBER
00123

DATE ISSUED
8/19/81
Month Day Year

55286 IC

Installer's Name
WAMSOM F I M I
RW

Owner
Scrubner & Larson
Address
215 Wood Street
St./Lot Number Street, Road Name Subdivision
(Location where plumbing was done and inspected)

Installer Code
 2

- Certificate of App. Number
- 1: Owner
 - 2: Licensed Master Plumber
 - 3: Licensed Oil Burnerman
 - 4: Employee of Public Utility
 - 5: Manufactured Housing Dealer
 - 6: Manufactured Housing Mechanic
 - 7: Limited License

THE INTERNAL PLUMBING INSTALLED PURSUANT TO THE ABOVE CERTIFICATE OF APPROVAL NUMBER HAS BEEN TESTED IN MY PRESENCE, FOUND TO BE FREE FROM LEAKS AND WAS INSTALLED IN COMPLIANCE WITH THE MUNICIPAL AND STATE PLUMBING RULES.

Conrad O. Goodness

OWNER'S COPY

Signature of LPI

Date Inspected AUG 19 1981

INTERNAL PLUMBING PERMIT FOR THE TOWN/CITY OF Portland

Town/City Code
05170

LPI Number
00123

Date Issued
8/19/81
Month Day Year

INSTALLER'S
WAMSOM License No.
55286

55286 IP

Address of Where Plumbing is Done
215 Wood Street
St./Lot Number Street/Road Name Subdivision

Installer Code
 2

- PERMIT NUMBER
- 1: Owner
 - 2: Licensed Master Plumber
 - 3: Licensed Oil Burnerman
 - 4: Employee of Public Utility
 - 5: Manufactured Housing Dealer
 - 6: Manufactured Housing Mech
 - 7: Limited License

Name of Owner
Scrubner & Larson Last Name F I M I Mailing Address Zip Code

Type of Construction	1 New 2 Remodeling	3 Addition 4 Remodeling & Addition	5 Replacement of Hot Water Heater 6 Hook up of Mobile Home	7 Hook up of Modular Home 8 Other (Specify)		
Plumbing To Serve	1 Single (Res) 2 Multi Fam/Res	3 Mobile Home 4 Modular Home	5 Commercial 6 School	7 Other (Specify)		
Number of Fixtures or Hook Ups	Sink(s) <input type="checkbox"/>	Toilet(s) <input type="checkbox"/>	Bath(s) <input type="checkbox"/>	Lavatory(s) <input type="checkbox"/>	Shower(s) <input type="checkbox"/>	Urinals <input type="checkbox"/>
	Clothes Washer(s) <input type="checkbox"/>	Dish Washer(s) <input type="checkbox"/>	Hot Water Heater(s) <input type="checkbox"/>	Floor Drain(s) <input type="checkbox"/>	hook Up(s) <input type="checkbox"/>	<input type="checkbox"/>

AUG 19 1981

IMPORTANT Note the following conditions:
1 This Permit is non transferable to another person or party
2 If construct on has not started within 6 months from the Date of Issue this Permit becomes invalid

Fixture Fee

Hook Up Fee

Total Fee

If Double Fee Check Box

Dept of Human Services
Div of Health Engineering

Signature of LPI _____



(IN INDUSTRIAL ZONE)

APPLICATION FOR PERMIT

Class of Building or Type of Structure Installation

Portland, Maine, March 7, 1950

CITY OF PORTLAND

PERMIT ISSUED

00354

MAR 28 1950

CITY of PORTLAND

ESS

To: INSPECTOR OF BUILDINGS, PORTLAND, MAINE

The undersigned hereby applies for a permit to ~~construct~~ install the following ~~building~~ equipment in accordance with the Laws of the State of Maine, the Building Code and Zoning Ordinance of the City of Portland, plans and specifications, if any, submitted herewith and the following specifications:

Location 215-239 Read Street Within Fire Limits? no Dist. No.
Owner's name and address First National Stores, Inc., 215-239 Read St. Telephone
Lessee's name and address
Contractor's name and address The Fels Co., 112 Union Street Telephone 2-1939
Architect Specifications Plans yes No. of sheets 1
Proposed use of building Warehouse, bakery etc. No. families
Last use No. families
Material No. stories Heat Style of roof Roofing
Other buildings on same lot
Estimated cost \$ Fee \$ 1.00

General Description of New Work

To install mechanical ventilation as per plan.

Sent to Fire Dept. 3/21/50
Rec'd from Fire Dept. 3/21/50

It is understood that this permit does not include installation of heating apparatus which is to be taken out separately by and in the name of the heating contractor. PERMIT TO BE ISSUED TO The Fels Co.

Details of New Work

Is any plumbing involved in this work? Is any electrical work involved in this work?
Height average grade to top of plate Height average grade to highest point of roof
Size, front depth No. stories solid or filled land? earth or rock?
Material of foundation Thickness, top bottom cellar
Material of underpinning Height Thickness
Kind of roof Rise per foot Roof covering
No. of chimneys Material of chimneys of lining Kind of heat fuel
Framing lumber—Kind Dressed or full size?
Corner posts Sills Girt or ledger board? Size
Girders Size Columns under girders Size Max. on centers
Studs (outside walls and carrying partitions) 2x4-16" O. C. Bridging in every floor and flat roof span over 8 feet.
Joists and rafters: 1st floor 2nd 3rd roof
On centers: 1st floor 2nd 3rd roof
Maximum span: 1st floor 2nd 3rd roof
If one story building with masonry walls, thickness of walls? height?

If a Garage

No. cars now accommodated on same lot, to be accommodated number commercial cars to be accommodated
Will automobile repairing be done other than minor repairs to cars habitually stored in the proposed building?

APPROVED:

Handwritten signature of inspector

Miscellaneous

Will work require disturbing of any tree on a public street? no
Will there be in charge of the above work a person competent to see that the State and City requirements pertaining thereto are observed? yes

First National Stores, Inc.
The Fels Co.

Signature of owner Charles H. Nelson

INSPECTION COPY



APPLICATION FOR AMENDMENT TO PERMIT

Amendment No. 2
Portland, Maine, Dec. 6, 1949

PERMIT ISSUED
DEC 7 1949
CITY OF PORTLAND

To the INSPECTOR OF BUILDINGS, PORTLAND, MAINE

The undersigned hereby applies for amendment to Permit No. 19/1075 pertaining to the building or structure comprised in the original application in accordance with the laws of the State of Maine, the Building Code and Zoning Ordinance of the City of Portland, plans and specifications, if any, submitted herewith, and the following specifications:

Location 215-239 Read Street Within Fire Limits? no Dist. No. _____
Owner's name and address First National Stores, Inc. 217-239 Read St. Telephone _____
Lessee's name and address _____ Telephone _____
Contractor's name and address C. A. Dodge Co., 2 Erie St., Cambridge, Mass. Telephone _____
Architect _____ Plans filed yes No. of sheets 1
Proposed use of building Warehouse (new building) No. families _____
Last use _____ No. families _____
Increased cost of work 500. Additional fee 25.

Description of Proposed Work

To erect 8" concrete block partition as shown on plan.

Permit Issued with Letter

sent to Fire Dept. 12/12/49
Acc'd from Fire Dept. 12/12/49

Details of New Work

Is any plumbing involved in this work? _____ Is any electrical work involved in this work? _____
Height average grade to top of plate _____ Height average grade to highest point of roof _____
Size, front _____ depth _____ No. stories _____ solid or filled land? _____ earth or rock? _____
Material of foundation _____ Thickness, top _____ bottom _____ cellar _____
Material of underpinning _____ Height _____ Thickness _____
Kind of roof _____ Rise per foot _____ Roof covering _____
No. of chimneys _____ Material of chimneys _____ of lining _____
Framing lumber—Kind _____ Dressed or full size? _____
Corner posts _____ Sills _____ Girt or ledger board? _____ Size _____
Girders _____ Size _____ Columns under girders _____ Size _____ Max. on centers _____
Studs (outside walls and carrying partitions) 2x4-16" O. C. Bridging in every floor and flat roof span over 8 feet.
Joists and rafters: 1st floor _____, 2nd _____, 3rd _____, roof _____
On centers: 1st floor _____, 2nd _____, 3rd _____, roof _____
Maximum span: 1st floor _____, 2nd _____, 3rd _____, roof _____

Approved: with letter by City
approved by Chief
Sanborn 12/14/49

First National Stores, Inc.
C. A. Dodge Co.
Signature of Owner: Will Low
Approved: 12/14/49 WMS
Inspector of Buildings

INSPECTION COPY

B. 215 - 2391 Reed St.

1/4/50 - Work started #11

1/10/50 - Fine screen (self-cleaning)
has been provided. Wall
is about 11' high. No one
working here. E.S.S.

2/8/50 - No work except for
removing louvers & shutters

2/23/50 - Automatic fire shutters
not yet provided E.S.S.

1/6/50. Fine shutters are

not labelled. They have

been made up by Fields Co.

Mr. Ross said they were o.k.

Permit for ventilation system
to be labored out by Fields. E.S.S.

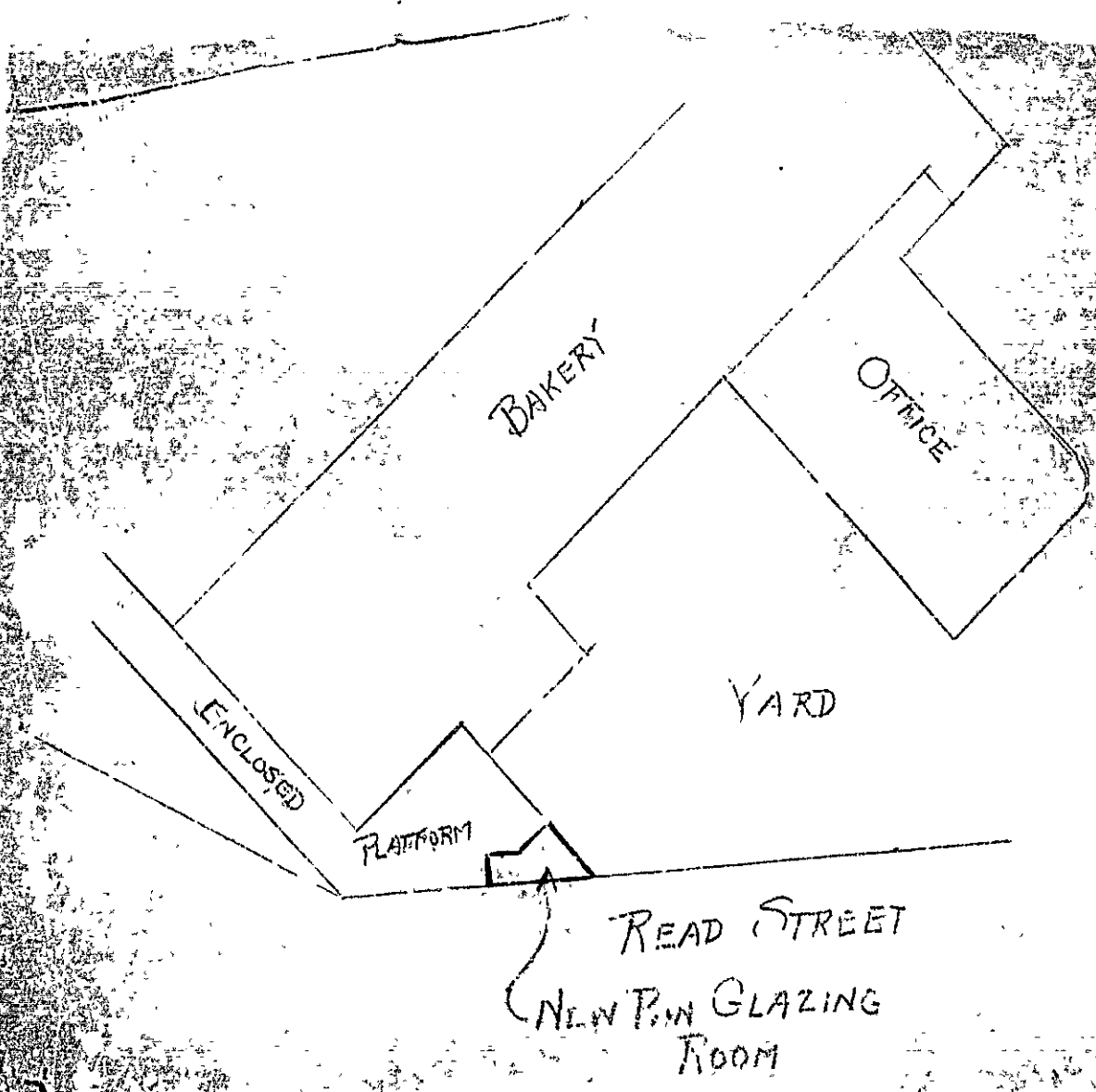

READ STREET
NEW PIN GLAZING
ROOM

BP 215-239 Read Street

*Approved
by
12/13/49*

Oliver P. Sanborn, Chief of the Fire Department

December 8, 1949

Warren McDonald, Inspr. of Bldgs.

Approval of permit for providing pan glazing room in building
of First National Stores, Inc. at 215-239 Read Street

This concrete block partition is apparently to provide an enclosure for a cap tank process to be used in glazing pans for use in the bakery and is to be built in a corner of the enclosed platform at the Read Street end of the building in location shown on pencil sketch attached. Because of the hazardous use and the need for ventilation of the room, the permit is sent to you for approval of the arrangements shown on the plan. The Building Code controls the situation only as a hazardous room and specifies a separation of one hour fire resistance for the room. The 8" concrete block partition and Class "B" fire door shown provides a two hour separation. The entire building is protected by an automatic sprinkler system.

AJS/G

BP 215-237 to Street-1

December 14, 1949

C. A. Dodge Company
c/o First National Stores, Inc.
215-237 Road Street
Portland, Me.

Subject: Amendment to permit 12/14/49 continuing
construction of concrete block partition in
portion of enclosed platform of building
at 215-237 Road Street

Castles:

The amendment covering the above work is issued herewith based on the plan filed with the application and subject to the following:

1. Because of the dipping process to be carried on in the room partitioned off by the new concrete block wall, the Building Code specifies that construction shall be as indicated for a hazardous room. The construction shown will meet such requirements, but the Class "B" fire door is required to be made either automatic or self-closing. Class "B" labeled automatic-closing fire shutters are required for the two small louvers shown.

2. It is possible that the erection of the new partition may make necessary adjustment of the heads of the automatic sprinkler system in this area to provide proper coverage and this should be taken care of if necessary.

3. Because of the dipping process to be carried on in this room, care should be taken to provide all of the safeguarding features specified in the standards of the National Board of Fire Underwriters covering such processes.

Very truly yours,

Warren L. Jenard
Inspector of Buildings

MIS/G

215-237 National Stores, Inc.
215-237 Road Street

C. A. Dodge Company
2 Erie Street
Salem, Massachusetts



(1) INDUSTRIAL ZONE

APPLICATION FOR PERMIT

Class of Building or Type of Structure

Portland, Maine, April 3, 1950

PERMIT ISSUED

00396

APR 4 1950

CITY OF PORTLAND

To the INSPECTOR OF BUILDINGS, PORTLAND, MAINE

The undersigned hereby applies for a permit to alter repair, etc. of the following building in accordance with the Laws of the State of Maine, the Building Code and Zoning Ordinance of the City of Portland, plans and specifications, if any, submitted herewith and the following specifications:

Location 215-239 Read Street Within Fire Limits? no Dist. No.
Owner's name and address First National Stores, Inc., 215-239 Read Street Telephone
Lessee's name and address Telephone
Contractor's name and address Ernest C. Soule, 75 Edwards Street Telephone 2-7301
Architect Specifications Plans no No. of sheets
Proposed use of building Office Section No. families
Last use " " No. families
Material No. stories Heat Style of roof Roofing
Other buildings on same lot
Estimated cost \$200 Fee \$2.00

General Description of New Work

To demolish non-bearing partition approximately 12' long and high, first floor between two offices.

CERTIFICATE OF OCCUPANCY REQUIREMENT IS WAIVED

It is understood that this permit does not include installation of heating apparatus which is to be taken out separately by and in the name of the heating contractor. PERMIT TO BE ISSUED TO Ernest C. Soule

Details of New Work

Is any plumbing involved in this work? is any electrical work involved in this work?
Height average grade to top of plate Height average grade to highest point of roof
Size, front depth No. stories solid or filled land? earth or rock?
Material of foundation Thickness, top bottom cellar
Material of underpinning Height Thickness
Kind of roof Rise per foot Roof covering
No. of chimneys Material of chimneys of lining Kind of heat fuel
Framing lumber--Kind Dressed or full size?
Corner posts Sills Girt or ledger board? Size
Girders Size Columns under girders Size Max. on centers
Studs (outside walls and carrying partitions) 2x4-16" O. C. Bridging in every floor and flat roof span over 8 feet.
Joists and rafters: 1st floor, 2nd, 3rd, roof
On centers: 1st floor, 2nd, 3rd, roof
Maximum span: 1st floor, 2nd, 3rd, roof
If one story building with masonry walls, thickness of walls? height?

If a Garage

No. cars now accommodated on same lot, to be accommodated number commercial cars to be accommodated
Will automobile repairing be done other than minor repairs to cars habitually stored in the proposed building?

APPROVED:

Miscellaneous

Will work require disturbing of any tree on a public street? no
Will there be in charge of the above work a person competent to see that the State and City requirements pertaining thereto are observed? yes

First National Stores, Inc.

Signature of owner by: Ernest C. Soule

INSPECTION COPY



(1) INDUSTRIAL ZONE

APPLICATION FOR PERMIT

Class of Building or Type of Structure First Class
Portland, Maine, August 24, 1949

PERMIT ISSUED
01360
AUG 29 1949
CITY of PORTLAND

To the INSPECTOR OF BUILDINGS, PORTLAND, MAINE

ATH

The undersigned hereby applies for a permit to ~~erect~~ alter ~~repair~~ ~~erect~~ the following building ~~structure~~ ~~erect~~ in accordance with the Laws of the State of Maine, the Building Code and Zoning Ordinance of the City of Portland; plans and specifications, if any, submitted herewith and the following specifications:

Location 215-239 Read Street Within Fire Limits? no Dist. No. _____
 Owner's name and address First National Stores Inc., 217 Read Street Telephone _____
 Lessee's name and address _____ Telephone _____
 Contractor's name and address C. A. Dodge Co., 2 Erie Street, Cambridge, Mass. Telephone _____
 Architect _____ Specifications _____ Plans yes No. of sheets 1
 Proposed use of building Repair shop No. families _____
 Last use concrete Boiler room No. families _____
 Material brick & concrete No. stories 1 Heat _____ Style of roof _____ Roofing _____
 Other buildings on same lot _____
 Estimated cost \$ 3500 Fee \$ 5.00

General Description of New Work

To change existing boiler room to repair shop as per plan.

PROVISION NOT COMPLETE
2/16/51

Permit Issued with Letter

It is understood that this permit does not include installation of heating apparatus which is to be taken out separately by and in the name of the heating contractor. PERMIT TO BE ISSUED TO C. A. Dodge Co.

Details of New Work

Is any plumbing involved in this work? _____ Is any electrical work involved in this work? _____
 Height average grade to top of plate _____ Height average grade to highest point of roof _____
 Size, front _____ depth _____ No. stories _____ solid or filled land? _____ earth or rock? _____
 Material of foundation _____ Thickness, top _____ bottom _____ cellar _____
 Material of underpinning _____ Height _____ Thickness _____
 Kind of roof _____ Rise per foot _____ Roof covering _____
 No. of chimneys _____ Material of chimneys _____ of lining _____ Kind of heat _____ fuel _____
 Framing lumber—Kind _____ Dressed or full size? _____
 Corner posts _____ Sills _____ Girt or ledger board? _____ Size _____
 Girders _____ Size _____ Columns under girders _____ Size _____ Max. on centers _____
 Studs (outside walls and carrying partitions) 2x4-16" O. C. Bridging in every floor and flat roof span over 8 feet.
 Joists and rafters: 1st floor _____, 2nd _____, 3rd _____, roof _____
 On centers: 1st floor _____, 2nd _____, 3rd _____, roof _____
 Maximum span: 1st floor _____, 2nd _____, 3rd _____, roof _____
 If one story building with masonry walls, thickness of walls? _____ height? _____

If a Garage

No. cars now accommodated on same lot _____, to be accommodated _____ number commercial cars to be accommodated _____
Will automobile repairing be done other than minor repairs to cars habitually stored in the proposed building? _____

APPROVED:

with letter by AGS

Miscellaneous

Will work require disturbing of any tree on a public street? no
Will there be in charge of the above work a person competent to see that the State and City requirements pertaining thereto are observed? yes

First National Stores, Inc.
C. A. Dodge Co.

Signature of owner by: *R. M. Low*

COPY

PERMIT ISSUED
1939

NOTES

APPLICATION FOR PERMIT

CITY OF PORTLAND

Location: 175 239
Owner: J. M. [unclear]
Date of permit: 12/29/1939
Inspection closing in: 11:00 AM
Final inspection: 11:00 AM

Permit No.	175 239
Location	175 239
Owner	J. M. [unclear]
Date of permit	12/29/1939
Inspection closing in	11:00 AM
Final inspection	11:00 AM

General description of new work

To correct existing defect...

Inspection completed



(1) INDUSTRIAL ZONE

APPLICATION FOR PERMIT

Class of Building or Type of Structure _____

Portland, Maine, April 3, 1950

PERMIT ISSUED
00396
APR 4 1950
CITY OF PORTLAND

To the INSPECTOR OF BUILDINGS, PORTLAND, MAINE

The undersigned hereby applies for a permit to ~~and alter repairs~~ ~~to the~~ following building ~~to be~~ ~~erected~~ in accordance with the Laws of the State of Maine, the Building Code and Zoning Ordinance of the City of Portland, plans and specifications, if any, submitted herewith and the following specifications:

Location 215-239 Read Street Within Fire Limits? no Dist. No. _____
 Owner's name and address First National Stores, Inc., 215-239 Read Street Telephone _____
 Lessee's name and address _____ Telephone _____
 Contractor's name and address Ernest C. Soule, 75 Edwards Street Telephone 2-7301
 Architect _____ Specifications _____ Plans no No. of sheets _____
 Proposed use of building Office Section No. families _____
 Last use _____ " " _____ No. families _____
 Material _____ No. stories _____ Heat _____ Style of roof _____ Roofing _____
 Other buildings on same lot _____
 Estimated cost \$ 200. Fee \$ 2.00

General Description of New Work

To demolish non-bearing partition approximately 12' long and 8' high, first floor between two offices.

CERTIFICATE OF OCCUPANCY
REQUIREMENT IS WAIVED

It is understood that this permit does not include installation of heating apparatus which is to be taken out separately by and in the name of the heating contractor. **PERMIT TO BE ISSUED TO Ernest C. Soule**

Details of New Work

Is any plumbing involved in this work? _____ Is any electrical work involved in this work? _____
 Height average grade to top of plate _____ Height average grade to highest point of roof _____
 Size, front _____ depth _____ No. stories _____ solid or filled land? _____ earth or rock? _____
 Material of foundation _____ Thickness, top _____ bottom _____ cellar _____
 Material of underpinning _____ Height _____ Thickness _____
 Kind of roof _____ Rise per foot _____ Roof covering _____
 No. of chimneys _____ Material of chimney _____ of lining _____ Kind of heat _____ fuel _____
 Framing lumber—Kind _____ Dressed or full size? _____
 Corner posts _____ Sills _____ Girt or ledger board? _____ Size _____
 Girders _____ Size _____ Columns under girders _____ Size _____ Max. on centers _____
 Studs (on inside walls and carrying partitions) 2x4-16" O. C. Bridging in every floor and flat roof span over 8 feet.
 Joists and rafters: 1st floor _____, 2nd _____, 3rd _____, roof _____
 On centers: 1st floor _____, 2nd _____, 3rd _____, roof _____
 Maximum span: 1st floor _____, 2nd _____, 3rd _____, roof _____
 one story building with masonry walls, thickness of walls? _____ height? _____

If a Garage

No. cars now accommodated on same lot _____, to be accommodated _____ number commercial cars to be accommodated _____
 Will automobile repairing be done other than minor repairs to cars habitually stored in the proposed building? _____

APPROVED: _____

Miscellaneous

Will work require disturbing of any tree on a public street? no
 Will there be in charge of the above work a person competent to see that the State and City requirements pertaining thereto are observed? yes

First National Stores, Inc.

Signature of owner by: Ernest C. Soule

INSPECTION COPY

Permit No. 501-396

Location 25239 Grand St.

Owner Grand National Stores Inc.

Date of permit 4/1/50

Notif. closing-in

Inspn. closing-in

Final Notice

Final Inspn.

Cert. of Occupancy Issued None

NOTES

4/5/50 - No inspection made. E.L.D.

Lined area for notes and observations, mostly blank.

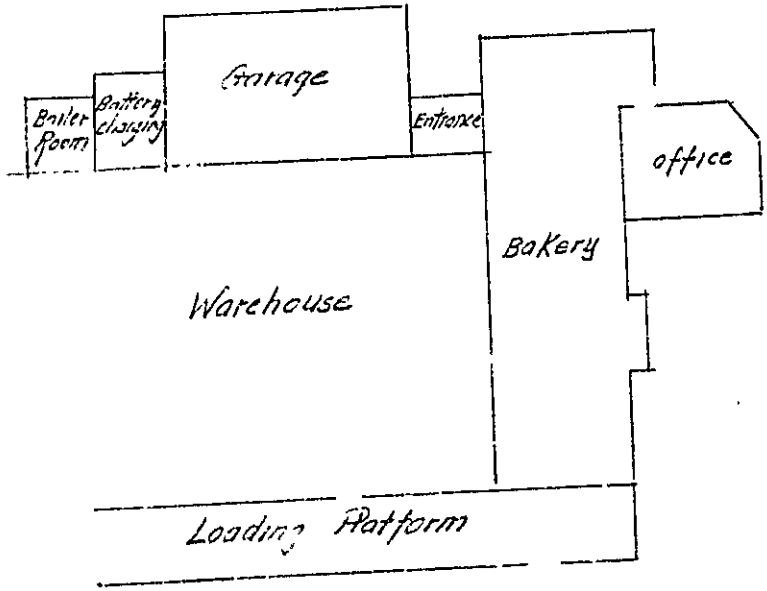

FIRST NAT'L WAREHOUSE
READ ST.

No scale

W. H. ...

AP 215-229 Read St.,

August 29, 1949

C. A. Dodge Company
2 Erie Street
Cambridge, Mass.,
First National Stores, Inc.,
217 Read Street
Portland, Maine

Subject: Permit for alterations to old boiler room to provide repair garage therein at 215-229 Read Street.

Gentlemen:

The permit for the above work is issued herewith to the C. A. Dodge Company, based on the plan filed August 24, 1949. We wish to call attention to the requirements of Section 204-f-5 of the Building Code specifying the enclosure of forges and vulcanizing and other heat generating equipment except central heating plants and unit heaters with partitions of one-hour fire resistance and with thresholds of doorways leading thereto raised at least 3" above the level of the garage floor. Apparatus for paint spraying is required to be enclosed with partitions of similar fire resistance without the requirement of the raised threshold.

If any of the above equipment is to be used in any part of the building where motor vehicles may be driven so that such separations will be required, this permit should be amended to cover the construction of such partitions.

Very truly yours,

Warren McDonald
Inspector of Buildings.

AJS/B

CC: Contonimo & McKullen
99 Chauncy Street
Boston, Mass.,



APPLICATION FOR PERMIT

Class of Building or Type of Structure Installation

Portland, Maine, August 11, 1949

PERMIT ISSUED

01261
AUG 12 1949

CITY of PORTLAND

To the INSPECTOR OF BUILDINGS, PORTLAND, MAINE

The undersigned hereby applies for a permit to ~~excavate and install~~ install the following ~~excavation~~ equipment in accordance with the Laws of the State of Maine, the Building Code and Zoning Ordinance of the City of Portland, plans and specifications, if any, submitted herewith and the following specifications:

Location 217 Read Street Within Fire Limits? no Dist. No. _____
 Owner's name and address First National Stores, Inc., 217 Read Street Telephone _____
 Lessee's name and address _____ Telephone _____
 Contractor's name and address Portland Pump Co., 275 Lincoln St., So. Portland Telephone 2-6336
 Architect _____ Specifications _____ Plans yes No. of sheets 1
 Proposed use of building _____ No. families _____
 Last use _____ No. families _____
 Material _____ No. stories _____ Heat _____ Style of roof _____ Roofing _____
 Other buildings on same lot _____
 Estimated cost \$ _____ Fee \$ 1.00

General Description of New Work

To install 2-3,000 gallon gasoline tanks. Storage to be for private use. Tanks will be 3' underground and painted with asphaltum. Tanks bear Underwriters' label. One ~~2~~ electric pump to be installed. 1 1/2" piping from tank to pump.

BEFORE Covering Tank and any Piping **APPROVAL** of FIRE DEPT. Required.

Sent to Fire Dept. 8/11/49
Rec'd from Fire Dept. 8/11/49

It is understood that this permit does not include installation of heating apparatus which is to be taken out separately by and in the name of the heating contractor. **PERMIT TO BE ISSUED TO** Portland Pump Co.

Details of New Work

Is any plumbing involved in this work? _____ Is any electrical work involved in this work? _____
 Height average grade to top of plate _____ Height average grade to highest point of roof _____
 Size, front _____ depth _____ No. stories _____ solid or filled land? _____ earth or rock? _____
 Material of foundation _____ Thickness, top _____ bottom _____ cellar _____
 Material of underpinning _____ Height _____ Thickness _____
 Kind of roof _____ Rise per foot _____ Roof covering _____
 No. of chimneys _____ Material of chimneys _____ of lining _____ Kind of heat _____ fuel _____
 Framing lumber—Kind _____ Dressed or full size? _____
 Corner posts _____ Sills _____ Girt or ledger board? _____ Size _____
 Girders _____ Size _____ Columns under girders _____ Size _____ Max. on centers _____
 Studs (outside walls and carrying partitions) 2x4-16" O. C. Bridging in every floor and flat roof span over 8 feet.
 Joists and rafters: 1st floor _____, 2nd _____, 3rd _____, roof _____
 On centers: 1st floor _____, 2nd _____, 3rd _____, roof _____
 Maximum span: 1st floor _____, 2nd _____, 3rd _____, roof _____
 If one story building with masonry walls, thickness of walls? _____ height? _____

If a Garage

No. cars now accommodated on same lot _____, to be accommodated _____ number commercial cars to be accommodated _____
Will automobile repairing be done other than minor repairs to cars habitually stored in the proposed building? _____

APPROVED:

Chas. W. [Signature]
Inspector of Buildings

Miscellaneous

Will work require disturbing of any tree on a public street? no
Will there be in charge of the above work a person competent to see that the State and City requirements pertaining thereto are observed? yes

First National Stores, Inc.
Portland Pump Co.

INSPECTION COPY

Signature of owner by: *Harry Wilson*

Permit No 49/261

Location 217 Grand St.

Owner First National Stores, Inc.

Date of permit 7-149

Notif. closing-in

Inspn. closing-in

Final Notif.

Final Insp. Fire Dept. Corp.

Certif. of Occupancy issued

NOTES

~~THIS SECTION IS RESERVED FOR THE USE OF THE INSPECTOR~~

212 Reed St.

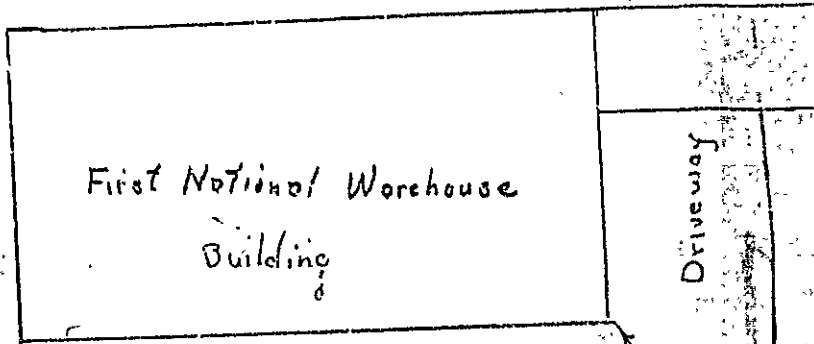

Gasoline Pump

2 - 3000 gal tanks

This work is being done in the center
 of the First National Warehouse grounds
 75' from any building and 200' from any street

RECEIVED
 AUG 11 1949
 DEPT. OF BLDG. INSP.
 CITY OF PORTLAND

Worcester Transportation Co

Memorandum from Department of Building Inspection, Portland, Maine

217 Read Street—Installation of 2-3,000 gallon gasoline tanks for First National Stores, Inc. by Portland Pump Co., installers

Before tank and piping is covered from view, installer is required to notify Fire Department Headquarters of readiness for inspection and to refrain from covering up until approved by the Fire Department.

This tank of 3,000 gallons capacity is required to be of steel or wrought iron no less in thickness than No. 7 gauge and before installation is required to be protected against corrosion, even though galvanized, by two preliminary coats of red lead and heavy coat of hot asphalt.

Pipe lines connected to underground tanks, other than tubing and except fill lines and test wells, must be provided with double swing joints arranged to permit the tank to settle without impairing the efficiency of the pipe connections.

Owner and installer will have to bear the responsibility for the structural capacity of the tank to support loads from above such as heavy steel tracks.

If tank will be so located as to be subjected to the action of tide water or "ground" water, adequate anchorage or weighting must be provided to prevent "floating" when tank is empty or nearly so.

S

CC: First National Stores, Inc.
217 Read Street

Oliver T. Hancock, Chief
of the Fire Department

(Signed) Warren McDonald
Inspector of Buildings

H.D.A. GANTEAUME
E.W. McMULLEN
2078
E. RICH

Handwritten notes:
P. 2
R. S. Riverside
7/26/49
Put in G.S. file

GANTEAUME & McMULLEN
ENGINEERS - ARCHITECTS
99 CHAUNCY STREET
BOSTON 11
TELEPHONE HANCOCK 8970

INDUSTRIAL BUILDINGS
COMMERCIAL BUILDINGS
INVESTIGATIONS
VALUATIONS
REPORTS

July 25, 1949

Department of Building Inspection
City of Portland
Maine

RECEIVED
JUL 26 1949
DEPT. OF BLD'G. INSP.
CITY OF PORTLAND

Gentlemen:

Mr. Warren McDonald

We have your letter of June 28 in connection with alterations of the First National Stores Boiler Room for use as a Repair Shop.

The application for permit will be filed by the owner.

Commenting on the other items which you list -

1. An additional exit door 2'-6" x 7'-0" will be provided in the northeast corner.
2. The old fuel bin is to be abandoned. The floor of this bin will be raised to that of the Repair Shop by filling with sand and gravel.
3. The 9" I beam lintel above the 12'-0" door will be fireproofed with 2" minimum of concrete.

Yours very truly

H C Thomas

LED/M
copy to Mr. Dexter

8/27/49 - See permit issued for this work

RECEIVED
JUL 26 1949
DEPT. OF BLD'G. INSP.
CITY OF PORTLAND

AP 215-239 Read Street-I

June 28, 1949

Ganteume & McMullen
99 Chauncey Street
Boston 11, Massachusetts

Subject: Inquiry in regard to change of use of
portion of old boiler room at rear of 215-
239 Read Street for First National Stores, Inc.

Gentlemen:

Attn: Mr. L. E. Day

Because of the great pressure of work in this office we have had to establish the practice of taking action on the applications for permits which have been filed ahead of inquiries such as yours. In order to get as prompt action as possible on this proposition, we suggest that you have filed an application for a permit for the work to which the plans which you sent may be attached for checking.

A cursory examination of the plans raises several questions concerning the proposed work. In order to meet Building Code requirements another exit from the new repair shop in either front or rear wall at the end where the old fuel bin is located seems to be indicated. This exit door is required to be at least 24" and not more than 48" wide and at least 6' 4" high.

For what purpose is the old fuel bin to be used? When the proposed work is completed the floor of the bin will be lower than that of the garage thus creating a pocket to catch any loose gasoline fumes that might be present in the garage. For this reason it is likely that some measures must be adopted to alleviate this hazard.

Since the lintel over the new 12' door opening will be called upon to support more than four feet of masonry, fireproofing the lintel for four hour fire resistance is required.

We will endeavor to give this job as quick action as possible as soon as the application for permit has been filed, but it would be well to have answers to the above questions worked out and submitted at that time.

Very truly yours,

Inspector of Buildings

KJG/g

A

GANTEAUME & McMULLEN
ENGINEERS - ARCHITECTS
99 CHAUNCY STREET
BOSTON II
TELEPHONE HANCOCK 8970

H. D. A. GANTEAUME
E. W. McMULLEN
L. 2078
A. B. RICH

INDUSTRIAL BUILDINGS
COMMERCIAL BUILDINGS
INVESTIGATIONS
VALUATIONS
REPORTS

June 8, 1949

Department of Building Inspection
Portland, Maine

Gentlemen: Mr. Warren MacDonald

We enclose two prints of our Dwg. 2078D-2, showing proposed alterations to the existing Boiler Room on the First National Stores property at Portland. It is proposed to use this area as an automobile repair shop.

May we have your approval?

Yours very truly



LED/M

*8/29/49 - Plans superseded
by plans filed with applica-
tion for permit 8/26/49
and hence were destroyed*

RECEIVED
JUN 10 1949
DEPT. OF BLD'G. INSP.
CITY OF PORTLAND



(1) INDUSTRIAL ZONE

APPLICATION FOR PERMIT

PERMIT ISSUED

01075
JUL 15 1949

CITY of PORTLAND

Class of Building or Type of Structure 1st

Portland, Maine, July 14, 1949

ATH

To the INSPECTOR OF BUILDINGS, PORTLAND, MAINE

The undersigned hereby applies for a permit to erect alter repair demolish install the following building structure equipment in accordance with the Laws of the State of Maine, the Building Code and Zoning Ordinance of the City of Portland, plans and specifications, if any, submitted herewith and the following specifications:

Location 215-227 Reed Street Within Fire Limits? no Dist. No.
Owner's name and address First National Stores, Inc., Reed Street Telephone
Lessee's name and address
Contractor's name and address C. A. Dodge Co., 2 Erie St., Cambridge, Mass. Telephone
Architect Specifications Plans yes No. of sheets 1
Proposed use of building Warehouse No. families
Last use No. families
Material brick No. stories Heat Style of roof Roofing
Other buildings on same lot
Estimated cost \$ 1500. Fee \$ 5.00

General Description of New Work

To erect 8" concrete block foundation wall under proposed cigar cigarette and candy room as per plan.
To partition off office space in basement (old building 3rd class construction) 2x4 studs, 16" O.C., sheetrock both sides

It is understood that this permit does not include installation of heating apparatus which is to be taken out separately by and in the name of the heating contractor. PERMIT TO BE ISSUED TO C.A. Dodge Co., Cambridge

Details of New Work

Is any plumbing involved in this work? Is any electrical work involved in this work?
Height average grade to top of plate Height average grade to highest point of roof
Size, front depth No. stories solid or filled land? earth or rock?
Material of foundation Thickness, top bottom cellar
Material of underpinning Height Thickness
Kind of roof Rise per foot Roof covering
No. of chimneys Material of chimneys of lining Kind of heat fuel
Framing lumber-Kind Dressed or full size?
Corner posts Sills Girt or ledger board? Size
Girders Size Columns under girders Size Max. on centers
Studs (outside walls and carrying partitions) 2x4-16" O. C. Bridging in every floor and flat roof span over 8 feet.
Joists and rafters: 1st floor, 2nd, 3rd, roof
On centers: 1st floor, 2nd, 3rd, roof
Maximum span: 1st floor, 2nd, 3rd, roof
If one story building with masonry walls, thickness of walls? height?

If a Garage

No. cars now accommodated on same lot, to be accommodated number commercial cars to be accommodated
Will automobile repairing be done other than minor repairs to cars habitually stored in the proposed building?

Miscellaneous

Will work require disturbing of any tree on a public street? no
Will there be in charge of the above work a person competent to see that the State and City requirements pertaining thereto are observed? yes

APPROVED

OK-7/15/49 - ags

First National Stores, Inc.
C. A. Dodge Co.

Signature of owner by:

William J Shaw

INSPECTION COPY

K

Permit No. 49/1075

Location 215-239 Read St.

Owner First National Stevedores, Inc.

Date of permit 7/15/49

Notif. closing-in _____

Inspn. closing-in _____

Final Notif. _____

Final Inspn. _____

Cert. of Occupancy issued _____

NOTES

INSPECTION NOT COMPLETED



APPLICATION FOR AMENDMENT TO PERMIT

Amendment No. 1

Portland, Maine, August 24, 1949

PERMIT ISSUED

AUG 24 1949

CITY of PORTLAND

To the INSPECTOR OF BUILDINGS, PORTLAND, MAINE

The undersigned hereby applies for amendment to Permit No. 129/1975 pertaining to the building or structure comprised in the original application in accordance with the Laws of the State of Maine, the Building Code and Zoning Ordinance of the City of Portland, plans and specifications, if any, submitted herewith, and the following specifications:

Location 215-239 Read Street Within Fire Limits? no Dist. No.
Owner's name and address First National Stores, Inc., 215-239 Read Street Telephone
Lessee's name and address Telephone
Contractor's name and address C. A. Dodge Co., 2 Erie St., Cambridge, Mass. Telephone
Architect. Plans filed. year No. of sheets.
Proposed use of building Warehouse (old building) No. families
Last use " No. families
Increased cost of work. 1800 Additional fee. 25

Description of Proposed Work

To partition off space on first floor of blu building for use as an egg candling room 2x4 studs, 16" on centers, covered with plywood 4' high and sheetrock above as per plan.

Permit to be issued to C. A. Dodge Co.

Details of New Work

Is any plumbing involved in this work? Is any electrical work involved in this work?
Height average grade to top of plate Height average grade to highest point of roof
Size, front depth No. stories solid or filled land? earth or rock?
Material of foundation Thickness, top bottom cellar
Material of underpinning Height Thickness
Kind of roof Rise per foot Roof covering
No. of chimneys Material of chimneys of lining
Framing lumber—Kind Dressed or full size?
Corner posts Sills Girt or ledger board? Size
Girders Size Columns under girders Size Max. on centers
Studs (outside walls and carrying partitions) 2x4-16" O. C. Bridging in every floor and flat roof span over 8 feet.
Joists and rafters: 1st floor, 2nd, 3rd, roof
On centers: 1st floor, 2nd, 3rd, roof
Maximum span: 1st floor, 2nd, 3rd, roof

Approved:

First National Stores, Inc.
C. A. Dodge Co.

Signature of Owner by: [Signature]

Approved: [Signature]

INSPECTION COPY

Inspector of Buildings



APPLICATION FOR PERMIT

Class of Building or Type of Structure _____ Structure _____
Portland, Maine, June 14, 1919

PERMIT ISSUED
AUG 25 1919
CITY of PORTLAND

To the INSPECTOR OF BUILDINGS, PORTLAND, MAINE

The undersigned hereby applies for a permit to erect ~~alter or demolish~~ ^{building structure equipment} in accordance with the Laws of the State of Maine, the Building Code and Zoning Ordinance of the City of Portland, plans and specifications, if any, submitted herewith and the following specifications:

Location 215-239 Read Street Within Fire Limits? no Dist. No. _____
 Owner's name and address First National Stores, Inc., 215 Read Street Telephone _____
 Lessee's name and address _____ Telephone _____
 Contractor's name and address _____ Telephone _____
 Architect Ganteaume & McMullen Specifications _____ Plans yes No. of sheets 3
99 Chauncy St., Boston, Mass.
 Proposed use of building _____ No. families _____
 Last use _____ No. families _____
 Material _____ No. stories _____ Heat _____ Style of roof _____ Roofing _____
 Other buildings on same lot _____
 Estimated cost \$ 15,000. Fee \$ 15.00

General Description of New Work

To construct water tank and tower with foundations as per plans.

It is understood that this permit does not include inallation of heating apparatus which is to be taken out separately by and in the name of the heating contractor. **PERMIT TO BE ISSUED TO**

Details of New Work

Is any plumbing involved in this work? _____ Is any electrical work involved in this work? _____
 Height average grade to top of plate _____ Height average grade to highest point of roof _____
 Size, front _____ depth _____ No. stories _____ solid or filled land? _____ earth or rock? _____
 Material of foundation _____ Thickness, top _____ bottom _____ cellar _____
 Material of underpinning _____ Height _____ Thickness _____
 Kind of roof _____ Rise per foot _____ Roof covering _____
 No. of chimneys _____ Material of chimneys _____ of lining _____ Kind of heat _____ fuel _____
 Framing lumber—Kind _____ Dressed or full size? _____
 Corner posts _____ Sills _____ Girt or ledger board? _____ Size _____
 Girders _____ Size _____ Columns under girders _____ Size _____ Max. in centers _____
 Studs (outside walls and carrying partitions) 2x4-16" O. C. Bridging in every floor and flat roof span over 8 feet.
 Joists and rafters: 1st floor _____, 2nd _____, 3rd _____, roof _____
 On centers: 1st floor _____, 2nd _____, 3rd _____, roof _____
 Maximum span: 1st floor _____, 2nd _____, 3rd _____, roof _____
 If one story building with masonry walls, thickness of walls? _____ height? _____

If a Garage

No. cars now accommodated on same lot _____, to be accommodated _____ number commercial cars to be accommodated _____
 Will automobile repairing be done other than minor repairs to cars habitually stored in the proposed building? _____

APPROVED:

Miscellaneous

Will work require disturbing of any tree on a public street? no
 Will there be in charge of the above work a person competent to see that the State and City requirements pertaining thereto are observed? yes

 First National Stores, Inc.

Signature of owner By: _____

John F. Carter

INSPECTION COPY

Permit No. 49/ 1332
Location 215-239 Read St.
Owner First National Stores, Inc
Date of permit 8/25/49
Notif. closing-in _____
Inspn. closing-in _____
Final Notif. _____
Final Inspn. 8/25/49, 226.
Cert. of Occupancy issued None

NOTES

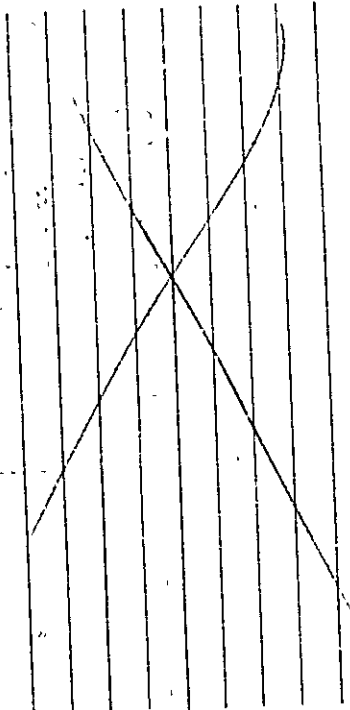

CHICAGO BRIDGE & IRON COMPANY

201 DEVONSHIRE STREET

BOSTON 10, MASSACHUSETTS

August 23, 1949

Mr. Warren McDonald
Inspector of Buildings
City of Portland
Portland, Maine

RECEIVED

AUG 25 1949

DEPT. OF BLD'G. INS'P.
CITY OF PORTLAND

Your File AP 215-239 Read Street-I.
Elevated Water Tank
100,000 Gallons - 86' 5" To Bottom
First National Stores, Inc.
Portland, Maine
Our Contract 5-2109

Dear Sir:

Enclosed are our drawings 5-2109, sheet 1, and 9M44 showing the above elevated tank and the welding details. The design on this tank has been prepared in accordance with the specifications of the National Board of Fire Underwriters. As the allowable stresses in this specification comply with the Building Code of the City of Portland, the certification form received with your letter of July 28th has been signed and is attached.

Also enclosed are a colored photograph showing the general appearance of the tank, a table with the principle dimensions and a sheet showing the details of the connection of the columns to the tank. The struts are structural channels assembled in the shape of a "T". The tank was assembled completely by welding. The design based on the wind load requirement of 30 pounds per square foot on a vertical plane surface and 18 pounds per square foot on the vertical projection of a cylindrical surface is as required by section 303 of the National Board of Fire Underwriters specification.

This standard design has not been revised to include special provisions for earth quake shock as this is generally not considered necessary in the New England area.

The welders used on the tank and tower were qualified according to the American Welding Society requirements in the past year. These welders and the other members of the erection crew used on this tank are our regular employees who have had wide experience in the field erection of elevated tanks. Our shop welders are qualified to meet the requirements of the American Welding Society.

The tank for the First National Stores, Inc., at Portland, Maine, was constructed under the supervision of Ganteaume & McMullen, Engineers & Architects, of Boston, Massachusetts.

The structure is our standard design for the requirements of the National Board of Fire Underwriters or the Associated Factory Mutual Fire Insurance Companies. The specifications of these organizations require a design which includes a greater factor of safety than is generally required by other specifications for steel construction.

Very truly yours,

CHICAGO BRIDGE & IRON COMPANY

J. E. Reveille
J. E. Reveille, Contracting Engineer

JER:cm

cc: Mr. J.F. Dexter

cc: First National Stores, Inc.
Ganteaume & McMullen, Engrs.

AP 215-239 Read Street-I
(Water tank and tower)

Nov. 28, 1949

Chicago Bridge & Iron Company
Greenville
Pennsylvania

Subject: Water tank and tower furnished and erected
by your company for First National Stores, Inc.
at 215-239 Read Street in Portland

Gentlemen:

Through some oversight this tower and water tank was erected some time ago without a permit therefor having been secured, and I am told that the actual erection was done by your crew or at least supervised by your superintendent. We are not trying to make any point of the work having been done without a permit, but we are trying to get the matter cleared up with the cooperation of the owners and their engineers so that the belated building permit may be issued with full knowledge that the Building Code has been complied with and our records show clearly what has been constructed under the permit.

The owners have made belated application for the permit and have furnished the detailed foundation plans and your contract drawing number 5-2109 sheet 1.

It appears that the tower consists of four large diameter pipe columns, each in three sections, braced by struts on all four sides just below the two splice points in each column and with two diagonal tension rods on each of the four sides and in each section. Probably there are other detailed plans for I cannot discover the shape of the struts or how the tank is supported on the top of the tower. Will you furnish these details, and while we are not interested in the detailed connections, please state whether these connections are bolted, riveted or welded. While our Building Code at present has no requirements to design against earthquake shock, as a result of a fairly serious shock in this area several years ago, some of our high buildings have been so designed. Will you tell me whether or not the tower has been so designed.

Our Building Code requires that the designer of such a structure shall attach to the plan his signed statement of design. I am enclosing a blank statement. Will you be kind enough to have your designer fill in and sign this statement? If you send any further plans, please attach the signed statement to the plans. If not, please send the blank that we may attach it to the sheets we have.

It appears likely that there may be considerable welding in the tank itself and also in the tower, done in both field and shop. Welders operating in this city are required to have first produced to this department certification that they have been qualified under the procedure of the American Welding Society. Perhaps you used local welders who were certified. If local welders were used, will you be good enough to indicate, if your record shows, who they were. If welders from elsewhere were used, please indicate in a letter to me that you have the assurance that the welders had been qualified under the American Welding Society procedure within a year before the time the welding was done.

As to any welding that may have been done in the shop please furnish in writing a certification by your company as manufacturer to the effect that all of the welding was designed and that all of the shop welding was performed according to the procedure and by welders properly qualified as set forth in the Code and qualification procedure established by the American Welding Society.

Very truly yours,

WEGD/G

CC: Mr. J. F. Dexter, First Nat'l Stores, Inc.
5 Middlesex Avenue, Somerville 45, Mass.
Ganteaume & McFullen, 99 Chauncy St.,
Boston, Mass.

Inspector of Buildings

Enclosure: Blank statement of design

Ganteaume & McMullen _____ 2

July 28, 1949

Gentlemen:

It appears that Chicago Bridge & Iron Company are responsible for the design and were responsible for the erection of the tank and tower, and their superintendent should have covered himself by securing a permit before he started. For that reason I am writing the Bridge Company direct to get this additional data.

Very truly yours,

Inspector of Buildings

034



FILL IN AND SIGN WITH INK

APPLICATION FOR PERMIT FOR HEATING, COOKING OR POWER EQUIPMENT

Portland, Maine, June 3, 1949

PERMIT ISSUED JUN 10 1949 CITY of PORTLAND

To the INSPECTOR OF BUILDINGS, PORTLAND, MAINE

The undersigned hereby applies for a permit to install the following heating, cooking or power equipment in accordance with the Laws of Maine, the Building Code of the City of Portland, and the following specifications:

Location 215-239 Read Street Use of Building Bakery No. Stories New Building "Existing"
Name and address of owner of appliance First National Stores, Inc.
Installer's name and address Frank S. Larkin, 262 Summit St., Boston Telephone 212-538-3511 MASS.

General Description of Work

To install gas-fired doughnut machine INSPECTION NOT COMPLETED 6/10/51

IF HEATER, OR POWER BOILER

Location of appliance or source of heat Type of floor beneath appliance
If wood, how protected? Kind of fuel
Minimum distance to wood or combustible material, from top of appliance or casing top of furnace
From top of smoke pipe From front of appliance From sides or back of appliance
Size of chimney flue Other connections to same flue
If gas fired, how vented? Rated maximum demand per hour

IF OIL BURNER

Name and type of burner Labelled by underwriter's laboratories?
Will operator be always in attendance? Does oil supply line feed from top or bottom of tank?
Type of floor beneath burner
Location of oil storage Number and capacity of tanks
If two 275-gallon tanks, will three-way valve be provided?
Will all tanks be more than five feet from any flame? How many tanks fire proofed?
Total capacity of any existing storage tanks for furnace burners

IF COOKING APPLIANCE

Location of appliance doughnut room Kind of fuel gas Type of floor beneath appliance brick tile over concrete
If wood, how protected?
Minimum distance to wood or combustible material from top of appliance concrete
From front of appliance concrete From sides and back concrete From top of smoke pipe concrete
Size of chimney flue Other connections to same flue none
Is hood to be provided? incorporated in appliance If so, how vented?
If gas fired, how vented? metal stack - See construction plans Rated maximum demand per hour 300,000 BTU

MISCELLANEOUS EQUIPMENT OR SPECIAL INFORMATION

[Empty lines for miscellaneous information]

Amount of fee enclosed? 2.00 (\$2.00 for one heater, etc., 50 cents additional for each additional heater, etc., in same building at same time.)

APPROVED: [Empty box for approval]

Will there be in charge of the above work a person competent to see that the State and City requirements pertaining thereto are observed? yes

INSPECTION COPY

Signature of Installer Frank S. Larkin by Leroy W. Hasey Jr

Permit No. 49/830

Location 215-239 Read St.

Owner Pisak National Stores Inc.

Date of permit 6/10/49

Approved _____

NOTES

INSPECTION NOT COMPLETED

(1) INDUSTRIAL ZONE



APPLICATION FOR PERMIT

Class of Building or Type of Structure Installation

Portland, Maine, February 23, 1949

PERMIT ISSUED

00271
MAR 12 1949

CITY of PORTLAND

To the INSPECTOR OF BUILDINGS, PORTLAND, MAINE

The undersigned hereby applies for a permit to ~~erect or repair~~ install the following building ~~and~~ equipment in accordance with the Laws of the State of Maine, the Building Code and Zoning Ordinance of the City of Portland, plans and specifications, if any, submitted herewith and the following specifications:

Location 215-239 Read Street Within Fire Limits? no Dist. No. _____

Owner's name and address First National Stores, Inc. Telephone _____

Lessee's name and address _____ Telephone _____

Contractor's name and address York Corp., 31 St. James Ave., Boston, Mass Telephone _____

Architect _____ Specifications _____ Plans See Plans No. of sheets 15

Proposed use of building Warehouse, bakery and office No. families _____

Last use _____ No. families _____

Material masonry No. stories 1 Heat _____ Style of roof _____ Roofing _____

Other buildings on same lot _____

Estimated cost \$ _____ Fee \$ 1.00

General Description of New Work

To install ~~exterior~~ refrigeration equipment in warehouse. Ammonia and brine refrigerant.
To install refrigeration equipment in bakery. Freon refrigerant. All as per plans.

Exp. to Fire Dept: 3/8/49
Rec'd from Fire Dept: 3/9/49

It is understood that this permit does not include installation of heating apparatus which is to be taken out separately and in the name of the heating contractor. PERMIT TO BE ISSUED TO John Morgan, York Corp. c/o Ganteaume & McKullen Field office, 215-239 Read St.

Details of New Work

Is any plumbing involved in this work? _____ Is any electrical work involved in this work? _____

Height average grade to top of plate _____ Height average grade to highest point of roof _____

Size, front _____ depth _____ No. stories _____ solid or filled land? _____ earth or rock? _____

Material of foundation _____ Thickness, top _____ bottom _____ cellar _____

Material of underpinning _____ Height _____ Thickness _____

Kind of roof _____ Rise per foot _____ Roof covering _____

No. of chimneys _____ Material of chimneys _____ of lining _____ Kind of heat _____ fuel _____

Framing lumber—Kind _____ Dressed or full size? _____

Corner posts _____ Sills _____ G'rt or ledger board? _____ Size _____

Girders _____ Size _____ Columns under girders _____ Size _____ Max. on centers _____

Studs (outside walls and carrying partitions) 2x4-16" O. C. Bridging in every floor and flat roof span over 8 feet.

Joists and rafters: 1st floor _____, 2nd _____, 3rd _____, roof _____

On centers: 1st floor _____, 2nd _____, 3rd _____, roof _____

Maximum span: 1st floor _____, 2nd _____, 3rd _____, roof _____

If one story building with masonry walls, thickness of walls? _____ height? _____

If a Garage

No. cars now accommodated on same lot _____, to be accommodated _____ number commercial cars to be accommodated _____

Will automobile repairing be done other than minor repairs to cars habitually stored in the proposed building? _____

APPROVED:

John Morgan

Miscellaneous

Will work require disturbing of any tree on a public street? no

Will there be in charge of the above work a person competent to see that the State and City requirements pertaining thereto are observed? yes

First National Stores, Inc.
York Corp.

Signature of owner by:

John Morgan York Engineer

INSPECTION COPY

Permit No. 9/271

Location 2nd St

Owner W. H. Adams, Inc.

Date of permit 31 12/49

Notif. closing-in _____

Inspn. closing-in _____

Final Notif. _____

Final Inspn. Fire Dept.

Cert. of Occupancy issued _____

NOTES

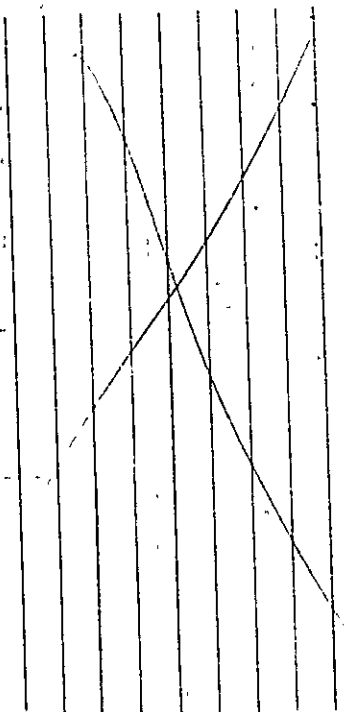

March 14, 1950

Mr. MacMullen of the firm of Ganteaume & MacMullen told me over the phone today that in designing floors for First National Stores' warehouses the floors of the higher warehouses have always been supported directly on the ground. In such cases their only occasion for determining live load on floor was in the case of surge on retaining walls, where they usually use 400 to 500 pounds per square foot live load.

Only on the smaller heights the warehouses, say 12', have they used suspended floor construction and in such cases they have used 250 pounds per square foot live load.

If a suspended floor were used with a headroom of 14 to 15' he thinks 350 to 400 pounds per square foot live load would be ample.

Warren McDonald



(I) INDUSTRIAL ZONE

APPLICATION FOR PERMIT

Class of Building or Type of Structure Installation

Portland, Maine, December 30, 1948

PERMIT ISSUED 00024 JAN 6 1949 CITY of PORTLAND

To the INSPECTOR OF BUILDINGS, PORTLAND, MAINE

The undersigned hereby applies for a permit to ~~erect~~ install the following ~~building~~ ~~structure~~ ~~equipment~~ in accordance with the Laws of the State of Maine, the Building Code and Zoning Ordinances of the City of Portland, plans and specifications, if any, submitted herewith and the following specifications:

Location 215-239 Read Street Within Fire Limits? no Dist. No. Owner's name and address First National Stores, Inc., 5 Middlesex Avenue Somerville, MASS. Telephone Lessee's name and address Contractor's name and address Pettingill Ross Co., 57 Cross Street Telephone 2-6223 Architect Specifications Plans No. of sheets Proposed use of building Warehouse, Bakery & office No. families Last use No. families Material No. stories 1-3 Heat Style of roof Roofing Other buildings on same lot Estimated cost \$ Fee \$ 1.00

General Description of New Work

To install mechanical ventilation and air-conditioning system as shown on general construction ~~plans~~ plans.

INSPECTION NOT COMPLETED 8/6/57

Health Notices to Officer and thus

It is understood that this permit does not include installation of heating apparatus which is to be taken out separately by and in the name of the heating contractor. PERMIT TO BE ISSUED TO Pettingill Ross Co.

Permit Issued with Letter

Details of New Work

Is any plumbing involved in this work? Is any electrical work involved in this work? Height average grade to top of plate Height average grade to highest point of roof Size, front depth No. stories solid or filled land? earth or rock? Material of foundation Thickness, top bottom cellar Material of underpinning Height Thickness Kind of roof Rise per foot Roof covering No. of chimneys Material of chimneys of lining Kind of heat fuel Framing kind Dressed or full size? Corner posts Sills Girt or ledger board? Size Girders Size Columns under girders Size Max. on centers Studs (outside walls and carrying partitions) 2x4-16" O. C. Bridging in every floor and flat roof span over 8 feet. Joists and rafters: 1st floor, 2nd, 3rd, roof On centers: 1st floor, 2nd, 3rd, roof Maximum span: 1st floor, 2nd, 3rd, roof If one story building with masonry walls, thickness of walls? height?

If a Garage

No. cars now accommodated on same lot, to be accommodated number commercial cars to be accommodated Will automobile repairing be done other than minor repairs to cars habitually stored in the proposed building?

APPROVED:

Signature of inspector: [Signature]

Miscellaneous

Will work require disturbing of any tree on a public street? no Will there be in charge of the above work a person competent to see that the State and City requirements pertaining thereto are observed? yes

First National Stores, Inc. Pettingill Ross Co.

Signature of owner by: Ernest H. Pettingill

NOTES

SECTION FOR PERMIT

Permit No. 49/211
 License No. 3600
 Owner W. J. McDaniel, Sr.
 Date of permit 11/16/49
 Notif. closing-in 11/16/49
 Inspn. closing-in 11/16/49
 Final Notif. 11/16/49
 Final Inspn. 11/16/49
 Cert. of Occupancy Issued

INSPECTION NOT COMPLETED

A. P. 215-239 Read Street

January 5, 1949

Pettingill Ross Company
57 Cross Street
Portland, Maine

Subject: Permit for mechanical ventilation
in buildings under construction at 215-
239 Read Street.

Gleghoin Company
121 Arlington Street
Boston 16, Mass.

Gentlemen:

The permit for the above work is issued herewith to Pettingill Ross Company, who made application for the permit, subject to the following:

1. This permit is intended to cover the installation of the various systems of mechanical ventilation to be provided throughout the different sections of the plant. Insofar as we have been able to determine from the plans these consist of two systems in the Office Building, seven in the Warehouse and eleven in the Bakery. Since the air conditioning units to be installed in the Bakery and Office Building are evidently going to be used in connection with the heating plant, for installation of which a permit has already been issued, we are considering that the installation of such equipment is covered by the heating permit.

2. This permit is issued on the basis that all details of the installation, including thickness of metal of duct work, linings of ducts, etc., are to comply in all respects with the Standards of the National Board of Fire Underwriters for the Installation of Air Conditioning, Warm Air Heating, Air Cooling and Ventilating Systems as recommended by the National Fire Protection Association, (Pamphlet No. 90). This pamphlet has been adopted by the Municipal Officers in the Appendix of the Building Code as the standard under which all such systems shall be designed and installed.

Very truly yours,

Inspector of Buildings.

ATS/S

CO First Nat Bank, Inc.,

Centocamo & McFadden,

Thomas O'Connor & Co., Inc., (Read Street, Portland)
(Main Street, Cambridge)



FILL IN AND SIGN WITH INK

APPLICATION FOR PERMIT FOR HEATING, COOKING OR POWER EQUIPMENT

Portland, Maine, December 29, 1948

PERMIT ISSUED 02394 DEC 30 1948 CITY OF PORTLAND

To the INSPECTOR OF BUILDINGS, PORTLAND, MAINE

The undersigned hereby applies for a permit to install the following heating, cooking or power equipment in accordance with the Laws of Maine, the Building Code of the City of Portland, and the following specifications:

Location 215-239 Read Street Use of Building Bakery No. Stories 3 New Building
Name and address of owner of appliance First National Stores, Inc., 215-239 Read Street
Installer's name and address Baker Perkins, Inc., 250 Park Avenue, New York, New York Telephone

General Description of Work

To install an automatic Baker Perkins Bread Oven 75' long 12' wide.

IF HEATER, OR POWER BOILER

Location of appliance or source of heat Type of floor beneath appliance
If wood, how protected? Kind of fuel
Minimum distance to wood or combustible material, from top of appliance or casing top of furnace
From top of smoke pipe From front of appliance From sides or back of appliance
Size of chimney flue Other connections to same flue
If gas fired, how vented? Rated maximum demand per hour

RECEIVED 1948 DEPT. OF STREETS AND CITY OF PORTLAND

IF OIL BURNER

Name and type of burner Baker Perkins light oil burners Permit Issued with Letter
Will operator be always in attendance? no Does oil supply line feed from top or bottom of tank? top
Type of floor beneath burner concrete
Location of oil storage Underground in yard Number and capacity of tanks 1 - 15000 gals.
If two 275-gallon tanks, will three-way valve be provided?
Will all tanks be more than five feet from any flame? yes How many tanks fire proofed? underground.
Total capacity of any existing storage tanks for furnace burners 2 - 15000 - 10000' away underground.

IF COOKING APPLIANCE

Location of appliance 2nd floor Kind of fuel oil Type of floor beneath appliance concrete
If wood, how protected?
Minimum distance to wood or combustible material from top of appliance
From front of appliance From sides and back From top of smokepipe
Size of chimney flue 3-10" stack Other connections to same flue none
Is hood to be provided? yes If so, how vented? to atmosphere by exhaust fan
If gas fired, how vented? direct atmosphere by stack Rated maximum demand per hour 3200 cu. ft.

MISCELLANEOUS EQUIPMENT OR SPECIAL INFORMATION

Standby gas burners, Baker Perkins suction type burner which is underwriter approved, working on the "on and off" principle. It will have a maximum demand of 3200 cubic feet per hour.

Permit Issued with Letter

Amount of fee enclosed? 3.00 (\$1.00 for one heater, etc., 50 cents additional for each additional heater, etc., in same building at same time.)

APPROVED:

Signature lines for approval

Will there be in charge of the above work a person competent to see that the State and City requirements pertaining thereto are observed? yes

Signature of Installer

Carl H. Peterson Supt. of Erectors

INSPECTION COPY

Permit No. 48/2394
Location 215-239 7th St
Owner First National Stores, Inc.
Date of permit 12/30/48
Approved _____

NOTES

INSPECTED AND
COMPLETED

AP 215-239 Road Street
(Bake oven and oil
burning equipment at
First National Bakery)

December 30, 1948

Baker Perkins, Inc.
Attn: C. H. Fletscher
Superintendent of Erection
Saginaw, Michigan

Subject: Building permit for installation of
automatic bread oven and oil burning equip-
ment in connection therewith; also "standby"
gas burners for the same oven for First Nation-
al Stores, Inc. at 215-239 Road Street in
Portland, Maine

Gentlemen:

The permit for the above installation is sent
to your company at the job, 215-
239 Road Street, c/o Thomas O'Connor Company, general contractors with the
thought that you would want it that way rather than sending it out to Saginaw,
the permit being issued subject to the following:

It is understood that the firing chambers of the oven are to be con-
nected to the three outside stacks which the owner is providing of no less than
3/16" metal.

We are not familiar with the "standby" gas burner arrangement, but pre-
sume these would be automatic also when in use. It is assumed that all three
gas burners are to be equipped that should the low flame or pilot light of any
burner be extinguished, the gas supply to that particular burner will be shut
off automatically, thus to prevent the flow of gas entering a stack where there
may be heat enough to ignite and explode it. That is a provision of our build-
ing Code if such a gas burner, automatically regulated, is to be connected to
any flue to which any other fire-actuated appliance is connected.

Very truly yours,

WHD/G

Inspector of Buildings

CC with building permit to the job

CC: Cantavano & Mcullen
99 Chauncy Street
Boston, Massachusetts

Thomas O'Connor Company, Inc.
215-239 Road Street



BAKER PERKINS INC. SAGINAW MICHIGAN

December 27, 1948

Inspector of Buildings
Department of Building Inspection
Portland, Maine.

SUBJECT: First National Stores, Portland, Maine

Dear Sir:

Enclosed herewith are two applications for permission to install one automatic Baker Perkins Bread Oven, 75' long and 12' wide. This oven will be regularly an oil fired oven. However, we are also having a standby set of gas burners; therefore, under the heading of "Miscellaneous Equipment" we are giving a brief description of the gas burner.

We would like to start erection of our equipment in this bakery the first week in January, and therefore would appreciate your prompt attention to this permit.

Enclosed also is our check for \$3.00 covering the three meters on this oven.

Yours very truly,

BAKER PERKINS INC.

C. H. Pletscher

C. H. Pletscher,
Supt. of Erection

CHP:PF



RECEIVED

DEPT. OF BUILDING
CITY OF PORTLAND

BP
(215-239 Road Street)

October 29, 1948

Baker Perkins, Inc.
Att: Mr. S. H. Brewer
250 Park Avenue
New York, New York

Installation of baking oven and any other
actuated equipment for First National Stores,
in the bakery under construction at 215-239
Road Street in Portland

Gentlemen:

Replying to Mr. Brewer's inquiry of October 25 as to the type of installation permits needed for your equipment, building permits are required only for the fire-actuated equipment. Certainly the baking oven is of that type but I am not sure whether or not the other equipment named may be fire-actuated.

Permits for such installations as the baking oven must be applied for by and are issuable only to the actual installer. While usually such a permit is applied for across the counter and information filled in by our permit clerk, with the idea that it may suit your convenience, we are enclosing application forms represented by our file copy and inspection copy on which you may make out your own application. If there are other fire-actuated appliances besides the baking oven, they may be entered on the same form but please distinguish which clearance figures and other descriptions apply to which appliance. The fee for one appliance, regardless of size, is two dollars and for each additional separate appliance fifty cents.

It is my impression that the baking oven is to be oil-fired and that the owner is providing a metal stack for the firing chambers. The true situation should be indicated on the application. I take it from your letter that the oil burners carry the label of the Underwriters Laboratories indicating that they have all of the safety features required for a burner where an attendant will not always be present. It is my impression also that the owner is installing the oil tank outside under ground, but the true situation should also be indicated in that case.

It is presumed that your forces are to install the entire ensemble of the ovens including the oil burning units. If some other party were to take the responsibility for installing the oil burners, then that party should file application for separate permits for the oil burners.

Please fill in and return both application forms, having signed them and with them the check for the proper fee, made payable to the City of Portland. When the building permit is issued, the applicant's copy of the application will be mailed with it. Please advise whether we should send the permit card to the job on Road Street or to you in New York.

Very truly yours,

WMB/C

Inspector of Buildings

P. S. Mechanical refrigeration, other than the portable plug-in type requires separate permits also, issuable only to the installer. If your equipment should involve anything of this character, it should not be entered on these forms. Please advise us and we will explain about that.

Enclosure: Two application blanks for building permit



BAKER PERKINS INC. 250 PARK AVE. NEW YORK

October 25, 1948

Mr. Warren McDonald, Inspector of Buildings
Department of Building Inspection
Portland, Maine

Dear Mr. McDonald:

Subject - FIRST NATIONAL STORES - PORTLAND, MAINE

We have been advised by Ganteaume & McMullen that you require the installers of equipment in the new First National Stores bakery to obtain installation permits for their equipment prior to its installation.

We are supplying the flour handling and storage system, the mixing machines, dough scaling machines, dry and wet proofing equipment, 75' x 12' baking oven, bread cooler with conveying system and the wrapping machines for this bakery. As a rule the installation of our equipment is included as a part of the building permit but in this building we are advised that it was not included and we request that you advise us the type of information you require to obtain said permit.

The heating units on our baking oven are all approved by the Underwriter's Laboratories, all motors are by nationally known manufacturers, and all of our equipment is manufactured in accordance with the standards of the American Society of Bakery Engineers, but if your office requires any special information we would like to be advised regarding same in order that we may submit the desired information with the request for permit.

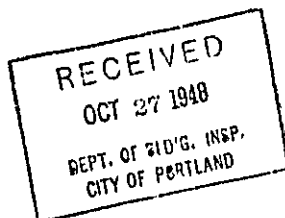

Yours very truly,
BAKER PERKINS INC.

By S. M. Brewer
S. M. Brewer

SMB:JAN

cc - Mr. R. W. McKenzie

BP 48/1184

November 18, 1948

Cloghorm Company
121 Arlington St.,
Boston, 16, Mass.,

Subject: Permit for ventilation system in
their First National Stores, Warehouse,
etc., at 215-239 Read Street in Portland.

Gentlemen;

With reference to your letter of June 25th and mine of July 6th in
reply, we have received applications for installation of the steel boilers
and system and for the oil burning equipment for the boilers, and have issued
these permits. Apparently, however, we have not received any application
for the permit to cover installation of the various mechanical ventilation
systems.

Ventilation plans were received with your first letter, but our
inspector reports that a local concern, Pottingill-Ross, are actually install-
ing these ventilation systems or a part of them. It is not clear whether
Pottingill-Ross is the actual installer or whether the responsibility for the
ventilation systems is to be taken by your Company.

Will you be good enough to look into the matter and get the appli-
cations filed here as soon as possible by the party who is actually in charge
of the installation work?

Very truly yours,

Inspector of Buildings.

WMOB/S

CG Pottingill-Ross 7-6223
57 Cross Street

Gentenuze & McMullen
99 Chauncey Street
Boston, Mass.,

Supt. Norman, First National Job
215-239 Read Street.

AP 215-239 Read Street-1

July 6, 1948

Oleghorn Company
121 Arlington Street
Boston 16, Mass.

Subject: Ventilation, heating and air conditioning for First National Stores warehouse, bakery etc. at 215-239 Read Street

Gentlemen:

Replying to your letter of June 25 on the above subject, it is necessary that your agent apply for the building permit for this installation, in person, giving the information to our permit clerk across the counter.

Examination of the plans has not been made to see whether or not there is more than one system involved either of heating or ventilating or air-conditioning. If there are separate systems for various purposes and I presume there must be separate ventilation systems for the toilet and locker rooms, as is required, then each of these separate systems whether of heating, ventilation or air-conditioning should be mentioned in the application for the permit. Also, if there are various heating and hot water heating appliances etc. to be installed at the same time, they may all be put on one application and a single permit issued, but the fee will be increased slightly according to the number of appliances installed at the same time. For instance the fee for the general heating system is one dollar, and if a separate hot water heating plant is to be installed at the same time that should be mentioned in the application and the additional fee of fifty cents will accrue, thus for each additional fire actuated device to be installed in general at the same time. If those appliances are widely separated in the plans, however, it will probably be best to file separate applications for each with the fee of one dollar applying to each.

Ventilation or air-conditioning systems ^{which} are connected with the heating system and therefore part of that system may be included in the heating permit, but systems which are purely for ventilation or air-conditioning without connection to the heating system require a separate application and a separate permit.

All of these applications may be filed only by the actual installer and the permits may only be issued to the actual installer.

In the second item of your list of plans, we received no Plan No. 605 but did receive one 505. In the third item the sheet which includes No. 507 also includes 607, 710 and 805.

Very truly yours,

Inspector of Buildings

WHD/S

CC: Gantoume & McKullen
89 Chauncy Street
Boston, Mass.
Supl. Newman, First National job, 215-239 Read St.



XXXXXXXXX
PRESIDENT
E. P. HACKETT
TREASURER

BALLARD SERVICE

HEATING OILS HEATING ENGINEERS
Oil Burning Equipment Commercial Refrigeration
AIR CONDITIONING EQUIPMENT

133 MARGINAL WAY
PORTLAND 3, MAINE
DIAL 2-1991

November 29, 1948

RECEIVED

NOV 30 1948

DEPT. OF BLD'G. INSP.
CITY OF PORTLAND

Mr. Warren McDonald
Building Inspectors Office
City Hall
Portland, Maine

Dear Mr. McDonald:

We are enclosing herewith drawing No. 124 showing the details of tanks, manholes, piping and covering for the two 15,000 gallon oil storage tanks at the First National Stores Warehouse, Read St., Portland, Maine which we trust meets with your approval.

Yours very truly,

BALLARD OIL & EQUIPMENT CO.

R. H. Dunton

RHD:AC



FILL IN AND SIGN WITH INK

APPLICATION FOR PERMIT FOR HEATING, COOKING OR POWER EQUIPMENT

Portland, Maine, Oct 30/48

PERMIT ISSUED 02151 NOV 17 1948 CITY OF PORTLAND

To the INSPECTOR OF BUILDINGS, PORTLAND, MAINE

The undersigned hereby applies for a permit to install the following heating appliance with the Laws of Maine, the Building Code of the City of Portland and the following power equipment in accordance with the laws of the State:

Location: 215-237 Read St East M Use of Building: Warehouse No. No. Stor.: New Building Existing: [checked] Name and address of owner of appliance: First National Stores Installer's name and address: Ballard Oil & Equip Co. Portland Telephone: 2-1991

General Description of Work

To install 3 Todd R.A.H. Fully Automatic Burners - #6 Oil Tank - Piping - Wiring - Controls etc

IF HEATER, OR POWER BOILER

Location of appliance or source of heat: Type of floor beneath appliance: IF wood, how protected?: Kind of fuel: Minimum distance to wood or combustible material, from top of appliance or casing top of furnace: From top of smoke pipe: From front of appliance: From sides or back of appliance: Size of chimney flue: Other connections to same flue: If gas fired, how vented?: Rated maximum demand per hour:

IF OIL BURNER

Permit Issued with Letter

Name and type of burner: Todd Type R.A.H. Labelled by underwriter's laboratories: Yes Will operator be always in attendance?: Yes Does oil supply line feed from top or bottom of tank?: Top Type of floor beneath burner: Concrete Burners floor on steel feet of boiler Location of oil storage: 2 at R.R. siding Old warehouse near Read St. at front of yard Number and capacity of tanks: 3 - 1500 If two 275-gallon tanks, will three-way valve be provided?: Yes Will all tanks be more than five feet from any flame?: Yes How many tanks fire proofed?: 3 Burned outside Total capacity of any existing storage tanks: furnace burners

IF COOKING APPLIANCE

Location of appliance: Kind of fuel: Type of floor beneath appliance: If wood, how protected?: Minimum distance to wood or combustible material from top of appliance: From front of appliance: From sides and back: From top of smokepipe: Size of chimney flue: Other connections to same flue: Is hood to be provided?: If so, how vented?: If gas fired, how vented?: Rated maximum demand per hour:

MISCELLANEOUS EQUIPMENT OR SPECIAL INFORMATION

2 - 1500 Tank at R.R. siding near old warehouse to supply 2 pumps in Warehouse, these pumped to 1500 cistern tank in fire room. 150000 at front of new warehouse on Read St. to supply #2 Oil to Bakery

Amount of fee enclosed: 2.00 (\$1.00 for one heater, etc., 50 cents additional for each additional heater, etc., in same building at same time.)

APPROVED:

11/4/48 [Signature]

Will there be in charge of the above work a person competent to see that the State and City requirements pertaining thereto are observed?

RECEIVED NOV - 2 1948 DEPT. OF BLD'G. INSP. CITY OF PORTLAND

INSPECTION COPY

Signature of Installer

[Signature]

m. D. Equid - 20

6
Permit No. 48/2151

Location 215-239 Road St.

Owner First National Stores^{INC}

Date of permit 11/17/48

Approved

NOTES

11/4/48 Final inspection
20" earth fill on west side
new footed concrete slab
G.C.

INSPECTION COMPLETED



*277
to Mr. J. H. Dunton*

BALLARD SERVICE

ATING OILS • HEATING ENGINEERS
g Equipment • Commercial Refrigeration
AIR CONDITIONING EQUIPMENT

November 18, 1948

135 MARGINAL WAY
PORTLAND 3, MAINE
DIAL 2-1891

Department of Building Inspection
City of Portland,
Maine

Attention: Mr. Warren McDonald

SUBJECT: BUILDING PERMIT FOR FIRST NATIONAL STORES, ~~NOV 10 1948~~
215-239 READ ST., PORTLAND, MAINE.

RECEIVED
NOV 10 1948
DEPT. OF BLD'G. INSP.
CITY OF PORTLAND

Gentlemen:

Supplementing our application and answering the various questions in your letter of November 17th 1948, please be advised that within the next few days, we will have a plan showing the exact structure over the two 15,000 gallon tanks alongside the old warehouse and the 15,000 gallon tank on the Read Street end of the building for the bakery.

Answering paragraph two, the shell and head of these tanks are 5/16" normal thickness and the tanks were given a coat of red lead and primary coat of asphaltum at the factory before shipment and the second coat of asphaltum after they were landed in the pit.

In answer to paragraph three, all suction and return piping will be provided with swing joints.

Regarding the 550 gallon settling tank in boiler room as mentioned in paragraph four, this has been properly coated with asphalt and insulated with an 18" brick wall to 1' over the top of the tank. All pipes including suction and return, vent, and fuel piping are from the top of the tank.

In accordance with paragraph seven, please be advised that pre-heaters located in the steam line are to be used and controlled by a Powers Regulator. Also, we are using a 5000 watt electric heater on the suction line and a 3000 watt electric heater at the burner so that the smoke nuisance will not be violated.

We thank you for your communication and wish to assure you that all of the local and state and Underwriters requirements will be met in this installation.

Yours very truly,

BALLARD OIL & EQUIPMENT CO.

R. H. Dunton

RHD:AC



215-239 Bond Street
(Oil burning equipment)-1

November 17, 1948

Ballard Oil & Equipment Company
135 Marginal Way
Portland, Maine

Attn: Mr. E. H. Emton

Gentlemen:

Subject: Building permit for installation of three automatic oil burners, 3-15,000 gallon oil tanks and one 550 gallon settling tank with necessary piping for First National Stores, Inc. at 215-239 Bond Street in connection with the new building under construction there

Building permit for the above installations is issued, herewith, subject to the following:

1. I have not found on the plan the depth which is proposed for the top of the tanks below the surface of the ground but from the note: "concrete pad over", I take it that the tanks are to be protected from pressure from above by means of reinforced concrete slab indicated in the standards and that the top of the tanks will be no less than the minimum of one foot below the surface of the ground, using a reinforced concrete slab no less than 4" thick and extending at least one foot beyond the perimeter of the tank in each case.
2. In the absence of full information on plan and application as to gauge or shell of tank, whether the tanks bear the Underwriters label for underground tanks or not, etc., the minimum requirements are that the shell of the tank shall be no less than 5/16" nominal thickness, and if thinner than No. 7 gauge the tanks shall be galvanized. In addition each tank requires the equivalent of two preliminary coatings of red lead followed by a heavy coating of hot asphalt.
3. The pipe lines, other than tubing, connected to these underground tanks, except fill and test wells, require double swing joints arranged to permit the tank to rotate without impairing the efficiency of the pipe connections.
4. Where reference is made to the fact in the application that the 550 gallon settling tank in the boiler room, is to be insulated note that this insulation is to be as provided in Section 2(c) of Paragraph 31 of the National Board of Fire Underwriters which is set up as standard by our Municipal Officers, also note that this 550 gallon tank is required to be no less than No. 14 gauge, and if the shell is less than No. 7 gauge, the tank is required to be galvanized. It too required the equivalent of two preliminary coatings of red lead following by a heavy coating of hot asphalt.
5. The application indicates that the supply lines feed from the top of each tank, and I presume this holds good for the 550 gallon tank in the boiler room as well as the others because where the delivery of oil from tank to burner assembly is by gravity, the tank is not permitted to exceed the capacity of 275 gallons.
6. Because of the size of these tanks, the inspection of the tanks in the holes before they are covered up are to be made by the Fire Department, and when ready Fire Department Headquarters should be notified. Our inspector will care for the oil burner assemblies and the small tank in the boiler room, but this tank should be inspected before the sand is filled in.
7. Your applications notes that No. 6 oil is to be used, but does not state whether preheaters are to be used or not. In view of all cooperative efforts at smoke prevention in the city, the owners engineers are being advised separately about this problem.

Very truly yours,

Inspector of Buildings

AMC/O

Ballard Oil & Equipment Company-----2

November 17, 1918

CC: Oliver T. Pashorn
Chief of the Fire Department

First National Stores, Inc.
5 Middlesex Avenue
Bostonville, Massachusetts

Thomas O'Connor Company, Inc.
Attn: Mr. Norman
215 Read Street

Ganteaux & McMullen
99 Chauncy Street
Boston, Massachusetts

Gentlemen:

For about a year now we have been engaged in a cooperative effort toward smoke abatement in the City of Portland, and your cooperation is solicited together with that of the owners of this building, not only with regard to the oil burning equipment but also with regard to the boiler installations which I understand Claghorn is to do.

It is quite common to assume that oil burning equipment is always smokeless, but we have learned otherwise. I note that No. 6 oil is to be used in the boilers.

In the course of our campaign here, we had a foremost expert on oil burning here and we were told that ^{oil} and in most cases No. 5 oil should never be used without pre-heating. If that were attempted, it is his claim that offensive smoke will almost always be produced and perhaps just as important, great quantities of oil will be wasted.

Since you and the owners are sparing no effort to make this splendid plant the most effective possible, I presume preheaters are being installed for this heavy oil—electric for starting the fires and steam preheaters after the fires are started. In the absence of any statement as to preheaters in connection with the issuance of the permit, however, it seemed best to call the matter to your attention.

Very truly yours,

Inspector of Buildings

AP 215-239 Read Street-J

September 3, 1918

First National Stores, Inc.
5 Middlesex Avenue
Somerville, Mass.

Subject: Permit for installation
of freight elevator in new
bakery at 215-239 Read Street

Gentlemen:

We are issuing to F. S. Payne Company a permit for the installation of a freight elevator in your new bakery at the above address. It is noted that Peole bi-parting doors are to be installed on the openings to the elevator enclosure. Since these doors are neither automatic or self-closing, as is usually required by the Building Code for the fire doors on openings in such an enclosure, it is strongly recommended that the practice be established of making certain that the doors to the enclosure are closed in that story where elevator car is left standing particularly when business operations are suspended for any length of time.

Very truly yours,

Inspector of Buildings

AJB/S

CC: F. S. Payne Company
Richdale Avenue
Cambridge, Mass.

Gentlemen & McKullon
97 Chauncy Street
Boston, Mass.

AP 215-239 Read Street-I
(elevator)

August 21, 1948

F. S. Payne Company
Richdale Avenue
Cambridge, Mass.

Subject: Application for permit
for installation of freight
elevator in new bakery at 215-
239 Read Street

Gentlemen:

We are in receipt of your application for a permit for
the above work. The fee for such a permit is two dollars
(\$2.00). Check should be made payable to the City of Portland.

Very truly yours,

Inspector of Buildings

AJS/S