

APPLICATION FOR PERMIT

PERMIT ISSUED

B.O.C.A. USE GROUP

B.O.C.A. TYPE OF CONSTRUCTION 626

MAY 22 1986

ZONING LOCATION B-2 PORTLAND, MAINE 5/9/86

City Of Portland

To the CHIEF OF BUILDING & INSPECTION SERVICES, PORTLAND, MAINE

The undersigned hereby applies for a permit to erect, alter, repair, demolish, move or install the following building, structure, equipment or change use in accordance with the Laws of the State of Maine, the Portland B.O.C.A. Building Code and Zoning Ordinance of the City of Portland with plans and specifications, if any, submitted herewith and the following specifications:

LOCATION 10 Adelaide St. Fire District #1 , #2

1. Owner's name and address ~~Geo. George Nelson~~ 37 Morse St. 04103 Telephone 773-8256

2. Lessee's name and address Telephone 761-8411

3. Contractor's name and address OWNER Telephone

..... No. of streets 4

Proposed use of building .. residential No. families 6

Last use same No. families single

Material .. wood ... No. stories .. 2 ... Heat .. electric ... Style of roof .. asphalt ... Roofing .. pitch

Other buildings on same lot

Estimated contractual cost \$ 20,000.00. Appeal Fees \$ 120.00

FIELD INSPECTOR—Mr. Base Fee 25.00

@ 775-5451

Late Fee

TOTAL \$ 145.00

Change of use from one family to six families as per plans 4 sheets with renovations with other

Stamp of Special Conditions

also to construct 18' by 32' addition to side of building

NOTE TO APPLICANT: Separate permits are required by the installers and subcontractors of heating, plumbing, electrical and mechanicals.

DETAILS OF NEW WORK

Is any plumbing involved in this work? ... yes Is any electrical work involved in this work? ... yes
Is connection to be made to public sewer? If not, what is proposed for sewage?
Has septic tank notice been sent? Form notice sent?
Height average grade to top of plate Height average grade to highest point of roof
Size, front depth No. stories solid or filled land? earth or rock?
Material of foundation Thickness, top bottom cellar
Kind of roof Rise per foot Roof covering
No. of chimneys Material of chimneys of lining Kind of heat fuel
Framing Lumber—Kind Dressed or full size? Corner posts Sills
Size Girder Columns undec. girders Size Max. on centers
Studs (outside walls and carrying partitions) 2x4-16" O. C. Bridging in every floor and flat roof span over 8 feet.
Joists and rafters: 1st floor 2nd 3rd roof
On centers: 1st floor 2nd 3rd roof
Maximum span: 1st floor 2nd 3rd roof
If one story building with masonry walls, thickness of walls? height?

IF A GARAGE

No. cars now accommodated on same lot to be accommodated number commercial cars to be accommodated
Will automobile repairing be done other than minor repairs to cars habitually stored in the proposed building?

APPROVALS BY: DATE
BUILDING INSPECTION PLAN EXAMINER
ZONING: J. W. 2/7/86
BUILDING CODE
Fire Dept. James J. Collins
Health Dept.
Others

MISCELLANEOUS
Will work require disturbing of any tree on a public street? NO
Will there be in charge of the above work a person competent to see that the State and City requirements pertaining thereto are observed?

Signature of Applicant [Signature] Phone # 773-8256
Type Name of above ... George Nelson ... 1 2 3 4
Other and Address

FIELD INSPECTOR'S COPY APPLICANT'S COPY OFFICE FILE COPY

9 Fred Williams

10 ADAMS ST

EXISTING BUILDING

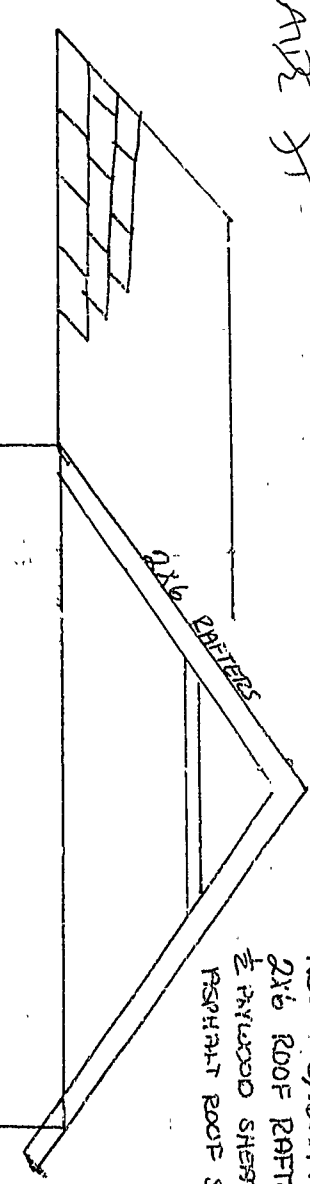

ROOF 5/12 PITCH
 2x6 ROOF RAFTERS
 1/2\"/>

2x10 EAVE JOIST

RECEIVED
 MAY - 9 1986
 DEPT. OF BUILDING INSPECTIONS
 CITY OF PORTLAND

2x10 EAVE JOIST

18'

FOUNDATION 18x32
8" THICK WALLS

1/2\"/>
 2x6 STUDS

