

55-59 MAYLAND STREET

SHAW-WALKER

Full cut #920R - Half cut #0202R - Third cut #9203R - Fifth cut #9205R

285



FILL IN AND SIGN WITH INK

APPLICATION FOR PERMIT FOR HEATING, COOKING OR POWER EQUIPMENT

Portland, Maine, October 5, 1951

PERMIT ISSUED
01968
CCT 5. 1951
CITY OF PORTLAND
I-ESC

To the INSPECTOR OF BUILDINGS, PORTLAND, ME.

The undersigned hereby applies for a permit to install the following heating, cooking or power equipment in accordance with the Laws of Maine, the Building Code of the City of Portland, and the following specifications:

Location ... 55-59 Mayland Street . . . Use of Building dwelling . . . No. Stories 1 1/2 . . . New Building "Existing"
Name and address of owner of appliance P. Dascanio, Washington Avenue
Installer's name and address Pallotta Oil Co., 112 Exchange Street . . . Telephone 4-2671

General Description of Work

To install forced warm air heating system and oil burning equipment

IF HEATER, OR POWER BOILER

Location of appliance or source of heat basement . . . Type of floor beneath appliance concrete
If wood, how protected? . . . Kind of fuel oil
Minimum distance to wood or combustible material, from top of appliance or casing top of furnace 3' . . . plenum chamber
From top of smoke pipe 2' . . . From front of appliance 10' . . . From sides or back of appliance 5'
Size of chimney flue 8x10 . . . Other connections to same flue none . . .
If gas fired, how vented? . . . Rated maximum demand per hour

IF OIL BURNER

Name and type of burner . . . Fluid Heat . . . Labelled by underwriters' laboratories? yes
Will operator be always in attendance? . . . Does oil supply line feed from top or bottom of tank? bottom
Type of floor beneath burner concrete . . .
Location of oil storage basement . . . Number and capacity of tanks 1-275 gal.
If two 275-gallon tanks, will three-way valve be provided?
Will all tanks be more than five feet from any flame? yes . . . How many tanks fire proofed?
Total capacity of any existing storage tanks for furnace burners none

IF COOKING APPLIANCE

Location of appliance . . . Kind of fuel . . . Type of floor beneath appliance
If wood, how protected?
Minimum distance to wood or combustible material from top of appliance
From front of appliance . . . From sides and back . . . From top of smokepipe
Size of chimney flue . . . Other connections to same flue
Is hood to be provided? . . . If so, how vented?
If gas fired, how vented? . . . Rated maximum demand per hour

MISCELLANEOUS EQUIPMENT OR SPECIAL INFORMATION

Amount of fee enclosed? 2.00 (\$2.00 for one heater, etc., 50 cents additional for each additional heater, etc., in same building at same time.)

APPROVED:
O.K. 2.2.2. 10/5/51

Will there be in charge of the above work a person competent to see that the State and City requirements pertaining thereto are observed? yes . . .

INSPECTION COPY

Signature of Installer

Pallotta Oil Co.
S. J. Pallotta

LOCATION CHANGED BY MR. DASCANIO
5/26/51



LOT NO. 557259

559
MAYLAND ST.
5. 1897

55-
MAYLAND
5/26/51

MAYLAND ST

5-21-51
MAYLAND ST
5/26/51



(RC) RESIDENCE ZONE - C
APPLICATION FOR PERMIT
Class of Building or Type of Structure... Third Class
Portland, Maine, May 21, 1951

PERMIT ISSUED
00897
MAY 25 1951
CITY OF PORTLAND

To the INSPECTOR OF BUILDINGS, PORTLAND, MAINE

The undersigned hereby applies for a permit to erect ~~the proposed building~~ ~~the following building~~ ~~structure~~ ~~structure~~ in accordance with the Laws of the State of Maine, the Building Code and Zoning Ordinance of the City of Portland; plans and specifications, if any, submitted herewith and the following specifications:

Location . . . 55-59 Mayland Street . . . Within Fire Limits? no -- Dist. No. . .
Owner's name and address Peter Daccanio, 23 Washington Avenue . . . Telephone 4-2386
Lessee's name and address . . . Telephone . . .
Contractor's name and address . . . owner . . . Telephone . . .
Architect **STANDARD PLAN B** Specifications . . . Plans yes . . . No. of sheets **4.7**
Proposed use of building . . . dwelling house . . . No. families . . . 1
Last use . . . No. families . . .
Material . . . No. stories . . . Heat . . . Style of roof . . . Roofing . . .
Other building on same lot . . .
Estimated cost \$ 7,000. . . Fee \$. . . 7.00.

General Description of New Work

To construct 1-story frame dwelling house 24' x 30'.

Permit Issued with Letter:

Important notice sent

It is understood that this permit does not include installation of heating apparatus which is to be taken out separately by and in the name of the heating contractor. **PERMIT TO BE ISSUED TO** owner

Details of New Work

Is any plumbing involved in this work? **yes** Is any electrical work involved in this work? **yes**
Is connection to be made to public sewer? **no** If not, what is proposed for sewage? **septic tank HOK**
Height average grade to top of plate . . . 10' . . . Height average grade to highest point of roof . . . 18'
Size, front . 26' 6" . . . depth . 24' . . . No. stories . . . 1 solid or filled land? **solid** . . . earth or rock? . . . **earth**
Material of foundation **concrete** . . . at least 4' below grade . . . Thickness, top 10" bottom 12" . . . cellar . . . **yes**
Material of underpinning . . . to sill . . . Height . . . Thickness . . .
Kind of roof **Fitch-gable** Rise per foot . . . 5" . . . Roof covering . **Asphalt Class C** . . . **Und. Lab.**
No. of chimneys . . . 1 . . . Material of chimneys **brick** of fluing tile Kind of heat f. hot air fuel . . . **oil**
Framing lumber—Kind . . . **hemlock** . . . Dressed or full size? . . . **dressed**
Corner posts . 3-2x4 . . . Sills . 2x8 box Girt or ledger board? . . . Size . . .
Girders . **yes** . . . Size **6x8** . . . Columns under girders . **Lally** . . . Size **3 1/2"** . . . Max. on centers . **4' 8"**
Studs (outside walls and carrying partitions) **2x1-16" O. C.** Bridging in every floor and flat roof span over 8 feet.
Joists and rafters: 1st floor . . . **2x8** . . . 2nd . . . **2x6** . . . 3rd roof . . . **2x6**
On centers: 1st floor . . . **16"** . . . 2nd . . . **16"** . . . 3rd roof . . . **16"**
Maximum span: 1st floor . . . **12'** . . . 2nd . . . **12'** . . . 3rd roof . . .
If one story building with masonry walls, thickness of walls? . . . height? . . .

If a Garage

No. cars now accommodated on same lot . . . , to be accommodated. . . number commercial cars to be accommodated . . .
Will automobile repairing be done other than minor repairs to cars habitually stored in the proposed building? . . .

APPROVED:
with letter by app!

Miscellaneous
Will work require disturbing of any tree on a public street? . . . **no**
Will there be in charge of the above work a person competent to see that the State and City requirements pertaining thereto are observed? . . . **yes**

INSPECTION COPY
Signature of owner *Peter R. Daccanio*

NOTES

5/8/51 - In motion 2/5 2/8 2/11
 6/29/51 - Form cancelled 2/11
 8/3/51 - Car permission letter
 in except annual chimney. 2/11
 8/17/51 - Game OK to close in
 entire the place only. no
 other items on green tag
 checked - 1/11
 1/22/52 - Work done,
 1/22/52 - To be
 issued. 2/11

217

Permit No. 51/897
 Location 5559 MacLeod St.
 Owner John Sparrow
 Date of permit 5/25/51
 Notif. closing-in 8/13/51
 Inspn. closing-in 8/3/51
 Final Notif. 1/22/52 9:00 BC
 Final Inspn. 1/2/52
 Cert. of Occupancy Issued 1/3/52

8-21-51. Changes made
by Mr. Discanto
shown in blue. *CDR.*

This lot kept 70'
wide but lines
moved 5'

This lot cut
to 65'

IRVING STREET

MAYLAND STREET

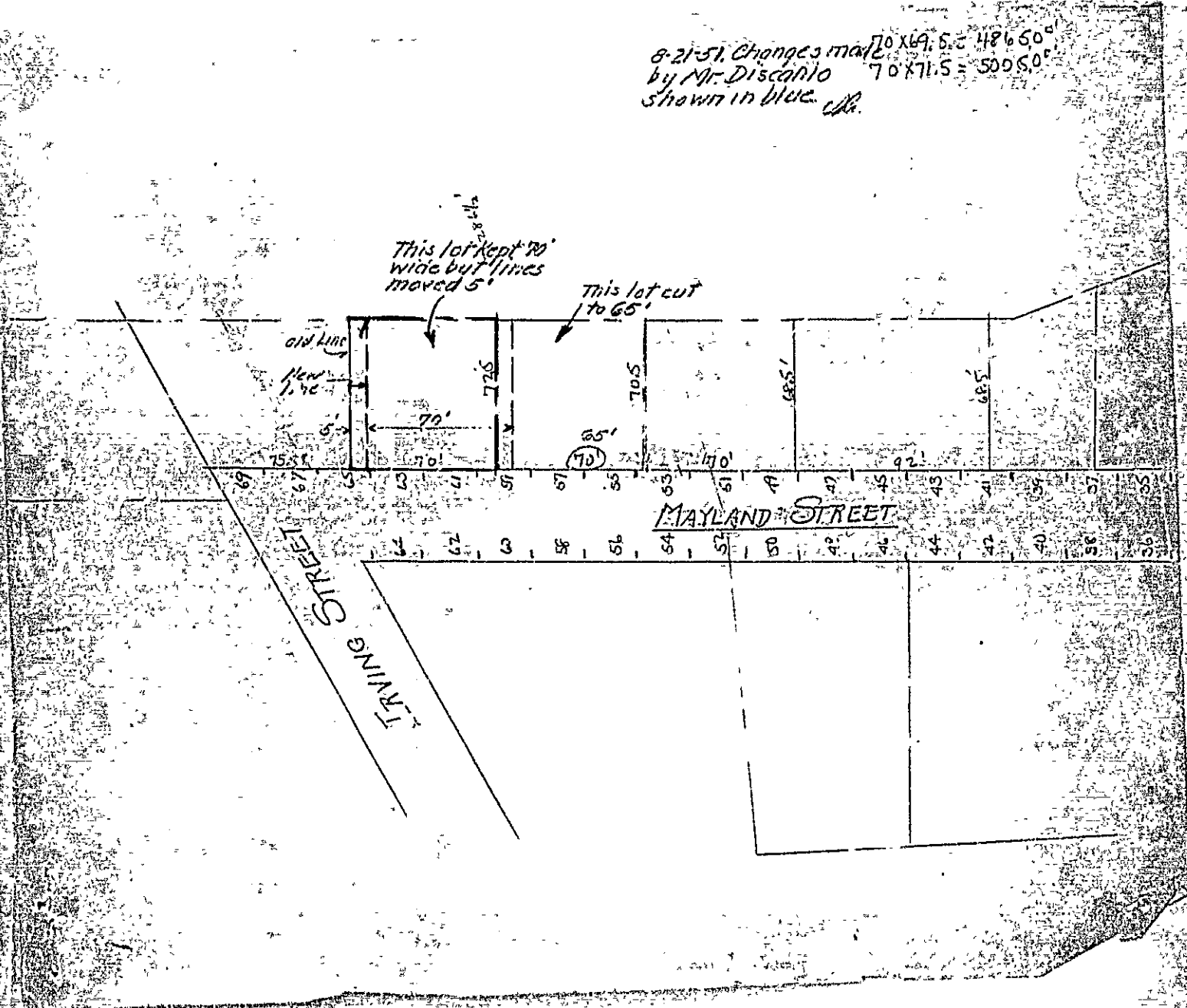

STATEMENT ACCOMPANYING APPLICATION FOR BUILDING PERMIT

for dwelling
at 55-59 Mayland Street Date 5/21/51

1. In whose name is the title of the property now recorded? Peter Dascario
2. Are the boundaries of the property in the vicinity of the proposed work shown clearly on the ground, and how? stakes
3. Is the outline of the proposed work now staked out upon the ground? yes
If not, will you notify the Inspection Office when the work is staked out and before any of the work is commenced? _____
4. What is to be maximum projection or overhang of eaves or drip? _____
5. Do you assume full responsibility for the correctness of the location plan or statement of location filed with this application, and does it show the complete outline of the proposed work on the ground, including bay windows, porches and other projections? yes
6. Do you assume full responsibility for the correctness of all statements in the application concerning the sizes, design and use of the proposed building? yes
7. Do you understand that in case changes are proposed in the location of the work or in any of the details specified in the application that a revised plan and application must be submitted to this office before the changes are made? yes

Peter P. Dascario

COPY

CITY OF PORTLAND, MAINE
Department of Building Inspection

Certificate of Occupancy



Issued to **Peter Dascario**

Date of Issue **January 23, 1952**

This is to certify that the building, premises, or part thereof, indicated below, and built—
~~erected—changed as a house~~ at **55-59 Highland Street**
under Building Permit No. **51/897**, has had final inspection, has been found to conform substantially to requirements of Zoning Ordinance and Building Code of the City, and is hereby approved for occupancy, limited or otherwise, as indicated below.

PORTION OF BUILDING OR PREMISES

APPROVED OCCUPANCY

Entire Building

One-family Dwelling House

Limiting Conditions:

This certificate supersedes
certificate issued
Approved **1/22/52**

Walter Small
Inspector

Warren Gold
Inspector of Buildings

Notice: This certificate identifies lawful use of building or premises, and ought to be transferred from owner to owner when property changes hands. Cop. will be furnished to owner or lessee for one dollar.