

100-104, CRAIGIE ST. ~~REDACTED~~.

SHAW-WALKER
S 9203-12



APPLICATION FOR PERMIT

Class of Building or Type of Structure Third Class

Portland, Maine, December 23, 1957

PERMIT ISSUED

DEC 24 1957

CITY OF PORTLAND

To the INSPECTOR OF BUILDINGS, PORTLAND, MAINE

The undersigned hereby applies for a permit to erect alter repair demolish install the following building structure equipment in accordance with the Laws of the State of Maine, the Building Code and Zoning Ordinance of the City of Portland, plans and specifications, if any, submitted herewith and the following specifications:

Location 102 Craigie Street Within Fire Limits? no Dist. No.
Owner's name and address Howard A. Burnham, 102 Craigie St. Telephone
Lessee's name and address Telephone
Contractor's name and address Donald York, 73 Broadway Telephone
Architect Specifications Plans YES No. of sheets 1
Proposed use of building Dwelling No. families 1
Last use No. families 1
Material frame No. stories Heat Style of roof Roofing
Other building on same lot
Estimated cost \$ 150. Fee \$ 2.00

General Description of New Work

To demolish existing rear platform 4'x5' and
To construct rear piazza 8'x10' with roof

4x6 plate - 5' span

It is understood that this permit does not include installation of heating apparatus which is to be taken out separately by and in the name of the heating contractor. PERMIT TO BE ISSUED TO Donald York

Details of New Work

Is any plumbing involved in this work? Is any electrical work involved in this work?
Is connection to be made to public sewer? If not, what is proposed for sewage?
Has septic tank notice been sent? Form notice sent? YES
Height average grade to top of plate 9' Height average grade to highest point of roof 12'
Size, front depth No. stories solid or filled land? earth or rock?
Material of foundation 9" Sonotubes at least 1' below grade Thickness, top bottom cellar
Material of underpinning Height Thickness
Kind of roof pitch-shed Rise per foot 4 1/2" Roof covering asphalt roofing Class C Und. Lab.
No. of chimneys Material of chimneys of lining Kind of heat fuel
Framing Lumber—Kind hemlock Dressed or full size? dressed Corner posts 4x4 Sills 4x6
Size Girder Columns under girders Size Max. on centers
Kind and thickness of outside sheathing of exterior walls?
Studs (outside walls and carrying partitions) 2x4-16" O. C. Bridging in every floor and flat roof span over 8 feet.
Joists and rafters: 1st floor 2x6, 2nd , 3rd , roof 2x6
On centers: 1st floor 16", 2nd , 3rd , roof 16"
Maximum span: 1st floor 8', 2nd , 3rd , roof 8'
If one story building with masonry walls, thickness of walls? height?

If a Garage

No. cars now accommodated on same lot , to be accommodated number commercial cars to be accommodated
Will automobile repairing be done other than minor repairs to cars habitually stored in the proposed building?

APPROVED:

OK - 12/24/57 - AGS

Miscellaneous

Will work require disturbing of any tree on a public street? no
Will there be in charge of the above work a person competent to see that the State and City requirements pertaining thereto are observed? YES

Howard A. Burnham

INSPECTION COPY

Signature of owner By:

D. B. York

2/16

NOTES

1-13-58 Rear sill
in place *MC*

1-21-58 Framing
under way *MC*

2-3-58 Completed *MC*

X

Permit No. 51/1954
Location 102 Chicago St
Owner Miss and Mr. Henderson
Date of permit 12/24/57
Notif. closing-in _____
Insp. closing-in _____
Final Notif _____
Final Insp _____
Cert. of Occupancy issued _____
Selling Out Notice _____
Form Check Notice _____

18

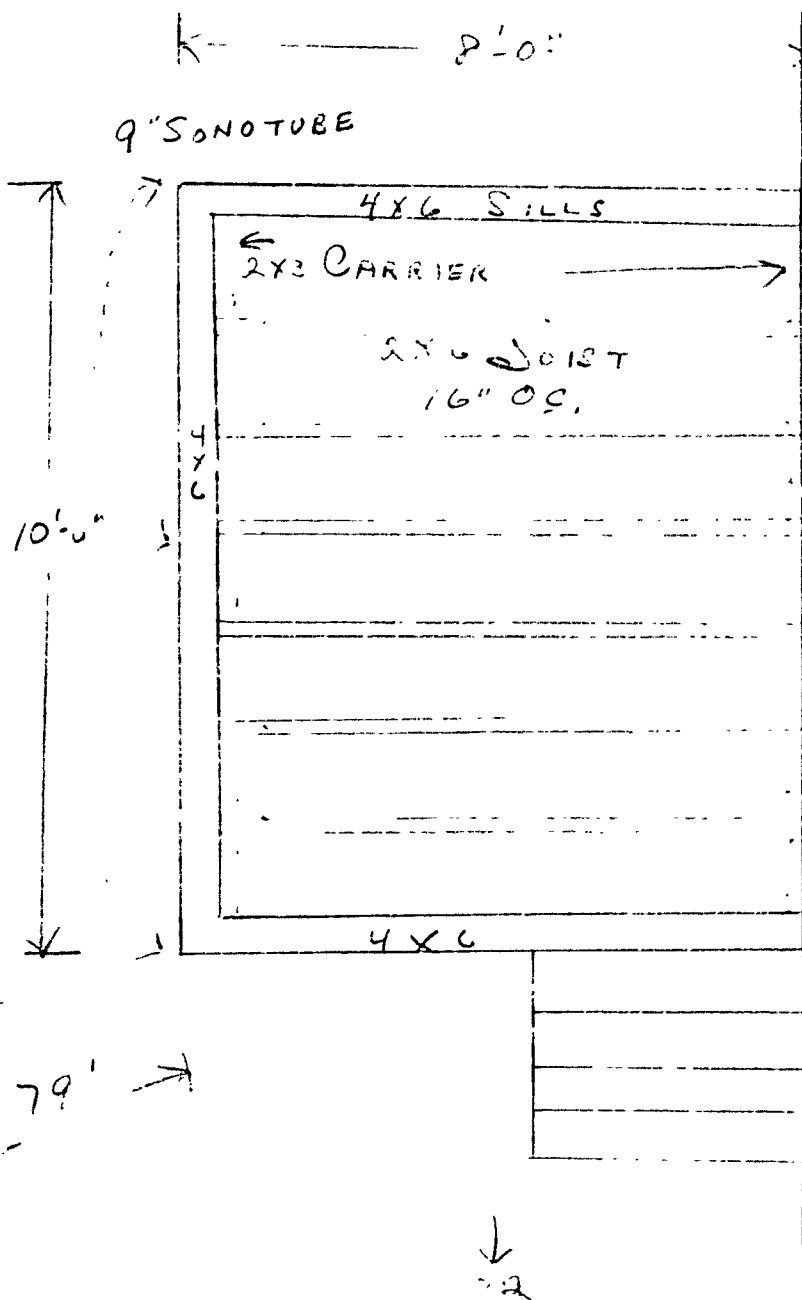

PROPERTY
OF MR.
HOWARD A.
BURNHAM
102 CRAIGIE ST.

TO REPLACE
PRESENT 4'x5'
PORCH

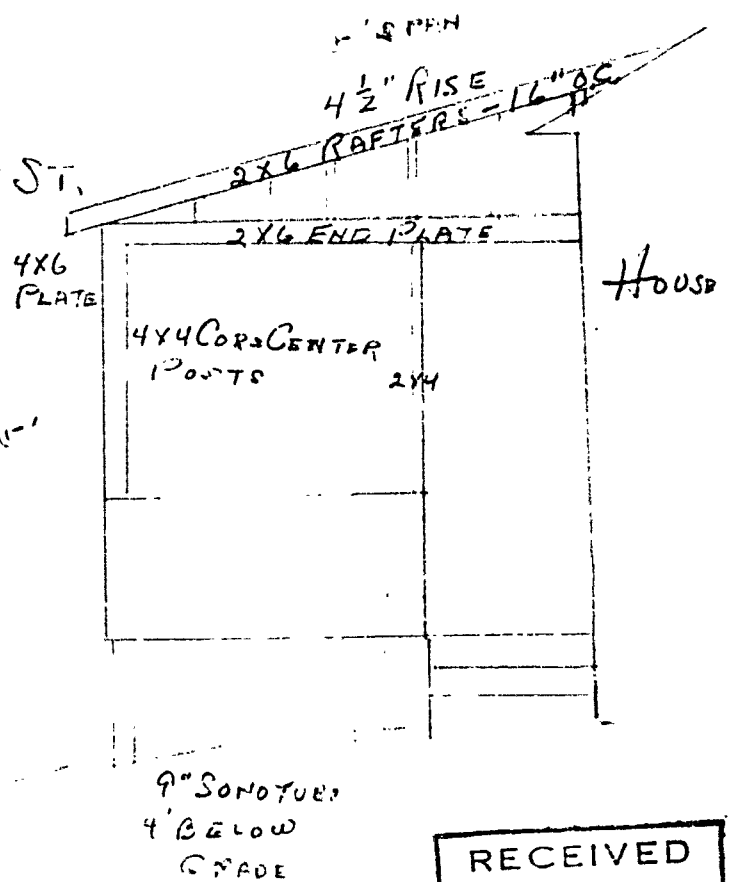

9" SONOTUBE
4' BELOW
GRADE

RECEIVED
DEC 23 1967
DEPT. OF BLDG. INSP.
CITY OF BIRMINGHAM

CHAS. E. SMITH CO. PORTLAND

(COPY)



CITY OF PORTLAND, MAINE
Department of Building Inspection

Certificate of Occupancy

LOCATION 100-104 Craigie St.

Issued to HOWARD BURNHAM

Date of Issue Aug. 10, 1956

This is to certify that the building, premises, or part thereof, at the above location, built—~~shoved~~
~~—done~~ under Building Permit No. 55/1604, has had final inspection, has been found to conform
substantially to requirements of Zoning Ordinance and Building Code of the City, and is hereby approved for
occupancy or use, limited or otherwise, as indicated below.

PORTION OF BUILDING OR PREMISES

Entire

APPROVED OCCUPANCY

One-family Dwelling House

Limiting Conditions:

This certificate supersedes
certificate issued

Approved:

8/10/56
(Date)

Nelson F. Cartwright
Inspector

W. A. C. Russell
Inspector of Buildings

Notice: This certificate identifies lawful use of building or premises, and ought to be transferred from
owner to owner when property changes hands. Copy will be furnished to owner or lessee for one dollar.

BOUNDARY MARKINGS AND STREET
CARDS ARE BASED ON SURVEY
AVAILABLE AND SURVEY PLANS

PROPOSED DWELLINGS

82-84
86-88
92-94
100-102

CRAIGIE ST.

SCALE: 1"=30'

OWNER: THE PRATT CORP.
CONTRACTOR: SAME
PLAN MAKER: A. COPE

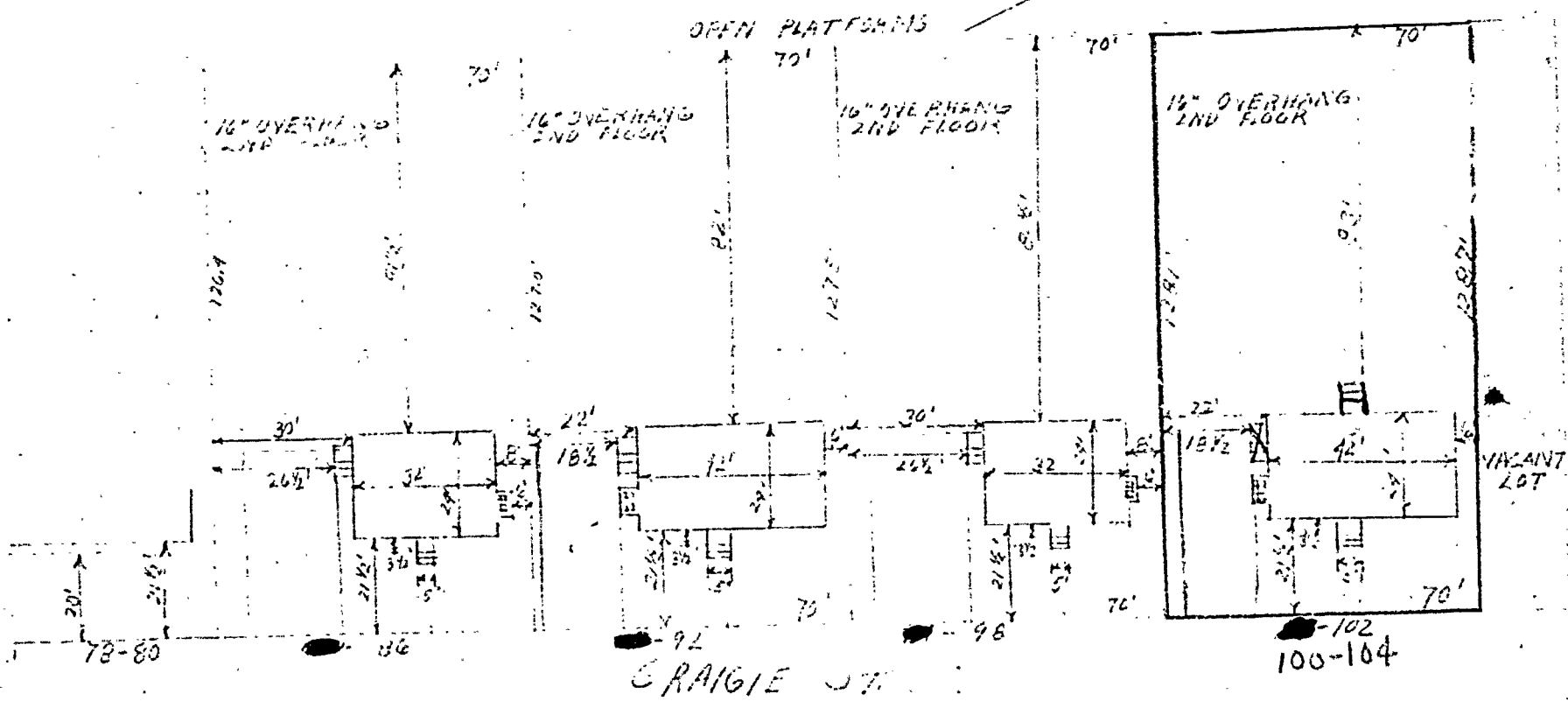



APPLICATION FOR PERMIT

Class of Building or Type of Structure Third Class

Portland, Maine, Sept. 22, 1955

RECEIVED
01612
SEP 23 1955

To the INSPECTOR OF BUILDINGS, PORTLAND, MAINE

The undersigned hereby applies for a permit to erect ~~alter or demolish~~ the following building structure ~~or structures~~ in accordance with the Laws of the State of Maine, the Building Code and Zoning Ordinance of the City of Portland, plans and specifications, if any, submitted herewith and the following specifications:

Location 100-104 Craigie St. Extension Within Fire Limits? no Dist. No. _____
Owner's name and address The Minat Corp., 34 Preble St. Telephone 4-6013
Lessee's name and address _____ Telephone _____
Contractor's name and address owners Telephone _____
Architect _____ Specifications _____ Plans yes No. of sheets 2
Proposed use of building dwelling house No. families 1
Last use _____ No. families _____
Material _____ No. stories _____ Heat _____ Style of roof _____ Roofing _____
Other buildings on same lot _____ Fee \$ 10.00
Estimated cost \$ 2,500.

General Description of New Work

To construct $1\frac{1}{2}$ -story frame dwelling house $42' \times 24'$.

It is understood that this permit does not include installation of heating apparatus which is to be taken out separately by and in the name of the heating contractor. PERMIT TO BE ISSUED TO owners

Details of New Work

Is any plumbing involved in this work? yes Is any electrical work involved in this work? yes
Is connection to be made to public sewer? yes If not, what is proposed for sewage? _____
Has septic tank notice been sent? _____ Form notice sent? ☒
Height average grade to top of plate 11' Height average grade to highest point of roof 19'
Size, front 42' depth 24' No. stories 1\frac{1}{2} solid or filled land? solid earth or rock? earth
Material of foundation concrete at least 4' below grade Thickness, top 10" bottom 12" cellar yes
Material of underpinning _____ to sill _____ Height _____ Thickness _____
Kind of roof pitch-gable Rise per foot 10" Roof covering Asphalt Class C Und Lab
No. of chimneys 1 Material of chimneys brick of lining tile Kind of heat hot water fuel oil
Framing lumber—Kind hemlock Dressed or full size? dressed
Corner posts 4x6 Sills box Girt or ledger board? _____ Size _____
Girders yes Size 6x8 full size Columns under girders lally Size 3\frac{1}{2}" Max. on centers 6'8"
Studs (outside walls and carrying partitions) 2x4-16" O. C. Bridging in every floor and flat roof span over 8 feet.
Joists and rafters: 1st floor 2x8, 2nd 2x8, 3rd _____, roof 2x8
On centers: 1st floor 16", 2nd 16", 3rd _____, roof 20"
Maximum span: 1st floor 12', 2nd 12', 3rd _____, roof _____
If one story building with masonry walls, thickness of walls? _____ height? _____

If a Garage

No. cars now accommodated on same lot _____, to be accommodated _____ number commercial cars to be accommodated _____
Will automobile repairing be done other than minor repairs to cars habitually stored in the proposed building? _____

Miscellaneous

Will work require disturbing of any tree on a public street? no
Will there be in charge of the above work a person competent to see that the State and City requirements pertaining thereto are observed? yes

The Minat Corp.

APPROVED:

9/26/55 - O.K. - C.J.S.

Signature of owner by: [Signature]

INSPECTION COPY

NOTES

10-4-55 Forms OK *OK*

10-4-55 10-4-55 10-4-55
10-4-55 10-4-55 10-4-55
10-4-55 10-4-55 10-4-55

10-4-55 10-4-55 10-4-55
10-4-55 10-4-55 10-4-55

10-4-55 10-4-55 10-4-55
10-4-55 10-4-55 10-4-55

10-4-55 10-4-55 10-4-55
10-4-55 10-4-55 10-4-55

10-4-55 10-4-55 10-4-55
10-4-55 10-4-55 10-4-55

10-4-55 10-4-55 10-4-55
10-4-55 10-4-55 10-4-55

10-4-55 10-4-55 10-4-55
10-4-55 10-4-55 10-4-55

10-4-55 10-4-55 10-4-55
10-4-55 10-4-55 10-4-55

10-4-55 10-4-55 10-4-55
10-4-55 10-4-55 10-4-55

10-4-55 10-4-55 10-4-55
10-4-55 10-4-55 10-4-55

10-4-55 10-4-55 10-4-55
10-4-55 10-4-55 10-4-55

10-4-55 10-4-55 10-4-55
10-4-55 10-4-55 10-4-55

Permit No. *55/1084*
 Location *1007044 Cairn Rd. 10-4-55*
 Owner *10-4-55 10-4-55 10-4-55*
 Date of permit *9/26/55*
 Notif. closing-in *5/13/56*
 Inspn. closing-in *5/13/56*
 Final Notif. *5/13/56*
 Final Inspn. *5/13/56*
 Cert. of Occupancy issued *8/10/56*
 Staking Out Notice *8/10/56*
 Form Check Notice *8/10/56*



FILL IN AND SIGN WITH INK

APPLICATION FOR PERMIT FOR HEATING, COOKING OR POWER EQUIPMENT

Portland, Maine, June 21, 1936

To the INSPECTOR OF BUILDINGS, PORTLAND, ME.

The undersigned hereby applies for a permit to install the following heating, cooking or power equipment in accordance with the Laws of Maine, the Building Code of the City of Portland, and the following specifications:

Location 100-104 Craigie St. Use of Building Dwelling No. Stories 1 New Building
Name and address of owner of appliance T. J. J. Corp., 74 Irving St. Existing
Installer's name and address Fallotta Oil Co., 112 Exchange St. Telephone 4-2671

General Description of Work

To install forced hot water heating system and oil burning equipment

IF HEATER, OR POWER BOILER

Location of appliance basement Any burnable material in floor surface or beneath? no
If so, how protected? Kind of fuel? oil
Minimum distance to burnable material, from top of appliance or casing top of furnace over 15"
From top of smoke pipe over 15" From front of appliance over 4 From sides or back of appliance over 2'
Size of chimney flue 8x8 Other connections to same flue none
If gas fired, how vented? Rated maximum demand per hour
Will sufficient fresh air be supplied to the appliance to insure proper and safe combustion? yes

IF OIL BURNER

Name and type of burner Fluid Heat Labelled by underwriters' laboratories? yes
Will operator be always in attendance? Does oil supply line feed from top or bottom of tank? bottom
Type of floor beneath burner concrete Size of vent pipe 1 1/2"
Location of oil storage basement Number and capacity of tanks 1-275 gal.
Low water shut off Make No.
Will all tanks be more than five feet from any flame? yes How many tanks enclosed?
Total capacity of any existing storage tanks for furnace burners none

IF COOKING APPLIANCE

Location of appliance Any burnable material in floor surface or beneath?
If so, how protected? Height of Legs, if any
Skirting at bottom of appliance? Distance to combustible material from top of appliance?
From front of appliance From sides and back From top of smokepipe
Size of chimney flue Other connections to same flue
Is hood to be provided? If so, how vented? Forced or gravity?
If gas fired, how vented? Rated maximum demand per hour

MISCELLANEOUS EQUIPMENT OR SPECIAL INFORMATION

Amount of fee enclosed? 2.00 (\$2.00 for one heater, etc., 50 cents additional for each additional heater, in same building at same time.)

APPROVED:

C. K. 6-15-36 7120

Will there be in charge of the above work a person competent to see that the State and City requirements pertaining thereto are observed? yes

Fallotta Oil Co.

Signature of Installer

E. J. Fallotta

CITY OF PORTLAND PRINTING CO.

INSPECTION COPY

NOTES

1. Mill Page
2. Vent No. B-10-5E Comp. L. Col.
3. Kind of Heat (10)
4. Burner Rigidity & Supports
5. Name & Label
6. Stack Control
7. High Limit Control
8. Remote Control
9. Piping Support & Protection
10. Valves & Supply Lines
11. Capacity of Tank
12. Tank Rigidity & Supports
13. Tank Distance
14. Oil Gauge
15. Instruction Card
16. Low Water Shut-off

Approved

Date of Permit

Owner

Location

Permit No.

6/15/56

The Phoenix Corp.

100-104 Craig St.

57/025

