

CITY OF PORTLAND, MAINE  
Application for Permit to Install Wires

Permit No. 55216

Issued 9/22/66

Portland, Maine September 22, 1966

To the City Electrician, Portland, Maine:

The undersigned hereby applies for a permit to install wires for the purpose of conducting electric current, in accordance with the laws of Maine, the Electrical Ordinance of the City of Portland, and the following specifications:

(This form must be completely filled out — Minimum Fee, \$1.00)

Owner's Name and Address Herbie Desautels Tel. \_\_\_\_\_  
Contractor's Name and Address John E. Allen Inc Tel. 892 4831  
Location 160 Congress St Use of Building Home  
Number of Families 1 Apartments \_\_\_\_\_ Stores \_\_\_\_\_ Number of Stories \_\_\_\_\_  
Description of Wiring: New Work \_\_\_\_\_ Additions \_\_\_\_\_ Alterations \_\_\_\_\_  
Change service to 500 Amp. 208V  
Pipe \_\_\_\_\_ Cable \_\_\_\_\_ Metal Molding \_\_\_\_\_ BX Cable \_\_\_\_\_ Plug Molding (No. of feet) \_\_\_\_\_  
No. Light Outlets \_\_\_\_\_ Plugs \_\_\_\_\_ Light Circuits \_\_\_\_\_ Plug Circuits \_\_\_\_\_  
FIXTURES: No. \_\_\_\_\_ Light Switches \_\_\_\_\_ Fluor. or Strip Lighting (No. feet) \_\_\_\_\_  
SERVICE: Pipe \_\_\_\_\_ Cable ☒ Underground \_\_\_\_\_ No. of Wires 3 Size 7/0 Alum  
METERS: Relocated \_\_\_\_\_ Added \_\_\_\_\_ Total No. Meters \_\_\_\_\_  
MOTORS: Number \_\_\_\_\_ Phase \_\_\_\_\_ H. P. \_\_\_\_\_ Amps \_\_\_\_\_ Volts \_\_\_\_\_ Starter \_\_\_\_\_  
HEATING UNITS: Domestic (Oil) \_\_\_\_\_ No. Motors \_\_\_\_\_ Phase \_\_\_\_\_ H.P. \_\_\_\_\_  
Commercial (Oil) \_\_\_\_\_ No. Motors \_\_\_\_\_ Phase \_\_\_\_\_ H.P. \_\_\_\_\_  
Electric Heat (No. of Rooms) \_\_\_\_\_  
APPLIANCES: No. Ranges \_\_\_\_\_ Watts \_\_\_\_\_ Brand Feeds (Size and No.) \_\_\_\_\_  
Elec. Heaters \_\_\_\_\_ Watts \_\_\_\_\_  
Miscellaneous \_\_\_\_\_ Watts \_\_\_\_\_ Extra Cabinets or Panels \_\_\_\_\_  
Transformers \_\_\_\_\_ Air Conditioners (No. Units) \_\_\_\_\_ Signs (No. Units) \_\_\_\_\_  
Will commence \_\_\_\_\_ 19 \_\_\_\_\_ Ready to cover in will call 19 \_\_\_\_\_ Inspection \_\_\_\_\_ 19 \_\_\_\_\_  
Amount of Fee \$ 2.00  
Signed John E. Allen

DO NOT WRITE BELOW THIS LINE

SERVICE ☒ METER \_\_\_\_\_ GROUND ☒  
VISITS: 1 \_\_\_\_\_ 2 \_\_\_\_\_ 3 \_\_\_\_\_ 4 \_\_\_\_\_ 5 \_\_\_\_\_ 6 \_\_\_\_\_  
7 \_\_\_\_\_ 8 \_\_\_\_\_ 9 \_\_\_\_\_ 10 \_\_\_\_\_ 11 \_\_\_\_\_ 12 \_\_\_\_\_  
REMARKS:

CS 282

INSPECTED BY P.W. Huber  
(OVER)

Not Ready  
9/27/66  
No. W  
9/28/66

LOCATION CRAIGIE ST. 160  
 INSPECTION DATE 9/28/66  
 WORK COMPLETED 9/28/66  
 TOTAL NO. INSPECTIONS 1  
 REMARKS:

FEEES FOR WIRING PERMITS EFFECTIVE JULY 31, 1963

WIRING

1 to 30 Outlets (including switches) \$ 2.00  
 31 to 60 Outlets (including switches) 3.00  
 Over 60 Outlets, each Outlet (including switches) .05  
 (Each twelve feet or fraction thereof of fluorescent lighting or  
 any type of plug molding will be classed as one outlet).

SERVICES

Single Phase 2.00  
 Three Phase 4.00

MOTORS

Not exceeding 50 H.P. 3.00  
 Over 50 H.P. 4.00

HEATING UNITS

Domestic (Oil) 2.00  
 Commercial (Oil) 4.00  
 Electric Heat (Each Room) .75

APPLIANCES

Ranges, Cooking Tops, Ovens, Water Heaters, Disposals, Dish-  
 washers, etc. — Each Unit 1.50

TEMPORARY WORK (Limited to 6 months from date of permit)

Service, Single Phase 1.00  
 Service, Three Phase 2.00  
 Wiring, 1-50 Outlets 1.00  
 Wiring, each additional outlet over 50 .02  
 Chaises, Carnivals, Fairs, etc. 10.00

MISCELLANEOUS

Distribution Cabinet or Panel, per unit 1.00  
 Transformers, per unit 2.00  
 Air Conditioners, per unit 2.00

# PERMIT TO INSTALL PLUMBING

out- 7-24-64

14261

PERMIT NUMBER

Date Issued 7/22/64  
PORTLAND PLUMBING INSPECTOR

Address 160 Craigie Street  
Installation For: Mr. Bennett  
Owner of Bldg. 160 Craigie Street  
Owner's Address: 160 Craigie Street  
Plumber: Gammell Co. Date: 7/22/64

By J.P. Welch  
APPROVED FIRST INSPECTION

Date 7-24-64

By J.P. Welch  
APPROVED FINAL INSPECTION

Date JOSEPH P. WELCH  
CHIEF PLUMBING INSPECTOR

By TYPE OF BUILDING  
☐ COMMERCIAL  
☐ RESIDENTIAL  
☐ SINGLE  
☐ MULTI FAMILY  
☐ NEW CONSTRUCTION  
☐ REMODELING

NEW	REPL	PROPOSED INSTALLATIONS	FEES	REF
	1	SINKS Laundry Tray	1	\$200
		LAVATORIES		
		TOILETS		
		BATH TUBS		
		SHOWERS		
		DRAINS		
		HOT WATER TANKS		
		TANKLESS WATER HEATERS		
		GARBAGE GRINDERS		
		SEPTIC TANKS		
		HOUSE SEWERS		
		ROOF LEADERS (Conn. to house drain)		
1		Washing Machine	1	2.00

PORTLAND HEALTH DEPT. PLUMBING INSPECTION TOTAL \$4.00

☐ REMODELING

SM 12-53

PORTLAND HEALTH DEPT.

PLUMBING INSPECTION

Total 2 2.00

☐ MULTI FAMILY

☐ NEW CONSTRUCTION

☐ REMODELING

SM 12-53

PORTLAND HEALTH DEPT.

PLUMBING INSPECTION

Total 13 17.50

Diablock - Wash Machine

PERMIT  
NUMBER 5261

Date: 6/18/57  
PORTLAND PLUMBING  
INSPECTOR

By: J. J. Welch  
APPROVED FIRST INSPECTION

Date: June 18-57

By: J. J. Welch  
APPROVED FINAL INSPECTION

Date: June 18-57

By: J. J. Welch

TYPE OF BUILDING

☐ COMMERCIAL

☐ RESIDENTIAL

☐ SINGLE

☐ MULTI FAMILY

☐ NEW CONSTRUCTION

☐ REMODELING

SM 12-53 ☐

PORTLAND HEALTH DEPT.

PLUMBING INSPECTION

SM 12-53 ☐

PORTLAND HEALTH DEPT.

PLUMBING INSPECTION

SM 12-53 ☐

PERMIT TO INSTALL PLUMBING

Address: 160 Craigie St. Portland

Installation For: Mr. Saul Spier

Owner of Bldg.: same

Owner's Address: same

Plumber: Wilbur F. Blake, Inc.

Date: 6/18/57

NEW	REP'L	PROPOSED INSTALLATIONS	NUMBERS	FEE
		SINKS	2	1.0
		LAVATORIES		
		TOILETS		
		BATH TUBS		
		SHOWERS		
		DRAINS		
		HOT WATER TANKS	3	
		TANKLESS WATER HEATERS		
		GARBAGE GRINDERS		
		SEPTIC TANKS		
		HOUSE SEWERS		
		ROOF LEADERS (conn. to house drains)		

Total

2 1.0

2 1.00

13 17.50

Total

PERMIT NUMBER **4716**  
 Date Issued **2-15-57**  
 PORTLAND PLUMBING INSPECTOR  
 By **J. P. Welch**  
 APPROVED FIRST INSPECTION  
 Date **Feb 21-57**  
 By **J. P. Welch**  
 APPROVED FINAL INSPECTION  
 Date **June 17-57**  
 By **J. P. Welch**  
 TYPE OF BUILDING  
☐ COMMERCIAL  
☐ RESIDENTIAL  
☐ SINGLE  
☐ MULTI FAMILY  
☐ NEW CONSTRUCTION  
☐ REMODELING

PERMIT TO INSTALL PLUMBING  
 Address **160 E. Craigie St.**  
 Installation For: **Charles H. Sheriff**  
 Owner of Bldg.: **160 Craigie St.**  
 Owner's Address: **160 Craigie St.**  
 Plumber: **William F. Blake Inc.** Date: **2-15-57**

PROPOSED INSTALLATIONS		NUMBER	FE
NEW	REPL		
1	SINKS	1	1.0
3	LAVATORIES	3	3.0
3	TOILETS	3	1.6
2	BATH TUBS	2	.6
1	SHOWERS	1	
1	DRAINS		
	HOT WATER TANKS	3	
	TANKLESS WATER HEATERS	1	3
	GARBAGE GRINDERS		
1	SEPTIC TANKS		
	HOUSE SEWERS		
2	ROOF LEADERS (conn. to house drain)	2	1.60
	<b>Dishwash - Wash Machine</b>		
	<b>Total</b>	<b>13</b>	<b>7.45</b>

PORTLAND HEALTH DEPT.  
 PLUMBING INSPECTION

154-162

THOMAS A. SANDERS  
ATTORNEY AND COUNSELLOR AT LAW  
PORTLAND, MAINE

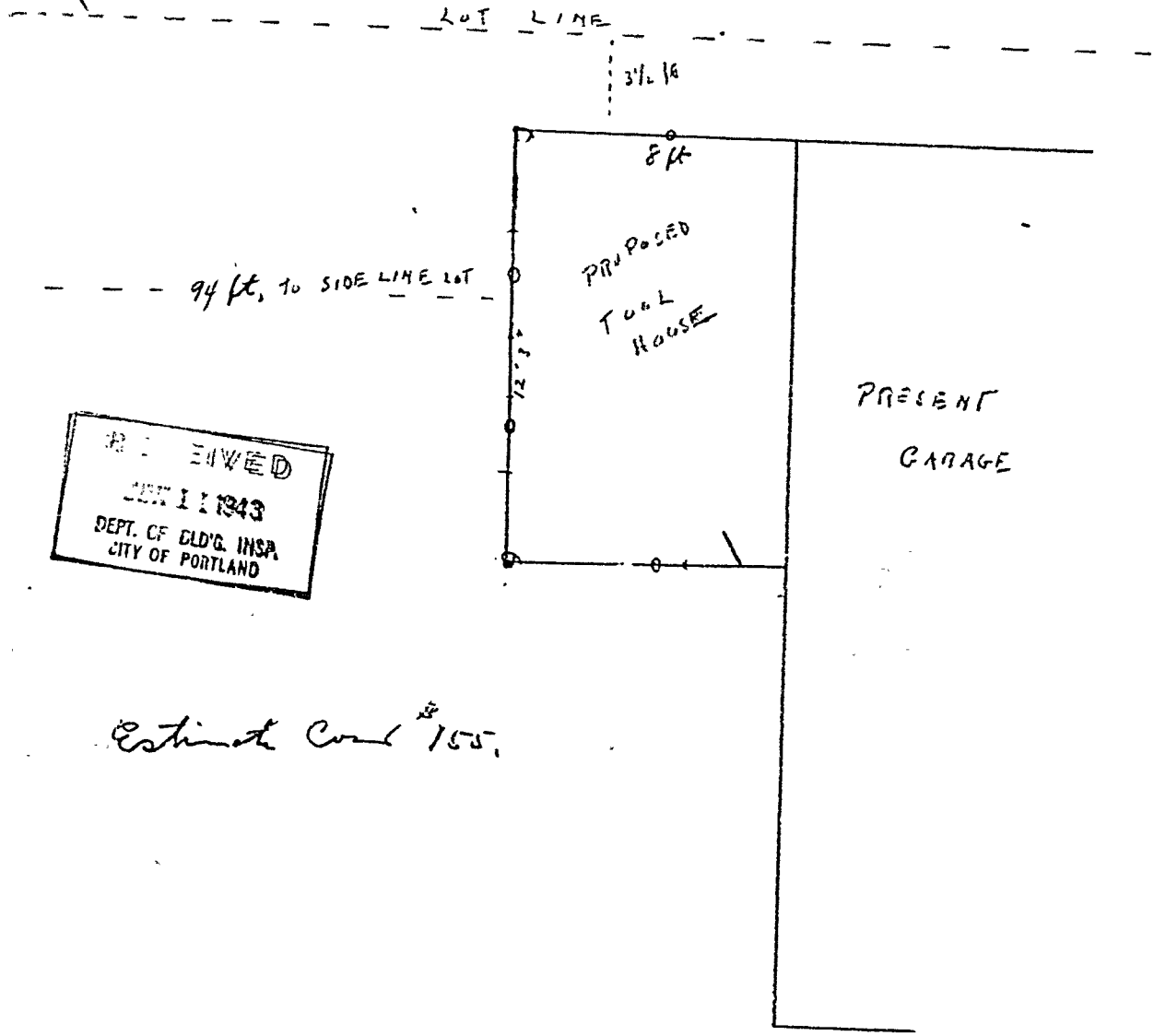

Estimated Cost \$155.

136'  
47 Craigie St.



RESIDENCE ZONE - A  
APPLICATION FOR PERMIT

Class of Building or Type of Structure Third Class

PERMIT ISSUED  
Permit No. 7737

JUN 11 1914

Portland, Maine, June 11, 1914

To the INSPECTOR OF BUILDINGS, PORTLAND, ME.

The undersigned hereby applies for a permit to erect-alter install the following building structure, equipment in accordance with the Laws of the State of Maine, the Building Code of the City of Portland, plans and specifications, if any, submitted herewith and the following specifications:

Location 47 Craigie Street Within Fire Limits? no Dist. No. \_\_\_\_\_  
Owner's-or-Lessee's name and address Thomas A. Sanders, 17 Craigie St. Telephone 2-1776  
Contractor's name and address George Sears, 22 Cottage St Telephone \_\_\_\_\_  
Architect \_\_\_\_\_ Plans filed yes No. of sheets 1  
Proposed use of building 2 car garage and tool house (storage of lawn mower and garden tools) No. families \_\_\_\_\_  
Other buildings on same lot dwelling house  
Estimated cost \$ 155. Fee \$ 1.00

Description of Present Building to be Altered

Material wood No. stories 1 Heat none Style of roof pitch Roofing asphalt  
Last use 2 car garage No. families \_\_\_\_\_

General Description of New Work

To bu'ld one story frame addition <sup>south</sup> 8' x 12' 3" on side of existing garage

It is understood that this permit does not include installation of heating apparatus which is to be taken out separately by the heating contractor.

Details of New Work

Is any plumbing work involved in this work? \_\_\_\_\_  
Is any electrical work involved in this work? \_\_\_\_\_ Height average grade to top of plate \_\_\_\_\_  
Size, front \_\_\_\_\_ depth \_\_\_\_\_ No. stories \_\_\_\_\_ Height average grade to highest point of roof 7' 6"  
To be erected on solid or filled land? solid earth or rock? earth  
Material of foundation cedar posts Thickness, top \_\_\_\_\_ bottom \_\_\_\_\_ cellar \_\_\_\_\_  
Material of underpinning \_\_\_\_\_ Height \_\_\_\_\_ Thickness \_\_\_\_\_  
Kind of roof flat Rise per foot 2" Roof covering Asphalt roofing Class C Unl. Lab.  
No. of chimneys no Material of chimneys \_\_\_\_\_ of lining \_\_\_\_\_  
Kind of heat no Type of fuel \_\_\_\_\_ Is gas fitting involved? \_\_\_\_\_  
Framing lumber—Kind hemlock Dressed or full size? dressed  
Corner posts 4x4 Sills 4x6 Girt or ledger board? \_\_\_\_\_ Size \_\_\_\_\_  
Material columns under girders \_\_\_\_\_ Size \_\_\_\_\_ Max. on centers \_\_\_\_\_  
Studs (outside walls and carrying partitions) 2x4-16" O. C. Girders 6x8 or larger. Bridging in every floor and flat roof span over 8 feet. Sills and corner posts all one piece in cross section.  
Joists and rafters: 1st floor 2x6, 2nd \_\_\_\_\_, 3rd \_\_\_\_\_, roof 2x6  
On centers: 1st floor 16", 2nd \_\_\_\_\_, 3rd \_\_\_\_\_, roof 16"  
Maximum span: 1st floor 21', 2nd \_\_\_\_\_, 3rd \_\_\_\_\_, roof 21'

If one story building with masonry walls, thickness of walls? \_\_\_\_\_ height? \_\_\_\_\_

If a Garage

No. cars now accommodated on same lot 2, to be accommodated 2

Total number commercial cars to be accommodated none

Will automobile repairing be done other than minor repairs to cars habitually stored in the proposed building? no

Miscellaneous

Will above work require removal or disturbing of any shade tree on a public street? no

Will there be in charge of the above work a person competent to see that the State and City requirements pertaining thereto are observed? yes

INSPECTION COPY

Signature of owner THOMAS A. SANDERS

NOTIFICATION BEFORE ERECTION  
OR CLOSURE OF SAME  
IS WAIVED  
CERTIFICATE OF COMPLIANCE  
REQUIREMENT IS WAIVED

3340

Permit No. 43/537  
Location 49 Craigie St.  
Owner Thomas G. Sanders  
Date of permit 6/11/43.  
Notif. closing-in \_\_\_\_\_  
Inspn. closing-in \_\_\_\_\_  
Final Notif. \_\_\_\_\_  
Final Inspn. 6/30/43  
Cert. of Occupancy issued None

NOTES

6/23/43 - Work started  
at 9:00  
6/30/43 - Work about  
completed - 9:00

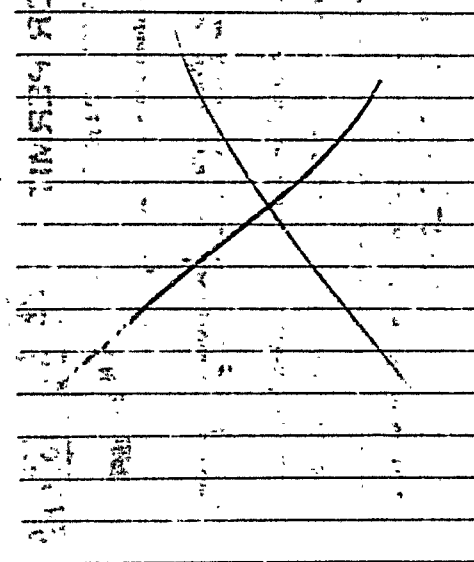





FILL IN COMPLETELY AND SIGN WITH INK

PERMIT ISSUED

Permit No. 1358  
OCT 7 1937

APPLICATION FOR PERMIT FOR HEATING, COOKING OR POWER EQUIPMENT

To the INSPECTOR OF BUILDINGS, PORTLAND, ME.

Portland, Maine, October 7, 1937.

The undersigned hereby applies for a permit to install the following heating, cooking or power equipment in accordance with the Laws of Maine, the Building Code of the City of Portland, and the following specifications:

Location 47 Craig St. Use of Building Residence No. Stories 2  
Name and address of owner Arthur T. Spring Ward 8  
Contractor's name and address Randall & McAllister 84 Commercial Telephone 3-2941

General Description of Work

To install Timken Burner to existing steam heat

IF HEATER, POWER BOILER OR COOKING DEVICE

Is heater or source of heat to be in cellar? yes If not, which story \_\_\_\_\_ Kind of Fuel Oil  
Material of supports of heater or equipment (concrete floor or what kind) Concrete  
Minimum distance to wood or combustible material, from top of boiler or casing top of furnace, \_\_\_\_\_  
from top of smoke pipe \_\_\_\_\_, from front of heater \_\_\_\_\_ from sides or back of heater \_\_\_\_\_  
Size of chimney flue \_\_\_\_\_ Other connections to same flue \_\_\_\_\_

IF OIL BURNER

Name and type of burner Timken Labeled and approved by Underwriters' Laboratories? yes  
Will operator be always in attendance? \_\_\_\_\_ Type of oil feed (gravity or pressure) Pressure  
Location oil storage Buried tank No. and capacity of tanks 1,000 gal  
Will all tanks be more than seven feet from any flame? yes How many tanks fireproofed? \_\_\_\_\_  
Amount of fee enclosed? 1.00 (\$1.00 for one heater, etc., 50 cents additional for each additional heater, etc., in same building at same time.)

INSPECTION COPY

Signature of contractor Randall & McAllister

W. B. Bently

46

Ward 8 Permit No. 37/1658  
 Location #4 Craigie St.  
 Owner Arthur T. Spung  
 Date of permit 10/7/37  
 Post Card sent 10/7/37  
 Notif. for insp. 10/11/37  
 Approval Tax issued 10/11/37 - 16  
 Oil Burner Check List (date) 10/13/37  
 1. Kind of heat Steam  
 2. Label 1176905  
 3. Anti-siphon ☒  
 4. Oil storage ☒  
 5. Tank distance ☒  
 6. Vent pipe ☒  
 7. Fill pipe ☒  
 8. Gauge ☒  
 9. Rigidity ☒  
 10. Feed safety ☒  
 11. Pipe sizes and material ☒  
 12. Control valve ☒  
 13. Ash pit vent ☒  
 14. Temp. or pressure safety ☒  
 15. Instruction card ☒  
 16. Draft stat in smoke pipe

NOTES

Zussdale Automatic oil  
 Pump used to convert  
 gravity to pressure feed.  
 C.H.

Zussdale Automatic  
 Oil Pump

Zussdale Co.  
 10/11/37



192

No. 6132

APPLICATION FOR  
PERMIT TO BUILD 3d CLASS BUILDING

LOCATION

No. 160 49 Craigie

Ward 8

Inspector.

CONDITIONS

PERMIT GRANTED

June 25, 1921 192

Permit filled out by

Permit number

Plan number

FINAL REPORT

192

Has the work been completed in accordance with  
this application and plans filed and approved?

Law been violated?

Natu. : of violation?

Violation removed when? 192

Estimated cost of building, etc., \$

Building Inspector.

APPROVAL OF PLANS

Supervisor of plans:



Location, ownership and detail must be correct, complete and legible. Separate application required for every building. Plans must be filed with this application

## APPLICATION FOR PERMIT TO BUILD

(3d CLASS BUILDING)

Portland, Me., June 25, 1921 19

TO THE

INSPECTOR OF BUILDINGS

The undersigned hereby applies for a permit to build, according to the following Specifications:—

Location 160 49 Craigie Wd. 8  
Name of owner is? Arthur T Spring Address 68 Prospect  
Name of mechanic is? Porter Burnham " 71 Kennebec  
Name of architect is? \_\_\_\_\_  
Proposed occupancy of building (purpose)? dwelling  
If a dwelling or tenement house, for how many families? 1  
Are there to be stores in lower story? \_\_\_\_\_  
Size of lot, No. of feet front? \_\_\_\_\_; No. of feet rear? \_\_\_\_\_; No. of feet deep? \_\_\_\_\_  
Size of building, No. of feet front? 28ft; No. of feet rear? 28ft; No. of feet deep? 24ft  
No. of stories, front? 2; rear? \_\_\_\_\_  
No. of feet in height from the mean grade of street to the highest part of the roof? 26ft  
Distance from lot lines, front? \_\_\_\_\_ feet; side? \_\_\_\_\_ feet; side? \_\_\_\_\_ feet; rear? \_\_\_\_\_  
Firestop to be used? yes  
Will the building be erected on solid or filled land? \_\_\_\_\_  
Will the foundation be laid on earth, rock or piles? \_\_\_\_\_  
If on piles, No. of rows? \_\_\_\_\_ distance on centres? \_\_\_\_\_ length of? \_\_\_\_\_  
Diameter, top of? \_\_\_\_\_ diameter, bottom of? \_\_\_\_\_  
Size of posts? 4x6 Studding 2x4 16 O C Sills 4x8 Roof Rafters 2x6 24 O C Girder 6x8  
" girts? 4x4  
" floor timbers? 1st floor 2x8, 2d \_\_\_\_\_, 3d \_\_\_\_\_, 4th \_\_\_\_\_  
O. C. " " " 16, " \_\_\_\_\_, " \_\_\_\_\_, " \_\_\_\_\_  
Span " " " not over 16 ft, " \_\_\_\_\_, " \_\_\_\_\_, " \_\_\_\_\_  
Braces, how put in? \_\_\_\_\_  
Building, how framed? \_\_\_\_\_  
Material of foundation? concrete thickness of? 12in laid with mortar? \_\_\_\_\_  
Underpinning, material of? brick height of? 3ft thickness of? 8in  
Will the roof be flat, pitch, mansard, or hip? pitch Material of roofing? asphalt  
Will the building be heated by steam, furnaces, stoves, or grates? steam Will the flues be lined? yes  
Will the building conform to the requirements of the law? yes  
No. of brick walls? \_\_\_\_\_ and where placed? \_\_\_\_\_  
Means of egress? \_\_\_\_\_

If the building is to be occupied as a Tenement House, give the following particulars:

What is the height of cellar or basement? \_\_\_\_\_  
What will be the clear height of first story? \_\_\_\_\_ second? \_\_\_\_\_ third? \_\_\_\_\_  
State what means of egress is to be provided? \_\_\_\_\_  
Scuttle and stepladder to roof? \_\_\_\_\_

Estimated Cost,

\$ 14,000.

Signature of owner or authorized representative,

Paul Burnham Co

Address,

Plans submitted? \_\_\_\_\_ Received by? \_\_\_\_\_

PERMIT MUST BE RECEIVED BEFORE BEGINNING WORK.

192

No. 6131

APPLICATION FOR  
PERMIT TO BUILD 3d CLASS BUILDING

LOCATION

No. 160  
42 Craigie

Ward 8

Inspector.

CONDITIONS

PERMIT GRANTED

June 25, 1921 192

Permit filled out by

Permit number

Plan number

FINAL REPORT

192

Has the work been completed in accordance with  
this application and plans filed and approved?

Law been violated?

Nature of violation?

Violation removed when? 192

Estimated cost of building, etc., \$

Building Inspector.

APPROVAL OF PLANS

Supervisor of plans.

# APPLICATION FOR PERMIT

PERMIT ISSUED

B.O.C.A. USE GROUP .....  
 B.O.C.A. TYPE OF CONSTRUCTION ..... 0.77.2  
 ZONING LOCATION ..... PORTLAND, MAINE June 3, 1985

June 17 1985  
 City Of Portland

To the CHIEF OF BUILDING & INSPECTION SERVICES, PORTLAND, MAINE

The undersigned hereby applies for a permit to erect, alter, repair, demolish, move or install the following building, structure, equipment or change use in accordance with the Laws of the State of Maine, the Portland B.O.C.A. Building Code and Zoning Ordinance of the City of Portland with plans and specifications, if any, submitted herewith and the following specifications:

LOCATION ..... 160 Craigie St. Fire District #1 ☐ #2 ☐  
 1. Owner's name and address ..... Herbert Bennett - same Telephone # 773-4775  
 2. Lessee's name and address ..... Superior Bldg Contractors - 263 1/2 St. John St. Telephone # 772-1742  
 3. Contractor's name and address .....  
 Proposed use of building ..... 2 car detached garage No. of sheets .....  
 Last use ..... No. families .....  
 Material ..... No. stories ..... Heat ..... Style of roof ..... Roofing .....  
 Other buildings on same lot .....  
 Estimated contractual cost \$ ..... 7,600

FIELD INSPECTOR—Mr. ....  
 @ 775-5451

Appeal Fees \$ .....  
 Base Fee ..... 50.00  
 Late Fee ..... 25.00  
 TOTAL \$ ..... 75.00

To demolish 18' x 22' garage and to construct  
 2 car detached garage as per plans. 1 sheet of plans.

Stamp of Special Conditions

send permit to # 3 04103

**NOTE TO APPLICANT:** Separate permits are required by the installers and subcontractors of heating, plumbing, electrical and mechanicals.

## no DETAILS OF NEW WORK

yes

Is any plumbing involved in this work? ..... Is any electrical work involved in this work? .....  
 Is connection to be made to public sewer? ..... If not, what is proposed for sewage? .....  
 Has septic tank notice been sent? ..... Form notice sent? .....  
 Height average grade to top of plate ..... Height average grade to highest point of roof .....  
 Size, front ..... depth ..... No. stories ..... solid or filled land? ..... earth or rock? .....  
 Material of foundation ..... Thickness, top ..... bottom ..... cellar .....  
 Kind of roof ..... Rise per foot ..... Roof covering .....  
 No. of chimneys ..... Material of chimneys ..... of lining ..... Kind of heat ..... fuel .....  
 Framing Lumber—Kind ..... Dressed or full size? ..... Corner posts ..... Sills .....  
 Size Girder ..... Columns under girders ..... Size ..... Max. on centers .....  
 Studs (outside walls and carrying partitions) 2x4-16" O. C. Bridging in every floor and flat roof span over 8 feet.  
 Joists and rafters: 1st floor ..... 2nd ..... 3rd ..... roof .....  
 On centers: 1st floor ..... 2nd ..... 3rd ..... roof .....  
 Maximum span: 1st floor ..... 2nd ..... 3rd ..... roof .....  
 If one story building with masonry walls, thickness of walls? ..... height? .....

## IF A GARAGE

No. cars to be accommodated on same lot ..... to be accommodated ..... number commercial cars to be accommodated .....  
 Will automobile repairing be done other than minor repairs to cars habitually stored in the proposed building? .....

APPROVALS BY: DATE  
 BUILDING INSPECTION—PLAN EXAMINER .....  
 ZONING: .....  
 BUILDING CODE: .....  
 Fire Dept.: .....  
 Health Dept.: .....  
 Others: .....

MISCELLANEOUS  
 Will work require disturbing of any tree on a public street? .....  
 Will there be in charge of the above work a person competent to see that the State and City requirements pertaining thereto are observed? .....

Signature of Applicant ..... Earl Wycotte  
 Type Name of above ..... Earl Wycotte for Superior Bldg. Contractors  
 Other .....  
 and Address .....

FIELD INSPECTOR'S COPY

APPLICANT'S COPY

OFFICE FILE COPY

# APPLICATION FOR PERMIT

B.O.C.A. USE GROUP .....  
 B.O.C.A. TYPE OF CONSTRUCTION ..... 0 772  
 ZONING LOCATION R-3 PORTLAND, MAINE June 3, 1985

PERMIT ISSUED

000 17 1985

To the CHIEF OF BUILDING & INSPECTION SERVICES, PORTLAND, MAINE

The undersigned hereby applies for a permit to erect, alter, repair, demolish, move or install the following building, structure, equipment or change use in accordance with the Laws of the State of Maine, the Portland B.O.C.A. Building Code and Zoning Ordinance of the City of Portland with plans and specifications, if any, submitted herewith and the following specifications:

LOCATION 160 Craigie St. Fire District #1 ☐ #2 ☐  
 1. Owner's name and address Herbert Bennett - same Telephone W-773-4775  
 2. Lessee's name and address Telephone 772-1742  
 3. Contractor's name and address Superior Bldg. Contractors, 263 1/2 St. John St. Telephone 772-1742

Proposed use of building 2 car detached garage No. of sheets .....  
 Last use ..... No. families .....  
 Material ..... No. stories ..... Heat ..... Style of roof ..... Roofing .....

Other buildings on same lot .....  
 Estimated contractual cost \$ 7,600

FIELD INSPECTOR—Mr. @ 775-5451

Appeal Fees \$ .....  
 Base Fee 50.00  
 Late fee 25.00  
 TOTAL \$ 75.00

To demolish 18' x 22' garage and to construct  
 2 car detached garage as per plans. 1 sheet of plans.

Stamp of Special Conditions

send permit to # 3 04103

NOTE TO APPLICANT: Separate permits are required by the installers and subcontractors of heating, plumbing, electrical and mechanicals.

## DETAILS OF NEW WORK

Is any plumbing involved in this work? no Is any electrical work involved in this work? yes  
 Is connection to be made to public sewer? If not, what is proposed for sewage?  
 Has septic tank notice been sent? Form notice sent?  
 Height average grade to top of plate Height average grade to highest point of roof  
 Size, front depth No. stories solid or filled land? earth or rock?  
 Material of foundation Thickness, top bottom cellar  
 Kind of roof Rise per foot Roof covering  
 No. of chimneys Material of chimneys of lining Kind of heat fuel  
 Framing Lumber—Kind Dressed or full size? Corner posts Sills  
 Size Girder Columns under girders Size Max. on centers  
 Studs (outside walls and carrying partitions) 2x4-16" O. C. Bridging in every floor and flat roof span over 8 feet.  
 Joists and rafters: 1st floor 2nd 3rd roof  
 On centers: 1st floor 2nd 3rd roof  
 Maximum span: 1st floor 2nd 3rd roof  
 If one story building with masonry walls, thickness of walls? height?

## IF A GARAGE

No. cars now accommodated on same lot to be accommodated number commercial cars to be accommodated  
 Will automobile repairing be done other than minor repairs to cars habitually stored in the proposed building?

## APPROVALS BY:

BUILDING INSPECTION PLAN EXAMINER DATE 7/15/85  
 ZONING: ON 7/15/85  
 BUILDING CODE:  
 Fire Dept.:  
 Health Dept.:  
 Others:

## MISCELLANEOUS

Will work require disturbing of any tree on a public street? no  
 Will there be in charge of the above work a person competent to see that the State and City requirements pertaining thereto are observed? yes

Signature of Applicant Earl Waycotte Phone # same  
 Type Name of above Earl Waycotte for 1 ☐ 2 ☐ 3 ☒ 4 ☐  
 Superior Bldg. Contractor  
 and Address

FIELD INSPECTOR'S COPY

APPLICANT'S COPY

OFFICE FILE COPY

2 Mr. Carroll



Permit No. 857723  
Location 1614 Avenue C St.  
Owner Shelly & Son  
Date of permit 6-3-85  
Approved 7-18-85  
Dwelling  
Garage 2 car detached  
Alteration

NOTES

Handwritten notes and a large 'X' mark on the first set of lines.

Two columns of horizontal lines for additional notes or specifications.

# APPLICATION FOR SUBMETER



RECEIVED

MAY 2 1979

PUBLIC WORKS ENGINEERING

## For Sewer User Charge Adjustments

The undersigned hereby requests permission to install additional water meter(s) in accordance with Section 322.6C of the "Municipal Code of the City of Portland, Maine".

It is understood that all expenses related to the purchase, installation and maintenance of the meter(s) is to be borne by the applicant.

### To be Completed by Applicant

Address where sub-meter is requested 160 Craigie Street

Property owner name Herbert H. Bennett and Elaine L. Bennett

Tax Map Reference (on Real Estate Tax Bill) 120-A-14-15 Craigie St. 154-161

Property owner address 160 Craigie St. Portland

Person to be contacted to schedule inspections Elaine Bennett 773-4775 or 775-2702  
(Name and Telephone Number)

Portland Water District Acct. No. (on bill) D-29-21008

Billing Name & Address (on bill) HERBERT H. BENNETT

160 Craigie St. Portland Mo.

Location and size existing Portland Water District Service Meter located in Basement  
3/4" piping

Proposed location and size of sub-meter to be located in basement near water pipe  
serving outside faucet

Will a remote reading register be utilized? ☒ NO ☐ YES (If yes, state location Next to Existing meter)

Description of proposed changes in plumbing required for submetering:

None cut in sub-meter after existing stop & waste before outside sillcock

Sketch plan showing proposed changes in plumbing and the location of existing and proposed meters. Show water flow through submeter to non-discharge equipment or location (use additional sheet of paper if necessary)

CRABIE St.

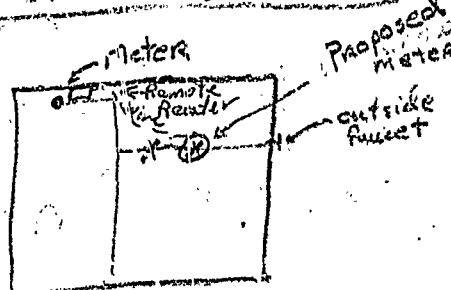

The volume of water to be submetered can be shown not to enter the sewerage system by virtue of its use for:

watering the grass & shrubs

I certify the above information is true and correct:

Elaine L. Bennett  
Signature

May 1, 1979  
Date

# INSTRUCTIONS

First - The applicant is to complete front of this form. The Tax Map Reference can be found on your Real Estate Tax Bill directly following owners name and address in the center of your Property Tax Bill. Billing name and address should be copied from your Water & Sewer Bill as well as the Portland Water District Account Number which is in the lower left corner of the meter and sewer bill.

Second - Mail completed application form to:

City of Portland  
Dept. of Public Works  
424 City Hall  
Portland, Maine 04101

ATTN: MR. WILLIAM GOODWIN

Third - The Public Works Department will call the person indicated on front side to schedule pre-installation inspection. During this inspection the Public Works section of this form (below) will be completed. Following this inspection Public Works will make copies of the application form. If the application is approved 3 copies will be made, one will be mailed to the Portland Water District, one will be forwarded to the City Plumbing Inspector and one will be mailed back to the Applicant. If the application is denied, one copy will be made and mailed to the applicant showing reason for denial.

Fourth - Upon receipt of a copy of the approved application, the applicant can purchase and install the sub-meter as approved. Following installation the applicant or his plumber must call the Chief Plumbing Inspector at 775-5451 Ext. 234 for an inspection of the completed installation. Following inspection by the Chief Plumbing Inspector, the Water District will be requested to seal the sub-meter and arrange to have an automatic reading system (if applicable - See General Information) instituted where by the volume shown by the sub-meter will be credited on the Sewer User Charges of the Bill.

# GENERAL INFORMATION

Section 322.6C of the "Municipal Code of the City of Portland, Maine" reads as follows:

"Submetering of Water Volume. Any person who feels that recorded water records are not a reliable index of his discharge volume may install an additional water meter of a type approved by the Director to measure the volume of water which can be shown not to enter the sewerage system. The person installing such a meter shall immediately notify the Director of such installation and shall be responsible to the Director for reporting meter readings, not less often than every three months. Such person shall be credited with the volume charges for the volume shown by such meter, which meter shall be accessible for reading by the City or its agents at all reasonable times."

The City and the District have arranged to relieve the customer from the reporting responsibility required above if both meters can be read simultaneously by the District Meter Readers during their regularly scheduled visits to read the pre-existing service meter. This can be accomplished by locating the sub-meter directly adjacent to the pre-existing service meter or by equipping the sub-meter located elsewhere with a remote reading register located so both readings can be made at the same time.

Approved meters are, Neptune and Rockwell meters, conforming to the following specifications:

1. shall meet or exceed ANWA accuracy test requirements and be accompanied by a certificate of test accuracy.
2. the meters will have straight readings, cubic foot registers.
3. the meters will have the meter number stamped into the main case.
4. the meters shall be magnetic drive.
5. shall have either a rotating disc or oscillating piston.
6. shall have a bronze case.

Approved meters are available from the Water District, which sells them for the price the District buys them from the manufacturer. If you wish to purchase a sub-meter from the District you must bring your copy of an approved application with you at time of purchase.

# TO BE COMPLETED BY PUBLIC WORKS

Pre-installation inspection by William B. Goodwin  
on June 18, 1979

Automatic reading system requested ☒ YES ☐ NO

☐ A Watts No. 8 A Back Flow Preventer or equal shall be installed on the hose bibb

Application ☒ Approved ☐ Denied

Comments \_\_\_\_\_

# TO BE COMPLETE BY THE PLUMBING INSPECTOR

An inspection of the completed installation of the submetering system approved on this application was conducted on 7-3-79 by Ernold R. Goodwin, Chief Plumbing Inspector, of the City of Portland.

☒ The submetering system was installed as approved.

☒ No cross connections were found.

The installation is ☒ approved ☐ dis-approved

# TO BE COMPLETED BY THE WATER DISTRICT

Date submeter sold 6-26-79  
Submeter account number 229-21008  
Submeter make and number SK 25281628  
Submeter installation readings 0  
Submeter account entered into computer \_\_\_\_\_  
Submeter account entered into meter book 6-26-79  
Special Instructions Note to Computer