



Bedford Street

- 7 BEDFORD STREET



# APPLICATION FOR PERMIT

001061

PERMIT ISSUED

NOV 26 1979

B.O.C.A. USE GROUP

B.O.C.A. TYPE OF CONSTRUCTION

PORTLAND, MAINE, 11-26-79

CITY of PORTLAND

ZONING LOCATION

To the DIRECTOR OF BUILDING & INSPECTION SERVICES, PORTLAND, MAINE  
The undersigned hereby applies for a permit to erect, alter, repair, demolish, move or install the following building, structure, equipment or change use in accordance with the Laws of the State of Maine, the Portland B.O.C.A. Building Code and Zoning Ordinance of the City of Portland with plans and specifications, if any, submitted herewith and the following specifications:

LOCATION 7 Bedford Street Fire District #1  #2   
 1. Owner's name and address Iris Pulkkinen - RFD #1, Hebron, Me. Telephone 966-3695  
 2. Lessee's name and address Telephone  
 3. Contractor's name and address owner Plans No. of sheets  
 4. Architect Specifications No. families  
 Proposed use of building tree shed for storage Roofing  
 Last use No. stories Heat Style of roof  
 Material Other buildings on same lot Fee \$ 5.50  
 Estimated contractual cost \$

FIELD INSPECTOR—Mr. @ 775-5451 To construct small storage shed for Christmas  
 This application is for: Ext. 234 tree shelter. Temporary 11-29-79 to December  
 24, 1979.

Dwelling  
 Garage  
 Masonry Bldg.  
 Metal Bldg.  
 Alterations  
 Demolitions  
 Change of Use  
 Other  
 NOTE TO APPLICANT: Separate permits are required by the installer and subcontractors of heating, plumbing, electrical and mechanicals.

PERMIT IS TO BE ISSUED TO 1  2  3  4

### DETAILS OF NEW WORK

Is any plumbing involved in this work? Is any electrical work involved in this work?  
 Is connection to be made to public sewer? If not, what is proposed for sewage?  
 Has septic tank notice been sent? Form notice sent?  
 Height average grade to top of plate Height average grade to highest point of roof  
 Size, front depth No. stories solid or filled land? earth or rock?  
 Material of foundation Thickness, top bottom cellar  
 Kind of roof Rise per foot Roof covering Kind of heat fuel  
 No. of chimneys Material of chimneys of lining Corner posts Sills  
 Framing Lumber—Kind Dressed or full size? Size Max. on centers  
 Size Girder Columns under girders O. C. Bridging in every floor and flat roof span over 8 feet.  
 Studs (outside walls and carrying partitions) 2x4-16" 1st floor 2nd 3rd roof  
 Joists and rafters: 1st floor 2nd 3rd roof  
 On centers: 1st floor 2nd 3rd roof  
 Maximum span: 1st floor 2nd 3rd height?  
 If one story building with masonry walls, thickness of walls?

### IF A GARAGE

No. cars now accommodated on same lot to be accommodated number commercial cars to be accommodated  
 Will automobile repairing be done other than minor repairs to cars habitually stored in the proposed building?

### MISCELLANEOUS

Will work require disturbing of any tree on a public street?  
 Will there be in charge of the above work a person competent to see that the State and City requirements pertaining thereto are observed?

### APPROVALS BY:

DATE  
 BUILDING INSPECTION—PLAN EXAMINER  
 ZONING:  
 BUILDING CODE:  
 Fire Dept.:  
 Health Dept.:  
 Others:

Signature of Applicant Iris Pulkkinen  
 Type Name of above Iris Pulkkinen

Phone # 966-3695

1  2  3  4   
 Other  
 and Address

FIELD INSPECTOR'S COPY



# APPLICATION FOR PERMIT

**PERMIT ISSUED**

NOV 20 1980

B.O.C.A. USE GROUP .....

B.O.C.A. TYPE OF CONSTRUCTION .....

ZONING LOCATION PORTLAND, MAINE

985  
NOV. 20, 1980

CITY OF PORTLAND

To the DIRECTOR OF BUILDING & INSPECTION SERVICE

The undersigned hereby applies for a permit to erect, alter, demolish, move or install the following building, structure, equipment or change use in accordance with the Laws of the State of Maine, the Portland B.O.C.A. Building Code and Zoning Ordinance of the City of Portland with plans and specifications, if any, submitted herewith and the following specifications:

LOCATION 7 Bedford St.

1. Owner's name and address Iris Pulkkinen - RFD #1, Hebron Me. Fire District #1  #2

2. Lessee's name and address ..... Telephone 966-3695

3. Contractor's name and address owner Telephone .....

4. Architect ..... Telephone .....

Proposed use of building Storage shed for selling Christmas Trees Specifications ..... Plans ..... No. of sheets .....

Last use ..... No. families .....

Material ..... No. stories ..... Heat ..... Style of roof ..... Roofing .....

Other buildings on same lot ..... No. families .....

Estimated contractual cost \$ ..... Fee \$ 5.50

FIELD INSPECTOR—Mr. ....

### GENERAL DESCRIPTION

This application is for: @ 775-5451  
Ext. 234

To construct small storage shed for Christmas tree shelter. Temporary from Nov. 21 to Dec. 24, 1980

Stamp of Special Conditions

NOTE TO APPLICANT: Separate permits are required by the installers and subcontractors of heating, plumbing, electrical and mechanicals.

PERMIT IS TO BE ISSUED TO 1  2  3  4

Other: .....

### DETAILS OF NEW WORK

Is any plumbing involved in this work? ..... Is any electrical work involved in this work? .....

Is connection to be made to public sewer? ..... If not, what is proposed for sewage? .....

Has septic tank notice been sent? ..... Form notice sent? .....

Height average grade to top of plate ..... Height average grade to highest point of roof .....

Size: front ..... depth ..... No. stories ..... solid or filled land? ..... earth or rock? .....

Material of foundation ..... Thickness, top ..... bottom ..... cellar .....

Kind of roof ..... Rise per foot ..... Roof covering ..... Kind of heat ..... fuel .....

No. of chimneys ..... Material of chimneys ..... of lining ..... Sills .....

Framing Lumber—Kind ..... Dressed or full size? ..... Corner posts ..... Max. on centers .....

Size Girder ..... Column under girders ..... Size ..... Bridging in every floor and flat roof span over 8 feet. ....

Joists and rafters: 1st floor ..... 2nd ..... 3rd ..... roof .....

On centers: 1st floor ..... 2nd ..... 3rd ..... roof .....

Maximum span: 1st floor ..... 2nd ..... 3rd ..... roof .....

If one story building with masonry walls, thickness of walls? ..... height? .....

### IF A GARAGE

No. cars now accommodated on same lot ..... to be accommodated ..... number commercial cars to be accommodated .....

Will automobile repairing be done other than minor repairs to cars habitually stored in the proposed building? .....

### APPROVALS BY:

BUILDING INSPECTION—PLAN EXAMINER ..... DATE .....

### MISCELLANEOUS

ZONING: ..... Will work require disturbing of any tree on a public street? .....

BUILDING CODE: ..... Will there be in charge of the above work a person competent to see that the State and City requirements pertaining thereto are observed? .....

Fire Dept.: .....

Health Dept.: .....

Others: .....

Signature of Applicant Iris Pulkkinen Phone # 966-3695

Type Name of above Iris Pulkkinen 1  2  3  4

Other .....

and Address .....

FIELD INSPECTOR'S COPY



APPLICATION FOR PERMIT

PERMIT ISSUED

B.O.C.A. USE GROUP

001015 NOV 29 1978

B.O.C.A. TYPE OF CONSTRUCTION

ZONING LOCATION

PORTLAND, MAINE, 11-29-78

CITY OF PORTLAND

To the DIRECTOR OF BUILDING & INSPECTION SERVICES, PORTLAND, MAINE

The undersigned hereby applies for a permit to erect, alter, repair, demolish, move or install the following building, structure, equipment or change use in accordance with the Laws of the State of Maine, the Portland B.O.C.A. Building Code and Zoning Ordinance of the City of Portland with plans and specifications, if any, submitted herewith and the following specifications:

LOCATION: 7 Bedford Street, Fire District #1, #2
1. Owner's name and address: Iris Pulkkinen, RFD #1, Hebron, Me. Telephone: 966-3695
2. Lessee's name and address
3. Contractor's name and address: OWR&T Telephone
4. Architect Specifications Plans No. of sheets
Proposed use of building: tree shed for storage No. families
Last use No. families
Material No. stories Heat Style of roof Roofing
Other buildings on same lot
Estimated contractual cost \$ Fee \$ 5.00

FIELD INSPECTOR-Mr. GENERAL DESCRIPTION

This application is for: @ 775-5451 Ext. 234 To construct small storage shed for Christmas Tree shelter. Temporary 11-29-78 to December 24, 1978. Stamp of Special Conditions

NOTE TO APPLICANT: Separate permits are required by the installers and subcontractors of heating, plumbing, electrical and mechanicals.

PERMIT IS TO BE ISSUED TO 1 2 3 4 Other:

DETAILS OF NEW WORK

Is any plumbing involved in this work? Is any electrical work involved in this work?
Is connection to be made to public sewer? If not, what is proposed for sewage?
Has septic tank notice been sent? Form notice sent?
Height average grade to top of plate Height average grade to highest point of roof
Size, front depth No. stories solid or filled land? earth or rock?
Material of foundation Thickness, top bottom cellar
Kind of roof Rise per foot Roof covering
No. of chimneys Material of chimneys of lining Kind of heat fuel
Framing Lumber--Kind Dressed or full size? Corner posts Sills
Size Girder Columns under girders Size Max. on centers
Studs (outside walls and carrying partitions) 2x4-16" O. C. Bridging in every floor and flat roof span over 8 feet.
Joists and rafters: 1st floor 2nd 3rd roof
On centers: 1st floor 2nd 3rd roof
Maximum span: 1st floor 2nd 3rd roof
If one story building with masonry walls, thickness of walls? height?

IF A GARAGE

No. cars now accommodated on same lot . . . , to be accommodated . . . number commercial cars to be accommodated . . .
Will automobile repairing be done other than minor repairs to cars habitually stored in the proposed building?

APPROVALS BY: DATE MISCELLANEOUS
BUILDING INSPECTION-PLAN EXAMINER Will work require disturbing of any tree on a public street?
ZONING:
BUILDING CODE: O.K.E.S. 11/29/78 Will there be in charge of the above work a person competent to see that the State and City requirements pertaining thereto are observed?
Fire Dept.:
Health Dept.:
Others:

Signature of Applicant Mrs. Pulkkinen Phone # 966-3695
Type Name of above Iris Pulkkinen 1 2 3 4

FIELD INSPECTOR'S COPY

Other and Address



# APPLICATION FOR PERMIT

**PERMIT ISSUED**

NOV 29 1977

**CITY OF PORTLAND**

B.O.C.A. USE GROUP .....

B.O.C.A. TYPE OF CONSTRUCTION .....

1077

ZONING LOCATION .....

PORTLAND, MAINE, Nov. 29, 1977

To the DIRECTOR OF BUILDING & INSPECTION SERVICES, PORTLAND, MAINE

The undersigned hereby applies for a permit to erect, alter, repair, demolish, move or install the following building, structure, equipment or change use in accordance with the Laws of the State of Maine, the Portland B.O.C.A. Building Code and Zoning Ordinance of the City of Portland with plans and specifications, if any, submitted herewith and the following specifications:

LOCATION Bedford Street

- 1. Owner's name and address Iris Desrosier - RFD # 1 Habron, Me. Fire District #1  #2
- 2. Lessee's name and address .....
- 3. Contractor's name and address Owner Telephone 966-3695
- 4. Architect .....

Proposed use of building tree shed for storage Specifications Plans No. of sheets  
 Last use .....

Material No. stories Heat Style of roof No. families  
 Other buildings on same lot .....

Estimated contractual cost \$ .....

### FIELD INSPECTOR—Mr.

This application is for:  
 Dwelling @ 775-5451  
 Garage Ext. 234

### GENERAL DESCRIPTION

Fee \$ 5.00

**To construct small storage shed for Christmas Tree shelter. Temporary used form 11-29-77 to Dec. 24, 1977 Stamp of Special Conditions**

NOTE TO APPLICANT: Separate permits are required by the installers and subcontractors of heating, plumbing, electrical and mechanicals.

PERMIT IS TO BE ISSUED TO  1  2  3  4  
 Other: .....

### DETAILS OF NEW WORK

- Is any plumbing involved in this work? .....
- Is connection to be made to public sewer? .....
- Has septic tank notice been sent? .....
- Height average grade to top of plate .....
- Size, front depth .....
- Material of foundation .....
- Kind of roof .....
- No. of chimneys .....
- Framing Lumber—Kind .....
- Size Girder .....
- Studs (outside walls and carrying partitions) 2x4-16" O. C. Bridging in every floor and flat roof span over 8 feet.
- Joists and rafters: 1st floor .....
- On centers: 1st floor .....
- Maximum span: 1st floor .....
- If one story building with masonry walls, thickness of walls? .....

### IF A GARAGE

- No. cars now accommodated on same lot .....
- Will automobile repairing be done other than minor repairs to cars habitually stored in the proposed building? .....

### APPROVALS BY:

BUILDING INSPECTION—PLAN EXAMINER [Signature] DATE .....

ZONING: .....

BUILDING CODE: .....

Fire Dept.: .....

Health Dept.: .....

Others: .....

### MISCELLANEOUS

- Will work require disturbing of any tree on a public street? .....
- Will there be in charge of the above work a person competent to see that the State and City requirements pertaining thereto are observed? .....

Signature of Applicant Iris Desrosier Phone # .....

Type Name of above Iris Desrosier Other  1  2  3  4

and Address .....

FIELD INSPECTOR'S COPY



APPLICATION FOR PERMIT

PERMIT ISSUED

B.O.C.A. USE GROUP 001265

B.O.C.A. TYPE OF CONSTRUCTION

NOV 24 1981

ZONING LOCATION R-5 PORTLAND, MAINE, Nov. 23, 1981

CITY OF PORTLAND

To the DIRECTOR OF BUILDING & INSPECTION SERVICES, PORTLAND, MAINE

The undersigned hereby applies for a permit to erect, alter, repair, demolish, move or install the following building, structure, equipment or change use in accordance with the Laws of the State of Maine, the Portland B.O.C.A. Building Code and Zoning Ordinance of the City of Portland with plans and specifications, if any, submitted herewith and the following specifications:

LOCATION 7 Bedford St. Fire District #1, #2
1. Owner's name and address Iris Pulkkinen - RFD # 1 Hebron, Me Telephone 966-3695
2. Lessee's name and address
3. Contractor's name and address Owner Telephone
4. Architect Specifications Plans No. of sheets
Proposed use of building No. families
Last use No. families
Material No. stories Heat Style of roof Roofing
Other buildings on same lot
Estimated contractual cost \$ Fee \$ 15.00

FIELD INSPECTOR M. Carroll GENERAL DESCRIPTION

This application is for: @ 775-5451
Dwelling Ext. 234
Garage
Masonry Bldg.
Metal Bldg.
Alterations
Demolitions
Change of Use
Other

To set already constructed 7' x 10' building to be used for the sale of Christmas trees temporary from Stamp of Special Conditions Nov. 30 to Dec. 24, 1981.

NOTE TO APPLICANT: Separate permits are required by the installers and subcontractors of heating, plumbing, electrical and mechanicals.

PERMIT IS TO BE ISSUED TO 1 2 3 4 Other:

DETAILS OF NEW WORK

Is any plumbing involved in this work? Is any electrical work involved in this work?
Is connection to be made to public sewer? If not, what is proposed for sewage?
Has septic tank notice been sent? Form notice sent?
Height average grade to top of plate Height average grade to highest point of roof
Size, front depth No. stories solid or filled land? earth or rock?
Material of foundation Thickness, top bottom cellar
Kind of roof Rise per foot Roof covering
No. of chimneys Material of chimneys of lining Kind of heat fuel
Framing Lumber—Kind Dressed or full size? Corner posts Sills
Size Girder Column: under girders Size Max. on centers
Studs (outside walls and carrying partitions) 2x4-16" O. C. Bridging in every floor and flat roof span over 8 feet.
Joists and rafters: 1st floor, 2nd, 3rd, roof
On centers: 1st floor, 2nd, 3rd, roof
Maximum span: 1st floor, 2nd, 3rd, roof
If one story building with masonry walls, thickness of walls? height?

IF A GARAGE

No. cars now accommodated on same lot, to be accommodated number commercial cars to be accommodated
Will automobile repairing be done other than minor repairs to cars habitually stored in the proposed building?

APPROVALS BY: DATE MISCELLANEOUS
BUILDING INSPECTION—PLAN EXAMINER Will work require disturbing of any tree on a public street?
ZONING: A.K. Will there be in charge of the above work a person competent to see that the State and City requirements pertaining thereto are observed?
BUILDING CODE:
Fire Dept.:
Health Dept.:
Others:

Signature of Applicant Iris Pulkkinen Phone #
Type Name of above Iris Pulkkinen 1 2 3 4
Other and Address

FIELD INSPECTOR'S COPY

Handwritten number 2 in a circle

7 BEDFORD STREET





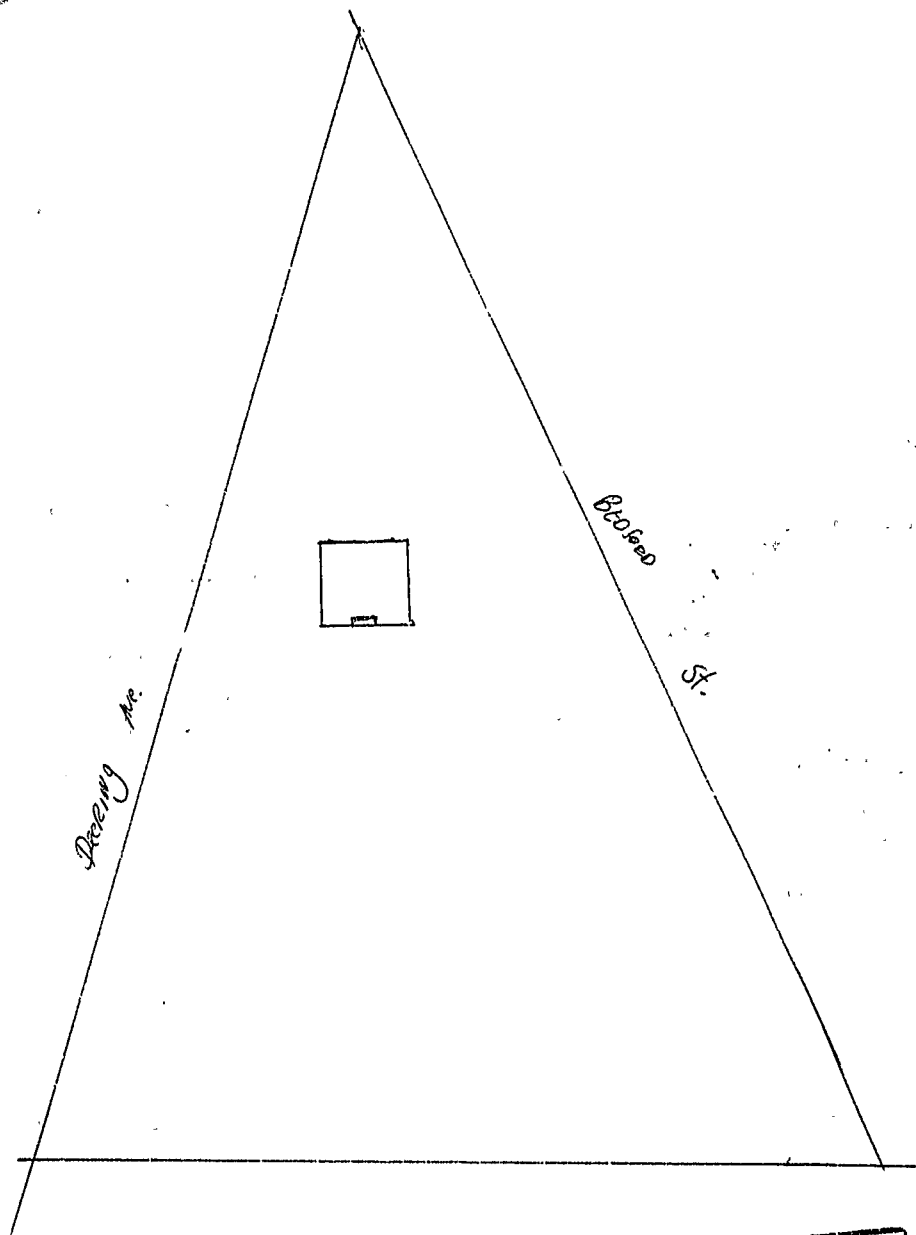

RECEIVED  
NOV 24 1982  
DEPT. OF BLDG. INSP.  
CITY OF PORTLAND

APPLICATION FOR PERMIT

B.O.C.A. USE GROUP ..... 01059 .....
B.O.C.A. TYPE OF CONSTRUCTION .....

ZONING LOCATION ..... PORTLAND, MAINE .. Nov. 24, 1982

PERMIT ISSUED
NOV 29 1982
CITY OF PORTLAND

To the CHIEF OF BUILDING & INSPECTION SERVICES, PORTLAND, MAINE

The undersigned hereby applies for a permit to erect, alter, repair, demolish, move or install the following building, structure, equipment or change use in accordance with the Laws of the State of Maine, the Portland B.O.C.A. Building Code and Zoning Ordinance of the City of Portland with plans and specifications, if any, submitted herewith and the following specifications:

LOCATION 7 Bedford Street Fire District #1 [ ] #2 [ ]
1. Owner's name and address Iris Pulkkinen - RFD # 1 Hebron, Me. Telephone 966-3695
2. Lessee's name and address ..... Telephone .....
3. Contractor's name and address Owner Telephone .....
Proposed use of building temp storage shed for Christmas trees No. of sheets .....
Last use ..... No. families .....
Material ..... No. stories ..... Heat ..... Style of roof ..... Roofing .....
Other buildings on same lot .....
Estimated contractual cost \$ 500.00

FIELD INSPECTOR—Mr. @ 775-5451
Appeal Fees \$ .....
Base Fee ... 15.00 ...
Late Fee ... 15.00 ...
TOTAL \$ .....

Construct 7' x 10' wood and aluminum storage shed, pre-fab building, to be set on slab to be used from Nov. 29 to Dec. 24, 1982

Stamp of Special Conditions

NOTE TO APPLICANT: Separate permits are required by the installers and subcontractors of heating, plumbing, electrical and mechanicals.

DETAILS OF NEW WORK

Is any plumbing involved in this work? ..... Is any electrical work involved in this work? .....
Is connection to be made to public sewer? ..... If not, what is proposed for sewage? .....
Has septic tank notice been sent? ..... Form notice sent? .....
Height average grade to top of plate ..... Height average grade to highest point of roof .....
Size, front ..... depth ..... No. stories ..... solid or filled lana ..... earth or rock? .....
Material of foundation ..... Thickness, top ..... bottom ..... cellar .....
Kind of roof ..... Rise per foot ..... Roof covering .....
No. of chimneys ..... Material of chimney ..... of lining ..... Kind of heat ..... fuel .....
Framing Lumber—Kind ..... Dressed or full size? ..... Corner posts ..... Sills .....
Size Girder ..... Columns under girders ..... Size ..... Max on centers .....
Studs (outside walls and carrying partitions) 2x4-16" O. C. Bridging in every floor and flat roof span over 8 feet.
Joists and rafters: 1st floor ..... 2nd ..... 3rd ..... roof .....
On centers: 1st floor ..... 2nd ..... 3rd ..... roof .....
Maximum span: 1st floor ..... 2nd ..... 3rd ..... roof .....
If one story building with masonry walls, thickness of walls? ..... height? .....

IF A GARAGE

No. cars now accommodated on same lot ..... to be accommodated ..... number commercial cars to be accommodated .....
Will automobile repairing be done other than minor repairs to cars habitually stored in the proposed building? .....

APPROVALS BY: DATE MISCELLANEOUS
BUILDING INSPECTION—PLAN EXAMINER ..... Will work require disturbing of any tree on a public street? .....
ZONING: M.P.A. ....
BUILDING CODE: ..... Will there be in charge of the above work a person competent to see that the State and City requirements pertaining thereto are observed? .....
Fire Dept.: .....
Health Dept.: .....
Others: .....

Signature of Applicant Iris Pulkkinen Phone # same
Type Name of above Iris Pulkkinen 1 [ ] 2 [ ] 3 [ ] 4 [ ]
Other and Address .....

(2)

FIELD INSPECTOR'S COPY APPLICANT'S COPY OFFICE FILE COPY

Per. no. 82/1059  
Location 2 Bedford St.  
Owner Lisa Sullivan  
Date of permit 11-24-82  
Approved 11-29-82  
Dwelling \_\_\_\_\_  
Garage \_\_\_\_\_  
Alteration Storage shed for Christmas trees

NOTES

ACD  
11/29/82  
P



APPLICATION FOR PERMIT

PERMIT ISSUED

B.O.C.A. USE GROUP .....  
 B.O.C.A. TYPE OF CONSTRUCTION **1 2273** .....  
 ZONING LOCATION ..... PORTLAND, MAINE ..... Nov. 28, 1983

NOV 28 1983

CITY OF PORTLAND

To the CHIEF OF BUILDING & INSPECTION SERVICES FOR AND MAINE

The undersigned hereby applies for a permit to erect, alter, repair, demolish, move or install the following building, structure, equipment or change use in accordance with the Laws of the State of Maine, the Portland B.O.C.A. Building Code and Zoning Ordinance of the City of Portland with plans and specifications if any, submitted herewith and the following specifications:

LOCATION ..... 7 Bedford Street ..... Fire District #1  #2   
 1. Owner's name and address Iris Pulkkinen - RTD #4, L. Iron, Me. Telephone 966-3695  
 2. Lessee's name and address ..... Telephone .....  
 3. Contractor's name and address Owner ..... Telephone .....  
 No. of sheets .....  
 Proposed use of building temp storage shed for sale of Christmas Trees No families .....  
 Last use ..... No families .....  
 Material ..... No. stories ..... Max. height ..... Style of roof ..... Roofing .....  
 Other buildings on same lot .....  
 Estimated contractual cost \$ 500.00 Appeal Fees .....  
 FIELD INSPECTOR - Mr. ..... Base Fee \$15.00  
 (@ 775-5451) Late Fee .....  
 TOTAL \$15.00

Construct 7' x 10' wood and aluminium storage shed, pre-fab building, to be set on slab to be used from Nov. 29 to Dec. 24, 1983

Stamp of Special Conditions

NOTE TO APPLICANT: Separate permits are required by the installers and subcontractors of heating, plumbing electrical and mechanical.

DETAILS OF NEW WORK

Is any plumbing involved in this work? ..... Is any electrical work involved in this work? .....  
 Is connection to be made to public sewer? ..... If no, what is proposed for sewage? .....  
 Has septic tank notice been sent? ..... Form notice sent? .....  
 Height average grade to top of plate ..... Height average grade to highest point of roof .....  
 Size, front ..... depth ..... No. stories ..... solid or filled land? ..... earth or rock? .....  
 Material of foundation ..... Thickness, top ..... bottom ..... cellar .....  
 Kind of roof ..... Rise per foot ..... Roof covering .....  
 No. of chimneys ..... Material of chimneys ..... of lining ..... Kind of heat ..... fuel .....  
 Framing Lumber - Kind ..... Dressed or full size? ..... Corner posts ..... Sills .....  
 Steel Girder ..... Columns under girders ..... Size ..... Max. on centers .....  
 Studs (outside walls and carrying partitions) 2x4-16" O. C. Bridging in gable floor and flat roof span over 8 feet.  
 Joists and rafters ..... 1st floor ..... 2nd ..... 3rd .....  
 On centers ..... 1st floor ..... 2nd ..... 3rd ..... roof .....  
 Maximum span ..... 1st floor ..... 2nd ..... 3rd ..... roof .....  
 If one story building with masonry walls, thickness of walls? ..... height? .....

IF A GARAGE:

No. cars now accommodated on same lot ..... to be accommodated ..... number commercial cars to be accommodated .....  
 Will automobile repairing be done other than minor repairs to cars habitually stored in the proposed building? .....

APPROVALS BY: DATE MISCELLANEOUS  
 BUILDING INSPECTION PLAN EXAMINER ..... Will work require disturbing of any tree on a public street? .....  
 ZONING .....  
 BUILDING CODE: ..... Will there be in charge of the above work a person competent to see that the State and City requirements pertaining thereto are observed? .....  
 Fire Dept. ....  
 Health Dept. ....  
 Others: .....

Signature of Applicant Iris Pulkkinen Phone # same  
 Type Name of above Iris Pulkkinen 13 20 30 40  
 Other .....  
 and address .....

FIELD INSPECTOR'S COPY APPLICANT'S COPY OFFICE FILE COPY

MR. MacIsaac

Permit No. 83/2273  
Location 7 Dod Ford St.  
Owner Trs. Pulkkinen  
Date of permit 11-28-83  
Approved 11-28-83  
Dwelling Temp. Storage  
Garage \_\_\_\_\_  
Alteration \_\_\_\_\_

NOTES

12-14 Unable to find it yet -  
They must have abandoned  
the idea.

12-21 Work never  
started and won't be.

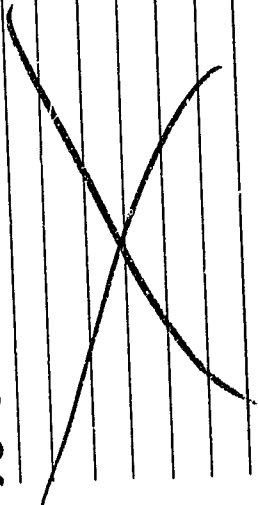

APPLICATION FOR PERMIT

PERMIT ISSUED

B.O.C.A. USE GROUP .....

B.O.C.A. TYPE OF CONSTRUCTION ..... 0.22.73

ZONING LOCATION ..... PORTLAND, MAINE ..... NOV. 28, 1983

NOV 28 1983

CITY OF PORTLAND

To the CHIEF OF BUILDING & INSPECTION SERVICES, PORTLAND, MAINE
The undersigned hereby applies for a permit to erect, alter, repair, demolish, move or install the following building, structure, equipment or change use in accordance with the Laws of the State of Maine, the Portland B.O.C.A. Building Code and Zoning Ordinance of the City of Portland with plans and specifications, if any, submitted herewith and the following specifications:

LOCATION ..... 7 Bedford Street
1. Owner's name and address ..... Iris Pullkinen - RFD # 1, Hebron, Me.
2. Lessee's name and address .....
3. Contractor's name and address ..... Owner
Proposed use of building ..... temp storage shed for sale of Christmas Trees
Last use .....
Material ..... No. stories ..... Heat ..... Style of roof ..... Roofing .....
Other buildings on same lot .....
Estimated contractual cost \$ ..... 1500.00 500.00

FIELD INSPECTOR—Mr. @ 775-5451

Appeal Fees \$
Base Fee \$ 15.00
Late Fee
TOTAL \$ 15.00

Construct 7' x 10' wood and aluminium storage shed, pre-fab building, to be set on slab to be used from Nov. 29 to Dec. 24, 1983

Stamp of Special Conditions

NOTE TO APPLICANT: Separate permits are required by the installers and subcontractors of heating, plum. ing, electrical and mechanicals.

DETAILS OF NEW WORK

Is any plumbing involved in this work?
Is connection to be made to public sewer?
Has septic tank notice been sent?
Height average grade to top of plate
Size, front ..... depth
Material of foundation ..... Thickness, top ..... bottom ..... cellar
Kind of roof ..... Rise per foot ..... Roof covering ..... Kind of heat ..... fuel
No. of chimneys ..... Material of chimneys ..... of lining ..... Sills
Framing Lumber—Kind ..... Dressed or full size? ..... Corner posts ..... Max. on centers
Size Girder ..... Columns under girders ..... Size ..... Max. on centers
Studs (on side walls and carrying partitions) 2x4-16' O. C. Bridging in every floor and flat roof span over 8 feet.
Joists and rafters: 1st floor ..... 2nd ..... 3rd ..... roof
On centers: 1st floor ..... 2nd ..... 3rd ..... roof
Maximum span: 1st floor ..... 2nd ..... 3rd ..... roof
If one story building with masonry walls, thickness of walls? ..... height?

IF A GARAGE

No. cars now accommodated on same lot ..... to be accommodated ..... number commercial cars to be accommodated
Will automobile repairing be done other than minor repairs to cars habitually stored in the proposed building? .....

APPROVALS BY:
BUILDING INSPECTION—PLAN EXAMINER ..... DATE
ZONING: .....
BUILDING CODE: .....
Fire Dept.: .....
Health Dept.: .....
Others: .....

MISCELLANEOUS

Will work require disturbing of any tree on a public street? .....
Will there be in charge of the above work a person competent to see that the State and City requirements pertaining thereto are observed? .....

Signature of Applicant Iris Pullkinen Phone # 3010
Type Name of above
Other ..... 2 3 4
and Address .....

6

FIELD INSPECTOR'S COPY

APPLICANT'S COPY

OFFICE FILE COPY