



APPLICATION FOR PERMIT

PERMIT ISSUED
OCT 26 1976
0390
CITY of PORTLAND

B.O.C.A. USE GROUP
B.O.C.A. TYPE OF CONSTRUCTION

ZONING LOCATION PORTLAND, MAINE, Oct. 26, 1976

To the DIRECTOR OF BUILDING & INSPECTION SERVICES, PORTLAND, MAINE
The undersigned hereby applies for a permit to erect, alter, repair, demolish, move or install the following building, structure, equipment or change in accordance with the Laws of the State of Maine, the Portland B.O.C.A. Building Code and Zoning Ordinance of the City of Portland with plans and specifications, if any, submitted herewith and the following specifications:

LOCATION Dexter Blvd. Fire District #1 [] #2 []
1. Owner's name and address Sewald Constr. Portsmouth, N.H. Telephone
2. Designer's name and address Telephone
3. Contractor's name and address Suburban Propane Gas Thomp. Pt. Telephone 774-0387
4. Architect Specifications Plans No. of sheets
Proposed use of building No. families
Last use No. families
Material No. stories Heat Style of roof Roofing
Other buildings on same lot
Estimated contractual cost \$ Fee \$ 1.60

FIELD INSPECTOR—Mr. GENERAL DESCRIPTION

This application is for: @ 775-5451
Dwelling Ext. 234
Garage
Masonry Bldg.
Metal Bldg.
Alterations
Demolitions
Change of Use
Other

Permit to install 2 -100 gal tank for temporary heat

Stamp of Special Conditions

NOTE TO APPLICANT: Separate permits are required by the installers and subcontractors of heating, plumbing, electrical and mechanicals.

PERMIT IS TO BE ISSUED TO 1 [] 2 [] 3 [x] 4 []
Other:

DETAILS OF NEW WORK

Is any plumbing involved in this work? Is any electrical work involved in this work?
Is connection to be made to public sewer? not, what is proposed for sewage?
Has septic tank notice been sent? Form notice sent?
Height average grade to top of plate Height average grade to highest point of roof
Size, front depth No. stories solid or filled land? earth or rock?
Material of foundation Thickness, top bottom cellar
Kind of roof Rise per foot Roof covering
No. of chimneys Material of chimneys of lining Kind of heat fuel
Framing Lumber—Kind Dressed or full size? Corner posts Sills
Size Girder Columns under girders Size Max. on centers
Studs (outside walls and carrying partitions) 2x4-16" O. C. Bridging in every floor and flat roof span over 8 feet.
Joists and rafters: 1st floor, 2nd, 3rd, roof
On centers: 1st floor, 2nd, 3rd, roof
Maximum span: 1st floor, 2nd, 3rd, roof
If one story building with masonry walls, thickness of walls? height?

IF A GARAGE

No. cars now accommodated on same lot to be accommodated number commercial cars to be accommodated
Will automobile repairing be done other than minor repairs to cars habitually stored in the proposed building?

APPROVALS BY: DATE
BUILDING INSPECTION—PLAN EXAMINER
ZONING:
BUILDING CODE:
Dept.:
Health Dept.:
Others:

MISCELLANEOUS
Will work require disturbing of any tree on a public street?
Will there be in charge of the above work a person competent to see that the State and City requirements pertaining thereto are observed?

Signature of Applicant Michael Merletti Phone # 9288
Type Name of above Michael Merletti 1 [] 2 [] 3 [x] 4 []
Other
and Address

OFFICE FILE COPY



APPLICATION FOR PERMIT
 DEPARTMENT OF BUILDING INSPECTIONS SERVICES
 ELECTRICAL INSTALLATIONS

Date Oct. 12, 19 76
 Receipt and Permit number A7986

To the CHIEF ELECTRICAL INSPECTOR, Portland, Maine:

The undersigned hereby applies for a permit to make electrical installations in accordance with the laws of Maine, the Portland Electrical Ordinance, the National Electrical Code and the following specifications:

LOCATION OF WORK: 214 Baxter Blvd. Apt. 2
 OWNER'S NAME: Forest Park ADDRESS: same

OUTLETS: (number of)
 Lights _____
 Receptacles _____
 Switches _____
 Plugmold _____ (number of feet)
 TOTAL _____ FEES _____

FIXTURES: (number of)
 Incandescent _____
 Fluorescent _____ (Do not include strip fluorescent)
 TOTAL _____
 Strip Fluorescent, in feet _____

SERVICES:
 Permanent, total amperes _____
 Temporary _____

METERS: (number of) _____

MOTORS: (number of)
 Fractional _____
 1 HP or over _____

RESIDENTIAL HEATING:
 Oil or Gas (number of units) _____
 Electric (number of rooms) _____

COMMERCIAL OR INDUSTRIAL HEATING:
 Oil or Gas (by a main boiler) _____
 Oil or Gas (by separate units) _____
 Electric (total number of kws) _____

APPLIANCES: (number of)
 Ranges 1 Water Heaters _____
 Cook Tops _____ Disposals _____
 Wall Ovens _____ Dishwashers _____
 Dryers _____ Compactors _____
 Fans _____ Others (denote) _____
 TOTAL _____ 3.00
~~2200x~~

MISCELLANEOUS: (number of)
 Branch Panels _____
 Transformers _____
 Air Conditioners _____
 Signs _____
 Fire/Burglar Alarms _____
 Circus, Fairs, etc. _____
 Alterations to wires _____
 Repairs after fire _____
 Heavy Duty, 220v outlets _____
 Emergency Lights, battery _____
 Emergency Generators _____

FOR ADDITIONAL WORK NOT ON ORIGINAL PERMIT INSTALLATION FEE DUE: _____
 FOR REMOVAL OF A "STOP ORDER" (304-16.b) DOUBLE FEE DUE: _____
 FOR PERFORMING WORK WITHOUT A PERMIT (304-9)
 TOTAL AMOUNT DUE: 3/00

INSPECTION:
 Will be ready on 10-12-76, 19 76; or Will Call _____

CONTRACTOR'S NAME: Curran Electric
 ADDRESS: 49 Darmouth St.
 TEL.: 772-5424

MASTER LICENSE NO.: 2481

LIMITED LICENSE NO.: _____

SIGNATURE OF CONTRACTOR:
John C. Wilson

INSPECTOR'S COPY



APPLICATION FOR PERMIT
DEPARTMENT OF BUILDING INSPECTIONS SERVICES
ELECTRICAL INSTALLATIONS

Date Oct. 5, 19 76
Receipt and Permit number A7963

To the CHIEF ELECTRICAL INSPECTOR, Portland, Maine:
The undersigned hereby applies for a permit to make electrical installations in accordance with the laws of Maine,
the Portland Electrical Ordinance, the National Electrical Code and the following specifications:

LOCATION OF WORK: Baxter Blvd. Sewerage pump station, off Clifton St.
OWNER'S NAME: Seward Construction ADDRESS: Murray St. 773-7322

OUTLETS: (number of)
Lights _____
Receptacles _____
Switches _____
Plugmold _____ (number of feet)
TOTAL _____ FEES _____

FIXTURES: (number of)
Incandescent _____
Fluorescent _____ (Do not include strip fluorescent)
TOTAL _____
Strip Fluorescent, in feet _____

SERVICES:
Permanent, total amperes 200
Temporary _____

METERS: (number of) 1 _____ 3.00

MOTORS: (number of)
Fractional _____
1 HP or over _____ .50

RESIDENTIAL HEATING:
Oil or Gas (number of units) _____
Electric (number of rooms) _____

COMMERCIAL OR INDUSTRIAL HEATING:
Oil or Gas (by a main boiler) _____
Oil or Gas (by separate units) _____
Electric (total number of kws) _____

APPLIANCES: (number of)
Ranges _____
Cook Tops _____
Wall Ovens _____
Dryers _____
Fans _____
Water Heaters _____
Disposals _____
Dishwashers _____
Compactors _____
Others (denote) _____
TOTAL _____

MISCELLANEOUS: (number of)
Branch Panels _____
Transformers _____
Air Conditioners _____
Signs _____
Fire/Burglar Alarms _____
Circus, Fairs, etc. _____
Alterations to wires _____
Repairs after fire _____
Heavy Duty, 220v outlets _____
Emergency Lights, battery _____
Emergency Generators _____

FOR ADDITIONAL WORK NOT ON ORIGINAL PERMIT INSTALLATION FEE DUE:
FOR REMOVAL OF A "STOP ORDER" (304-16.b) DOUBLE FEE DUE:
FOR PERFORMING WORK WITHOUT A PERMIT (304-9)
TOTAL AMOUNT DUE: 3.50

INSPECTION:
Will be ready on 10-6-76, 19___; or Call _____

CONTRACTOR'S NAME: Richardson Electric
ADDRESS: 18 Cooper Lane Waltham, Mass.
TEL: 1-617-8944403

MASTER LICENSE NO.: 2437
LIMITED LICENSE NO.: _____
SIGNATURE OF CONTRACTOR: Allen Cook

INSPECTOR'S COPY



APPLICATION FOR PERMIT

DEPARTMENT OF BUILDING INSPECTIONS SERVICES

ELECTRICAL INSTALLATIONS

Date Sept. 27, 1976
 Receipt and Permit number A7931

To the CHIEF ELECTRICAL INSPECTOR, Portland, Maine:
 The undersigned hereby applies for a permit to make electrical installations in accordance with the laws of Maine,
 the Portland Electrical Ordinance, the National Electrical Code and the following specifications:

LOCATION OF WORK: Pole # J-1 Adjacent to on Baxter Blvd.
 OWNER'S NAME: Richardson Elec. ADDRESS: _____

OUTLETS: (number of) _____ FEES
 Lights _____
 Receptacles _____
 Switches _____
 Plugmold _____ (number of feet)
 TOTAL _____

FIXTURES: (number of) _____
 Incandescent _____
 Fluorescent _____ (Do not include strip fluorescent)
 TOTAL _____
 Strip Fluorescent, in feet _____

SERVICES:
 Permanent, total amperes _____
 Temporary 1 _____

METERS: (number of) 1 _____ 3.00
 Fractional _____ .50
 1 HP or over _____

RESIDENTIAL HEATING:
 Oil or Gas (number of units) _____
 Electric (number of rooms) _____

COMMERCIAL OR INDUSTRIAL HEATING:
 Oil or Gas (by a main boiler) _____
 Oil or Gas (by separate units) _____
 Electric (total number of kws) _____

APPLIANCES: (number of)
 Ranges _____
 Cook Tops _____
 Wall Ovens _____
 Dryers _____
 Fans _____
 Water Heaters _____
 Disposals _____
 Dishwashers _____
 Compactors _____
 Others (denote) _____

MISCELLANEOUS: (number of)
 Branch Panels _____
 Transformers _____
 Air Conditioners _____
 Signs _____
 Fire/Burglar Alarms _____
 Circus, Fairs, etc. _____
 Alterations to wires _____
 Repairs after fire _____
 Heavy Duty, 220v outlets _____
 Emergency Lights, battery _____
 Emergency Generators _____

FOR ADDITIONAL WORK NOT ON ORIGINAL PERMIT INSTALLATION FEE DUE: 3.50
 FOR REMOVAL OF A "STOP ORDER" (304-16.b) DOUBLE FEE DUE: _____
 FOR PERFORMING WORK WITHOUT A PERMIT (304-9) TOTAL AMOUNT DUE: 3.50

INSPECTION:
 Will be ready on today, 1976; or Will Call _____
 CONTRACTOR'S NAME: Richardson Elec.
 ADDRESS: 16 Cooper Lane - Waltham, Mass.
 TEL.: _____

MASTER LICENSE NO.: 2237
 LIMITED LICENSE NO.: _____

SIGNATURE OF CONTRACTOR:
[Signature]

INSPECTOR'S COPY



APPLICATION FOR PERMIT
DEPARTMENT OF BUILDING INSPECTIONS SERVICES
ELECTRICAL INSTALLATIONS

Date 8/26/85, 19__
 Receipt and Permit number 05839

To the CHIEF ELECTRICAL INSPECTOR, Portland, Maine:

The undersigned hereby applies for a permit to make electrical installations in accordance with the laws of Maine, the Portland Electrical Ordinance, the National Electrical Code and the following specifications:

LOCATION OF WORK: Baxter Boulevard (CMP pole #56)
 OWNER'S NAME: Reed & Reed Const. ADDRESS: Woolwich, Maine

OUTLETS: _____ FEES

Receptacles _____ Switches _____ Plugmold _____ ft. TOTAL _____

FIXTURES: (number of) _____

Incandescent _____ Flourescent _____ (not strip) TOTAL _____

Strip Flourescent _____ ft. _____

SERVICES: _____

Overhead _____ Underground _____ Temporary x TOTAL amperes 60 .. 3.00

METERS: (number of) 1 .. .50

MOTORS: (number of) _____

Fractional _____

1 HP or over _____

RESIDENTIAL HEATING: _____

Oil or Gas (number of units) _____

Electric (number of rooms) _____

COMMERCIAL OR INDUSTRIAL HEATING: _____

Oil or Gas (by a main boiler) _____

Oil or Gas (by separate units) _____

Electric Under 20 kws _____ Over 20 kws _____

APPLIANCES: (number of) _____

Ranges _____ Water Heaters _____

Cook Tops _____ Disposals _____

Wall Ovens _____ Dishwashers _____

Dryers _____ Compactors _____

Fans _____ Others (denote) _____

TOTAL _____

MISCELLANEOUS: (number of) _____

Branch Panels _____

Transformers _____

Air Conditioners Central Unit _____

Separate Units (windows) _____

Signs 20 sq. ft. and under _____

Over 20 sq. ft. _____

Swimming Pools Above Ground _____

In Ground _____

Fire/Burglar Alarms Residential _____

Commercial _____

Heavy Duty Outlets, 220 Volt (such as welders) 30 amps and under _____

over 30 amps _____

Circus, Fairs, etc. _____

Alterations to wires _____

Repairs after fire _____

Emergency Lights, battery _____

Emergency Generators _____

INSTALLATION FEE DUE: _____

FOR ADDITIONAL WORK NOT ON ORIGINAL PERMIT DOUBLE FEE DUE: _____

FOR REMOVAL OF A "STOP ORDER" (304-16.b) _____

TOTAL AMOUNT DUE: 5.00 min.

INSPECTION: _____

Will be ready on ready, 19__ ; or Will Call _____

CONTRACTOR'S NAME: A.D. Electric

ADDRESS: 64 Grove St., Lewiston

TEL.: 375-6616

MASTER LICENSE NO.: 2801 SIGNATURE OF CONTRACTOR: _____

LIMITED LICENSE NO.: _____

INSPECTOR'S COPY — WHITE

OFFICE COPY — CANARY

CONTRACTOR'S COPY — GREEN

902019

FEE WAIVED BY MARK GREEN

Permit # 902019 City of Portland BUILDING PERMIT APPLICATION Fee _____ Zone _____ Map # _____ Lot# _____

Please fill out any part which applies to job. Proper plans must accompany form.

Owner: <u>City of Portland - Fire Dept.</u> Phone # <u>Ext. 8409 Gerry DiMillo</u> Address: <u>389 Congress St., Portland, ME</u> LOCATION OF CONSTRUCTION <u>Baxter Blvd. - Payson Park</u> Contractor: <u>New Eng. On Premises ASU</u> Address: <u>17 Elm St., Gorham, ME 04038</u> Phone # _____ Est. Construction Cost: _____ Proposed Use: <u>tent</u> _____ Past Use: _____ # of Existing Res. Units _____ # of New Res. Units _____ Building Dimensions L _____ W _____ Total Sq. Ft. _____ # Stories: _____ # Bedrooms _____ Lot Size: _____ Is Proposed Use: Seasonal _____ Condominium _____ Conversion _____ Explain Conversion <u>To erect 30'x90' tent for 3 days, erect Fri.,</u> <u>Oct. 12, 1990, taken down Mond., Oct. 15, 1990.</u>	For Official Use Only Date <u>Oct. 11, 1990</u> Subdivision: _____ Name _____ Inside Fire Limits _____ Lot _____ Bldg Code _____ Ownership: _____ Public _____ Time Limit _____ Private _____ Estimated Cost _____ Zoning: Street Frontage Provided: _____ Provided Setbacks: Front _____ Back _____ Side _____ Side _____ Review Required: Zoning Board Approval: Yes _____ No _____ Date: _____ Planning Board Approval: Yes _____ No _____ Date: _____ Conditional Use: _____ Variance _____ Site Plan _____ Subdivision _____ Shoreland Zoning Yes _____ No _____ Floodplain Yes _____ No _____ Special Exception _____ Other _____ (Explain) _____
--	---

Foundation:

- Type of Soil: _____
- Set Backs - Front _____ Rear _____ Side(s) _____
- Footings Size: _____
- Foundation Size: _____
- Other: _____

Floor:

- Sills Size: _____ Sills must be anchored.
- Girder Size: _____
- Lally Column Spacing: _____ Size: _____
- Joists Size: _____ Spacing 16" O.C.
- Bridging Type: _____ Size: _____
- Floor Sheathing Type: _____ Size: _____
- Other Material: _____

Exterior Walls:

- Studding Size _____ Spacing _____
- No. windows _____
- No. Doors _____
- Header Sizes _____ Spar(s) _____
- Bracing: Yes _____ No _____
- Cornor Posts Size _____
- Insulation Type _____ Size _____
- Sheathing Type _____ Size _____
- Siding Type _____ Weather Exposure _____
- Masonry Materials _____
- Metal Materials _____

Interior Walls:

- Studding Size _____ Spacing _____
- Header Sizes _____ Span(s) _____
- Wall Covering Type _____
- Fire Wall if required _____
- Other Materials _____

Ceiling:

- Ceiling Joists Size: _____ Spacing _____
- Ceiling Strapping Size _____ Spacing _____
- Type Ceilings: _____
- Insulation Type _____ Size _____
- Ceiling Height: _____

Roof:

- Truss or Rafter Size _____ Span _____
- Sheathing Type _____
- Roof Covering Type _____

Chimneys:

Type: _____ Number of Fire Places _____

Heating:

Type of Heat: _____

Electrical:

Service Entrance Size: _____ Smoke Detector Required Yes _____ No _____

Plumbing:

- Approval of soil test if required Yes _____ No _____
- No. of Tubs or Showers _____
- No. of Flushes _____
- No. of Lavatories _____
- No. of Other Fixtures _____

Swimming Pools:

- Type: _____
- Pool Size: _____ x _____ Square Footage _____
- Must conform to National Electrical Code and State Law.

PERMIT ISSUED
OCT 11 1990
City of Portland

Permit Received By Joyce M. Rinaldi
Signature of Applicant Gerry DiMillo Date 10/11/90
Signature of CEO _____ Date _____
Inspection Dates _____

902019

FEE WAIVED BY MARK GREEN

Permit # 902019 City of Portland BUILDING PERMIT APPLICATION Fee _____ Zone _____ Map # _____ Lot# _____

Please fill out any part which applies to job. Proper plans must accompany form.

Owner: City of Portland - Fire Dept. Phone # Ext. 8409 Garry DiMillo

Address: 389 Congress St., Portland, ME

LOCATION OF CONSTRUCTION: Payson Blvd. - Payson Park

Contractor: New Eng. On Premises ASIB

Address: 17 Elm St., Gorham, ME 04038 Phone # _____

Est. Construction Cost: _____ Proposed Use: tent

Post Use: _____

of Existing Res. Units _____ # of New Res. Units _____

Building Dimensions L _____ W _____ Total Sq. Ft. _____

Stories: _____ # Bedrooms _____ Lot Size: _____

Is Proposed Use: Seasonal _____ Condominium _____ Conversion _____

Explain Conversion To erect 30'x90' tent for 3 days, erect Pri.,

For Official Use Only

Date: Oct. 11, 1990 Subdivision: _____

Inside Fire Limits: _____ Name: _____

Bldg Code: _____ Lot: _____

Fire Limit: _____ Ownership: _____ Public _____ Private _____

Estimated Cost: _____

Zoning: _____

Street Frontage Provided: _____ Back _____ Side _____ Side _____

Provided Setbacks: Front _____ Back _____ Side _____ Side _____

Review Required: _____

Zoning Board Approval: Yes _____ No _____ Date: _____

Planning Board Approval: Yes _____ No _____ Date: _____

Conditional Use: _____ Variance _____ Site Plan _____ Subdivision _____

Shoreland Zoning Yes _____ No _____ Floodplain Yes _____ No _____

Special Exception _____

Other (Explain) _____

Oct. 12, 1990, taken down Mond., Oct. 15, 1990.

Foundation:

- Type of Soil: _____
- Set Backs - Front _____ Rear _____ Side(s) _____
- Footings Size: _____
- Foundation Size: _____
- Other _____

Floor:

- Sills Size: _____ Sills must be anchored.
- Girder Size: _____
- Lally Column Spacing: _____ Size: _____ Spacing 16" O.C.
- Joists Size: _____ Size: _____
- Bridging Type: _____ Size: _____
- Floor Sheathing Type: _____ Size: _____
- Other Material: _____

Exterior Walls:

- Studding Size _____ Spacing _____
- No. windows _____
- No. Doors _____ Span(s) _____
- Header Sizes _____
- Bracing: Yes _____ No _____
- Corner Posts Size _____
- Insulation Type _____ Size _____
- Sheathing Type _____ Size _____
- Siding Type _____ Weather Exposure _____
- Masonry Materials _____
- Metal Materials _____

Interior Walls:

- Studding Size _____ Spacing _____
- Header Sizes _____ Span(s) _____
- Wall Covering Type _____
- Fire Wall if required _____
- Other Materials _____

Ceiling:

- Ceiling Joists Size: _____ Spacing _____
- Ceiling Strapping Size _____
- Type Ceilings: _____
- Insulation Type _____
- Ceiling Height: _____

Roof:

- Truss or Rafter Size _____ Span _____
- Sheathing Type _____ Size _____
- Roof Covering Type _____

Chimneys: Type: _____ Number of Fire Places _____

Heating: Type of Heat: _____

Electrical: Service Entrance Size: _____ Smoke Detector: Required Yes _____ No _____

Plumbing: 1. Approval of soil test if required Yes _____ No _____

Swimming Pools:

- Type: _____
- Pool Size: _____ x _____ Square Footage _____
- Must conform to National Electrical Code and State Law.

Permit Received By Joyce M. Rinaldi

Signature of Applicant [Signature] Date 10/11/90

Signature of CEO _____ Date _____

Inspection Dates _____

White-Tax Assessor Yellow-GPCOG White Tag -CEO [12] © Copyright GPCOG 1988

PERMIT ISSUED
OCT 11 1990
City of Portland

PLOT PLAN



FEES (Breakdown From Front)
Base Fee \$ _____
Subdivision Fee \$ _____
Site Plan Review Fee \$ _____
Other Fees \$ _____
(Explain) _____
Late Fee \$ _____

Type	Inspection Record	Date
_____	_____	____/____/____
_____	_____	____/____/____
_____	_____	____/____/____
_____	_____	____/____/____

COMMENTS *Done All*

Signature of Applicant *Guy DiMillo* _____ Date *10/11/90* _____

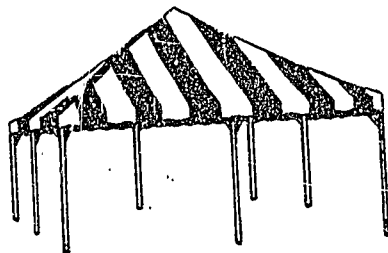

Eureka! Tent

One Marine Midland Plaza
P.O. Box 966
Binghamton, N.Y. 13902
(607) 723-7546

August 13, 1987

Mr. Peter Wentworth
New England On Premises Advertising
17 Elm Street
Gorham, ME 04038

Dear Peter:
This letter is to confirm that the materials used to manufacture all Eureka! party tents have been treated for flame resistance in conformance with California Fire Marshall Code, National Fire Protection NFPA-701, and Industrial Fabrics Association CPAI-84. (Treatment cannot be removed by washing or wear.)

Specifically, this applies to all 15', 20' and 30' Party Canopies, 10' and 20' Frame Tents, 20', 30', 40', 50', 60' and 80' Party Tents, and 30', 40', and 60' Genesis Tents in all colors.

Please contact me if I may be of further assistance.

Sincerely,

JOHNSON CAMPING, INC.

Connie Shaddock
Connie Shaddock
Commercial Tents Marketing Coordinator

CS/0408c

Division of Johnson Camping, Inc.

Johnson Camping, Inc.

CONNIE SHADDUCK
COMMERCIAL TENTS MARKETING
COORDINATOR

(800) 847-1460
(607) 723-7546
1 MARINE MIDLAND PLAZA, Binghamton, N.Y. 13902



Eureka!

RECEIVED

NOV 11 1987

DEPT. OF BUILDING INSPECTION
CITY OF PORTLAND

PERMIT # 1131 CITY OF Portland BUILDING PERMIT APPLICATION

Please fill out any part which applies to job. Proper plans must accompany form.

MAP # _____ LOT# _____

Owner: WPOR
Address: Baxter Boulevard

LOCATION OF CONSTRUCTION Baxter Boulevard

CONTRACTOR Bailey Sign Co. SUBCONTRACTORS _____

ADDRESS: 9 Thomas Drive, Westbrook 04092

Est. Construction Cost: _____ Type of Use: office

Past Use: _____

Building Dimensions L _____ W _____ Sq. Ft. _____ # Stories: _____ Lot Size: _____

Is Proposed Use: _____ Seasonal _____ Condominium _____ Apartment _____
Conversion - Explain to erect 33 signs - 138 sq. ft. total

COMPLETE ONLY IF THE NUMBER OF UNITS WILL CHANGE
Residential Buildings Only:
Of Dwelling Units _____ # Of New Dwelling Units _____

Foundation:
1. Type of Soil: _____
2. Set Backs - Front _____ Rear _____ Side(s) _____
3. Footings Size: _____
4. Foundation Size: _____
5. Other _____

Floor:
1. Sills Size: _____ Sills must be anchored.
2. Girder Size: _____
3. Lally Column Spacing: _____ Size: _____
4. Joists Size: _____ Spacing 16" O.C.
5. Bridging Type: _____ Size: _____
6. Floor Sheathing Type: _____ Size: _____
7. Other Material: _____

Exterior Walls:
1. Studding Size _____ Spacing _____
2. No. windows _____
3. No. Doors _____
4. Header Sizes _____ Span(s) _____
5. Bracing: Yes _____ No _____
6. Corner Posts Size _____
7. Insulation Type _____ Size _____
8. Sheathing Type _____ Size _____
9. Siding Type _____ Weather Exposure _____
10. Masonry Materials _____
11. Metal Materials _____

Interior Walls:
1. Studding Size _____ Spacing _____
2. Header Sizes _____ Span(s) _____
3. Wall Covering Type _____
4. Fire Wall if required _____
5. Other Materials _____

For Official Use Only

Date 10/25/87 Subdivision: Yes / No _____
 Inside Fire Limit's _____ Name _____
 Bldg Code _____ Let _____
 Time Limit _____ Block _____
 Estimated Cost _____ Permit Expiration: _____
 Value/Structure: 22,000 Ownership: _____ Public _____ Private _____
 Fee: _____

Ceiling:
1. Ceiling Joists Size: _____
2. Ceiling Strapping Size _____ Spacing _____
3. Type Ceilings: _____ **PERMIT ISSUED**
4. Insulation Type _____ Size _____
5. Ceiling Height: _____

Roof:
1. Truss or Rafter Size _____ Span _____ OCT 27 1987
2. Sheathing Type _____ Size _____
3. Roof Covering Type _____ **City of Portland**
4. Other _____

Chimneys:
Type: _____ Number of Fire Places _____

Heating:
Type of Heat: _____

Electrical:
Service Entrance Size: _____ Smoke Detector Required Yes _____ No _____

Plumbing:
1. Approval of soil test if required Yes _____ No _____
2. No. of Tubs or Showers _____
3. No. of Flushes _____
4. No. c. lavatories _____
5. No. of Other Fixtures _____

Swimming Pools:
1. Type: _____
2. Pool Size: _____ x _____ Square Footage _____
3. Must conform to National Electrical Code and State Law.

Zoning:
District F2 Street Frontage Req.: _____ Provided _____
Required Setbacks: Front _____ Back _____ Side _____ Side _____

Review Required:
Zoning Board Approval: Yes _____ No _____ Date: _____
Planning Board Approval: Yes _____ No _____ Date: _____
Conditional Use: _____ Variance _____ Site Plan _____ Sub-Division _____
Shore and Floodplain Mgmt. _____ Special Exception _____
Other (Explain) _____
Date Approved D.K. Adams January 1988

Permit Received By Kandi Gore

Signature of Applicant _____ Date _____

Signature of CEO _____ Date _____

Inspection Dates _____

Permit # **912464** City of Portland BUILDING PERMIT APPLICATION Fee waived; per Mark Green Zone _____ Map # _____ Lot# _____
 Please fill out any part which applies to job. Proper plans must accompany form.

Owner: Little League East Seven Phone # 773-9611
 Address: c/o Marc Lamontagne, 922 Baxter Bld, Pld, ME
 LOCATION OF CONSTRUCTION Baxter Bld- Payson Pk 04103
 (City of Pld property) Sub: _____
 Address: _____ Phone # _____
 Est. Construction Cost: _____ Proposed Use: ballfield w sign
 Past Use: ballfield
 # of Existing Res. Units _____ # of New Res. Units _____
 Building Dimensions L _____ W _____ Total Sq. Ft. _____
 # Stories: _____ # Bedrooms _____ Lot Size: _____
 Is Proposed Use: Seasonal _____ Condominium _____ Conversion _____
 Explain Conversion: erect sign - appx 11'x7' - 2 sides

For Official Use Only
 Date: 4/5/91 Subdivision: _____
 Inside Fire Limits: _____
 Bldg Code: _____
 Time Limit: _____
 Estimated Cost: _____
 Zoning: R05
 Street Frontage Provided: _____
 Provided Setbacks: Front _____ Back _____ Side _____
 Review Required:
 Zoning Board Approval: Yes _____ No _____ Date: _____
 Planning Board Approval: Yes _____ No _____ Date: _____
 Conditional Use: _____ Variance _____ Site Plan _____
 Shoreland Zoning Yes _____ No _____ Floodplain Yes _____ No _____
 Special Exception _____
 Other: OK W/ 4-8-91

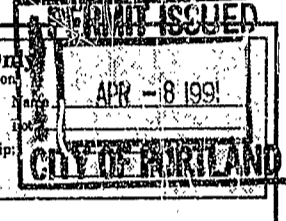

Foundation:
 1. Type of Soil: _____
 2. Set Backs - Front _____ Rear _____ Side(s) _____
 3. Footings Size: _____
 4. Foundation Size: _____
 5. Other: _____

Floor:
 1. Sills Size: _____ Sills must be anchored.
 2. Girder Size: _____
 3. Lally Column Spacing: _____ Size: _____
 4. Joist Size: _____ Spacing 16" O.C.
 5. Bridging Type: _____ Size: _____
 6. Floor Sheathing Type: _____ Size: _____
 7. Other Material: _____

Exterior Walls:
 1. Studding Size _____ Spacing _____
 2. No. windows _____
 3. No. Doors _____
 4. Header Sizes _____ Span(s) _____
 5. Bracing: Yes _____ No _____
 6. Corner Posts Size _____
 7. Insulation Type _____ Size _____
 8. Sheathing Type _____ Size _____
 9. Siding Type _____ Weather Exposure _____
 10. Masonry Materials _____
 11. Metal Materials _____

Interior Walls:
 1. Studding Size _____ Spacing _____
 2. Header Sizes _____ Span(s) _____
 3. Wall Covering Type _____
 4. Fire Wall if required _____
 5. Other Materials _____

Ceiling:
 1. Ceiling Joists Size: _____
 2. Ceiling Strapping Size _____ Spacing _____
 3. Type Ceiling: _____
 4. Insulation Type _____ Size _____
 5. Ceiling Height: _____

Roof:
 1. Truss or Rafter Size _____ Span _____
 2. Sheathing Type _____ Size _____
 3. Roof Covering Type _____

Chimneys:
 Type: _____ Number of Fire Places _____ Date: _____

Heating:
 Type of Heat: _____

Electrical:
 Service Entrance Size: _____ Smoke Detector Required Yes _____ No _____

Plumbing:
 1. Approval of soil test if required Yes _____ No _____
 2. No. of Tubs or Showers _____
 3. No. of Flushes _____
 4. No. of Lavatories _____
 5. No. of Other Fixtures _____

Swimming Pools:
 1. Type: _____
 2. Pool Size: _____ Square Footage _____
 3. Must conform to National Electrical Code and State Law.

Permit Received By Louise E. Chase
 Signature of Applicant Marc Lamontagne Date 4-5-91
 Signature of CEO _____ Date _____
 Inspection Dates _____

HISTORIC PRESERVATION
 Not in Dry Historic Landmark
 Does not require Certificate
 Requires Review

PLOT PLAN



FEES (Breakdown From Front)
Base Fee \$ Waived - per M. Green
Subdivision Fee \$ _____
Site Plan Review Fee \$ _____
Other Fees \$ _____
(Explain) _____
Late Fee \$ _____

Type	Inspection Record	Date
_____	_____	____/____/____
_____	_____	____/____/____
_____	_____	____/____/____
_____	_____	____/____/____
_____	_____	____/____/____

COMMENTS

6/13/91 OKAR

Signature of Applicant

M. Green (AGENT)

Date

4-5-91

(SCOREBOARD
SIGN LOCATION)

BAXTER BLVD.

LORING FIELD

YEA

PARKING LOT

FARM LEAGUE
FIELD

RECEIVED

APR 05 1991

DEPT. OF BUILDING INSPECTION
CITY OF PORTLAND

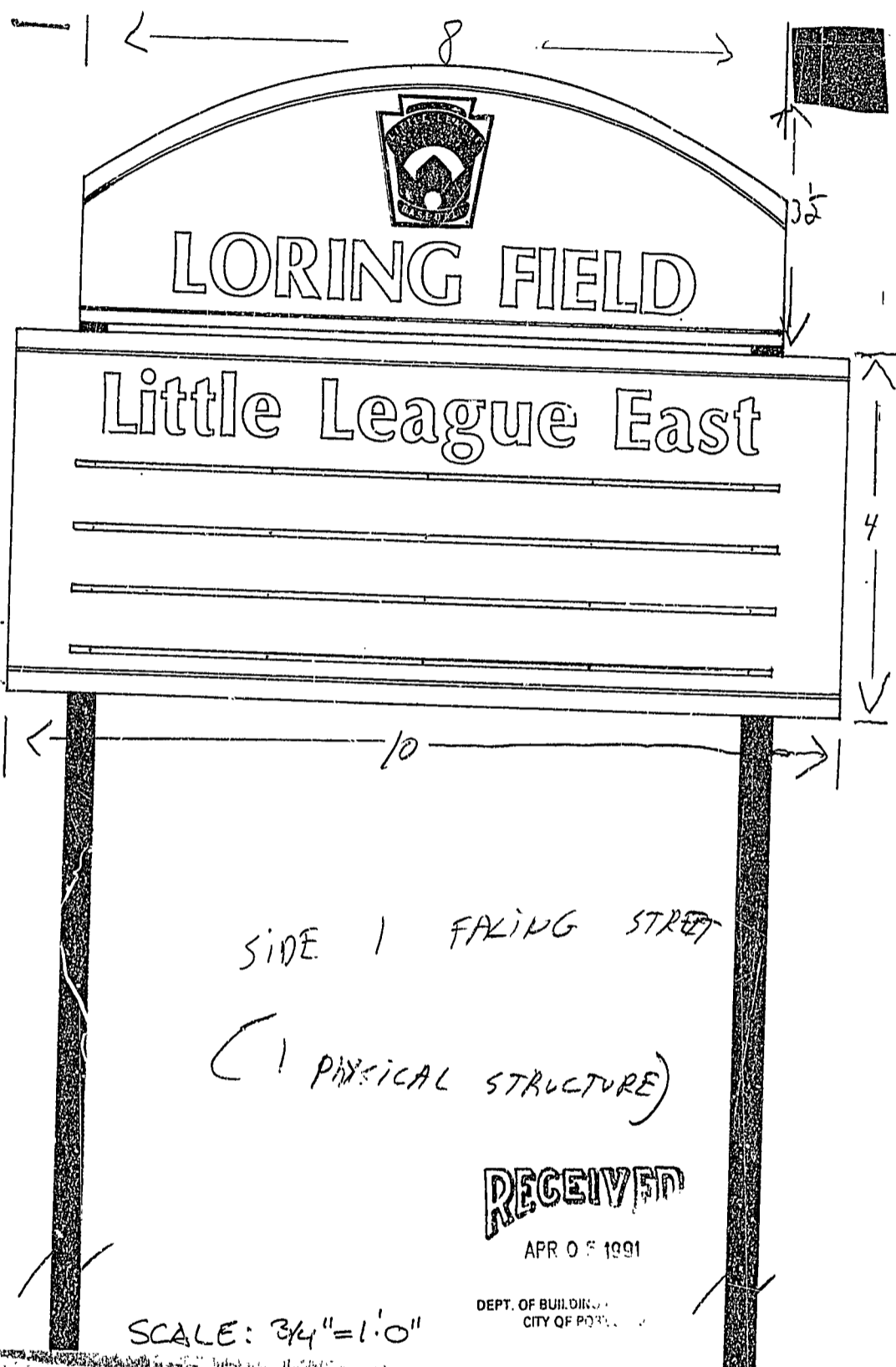

LORING FIELD

Little League East

SIDE 1 FACING STREET

(PHYSICAL STRUCTURE)

RECEIVED

APR 05 1991

DEPT. OF BUILDING
CITY OF PORTLAND

SCALE: 3/4" = 1'-0"

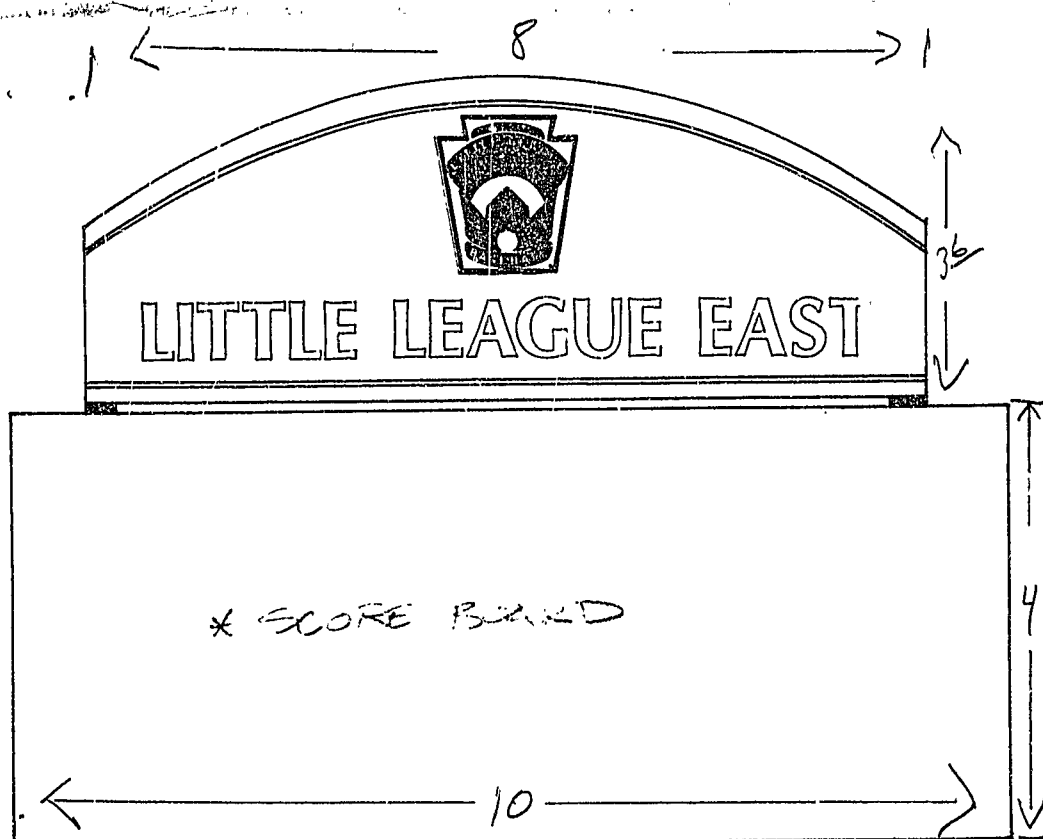

BACK SIDE
SIDE 2 → FACING BALL
FIELD

RECEIVED
APR 05 1991
DEPT. OF BUILDING INSPECTION
CITY OF PORTLAND

SCALE: 3/4" = 1'-0"

913015

Permit # 913015 City of Portland BUILDING PERMIT APPLICATION Fee waived Zone Map # Lot #
Please fill out any part which applies to job. Proper plans must accompany form.

Owner: City of Portland Phone #
 Address: 389 Congress St; Ptld, ME 04101
 LOCATION OF CONSTRUCTION (Payson Pk)- Baxter Blvd
 Contractor: Jeff Johnson Sub:
 Address: Phone #
 Est. Construction Cost: 5000 Proposed Use: baseball field w shed
 Past Use: baseball field
 # of Existing Res. Units # of New Res. Units
 Building Dimensions L W Total Sq. Ft.
 # Stories: # Bedrooms Lot Size:
 Is Proposed Use: Seasonal Condominium Conversion
 Explain Conversion construct storage shed - 27'x19'

For Official Use Only

Date 9/6/91 Subdivision:
 Inside Fire Limits Name
 Bldg Code Lot SEP 12 1991
 Time Limit Ownership:
 Estimated Cost 5000

Zoning:
 Street Frontage Provided:
 Provided Setbacks: Front Back Side Side

Review Required:
 Zoning Board Approval: Yes No Date:
 Planning Board Approval: Yes No Date:
 Conditional Use: Variance Site Plan Subdivision
 Shoreland Zoning Yes No Floodplain Yes No
 Special (Exemption)
 Other (Explain) WDO - 9-11-91

MAIL TO: Ben O'Reilly X 879-8821
 Foundation: 55 Portland St; Ptld, ME 04101
 1. Type of Soil:
 2. Set Backs - Front Rear Side(s)
 3. Footings Size:
 4. Foundation Size:
 5. Other

Floor:
 1. Sills Size: Sills must be anchored.
 2. Girder Size:
 3. Lally Column Spacing: Size:
 4. Joists Size: Spacing 18" O.C.
 5. Bridging Type: Size:
 6. Floor Sheathing Type: Size:
 7. Other Material:

Exterior Walls:
 1. Studding Size Spacing
 2. No. windows
 3. No. Doors
 4. Header Sizes Span(s)
 5. Bracing: Yes No
 6. Corner Posts Size
 7. Insulation Type Size
 8. Sheathing Type Size
 9. Siding Type Weather Exposure
 10. Masonry Materials
 11. Metal Materials

Interior Walls:
 1. Studding Size Spacing
 2. Header Sizes Span(s)
 3. Wall Covering Type
 4. Fire Wall if required
 5. Other Materials

Ceiling: **HISTORIC PRESERVATION**
 1. Ceiling Joists Size: Spacing Not in District nor Landmark.
 2. Ceiling Strapping Size Spacing Does not require review.
 3. Type Ceilings: Require Review.
 4. Insulation Type Size
 5. Ceiling Height: *****

Roof:
 1. Truss or Rafter Size Span Action: Approved
 2. Sheathing Type Size Approved with conditions
 3. Roof Covering Type Approved

Chimneys:
 Type: Number of Fire Places Date: 9/6/91
 Signature: [Signature]

Heating:
 Type of Heat:

Electrical:
 Service Entrance Size: Smoke Detector Required Yes No

Plumbing:
 1. Approval of soil test if required Yes No
 2. No. of Tubs or Showers
 3. No. of Flushes
 4. No. of Lavatories
 5. No. of Other Fixtures

Swimming Pools:
 1. Type:
 2. Pool Size: x Square Footage
 3. Must conform to National Electrical Code and State Law.

Permit Received By Louise E. Chase
 Signature of Applicant Ben O'Reilly Date 9-6-91
 CEO's District Ben O'Reilly

CONTINUED TO REVERSE SIDE
 Ivory Tag - CEO [Signature]

White - Tax Assessor

NOT TO SCALE
TRIANGLE IS @ 400 TO 500'
PER SIDE

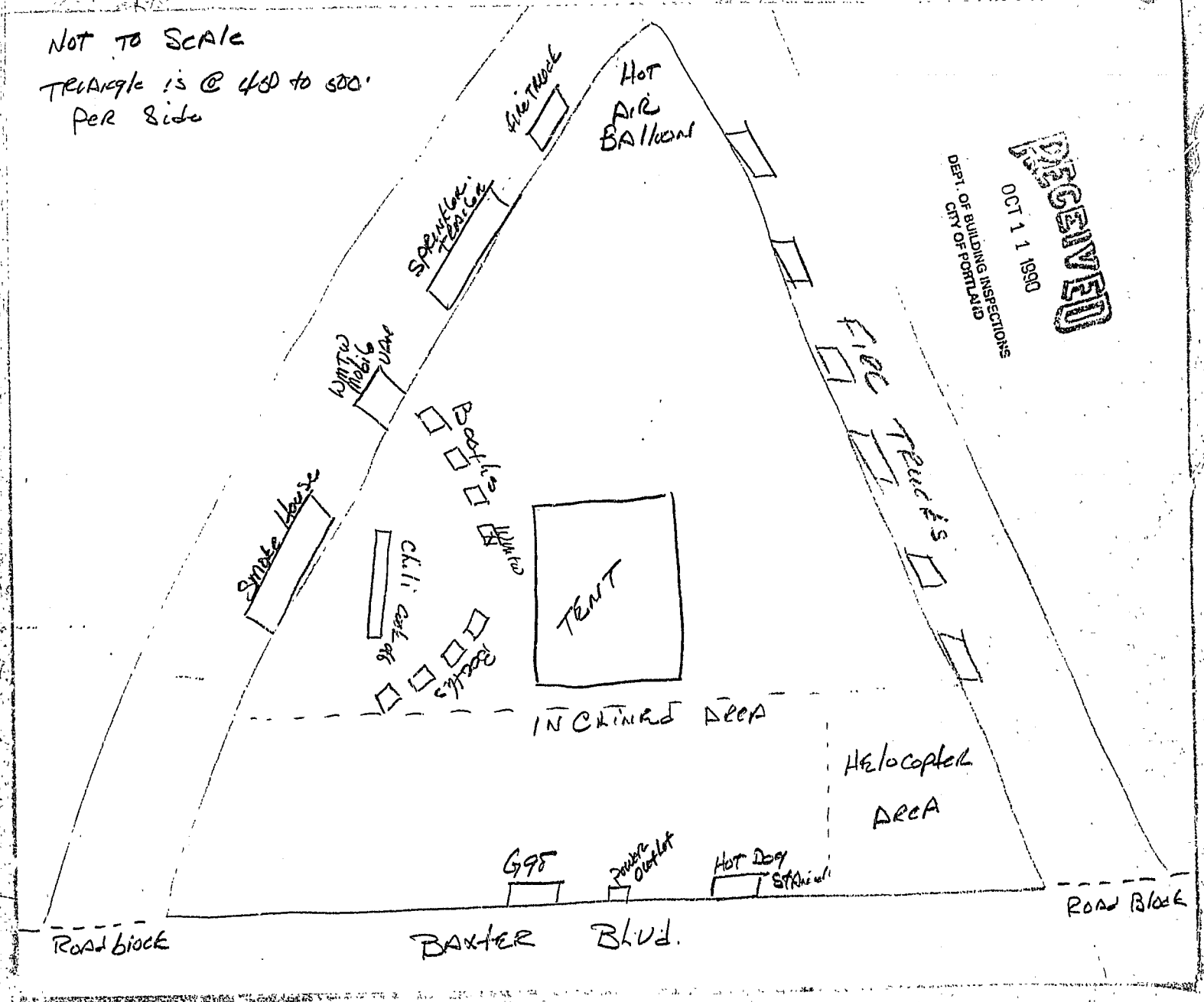

RECEIVED
OCT 11 1990
DEPT. OF BUILDING INSPECTIONS
CITY OF PORTLAND

PERMIT # 895 CITY OF Portland BUILDING PERMIT APPLICATION MAP # _____ LOT# _____

Please fill out any part which applies to job. Proper plans must accompany form.

Owner: D. R. Lawrence
 Address: 1436 Baxter Blvd.

LOCATION OF CONSTRUCTION 1436 Baxter Blvd.
 CONTRACTOR: John Robert & SO. SUBCONTRACTORS: 775-7795

ADDRESS: 7 Pilsbake St.
 Est. Construction Cost: 2,000 Type of Use: Residential

Past Use: _____
 Building Dimensions L _____ W _____ S. Ft. _____ # Stories _____ Lot Size: _____

Is Proposed Use: _____ Seasonal _____ Condominium _____ Apartment _____
 Conversion - Explain to construct a second floor deck as per plan

COMPLETE ONLY IF THE NUMBER OF UNITS WILL CHANGE
 Residential Buildings Only
 # Of Dwelling Units _____ # Of New Dwelling Units _____

Foundation:
 1. Type of Soil: _____
 2. Set Backs - Front _____ Rear _____ Side(s) _____
 3. Footings Size: _____
 4. Foundation Size: _____
 5. Other _____

Floor:
 1. Sills Size: _____ Sills must be anchored.
 2. Girder Size: _____
 3. Lally Column Spacing: _____ Size: _____
 4. Joists Size: _____ Spacing 16" O.C.
 5. Bridging Type: _____ Size: _____
 6. Floor Sheathing Type: _____ Size: _____
 7. Other Material: _____

Exterior Walls:
 1. Studding Size _____ Spacing _____
 2. No. windows _____
 3. No. Doors _____
 4. Header Sizes _____ Span(s) _____
 5. Bracing: Yes _____ No _____
 6. Corner Posts Size _____
 7. Insulation Type _____ Size _____
 8. Sheathing Type _____ Size _____
 9. Siding Type _____ Weather Exposure _____
 10. Masonry Materials _____
 11. Metal Materials _____

Interior Walls:
 1. Studding Size _____ Spacing _____
 2. Header Sizes _____ Span(s) _____
 3. Wall Covering Type _____
 4. Fire Wall if required _____
 5. Other Materials _____

For Official Use Only

Date: July 27, 1988 Subdivision: Yes / No _____
 Inside fire Limits _____ Name _____
 Slog Code _____ Lot _____
 Time Limit: _____ Block _____
 Estimated Cost: 2,000 Permit Expiration: _____ Public _____ Private _____
 Value/Structure _____
 Fee: 60.00

Ceiling:
 1. Ceiling Joists Size: _____
 2. Ceiling Strapping Size _____ Spacing _____
 3. Type Ceilings: _____
 4. Insulation Type _____
 5. Ceiling Height: _____

Roof:
 1. Truss or Rafter Size _____
 2. Sheathing Type _____
 3. Roof Covering Type _____
 4. Other _____

Chimneys:
 Type: _____ Number of Fire Places _____

Heating:
 Type of Heat: _____

Electrical:
 Service Entrance Size: _____ Smoke Detector Required Yes _____ No _____

Plumbing:
 1. Approval of soil test if required U.C. Yes _____ No _____
 2. No. of Tubs or Showers _____
 3. No. of Flushes _____
 4. No. of Lavatories _____
 5. No. of Other Fixtures U.C.

Swimming Pools:
 1. Type: _____
 2. Pool Size: _____ x _____ Square Footage _____
 3. Must conform to National Electrical Code and State Law.

Zoning:
 District R-3 Street Frontage Req.: _____ Provided _____
 Required Setbacks: Front _____ Back _____ Side _____

Review Required:
 Zoning Board Approval: Yes _____ No _____ Date: _____
 Planning Board Approval: Yes _____ No _____ Date: _____
 Conditional Use: _____ Variance _____ Site Plan _____ Subdivision _____
 Shore and Floodplain Mgmt _____ Special Exception _____
 Other (Explain) _____
 Date Approved July 27, 1988

Permit Received By Lisa Cushnet

Signature of Applicant _____ Date July 27, 1988

Signature of CEO _____

Inspection Dates _____

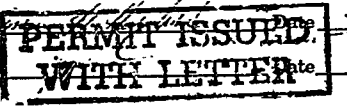

City of Portland, Maine - Building or Use Permit Application 389 Congress Street, 04101, Tel: (207) 874-8703, FAX: 874-8716

Location of Construction: Baxter Blvd		Owner: City	Phone:	Permit No: 950494
Owner Address:	Lease/Buyer's Name: Maine Veterinary Medical Assoc., Inc.	Phone:	Business Name:	PERMIT ISSUED Permit Issued: MAY 23 1995 CITY OF PORTLAND
Contractor Name:	Address:	Phone:		
Proposed Use: Parking Lot	Proposed Use: Same w/tent	COST OF WORK: \$	PERMIT FEE: \$ 35.00	
Proposed Project Description: Event tent from 19 May - 22 May 1995		FIRE DEPT. <input checked="" type="checkbox"/> Approved <input type="checkbox"/> Denied	INSPECTION: <input checked="" type="checkbox"/> Approved <input type="checkbox"/> Denied Use Group: Typ:	Zoning: CEB
Permit Taken By: Mary Gralik		Date Applied For: 18 May 1995		Zoning Approval: Special Zone or Reviews: <input type="checkbox"/> Shoreland <input type="checkbox"/> Wetland <input type="checkbox"/> Flood Zone <input type="checkbox"/> Subdivision <input type="checkbox"/> Site Plan n/a <input type="checkbox"/> minor <input type="checkbox"/> mm <input type="checkbox"/>

1. This permit application doesn't preclude the Applicant(s) from meeting applicable State and Federal rules.
 2. Building permits do not include plumbing, septic or electrical work.
 3. Building permits are void if work is not started within six (6) months of the date of issuance. False information may invalidate a building permit and stop all work.

Elizabeth Belliveau
Citrix Resources
1 Dana St.
Portland, ME 04101

CERTIFICATION

I hereby certify that I am the owner of record of the named property, or that the proposed work is authorized by the owner of record and that I have been authorized by the owner to make this application as his authorized agent and I agree to conform to all applicable laws of this jurisdiction. In addition, if a permit for work described in the application issued, I certify that the code official's authorized representative shall have the authority to enter all areas covered by such permit at any reasonable hour to enforce the provisions of the code(s) applicable to such permit

SIGNATURE OF APPLICANT: *Debra Difalco* ADDRESS: DATE: **18 May 1995** PHONE:

RESPONSIBLE PERSON IN CHARGE OF WORK, TITLE: PHONE:
 White-Permit Desk Green-Assessor's Canary-D.P.W. Pink-Public File Ivory Card-Inspector

Zoning Appeal
 Variance
 Miscellaneous
 Conditional Use
 Interpretation
 Approved
 Denied

Historic Preservation
 Not in District or Landmark
 Does Not Require Review
 Requires Review

Action:
 Approved
 Approved with Conditions
 Denied

Date: *5/19/95*

CEO DISTRICT **6**
Mary Gralik

COMMENTS

OK A. Lowe
6/14/95

Type	Inspection Record	Date
Foundation:	_____	_____
Framing:	_____	_____
Plumbing:	_____	_____
Final:	_____	_____
Other:	_____	_____

NUMIA Rabies Clinic

5/20/95

Pet Walk for Center for Grieving Children

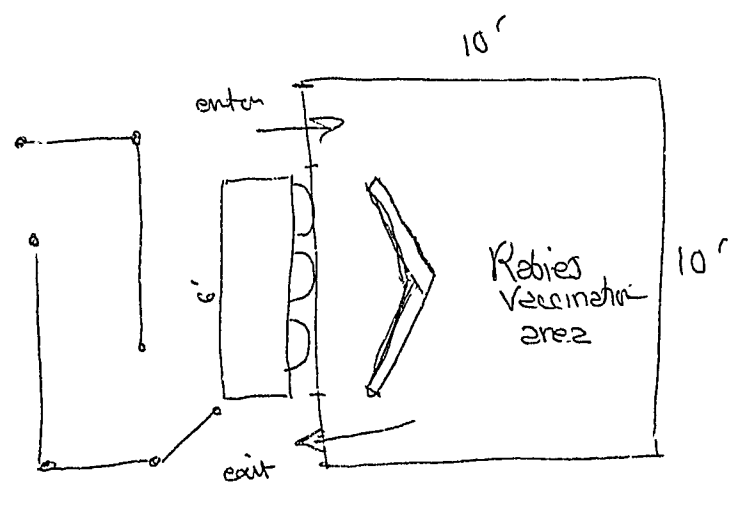

State of Illinois
Department of Health
Division of Environmental Health
Epidemiology and Prevention
Bureau of Disease Prevention
1001 North Dearborn Street
Chicago, IL 60610
Tel: (312) 463-5000
Fax: (312) 463-5001

940456

Permit # 940456 City of Portland BUILDING PERMIT APPLICATION Fee 35.00 Zone _____ Map # _____ Lot# _____

Please fill out any part which applies to job. Plans per plans must accompany form.

Owner: City of Portland Phone # _____
 Address: _____
 LOCATION OF CONSTRUCTION Back Cove (Soccer Field)
 Contractor: _____ Sub. _____
 Address: _____ Phone # _____
 Est. Construction Cost: _____ Proposed Use: Soccer Field w/tent
 Past Use: Soccer Field
 # of Existing Res Units _____ # of New Res. Units _____
 Building Dimensions L _____ W _____ Total Sq Ft. _____
 # Stories: _____ # Bedrooms _____ Lot Size: _____
 Is Proposed Use: Seasonal _____ Condominium _____ Conversion _____
 Explain Conversion Erect Tent from 5-20 thru 5-22

For Official Use Only
 Date 20 May '94 Subdivision: _____
 Inside Fire Limits: _____ Name: _____
 Fldg Code: _____ Lot: _____
 Type Limit: _____ Ownership: MAY 20 1994 Public
 Estimated Cost: _____ Private

Zoning: _____
 Street Frontage Provided: _____
 Provided Setbacks: Front _____ Back _____ Side 4' Side _____
 Review Required:
 Zoning Board Approval: Yes _____ No _____ Date: _____
 Planning Board Approval: Yes _____ No _____ Date: _____
 Conditional Use: _____ Variance _____ Site Plan _____ Subdivision _____
 Shoreland Zoning Yes _____ No _____ Floodplain Yes _____ No _____
 Special Exception _____
 Other (Explain) _____

Foundation:
 1. Type of Soil: _____
 2. Set Backs - Front _____ Rear _____ Side(s) _____
 3. Footings Size: _____
 4. Foundation Size: _____
 5. Other _____

Floor:
 1. Sills Size: _____ Sills must be anchored.
 2. Girder Size: _____
 3. Lally Column Spacing: _____ Size: _____
 4. Joists Size: _____ Spacing 16" O.C.
 5. Bridging Type: _____ Size: _____
 6. Floor Sheathing Type: _____ Size: _____
 7. Other Material: _____

Exterior Walls:
 1. Studding Size _____ Spacing _____
 2. No. windows _____
 3. No. Doors _____
 4. Header Sizes _____ Span(s) _____
 5. Bracing: Yes _____ No _____
 6. Corner Posts Size _____
 7. Insulation Type _____ Size _____
 8. Sheathing Type _____ Size _____
 9. Siding Type _____ Weather Exposure _____
 10. Masonry Materials _____
 11. Metal Materials _____

Interior Walls:
 1. Studding Size _____ Spacing _____
 2. Header Sizes _____ Span(s) _____
 3. Wall Covering Type _____
 4. Fire Wall if required _____
 5. Other Materials _____

Ceiling:
 1. Ceiling Joists Size: _____
 2. Ceiling Strapping Size _____ Spacing _____
 3. Type Ceilings: _____
 4. Insulation Type _____ Size _____
 5. Ceiling Height: _____

Roof:
 1. Truss or Rafter Size _____ Span _____
 2. Sheathing Type _____ Size _____
 3. Roof Covering Type _____

Chimneys:
 Type _____ Number of Fire Places _____

Heating:
 Type of Heat: _____

Electrical:
 Service Entrance Size: _____ Smoke Detector Required Yes _____ No _____

Plumbing:
 1. Approval of soil test if required Yes _____ No _____
 2. No. of Tubs or Showers _____
 3. No. of Flushes _____
 4. No. of Lavatories _____
 5. No. of Other Fixtures _____

Swimming Pools:
 1. Type: _____
 2. Pool Size: _____ x _____ Square Footage _____
 3. Must conform to National Electrical Code and State Law.

Permit Received By Mary Gresik

Signature of Applicant _____ Date 20 May '94

CEO's District 67 Bob Jones

CONTINUED TO REVERSE SIDE

Ivory Tag - CEO

White - Tax Assessor

S.P.C. TRANSPORT INC
150 READ ST
PORTLAND, ME 775-0223
04104

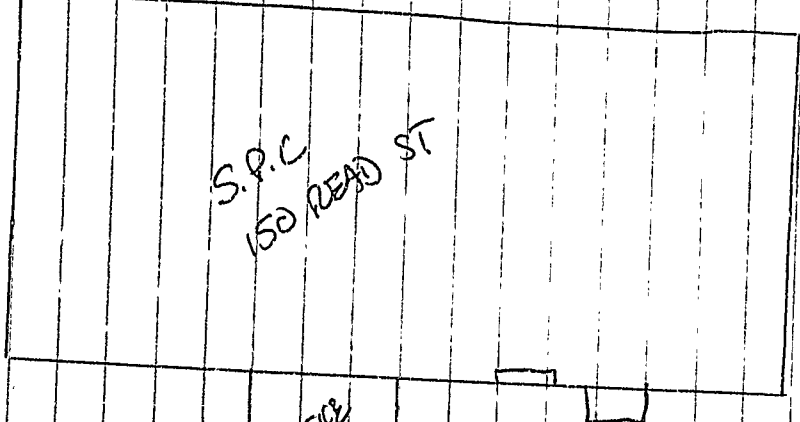

* 12x11 STEEL STORAGE
CAGE FOR OUTDOOR
STORAGE OF FORKlift C.B.
WITH LOCKING DOOR &
MARKERS FOR PROPANE

RECEIVED
MAY 1 1980
CIVIL SERVICE COMMISSION
STATE OF MAINE

READ ST

RR

Certificate of Flame Resistance

REGISTERED
APPLICATION
NUMBER

F121.4



ISSUED BY
ANCHOR INDUSTRIES INC.
EVANSVILLE, INDIANA 47711

MANUFACTURERS OF THE FINISHED
TENT PRODUCTS DESCRIBED HEREIN

Date of Manufacture

970892 7/9/92

SERIAL #.

8115930

This is to certify that the materials described have been flame-retardant treated (or are inherently nonflammable) and were supplied to:

NAME: LOGICAL SOLUTIONS
CITY WINDHAM STATE ME

Certification is hereby made that:
The articles described on this Certificate have been treated with a flame-retardant approved chemical and that the application of said chemical was done in conformance with California Fire Marshall Code, equal to or exceeds NFPA 701, CPAI 84 GOVERNMENT CERTIFIED LAB #3056

Method of application: LAMINATED
MIL - C - 43006D NYC - 374 - 85 - SM U.I. - 214

Type, color and weight of canvas/vinyl: 10 OZ. BOYLES BIG TOP VINYL LAMINATE BLUE & WHITE

Description of item certified: (1) AP CPY TOP 20W X 30

**Flame Retardant Process Used Will Not Be Removed By
Washing And Is Effective For The Life Of The Fabric**

JOHN BOYLE & CO.
Name of Applicator of Flame Resistant Finish
STATESVILLE, NC

Signed: *Louis R. Brown*
TENT DEPARTMENT - ANCHOR INDUSTRIES INC.
LOUIS R. BROWN

Permit # 940456 City of Portland BUILDING PERMIT APPLICATION Fee 35.00 Zone _____ Map # _____ Lot# _____
 Please fill out any part which applies to job. Proper plans must accompany form.

Owner: City of Portland Phone # _____
 Address: _____
 LOCATION OF CONSTRUCTION Back Cove (Soccer Field)
 Contractor: _____ Sub: _____
 Address: _____ Phone # _____
 Est. Construction Cost: _____ Proposed Use: Soccer Field w/tent
 Past Use: Soccer Field
 # of Existing Res. Units _____ # of New Res. Units _____
 Building Dimensions L _____ W _____ Total Sq. Ft. _____
 # Stories: _____ # Bedrooms _____ Lot Size: _____
 Is Proposed Use: Seasonal _____ Condominium _____ Conversion _____
 Explain Conversion: Erect Tent from 5-20 thru 5-22

For Official Use Only

Date 20 May '94 Subdivision _____
 Inside Fire Limits _____ Name _____
 Bldg Code _____ Lot _____
 Time Limit _____ Ownership: _____
 Estimated Cost _____

PERMIT ISSUED
 MAY 20 1994
 Private

Zoning: CITY OF PORTLAND
 Street Frontage Provided: _____
 Provided Setbacks: Front _____ Back _____ Side _____ Side _____

Review Required:
 Zoning Board Approval: Yes _____ No _____ Date: _____
 Planning Board Approval: Yes _____ No _____ Date: _____
 Conditional Use: _____ Variance _____ Site Plan _____ Subdivision _____
 Shoreland Zoning Yes _____ No _____ Floodplain: Yes _____ No _____
 Special Exception _____
 Other _____ (Explain) _____

Foundation:
 1. Type of Soil: _____
 2. Set Backs - Front _____ Rear _____ Side(s) _____
 3. Footings Size: _____
 4. Foundation Size: _____
 5. Other _____

Floor:
 1. Sills Size: _____ Sills must be anchored.
 2. Girder Size: _____
 3. Lally Column Spacing: _____ Size: _____
 4. Joists Size: _____ Spacing 16" O.C.
 5. Bridging Type: _____ Size: _____
 6. Floor Sheathing Type: _____ Size: _____
 7. Other Material: _____

Exterior Walls:
 1. Studding Size _____ Spacing _____
 2. No. windows _____
 3. No. Doors _____
 4. Header Sizes _____ Spun(s) _____
 5. Bracing: Yes _____ No _____
 6. Corner Posts Size _____
 7. Insulation Type _____ Size _____
 8. Sheathing Type _____ Size _____
 9. Siding Type _____ Weather Exposure _____
 10. Masonry Materials _____
 11. Metal Materials _____

Interior Walls:
 1. Studding Size _____ Spacing _____
 2. Header Sizes _____ Span(s) _____
 3. Wall Covering Type _____
 4. Fire Wall if required _____
 5. Other Materials _____

Ceiling:
 1. Ceiling Joists Size: _____
 2. Ceiling Strapping Size _____ Spacing _____
 3. Type Ceilings: _____
 4. Insulation Type _____ Size _____
 5. Ceiling Height: _____

Roof:
 1. Truss or Rafter Size _____ Span _____
 2. Sheathing Type _____ Size _____
 3. Roof Covering Type _____

Chimneys:
 Type: _____ Number of Fire Places _____

Heating:
 Type of Heat: _____

Electrical:
 Service Entrance Size: _____ Smoke Detector Required Yes _____ No _____

Plumbing:
 1. Approval of soil test if required Yes _____ No _____
 2. No. of Tubs or Showers _____
 3. No. of Flushes _____
 4. No. of Lavatories _____
 5. No. of Other Fixtures _____

Swimming Pools:
 1. Type: _____
 2. Pool Size: _____ x _____ Square Footage _____
 3. Must conform to National Electrical Code and State Law.

Permit Received By Mary Gresik
 Signature of Applicant _____ Date 20 May '94
 CEO's District (2) Bob Jones

CONTINUED TO REVERSE SIDE [Signature]
 Ivory Tag - CEO

White - Tax Assessor

Certificate of Flame Resistance

REGISTERED APPLICATION NUMBER

F121.4



ISSUED BY ANCHOR INDUSTRIES INC. EVANSVILLE, INDIANA 47711

MANUFACTURERS OF THE FINISHED TENT PRODUCTS DESCRIBED HEREIN

Date of Manufacture

INV#052003 1/1/00

This is to certify that the materials described have been flame-retardant treated (or are inherently nonflammable) and were supplied to:

NAME: HANDYMAN EQUIP RENTAL CO. / ONE STOP PARTY SHOP
CITY PORTLAND STATE ME

Certification is hereby made that:
The articles described on this Certificate have been treated with a flame-retardant approved chemical and that the application of said chemical was done in conformance with California Fire Marshall Code, equal to or exceeds NFPA 701, CPAI 84 GOVERNMENT CERTIFIED LAB #3056

Method of application: LAMINATED
MIL-C-48066D, NYC-374-65-SM

Type, color and weight of canvas/vinyl: BOYLES BIG TOP VINYL LAMINATE YELLOW/WHITE

Description of item certified: (1) 20 X 20' APC

Flame Retardant Process Used Will Not Be Removed By Washing And Is Effective For The Life Of The Fabric

JOHN BOYLE & CO.
Name of Applicator of Flame Resistant Finish
STATESVILLE, NC

Signed: *Louis B. Brown*
TENT DEPARTMENT - ANCHOR INDUSTRIES INC.
LOUIS B. BROWN

City of Portland, Maine - Building or Use Permit Application 389 Congress Street, 04101, Tel: (207) 874-8703, FAX: 874-8716

Location of Construction: Baxter Blvd		Owner: City	Phone:	Permit No: 950494
Owner Address:	Leasee/Buyer's Name: Maine Veterinary Medical Assoc., Inc.	Phone:	Business Name:	
Contractor Name:	Address:	Phone:		PERMIT ISSUED Permit issued: MAY 23 1995 CITY OF PORTLAND
Past Use: Parking Lot	Proposed Use: Same w/tent	COST OF WORK: \$	PERMIT FEE: \$ 35.00	
Proposed Project Description: Erect tent from 19 May - 22 May 1995		FIRE DEPT. <input checked="" type="checkbox"/> Approved <input type="checkbox"/> Denied	INSPECTION: Use Group: Type:	
		Signature: <i>[Signature]</i>	Signature:	
		PEDESTRIAN ACTIVITIES DISTRICT (P.U.D.)		Zone: ASO CBL:
		Action: <input type="checkbox"/> Approved <input type="checkbox"/> Approved with Conditions <input type="checkbox"/> Denied	Zoning Approval: AS	
Permit Taken By: Mary Gresik		Date Applied For: 18 May 1995		

1. This permit application doesn't preclude the Applicant(s) from meeting applicable State and Federal rules.
2. Building permits do not include plumbing, septic or electrical work.
3. Building permits are void if work is not started within six (6) months of the date of issuance. False information may invalidate a building permit and stop all work.

Elizabeth Belliveau
Citrine Resources
1 Dana St
Portland, ME 04101

CERTIFICATION

I hereby certify that I am the owner of record of the named property, or that the proposed work is authorized by the owner of record and that I have been authorized by the owner to make this application as his authorized agent and I agree to conform to all applicable laws of this jurisdiction. In addition, if a permit for work described in the application issued, I certify that the code official's authorized representative shall have the authority to enter all areas covered by such permit at any reasonable hour to enforce the provisions of the code(s) applicable to such permit

Debra DiFalco Tower X 222 St John St - 18 May 1995 772-7775
 SIGNATURE OF APPLICANT Debra DiFalco ADDRESS: DATE: PHONE:

RESPONSIBLE PERSON IN CHARGE OF WORK, TITLE PHONE:
 White-Permit Desk Green-Assessor's Canary-D.P.W. Pink-Public File Ivory Card-Inspector

PERMIT ISSUED	
Permit issued: MAY 23 1995	
CITY OF PORTLAND	
Zone: ASO	CBL:
Zoning Approval: AS	
Special Zone or Reviews:	
<input type="checkbox"/> Shoreland	
<input type="checkbox"/> Wetland	
<input type="checkbox"/> Flood Zone	
<input type="checkbox"/> Subdivision	
<input type="checkbox"/> Site Plan ma <input type="checkbox"/> minor <input type="checkbox"/> mm <input type="checkbox"/>	
Zoning Appeal	
<input type="checkbox"/> Variance	
<input type="checkbox"/> Miscellaneous	
<input type="checkbox"/> Conditional Use	
<input type="checkbox"/> Interpretation	
<input type="checkbox"/> Approved	
<input type="checkbox"/> Denied	
Historic Preservation	
<input checked="" type="checkbox"/> Not In District or Landmark	
<input type="checkbox"/> Does Not Require Review	
<input type="checkbox"/> Requires Review	
Action:	
<input type="checkbox"/> Approved	
<input type="checkbox"/> Approved with Conditions	
<input type="checkbox"/> Denied	
Date: <i>5/19/95</i>	
<i>[Signature]</i>	
CEO DISTRICT 6	
<i>[Signature]</i>	

City of Portland, Maine - Building or Use Permit Application 389 Congress Street, 04101, Tel: (207) 874-8703, FAX: 874-8716

Location of Construction: 11 Baxter Blvd		Owner: Crossland Mortgage	Phone:
Owner Address:		Leasee/Buyer's Name: Crossland Mortgage	Business Name:
Contractor Name: Ace Building Movers		Address: 266 Beechridge Rd Scarborough, ME 04074	
Past Use: Vacant		Proposed Use: Office	Phone: 839-4296
Proposed Project Description: Change Use/Make Interior Renovations		COST OF WORK: \$ 20,000.00	PERMIT FEE: \$ 125.00
		FIRE DEPT. <input checked="" type="checkbox"/> Approved <input type="checkbox"/> Denied	INSPECTION: Use Group: Type:
		Signature: <i>[Signature]</i>	Signature:

Permit No: **960532**

PERMIT ISSUED

JUN 12 1996

CITY OF PORTLAND

15-2

Zoning Approval: *[Signature]* 6/10/96

Special Zone or Reviews:

- Shoreland
- Wetland
- Flood Zone
- Subdivision
- Site Plan major minor mm

Permit Taken By: **Mary Gresik** Date Applied For: **05 June 1996**

- This permit application doesn't preclude the Applicant(s) from meeting applicable State and Federal rules.
- Building permits do not include plumbing, septic or electrical work.
- Building permits are void if work is not started within six (6) months of the date of issuance. False information may invalidate a building permit and stop all work.

Call leave message for [Signature]

PERMIT ISSUED WITH REQUIREMENTS

CERTIFICATION
I hereby certify that I am the owner of record of the named property, or that the proposed work is authorized by the owner of record and that I have been authorized by the owner to make this application as his authorized agent and I agree to conform to all applicable laws of this jurisdiction. In addition, if a permit for work described in the application issued, I certify that the code official's authorized representative shall have the authority to enter all areas covered by such permit at any reasonable hour to enforce the provisions of the code(s) applicable to such permit

SIGNATURE OF APPLICANT: *[Signature]* **Oren Ahlquist** ADDRESS: **266 Beech Ridge Rd.** DATE: **05 June 1996** PHONE:

RESPONSIBLE PERSON IN CHARGE OF WORK, TITLE: _____ PHONE: _____

Zoning Appeal

- Variance
- Miscellaneous
- Conditional Use
- Interpretation
- Approved
- Denied

Historic Preservation

- Not in District or Landmark
- Does Not Require Review
- Requires Review

Action:

- Approved
- Approved with Conditions
- Denied

Date: *6/7/96*

[Signature]

CEO DISTRICT **5**

[Signature]

White-Permit Desk Green-Assessor's Canary-D.P.W. Pink-Public File Ivory Card-Inspector