

es 1225  
 186.47  
 quality 1411.77

# Custom Garage Series

Designed with Extra Features - Top of the Line

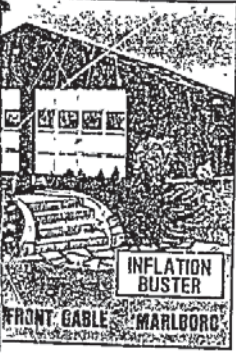
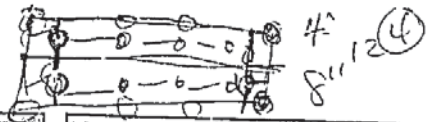

INFLATION BUSTER

FRONT GABLE MARLBORO



12'x22' 1 CAR FRONT GABLE MONMOUTH

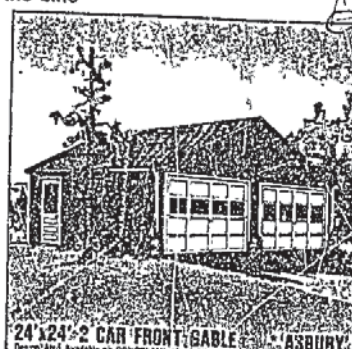

24'x24' 2 CAR FRONT GABLE ASBURY

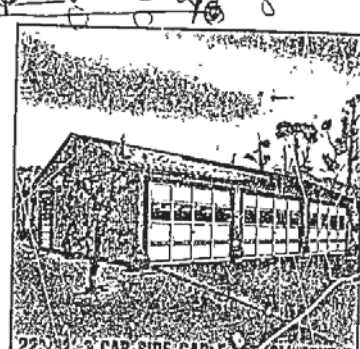

22'x42' 3 CAR SIDE GABLE PLYMOUTH

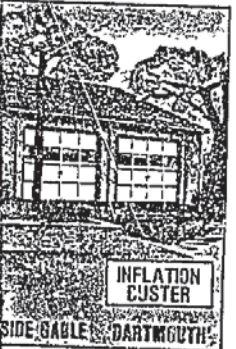

INFLATION BUSTER

SIDE GABLE DARTMOUTH



14'x22' 1 CAR SALT BOX SALEM

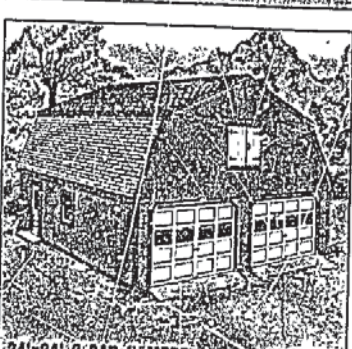

24'x24' 2 CAR GAMBREL HALIFAX

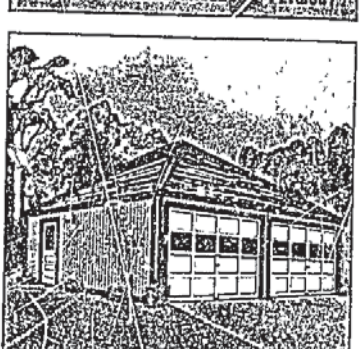

20'x22' 2 CAR HIP ROOF DOVER

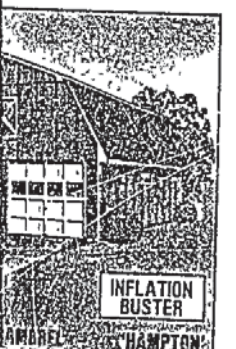

INFLATION BUSTER

GAMBREL HAMPTON

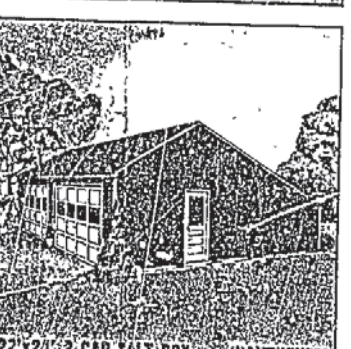

22'x24' 2 CAR SALT BOX HANTUCKET



24'x24' 2 CAR SIDE GABLE DUXBURY

## Options Available

The following options are available.

- Choice of Siding to Match Your Home
- A One-Piece, 16 ft Sectional Garage Door (On All 2-Car Models)
- Grossman's Wide in Stock Assortment of Quality Paints and Stains

Options Available at Extra Cost

**OPTIONS**  
 • Overhead sectional, per plan  
 • 28x12 • Closed in  
 • fascia and planica • Nails and  
 • trim pine (rake and corner boards)  
 • or 4'x8'x1/2" wood water board  
 • (for plans and materials list  
 • Assembly instructions  
 • paint not included

## CUSTOM GARAGE SPECIFICATIONS

- All lumber to be construction grade Standard or better
- Sills 2x6 • Studs 2x4 16" on Center • Corner Posts 3 2x4's built-up • Garage Door Header 2 2x10's • Window Headers 2 2x10's • Walk Out Door Headers 2-2x10's (if applicable) • Shoe 2x4 • Plate 2x4 Doubled (per plan)
- Rafters 2x6 - 16' on Center (for conventional packages)
- Prebuilt Roof Trusses 2x4 24' on Center for panelized packages • Roof Sheathing 4'x8'x1/2" CDX Plyscore or 1/2" Ply strand • Asphalt Felt for roof
- Roof Shingles - self sewing • Garage Doors 9x7 sectional overhead with hardware (per plan)
- Windows - wood double hung 1/1 sash • led No 2432
- Exterior Doors - wood 2'8"x6'5"x1 1/4" for 2 and 3 car models • Closed in rafter overhang 1x6 pine fascia and planica • Nails, hardware and flashing per plan
- Trim - Pine (rake and corner boards) • Exterior Sidewall cover - 1/2" Texture 1-11 (basic siding) • Architectural plans and materials list • Assembly instructions
- Template for conventional roof rafters • Cement, foundation, paint not included

ALL MATERIALS PER SPECIFICATIONS. MODELS MARKED WITH ASTERISK\* ALSO AVAILABLE IN PANELIZED PACKAGES.



APPLICATION FOR PERMIT

B.O.C.A. USE GROUP .....  
 B.O.C.A. TYPE OF CONSTRUCTION ..... 65<sup>A</sup>

ZONING LOCATION ..... PORTLAND, MAINE

PERMIT ISSUED

JUN 15 1984

CITY of PORTLAND

To the CHIEF OF BUILDING & INSPECTION SERVICES, PORTLAND, MAINE

The undersigned hereby applies for a permit to erect, alter, repair, demolish, move or install the following building, structure, equipment or change use in accordance with the Laws of the State of Maine, the Portland B.O.C.A. Building Code and Zoning Ordinance of the City of Portland with plans and specifications if any submitted herewith and the following specifications:

LOCATION ..... Beach Road Cliff Is. Fire District #1  #2   
 1 Owner's name and address ..... Ben. O'Reilly Telephone 766-2032  
 2 Lessee's name and address ..... Telephone .....  
 3 Contractor's name and address ..... O.W. [unclear] Telephone .....  
 Proposed use of building ..... Storage No. of sheets .....  
 Last use ..... Storage No. families .....  
 Material Wood No. stories 1 Heat No Style of roof Gable Roofing Ash  
 Other buildings on same lot ..... One Family Dwelling  
 Estimated contractor's cost \$2000 Appeal Fees \$ .....  
 FIELD INSPECTOR—Mr. Addato ..... Base Fee \$1500  
 @ 775-1451 Late Fee .....  
 TOTAL \$2000

To be placed on site of  
 old structure, (fire last year)  
 22' storage shed.

Stamp of Special Conditions

NOTE TO APPLICANT: separate permits are required by the installers and subcontractors of heating, plumbing, electrical and mechanicals.

DETAILS OF NEW WORK

Is any plumbing involved in this work? No Is any electrical work involved in this work? Yes  
 Is connection to be made to public sewer? No If not what is proposed for sewage? No  
 Has septic tank notice been sent? No Form notice sent? No  
 Height average grade to top of plate 8 Height average grade to highest point of roof .....  
 Size, front depth No. stories ..... solid or filled land? earth or rock?  
 Material of foundation 2000 Tubes Thickness top 8 bottom .....  
 Kind of roof ASP Rise per foot 5/12 Roof covering ASP  
 No. of chimneys No Material of chimneys 5/12 Kind of heat fuel  
 Framing Lumber—Kind Dressed or full size? 4x4 Corner posts built up Sills 2x4  
 Size Girder 4x8 Columns under girders Size Max. on centers 16  
 Sills (outside walls and carrying partitions) 2x4-16" O.C. Bridging in every floor and flat roof span over 8 feet.  
 Joists and rafters 2x4 1st floor 2x8 2nd ..... 3rd ..... roof  
 On center 1st floor ..... 2nd ..... 3rd ..... roof  
 Maximum span 1st floor ..... 2nd ..... 3rd ..... roof  
 If one story building with masonry walls, thickness of walls? height?

IF A GARAGE

No cars now accommodated on same lot ..... to be accommodated ..... number commercial cars to be accommodated .....  
 Will automobile repairing be done other than minor repairs to cars habitually stored in the proposed building? .....

APPROVALS BY: DATE MISCELLANEOUS  
 BUILDING INSPECTION—PLAN EXAMINER ..... Will work require disturbing of any tree on a public street? .....  
 ZONING: .....  
 BUILDING CODE: ..... Will there be in charge of the above work a person competent  
 Fire Dept.: ..... to see that the State and City requirements pertaining thereto  
 Health Dept.: ..... are observed? .....  
 Others: .....

Signature of Applicant ..... Ben. O'Reilly Phone # .....  
 Type Name of above ..... 1  2  3  4   
 Owner .....  
 and Address .....

FIELD INSPECTOR'S COPY APPLICANT'S COPY OFFICE FILE COPY

*[Handwritten signature]*

