

REGISTERED NO.

3476

Value \$ <i>N.V.</i>	Special Delivery \$
Reg Fee \$ <i>95</i>	Return Receipt \$ <i>15</i>
Handling Charge \$	Restricted Delivery \$
Postage \$ <i>04</i>	<input type="checkbox"/> AIRMAIL



POSTMASTER USE

FROM *City of Portland Me.*

*115 Peter St. W.*

*Portland Me.*

TO *Mr. Robert R. Conyatt, President*

*James Beck*

*Woolwich, Me. 04579*

MAILING OFFICE

U.S. POST OFFICE

PLEASE, FURNISH SERVICE(S) INDICATED BY CHECKED BLOCK(S)  
(REQUIRED FEE(S) PAID)



Show to whom, date and address  
where delivered



Deliver ONLY  
to addressee

**RECEIPT**

Received the numbered article described below

REGISTERED NO.

3476

SIGNATURE OR NAME OF ADDRESSEE (Must always be filled in)

CERTIFIED NO.

1

*Robert A. Brandon*

INSURED NO.

2

SIGNATURE OF ADDRESSEE'S AGENT, IF ANY

DATE DELIVERED

2-26-72

SHOW WHERE DELIVERED (only if requested)



POST OFFICE DEPARTMENT  
OFFICIAL BUSINESS



NECESSARY FOR PRIVATE USE TO AVOID  
PAYMENT OF POSTAGE, 100

POSTMARK OF DELIVERING OFFICE

Print your name and address below. If you want to  
resubmit delivery, or to have the address of delivery  
shown on this receipt, check block(s) on other side.  
Moisten gummed ends and attach this card to back of  
article.

RETURN  
TO

Building & Inspection Services  
Room 113, City Hall, 389 Congress Street  
Portland, Maine 04111

FD-38 (Rev. 3-11-67) Apr. 1969

reg.mail  
ret-rac.req.

Cliff Island  
Assrs.109 B-D-2  
Lot 2

Feb. 23, 1972

Mr. & Mrs. Robert R. & Emily A. Bowdoin  
River Road  
Woolwich, Maine, 04579

cc to: Corporation Counsel

Dear Mr. & Mrs. Bowdoin:

Recently I had the opportunity to visit Cliff Island as Director of the Building Inspection Department along with the City Manager and members of the Council and had the opportunity to look at the above named property. I found that it was in a very bad state of repair, much of it decayed and the inside in terrible condition.

As Building Inspector it is my duty to inform you that this structure is no longer of habitable value and should be demolished. As the structure stands now it is an open harborage for vandalism and possible fire which could in turn do great damage to other cottages on the Island. Please be advised that I am requesting that it be demolished and the sooner the better as work of this nature on the Islands usually must be done during the snowfall time of the year so that the parts can be properly burned without spreading fire elsewhere. I would appreciate your advising me of what you intend to do. A permit is required through this office for a demolition so that it can be removed from the tax record. Please advise me of what disposition you intend to make of this structure.

Very truly yours,

R. Lovell Brown  
Director

RLB:m

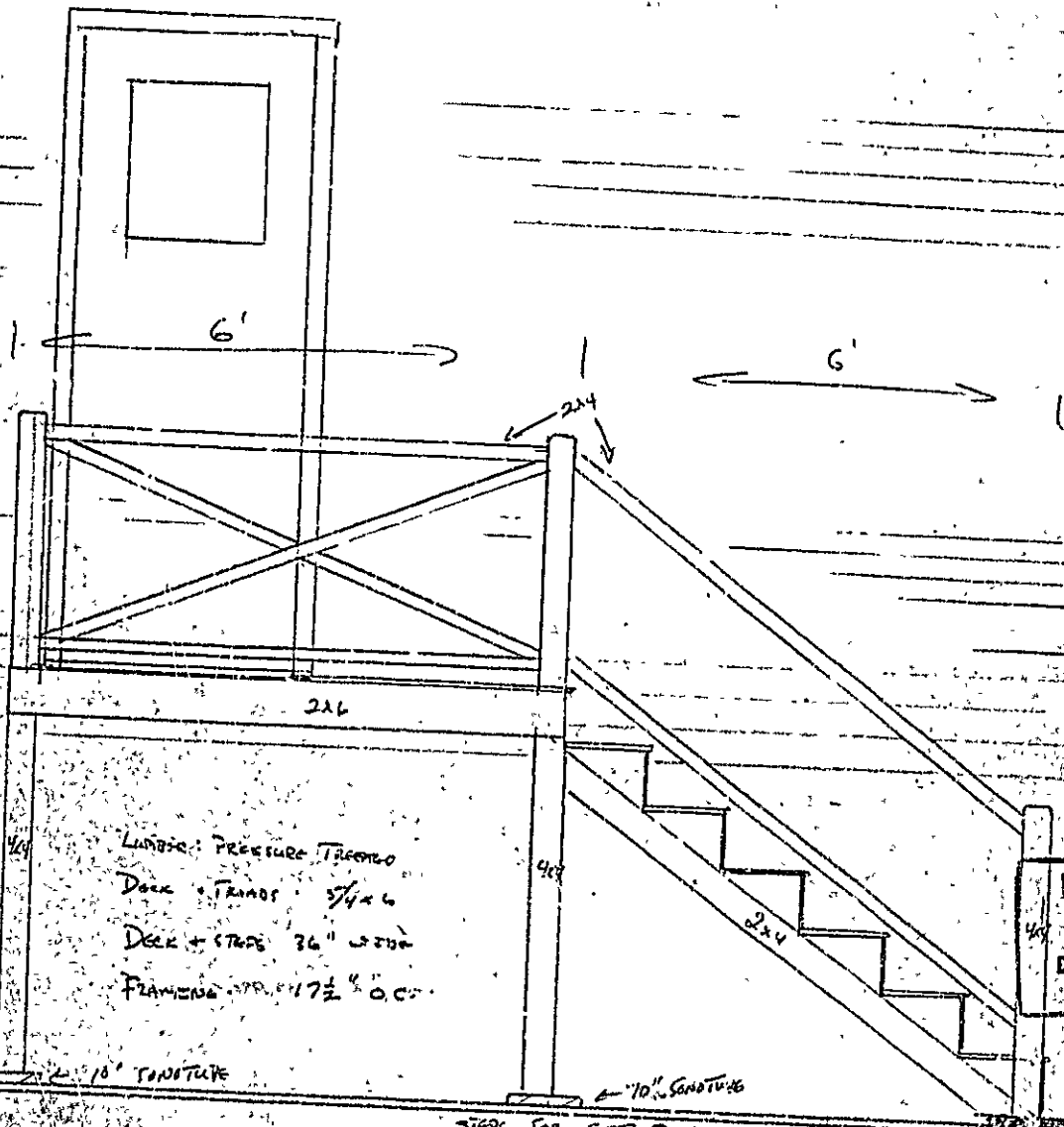

LUMBER: PRESSURE TREATED  
 Deck + RAILS 5/4 x 6  
 Deck + STAIRS 3/4" x 6"  
 FRAMING 2x4 @ 17 1/2" O.C.

**RECEIVED**  
 SEP 29 1983  
 DEPT. OF BLDG. INSP.  
 CITY OF PORTLAND

BUILDER  
 ROBERT M. JAMES  
 CLIFF ISLAND

STAIRS FOR CLIFF IS. LIBRARY  
 LOT # 109-B-D-1

CHECK FOR  
 PRO  
 ON LOGS



## CITY OF PORTLAND

JOSEPH E. GRAY, JR.  
DIRECTOR OF PLANNING  
AND URBAN DEVELOPMENT

September 29, 1983

Mr. Robert Howard  
Cliff Island, Maine

Dear Sir:

Your application to construct a set of stairs at Cliff Island Library has been reviewed and a building permit is herewith issued subject to the following requirement:

The maximum riser shall be 7 inches minimum riser 4".  
Minimum tread 11 inches.

If you have any questions on this requirement, please call this office.

Sincerely,

P. Samuel Hoffses  
Chief of Inspections Services

PSH/ulb

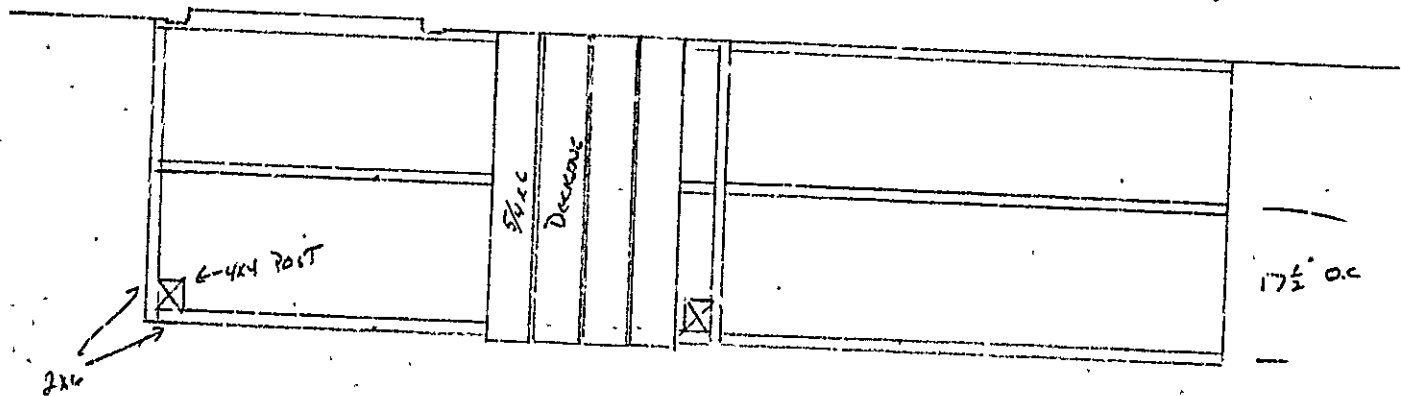

RECEIVED  
SEP 29 1983  
DEPT. OF BLDG. INSP.  
CITY OF PORTLAND

FRANCOIS PIANO  
CLIFF IS. LIBRARY  
LOT 109-B-D-1

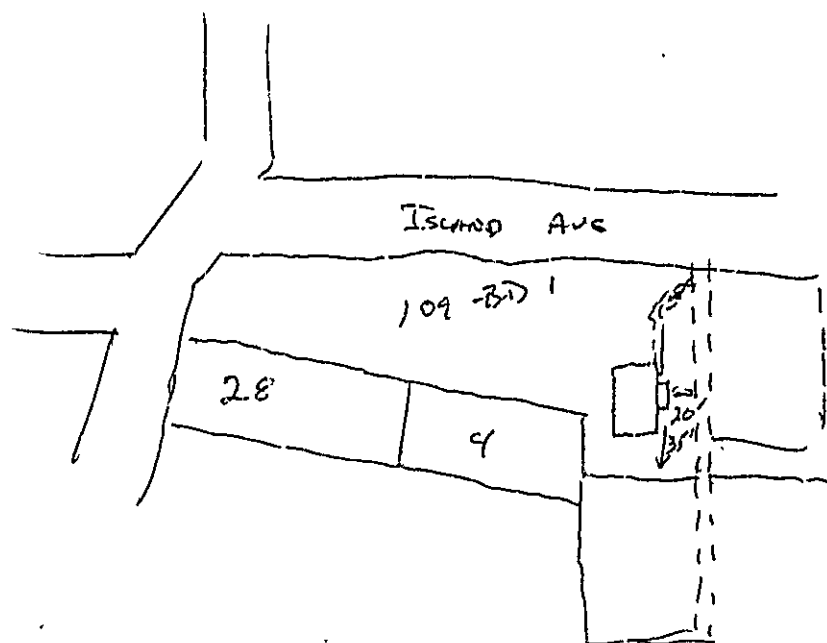

LOT PLAN SHOWING  
STEPS BRIDGE ADDED TO  
CLIFF ISLAND LIBRARY

RECEIVED  
SEP 29 1983  
DEPT. OF BLDG. INSP.  
CITY OF PORTLAND



APPLICATION FOR PERMIT

B.O.C.A. USE GROUP .....
B.O.C.A. TYPE OF CONSTRUCTION ..... 071046
ZONING LOCATION ..... PORTLAND, MAINE Sept. 29, 1983

PERMIT ISSUED

OCT 6 1983

CITY OF PORTLAND

To the CHIEF OF BUILDING & INSPECTION SERVICES, PORTLAND, MAINE

The undersigned hereby applies for a permit to erect, alter, repair, demolish, move or install the following building, structure, equipment or change use in accordance with the Laws of the State of Maine, the Portland B.O.C.A. Building Code and Zoning Ordinance of the City of Portland with plans and specifications, if any, submitted herewith and the following specifications:

LOCATION .... 109-32-1 Island Avenue, Cliff Island ..... Fire District #1 [ ], #2 [ ]
1. Owner's name and address Cliff Isl. Library association - same ..... Telephone none .....
2. Lessee's name and address ..... Telephone .....
3. Contractor's name and address Robert Howard - Cliff Island ..... Telephone 766-2850 .....

Proposed use of building Library with back stairway ..... No. of sheets .....
Last use ..... No. families .....
Material ..... No. stories ..... Heat ..... Style of roof ..... Roofing .....

Other buildings on same lot .....
Estimated contractual cost \$ 600.00 ..... Appeal Fees \$ .....
Base Fee 15.00

FIELD INSPECTOR-Mr. @ 775-5451 ..... Late Fee .....
TOTAL \$ 15.00

To construct set of stairs (wooden) on back of building as per plans. 3 sheets of plans.

send permit to # 3 4019.

Stamp of Special Conditions
PERMIT ISSUED WITH LETTER

NOTE TO APPLICANT: Separate permits are required by the installers and subcontractors of heating, plumbing, electrical and mechanicals.

DETAILS OF NEW WORK

Is any plumbing involved in this work? no Is any electrical work involved in this work? no
Is connection to be made to pub. sewer? If not, what is proposed for sewage?
Has septic tank notice been sent? Form notice sent?
Height average grade to top of plate Height average grade to highest point of roof
Size, front depth No. stories solid or filled land? earth or rock?
Material of foundation Thickness, top bottom cellar
Kind of roof Rise per foot Roof covering
No. of chimneys Material of chimneys of lining Kind of heat fuel
Framing Lumber-Kind Dressed or full size? Corner posts Sills
Size Girder Columns under girders Size Max. on centers
Studs (outside walls and carrying partitions) 2x4-16" O. C. Bridging in every floor and flat roof span over 8 feet.
Joists and rafters: 1st floor 2nd 3rd roof
On centers: 1st floor 2nd 3rd roof
Maximum span: 1st floor 2nd 3rd roof
If one story building with masonry walls, thickness of walls? height?

IF A GARAGE

No. cars now accommodated on same lot, to be accommodated, number commercial cars to be accommodated
Will automobile repairing be done other than minor repairs to cars habitually stored in the proposed building?

APPROVALS BY: DATE MISCELLANEOUS
BUILDING INSPECTION-PLAN EXAMINER Will work require dist. of any tree on a public street? no
ZONING:
BUILDING CODE: Will there be in charge of the above work a person competent to see that the State and City requirements pertaining thereto are observed? yes
Fire Dept.:
Health Dept.:
Others:

Signature of Applicant Robert Howard for Cliff Isl. Library Phone # same
Type Name of above Robert Howard for Cliff Isl. Library [ ] [ ] [ ] [ ]
Other and Address

PERMIT ISSUED WITH LETTER

APPLICANT'S COPY OFFICE FILE COPY

Handwritten note: MR. ADDATO

NOTES

9-18-84. Complete at imp.  
OK. a7

*(This section is crossed out with a diagonal line)*

*(This section is crossed out with a diagonal line)*

*(This section is crossed out with a diagonal line)*

Permit No. 83/1018  
 Location 159 R.R. - 1 St. Cms  
 Owner *Clark and Wilham Construction*  
 Date of permit 9-29-83  
 Approved 10-6-83  
 Issuing *Stanic*  
 Garage \_\_\_\_\_  
 Alteration \_\_\_\_\_

*Clark and Wilham Construction*



**APPLICATION FOR PERMIT**  
**DEPARTMENT OF BUILDING INSPECTIONS SERVICES**  
**ELECTRICAL INSTALLATIONS**

Date March 20, 19 91  
 Receipt and Permit number 01954

To the CHIEF ELECTRICAL INSPECTOR, Portland, Maine:

The undersigned hereby applies for a permit to make electrical installations in accordance with the laws of Maine, the Portland Electrical Ordinance, the National Electrical Code and the following specifications:

LOCATION OF WORK: Island Ave. Cliff Island 109B-D-2

OWNER'S NAME: Robert Bowdoin ADDRESS: P.O. Box 34 Cliff 04019

OUTLETS: 3 Receptacles 0 Switches 0 Plugmold 0 ft. TOTAL \_\_\_\_\_ FEES

FIXTURES: (number of) Incandescent \_\_\_\_\_ Fluorescent \_\_\_\_\_ (not strip) TOTAL \_\_\_\_\_ ATTACH  
 Strip Fluorescent \_\_\_\_\_ ft. \_\_\_\_\_

SERVICES: Overhead  Underground \_\_\_\_\_ Temporary \_\_\_\_\_ TOTAL amperes 100 .. 15.00

METERS: (number of) 1 .. 1.00

MOTORS: (number of) Fractional \_\_\_\_\_  
 1 HP or over \_\_\_\_\_

RESIDENTIAL HEATING: Oil or Gas (number of units) \_\_\_\_\_  
 Electric (number of rooms) \_\_\_\_\_

COMMERCIAL OR INDUSTRIAL HEATING: Oil or Gas (by a main boiler) \_\_\_\_\_  
 Oil or Gas (by separate units) \_\_\_\_\_  
 Electric Under 20 kws \_\_\_\_\_ Over 20 kws \_\_\_\_\_

APPLIANCES: (number of) Ranges \_\_\_\_\_ Water Heaters \_\_\_\_\_  
 Cook Tops \_\_\_\_\_ Disposals \_\_\_\_\_  
 Wall Ovens \_\_\_\_\_ Dishwashers \_\_\_\_\_  
 Dryers \_\_\_\_\_ Compactors \_\_\_\_\_  
 Fans \_\_\_\_\_ Others (denote) \_\_\_\_\_

MISCELLANEOUS: (number of) TOTAL \_\_\_\_\_  
 Branch Panels \_\_\_\_\_  
 Transformers \_\_\_\_\_  
 Air Conditioners Central Unit \_\_\_\_\_  
 Separate Units (windows) \_\_\_\_\_  
 Signs 20 sq. ft. and under \_\_\_\_\_  
 Over 20 sq. ft. \_\_\_\_\_  
 Swimming Pools Above Ground \_\_\_\_\_  
 In Ground \_\_\_\_\_  
 Fire/Burglar Alarms Residential \_\_\_\_\_  
 Commercial \_\_\_\_\_  
 Heavy Duty Outlets, 220 Volt (such as welders) 30 amps and under \_\_\_\_\_  
 over 30 amps \_\_\_\_\_  
 Circus, Tubs, etc. \_\_\_\_\_  
 Alterations to wires \_\_\_\_\_  
 Repairs after fire \_\_\_\_\_  
 Emergency Lights, battery \_\_\_\_\_  
 Emergency Generators \_\_\_\_\_

FOR ADDITIONAL WORK NOT ON ORIGINAL PERMIT ... .. DOUBLE FEE DUE:  
 FOR REMOVAL OF A "STOP ORDER" (304-16.b) .....

TOTAL AMOUNT DUE: 16.00

INSPECTION: Will be ready on \_\_\_\_\_, 19\_\_; or Will Call   
 CONTRACTOR'S NAME: Seabee Elec.  
 ADDRESS: 200 Anderson St. Portland 04101  
 TEL.: 774-4880  
 MASTER LICENSE NO.: 3011 SIGNATURE OF CONTRACTOR: William Seabee  
 LIMITED LICENSE NO.: \_\_\_\_\_

INSPECTOR'S COPY — WHITE  
 OFFICE COPY — CANARY  
 CONTRACTOR'S COPY — GREEN

