

STATEMENT ACCOMPANYING APPLICATION FOR BUILDING PERMIT

for additions to cottage
at Sunset Rd Cliff Date 7/6/33

1. In whose name is the title of the property now recorded? Ms. O. P. Stone
2. Are the boundaries of the property in the vicinity of the proposed work shown clearly on the ground, and how? markers
3. Is the outline of the proposed work now staked out upon the ground? If not, will you notify the Inspection Office when the work is staked out and before any of the work is commenced?
4. What is to be maximum projection or overhang of eaves or drip? 6"
5. Do you assume full responsibility for the correctness of the location plan or statement of location filed with this application, and does it show the complete outline of the proposed work on the ground, including bay windows, porches and other projections? yes
6. Do you assume full responsibility for the correctness of all statements in the application concerning the sizes, design and use of the proposed building? yes
7. Do you understand that in case changes are proposed in the location of the work or in any of the details specified in the application that a revised plan and application must be submitted to this office before the changes are made? yes.

Bland Merrill.

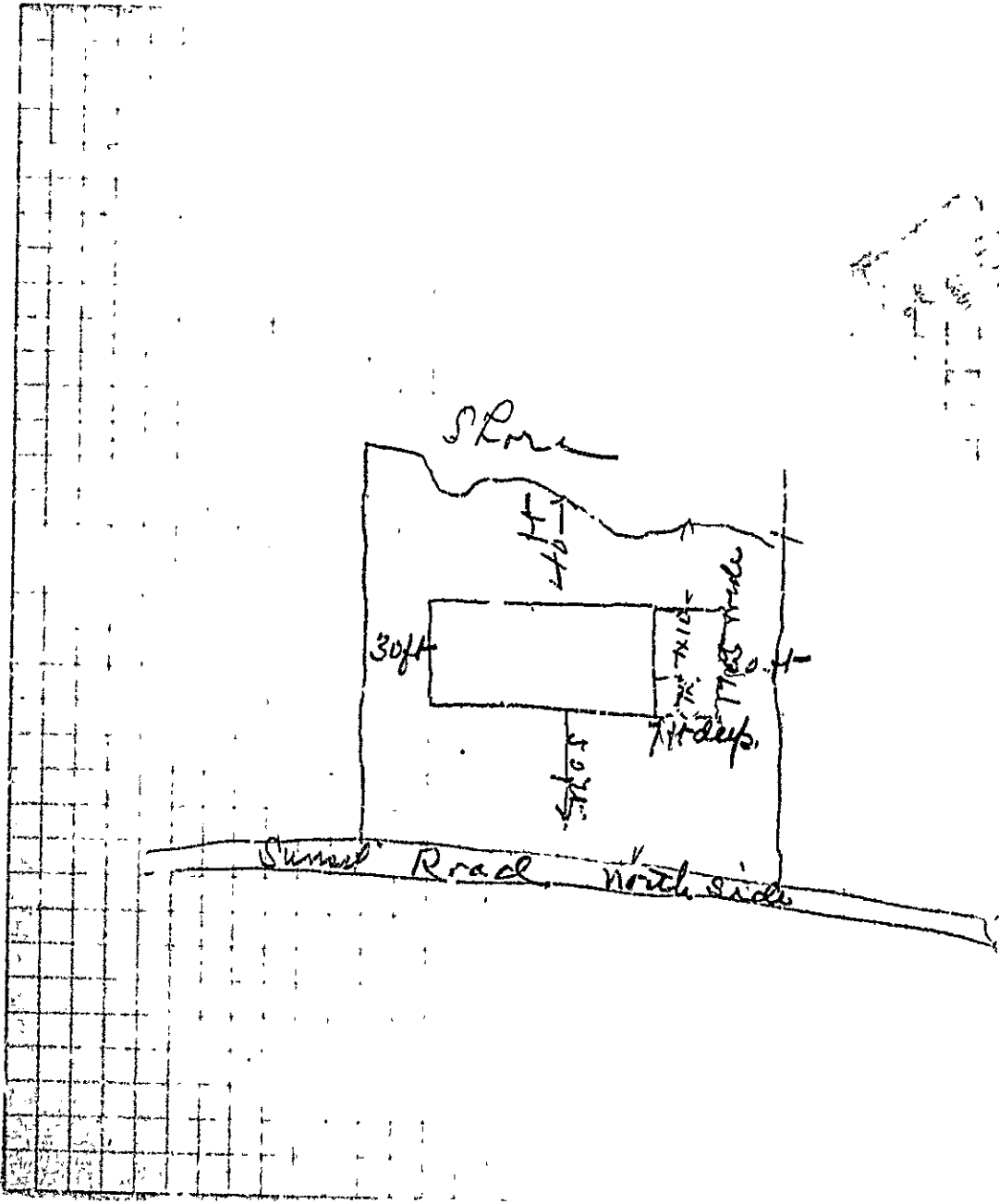

(A) APARTMENT HO: 158 7014



(A) APARTMENT HOUSE ZONE
APPLICATION FOR PERMIT **PERMIT ISSUED**

Class of Building or Type of Structure Third Class JUL 8 1925

Portland, Maine, July 8, 1925

To the INSPECTOR OF BUILDINGS, PORTLAND, ME.

The undersigned hereby applies for a permit to erect alter install the following building ~~in accordance with the Laws of the State of Maine, the Building Code of the City of Portland, plans and specifications, if any, submitted herewith and the following specifications:~~

Location Sunset Road, Cliff Island Ward Isl. 1 Within Fire Limits? no Dist. No. _____

Owner's or trustee's name and address Mrs. D. P. Stone, Cliff Island Telephone _____

Contractor's name and address Leland Merrill, Cliff Island Telephone _____

Architect's name and address _____

Proposed use of building Cottage No. families _____

Other buildings on same lot _____

Plans filed as part of this application? yes No. of sheets 1

Estimated cost \$ 75. Fee \$.50

Description of Present Building to be Altered

Material wood No. stories 1 1/2 Heat _____ Style of roof ditch Roofing wood

Last use Cottage No. families _____

General Description of New Work

To erect one story frame addition 7' x 17' window at least three square feet in area for ventilation of new bath room

CERTIFICATE OF OCCUPANCY
 REQUIREMENT IS WAIVED

It is understood that this permit does not include installation of heating apparatus which is to be taken out separately by and in the name of the heating contractor.

Details of New Work

Height average grade to top of plate _____

Size, front _____ depth _____ No. stories _____ Height average grade to highest point of roof 10'

To be erected on solid or filled land? solid earth or rock? earth

Material of foundation concr posts Thickness, top _____ bottom _____

Material of underpinning _____ Height _____ Thickness _____

Kind of Roof flat Rise per foot 3/4" Roof covering Asphalt roofing Class C Und. Lab.

No. of chimneys no Material of chimneys _____ of lining _____

Kind of heat _____ Type of fuel _____ Is gas fitting involved? _____

Corner posts 4x4 Sills 4x8 Girt or ledger board _____ Size _____

Material columns under girders _____ Size _____ Max. on centers _____

Studs (outside walls and carrying partitions) 2x4-16" O. C. Girders 6x8 or larger. Bridging in every floor and flat roof span over 8 feet. Sills and corner posts all one piece in cross section.

Joists and rafters: 1st floor 2x8 2nd _____ 3rd _____ roof 2x8

O. centers: 1st floor 18" 2nd _____ 3rd _____ roof 22"

Maximum span: 1st floor 7' 2nd _____ 3rd _____ roof 7'

If one story building with masonry walls, thickness of walls? _____ height? _____

If a Garage

No. cars now accommodated on same lot _____, to be accommodated _____

Total number commercial cars to be accommodated _____

Will automobile repairing be done other than minor repairs to cars habitually stored in the proposed building? _____

Miscellaneous

Will above work require removal or disturbing of any shade tree on a public street? no

Will there be in charge of the above work a person competent to see that the State and City requirements pertaining thereto are observed? yes

Signature of owner Mrs. D. P. Stone
Leland Merrill

INSPECTION COPY

125

Word 211 Permit No 33/867

Location ~~Swan Rd. Cliff's~~

Owner Mrs. D. P. Stone

Date of permit 7/6/33

Notif. closing-in Mine Gaves

Inspr. closing-in

Final Notif.

Final Inspn. 7/17/33

Cert. of Occupancy issued

NOTES
Work closed in for
one at home. Sheath
from sill to grade.

1094-B-10

