

CHURCH AVENUE

CHURCH AVENUE  
109B-A-6

CLIFF ISLAND

NO.	DESCRIPTION	DATE	BY	STATUS
1				
2				
3				
4				
5				
6				
7				
8				
9				
10				
11				
12				
13				
14				
15				
16				
17				
18				
19				
20				
21				
22				
23				
24				
25				
26				
27				
28				
29				
30				
31				
32				
33				
34				
35				
36				
37				
38				
39				
40				
41				
42				
43				
44				
45				
46				
47				
48				
49				
50				

LOCATION  
CLIFF  
DEPARTMENT



# APPLICATION FOR PERMIT PERMIT 0574 ISSUED

Class of Building or Type of Structure REPAIR WORK

To the INSPECTOR OF BUILDINGS, PORTLAND, ME. Portland, Maine, May 3, 1938 MAY 2 1938

The undersigned hereby applies for a permit to erect or alter install the following building structure equipment in accordance with the Laws of the State of Maine, the Building Code of the City of Portland, plans and specifications, if any, submitted herewith and the following specifications:

Location Church Road, Cliff Island Ward Isl. 1 Within Fire Limits? no Dist. No. \_\_\_\_\_

Owner's, or Lessee's name and address Alma E. Bickford, Cliff Island Telephone \_\_\_\_\_

Contractor's name and address Omar Telephone \_\_\_\_\_

Architect \_\_\_\_\_ Telephone \_\_\_\_\_

Proposed use of building \_\_\_\_\_ Plans filed no No. of sheets \_\_\_\_\_

Other buildings on same lot \_\_\_\_\_ No. families \_\_\_\_\_

Estimated cost \$ \_\_\_\_\_ Fee \$ \_\_\_\_\_

**Description of Present Building to be Altered**

Material wood No. stories 1 Heat \_\_\_\_\_ S'le of roof \_\_\_\_\_ Roofing \_\_\_\_\_

Last use Dwelling (Stephyn Griffin) No. families \_\_\_\_\_

**General Description of New Work**

To demolish building 20' x 30' no sewer connection

It is understood that this permit does not include installation of heating apparatus which is to be taken out separately by and in the name of the heating contractor.

### Details of New Work

Size, front \_\_\_\_\_ depth \_\_\_\_\_ No. stories \_\_\_\_\_ Height average grade to top of plate \_\_\_\_\_

To be erected on solid or filled land? \_\_\_\_\_ earth or rock? \_\_\_\_\_

Material of foundation \_\_\_\_\_ Thickness, top \_\_\_\_\_ bottom \_\_\_\_\_

Material of underpinning \_\_\_\_\_ Height \_\_\_\_\_ Thickness \_\_\_\_\_

Kind of Roof \_\_\_\_\_ Rise per foot \_\_\_\_\_ Roof covering \_\_\_\_\_

No. of chimneys \_\_\_\_\_ Material of chimneys \_\_\_\_\_ of lining \_\_\_\_\_

Kind of heat \_\_\_\_\_ Type of fuel \_\_\_\_\_ Is gas fitting involved? \_\_\_\_\_

Corner posts \_\_\_\_\_ Sills \_\_\_\_\_ Girt or ledger board? \_\_\_\_\_ Size \_\_\_\_\_

Material columns under girders \_\_\_\_\_ Size \_\_\_\_\_ Max. on centers \_\_\_\_\_

Studs (outside walls and carrying partitions) 2x4-16' O. C. Girders 6x8 or larger. Bridging in every floor and flat roof span over 8 feet. Sills and corner posts all one piece in cross section.

Joists and rafters: \_\_\_\_\_

On centers: \_\_\_\_\_

Maximum span: \_\_\_\_\_

If one story building with masonry walls, thickness of walls? \_\_\_\_\_ height? \_\_\_\_\_

### If a Garage

No. cars now accommodated on same lot \_\_\_\_\_, to be accommodated \_\_\_\_\_

Total number commercial cars to be accommodated \_\_\_\_\_

Will automobile repairing be done other than minor repairs to cars habitually stored in the proposed building? \_\_\_\_\_

### Miscellaneous

Will above work require removal or disturbing of any shade tree on a public street? no

Will there be in charge of the above work a person competent to see that the State and City requirements pertaining thereto are observed? yes

Signature of owner Alma E. Bickford

By Wendell P. Bickford

INSPECTION COPY

Word 1 Permit No. 387574

Location: Church Rd., Cliff

Owner: Oliver E. B. B. B.

Date of permit: 5/2/38

Notif. closing-in

Inspn. closing-in

Final Notif.

Final Inspn. 7/6/38

Cert. of Occupancy issued: None

NOTES

Open

1098-A-6

for  
Stephen

(B) LIMITED BUSINESS ZONE

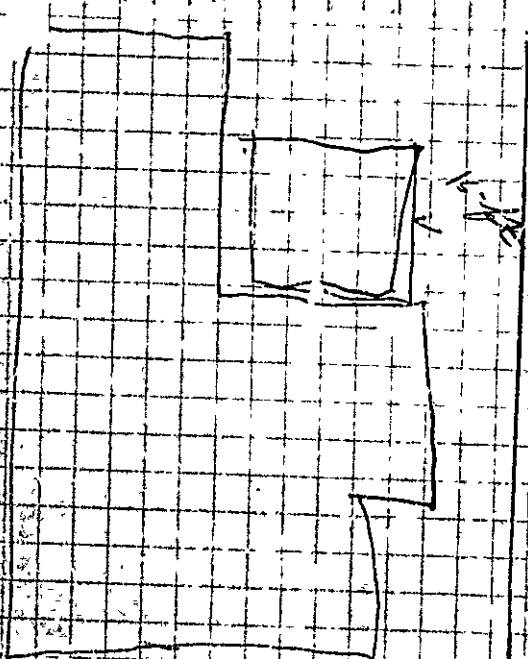



(5) LIMITED BUSINESS ZONE

Permit No. ISSUED  
MAY 1 1926

# APPLICATION FOR PERMIT

Class of Building or Type of Structure Third Class

Portland, Maine, May 1, 1926

To the INSPECTOR OF BUILDINGS, PORTLAND, ME.

The undersigned hereby applies for a permit to erect ~~after install~~ the following building structure ~~equipment~~ in accordance with the Laws of the State of Maine, the Building Code of the City of Portland, plans and specifications, if any, submitted herewith and the following specifications:

Location near Landing, Cliff Island Ward 1 Within Fire Limits? NO Dist. No. \_\_\_\_\_

Owner's or Lessee's name and address Stephen H. Griffin, Cliff Island Telephone \_\_\_\_\_

Contractor's name and address OWNER Telephone \_\_\_\_\_

Architect's name and address \_\_\_\_\_

Proposed use of building wood shed No. families \_\_\_\_\_

Other buildings on same lot dwelling 1 family with store

### Description of Present Building to be Altered

Material \_\_\_\_\_ No. stories \_\_\_\_\_ Heat \_\_\_\_\_ Style of roof \_\_\_\_\_ Roofing \_\_\_\_\_

Last use \_\_\_\_\_ No. families \_\_\_\_\_

### General Description of New Work

To erect frame wood shed, 8x10

NOTIFICATION BEFORE LATHING  
OR CLOSING IN IS WAIVED  
CERTIFICATE OF OCCUPANCY  
REQUIREMENT IS WAIVED

### Details of New Work

Size, front \_\_\_\_\_ depth \_\_\_\_\_ No. stories 1 Height average grade to highest point of roof 10'

To be erected on solid or filled land? solid earth or rock? earth and rock

Material of foundation Rock Thickness, top \_\_\_\_\_ bottom \_\_\_\_\_

Material of underpinning \_\_\_\_\_ Height \_\_\_\_\_ Thickness \_\_\_\_\_

Kind of roof Flat (shed) Roof covering Asphalt roofing Class 0 U.S. Lab.

No. of chimneys NO Material of chimneys \_\_\_\_\_ of lining \_\_\_\_\_

Kind of heat NO Type of fuel \_\_\_\_\_ Distance, heater to chimney \_\_\_\_\_

If oil burner, name and model \_\_\_\_\_

Capacity and location of oil tanks \_\_\_\_\_

Is gas fitting involved? NO Size of service \_\_\_\_\_

Corner posts 3x5 Sills 2x4 Girt or ledger board? \_\_\_\_\_ Size \_\_\_\_\_

Material columns under girders \_\_\_\_\_ Size \_\_\_\_\_ Max. on centers \_\_\_\_\_

Studs (outside walls and carrying partitions) 2x4-16" O. C. Girders 6x8 or larger. Bridging in every floor and flat roof span over 8 feet. Sills and corner posts all one piece in cross section.

Joists and rafters: 1st floor 3x5, 2nd \_\_\_\_\_, 3rd \_\_\_\_\_, roof 2x5

On centers: 1st floor 3', 2nd \_\_\_\_\_, 3rd \_\_\_\_\_, roof 2'

Maximum span: 1st floor \_\_\_\_\_, 2nd \_\_\_\_\_, 3rd \_\_\_\_\_, roof \_\_\_\_\_

If one story building with masonry walls, thickness of walls? \_\_\_\_\_ height? \_\_\_\_\_

### If a Garage

No. cars now accommodated on same lot \_\_\_\_\_, to be accommodated \_\_\_\_\_

Total number commercial cars to be accommodated \_\_\_\_\_

Will automobile repairing be done other than minor repairs to cars habitually stored in the proposed building? \_\_\_\_\_

### Miscellaneous

Will above work require removal or disturbing of any shade tree on a public street? NO

Plans filed as part of this application? YES No. sheets 1

Estimated cost \$ 75. Fee \$ 50.

Will there be in charge of the above work a person competent to see that the State and City requirements pertaining thereto are observed? Yes

Signature of owner Stephen H. Griffin

INSPECTION COPY

6203

Ward 1 Permit No. 28716  
 Loc. Church St  
 Owner St. Philip's R. C. Church  
 Date of permit 5/1/28  
 Notice closing-in DE  
 Inspn. closing-in DE  
 Final Notif. DE  
 Final Inspn. DE  
 Cert. of Occupancy issued DE

NOTES  
 1090-A-6  
 [Handwritten signatures and notes]

Order for this on 5/1/28  
 Description of License Building to be altered

General Description of New Work

As shown on page 1000

Details of New Work

To be located by a copy of this plan  
 [Faint grid lines and illegible text]