

000897  
 Permit # City of Portland BUILDING PERMIT APPLICATION Fee \$35. Zone \_\_\_\_\_ Map # \_\_\_\_\_ Lot# \_\_\_\_\_  
 Please fill out any part which applies to job. Proper plans must accompany form.

Owner: D. J. N. Hill in \_\_\_\_\_ Floor # 875-5415  
 Address: 17 Pleasant St. Portland, ME 04096  
 LOCATION OF CONSTRUCTION: 17 Pleasant St. Portland, ME 04096  
 Contractor: Owner Sub: AAA Phone # \_\_\_\_\_  
 Address: \_\_\_\_\_  
 Est. Construction Cost: \$2500 Proposed Use: 1-fam w shed  
 Past Use: 1-fam  
 # of Existing Res. Units: \_\_\_\_\_ # of New Res. Units: \_\_\_\_\_  
 Building Dimensions: L \_\_\_\_\_ W \_\_\_\_\_ Total Sq. Ft. \_\_\_\_\_  
 # Stories: \_\_\_\_\_ # Bedrooms: \_\_\_\_\_ Lot Size: \_\_\_\_\_  
 Is Proposed Use: Seasonal \_\_\_\_\_ Condominium \_\_\_\_\_ Conversion \_\_\_\_\_  
 Explain Conversion: Construct storage shed; 12'x16'

Foundations:  
 1. Type of Soil: \_\_\_\_\_  
 2. Set Backs: Front \_\_\_\_\_ Rear \_\_\_\_\_ Sid(e) \_\_\_\_\_  
 3. Footings Size: \_\_\_\_\_  
 4. Foundation Size: \_\_\_\_\_  
 5. Other: \_\_\_\_\_

Floors:  
 1. Sill Size: \_\_\_\_\_ Sills must be anchored.  
 2. Girder Size: \_\_\_\_\_ Size \_\_\_\_\_ Spacing 15" O.C.  
 3. Lally Column Spacing: \_\_\_\_\_  
 4. Joist Size: \_\_\_\_\_ Size \_\_\_\_\_  
 5. Bridging Type: \_\_\_\_\_ Size \_\_\_\_\_  
 6. Floor Sheathing Type: \_\_\_\_\_  
 7. Other Material: \_\_\_\_\_

Exterior Walls:  
 1. Studding Size: 7 Spacing \_\_\_\_\_  
 2. No. windows: \_\_\_\_\_  
 3. No. Doors: \_\_\_\_\_ Span(s) \_\_\_\_\_  
 4. Header Size: \_\_\_\_\_ No. \_\_\_\_\_  
 5. Bracing: \_\_\_\_\_ Yes \_\_\_\_\_ No \_\_\_\_\_  
 6. Corner Posts Size: \_\_\_\_\_  
 7. Insulation Type: \_\_\_\_\_ Size \_\_\_\_\_  
 8. Sheathing Type: \_\_\_\_\_  
 9. Siding Type: \_\_\_\_\_  
 10. Masonry Materials: \_\_\_\_\_  
 11. Metal Materials: \_\_\_\_\_

Interior Walls:  
 1. Studding Size: \_\_\_\_\_ Spacing \_\_\_\_\_  
 2. Header Sizes: \_\_\_\_\_ Span(s) \_\_\_\_\_  
 3. Wall Covering Type: \_\_\_\_\_  
 4. Fire Wall if required: \_\_\_\_\_  
 5. Other Materials: \_\_\_\_\_

For Official Use ONLY PERMIT ISSUED  
 Date: 7/13/90 Subdivision: \_\_\_\_\_  
 Inside Fire Limits: \_\_\_\_\_ Name: JUL 25 1990  
 Bldg Code: \_\_\_\_\_ Lot: \_\_\_\_\_  
 Time Limit: \_\_\_\_\_ Ownership: City of Portland  
 Enter Fee Code: 2250

Zoning: Street Frontage Provided: \_\_\_\_\_ Back \_\_\_\_\_ Side \_\_\_\_\_  
 Provided Setbacks: Front \_\_\_\_\_  
 Review Required: Zoning Board Approval: Yes \_\_\_\_\_ No \_\_\_\_\_ Date: \_\_\_\_\_  
 Planning Board Approval: Yes \_\_\_\_\_ No \_\_\_\_\_ Site Plan \_\_\_\_\_ Subd. vision \_\_\_\_\_  
 Conditional Use: \_\_\_\_\_ Variance \_\_\_\_\_  
 Shoreland Zoning: Yes \_\_\_\_\_ No \_\_\_\_\_ Floodplain: Yes \_\_\_\_\_ No \_\_\_\_\_  
 Special Exception: \_\_\_\_\_  
 Other (Explain): OK WDA 7-19-90

Ceiling:  
 1. Ceiling Joists Size: \_\_\_\_\_ Spacing \_\_\_\_\_  
 2. Ceiling Strapping Size: \_\_\_\_\_  
 3. Type Ceiling: \_\_\_\_\_ Size \_\_\_\_\_  
 4. Insulation Type: \_\_\_\_\_  
 5. Ceiling Height: \_\_\_\_\_

Roof:  
 1. Truss or Rafters Size: \_\_\_\_\_ Spacing \_\_\_\_\_  
 2. Sheathing Type: \_\_\_\_\_  
 3. Roof Covering Type: \_\_\_\_\_  
 Chimneys: Type: \_\_\_\_\_ Number of Fire Places: \_\_\_\_\_

Heating: Type of Heat: \_\_\_\_\_  
 Electrical: Service Entrance Size: \_\_\_\_\_ Smoke Detector Required: Yes \_\_\_\_\_ No \_\_\_\_\_

Plumbing: Service Entrance Size: \_\_\_\_\_  
 1. Approval of test if required: \_\_\_\_\_  
 2. No. of Tubs or Showers: \_\_\_\_\_  
 3. No. of Flushes: \_\_\_\_\_  
 4. No. of Lavatories: \_\_\_\_\_  
 5. No. of Other Fixtures: \_\_\_\_\_

Swimming Pools:  
 1. Type: \_\_\_\_\_ Square Footage \_\_\_\_\_  
 2. Pool Size: \_\_\_\_\_  
 3. Must conform to National Electrical Code and State Law.

Permit Received By: Louise F. Inase  
 Signature of Applicant: Ellen Manson Date: 7/13/90  
 Signature of CEO: \_\_\_\_\_ Date: \_\_\_\_\_

Inspection Dates: \_\_\_\_\_  
 White Tax Assessor \_\_\_\_\_ Yellow-GPCOG \_\_\_\_\_ White Tag-CEO \_\_\_\_\_  
 MA. ADDATO

PLOT PLAN

N



**FEES (Breakdown From Front)**  
Base Fee \$ 35  
Subdivision Fee \$ \_\_\_\_\_  
Site Plan Review Fee \$ \_\_\_\_\_  
Other Fees \$ \_\_\_\_\_  
(Explain) \_\_\_\_\_  
Late Fee \$ \_\_\_\_\_

Type	Inspection Record	Date
_____	_____	____/____/____
_____	_____	____/____/____
_____	_____	____/____/____
_____	_____	____/____/____
_____	_____	____/____/____

COMMENTS

6/28/94

O.K.  
after

Signature of Applicant Colleen Ouse

Date 1/13/90

RECEIVED

Ocean

JUL 13 1990

DEPT. OF BUILDING INS. ...  
CITY OF PORTLAND

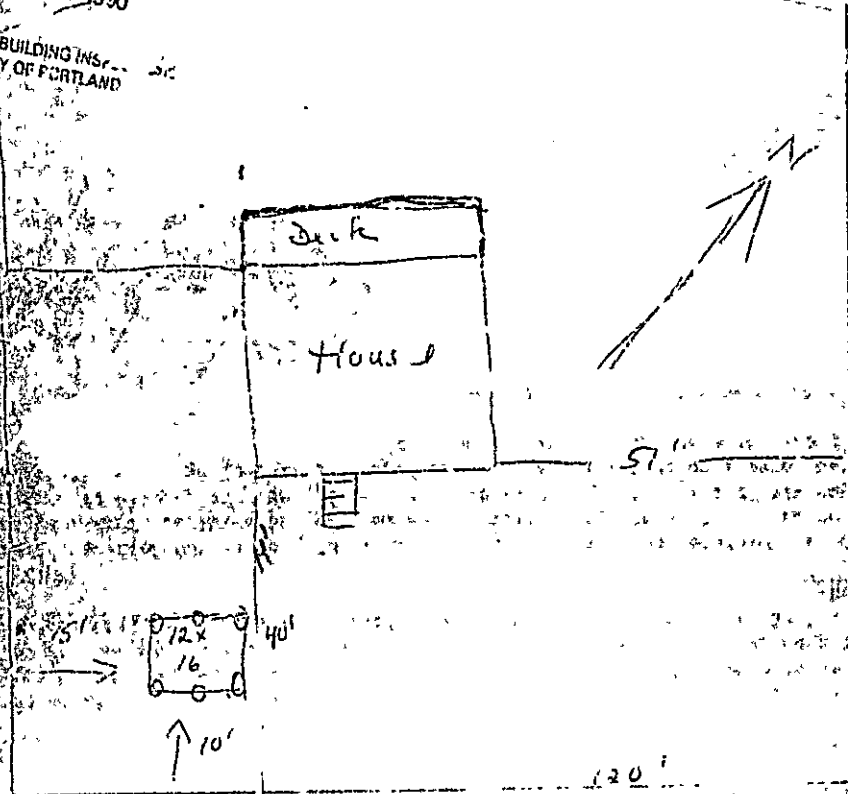

2x4's  
16" OC  
6" - 8" solar tubes  
Board & Batten  
Asphalt shingles

Jo. Owen