



APPLICATION FOR PERMIT
 DEPARTMENT OF BUILDING INSPECTIONS SERVICES
 ELECTRICAL INSTALLATIONS

Date May 25, 19 77
 Receipt and Permit number A09993

To the CHIEF ELECTRICAL INSPECTOR, Portland, Maine:

The undersigned hereby applies for a permit to make electrical installations in accordance with the laws of Maine, the Portland Electrical Ordinance, the National Electrical Code and the following specifications:

LOCATION OF WORK: Lot # 109-B-B-1 Rear Island Ave. Cliff Island, Me.
 OWNER'S NAME: William Lunederg ADDRESS: same

OUTLETS: (number of)	<u>1-30</u>		
Lights	_____		
Receptacles	_____		
Switches	_____		
Plugmold	_____ (number of feet)		
TOTAL	_____		<u>3.00</u>
FIXTURES: (number of)			
Incandescent	_____		
Fluorescent	_____ (Do not include strip fluorescent)		
TOTAL	_____		
Strip Fluorescent, in feet	_____		
SERVICES:			
Permanent, total amperes	<u>200</u>		<u>3.00</u>
Temporary	_____		
MEIERS: (number of)	<u>1</u>		<u>.50</u>
MOTORS: (number of)			
Fractional	_____		
1 HP or over	_____		
RESIDENTIAL HEATING:			
Oil or Gas (number of units)	_____		
Electric (number of rooms)	<u>9</u>		<u>9.00</u>
COMMERCIAL OR INDUSTRIAL HEATING:			
Oil or Gas (by a main boiler)	_____		
Oil or Gas (by separate units)	_____		
Electric (total number of kws)	_____		
APPLIANCES: (number of)			
Ranges	_____	Water Heaters	_____
Cook Tops	_____	Disposals	_____
Wall Ovens	_____	Dishwashers	_____
Dryers	<u>x</u>	Compactors	_____
Fans	_____	Others (denote)	_____
TOTAL	_____		<u>1.50</u>
MISCELLANEOUS: (number of)			
Branch Panels	_____		
Transformers	_____		
Air Conditioners	_____		
Signs	_____		
Fire/Burglar Alarms	_____		
Circus, Fairs, etc.	_____		
Alterations to wires	_____		
Repairs after fire	_____		
Heavy Duty, 220v outlets	_____		
Emergency Lights, battery	_____		
Emergency Generators	_____		

INSTALLATION FEE DUE: _____
 FOR ADDITIONAL WORK NOT ON ORIGINAL PERMIT DOUBLE FEE DUE: _____
 FOR REMOVAL OF A "STOP ORDER" (304-16.b) _____
 FOR PERFORMING WORK WITHOUT A PERMIT (304-9) _____
 TOTAL AMOUNT DUE: 17.00

INSPECTION:
 Will be ready on _____, 19____; or Will Call x

CONTRACTOR'S NAME: P. A. Gomez
 ADDRESS: Chataque Island, Me.
 TEL.: 846-4110

MASTER LICENSE NO.: 4676 limited license
 LIMITED LICENSE NO.: _____

SIGNATURE OF CONTRACTOR:

OFFICE COPY



APPLICATION FOR PERMIT
 DEPARTMENT OF BUILDING INSPECTIONS SERVICES
 ELECTRICAL INSTALLATIONS

Date Sept. 26 19 77
 Receipt and Permit number A03239

To the CHIEF ELECTRICAL INSPECTOR, Portland, Maine:

The undersigned hereby applies for a permit to make electrical installations in accordance with the laws of Maine, the Portland Electrical Code, the National Electrical Code and the following specifications:

LOCATION OF WORK: Lot # 109-B-4 Isl Ave, Cliff Island
 OWNER'S NAME: Margaret Newcomb ADDRESS: same

OUTLETS: (number of)

Lights	_____	
Receptacles	_____	FEES
Switches	_____	
Plugmold	_____ (number of feet)	
TOTAL	_____	_____

FIXTURES: (number of)

Incandescent	_____	
Fluorescent	_____ (Do not include strip fluorescent)	
TOTAL	_____	_____
Strip Fluorescent, in feet	_____	_____

SERVICES:

Permanent, total amperes	<u>100</u>	_____	<u>3.00</u>
Temporary	_____	_____	_____

METERS. (number of) 1 _____ .50

MOTORS: (number of)

Fractional	_____	_____
1 HP or over	_____	_____

RESIDENTIAL HEATING:

Oil or Gas (number of units)	_____	_____
Electric (number of rooms)	_____	_____

COMMERCIAL OR INDUSTRIAL HEATING:

Oil or Gas (by a main boiler)	_____	_____
Oil or Gas (by separate units)	_____	_____
Electric (total number of kws)	_____	_____

APPLIANCES: (number of)

Ranges	_____	Water Heaters	_____
Cook Tops	_____	Disposals	_____
Wall Ovens	_____	Dishwashers	_____
Dryers	_____	Compactors	_____
Fans	_____	Others (denote)	_____
TOTAL	_____		_____

MISCELLANEOUS: (number of)

Branch Panels	_____	_____
Transformers	_____	_____
Air Conditioners	_____	_____
Signs	_____	_____
Fire/Burglar Alarms	_____	_____
Circus, Fairs, etc.	_____	_____
Alterations to wires	_____	_____
Repairs after fire	_____	_____
Heavy Duty, 220v outlets	_____	_____
Emergency Lights, battery	_____	_____
Emergency Generators	_____	_____

INSTALLATION FEE DUE: _____
 FOR ADDITIONAL WORK NOT ON ORIGINAL PERMIT DOUBLE FEE DUE: _____
 FOR REMOVAL OF A "STOP ORDER" (304-16.b) _____
 FOR PERFORMING WORK WITHOUT A PERMIT (304-9) _____
 TOTAL AMOUNT DUE: 3.50

INSPECTION:
 Will be ready on 9-26-, 19 77 or Will Call _____

CONTRACTOR'S NAME: P. A. Gorez
 ADDRESS: Chebeague Island
 TEL.: 846-4110

MASTER LICENSE NO.: 4676
 LIMITED LICENSE NO.: _____

SIGNATURE OF CONTRACTOR:

OFFICE COPY



APPLICATION FOR PERMIT
 DEPARTMENT OF BUILDING INSPECTIONS SERVICES
 ELECTRICAL INSTALLATIONS

Date Aug. 19, 19 77
 Receipt and Permit number A03112

To the CHIEF ELECTRICAL INSPECTOR, Portland, Maine:

The undersigned hereby applies for a permit to make electrical installations in accordance with the laws of Maine, the Portland Electrical Ordinance, the National Electrical Code and the following specifications:

LOCATION OF WORK: 109-C-A-1 Island Ave., Cliff Island
 OWNER'S NAME: Butter Clifford ADDRESS: same

OUTLETS: (number of)

Lights	_____	
Receptacles	_____	FEES
Switches	_____	
Plugmold	_____ (number of feet)	
TOTAL	_____	_____

FIXTURES: (number of)

Incandescent	_____	
Fluorescent	_____ (Do not include strip fluorescent)	
TOTAL	_____	_____
Strip Fluorescent, in feet	_____	_____

SERVICES:

Permanent, total amperes <u>200</u>	_____	<u>3.00</u>
Temporary	_____	_____

METERS: (number of)

<u>1</u>	_____	<u>.50</u>
----------	-------	------------

MOTORS: (number of)

Fractional	_____	_____
1 HP or over	_____	_____

RESIDENTIAL HEATING:

Oil or Gas (number of units)	_____	_____
Electric (number of rooms)	_____	_____

COMMERCIAL OR INDUSTRIAL HEATING:

Oil or Gas (by a main boiler)	_____	_____
Oil or Gas (by separate units)	_____	_____
Electric (total number of kws)	_____	_____

APPLIANCES: (number of)

Ranges	_____	Water Heaters	_____
Cook Tops	_____	Disposals	_____
Wall Ovens	_____	Dish washers	_____
Dryers	_____	Compactors	_____
Fans	_____	Others (denote)	_____
TOTAL	_____	_____	_____

MISCELLANEOUS: (number of)

Branch Panels	_____	_____
Transformers	_____	_____
Air Conditioners	_____	_____
Signs	_____	_____
Fire/Burglar Alarms	_____	_____
Circus, Fairs, etc.	_____	_____
Alterations to wires	_____	_____
Repairs after fire	_____	_____
Heavy Duty, 220v outlets	_____	_____
Emergency Lights, battery	_____	_____
Emergency Generators	_____	_____

INSTALLATION FEE DUE:

FOR ADDITIONAL WORK NOT ON ORIGINAL PERMIT	_____	DOUBLE FEE DUE:	_____
FOR REMOVAL OF A "STOP ORDER" (304-16.b)	_____		_____
FOR PERFORMING WORK WITHOUT A PERMIT (304-9)	_____		_____
TOTAL AMOUNT DUE:	_____		<u>3.50</u>

INSPECTION:

Will be ready on _____, 19____; or Will Call XX

CONTRACTOR'S NAME: Roy Ferguson
 ADDRESS: Long Island, Me.
 TEL.: 766-2883

MASTER LICENSE NO.: 2641
 LIMITED LICENSE NO.: _____

SIGNATURE OF CONTRACTOR:
Roy A. Ferguson



APPLICATION FOR PERMIT
 DEPARTMENT OF BUILDING INSPECTIONS SERVICES
 ELECTRICAL INSTALLATIONS

Date July 22, 1977
 Receipt and Permit number: A 1G215

To the CHIEF ELECTRICAL INSPECTOR, Portland, Maine:
 The undersigned hereby applies for a permit to make electrical installations in accordance with the laws of Maine, the Portland Electrical Ordinance, the National Electrical Code and the following specifications:

LOCATION OF WORK: Lot # 109-B-E-29 Isl. Ave. Cliff Isl.
 OWNER'S NAME: Cliff Community Center ADDRESS: same

OUTLETS: (number of) 1-30
 Lights _____
 Receptacles _____
 Switches _____
 Plugmold _____ (number of feet) _____ FEES
 TOTAL _____

FIXTURES: (number of)
 Incandescent _____
 Fluorescent _____ (Do not include strip fluorescent)
 TOTAL _____
 Strip Fluorescent, in feet _____

SERVICES:
 Permanent, total amperes 200 _____
 Temporary _____ FEES
 TOTAL _____

METERS: (number of) 1 _____ FEES
 TOTAL _____

MOTORS: (number of)
 Fractional _____
 1 HP or over _____

RESIDENTIAL HEATING:
 Oil or Gas (number of units) _____
 Electric (number of rooms) _____

COMMERCIAL OR INDUSTRIAL HEATING:
 Oil or Gas (by a main boiler) _____
 Oil or Gas (by separate units) _____
 Electric (total number of kws) 4 _____ FEES
 TOTAL _____

APPLIANCES: (number of)
 Ranges _____
 Cook Tops _____
 Wall Ovens _____
 Dryers _____
 Fans _____
 Water Heaters _____
 Disposals _____
 Dishwashers _____
 Compactors _____
 Other. (denote) _____
 TOTAL _____

MISCELLANEOUS: (number of)
 Branch Panels 2 _____
 Transformers _____
 Air Conditioners _____ FEES
 Signs _____
 Fire/Burglar Alarms _____
 Circus, Fairs, etc. _____
 Alterations to wires _____
 Repairs after fire _____
 Heavy Duty, 220v outlets _____
 Emergency Lights, battery _____
 Emergency Generators _____

FOR ADDITIONAL WORK NOT ON ORIGINAL PERMIT INSTALLATION FEE DUE: _____
 FOR REMOVAL OF A "STOP ORDER" (304-16.b) DOUBLE FEE DUE: _____
 FOR PERFORMING WORK WITHOUT A PERMIT (304-9)
 TOTAL AMOUNT DUE: 8.90

INSPECTION:
 Will be ready on _____, 19__; or Will Call xx

CONTRACTOR'S NAME: P. A. Gomez
 ADDRESS: Chebeague Isl.
 TEL.: 846-4110
 MASTER LICENSE NO.: 46 limited

SIGNATURE OF CONTRACTOR

LIMITED LICENSE NO.: _____
 INSPECTOR'S COPY

ELECTRICAL INSTALLATIONS

Permit Number 10215

Location 109-13-E-29 Terminal Bldg

Owner CIEL Community Center

Date of Permit 7-22-77

Final Inspection 8-19-77

By Inspector R. Blodgett

Permit Application Register Page No. 102

INSPECTIONS: Service _____ by _____

Service called in _____

Closing-in _____ by _____

PROGRESS INSPECTIONS: 8-19-77 _____ / _____ / _____ / _____ / _____ / _____ / _____ / _____ / _____ / _____ /

CODE
COMPLIANCE
COMPLETED
DATE 8-19-77

DATE:	REMARKS:

CIEL IS.



APPLICATION FOR PERMIT
DEPARTMENT OF BUILDING INSPECTIONS SERVICES
ELECTRICAL INSTALLATIONS

Date July 22, 1977
 Receipt and Permit number A10209

I, the CHIEF ELECTRICAL INSPECTOR, Portland, Maine:
 The undersigned hereby applies for a permit to make electrical installations in accordance with the laws of Maine, the Portland Electrical Ordinance, the National Electrical Code and the following specifications:

LOCATION OF WORK: Lot # 109-B-F -10 Isl Ave. Cliff Island
 OWNER'S NAME: George Smith ADDRESS: same

OUTLETS: (number of) 1-30

Lights	_____	
Receptacles	_____	
Switches	_____	
Plugmold	_____ (number of feet)	
TOTAL	_____	3.00

FIXTURES: (number of)

Incandescent	_____	
Fluorescent	_____ (Do not include strip fluorescent)	
TOTAL	_____	
Strip Fluorescent, in feet	_____	

SERVICES:

Permanent, total amperes	<u>200</u>	<u>3.00</u>
Temporary	_____	_____

METERS: (number of) 150

MOTORS: (number of)

Fractional	_____	
1 HP or over	_____	

RESIDENTIAL HEATING:

Oil or Gas (number of units)	_____	
Electric (number of rooms)	_____	

COMMERCIAL OR INDUSTRIAL HEATING:

Oil or Gas (by a main boiler)	_____	
Oil or Gas (by separate units)	_____	
Electric (total number of kw's)	_____	

APPLIANCES: (number of)

Ranges	_____	Water Heaters	_____
Cook Tops	_____	Disposals	_____
Wall Ovens	_____	Dishwashers	_____
Dryers	_____	Compactors	_____
Fans	_____	Others (denote)	_____
TOTAL	_____		_____

MISCELLANEOUS: (number of)

Branch Panels	_____	
Transformers	_____	
Air Conditioners	_____	
Signs	_____	
Fire/Burglar Alarms	_____	
Circus, Fairs, etc.	_____	
Alterations to wires	_____	
Repairs after fire	_____	
Heavy Duty, 220v outlets	_____	
Emergency Lights, battery	_____	
Emergency Generators	_____	

	INSTALLATION FEE DUE:	_____
FOR ADDITIONAL WORK NOT ON ORIGINAL PERMIT	DOUBLE FEE DUE:	_____
FOR REMOVAL OF A "STOP ORDER" (304-16.b)		_____
FOR PERFORMING WORK WITHOUT A PERMIT (304-9)		_____
	TOTAL AMOUNT DUE:	6.50

INSPECTION:
 Will be ready on _____, 19____; or Will Call _____

CONTRACTOR'S NAME: P. A. Gomez
 ADDRESS: Chebeague Island
 TEL: 846-4110

MASTER LICENSE NO.: 46 limited SIG. OF CONTRACTOR: _____
 LIMITED LICENSE NO.: _____

INSPECTOR'S COPY

ELECTRICAL INSTALLATIONS -

Permit Number 12209

Location 1298 E 110 Street Ave

Owner George Smith

Date of Permit 7-22-77

Final Inspection 8-19-77

By Inspector D. M. [Signature]

Permit Application Register Page No 107

INSPECTIONS: Service _____ by _____
Service called in _____
Closing-in _____ by _____

PROGRESS INSPECTIONS: 8-19-77 / _____
_____/_____
_____/_____
_____/_____
_____/_____

CODE
COMPLIANCE
COMPLETED
DATE 8-19-77

DATE:	REMARKS:

CLIFF IS.



APPLICATION FOR PERMIT
 DEPARTMENT OF BUILDING INSPECTIONS SERVICES
 ELECTRICAL INSTALLATIONS

Date July 22, 1977
 Receipt and Permit number A10208

To the CHIEF ELECTRICAL INSPECTOR, Portland, Maine:

The undersigned hereby applies for a permit to make electrical installations in accordance with the laws of Maine, the Portland Electrical Ordinance, the National Electrical Code and the following specifications:

LOCATION OF WORK: Lot # 108B = F-3 Isl Ave, Cliff Island
 OWNER'S NAME: Kidder/Davidson ADDRESS: same

OUTLETS: (number of) 1-30

Lights	_____	
Receptacles	_____	FEES
Switches	_____	
Plugmold	_____ (number of feet)	
TOTAL	_____	3.00

FIXTURES: (number of)

Incandescent	_____	
Fluorescent	_____ (Do not include strip fluorescent)	
TOTAL	_____	
Strip Fluorescent, in feet	_____	

SERVICES:

Permanent, total amperes	<u>100</u>	<u>3.00</u>
Temporary	_____	_____

METERS: (number of) 150

MOTORS: (number of)

Fractional	_____	
1 HP or over	_____	

RESIDENTIAL HEATING:

Oil or Gas (number of units)	_____	
Electric (number of rooms)	_____	

COMMERCIAL OR INDUSTRIAL HEATING:

Oil or Gas (by a main boiler)	_____	
Oil or Gas (by separate units)	_____	
Electric (total number of kws)	_____	

APPLIANCES: (number of)

Ranges	_____	Water Heaters	_____
Cook Tops	_____	Disposals	_____
Wall Ovens	_____	Dishwashers	_____
Dryers	_____	Compactors	_____
Fan	_____	Others (denote)	_____
TOTAL	_____		

MISCELLANEOUS: (number of)

Branch Panels	_____	
Transformers	_____	
Air Conditioners	_____	
Signs	_____	
Fire/Burglar Alarms	_____	
Circuits, Fuses, etc.	_____	
Alterations to wires	_____	
Repairs after fire	_____	
Heavy Duty, 220v outlets	_____	
Emergency Lights, battery	_____	
Emergency Generators	_____	

	INSTALLATION FEE DUE:	_____
FOR ADDITIONAL WORK NOT ON ORIGINAL PERMIT	DOUBLE FEE DUE	_____
FOR REMOVAL OF A "STOP ORDER" (304-16.b)		_____
FOR PERFORMING WORK WITHOUT A PERMIT (304-9)		_____
	TOTAL AMOUNT DUE:	6.50

INSPECTION: Will be ready on _____, 19____; or Will Call XX

CONTRACTOR'S NAME: P. A. Gomez
 ADDRESS: Chebeague Island
 TEL.: 846-4110

MASTER LICENSE NO.: 46-111111
 LIMITED LICENSE NO.: _____

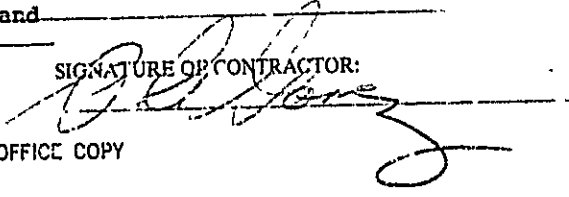
SIGNATURE OF CONTRACTOR:

 OFFICE COPY



APPLICATION FOR PERMIT
 DEPARTMENT OF BUILDING INSPECTIONS SERVICES
 ELECTRICAL INSTALLATIONS

Date July 22, 1977
 Receipt and Permit number A10211

To the CHIEF ELECTRICAL INSPECTOR, Portland, Maine:
 The undersigned hereby applies for a permit to make electrical installations in accordance with the laws of Maine, the Portland Electrical Ordinance, the National Electrical Code and the following specifications:

LOCATION OF WORK: Lot # 109-B-D-25 Isl Ave, Cliff Isl.
 OWNER'S NAME: Roger Burle ADDRESS: same

OUTLETS: (number of) 1-30

Lights	_____	
Receptacles	_____	
Switches	_____	
Plugmold	_____ (number of feet)	
TOTAL	_____	FEES

FIXTURES: (number of)		
Incandescent	_____	
Fluorescent	_____ (Do not include strip fluorescent)	
TOTAL	_____	3.00
Strip Fluorescent, in feet	_____	

SERVICES:

Permanent, total amperes	<u>100</u>	
Temporary	_____	
TOTAL	_____	3.00

METERS: (number of) 150

MOTORS: (number of)

Fractional	_____	
1 HP or over	_____	

RESIDENTIAL HEATING.

Oil or Gas (number of units)	_____	
Electric (number of rooms)	_____	

COMMERCIAL OR INDUSTRIAL HEATING:

Oil or Gas (by a main boiler)	_____	
Oil or Gas (by separate units)	_____	
Electric (total number of kws)	_____	

APPLIANCES: (number of)

Ranges	_____	Water Heaters	_____
Cook Tops	_____	Dishwashers	_____
Wall Oven	_____	Compactors	_____
Dryers	_____	Others (denote)	_____
Fans	_____		
TOTAL	_____		

MISCELLANEOUS: (number of)

Branch Panels	_____
Transformers	_____
Air Conditioners	_____
Signs	_____
Fire/Burglar Alarms	_____
Circus, Fairs, etc.	_____
Alterations to wires	_____
Repairs after fire	_____
Heavy Duty, 220v outlets	_____
Emergency Lights, battery	_____
Emergency Generators	_____

FOR ADDITIONAL WORK NOT ON ORIGINAL PERMIT	INSTALLATION FEE DUE:	_____
FOR REMOVAL OF A "STOP ORDER" (304-16.b)	DOUBLE FEE DUE:	_____
FOR PERFORMING WORK WITHOUT A PERMIT (304-9)	TOTAL AMOUNT DUE:	6.50

INSPECTION: Will be ready on _____, 19____; or Will Call ~~at~~ _____

CONTRACTOR'S NAME: P. A. Gomez
 ADDRESS: Chebeague Isl.
 TEL: 846-4110

MASTER LICENSE NO. 10 limited 46
 LIMITED LICENSE NO.: _____

SIGNATURE OF CONTRACTOR: _____



APPLICATION FOR PERMIT
 DEPARTMENT OF BUILDING INSPECTIONS SERVICES
 ELECTRICAL INSTALLATIONS

Date July 27, 1977
 Receipt and Permit number A10210

To the CHIEF ELECTRICAL INSPECTOR, Portland, Maine:

I undersigned hereby applies for a permit to make electrical installations in accordance with the laws of Maine, the Portland Electrical Ordinance, the National Electrical Code and the following specifications:

LOCATION OF WORK: Lot # 109-B-D-1-38 Isl Ave. Cliff Island
 OWNER'S NAME: Stone Library ADDRESS: same

OUTLETS: (number of) 1-30

Lights	_____	
Receptacles	_____	
Switches	_____	FEE\$
Plugmold	_____ (number of feet)	
TOTAL	_____	<u>3.00</u>

FIXTURES: (number of)

Incandescent	_____	
Fluorescent	_____ (Do not include strip fluorescent)	
TOTAL	_____	
Strip Fluorescent, in feet	_____	

SERVICES:

Permanent, total amperes	<u>100</u>	FEE\$
Temporary	_____	

METERS: (number of) 1 FEE\$.50

MOTORS: (number of)

Fractional	_____	
1 HP or over	_____	

RESIDENTIAL HEATING:

Oil or Gas (number of units)	_____	
Electric (number of rooms)	_____	

COMMERCIAL OR INDUSTRIAL HEATING:

Oil or Gas (by a main boiler)	_____	
Oil or Gas (by separate units)	_____	
Electric (total number of kws)	_____	

APPLIANCES: (number of)

Ranges	_____	Water Heaters	_____
Cook Tops	_____	Disposals	_____
Wall Ovens	_____	Dishwashers	_____
Dryers	_____	Compactors	_____
Fans	_____	Others (denote)	_____
TOTAL	_____		

MISCELLANEOUS: (number of)

Branch Panels	_____	
Transformers	_____	
Air Conditioners	_____	
Signs	_____	
Fire/Burglar Alarms	_____	
Circus, Fairs, etc.	_____	
Alterations to wires	_____	
Repairs after fire	_____	
Heavy Duty, 220v outlets	_____	
Emergency Lights, Lattery	_____	
Emergency Generators	_____	

INSTALLATION FEE DUE: _____
 FOR ADDITIONAL WORK NOT ON ORIGINAL PERMIT DOUBLE FEE DUE: _____
 FOR REMOVAL OF A "STOP ORDER" (304-15 b) _____
 FOR PERFORMING WORK WITHOUT A PERMIT (304-9) _____
 TOTAL AMOUNT DUE: 6.50

INSPECTION: Will be ready on _____, 19____; or Will Call 302

CONTRACTOR'S NAME: P. J. Gomez
 ADDRESS: Chabangua Isl
 TEL.: 846-4110

MASTER LICENSE NO.: 45-limited SIGNATURE OF CONTRACTOR: _____
 LIMITED LICENSE NO.: _____

OFFICE COPY



APPLICATION FOR PERMIT
 DEPARTMENT OF BUILDING INSPECTIONS SERVICES
 ELECTRICAL INSTALLATIONS

Date July 22, 19 77
 Receipt and Permit number A10212

To the CHIEF ELECTRICAL INSPECTOR, Portland, Maine:

The undersigned hereby applies for a permit to make electrical installations in accordance with the laws of Maine, the Portland Electrical Ordinance, the National Electrical Code and the following specifications:

LOCATION OF WORK: Cor # 109-C-A-27 Isl Ave, Cliff Island
 OWNER'S NAME: Thomas Wright ADDRESS: same

OUTLETS: (number of) 1200x 1-30
 Lights _____
 Receptacles _____
 Switches _____ FEES
 Plugmold _____ (number of feet)
 TOTAL _____

FIXTURES: (number of) _____
 Incandescent _____
 Fluorescent _____ (Do not include strip fluorescent)
 TOTAL _____
 Strip Fluorescent, in feet _____

SERVICES:
 Permanent, total amperes 200 _____ FEES 3.00
 Temporary _____

METERS: (number of) 1 _____ FEES .50

MOTORS: (number of)
 Fractional _____
 1 HP or over _____

RESIDENTIAL HEATING:
 Oil or Gas (number of units) _____
 Electric (number of rooms) 4 _____ FEES 4.00

COMMERCIAL OR INDUSTRIAL HEATING:
 Oil or Gas (by a main boiler) _____
 Oil or Gas (by separate units) _____
 Electric (total number of kws) _____

APPLIANCES: (number of)
 Ranges _____ Water Heaters _____
 Cook Tops _____ Disposals _____
 Wall Ovens _____ Dishwashers _____
 Dryers _____ X _____ Compactors _____
 Fans _____ Others (denote) _____
 TOTAL _____ FEES 1.50

MISCELLANEOUS: (number of)
 Branch Panels _____
 Transformers _____
 Air Conditioners _____
 Signs _____
 Fire/Burglar Alarms _____
 Circus, Fairs, etc. _____
 Alterations to wires _____
 Repairs after fire _____
 Heavy Duty, 220v outlets _____
 Emergency Lights, battery _____
 Emergency Generators _____

INSTALLATION FEE DUE: _____
 FOR ADDITIONAL WORK NOT ON ORIGINAL PERMIT DOUBLE FEE DUE: _____
 FOR REMOVAL OF A "STOP ORDER" (304-16.b) _____
 FOR PERFORMING WORK WITHOUT A PERMIT (304-9) _____
 TOTAL AMOUNT DUE: 12.00

INSPECTION:
 Will be ready on _____, 19__; or Will Call XX

CONTRACTOR'S NAME: P. A. Gomez
 ADDRESS: Chabouge Isl.
 TEL.: 826-4110

MASTER LICENSE NO.: 46 limited
 LIMITED LICENSE NO.: _____

SIGNATURE OF CONTRACTOR



APPLICATION FOR PERMIT
 DEPARTMENT OF BUILDING INSPECTIONS SERVICES
 ELECTRICAL INSTALLATIONS

Date June 30 1977
 Receipt and Permit number ALG218

To the CHIEF ELECTRICAL INSPECTOR, Portland, Maine:
 The undersigned hereby applies for a permit to make electrical installations in accordance with the laws of Maine, the Portland Electrical Ordinance, the National Electrical Code and the following specifications:

LOCATION OF WORK: 109 D-F-11 Cliff Island
 OWNER'S NAME: Malcolm Griffin ADDRESS: same

OUTLETS: (number of)
 Lights 1-30
 Receptacles _____
 Switches _____
 Plugmold _____ (number of feet)
 TOTAL _____ **FEEES** 3.00

FIXTURES: (number of)
 Incandescent _____
 Fluorescent _____ (Do not include strip fluorescent)
 TOTAL _____
 Strip Fluorescent, in feet _____

SERVICES:
 Permanent, total amperes 100
 Temporary _____ **FEEES** 3.00

METERS: (number of) 1 **FEEES** .50

MOTORS: (number of)
 Fractional _____
 1 HP or over _____

RESIDENTIAL HEATING:
 Oil or Gas (number of units) _____
 Electric (number of rooms) _____

COMMERCIAL OR INDUSTRIAL HEATING:
 Oil or Gas (by a main boiler) _____
 Oil or Gas (by separate units) _____
 Electric (total number of kws) _____

APPLIANCE(S): (number of)
 Ranges _____ Water Heaters _____
 Cook Tops _____ Disposal _____
 Wall Ovens _____ Dishwashers _____
 Dryers _____ Compactors _____
 Fans _____ Others (denote) _____
 TOTAL _____

MISCELLANEOUS: (number of)
 Branch Panels _____
 Transformers _____
 Air Conditioners _____
 Signs _____
 Fire/Burglar Alarms _____
 Circuits Fairs, etc. _____
 Alterations to wires _____
 Repairs after fire _____
 Heavy Duty, 220v outlets _____
 Emergency Lights, battery _____
 Emergency Generators _____

INSTALLATION FEE DUE _____
 FOR ADDITIONAL WORK NOT ON ORIGINAL PERMIT DOUBLE FEE DUE _____
 FOR REMOVAL OF A "STOP ORDER" (304-16.b) _____
 FOR PERFORMING WORK WITHOUT A PERMIT (304-9) _____
 TOTAL AMOUNT DUE 6.50

INSPECTION:
 Will be ready on _____ 19____; or Will Call xxx _____

CONTRACTOR'S NAME: Patrick Davis
 ADDRESS: 199 Vaughn St.
 TEL: 772-5340

MASTER LICENSE NO.: # 43 SIGNATURE OF CONTRACTOR: Patrick J. Davis
 LIMITED LICENSE NO.: _____

OFFICE COPY



APPLICATION FOR PERMIT

PERMIT ISSUED

B.O.C.A. USE GROUP 532

JUL 8 1975

B.O.C.A. TYPE OF CONSTRUCTION

ZONING LOCATION PORTLAND, MAINE, June 30, 1975

CITY of PORTLAND

To the DIRECTOR OF BUILDING & INSPECTION SERVICES, PORTLAND, MAINE

The undersigned hereby applies for a permit to erect, alter, repair, demolish, move or install the following building, structure, equipment or change use in accordance with the Laws of the State of Maine, the Portland B.O.C.A. Building Code and Zoning Ordinance of the City of Portland with plans and specifications, if any, submitted herewith and the following specifications:

LOCATION 109B-D-14, 15 & 36 Island Ave, Cliff Island Fire District #1 #2

1. Owner's name and address Kenneth Stone, same Telephone

2. Lessee's name and address Telephone

3. Contractor's name and address owner Telephone

4. Architect Specifications Plans *yes* No. of sheets 1

Proposed use of building dwelling No. families

Last use same No. families

Material No. stories Heat Style of roof Roofing

Other buildings on same lot

Estimated contractual cost \$ 2,000.00 Fee \$ 8.00

FIELD INSPECTOR—Mr. Smith GENERAL DESCRIPTION
 This application is for: @ 775-5451 to construct a 12' x 20' addition per plan.
 Dwelling Ext. 234
 Garage
 Masonry Bldg
 Metal Bldg
 Alterations
 Demolitions
 Change of Use
 Other

PERMIT ISSUED WITH LETTER

Stamp of Special Conditions

NOTE TO APPLICANT: Separate permits are required by the installers and subcontractors of heating, plumbing, electrical and mechanicals.

PERMIT IS TO BE ISSUED TO 1 2 3 4
Other:

DETAILS OF NEW WORK

Is any plumbing involved in this work? ... NO Is any electrical work involved in this work? ... YES

Is connection to be made to public sewer? If not what is proposed for sewage?

Has septic tank notice been sent? Form notice sent?

Height average grade to top of plate Height average grade to highest point of roof

Size, front depth No. stories solid or filled land? earth or rock?

Material of foundation Thickness, top bottom cellar

Kind of roof Rise per foot Roof covering

No. of chimneys Material of chimneys of lining Kind of heat fuel

Framing Lumber—Kind Dressed or full size? Corner posts Sills

Size Girder Columns under girders Size Max. on centers

Studs (outside walls and carrying partitions) 2x4-16" O. C. Bridging in every floor and flat roof span over 8 feet.

Joists and rafters: 1st floor 2nd 3rd roof

On centers: 1st floor 2nd 3rd roof

Maximum span: 1st floor 2nd 3rd roof

If one story building with masonry walls, thickness of walls? height?

IF A GARAGE

No. cars now accommodated on same lot, to be accommodated number commercial cars to be accommodated

Will automobile repairing be done other than minor repairs to cars habitually stored in the proposed building?

APPROVALS BY: DATE MISCELLANEOUS

BUILDING INSPECTION—PLAN EXAMINER Will work require disturbing of any tree on a public street?

ZONING: G.M. - 7/11/75 - Allen

BUILDING CODE: Will there be in charge of the above work a person competent to see that the State and City requirements pertaining thereto are observed? ... YES

Fire Dept.:

Health Dept.:

Others:

Signature of Applicant *Kenneth Stone* Phone # none

Type Name of above Kenneth Stone 1 2 3 4

FIELD INSPECTOR'S COPY

Other and Address

NOTES

7/16/75 - platform framed.

9/29/76 - work done E.S.

Permit No.

75/532

Boyle

Location

15144 Ave Cliffside

Owner

STOYE

Date of permit

7/3/75

Approved

Chart, Block & Lot
709.B D 14, 15, 36

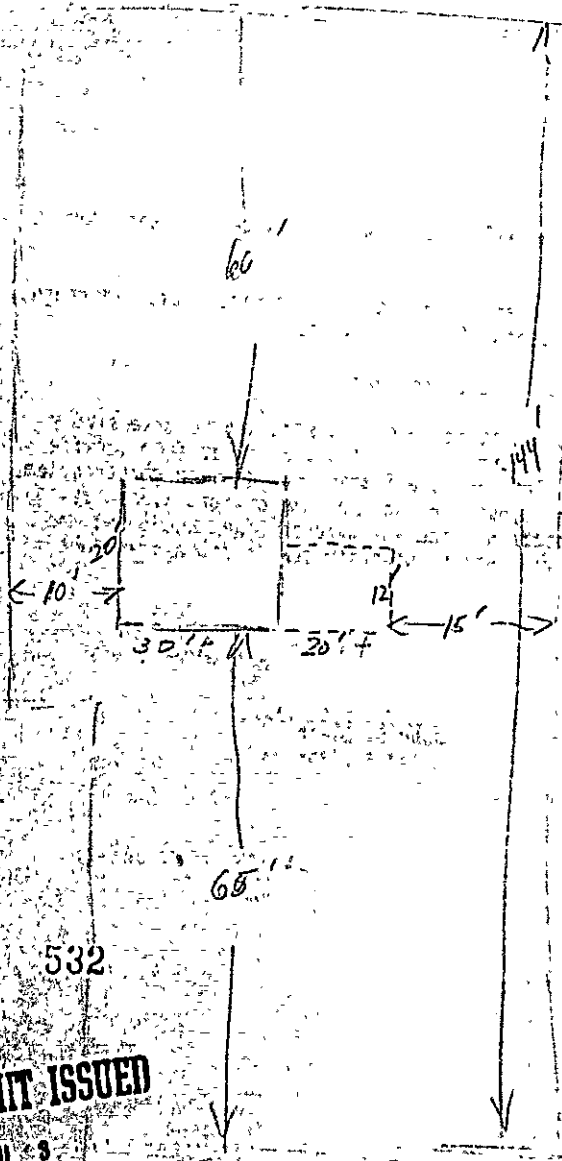
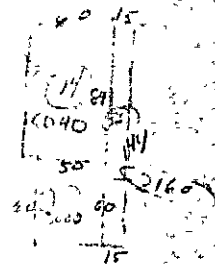

Addition 4' BELOW GRADE
OR TO LEAVE
on cement posts 10" dia
4'x16' sills
2'x4' frame 16" O.C.
2x6' rafters 16" O.C.
4'x4' corner posts
Pitch Roof 4/12
ASPHALT SHINGLES
STANDARD SIZE DOOR AND
WINDOWS
L. C. ANDREWS
10' FM GRADE TO PLATE

RECEIVED
JUN 30 1975
DEPT. OF BLDG. INSP.
CITY OF PORTLAND

532
PERMIT ISSUED
JUL 3
CITY of PORTLAND

PERMIT TO INSTALL PLUMBING

Address: Griffina Cove, Cliff Island PERMIT NUMBER **4756**

Installation For: our family

Owner of Bldg: Mrs. Dorothy Work, Cliff Island

Owner's Address: same

Plumber: Richard Walk, 536 Washington Ave. Date: 8-31-76

Date Issued: 8-31-76
 Portland Plumbing Inspector
 By: EROLD R. GOODWIN

App. First Insp. SEP 29 1976

Date: _____
 By: _____

App. Final Insp. _____

Date: _____
 By: _____

Type of Bldg.
 Commercial _____
 Residential _____
 Single _____
 Multi Family _____
 New Construction _____
 Remodeling _____

NEW	REPL		NO.	FEE
	1	SINKS		
1		LAVATORIES	1	2.00
1		TOILETS	1	2.00
1		BATH TUBS	1	2.00
		SHOWERS	1	2.00
		DRAINS FLOOR SURFACE		
1		HOT WATER TANKS		
		TANKLESS WATER HEATERS	1	2.00
		GARBAGE DISPOSALS		
		SEPTIC TANKS		
		HOUSE SEWERS		
		ROOF LEADERS		
		AUTOMATIC WASHERS		
		DISHWASHERS		
		OTHER		
		Base Fee		3.00
			TOTAL	13.00

Building and Inspection Services Dept.: Plumbing Inspection

109-C-B-12, Cliff Island

September 27, 1976

Robert C. Howard
Cliff Island,
Maine

c.c. Duncan P. Whittaker
Island Ave.
Cliff Island, Me.

Dear Sir:

In reply to your letter of September 13, I have checked with Corporation Counsel and he advises me that first it will be necessary to go before Council to request to build on this lot due to the fact that the right of way is only 12' in width from Church Rd. This lot comes under Section 602.19L of the Zoning Ordinance which states; a lot of record as such can be considered for approval by Municipal Offices under Section 602.19P which states in part, such means of ingress and egress may be approved by Municipal Offices of the City of Portland who may permit a lesser right of way when in their opinion such lesser width adequately serves the needs of the lot.

If you desire to purchase this property, apply for a building permit with a plot plan, showing us the location of the building on this lot as well as at least one parking space 8'x18'. If no garage is proposed. We will also need a rough elevation of this building so that we can determine how many stories as well as the floor plan. We will then be able to go before the Portland City Council, and if approved, you can supply the rest of the plans and the fee.

Very truly yours,

A. Allan Soule
Assistant Director

AAS:k

(109-C)-B-12

(109B)

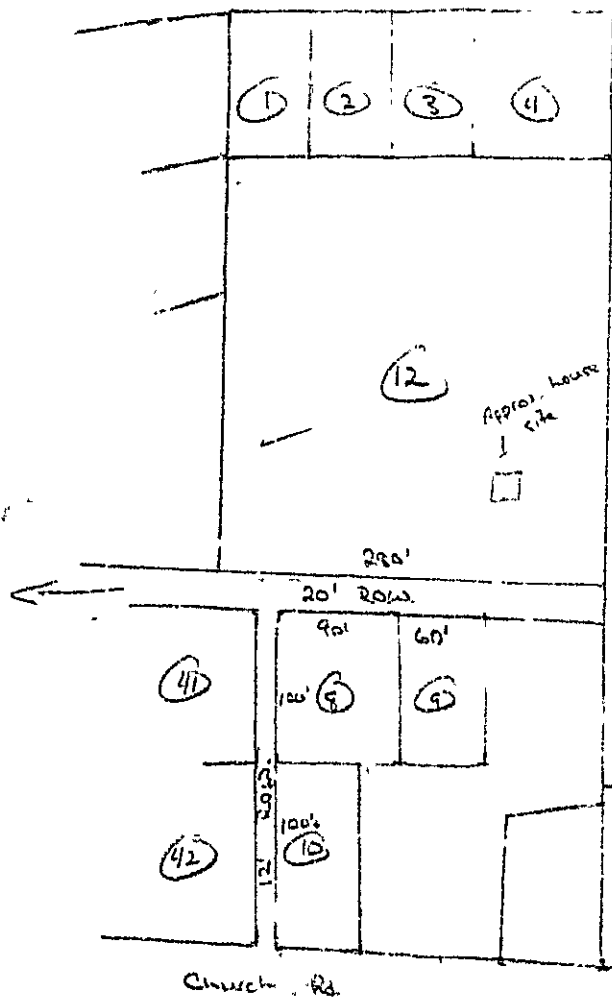

Map of area
around lot 12
on Cliff Island

Real Estate Index
Tax File

Map # 109C
section B

RECEIVED
SEP 13 1976
DEPT. OF BLDG. INSP.
CITY OF PORTLAND

Fisherman's Cove

100ft

Robert C Howard
Cliff Island
Maine 04019

Cliff Island
Maine, 04019
9/13/76

Building Dept
City Hall
Portland, Maine

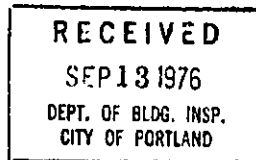

Dear Sirs:

I am in the process of purchasing land on Cliff Island and, before completing the purchase, I request your determination that the lot meets necessary access, frontage and similar requirements for construction of a single family residence. I realize that a separate determination as to sanitary requirements would be necessary.

Number 12 on the attached map is the property in question.

Thank you
Robert C Howard

Lot presently owned by Denaugh P Whittaker
Island Ave.
Cliff Island 04019

CITY OF PORTLAND, MAINE

Application for Permit to Install Wires

Permit No. 58785 ..
 Issued 6/16/72 ..

Portland, Maine June 16 .., 1972

To the City Electrician, Portland, Maine:

The undersigned hereby applies for a permit to install wires for the purpose of conducting electric current, in accordance with the laws of Maine, the Electrical Ordinance of the City of Portland, and the following specifications:

(This form must be completely filled out — Minimum Fee, \$1.00) com

Owner's Name and Address A G Bassett clif Island ..
 Contractor's Name and Address R L Mun Van clif Island 766-2587 ..

Location Use of Building

Number of Families .. Apartments .. Stores .. Number of Stories ..

Description of Wiring: New Work .. Additions .. Alterations ..

add 1 range

Pipe .. Cable .. Metal Molding .. BX Cable .. Plug Molding (No. of feet) ..

No. Light Outlets .. Plugs .. Light Circuits .. Plug Circuits ..

FIXTURES: No. Fluor. or Strip Lighting (No. feet) ..

SERVICE: Pipe .. Cable .. Underground .. No. of Wires .. Size ..

METERS: Relocated .. Added .. Total No. Meters ..

MOTORS: Number .. Phase .. H. P. .. Amps .. Volts .. Starter ..

HEATING UNITS: Domestic (Oil) .. No. Motors .. Pl. ce .. H.P.

Commercial (Oil) .. No. Motors .. Phase .. H.P.

Electric Heat (No. of Rooms) ..

APPLIANCES: No. Ranges 1 .. Watts 10 kW .. Brand Feeds (Size and No.) 5/3 ..

Elec. Heaters Watts

Miscellaneous Watts Extra Cabinets or Panels

Transformers Air Conditioners (No. Units) .. Signs (No. Units) ..

Will commence 19 .. Ready to cover in 19 .. Inspection 19 ..

Amount of Fee \$ 1.50

Signed Robert Mun Van ..

DO NOT WRITE BELOW THIS LINE

SERVICE	METER	GROUND
VISITS: 1 2 3 4 5 6	7 8 9 10 11 12	

REMARKS:

INSPECTED BY (OVER)

CITY OF PORTLAND, MAINE

Application for Permit to Install Wires

Permit No. 57793

ss1 2d 6/14/72

Portland, Maine June 16, 1972

To the City Electrician, Portland, Maine:

The undersigned hereby applies for a permit to install wires for the purpose of conducting electric current, in accordance with the laws of Maine, the Electrical Ordinance of the City of Portland, and the following specifications:

(This form must be completely filled out — Minimum Fee, \$1.00) turn receipt

Owner's Name and Address P. B. Bassett Cliff Junction Tel.

Contractor's Name and Address F. S. McNamee Cliff Junction Tel. 766-2682

Location Use of Building

Number of Families Apartments Stores Number of Stories

Description of Wiring: New Work Additions ← Alterations

Change over 2,100 wps. under 6 outlets & 1-w hts. 1 range.

Pipe Cable Metal Molding BX Cable Plug Molding (No. of feet)

No. Light Outlets Plugs 6 Light Circuits Plug Circuits

FIXTURES: No. Fluor. or Strip Lighting (No. feet)

SERVICE: Pipe Cable 1 Underground No. of Wires 3 Size 2

METERS: Relocated Added Total No. Meters

MOTORS: Number Phase H. P. Amps Volts Starter

HEATING UNITS: Domestic (Oil) No. Motors Phase H.P.

Commercial (Oil) No. Motors Phase H.P.

Electric Heat (No. of Rooms)

APPLIANCES: No. Ranges 1 Watts 104w Brand Feeds (Size and No.) 2/1

Elec. Heaters 1 WH Watts 4500

Miscellaneous Watts Extra Cabinets or Panels

Transformers Air Conditioners (No. Units) Signs (No. Units)

Will commence 19 Ready to cover in 19 Inspection 19

Amount of Fee \$ 5.00

Signed F. S. McNamee

DO NOT WRITE BELOW THIS LINE

SERVICE METER GROUND

VISITS: 1 2 3 4 5 6

7 8 9 10 11 12

REMARKS:

INSPECTED BY

CITY OF PORTLAND, MAINE

Application for Permit to Install Wires

Permit No. 58784
Issued 6/16/72

Portland, Maine 9

To the City Electrician, Portland, Maine:

The undersigned hereby applies for a permit to install wires for the purpose of conducting electric current, in accordance with the laws of Maine, the Electrical Ordinance of the City of Portland, and the following specifications:

(This form must be completely filled out — Minimum Fee, \$1.00)

Owner's Name and Address Joseph, Denis Cliff Portland.
Contractor's Name and Address Robert & Suzanne Cliff Portland 766-2627
Location Cliff St.

Use of Building		Number of Stories	
Number of Families	Apartments	Stores	Alterations
Description of Wiring: New Work		Additions <input checked="" type="checkbox"/>	
<u>Change over from 604 to 100 amp. add W.H.F.</u>			
Pipe	Cable <input checked="" type="checkbox"/>	Metal Molding	BX Cable
No. Light Outlets	Plugs	Light Circuits	Plug Molding (No. of feet)
FIXTURES: No.		Fluor. or Strip Lighting (No. feet)	
SERVICE: Pipe	Cable <input checked="" type="checkbox"/>	Underground	No. of Wires <input checked="" type="checkbox"/> Size <input checked="" type="checkbox"/>
METERS: Relocated		Added	Total No. Meters
MOTORS: Number	Phase	H.P.	Amps
HEATING UNITS: Domestic (Oil)		No. Motors	Phase
Commercial (Oil)		No. Motors	Phase
Electric Heat (No. of Rooms)			
APPLIANCES: No. Ranges	Watts	Brand Feeds (Size and No.)	
Elec. Heaters	Watts <u>4500</u>		
Miscellaneous	Watts	Extra Cabinets or Panels	
Transformers	Air Conditioners (No. Units)	Signs (No. Units)	
Will commence	19	Ready to cover in	19
Amount of Fee \$.	<u>2.50</u>	Signed <u>Robert Cliff</u>	

DO NOT WRITE BELOW THIS LINE

SERVICE		METER		GROUND	
VISITS: 1	2	3	4	5	6
..... 7	8	9	10	11	12
REMARKS:					

INSPECTED BY (OVER)

CITY OF PORTLAND, MAINE

Application for Permit to Install Wires

Permit No. 59786
 Issued 6/16/72

Portland, Maine 19

To the City Electrician, Portland, Maine:

The undersigned hereby applies for a permit to install wires for the purpose of conducting electric current, in accordance with the laws of Maine, the Electrical Ordinance of the City of Portland, and the following specifications:

(This form must be completely filled out — Minimum Fee, \$1.00)

Owner's Name and Address Arthur Reith Clifford
 Contractor's Name and Address A. L. Moulton Clifford Tel. 766-2057
 Location Palmer Ave Use of Building
 Number of Families Apartments Stores Number of Stories
 Description of Wiring: New Work Additions Alterations
add. 1 range
 Pipe Cable Metal Molding BX Cable Plug Molding (No. of feet)
 No. Light Outlets Plugs Light Circuits Plug Circuits
 FIXTURES: No. Fluor. or Strip Lighting (No. feet)
 SERVICE: Pipe Cable Underground No. of Wires Size
 METERS: Relocated Added Total No. Meters
 MOTORS: Number Phase H. P. Amps Volts Starter
 HEATING UNITS: Domestic (Oil) No Motors Phase H.P.
 Commercial (Oil) No. Motors Phase H.P.
 Electric Heat (No. of Rooms)
 APPLIANCES: No. Ranges 1 Watts 12 Kw. Brand Feeds (Size and No.) 4/3
 Elec. Heaters Watts
 Miscellaneous Watts Extra Cabinets or Panels
 Transformers Air Conditioners (No. Units) Signs (No. Units)
 Will commence 19 Ready to cover in 19 Inspection 19
 Amount of Fee \$ 1.50 Signed A. L. Moulton Clifford

DO NOT WRITE BELOW THIS LINE

SERVICE METER GROUND
 VISITS: 1 2 3 4 5 6
 7 8 9 10 11 12
 REMARKS:

INSPECTED BY (OVER)

CITY OF PORTLAND, MAINE

Application for Permit to Install Wires

Permit No. 58788
 Issued 6/16/22
 Portland, Maine 6/16/22, 1922

To the City Electrician, Portland, Maine:

The undersigned hereby applies for a permit to install wires for the purpose of conducting electric current, in accordance with the laws of Maine the Electrical Ordinance of the City of Portland, and the following specifications:

(This form must be completely filled out — Minimum Fee, \$1.00)

Owner's Name and Address Barker - Benson Cliff Island
 Contractor's Name and Address R. L. McNamee Cliff Island 706-2687
 Location summit rd. Use of Building _____
 Number of Families Apartments Stores Number of Stories _____
 Description of Wiring: New Work Additions Alterations _____
change ser. to 100 amp.
 Pipe . . . Cable 1/2 Metal Molding BX Cable Plug Molding (No. of feet) . . .
 No. Light Outlets Plugs Light Circuits Plug Circuits . . .
 FIXTURES: No. Fluor. or Strip Lighting (No. feet) . . .
 SERVICE: Pipe Cable Underground No. of Wires 3 Size 2
 METERS: Relocated Added Total No. Meters _____
 MOTORS: Number Phase H. P. Amps Volts Starter . . .
 HEATING UNITS: Domestic (Oil) . No. Motors Phase H.P. . . .
 Commercial (Oil) No. Motors Phase H.P. . . .
 Electric Heat (No. of Rooms) _____
 APPLIANCES: No. Ranges . Watts Brand Feeds (Size and No.) . . .
 Elec. Heaters Watts . . .
 Miscellaneous Watts . . . Extra Cabinets or Panels . . .
 Transformers . . . Air Conditioners (No. Units) Signs (No. Units) . . .
 Will commence . . . 19 Ready to cover in 19 Inspection . . . 19 . . .
 Amount of Fee \$ 2.00
 Signed R. L. McNamee

DO NOT WRITE BELOW THIS LINE

SERVICE	METER	GROUND
VISITS: 1 2 3 4 5 6		
. 7 8 9 10 11 12		

REMARKS: _____

INSPECTED BY _____

CITY OF PORTLAND, MAINE

Application for Permit to Install Wires

Permit No. 58787
 Issued 6/16/72

Portland, Maine

To the City Electrician, Portland, Maine:

The undersigned hereby applies for a permit to install wires for the purpose of conducting electric current, in accordance with the laws of Maine, the Electrical Ordinance of the City of Portland, and the following specifications:

(This form must be completely filled out - Minimum Fee, \$1.00)

Owner's Name and Address David Thompson Cliff Road
 Contractor's Name and Address F. L. McNamee Cliff Road Tel. 761-2687

Location street side Use of Building
 Number of Families _____ Stores _____
 Description of Wiring: New Work _____ Additions _____ Alterations _____
 Pipe _____ Cable _____ Metal Molding _____ BX Cable _____ Plug Molding (No. of feet) _____
 No. Light Outlets _____ Plugs _____ Light Circuits _____ Plug Circuits _____
 No. of Wires _____ Size _____
 SERVICE: No. _____ Total No. Meters _____
 METERS: Relocated _____ Added _____
 MOTORS: Number _____ Phase _____ H. P. _____ Amps _____ Volts _____ Starter _____
 HEATING UNITS: Domestic (Oil) _____ No. Motors _____ Phase _____ H.P. _____
 Commercial (Oil) _____ No. Motors _____ Phase _____ H.P. _____
 Electric Heat (No. of Rooms) _____
 APPLIANCES: No. Ranges _____ Watts _____ Brand Feeds (Size and No.) _____
 Elec. Heaters _____ Watts _____
 Miscellaneous dryer Watts 4000 Extra Cabinets or Panels _____
 Transformers _____ Air Conditioners (No. Units) _____ Signs (No. Units) _____
 Will commence _____ 19 _____ Ready to cover in _____ 19 _____
 Amount of Fee \$ 3.50 Signed F. L. McNamee

DO NOT WRITE BELOW THIS LINE

SERVICE	METER	GROUND
VISITS: 1	2	3
..... 7	8	9
REMARKS:	4	5
	10	11
		12

INSPECTED BY _____ (OVER)

CITY OF PORTLAND, MAINE

Application for Permit to Install Wires

Permit No. 59053

Issued 7-7-72

July 7, 1972

Portland, Maine

To the City Electrician, Portland, Maine:

The undersigned hereby applies for a permit to install wires for the purpose of conducting electric current, in accordance with the laws of Maine, the Electrical Ordinance of the City of Portland, and the following specifications:

(This form must be completely filled out - Minimum Fee \$1.00)

Owner's Name and Address Burke Pearson Corp. Portland

Contractor's Name and Address Robert J. McVane Tel. 766-2681

Location Gulf Island Use of Building _____

Number of Families _____ Apartments _____ Stores _____ Number of Stories _____

Description of Wiring: New Work Additions _____ Alterations _____

add 1 Dryer

Pipe Cable _____ BX Cable _____ Plug Molding (No. of feet) _____

No. Light Outlets _____ Metal Molding _____ Light Circuits _____ Plug Circuits _____

FIXTURES: No. _____

SERVICE: Pipe _____ Cable _____ Fluor. or Strip Lighting (No feet) _____

METERS: Relocated _____ Added _____ No. of Wires _____ Size _____

MOTORS: Number _____ Phase _____ H. P. _____ Amps _____ Total No. Meters _____

HEATING UNITS: Domestic (Oil) _____ No. Motors _____ Volts _____ Starter _____

Commercial (Oil) _____ No. Motors _____ Phase _____ H.P. _____

Electric Heat (No. of Rooms) _____ Phase _____ H.P. _____

APPLIANCES: No. Ranges _____ Watts _____ Brand Feeds (Size and No.) _____

Elec. Heaters _____ Watts _____

Miscellaneous dryer Watts 5000 Extra Cabinets or Panels _____

Transformers _____ Air Conditioners (No. Units) _____ Signs (No. Units) _____

Will commence _____ 19 _____ Ready to cover in _____ 19 _____ Inspection _____ 19 _____

Amount of Fee \$ 1.50

Signed Robert J. McVane

DO NOT WRITE BELOW THIS LINE

SERVICE	1	2	3	4	5	6
VISITS:	7	8	9	10	11	12
REMARKS:						

INSPECTED BY _____ (OVER)

CITY OF PORTLAND, MAINE
Application for Permit to Install Wires

Permit No. 59055
 Issued 7-7-72
July 7, 1972

Portland, Maine

To the City Electrician, Portland, Maine:

The undersigned hereby applies for a permit to install wires for the purpose of conducting electric current, in accordance with the laws of Maine, the Electrical Ordinance of the City of Portland, and the following specifications:

(This form must be completely filled out - Minimum Fee, \$1.00)

Owner's Name and Address Thomas Heath Cliff Island Tel. 266-2687
 Contractor's Name and Address Robert E. McNamee Tel. 266-2687

Location Cliff Island Use of Building
 Number of Families . . . Apartments . . . Stores . . . Number of Stories . . .
 Description of Wiring: New Work . . . Additions . . . Alterations . . .

Pipe . . . Cable . . . Metal Molding . . . BX Cable . . . Plug Molding (No. of feet) . . .
 No. Light Outlets . . . Plugs . . . Light Circuits . . . Plug Circuits . . .
 FIXTURES: No. . . . Fluor. or Strip Lighting (No. feet) . . .
 SERVICE: Pipe . . . Cable . . . Underground . . . No. of Wires . . . Size . . .
 METERS: Relocated . . . Added . . . Total No. Meters . . .
 MOTORS: Number . . . Phase . . . H. P. . . . Amps . . . Volts . . . Starter . . .
 HEATING UNITS: Domestic (Oil) . . . No. Motors . . . Phase . . . H.P. . . .
 Commercial (Oil) . . . No. Motors . . . Phase . . . H.P. . . .
 Electric Heat (No. of Rooms)

APPLIANCES: No. Ranges . . . Watts . . . Brand Feeds (Size and No.)
 Elec. Heaters WH . . . Watts 4500 . . .
 Miscellaneous . . . Watts . . . Extra Cabinets or Panels

Transformers . . . Air Conditioners (No. Units) . . . Signs (No. Units)
 Will commence . . . 19 . . . Ready to cover in . . . 19 . . . Inspection . . . 19 . . .

Amount of Fee \$ 1.50
 Signed Robert E. McNamee

DO NOT WRITE BELOW THIS LINE

SERVICE	METER	GROUND
VISITS: 1 2	3 4	5 6
7 8	9 10	11 12

REMARKS:

INSPECTED BY (OVER)

CITY OF PORTLAND, MAINE
Application for Permit to Install Wires

Permit No. *59054*
 Issued *7-7-72*
July 7, 19*72*
 Portland, Maine

To the City Electrician, Portland, Maine:

The undersigned hereby applies for a permit to install wires for the purpose of conducting electric current, in accordance with the laws of Maine, the Electrical Ordinance of the City of Portland, and the following specifications:

(This form must be completely filled out -- Minimum fee, \$1.00)

Owner's Name and Address *James B. Merrill 1000 Commercial*
 Contractor's Name and Address *Robert E. Thayer* Tel. *766-2687*

Location *Commercial* Use of Building

Number of Families	Apartments	Stores	Number of Stories
Description of Wiring: New Work		Additions	Alterations
Pipe .. Cable	Metal Molding	BX Cable	Plug Molding (No. of feet)
No. Light Outlets	Plugs	Light Circuits	Plug Circuits
FIXTURES: No.		Fluor. or Strip Lighting (No. feet)	
SERVICE: Pipe	Cable	Underground	No. of Wires
METERS: Relocated		Added	Total No. Meters
MOTORS: Number	Phase	H. P.	Amps
HEATING UNITS: Domestic (Oil)		No. Motors	Phase
Commercial (Oil)		No. Motors	Phase
Electric Heat (No. of Rooms)			
APPLIANCES: No. Ranges	Watts	Brand Feeds (Size and No.)	
Elec. Heaters <i>W H</i>	Watts <i>4500</i>		
Miscellaneous	Watts	Extra Cabinets or Panels	
Transformers	Air Conditioners (No. Units)	Signs (No. Units)	
Will commence	19. . . Ready to cover in	19. . . Inspection	19
Amount of Fee \$ <i>1.50</i>			

Signed *Robert E. Thayer*

DO NOT WRITE BELOW THIS LINE

SERVICE	METER		GROUND		
VISITS: 1	2	3	4	5	6
..... 7	8	9	10	11	12

REMARKS:

INSPECTED BY
 (OVER)

CITY OF PORTLAND, MAINE

Application for Permit to Install Wires

Permit No. 59056
 Issued 7-7-72
July 7, 1972

Portland, Maine

To the City Electrician, Portland, Maine:

The undersigned hereby applies for a permit to install wires for the purpose of conducting electric current, in accordance with the laws of Maine, the Electrical Ordinance of the City of Portland, and the following specifications:

(This form must be completely filled out - Minimum Fee, \$1.00)

Owner's Name and Address Wm. Elbright Tom Wright Tel. 566-2667
 Contractor's Name and Address Chapman Electric Tel. 566-2667
 Location Chapman Island Use of Building residence Number of Stories 1
 Number of Families 1 Apartments 0 Stores 0 Additions 0 Alterations 0
 Description of Wiring: New Work

Pipe . . . Cable 4 Metal Molding 7 BX Cable 1 Plug Molding (No. of feet) 3
 No. Light Outlets 4 Plugs 7 Light Circuits 1 Plug Circuits 3
 FIXTURES: No. 4 Floor. or Strip Lighting (No. feet) 6
 SERVICE: Pipe 1 Cable 1 Underground 0 No. of Wires 3 Size 6
 METERS: Relocated 0 Added 0 Total No. Meters 0
 MOTORS: Number 0 Phase 0 H. P. 0 Amps 0 Volts 0 Starter 0
 HEATING UNITS: Domestic (Oil) 0 No. Motors 0 Phase 0 H.P. 0
 Commercial (Oil) 0 No. Motors 0 Phase 0 H.P. 0
 Electric Heat (No. of Rooms) 0
 APPLIANCES: No. Ranges 1 Watts 11500 Brand Feeds (Size and No.) 0
 Elec. Heaters 0 Watts 0
 Miscellaneous 0 Watts 0
 Transformers 0 Air Conditioners (No. Units) 0 Extra Cabinets or Panels 0
 Will commence 19 Ready to cover in 19 Signs (No. Units) 0
 Amount of Fee \$ 2.50 Inspection 19

Signed Robert C. [Signature]

DO NOT WRITE BELOW THIS LINE

SERVICE		METER		GROUND			
VISITS: 1	2	3	4	5	6	7	8
REMARKS:							

INSPECTED BY _____
 (OVER)

②

APPLICATION FOR PERMIT

PERMIT ISSUED

B.O.C.A. USE GROUP

B.O.C.A. TYPE OF CONSTRUCTION 0118

SEP 11 1934

ZONING LOCATION PORTLAND, MAINE Sept. 5, 1934

CITY OF PORTLAND

To the CHIEF OF BUILDING & INSPECTION SERVICES, PORTLAND, MAINE

The undersigned hereby applies for a permit to erect, alter, repair, demolish, move or install the following building, structure, equipment or change use in accordance with the Laws of the State of Maine, the Portland B.O.C.A. Building Code and Zoning Ordinance of the City of Portland with plans and specifications, if any, submitted herewith and the following specifications:

LOCATION 109-B-2-45 Cliff Island, Maine

1. Owner's name and address Bruce & Evalina Dyer - same Fire District #1 , #2

2. Lessee's name and address Telephone 766-2917

3. Contractor's name and address Cemer Telephone

Proposed use of building dwelling - year round No. of sheets

Last use same No. families 1

Material No. stories Heat Style of roof Roofing

Other buildings on same lot

Estimated contractual cost \$ 3,000

FIELD INSPECTOR—M. Appeal Fees \$

@ 775-5451 Base Fee 25.00

Late Fee

TOTAL \$ 25.00

To construct 10' x 24' addition to already existing dwelling, to be used as living room.

Stamp of Special Conditions

NOTE TO APPLICANT: Separate permits are required by the installers and subcontractors of heating, plumbing, electrical and mechanicals.

DETAILS OF NEW WORK

Is any plumbing involved in this work? no Is any electrical work involved in this work? yes

Is connection to be made to public sewer? If not, what is proposed for sewage?

Has septic tank notice been sent? Form notice sent.

Height average grade to top of plate Height average grade to highest point of roof

Size, front depth No. stories solid or filled land? earth or rock?

Material of foundation Thickness, top bottom cellar

Kind of roof Rise per foot Roof covering

No. of chimneys Material of chimneys of lining Kind of heat fuel

Framing Lumber—Kind Dressed or full size? Corner posts Sills

Size Girder Columns under girders Size Max. on centers

Studs (outside walls and carrying partitions) 2x4-16" O. C. Bridging in every floor and flat roof span over 8 feet.

Joists and rafters: 1st floor 2nd 3rd roof

On centers: 1st floor 2nd 3rd roof

Maximum span: 1st floor 2nd 3rd roof

If one story building with masonry walls, thickness of walls? height?

IF A GARAGE

No. cars now accommodated on same lot to be accommodated number commercial cars to be accommodated

Will automobile repairing be done other than minor repairs to cars habitually stored in the proposed building?

APPROVALS BY: DATE MISCELLANEOUS Will work require disturbing of any tree on a public street? no

BUILDING INSPECTION—PLAN EXAMINER ZONING: Will there be in charge of the above work a person competent

BUILDING CODE: to see that the State and City requirements pertaining thereto

Fire Dept.: are observed?

Health Dept.:

Others:

Signature of Applicant Evalina Dyer Phone # same

Type Name of above 100 200 300 400

Other and Address

FIELD INSPECTOR'S COPY

APPLICANT'S COPY

OFFICE FILE COPY

APPLICATION FOR PERMIT

PERMIT ISSUED

SEP 26 1984

B.O.C.A. USE GROUP

B.O.C.A. TYPE OF CONSTRUCTION

ZONING LOCATION PORTLAND, MAINE Sept. 26, 1984

To the CHIEF OF BUILDING & INSPECTION SERVICES, PORTLAND, MAINE

CITY OF PORTLAND

The undersigned hereby applies for a permit to erect, alter, repair, demolish, move or install the following building, structure, equipment or change use in accordance with the Laws of the State of Maine, the Portland B.O.C.A. Building Code and Zoning Ordinance of the City of Portland with plans and specifications, if any, submitted herewith and the following specifications:

- LOCATION 109-C-B 12 Cliff Island
1. Owner's name and address Robert Howard - same
2. Lessee's name and address
3. Contractor's name and address Owner

Proposed use of building Walling
Last use same
Material No. stories Heat Style of roof Roofing
Other buildings on same lot
Estimated contractual cost \$ 1,000

FIELD INSPECTOR-Mr. @ 775-5451

Appeal Fees \$
Base Fee \$ 5.00
Late Fee \$ 1.00
TOTAL \$

To construct open deck on front and side of dwelling 24' x 10' with 34' x 4' as per plans. 4 sheets of plans.

Stamp of Special Conditions

04019

NOTE TO APPLICANT: Separate permits are required by the installers and subcontractors of heating plumbing, electrical and mechanicals.

DETAILS OF NEW WORK

- Is any plumbing involved in this work?
Is any electrical work involved in this work? NO
Is connection to be made to public sewer?
Has septic tank notice been sent?
Height average grade to top of plate
Solid or filled land? earth or rock?
Material of foundation Thickness, top bottom cellar
Kind of roof Rise per foot Roof covering
No. of chimneys Material of chimneys of lining Kind of heat fuel
Framing Lumber--Kind Dressed or full size? Corner posts Sills
Size Girder Columns under girders Size Max. on centers
Studs (outside walls and carrying partitions) 2x4-16" C. C. Bridging in every floor and flat roof span over 8 feet.
Joists and rafters 1st floor 2nd 3rd roof
On centers: 1st floor 2nd 3rd roof
Maximum span: 1st floor 2nd 3rd roof
If one story building with masonry walls, thickness of walls? height?

IF A GARAGE

No. cars now accommodated on same lot, to be accommodated number commercial cars to be accommodated
Will automobile repairing be done other than minor repairs to cars habitually stored in the proposed building?

APPROVALS BY: BUILDING INSPECTION-PLAN EXAMINER
ZONING:
BUILDING CODE:
Fire Dept.:
Health Dept.:
Others:

Will work require disturbing of any tree on a public street?
Will there be in charge of the above work a person competent to see that the State and City requirements pertaining thereto are observed? YES

Signature of Applicant Robert Howard
Type Name of above Robert Howard
Phone # 5858
Other and Address

FIELD INSPECTOR'S COPY

APPLICANT'S COPY

OFFICE FILE COPY



APPLICATION FOR PERMIT
DEPARTMENT OF BUILDING INSPECTIONS SERVICES
ELECTRICAL INSTALLATIONS

Date Aug 27 19 86
 Receipt and Permit number D 24475

To the CHIEF ELECTRICAL INSPECTOR, Portland, Maine:

The undersigned hereby applies for a permit to make electrical installations in accordance with the laws of Maine, the Portland Electrical Ordinance, the National Electrical Code and the following specifications:

LOCATION OF WORK: Adjacent to Pitkin residence, Cliff Island

OWNER'S NAME: August Whales Inc. ADDRESS: Cliff Isl, Me.

	FEES
OUTLETS:	
Rec. outlets _____ Switches _____ Plugmold _____ ft. TOTAL _____	
FIXTURES: (number of)	
Incandescent _____ Fluorescent _____ (not strip) TOTAL _____	
Strip Fluorescent _____ ft. _____	
SERVICES:	
Overhead _____ Underground _____ Temporary <u>x</u> TOTAL amperes <u>200</u>	3.00
METERS: (number of) <u>1</u>	<u>5.50</u>
MOTORS: (number of)	
Fractional _____	
1 HP or over _____	
RESIDENTIAL HEATING:	
Oil or Gas (number of units) _____	
Electric (number of rooms) _____	
COMMERCIAL OR INDUSTRIAL HEATING:	
Oil or Gas (by a main boiler) _____	
Oil or Gas (by separate units) _____	
Electric Under 20 kws _____ Over 20 kws _____	
APPLIANCES: (number of)	
Ranges _____	Water Heaters _____
Cook Tops _____	Disposals _____
Wall Ovens _____	Dishwashers _____
Dryers _____	Compactors _____
Fans _____	Others (denote) _____
TOTAL _____	
MISCELLANEOUS: (number of)	
Branch Panels _____	
Transformers _____	
Air Conditioner: Central Unit _____	
Separate Units (windows) _____	
Signs 20 sq. ft. and under _____	
Over 20 sq. ft. _____	
Swimming Pools Above Ground _____	
In Ground _____	
Fire/Burglar Alarms Residential _____	
Commercial _____	
Heavy Duty Outlets, 220 Volt (such as welders) 30 amps and under _____	
over 30 amps _____	
Circus, Fairs, etc. _____	
Alterations to wires _____	
Repairs after fire _____	
Emergency Lights, battery _____	
Emergency Generators _____	

FOR ADDITIONAL WORK NOT ON ORIGINAL PERMIT INSTALLATION FEE DUE: _____
 FOR REMOVAL OF A "STOP ORDER" (304-16 b) DOUBLE FEE DUE: _____
 TOTAL AMOUNT DUE: 3.50
 min 5.00

INSPECTION: Will be ready on Aug 27 19 86 or Will Call xxx
 CONTRACTOR'S NAME: Seacoast Elec
 ADDRESS: 26 Union Wharf
 TEL: 774-6179
 MASTER LICENSE NO: 03098 SIGNATURE OF CONTRACTOR: [Signature]
 LIMITED LICENSE NO: _____

INSPECTOR'S COPY — WHITE
 OFFICE COPY — CANARY
 CONTRACTOR'S COPY — GREEN

ELECTRICAL INSTALLATIONS

Permit Number 24975

Location Cliff Island,

Owner August Whales

Date of Permit 8/27/86

Final Inspection 8/27/86

By Inspector D. P. [Signature]

Permit Application Register Page No. 120

INSPECTIONS: Service 200 amp by R. [Signature]
Service called in 8/27/86
Closing-in _____ by _____

PROGRESS INSPECTIONS 8/27/86 _____ /
6/25/87 _____ /
_____/_____
_____/_____
_____/_____
_____/_____

DATE:	REMARKS:

Ad J. T. [Signature] the Philip Residence.

COMPLETED
DATE 6/25/87 DR



APPLICATION FOR PERMIT
DEPARTMENT OF BUILDING INSPECTIONS SERVICES
ELECTRICAL INSTALLATIONS

Date July 3, 19 85
 Receipt and Permit number D 04090

To the CHIEF ELECTRICAL INSPECTOR, Portland, Maine:
 The undersigned hereby applies for a permit to make electrical installations in accordance with the laws of
 Maine, the Portland Electrical Ordinance, the National Electrical Code and the following specifications:

LOCATION OF WORK: 109-A-C- 20 Cliff Island
 OWNER'S NAME: Pick Lee ADDRESS: lives there

OUTLETS:	FEEES
Receptacles _____ Switches _____ Plugmold _____ ft TOTAL _____	
FIXTURES: (number of)	
Incandescent _____ Flourescent _____ (not strip) TOTAL _____	
Strip Flourescent _____ ft _____	
SERVICES:	
Overhead <input checked="" type="checkbox"/> Underground _____ Temporary _____ TOTAL amperes: <u>100</u> ..	<u>3.00</u>
METERS: (number of) <u>1</u> ..	<u>.50</u>
MOTORS: (number of)	
Fractional _____	
1 HP or over _____	
RESIDENTIAL HEATING:	
Oil or Gas (number of units) _____	
Electric (number of rooms) _____	
COMMERCIAL OR INDUSTRIAL HEATING:	
Oil or Gas (by a main boiler) _____	
Oil or Gas (by separate units) _____	
Electric Under 20 kws _____ Over 20 kws _____	
APPLIANCES: (number of)	
Ranges _____	Water Heaters _____
Cook Tops _____	Disposals _____
Wall Ovens _____	Dishwashers _____
Dryers _____	Compactors _____
Fans _____	Others (denote) _____
TOTAL _____	
MISCELLANEOUS: (number of)	
Branch Panels _____	
Transformers _____	
Air Conditioners Central Unit _____	
Separate Units (windows) _____	
Signs 20 sq. ft. and under _____	
Over 20 sq. ft. _____	
Swimming Pools Above Ground _____	
In Ground _____	
Fire/Burglar Alarms Residential _____	
Commercial _____	
Heavy Duty Outlets, 220 Volt (such as welders) 30 amps and under _____	
over 30 amps _____	
Circus, Fairs, etc. _____	
Alterations to wires _____	
Repairs after fire _____	
Emergency Lights, battery _____	
Emergency Generators _____	

FOR ADDITIONAL WORK NOT ON ORIGINAL PERMIT INSTALLATION FEE DUE: _____
 FOR REMOVAL OF A "STOP ORDER" (304-16.b) DOUBLE FEE DUE: _____
 TOTAL AMOUNT DUE: 3.50
 min 5.00

INSPECTION: Will be ready on ready, 19 85; or Will Call _____
 CONTRACTOR'S NAME: Robert Niles
 ADDRESS: 15 1. Ave. Peaks Isl.
 TEL: _____
 MASTER LICENSE NO.: 2576 SIGNATURE OF CONTRACTOR: _____
 LIMITED LICENSE NO.: _____

INSPECTOR'S COPY — WHITE
 OFFICE COPY — CANARY
 CONTRACTOR'S COPY — GREEN

ELECTRICAL INSTALLATIONS —

Permit Number 04098

Location 109-A-C-20

Owner R. Roe

Date of Permit 7-3-85

Final Inspector C. J. AF1

By Inspector D. P. [unclear]

Permit Application Register Page No. 76

Clay [unclear]

[Signature]

INSPECTIONS: Service 100 Amp by [Signature]
Service called in 7/3/85
Closing-in _____ by _____

PROGRESS INSPECTIONS: 7/3/85 _____
6/25/87 _____

DATE:	REMARKS:
<u>6/25/87</u>	<u>Completed</u>

CODE
COMPLIANCE
COMPLETED
DATE 6/25/87 DR

B



APPLICATION FOR AMENDMENT TO PERMIT

Amendment No. 1
Portland, Maine, July 15, 1987

PERMIT ISSUED

JUL 15 - 1987

City Of Portland

To the INSPECTOR OF BUILDINGS, PORTLAND, MAINE

The undersigned hereby applies for amendment to Permit No. 151/237 pertaining to the building or structure comprised in the original application in accordance with the Laws of the State of Maine, the Building Code and Zoning Ordinance of the City of Portland, plans and specifications, if any, submitted herewith, and the following specifications:

Location 109-A-1-5th Cliff Island, ME Within Fire Limits? Dist. No.

Owner's name and address Rick and Loris Olney - Cape Telephone 765-4453

Lessee's name and address Telephone

Contractor's name and address Robert Howard & Sons - Cliff Island Telephone 766-2950

Architect Plans filed No. of sheets

Proposed use of building single family dwelling No. families

Last use boat shed No. families

Increased cost of work 45,000 Additional fee \$250.00

Description of Proposed Work

change of use from boat shed to single family dwelling

DEP Permit approval on file - Public Works

Details of New Work

Is any plumbing involved in this work? Is any electrical work involved in this work?

Height average grade to top of plate Height average grade to highest point of roof

Size, front depth No. stories solid or filled land? earth or rock?

Material of foundation Thickness, top bottom cellar

Material of underpinning Height Thickness

Kind of roof Rise per foot Roof covering

No. of chimneys Material of chimneys of lining

Framing lumber—Kind Dressed or full size?

Corner posts Sills Girt or ledger board? Size

Girders Size Columns under girders Size Max. on centers

Studs (outside walls and carrying partitions) 2x4-16" O. C. Bridging in every floor and flat roof span over 8 feet.

Joists and rafters: 1st floor 2nd 3rd roof

On centers: 1st floor 2nd 3rd roof

Maximum span: 1st floor 2nd 3rd roof

Approved:

Signature of Owner

INSPECTION COPY

Approved:

Inspector of Buildings

FILE COPY

APPLICANT'S COPY

ASSessor's COPY



APPLICATION FOR PERMIT
 DEPARTMENT OF BUILDING INSPECTIONS SERVICES
 ELECTRICAL INSTALLATIONS

Date July 7, 1984
 Receipt and Permit number 21497

To the CHIEF ELECTRICAL INSPECTOR, Portland, Maine:

The undersigned hereby applies for a permit to make electrical installations in accordance with the laws of Maine, the Portland Electrical Ordinance, the National Electrical Code and the following specifications:

LOCATION OF WORK: Lot 190C-A-52 Cliff Island
 OWNER'S NAME: John Ryan ADDRESS: Cliff Island

FEE\$

OUTLETS:

Receptacles _____ Switches _____ Plugmold _____ ft. TOTAL _____

FIXTURES: (number of)

Incandescent _____ Fluorescent _____ (not strip) TOTAL _____

Strip Fluorescent _____ ft. _____

SERVICES:

Overhead Underground _____ Temporary _____ TOTAL amperes 200 3.00

METERS: (number of) 1 _____ .50

MOTORS: (number of)

Fractional _____

1 HP or over _____

RESIDENTIAL HEATING:

Oil or Gas (number of units) _____

Electric (number of rooms) _____

COMMERCIAL OR INDUSTRIAL HEATING:

Oil or Gas (by a main boiler) _____

Oil or Gas (by separate units) _____

Electric Under 20 kws _____ Over 20 kws _____

APPLIANCES: (number of)

Ranges _____ Water Heaters _____

Cook Tops _____ Disposals _____

Wall Ovens _____ Dishwashers _____

Dryers _____ Compactors _____

Fans _____ Others (denote) _____

TOTAL _____

MISCELLANEOUS: (number of)

Branch Panels _____

Transformers _____

Air Conditioners Central Unit _____

Separate Units (windows) _____

Signs 20 sq. ft. and under _____

Over 20 sq. ft. _____

Swimming Pools Above Ground _____

In Ground _____

Fire/Burglar Alarms Residential _____

Commercial _____

Heavy Duty Outlets, 220 Volt (such as welders) 30 amps and under _____

over 30 amps _____

Circus, Fairs, etc. _____

Alterations to wires _____

Repairs after fire _____

Emergency Lights, battery _____

Emergency Generators _____

INSTALLATION FEE DUE:

FOR ADDITIONAL WORK NOT ON ORIGINAL PERMIT DOUBLE FEE DUE:

FOR REMOVAL OF A "STOP ORDER" (304-16.b)

TOTAL AMOUNT DUE: 5.00 min.

INSPECTION:

Will be ready on _____, 19__; or Will Call

CONTRACTOR'S NAME: Thomas Wright

ADDRESS: Cliff Island

TEL: _____

MASTER LICENSE NO.: 534 (7A02M2) SIGNATURE OF CONTRACTOR: _____

LIMITED LICENSE NO.: _____

INSPECTOR'S COPY — WHITE
 OFFICE COPY — CANARY
 CONTRACTOR'S COPY — GREEN

ELECTRICAL INSTALLATIONS -

Permit Number 21497

Location Lot 1900-A-52

Owner J. Ryan

Date of Permit 7-2-84

Final Inspection 6/25/87

By Inspector D. R. [unclear]

Permit Application Register Page No 38

(Vertical signature)

INSPECTIONS. Service by [Signature]
Service called in 7-18-84
Closing-in by

PROGRESS INSPECTIONS 7-19-84 / / / /
 / / / /
 / / / /
 / / / /
 / / / /

DATE:	REMARKS:
6/25/87	Completed

6/25/87 DR

APR 30, 1987

PERMIT # ... BUILDING PERMIT APPLICATION **Portland** Previous permit # ...
APPLICANT FILL OUT I - VIII AND DETAILS OF WORK ON REVERSE
Please insert N/A (not applicable) for any item not pertaining to your request

I. GENERAL INFORMATION

Location/address of construction 109- Dew Hill Southwest Side Cliff Island
Owner or lessee's name Bykov & Aalha Oum Tel 761-4514 H
Address 9 Tate St. - V 766-2277 Tel. home
Contractor's name Owner Tel _____
Address _____

Subcontractors: _____
PERMIT ISSUED
MAY 5 1987

II. NEW SUBDIVISION OR EXISTING LOT REFERENCE
Name _____
Lot _____
Block _____
Bk: & pg: Reg. / deeds _____
Date recorded _____

III. PROPOSED USE: CODE: 114 If other: Storage shed Explain Storage shed Seasonal Condominium Apartment

IV. PAST USE: _____
V. OWNERSHIP: PUBLIC (Federal/State/local government) PRIVATE (Individual/corp/nonprofit)

VI. DESCRIPTION OF WORK:

to erect 16 x 24 storage shed as per plans. 1 sheet of plans.

VII. BUILDING DIMENSIONS: length _____ width _____ square footage _____ height _____ *stories _____

VIII. EST. CONSTRUCTION COST: _____ **IX. AGR. SOURCE OF LAND:** _____ **X. BUILDING:** _____

X. RESIDENTIAL BUILDINGS ONLY: _____ **BE ROOMS:** _____
1 BDRM _____ 2 BDRMS _____ 3 BDRMS _____
NEW DWELLING UNITS WITH _____
EXISTING DWELLING UNITS WITH _____

XI. RESIDENTIAL UNITS:
NEW DWELLINGS _____
EXISTING DWELLINGS _____
NET RESIDENTIAL UNITS _____

XII. SIGNATURE OF APPLICANT: _____ **DATE:** _____

DO NOT WRITE BELOW THIS LINE

XIII. ZONING:
DISTRICT _____ STREET FRONTAGE _____
SETBACKS: front _____ back _____ side _____
ZONING BOARD APPROVAL: no yes (date) _____
PLANNING BOARD APPROVAL: no yes (date) _____

XIV. OFFICE USE:
TAX MAP _____
LOT # _____
VALUE/STRUCTURE _____
PERMIT EXPIRATION _____

XV. CONDITIONAL USE: variance _____ site plan _____ subdivision _____ shore and flood plain mgmt _____
special exception _____ other _____ (explain) _____

XVI. SIGNATURE OF FIELD INSPECTOR (CEO): _____ **DATE:** _____

XVII. FEES:
base fee _____
subdivision fee _____
site plan review fee _____
other fees _____
late fee _____
TOTAL ... 45.00

XVIII. SPACE FOR FIGURING / ADDITIONAL COMMENTS:

1. WATER SUPPLY <input type="checkbox"/> public <input type="checkbox"/> private	8. CHIMNEY * flues * fireplaces
2. SEWER <input type="checkbox"/> public <input type="checkbox"/> private, type	material
3. HEAT type fuel	9. FRAMING, floor joists
4. FOUNDATION type	size max on centers
5. ROOF type thickness roofing	ceiling joists
covering pitch load	rafters
6. PLUMBING # tubs # showers	studs
# lavatories # laundry tubs	wall studs
# flushes # other	10. If 1-story building w/ masonry walls.
SPRINKLER SYSTEM? <input type="checkbox"/> yes <input type="checkbox"/> no	wall thickness height
7. ELECTRICAL service entrance size	11. BEDROOM WINDOWS
# smoke detectors	height width sill height
NUMBER OF OFF-STREET PARKING SPACES:	egress window? <input type="checkbox"/> yes <input type="checkbox"/> no
enclosed outdoors	

PLOT PLAN/DETAILS OF WORK ON REVERSE
White - Municipal Office
V low - CEO
Pink - Tax Assessor
Gold - GPCUJ

As I think,
we're going
to have to
investigate

Tom WRIGHT
Po Box 25
CLIFF ISLAND 04019
773 3625 (6)

RECEIVED

OCT 25 1990

10-22-90

DEPT OF BUILDING INSPECTIONS
CITY OF PORTLAND

in writing to inform
inspections department
that the owners of the lot next to
mine on Cliff Island have completely
renovated an old cottage and built an
addition on the front with a deck,
that has no regard for the set back
requirements from the water. I asked
when they built it how they got a permit.
Since then they have built an additional
building and cleared the lot.

I realize the difficulty of
keeping track of island projects and understand
the slightly more liberal position that
must be taken. I also believe that
the set back requirements are important
to observe, at least reflect upon,
before building. The set back requirements
from the water is certainly one of
the best ways to preserve our waterfront.

Thank you for your interest
in this matter.

Sincerely, Tom Wright

Arthur,
We're going
to have to
investigate

RECEIVED

OCT 25 1990

DEPT OF BUILDING INSPECTIONS
CITY OF PORTLAND

Tom Wright
Po Box 25
CLIFF ISLAND 04019
773 3625 (6)

10-22-90

in writing to inform
inspections department
that the owners of the lot next to
mine on Cliff Island have completely
renovated an old cottage and built an
addition on the front with a deck,
that has no regard for the set back
requirements from the water. I asked
when they built it how they got a permit.
Since then they have built an additional
building and cleared the lot.

I realize the difficulty of
keeping track of island projects and understand
the slightly more liberal position that
must be taken. I also believe that
the set back requirements are important
to observe, at least reflected upon,
before building. The set back requirements
from the water is certainly one of
the best ways to preserve our waterfront.

Thank you for your interest
in this matter.

Sincerely, Tom Wright