

ISLAND AVIATION  
92-F-14

PEAKS ISLAND

80-0000 #  
SMAV-100  
PEAKS ISLAND

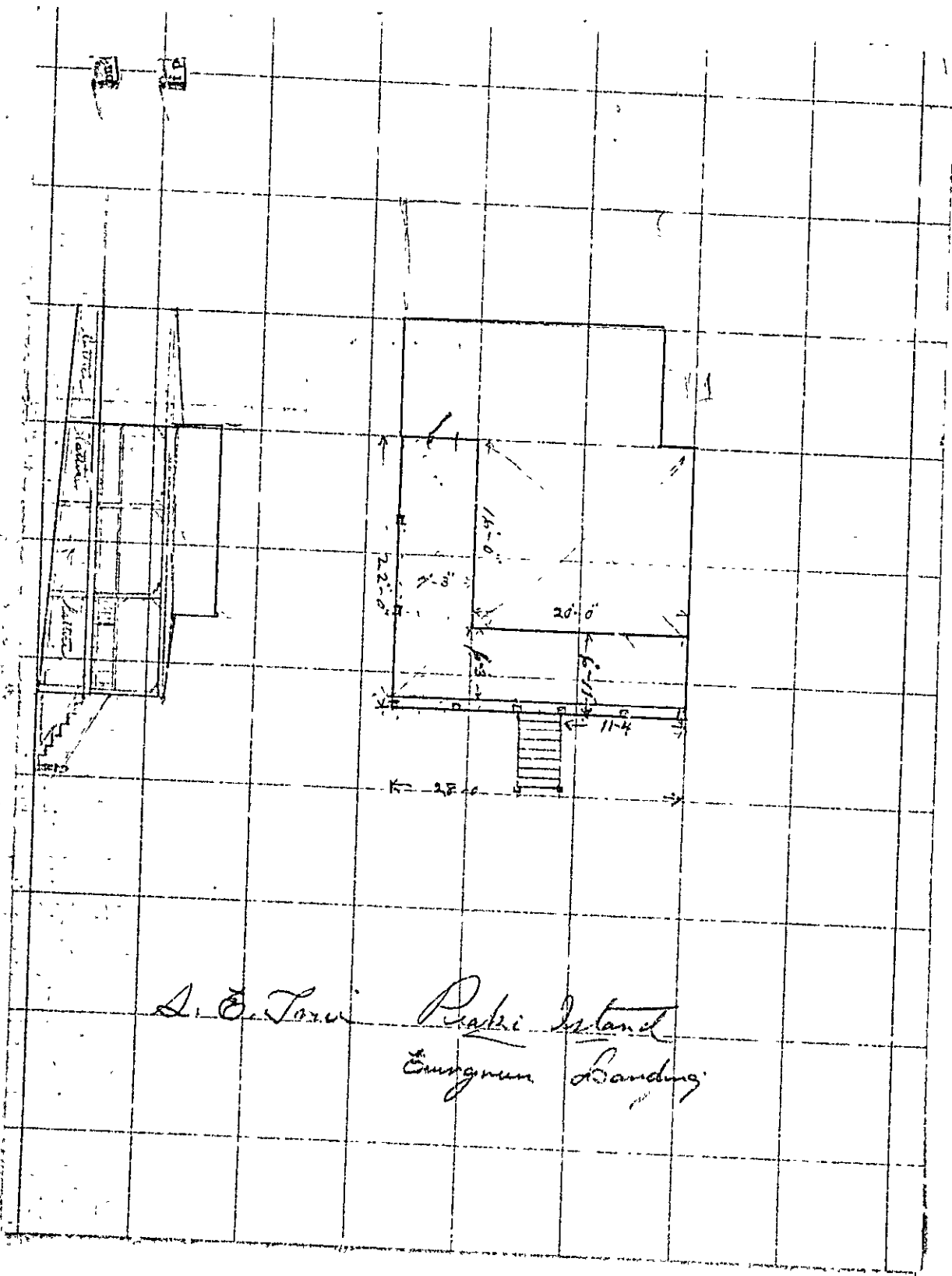

A. E. Toru Peaki Island  
Emergenc Landing



APARTMENT HOUSE  
APPLICATION FOR PERMIT

ISSUED  
Permit No. 13637

Class of Building or Type of Structure Third Class JUN 29 1938

Portland, Maine, June 19, 1938

To the INSPECTOR OF BUILDINGS, PORTLAND, ME.

The undersigned hereby applies for a permit to erect and install the following building structure, equipment in accordance with the Laws of the State of Maine, the Building Code of the City of Portland, plans and specifications, if any, submitted herewith and the following specifications:

Location Island Avenue, Peaks Island Within Fire Limits? no Dist. No. \_\_\_\_\_

Owner's or Lessee's name and address S. E. Trus, Peaks Island Telephone \_\_\_\_\_

Contractor's name and address Gooding & Clark, 48 Portland Street Telephone 2-5163

Architect \_\_\_\_\_ Plans filed yes No. of sheets 1

Proposed use of building Cottage No. families \_\_\_\_\_

Other buildings on same lot \_\_\_\_\_

Estimated cost \$ 100. Fee \$ .75

Description of Present Building to be Altered

Material Frame No. stories 1 Heat \_\_\_\_\_ Style of roof flat Roofing asphalt roofing

Last use Cottage No. families \_\_\_\_\_

General Description of New Work

To enlarge front portion of piazza from 6' 3" to 5' 11", 28' long  
To cover this portion of roof with asphalt roofing Class C Und. Lab.

92  
F  
14

It is understood that this permit does not include installation of heating apparatus which is to be taken out separately by and to the heating contractor.

NOTIFICATION BEFORE LEAVING OR CLOSING OF BUSINESS  
DATE OF OCCUPANCY  
PERMIT NO. 13637

Details of New Work

Size, front 28' depth 6' 11" No. stories 1 Height average grade to top of plate \_\_\_\_\_

To be erected on solid or filled land? solid earth or rock? earth and rock

Material of foundation cedar posts Thickness, top \_\_\_\_\_ bottom \_\_\_\_\_ center \_\_\_\_\_

Material of underpinning \_\_\_\_\_ Height \_\_\_\_\_ Thickness \_\_\_\_\_

Kind of Roof flat Rise per foot 1/2" Roof covering asphalt roofing Class C Und. Lab.

No. of chimneys \_\_\_\_\_ Material of chimneys \_\_\_\_\_ of lining \_\_\_\_\_

Kind of heat \_\_\_\_\_ Type of fuel \_\_\_\_\_ Is gas fitting involved? \_\_\_\_\_

Framing Lumber - Kind spruce Dressed or Full Size full size

Corner posts 4x4 Sills 4x8 Girder or ledger board? \_\_\_\_\_ Size \_\_\_\_\_

Material columns, under girders \_\_\_\_\_ Size \_\_\_\_\_ Max. on centers \_\_\_\_\_

Studs (outside walls and carrying partitions) 2x4-16" O. C. Girders 6x8 or larger Bridging in every floor and flat roof span over 8 feet. Sills and corner posts all one piece in cross section.

Joists and rafters: 1st floor 2x8, 2nd \_\_\_\_\_, 3rd \_\_\_\_\_, roof 2x4

On centers: 1st floor 18", 2nd \_\_\_\_\_, 3rd \_\_\_\_\_, roof 120"

Maximum span: 1st floor 10', 2nd \_\_\_\_\_, 3rd \_\_\_\_\_, roof 0' 11"

If one story building with masonry walls, thickness of walls? \_\_\_\_\_ height? \_\_\_\_\_

If a Garage

No. cars now accommodated on same lot \_\_\_\_\_ to be accommodated \_\_\_\_\_

Total number commercial cars to be accommodated \_\_\_\_\_

Will automobile repairing be done other than minor repairs to cars habitually stored in the proposed building? \_\_\_\_\_

Miscellaneous

Will above work require removal or disturbing of any shade trees on a public street? no

Will there be in charge of the above work a person competent to see that the State and City requirements pertaining thereto are observed? yes

INSPECTION COPY

Signature of owner E. J. Trus

Gooding & Clark

2-26-38

Permit No. 38/965  
 Loc. Island on Beach  
 Owner E. True  
 Date 6/30/38  
 Notif. closing-in \_\_\_\_\_  
 Inspn. closing-in \_\_\_\_\_  
 Final Notif. \_\_\_\_\_  
 Final Inspn. 7/21/38? JDO  
 Cert. of Occupancy issued None

NOTES

		92
		F
		114

~~376 at the same place  
 about 100 ft from  
 the shore of the  
 beach of the  
 island of the  
 same name  
 in the  
 same place~~

92-F-111

3  
1



Location, Ownership and detail must be correct, complete and legible.  
**YOU!** Separate application required for every building.  
Plans must be filed with this application.

are responsible for complying with the law, whether you know the requirements or not.  
**Application for Permit for Alterations, etc.**

Portland, Me., June 5, 1925 19

This Application and  
Get All Questions Settled  
BEFORE Commencing Work.

To the Failure To Do So  
INSPECTOR OF BUILDINGS:  
May Prove

**EXPLANATION** The undersigned applies for a permit to alter the following described building:—

Location Island Ave, Peaks Island Ward 1 in fire-limits? No

Name of Owner or Lessee, F W Hooper & S E True Address 36 Florence St

" " Contractor, J F Stimpson " Peaks Island

" " Architect, .....

Material of Building is wood Style of Roof, pitch Material of Roofing, asphalt

Size of Building is ..... feet long; ..... feet wide. No. of Stories, .....

Collar Wall is constructed of ..... is ..... inch s wide on bottom and batters to ..... inches on top.

Underpinning is ..... is ..... inch thick; is ..... feet in height.

Height of Building ..... Wall, if Brick; 1st, ..... 2d, ..... 3d, ..... 4th, ..... 5th, .....

What was Building last used for? cottage No. of Families? 1

What will Building now be used for? cottage 1 family

**Detail of Proposed Work**

Build addition 9x16 feet one story high

all to comply with the building ordinances

.....

.....

..... Estimated Cost \$ 100.

**If Extended On Any Side**

Size of Extension, No. of feet long? .....; No. of feet wide? .....; No. of feet high above sidewalk? .....

No. of Stories high? .....; Style of Roof? .....; Material of Roofing? .....

Of what material will the Extension be built? ..... Foundation? .....

If of Brick, what will be the thickness of External Walls? ..... inches; and Party Walls ..... inches.

How will the extension be occupied? ..... How connected with Main Building? .....

**When Moved, Raised or Built Upon**

No. of Stories in height when Moved, Raised, or Built upon? ..... Proposed Foundations? .....

No. of feet high from level of ground to highest part of Roof to be? .....

How many feet will the External Walls be increased in height? ..... Party Walls .....

.....

.....

**If Any Portion of the External or Party Walls Are Removed**

Will an opening be made in the Party or External Walls? ..... in ..... Story.

Size of the opening? ..... How protected? .....

How will the remaining portion of the wall be supported? .....

Signature of Owner or Authorized Representative Fred W. Hooper

Address 36 Florence St

PERMIT MUST BE OBTAINED BEFORE BEGINNING WORK

1774



Island Ave. Peaks

June 5/68

927-14-46  
8577  
H.W. H.

NOV 1968

U.S. POSTAGE