

APPLICATION FOR PERMIT

PERMIT ISSUED

B.O.C.A. USE GROUP 1059

B.O.C.A. TYPE OF CONSTRUCTION

SEP 18 1985

ZONING LOCATION PORTLAND, MAINE Aug. 13, 1985

City of Portland

To the CHIEF OF BUILDING & INSPECTION SERVICES, PORTLAND, MAINE

The undersigned hereby applies for a permit to erect, alter, repair, demolish, move or install the following building, structure, equipment or change use in accordance with the Laws of the State of Maine, the Portland B.O.C.A. Building Code and Zoning Ordinance of the City of Portland with plans and specifications, if any, submitted herewith and the following specifications:

LOCATION 91-P-9, Reed Ave., Peaks Island Fire District #1 #2
1. Owner's name and address Francis O'Leary, 19 Hillcroft Rd., Jamaica Plain, Mass 02130 Telephone

2. Lessee's name and address Telephone
3. Contractor's name and address same Telephone

Proposed use of building sin. fam. No. of sheets
Last use vacant lot No. families
Material No. stories Heat Style of roof Roofing

Estimated contractual cost \$ 25,000.00

FIELD INSPECTOR--Mr. @ 775-5451

Appeal Fees \$
Base Fee ... 50.00 Site Plan.
Late Fee
TOTAL \$ 145.00
\$195.00

To construct single Family, 26' x 36', no garage, as per plan. Also, Site Plan Review.

Stamp of Special Conditions

ISSUE PERMIT TO #1

NOTE TO APPLICANT. Separate permits are required by the installers and subcontractors of heating, plumbing, electrical and mechanicals.

DETAILS OF NEW WORK

Is any plumbing involved in this work? yes Is any electrical work involved in this work? yes
Is connection to be made to public sewer? no If not, what is proposed for sewage? septic system
Has septic tank notice been sent? yes Form notice sent? yes
Height average grade to top of plate 22' 12" Height average grade to highest point of roof 22'
Size, front 36' depth 26' No. stories 1 1/2 solid or filled land? solid earth or rock? both
Material of foundation posts Thickness 12" footing 8" posts no
Kind of roof pitch Rise per foot 9 1/2, 12 Roof covering asphalt shingle
No. of chimneys 2 Material of chimneys of lining Kind of heat none fuel
Framing Lumber--Kind spruce Dressed or full size? dressed Corner posts 4x4 Sills 2x6
Size Girder 2x10 three Columns under girders lally Size 3 1/2 Max. on centers 16' 8"
Studs (outside walls and carrying partitions) 2x4-16" O. C. Bridging in every floor and flat roof span over 8 feet.
Joists and rafters: 1st floor 2x6 2nd 3rd roof 2x8
On centers: 1st floor 16" 2nd 3rd roof 16"
Maximum span: 1st floor 8' 2nd 3rd roof 13'
If one story building with masonry walls, thickness of walls? height?

IF A GARAGE

No. cars now accommodated on same lot to be accommodated number commercial cars to be accommodated
Will automobile repairing be done other than minor repairs to cars habitually stored in the proposed building?

APPROVALS BY: DATE
BUILDING INSPECTION--PLAN EXAMINER
ZONING:
BUILDING CODE:
Fire Dept.:
Health Dept.:
Others:

MISCELLANEOUS
Will work require disturbing of any tree on a public street? NO.
Will there be in charge of the above work a person competent to see that the State and City requirements pertaining thereto are observed? yes.

Signature of Applicant [Signature] Phone # 624-0387
Type Name of above Francis H. O'Leary 1 2 3 4
Other and Address

FIELD INSPECTOR'S COPY

APPLICANT'S COPY

OFFICE FILE COPY

SUBSURFACE WASTEWATER DISPOSAL SYSTEM APPLICATION

Department of Human Services
Division of Health Engineering

Town, City, Parish
PORTLAND PEAKS ISLAND REED AVENUE

Street, Road, Subdivision
FRANCIS O'LEARY

Owners Name

SUBSURFACE WASTEWATER DISPOSAL PLAN

Scale 1" = 20'

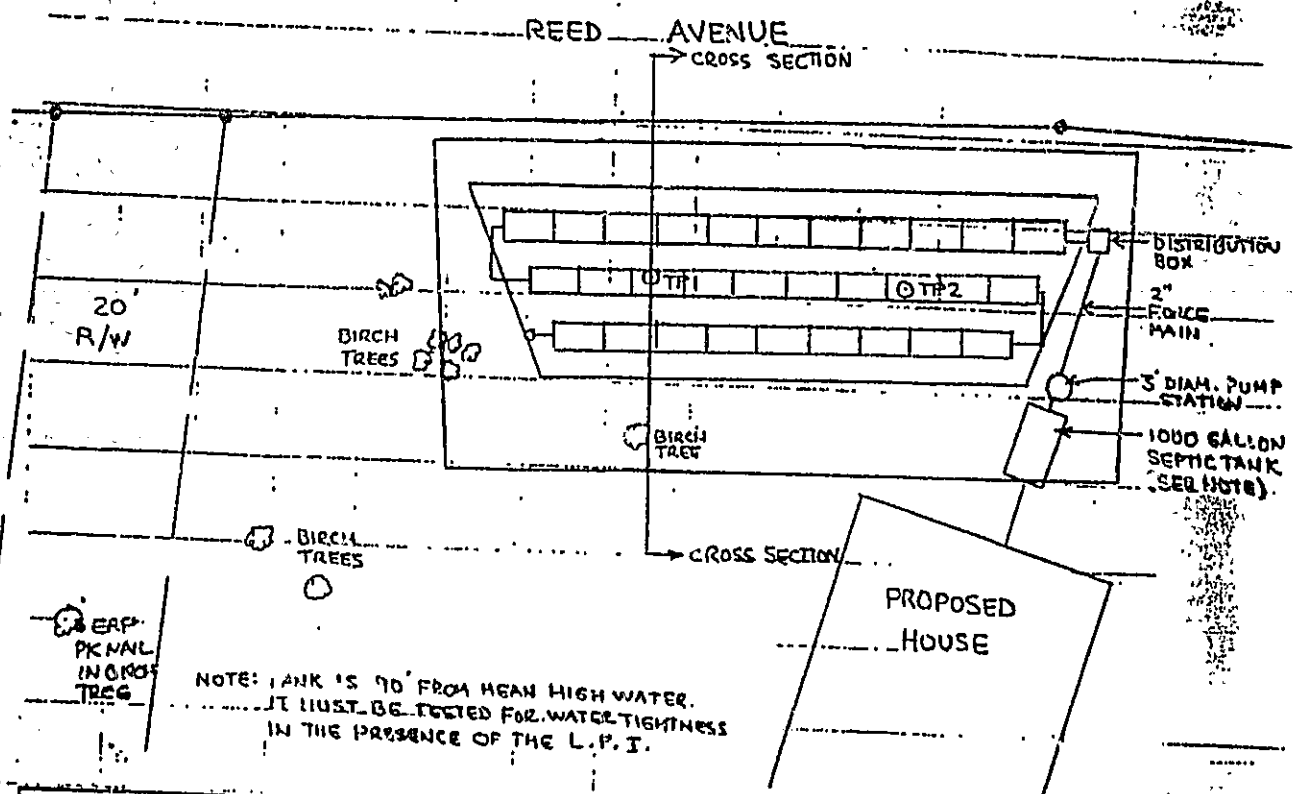

FILL REQUIREMENTS		CONSTRUCTION ELEVATIONS		ELEVATION REFERENCE POINT LOCATION & DESCRIPTION PK IN BIRCH TREE IN 20' RIGHT OF WAY
Depth of Fill (Upslope)	24'	Reference Elevation is	25.84	
Depth of Fill (Downslope)	24'	Bottom of Disposal Area	SEE X-SECTION	
		Top of Distribution Lines or Chambers		SEE X-SECTION

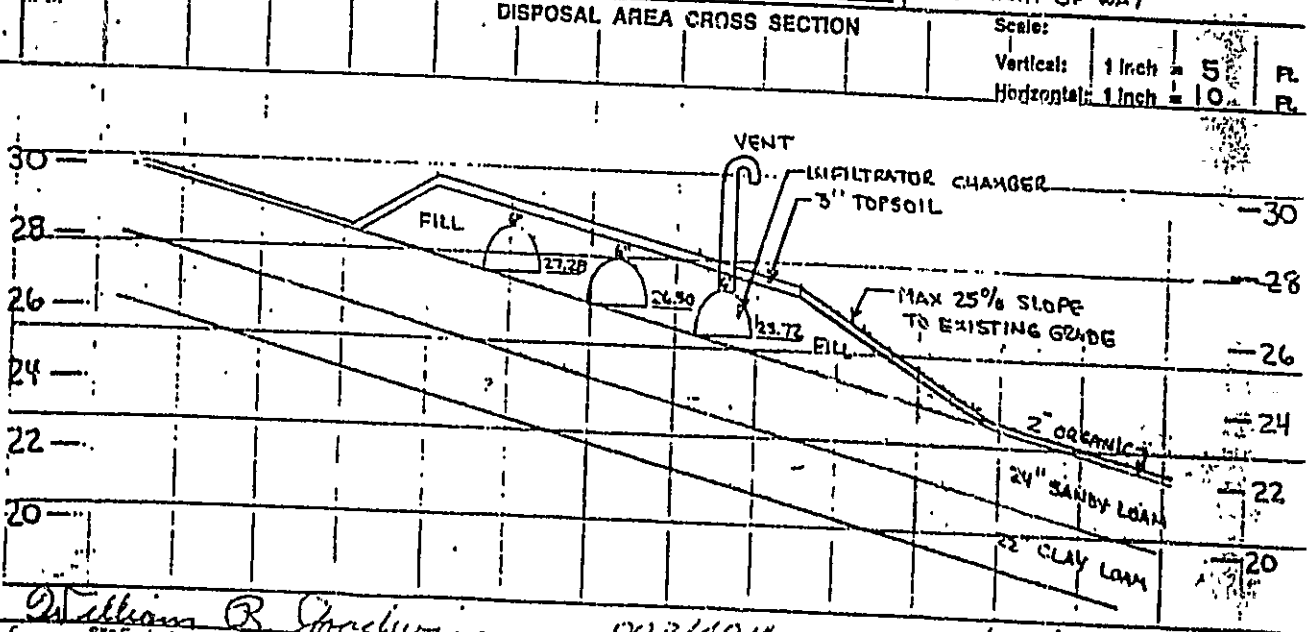

William B. Anderson
Site Evaluator or Professional Engineer's Signature

00.3/4919

2.12.11

SUBSURFACE WASTEWATER DISPOSAL SYSTEM APPLICATION

Department of Human Services
Division of Health Engineering

Town, City, or Village

PORTLAND PEAKS ISLAND

Street, Road, Subdivision

REED AVENUE

Owners Name

FRANCIS O'LEARY

SITE PLAN

Scale 1" = 100' FL

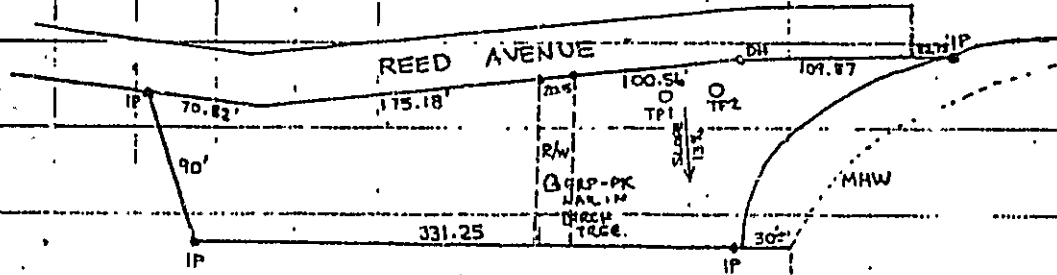
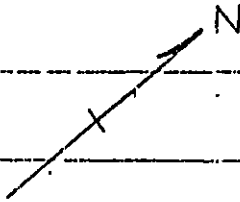
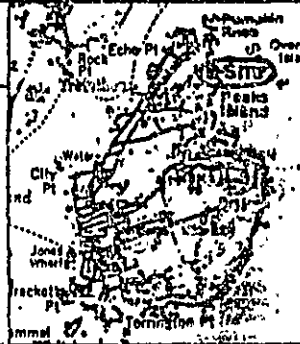

SOIL DESCRIPTION AND CLASSIFICATION (Location of Observation Holes Shown Above)

Observation Hole 2 Test Pit Boring

Depth of Organic Horizon Above Mineral Soil

DEPTH BELOW MINERAL SOIL SURFACE (Inches)	Texture	Consistency	Color	Mottling
0-6	STONY LOAM	MODERATELY FRIABLE	DARK BROWN	NONE
6-30				
30-40	CLAY LOAM	FRIABLE	GRAY BROWN	FEW
40-50	BEDROCK			

Soil 2 Classification AIII Slope 13 % Limiting Factor 24 Under Water Rooting Layer Bedrock

Observation Hole 2 Test Pit Boring

Depth of Organic Horizon Above Mineral Soil

DEPTH BELOW MINERAL SOIL SURFACE (Inches)	Texture	Consistency	Color	Mottling
0-6	LOAM	FRIABLE	DARK BROWN	
6-10				NONE
10-30	GRAVELLY LOAM	MODERATELY FRIABLE	LIGHT BROWN	
30-40				FEW
40-50	BEDROCK			

Soil 2 Classification AIII Slope 13 % Limiting Factor 30 Under Water Rooting Layer Bedrock

William B. Poolewin

003/9814

5/31/92