



**CITY OF PORTLAND**

JOSEPH E. GRAY, JR.  
DIRECTOR OF PLANNING  
AND URBAN DEVELOPMENT

OK  
BY *[Signature]*  
DATE 5-12-82

November 30, 1982

Edward L. Casey  
Island Ave.  
Peaks Island, Maine

Dear Mr. Casey;

It has come to the attention of this office that you have started work on your proposed project 91-A-1 Seashore Avenue, Peaks Island, Maine.

Section 111.1 of the City of Portland, Maine Building Code (1981 BOCA Basic Building Code eighth edition) states, "It shall be unlawful to construct, enlarge, alter, or demolish a structure; or change the occupancy of a building or structure requiring greater strength, exit or sanitary provisions; or to change to another use; or to install or alter any equipment for which provision is made or the installation of which is regulated by this code, without first filing an application with the building official in writing and obtaining the required permit therefor; except the repairs as defined in Section 104.0 and which do not involve any violation of this code, shall be exempted from this provision."

If this work is not stopped immediately legal action will be started.

Sincerely,

P. Samuel Hoffses,  
Chief of Inspection Services

PHS/lh

This certifies that I have received a copy of this letter on 11/30/82  
Date

*[Signature]*  
Edward J. Casey

# CERTIFICATE OF APPROVAL

FOR WASTEWATER DISPOSAL FOR THE TOWN/CITY OF ROSS

City Code: 000 LPI Number: 0000 Date Issued: 1/1/83  
 Month: 1 Day: 1 Year: 83

Last Name: SMITH F.I. M.I.:   

**Nº 25541 EC**  
 Certificate of App. Number

Address: 100 Main St, ROSS, Maine  
 Location where system was installed and inspected.

Installer Code:  1. Owner  
 2. Builder  
 3. Installer  
 4. Developer  
 5. Realtor  
 6. Other

**THE SUBSURFACE SEWAGE DISPOSAL SYSTEM AND/OR COMPONENTS INSTALLED PURSUANT TO THE ABOVE CERTIFICATE OF APPROVAL NUMBER HAS BEEN PERSONALLY EXAMINED AND HAS BEEN PROPERLY INSTALLED IN COMPLIANCE WITH THE MUNICIPAL AND STATE SUBSURFACE SEWAGE DISPOSAL REGULATIONS AND THE HHE-200 FORM PERFORMED BY 003 ON 12/12/83 (Soil Evaluator Number) Date—Month, Day, Year**

*Arnold W. Goodwin*  
 Signature of LPI

Date Inspected: **JUL 12 1983**

ORIGINAL—to be sent to: Department of Human Services, Division of Health Engineering, Augusta, Maine 04333

**STATE OFFICE USE ONLY**  
 Control Number:   

## SUBSURFACE WASTEWATER DISPOSAL PERMIT

Town/City Code: 000 LPI Number: 0000 Date Issued: 1/1/83 FOR THE TOWN/CITY OF ROSS  
 Evaluator Number:   

Address of System's Location: 100 Main St, ROSS, Maine  
 Name of Owner: SMITH Last Name:    F.I. M.I.:   

**Nº 25541 EP**  
 PERMIT NUMBER

Permit Insurance:  1. Regular  2. Replacement Variance  3. State Variance  4. Local Site Evaluation Option

Type of System:  1. New  2. Replacement  3. Expansion  4. Experimental

Replacement Malfunction:  If system is being replaced or is a malfunction, enter year of original system installation:   

System to Serve:  1. Single (Frs)  2. Multi-Fam Res.  3. Mobile Home  4. Modular Home  5. Commercial  6. School  7. Other (Specify)   

Complete System:  1. Bed  2. Chamber  3. Special System (includes one waterless toilet)  4. Other (Specify)   

Treatment Tank ONLY:  1. Septic (\$10, ea)  2. Aerobic (\$10 each)  3. Holding (\$20, each)  4. Other (Specify) (\$20, each)   

Disposal Area ONLY:  1. Bed (\$20, each)  2. Chamber (\$20, each)  3. Laundry Waste (\$10, each)  4. Other (Specify) (\$10, each)   

Waterless Toilets:  1. Pit Privy  2. Vault Privy  3. Compost Toilet  4. Other (Specify) (\$10, each)   

**STATE OFFICE USE ONLY**  
 Cont of Number:     
 Administrative Code:   

LPI to Insert Soil Group:    Soil Condition:   

This subsurface sewage disposal permit is invalid if work is not commenced within six(6) months from date of issuance. Upon completion of work a "Certificate of Approval" must be obtained from the LPI.

Hook-Up Fee:    \$ 00  
 Administrative Fee:    \$ 00  
 Total Fee:    \$ 00

If Double Fee Check (  ) Box:

Signature of LPI:

APPLICATION FOR SUBSURFACE WASTEWATER DISPOSAL PERMIT  
 This is NOT A Permit; This Form When Completed Must Be  
 Presented To The Local Plumbing Inspector To Obtain A Permit

This Application is For:  New System  Replacement Of Entire System  Expanded System  Replacement Of Disposal Area Only  Conversion Permit

Variance:  None Requested  Replacement System Variance With LPI Approval  Dept. Review  New System Variance

PROPERTY LOCALITY: **Portland Peaks Island** Town/Plantation

PROPERTY OWNER OR APPLICANT: **Edward Caser**

Address: **Seashore Ave** Street Road

City: **Portland** State: **Me** Zip: **04108**

Phone: **706/2817**

Tax: **Map 91 Block A** Part: **1**

TYPE OF STRUCTURE, DESIGN FLOW  
 Single Family Dwelling Number of Bedrooms: **3** Design Flow: **450** GPD  
 Design Flow based on:  Minimum  Moderate  Conservative  
 Reduction in Design Flow due to Water Conservation  
 If so, specify type (s): \_\_\_\_\_  
 Other Establishment Specify: \_\_\_\_\_ Type of Facility: \_\_\_\_\_  
 (Number of Employees Seating Capacity Building Size etc.)  
 Design Flow: \_\_\_\_\_ GPD  
 If greater than 2000 GPD Specify Professional Engineer

PROPERTY INFORMATION  
 Area of Property: **20000** Sq. Ft.  Acres  Zoned  Not Zoned  
 If zoned, type of zoning: **R-3**  
 Property on Water Body If so Name of Water Body: \_\_\_\_\_  
 Water Supply is:  Public Utility  Drilled Well \_\_\_\_\_ depth  
 Dug Well \_\_\_\_\_ depth  Well Point  Springs  Surface Water

SOIL PROFILE DESCRIPTION Location of Observation Holes shown on page 2

TEXTURAL DESCRIPTION OF EACH SOIL STRATA ENCOUNTERED	Observation Hole No. 1		Observation Hole No. 2		Observation Hole No. 3	
	Test Pit <input checked="" type="checkbox"/> Boring	Thickness	Test Pit <input type="checkbox"/> Boring	Thickness	Test Pit <input type="checkbox"/> Boring	Thickness
Organic Strata or (Existing Fill) <b>sod</b>	<b>211</b>		Organic Strata or (Existing Fill) <b>sod</b>	<b>311</b>	Organic Strata or (Existing Fill)	
1st Original Mineral Soil Strata <b>Dk brown sandy loam</b>	<b>6</b>		1st Original Mineral Soil Strata <b>Dk brown sandy loam</b>	<b>7</b>	1st Original Mineral Soil Strata	
2nd <b>brown sandy gravel</b>	<b>10</b>		2nd <b>red yellow sandy gravel</b>	<b>17</b>	2nd	
3rd <b>red yellow sandy gravel</b>	<b>7</b>		3rd <b>red sandy gravel</b>		3rd	
4th <b>yellow sand</b>	<b>7</b>		4th <b>yellow sand</b>	<b>12</b>	4th	
Total Depth of Observation Hole: <b>30</b>			Total Depth of Observation Hole: <b>38</b>		Total Depth of Observation Hole	
Maximum Seasonal High Ground Water Table Depth: <b>16 - mottling</b>			Maximum Seasonal High Ground Water Table Depth: <b>17 - mottling</b>		Maximum Seasonal High Ground Water Table Depth	
Depth to Restrictive Layer: <b>30</b>			Depth to Restrictive Layer: <b>24</b>		Depth to Restrictive Layer	
Depth to Bedrock: <b>30</b>			Depth to Bedrock: <b>38</b>		Depth to Bedrock	

DISPOSAL SYSTEM PROPOSED Location of system and Details on Proposed Plan on page 2

PROFILE	CONDITION	SLOPE	PROFILE	CONDITION	SLOPE	PROFILE	CONDITION	SLOPE
<b>6</b>	<b>C</b>	<b>2.5%</b>	<b>6</b>	<b>C</b>	<b>2.5%</b>			

TYPE OF SYSTEM:  Combined System  Separated System

TREATMENT TANK:  Septic Tank  Aerobic Tank Size: **1000** gals

GOSAGE:  Pumping is not required  Pumping is required

SUBSURFACE DISPOSAL AREA/TYPE:  Trench Disposal Area  Bed Disposal Area

CHAMBER DISPOSAL AREA:  Chamber Disposal Area

SYSTEM SIZE PAVING:  Small  Medium  Medium-Large  Large  Extra Large

DISPOSAL AREA ELEVATION: **30** inches

Depth of Unslope Fill required: **35** inches

Reference Elevation Point established at: **20.00** Elevation

Top of Distribution Lines or Top of Chambers: **23.69** Elevation

Yes  No The proposed subsurface disposal area will be located at least 100 feet from any and all wells, springs, surface water bodies and courses (lake, pond, ocean, brook stream, river), swamps, marshes, and bogs

Yes  No The proposed subsurface disposal area will be located at least 300 feet from any and all wells and springs producing 1000 gallons or more of water per day and any public water supply.

FOR USE BY SITE EVALUATOR  
 On **12-12-81** (date), a site investigation for this project was completed. I conducted this soil evaluation and certify that the results indicated above best represent the soil conditions found. I recommend the above type and size of subsurface wastewater disposal system. I also recommend the trench disposal system layout and location shown on page 2.

Signature of Site Evaluator: **William B. Jordan** Site Evaluator License Number: **0005**

Date signed: **12/20/81**

FOR USE BY OWNER/APPLICANT  
 I certify that all the information submitted to be true and correct to the best of my knowledge. I understand that any falsification of this application is reason to deny a permit. I will not install a disposal system and that the permit is valid for a six (6) month period from the date of permit issuance. I also understand that no guarantee is intended or implied by reason of any advice or approval given.

Signature of Owner/Applicant: **Edward Caser**

Date signed: **11/13/82**

Signature of LPI: **John**

Date: **11/15/82**

PERMIT NO: **217-117**

Date Issued: **11/17/82**



APPLICATION FOR SUBSURFACE WASTEWATER DISPOSAL PERMIT

Page 2 of 2

PROPERTY LOCATION Portland Pea Island Town/Parishion		Seashore Ave Street/Road		Subdivision Name	Lot No.
PROPERTY OWNER or APPLICANT Edward Casey		DISPOSAL AREA ELEVATION Depth of Upslope Fill required 30 inches Depth of Downslope Fill required 25 inches		Reference Elevation Point established at 20.00 Elevation. Disposal Area Bottom to be established at 23.60 Elevation. Top of Distribution Lines or Top of Chamber 23.68 Elevation.	

Site Plan

Scale 1" = 50 ft.

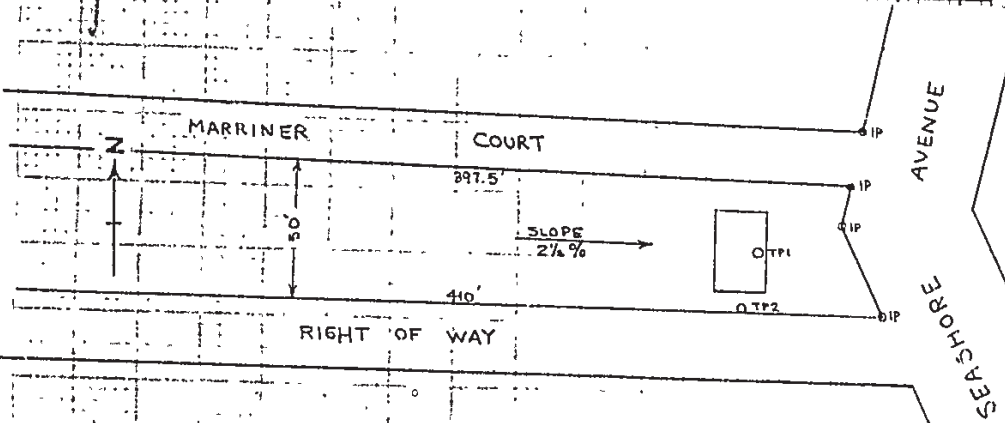

Subsurface Wastewater Disposal Plan

Scale 1" = 20' Drawn by N.V.T.

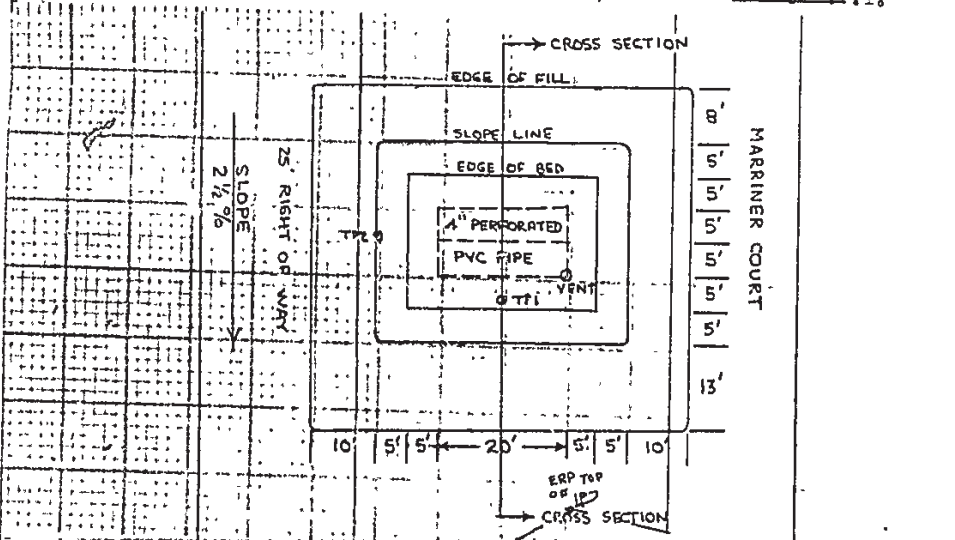

Subsurface Wastewater Disposal Area Cross-section

Scale: Vertical: 1" = 5'

Horizontal: 1" = 20'

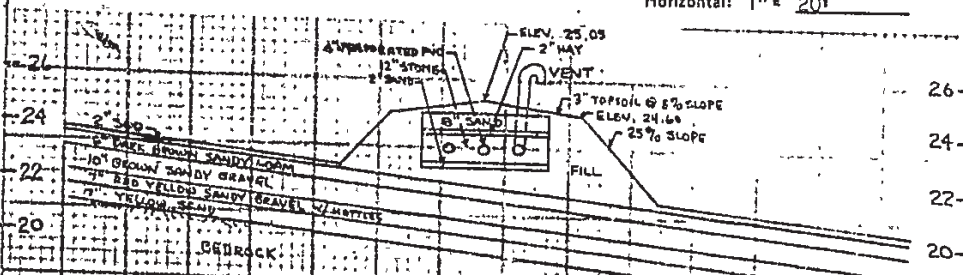

Site Engineer Signature  
Walter B. Goodwin

Date March 20, 1982 License Number 0003