

PLEASANT AVENUE PEAKS ISLAND
90-P-11



APPLICATION FOR PERMIT

Class of Building or Type of Structure

Permit No. 10621

0621

To the INSPECTOR OF BUILDINGS, PORTLAND, ME.

Portland, Maine

May 16, 1939

MAY 16 1939

The undersigned hereby applies for a permit to erect alter install the following building structure equipment in accordance with the Laws of the State of Maine, the Building Code of the City of Portland, plans and specifications, if any, submitted herewith and the following specifications:

Location Pleasant Avenue, Peck Island Within Fire Limits? No Dist. No. _____
 Owner's or Lessee's name and address Walter Cobb, Peck Island Telephone _____
 Contractor's name and address George H. Weaver, New Island Ave., Peck Isl. Telephone 2-200
 Architect _____ Plans filed _____ No. of sheets _____
 Proposed use of building Cottage No. families 1
 Other buildings on same lot 1 car garage
 Estimated cost \$ 260.00 Fee \$.75

Description of Present Building to be Altered

Material Wood No. stories 1 1/2 Heat _____ Style of roof Gitch Roofing asphalt
 Last use Cottage No. families 1

General Description of New Work

To make second story addition 6' x 12' to existing cottage, including also the enclosure of portion of existing piazza 6' x 12' to make new room 12' x 12'.
 To erect new fireplace chimney.

Not less than 6x6 sill under wall where chimney is to be.

CERTIFICATE OF OCCUPANCY REQUIREMENT IS WAIVED

It is understood that this permit does not include installation of heating apparatus which is to be taken out separately by and in the name of the heating contractor.

Details of New Work

No	Yes
Size, front depth _____	Height average grade to top of plate _____ <u>10'</u>
No. stories <u>1</u>	Height average grade to highest point of roof <u>12'</u>
To be erected on solid or filled land? <u>Solid</u>	earth or rock? <u>ledge</u>
Material of foundation <u>Cedar posts</u>	Thickness, top _____ bottom _____ cellar _____
Material of underpinning _____	Height _____ Thickness _____
Kind of Roof <u>shed</u>	Rise per foot <u>4"</u> Roof covering <u>Asphalt roofing Glass pan and Lab.</u>
No. of chimneys <u>1</u>	Material of chimneys <u>brick</u> Lining <u>tile</u>
Kind of heat _____	Type of fuel _____ Is gas fitting involved? _____
Framing Lumber Kind <u>heart oak</u>	Dressed or Full Size? <u>crossed</u>
Corner posts <u>4x6</u>	Sills <u>4x6</u> Girt or ledger board? _____ Size _____
Material columns under girders _____	Size _____ Max. on centers _____
Studs (outside walls and carrying partitions) <u>2x4-16" O. C.</u>	Girders <u>6x8</u> or larger. Bridging in every floor and flat roof span over 8 feet. Sills and corner posts all one piece in cross section.
Joists and rafters:	1st floor <u>2x6</u> , 2nd _____, 3rd _____, roof <u>2x8</u>
On centers:	1st floor <u>16"</u> , 2nd _____, 3rd _____, roof <u>16"</u>
Maximum span:	1st floor <u>8'</u> , 2nd _____, 3rd _____, roof <u>12'</u>
If one story building with masonry walls, thickness of walls? _____	height? _____

If a Garage

No. cars now accommodated on same lot _____ to be accommodated _____
 Total number commercial cars to be accommodated _____
 Will automobile repairing be done other than minor repairs to cars habitually stored in the proposed building? _____

Miscellaneous

Will above work require removal or disturbing of any shade tree on a public street? no
 Will there be in charge of the above work a person competent to see that the State and City requirements pertaining thereto are observed? yes

INSPECTION COPY

Signature of owner Walter Cobb

By George H. Weaver

4-3637

Permit No. 39/621

Location Pleasant Grove Peak

Owner Walter Coffe

Date of permit 5/16/39

Notif. closing-in

Inspn. closing-in

Final Notif.

Final Inspn. 6/19/39. 126.

Cert. of Occupancy issued None.

NOTES

90-P-1

A.P.T. Because
asphalt shingle on
roof we will not under
on brass exactly
10 feet between outlet
if chimney and nearest
roof surface. But this is
not to be taken as
a precedent a plane
supposed this point to
Wesley West & Keeney
when you see them
5/24/39. I said will
along chimney not
at all!



(G) GENERAL BUSINESS ZONE
APPLICATION FOR PERMIT

Permit No. 6729

Class of Building or Type of Structure Third Class

Portland, Maine April 9, 1934

PERMIT ISSUED

To the INSPECTOR OF BUILDINGS, PORTLAND, ME.

APR 9 1934

The undersigned hereby applies for a permit to erect alter install the following building structure equipment in accordance with the Laws of the State of Maine, the Filing Code of the City of Portland, plans and specifications, if any, submitted herewith and the following specifications:

Location Pleasant Avenue, Backs Island Ward 1st, E Within Five Limits? No Dist. No. _____

Owner's or Lessee's name and address Walter W. Cobb, 11 Shepley Street Telephone _____

Contractor's name and address George A. Kaening, Willow Street, Pa I. Telephone None

Architect's name and address _____

Proposed use of building Cottage No. families 1

Other buildings on same lot Garage

Plans filed as part of this application? None No. of sheets _____

Estimated cost \$ 25.00 Fee \$ 25

Description of Present Building to be Altered

Material Wood No. stories 1 1/2 Heat _____ Style of roof Gitch Roofing _____

Last use Cottage No. families 1

General Description of New Work

To tear down one outside brick chimney and rebuild in same location
To cover entire roof of one story frame shed attached to cottage

CERTIFICATE OF OCCUPANCY
REQUIREMENT IS WAIVED

NOTIFICATION BEFORE LATERS
OR CLOSING-IN IS WAIVED

It is understood that this permit does not include installation of heating apparatus which is to be taken out separately by and in the name of the heating contractor.

Details of New Work

Height average grade to top of plate _____

Size, front _____ depth _____ No. stories _____ Height average grade to highest point of roof _____

To be erected on solid or filled land _____ earth or rock? _____

Material of foundation _____ Thickness, top _____ bottom _____

Material of underpinning _____ Height _____ Thickness _____

Kind of Roof Flat Rise per foot _____ Roof covering Asphalt roofing Clean Oil and Lab.

Material of chimneys Brick of lining Tile

Type of fuel _____ Is gas fitting involved? _____

Corner posts _____ Sills _____ Girt or ledger board? _____ Size _____

Material columns under girders _____ Size _____ Max. on centers _____

Studs (outside walls and carrying partitions) 2x4-16" O. C. Girders 6x8 or larger. Bridging in every floor and flat roof span over 8 feet? Sills and corner posts all one piece in cross section.

Joist and rafters: 1st floor _____, 2nd _____, 3rd _____, roof _____

On centers: 1st floor _____, 2nd _____, 3rd _____, roof _____

Maximum span: 1st floor _____, 2nd _____, 3rd _____, roof _____

If one story building with masonry walls, thickness of walls? _____ height? _____

If a Garage

No. cars to be accommodated on same lot _____ to be accommodated _____

Total number commercial cars to be accommodated _____

Will automobile repairing be done other than minor repairs to cars habitually stored in the proposed building? _____

Miscellaneous

Will above work require removal or disturbing of any shade tree on a public street? _____

Will there be in charge of the above work a person competent to see that the State and City requirements pertaining thereto are observed? Yes

Signature of owner

Walter W. Cobb
George A. Kaening

INSPECTION COPY

APR 12 1934

Ward 242 Permit No. 34/329

Location Pleasant Dr. Peaks

Owner Walter W. Cobb

Date of permit 4/9/34

Notif. closing-in _____

Inspn. closing-in _____

Final Notif. _____

Final Inspn. 4/24/34

Cert. of Occupancy issued None

NOTES

4/24/34 - Work done -
A. J. S.

~~_____~~

90
P
11

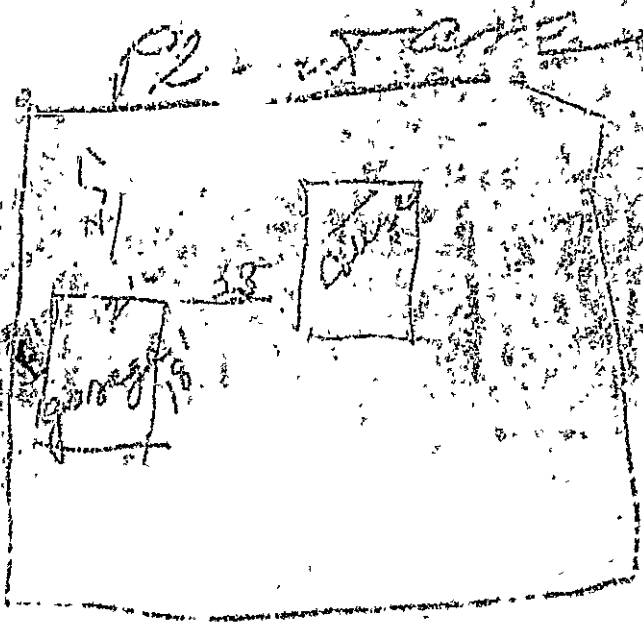

STATEMENT ACCOMPANYING APPLICATION FOR BUILDING PERMIT

for 1 car garage
at Pleasant View, Peaks Is.

Date 5/16/32
~~5/26/32~~

Walter H. Cobb

1. In whose name is the title of the property now recorded? _____
2. Are the boundaries of the property in the vicinity of the proposed work shown clearly on the ground, and how? Wood stakes
3. Is the outline of the proposed work now staked out upon the ground? Yes If not, will you notify the Inspection Office when the work is staked out and before any of the work is commenced? Y
4. What is to be maximum projection or overhang of eaves or drip? 10"
5. Do you assume full responsibility for the correctness of the location plan or statement of location filed with this application, and does it show the complete outline of the proposed work on the ground, including bay windows, porches and other projections? Yes
6. Do you assume full responsibility for the correctness of all statements in the application concerning the sizes, design and use of the proposed building? Yes
7. Do you understand that in case changes are proposed in the location of the work or in any of the details specified in the application that a revised plan and application must be submitted to this office before the changes are made? Yes

E. J. Weaver



(A) APARTMENT HOUSE ZONE

PERMIT ISSUED
Permit No. 0637

APPLICATION FOR PERMIT

MAY 18 1932

Class of Building or Type of Structure Third Class

Portland, Maine, May 18, 1932

To the INSPECTOR OF BUILDINGS, PORTLAND, ME.

The undersigned hereby applies for a permit to erect alter install the following building structure equipment in accordance with the Laws of the State of Maine, the Building Code of the City of Portland, plans and specifications, if any, submitted herewith and the following specifications:

Location Pleasant Ave., Peaks Is. Ward 2 Within Fire Limits? no Dist. No. _____

Owner's or Lessee's name and address Walter Cobb 355 Congress St. Telephone _____

Contractor's name and address F. H. Weaver Sargent Road, Peaks Is. Telephone 252

Architect's name and address _____

Proposed use of building 1-car garage No. families _____

Other buildings on same lot cottage

Plans filed as part of this application? yes No. of sheets 1

Estimated cost \$ 261 Fee \$.75

Description of Present Building to be Altered

Material _____ No. stories _____ Heat _____ Style of roof _____ Roofing _____

Las. use _____ No. families _____

General Description of New Work

To erect 1-car frame garage 12' x 18'

NOTIFICATION BEFORE LATHING
OR CLOSING-IN IS WAIVED
CERTIFICATE OF OCCUPANCY
REQUIREMENT IS WAIVED

It is understood that this permit does not include installation of heating apparatus which is to be taken out separately by and in the name of the heating contractor.

Details of New Work

Size, front 12' depth 18' No. stories 1 Height average grade to top of plate 8'

To be erected on solid or filled land? solid earth or rock? earth Height average grade to highest point of roof 15'

Material of foundation cedar posts Thickness, top _____ bottom _____

Material of underpinning _____ Height _____ Thickness _____

Kind of Roof gale Rise per foot 8" Roof covering Asphalt shingles Class C Und Lat

No. of chimneys no Material of chimneys _____ of lining _____

Kind of heat _____ Type of fuel _____ Is gas fitting involved? _____

Corner posts 2x4 Sills 4x8 Girt or ledger board? _____ Size _____

Material columns under girders _____ Size _____ Max. on centers _____

Studs (outside walls and carrying partitions) 2x1-16" O. C. Girders 6x8 or larger. Bridging in every floor and flat roof span over 8 feet. Sills and corner posts all one piece in cross section.

Joists and rafters: 1st floor 2x8, 2nd _____, 3rd _____, roof 2x8

On centers: 1st floor 18", 2nd _____, 3rd _____, roof 24"

Maximum span: 1st floor 6', 2nd _____, 3rd _____, roof _____

If one story building with masonry walls, thickness of walls? _____ height? _____

If a Garage

No. cars now accommodated on same lot none, to be accommodated 1

Total number commercial cars to be accommodated none

Will automobile repairing be done other than minor repairs to cars habitually stored in the proposed building? no

Miscellaneous

Will above work require removal or disturbing of any shade tree on a public street? no

Will there be in charge of the above work a person competent to see that the State and City requirements pertaining thereto are observed? yes

Signature of owner. By F. H. Weaver Walter Cobb

INSPECTION COPY
Oliver T. Sanborn
CHIEF OF FIRE DEPT.

11425 C

22.
Ward 2 Permit No. 32/637
Location Pleasant Ave. Park
Owner Halter Cook
Date of permit 5/17/32
Notif. closing-in _____
Insn. closing-in _____
Final Notif. _____
Final Insp. 5/25/32
Cert. of Occupancy issued Nov

YES

90

0

5/17/32 - staking out
O.K. - A.J.S.
5/25/32 - framing com-
pleted A.J.S.





APPLICATION FOR PERMIT

Class of Building or Type of Structure 3rd

Portland, Maine, April 8 1930

Permit No. 0567
APR 8 1930

To the INSPECTOR OF BUILDINGS, PORTLAND, ME.

The undersigned hereby applies for a permit to erect a ¹¹⁴⁶ ~~new~~ ¹¹⁴⁶ building ~~in accordance with the Laws of the State of Maine, the Building Code, the City of Portland, plans and specifications, if any, submitted herewith and the following specifications:~~

Location Pleasant Ave. P.L. Trefother's Lodge Ward 1 Within Fire Limits? no Dist. No. _____

Owner's or Lessee's name and address Walter H. Goble 445 1/2 1st Ave. S.E. Telephone _____

Contractor's name and address Owner Telephone _____

Architect's name and address _____ Telephone _____

Proposed use of building Cottage No. families _____

Other buildings on same no _____

Description of Present Building to be Altered

Material wood No. stories 2 1/2 Heat _____ Style of roof Fitch Roofing _____

Last use Cottage No. families _____

General Description of New Work

Enlarge present toilet which is about 5'-0" x 5'-0" to about 5'-3" x 6'-0"
present window for ventilation, fire door

Details of New Work

Size, front _____ depth _____ No. stories _____ Height average grade to highest point of roof _____

To be erected on solid or filled land? _____ earth or rock? _____

Material of foundation _____ Thickness, top _____ bottom _____

Material of underpinning _____ Height _____ Thickness _____

Kind of roof _____ Roof covering _____

No. of chimneys _____ Material of chimneys _____ of lining _____

Kind of heat _____ Type of fuel _____ Distance heater to chimney _____

If oil burner, name and model _____

Capacity and location of oil tanks _____

Is gas fitting involved? _____ Size of service _____

Corner posts _____ Size _____ Girt or ledger board? _____ Size _____

Material columns under girders _____ Size _____ Max. on centers _____

Sheds (outside walls and carrying partitions) 2 x 4-10" C.C. Girders 6x8 or larger. Bridging in every _____ and flat roof span over 8 feet. Sills and corner posts all one piece in cross section.

Joists and rafters: 1st floor _____ 2nd _____ 3rd _____ roof _____

On centers: 1st floor _____ 2nd _____ 3rd _____ roof _____

Maximum span: 1st floor _____ 2nd _____ 3rd _____ roof _____

If one story building, masonry walls, thickness of walls? _____ height? _____

If a Garage

No. cars now or any later on same lot _____ to be accommodated _____

Number commercial cars to be accommodated _____

Automobile repairing to be done other than minor repairs to cars habitually stored in the proposed building _____

Miscellaneous

Will above work require removal or disturbing of any shade tree on a public street? no

Plans filed as part of this application? _____ No. sheets 3

Estimated cost \$ 100 Fee \$ 1.00

Will there be in charge of the above work a person competent to see that the State and City requirements pertaining thereto are observed? yes

Signature of owner Walter H. Goble

INSPECTION COPY

4267

Ward / Permit No. 30/562

Location Pleasant Ave, Pleasant

Owner Walter W. Clark

Date of permit 4/8/30

ing-in

Inspn closing-in

Final Notif.

Final Inspn.

Cert. of Occupancy Issued

NOTES

90

P

8

4/14/40 Work being done - A. J. [Signature]

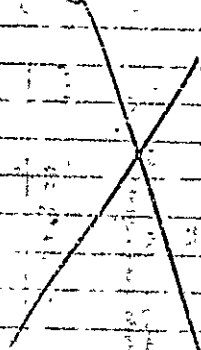

Proposed work, change sled door &
steps to platform one
side of sled &
cut in wd in shed

60 ft
to lot line

30 ft

35 ft
to lot line

26 ft

45 1/2 ft
to lot line

Platform
steps

New Steps

15 ft
to actual

Platform one



APPLICATION FOR PERMIT

Permit No. _____

Class of Building or Type of Structure 3rd

Portland, Maine, Aug. 23, 1925

To the INSPECTOR OF BUILDINGS, PORTLAND, ME.

The undersigned hereby applies for a permit to ~~erect~~ alter all the following building ~~plans and specifications~~ in accordance with the Laws of the State of Maine, the Building Code of the City of Portland, plans and specifications, if any, submitted herewith and the following specifications:

Location Peaks Island, Prof. Ldg. Ward 1 Within Fire Limits? no Dist. No. _____

Owner's or title's name and address Walter F. Cobb, Pleasant Ave. Telephone _____

Contractor's name and address Harry S. Hear, A St. Peaks Island Telephone _____

Architect's name and address _____ Telephone _____

Proposed use of building Cottage No. families _____

Other buildings on same lot no

Description of Present Building to be Altered

Material wood No. stories 1 1/2 Heat _____ Style of roof Pitch Roofing _____

Last use Cottage No. families _____

General Description of New Work

Remove present side steps to rear, close up present door on side and cut in window, cut in new door in rear

*By phone from Mr. Cobb
To receive plans with Harry S. Hear*
Details of New Work

Size, front _____ depth _____ No. stories _____ Height average grade to highest point of roof _____

To be erected on _____ filled land? _____ earth or rock? _____

Material of foundation _____ Thickness, top _____ bottom _____

Material of underpinning _____ Height _____ Thickness _____

Kind of roof _____ Roof covering _____

No. of chimneys _____ Material of chimneys _____ of lining _____

Kind of heat _____ Type of fuel _____ Distance, heater to chimney _____

If oil burner, name and model _____

Capacity and location of oil tanks _____

gas fitting involved? _____ Size of service _____

Corner posts _____ Sills _____ Girt or ledger board? _____ Size _____

Material, columns under girders _____ Size _____ Max. on centers _____

Studs, (outside walls and carrying partition) 2x4-16" C. C. Girts 6x8 or larger. Bridging in every floor flat roof

span over 8 feet. Sills and corner posts all one piece in cross section.

Joists and rafters: 1st floor _____ 2nd _____ 3rd _____ roof _____

On centers: 1st floor _____ 2nd _____ 3rd _____ roof _____

Maximum span: 1st floor _____ 2nd _____ 3rd _____ roof _____ height? _____

If one story building with masonry walls, thickness of walls? _____ height? _____

If a Garage

No. cars now accommodated on same lot _____ to be accommodated _____

Total number commercial cars to be accommodated _____

Will automobile repairing be done other than minor repairs to cars habitually stored in the proposed building? _____

Miscellaneous

Will above work require removal or disturbing of any shade tree on a public street? no

Flat filed as part of this application? yes No. sheets 1 Fee \$25

Estimated cost \$ 22.00

Will there be in charge of the above work a person competent to see that the State and City requirements pertaining thereto are observed? yes

Signature of owner Walter F. Cobb

INSPECTION COPY

10111111

Ward 1 Permit No. 29/1672

Location Oliver and Live Peaks

Owner Walter H. Post

Date of permit 8/23/29

Notif. closing-in

Insprn closing-in

Final Notif.

Final Insprn.

Cert. of Occupancy issued

NOTES

90

P

8

10/16/29 - Work done

[Handwritten signature]

~~X~~