

ISLAND AVENUE
90-0-18

PEAKS ISLAND





R3 RESIDENCE ZONE
APPLICATION FOR PERMIT

Class of Building or Type of Structure Third Class
Portland, Maine, August 22, 1960

PERMIT ISSUED
AUG 25 1960
CITY OF PORTLAND

To the INSPECTOR OF BUILDINGS, PORTLAND, MAINE

The undersigned hereby applies for a permit to erect ~~alter~~ ~~repair~~ ~~remodel~~ install the following building structure equipment in accordance with the Laws of the State of Maine, the Building Code and Zoning Ordinance of the City of Portland, plans and specifications, if any, submitted herewith and the following specifications:

Location Island Ave, Peaks Island Me. 90-0-12 Within Fire Limits? _____ Dist. No. _____
 Owner's name and address Everett White, Melrose Mass. Telephone _____
 Lessee's name and address Christine E. Litchfield & Edith Cass, NY Telephone _____
 Contractor's name and address Elmer Harmon, City Point Rd. Peaks Island Me. Telephone no phone
 Architect _____ Specifications _____ Plans no No. of sheets _____
 Proposed use of building Dwelling No. families 1
 Last use _____ " _____ No. families 1
 Material frame No. stories 1 Heat _____ Style of roof _____ Roofing _____
 Other buildings on same lot _____
 Estimated cost \$ 200.00 Fee \$ 2.00

General Description of New Work

To construct outside cement block chimney on front of dwelling, chimney to project 2' above roof.

It is understood that this permit does not include installation of heating apparatus which is to be taken out separately by and in the name of the heating contractor. PERMIT TO BE ISSUED TO contractor

Details of New Work

Is any plumbing involved in this work? _____ Is any electrical work involved in this work? _____
 Is connection to be made to public sewer? _____ If not, what is proposed for sewage? _____
 Has septic tank notice been sent? _____ Form notice sent? _____
 Height average grade to top of plate _____ Height average grade to highest point of roof _____
 Size, front _____ depth _____ No. stories _____ solid or filled land? _____ earth or rock? _____
 Material of foundation concrete at least 4" below grade Thickness, top _____ bottom _____ cellar _____
 Material of underpinning 24" squares Height _____ Thickness _____
 Kind of roof _____ Rise per foot _____ Roof covering _____
 No. of chimneys 1 Material of chimneys concrete blk. of lining tile Kind of heat _____ fuel _____
 Framing Lumber—Kind _____ Dressed or full size? _____ Corner posts _____ Sills _____
 Size Girder _____ Columns under girders _____ Size _____ Max. on centers _____
 Kind and thickness of outside sheathing of exterior walls? _____
 Studs (outside walls and carrying partitions) 2x4-16" O. C. Bridging in every floor and flat roof span over 8 feet.
 Joists and rafters: 1st floor _____, 2nd _____, 3rd _____, roof _____
 On centers: 1st floor _____, 2nd _____, 3rd _____, roof _____
 Maximum span: 1st floor _____, 2nd _____, 3rd _____, roof _____
 If one story building with masonry walls, thickness of walls? _____ height? _____

If a Garage

No. cars now accommodated on same lot _____, to be accommodated _____ number commercial cars to be accommodated _____
 Will automobile repairing be done other than minor repairs to cars habitually stored in the proposed building? _____

APPROVED:

Miscellaneous

Will work require disturbing of any tree on a public street? no
 Will there be in charge of the above work a person competent to see that the State and City requirements pertaining thereto are observed? yes

Everett White
 Elmer Harmon

Signature of owner

Elmer Harmon

FILE COPY



(A) APARTMENT HOUSE ZONE

APPLICATION FOR PERMIT

Class of Building or Type of Structure. Third Class

Portland, Maine, April 23, 1956

RECEIVED
00474
APR 23 1956
CITY OF PORTLAND

To the INSPECTOR OF BUILDINGS, PORTLAND, MAINE

The undersigned hereby applies for a permit to ~~construct~~ demolish if ~~at~~ the following building ~~xxxxxx~~ ~~xxxxxx~~ in accordance with the Laws of the State of Maine, the Building Code and Zoning Ordinance of the City of Portland, plans and specifications, if any, submitted herewith and the following specifications:

Location Island Ave., Peaks Island 70-0-18 Within Fire Limits? no Dist. No.

Owner's name and address Vera L. Anderson, 25 Mt. Vernon St., Sq. Portland Telephone ..

Lessee's name and address Telephone ..

Contractor's name and address George Jordan, Peaks Island Telephone ..

Architect Specifications Plans no No. of sheets

Proposed use of building No. families

Last use storage shed No. families ..

Material Wood No. stories ... 1 Heat Style of roof Roofing ..

Other building on same lot ... dwelling house Fee \$.50

Estimated cost \$

General Description of New Work

To demolish 1-story frame shed approximately 10' x 14'.

It is understood that this permit does not include installation of heating apparatus which is to be taken out separately by and in the name of the heating contractor. PERMIT TO BE ISSUED TO owner

Details of New Work

Is any plumbing involved in this work? ... Is any electrical work involved in this work? ...

Is connection to be made to public sewer? ... If not, what is proposed for sewage? ...

Has septic tank notice been sent? ... Form notice sent? ...

Height average grade to top of plate .. Height average grade to highest point of roof ..

Size, front depth No. stories solid or filled land? earth or rock? ..

Material of foundation Thickness, top bottom cellar ..

Material of underpinning .. Height Thickness ..

Kind of roof Rise per foot Roof covering ..

No. of chimneys Material of chimneys of lining Kind of heat fuel ..

Framing lumber—Kind Dressed or full size? ..

Corner posts Sills Girt or ledger board? Size ..

Girders Size Columns under girders Size Max. on centers ..

Studs (outside walls and carrying partitions) 2x4-16" O. C. Bridging in every floor and flat roof span over 8 feet.

Joists and rafters: 1st floor 2nd 3rd roof ..

On centers: 1st floor 2nd 3rd roof ..

Maximum span: 1st floor 2nd 3rd roof ..

If one story building with masonry walls, thickness of wall height?

If a Garage

No. cars now accommodated on same lot ... , to be accommodated number commercial cars to be accommodated

Will automobile repairing be done other than minor repairs to cars habitually stored in the closed building? ..

Miscellaneous

Will work require disturbing of any tree on a public street? n

Will there be in charge of the above work a person competent to see that the State and City requirements pertaining thereto are observed? yes

APPROVED:

.....

.....

.....

Signature of owner

Vera L. Anderson

INSPECTION COPY

C16-254-11-3-1-54

NOTES

11/30/56 - Wash line
SLO

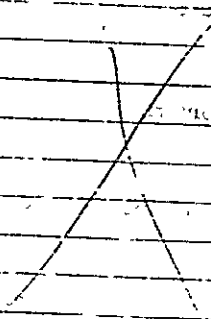

Permit No. 56/474

Location, Salvage Qu. Crabs

Owner David Anderson

Date of permit 4/23/56

Notice closing-in

Inspection closing-in

Final report

Final inspection 11/30/56

Cert. of Decu. entry issued

Staking Out Notice

Form C/C & Notes

STATEMENT ACCOMPANYING APPLICATION FOR BUILDING PERMIT

for storage shed
at Island Avenue, Peaks Island

Date 11/18/50

1. In whose name is the title of the property now recorded? *Ida Trefethen*
2. Are the boundaries of the property in the vicinity of the proposed work shown clearly on the ground, and how? *streets iron posts on south side*
3. Is the outline of the proposed work now staked out upon the ground? *yes* If not, will you notify the Inspection Office when the work is staked out and before any of the work is commenced?
4. What is to be maximum projection or overhang of eaves or drip? *6"*
5. Do you assume full responsibility for the correctness of the location plan or statement of location filed with this application, and does it show the complete outline of the proposed work on the ground, including bay windows, porches and other projections? *yes*
6. Do you assume full responsibility for the correctness of all statements in the application concerning the sizes, design and use of the proposed building? *yes*
7. Do you understand that in case changes are proposed in the location of the work or in any of the details specified in the application that a revised plan and application must be submitted to this office before the changes are made? *yes*

Walter E. McIntyre

Pleasant Ave

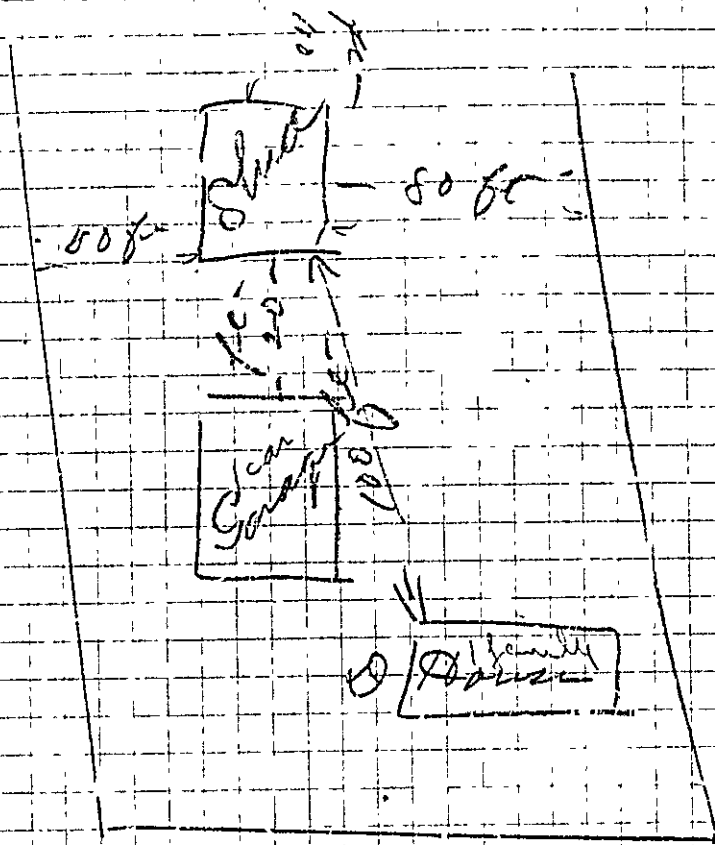

Island Ave



(A) APARTAMENT HOUSE ZONE

APPLICATION FOR PERMIT

Class of Building or Type of Structure Third Class

PERMIT ASSISTED
Permit No. 2615

NOV 18 1930

Portland, Maine, November 18, 1930

To the INSPECTOR OF BUILDINGS, PORTLAND, ME.

The undersigned hereby applies for a permit to erect ~~alter~~ erect the following building structure equipment in accordance with the Laws of the State of Maine, the Building Code of the City of Portland, plans and specifications, if any, submitted herewith and the following specifications:

Location Perks Island Ward 1 Within Fire Limits? no Dist. No. _____

Owner's or Lessee's name and address _____ Walter Perks Island Telephone _____

Contractor's name and address _____ W. S. Perks, Island Ave. Perks Island Telephone 34-11

Architect's name and address _____

Proposed use of building storage shed (private) No. families _____

Other buildings on same lot 1 car garage, 1 family dwelling house

Plans filed as part of this application? yes No. of sheets 1

Estimated cost \$ 20. Fee \$.25

Description of Present Building to be Altered

Material _____ No. stories _____ Heat _____ Style of roof _____ Roofing _____

Last use _____ No. families _____

General Description of New Work

To erect one story frame building 10' x 15'

NOV 18 1930
CITY OF PORTLAND
RECEIVED

It is understood that this permit does not include installation of heating apparatus which is to be taken out separately by and in the name of the heating contractor.

Details of New Work

Height average grade to top of plate 6'6"

Size, front 15' depth 10' No. stories 1 Height average grade to highest point of roof 8'6"

To be erected on solid or filled land? solid earth or rock? earth

Material of foundation flat stone Thickness, top _____ bottom _____

Material of underpinning _____ Height _____ Thickness _____

Kind of Roof pitch Rise per foot 6" Roof covering Asphalt roofing Class C Und. Lab

No. of chimneys no Material of chimneys _____ of lining _____

Kind of heat no Type of fuel _____ Is gas fitting involved? _____

Corner posts 4x4 Sills 4x6 Girt or ledger board? _____ Size _____

Material columns under girders _____ Size _____ Max. on centers _____

Studs (outside walls and carrying partitions) 2x4-16" O. C. Girders 6x8 or larger. Bridging in every floor and flat roof span over 8 feet. Sills and corner posts all one piece in cross section.

Joists and rafters: 1st floor 4x8-6x8 2nd _____ 3rd _____ roof 2x8-2x8

one story building with masonry walls, thickness of walls? _____

If a Garage

No. cars now accommodated on same lot _____

To number commercial cars to be accommodated _____ to be accommodated _____

Will automobile repairing be done other than minor repairs to cars habitually stored in the proposed building? _____

Miscellaneous

Will above work require removal or disturbing of any shade tree on a public street? no

Will there be in charge of the above work a person competent to see that the State and City requirements pertaining thereto are observed? yes

INSPECTION COPY

Signature of owner

Walter Perks
I do Trefethen

NOV 18 1930

Ward 1 Permit No. 30/2645

Address Island Ave Peabody

Owner Ida Trifalena

Date of permit 11/18/35

Inspr. closing-in

Final Notif.

Final Inspn. 10/13/36

Cert of Occupancy issued

NOTES

Handwritten notes: 10/10/36 Building erected - A.G. Being used for poultry house etc.

Vertical text on the right side of the page, possibly a list or schedule, including the name 'Deputy of New Alton'.

Pasant Ave

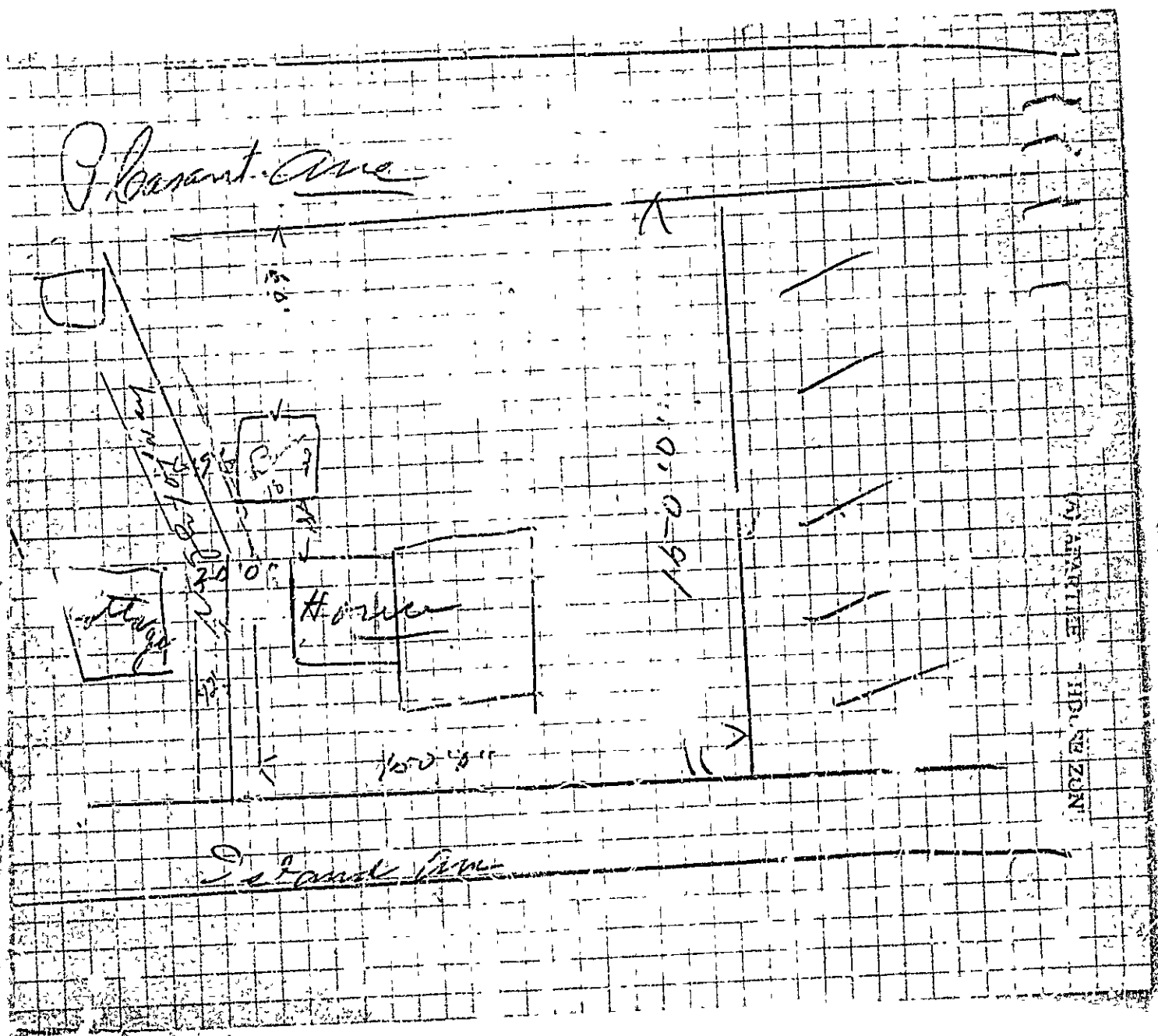

Island Ave



APPLICATION FOR PERMIT

Class. of Building or Type of Structure TRIAL CLEAR

Portland, Maine, December 27, 1938

RECEIVED
DEC 29 1938

To the INSPECTOR OF BUILDINGS, PORTLAND, ME.

The undersigned hereby applies for a permit to erect alter ~~and~~ install the following building structure and equipment in accordance with the Laws of the State of Maine, the Building Code of the City of Portland, plans and specifications, if any, submitted herewith and the following specifications:

Location Inland Avenue, Peaks Island Ward 1 Within City Limits? Yes Dist. No. _____
 Owner's or Lessee's name and address Volter E. McIntire, Peaks Island Telephone _____
 Contractor's name and address Omar Telephone _____
 Architect's name and address _____ Telephone _____
 Proposed use of building Storage shed and 1 car garage No. families _____

Other buildings on same lot _____

Description of Present Building to be Altered

Material wood No. stories 1 1/2 Heat _____ Style of roof _____ Roof _____
 Last use Storage (private) No. families _____

General Description of New Work

To move building about 50 feet on same property

(10' x 22')
THIS PERMIT DOES NOT ENTAIL THE RIGHT TO MOVE ANY BUILDING THROUGH THE PUBLIC STREETS OF THE CITY.

Details of New Work

Size front _____ depth _____ No. stories _____ Height average grade to top of plate 2 1/2'
 To be erected on soil or filled land? _____ earth or rock? _____
 Material of foundation concrete Thickness, top _____ bottom _____
 Material of underpinning _____ Height _____ Thickness _____
 Kind of roof _____ Roof covering _____
 No. of chimneys _____ Material of chimneys _____ of lining _____
 Kind of heat _____ Type of fuel _____ Distance heater to chimney _____
 If oil burner, name and model _____
 Capacity and location of oil tank _____
 Is gas fitting involved? _____ Size of service _____
 Corner posts _____ Sills _____ Girt or ledger board? _____ Size _____
 Material columns under girders _____
 Studs (outside walls and carrying partitions) 2x4-16' O.C. Girders 6x6 or larger Bridging in every floor and flat roof over 8 feet _____ and corner _____ all one piece in cross section
 Joists and rafters _____ 1st floor _____ 2nd _____ 3rd _____ roof _____
 On centers: _____ 1st floor _____ 2nd _____ 3rd _____ roof _____
 Maximum span _____ 1st floor _____ 2nd _____ 3rd _____ roof _____
 If one story building with masonry walls, thickness of walls? _____ height? _____

If a Garage

No. cars now accommodated on same lot none to be accommodated _____
 Total number commercial cars to be accommodated none
 Will automobile repairing be done other than minor repairs to cars habitually stored in the proposed building? no

Miscellaneous

Will above work require removal or cutting of any shade tree on a public street? no
 Plans filed as part of this application? yes No sheets _____
 Estimated cost \$ _____ Fee \$ 50

Will there be in charge of the above work a person competent to see that the State and City requirements pertaining thereto are observed? yes
 Signature of owner Volter E. McIntire

INSPECTOR CBPY

Oliver P. Sullivan

Signature of owner

83

Ward 1 Permit No 28/27

Island As Peaks

Wallis E. M. Intyul

Date of permit 12/25/28

ing-in

Inspn. closing-in

if.

Final Inspn.

Cert. of Occupancy issued

NOV 27

90
0
18

~~Ward
8/16/19~~