

SARGENT ROAD, PEAKS ISLAND

90-D-6

See back of map

FRONT -- WEST

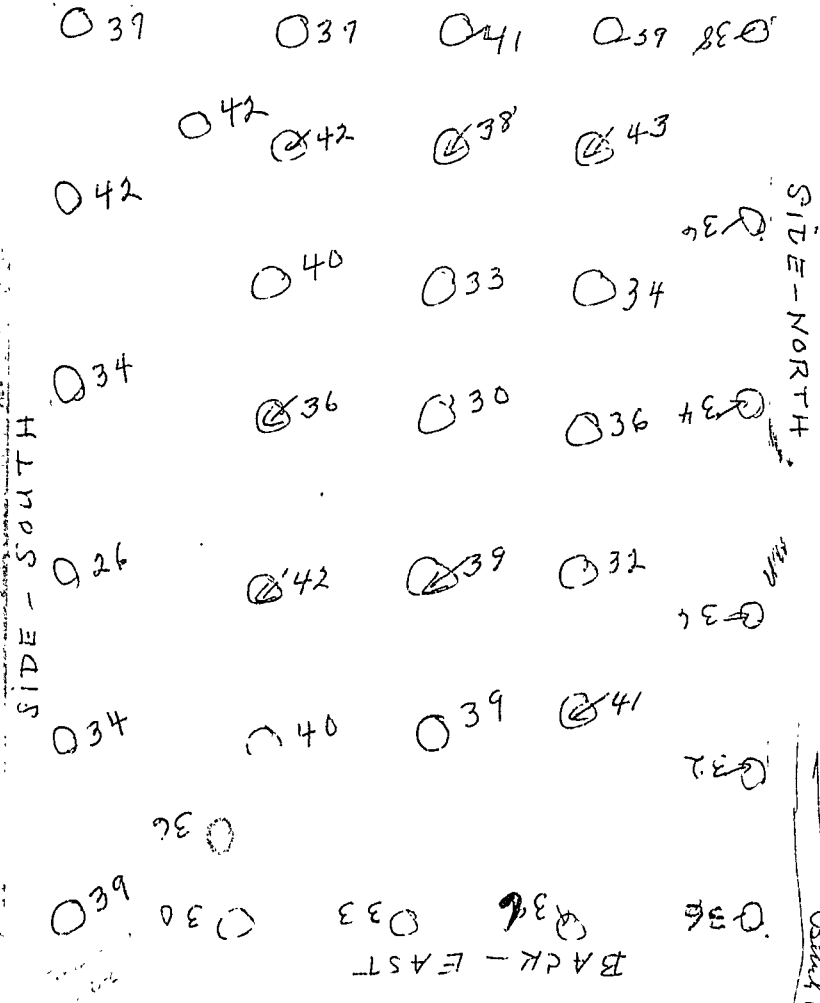

Madeline O'Brien (Mrs. John Q. O'Brien)
 Beach Rd.
 Peaks Island
 Maine

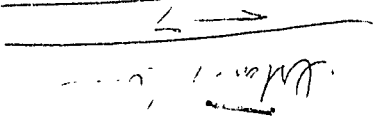

Finis - 1966

C-34-63-I

May 13, 1934

Messrs. Harold W. & Edward B. Lookwood
132 Glenwood Avenue
Portland, Maine

Gentlemen:

We find upon examination that the chimney in the cottage which you are reported to own on Sargent Road, Peaks Island, is in a questionable condition.

The chimney leans badly above the roof, and it has every appearance from the outside of having a break in the masonry or a hole below the roof line.

Please arrange to have this chimney rebuilt, at least, above the roof, and as far down into the building as may be necessary to make the chimney undoubtedly safe and sound on or before June 1st, 1934, this direction being given as authorized and directed by Sections 28, 29, 30, and 32 of Chapter 35, Revised Statutes of Maine, copy attached hereto.

In event it is found necessary to do repair work upon the chimney below the roof, it will be necessary to secure a building permit from this Department to cover the work.

Very truly yours,

Inspector of Buildings.

WJ/HO



(A) APARTMENT HOUSE ZONE PERMIT ISSUED

APPLICATION FOR PERMIT

JUN 22 1934

Class of Building or Type of Structure Third Class

Portland, Maine, June 22, 1934

To the INSPECTOR OF BUILDINGS, PORTLAND, ME.

The undersigned hereby applies for a permit to erect alter install the following building structure equipment in accordance with the Laws of the State of Maine, the Building Code of the City of Portland, plans and specifications, if any, submitted herewith and the following specifications:

Location: Seach Road, Peaks Island Ward 1st 2 Within Fire Limits? no Dist. No. _____
Owner's or Lessee's name and address Harold Lockwood, 15 Balknap St. Telephone 4-4845
Contractor's name and address Owner Telephone _____
Architect's name and address _____
Proposed use of building Cottage No. families _____
Other buildings on same lot _____
Plans filed as part of this application? no No. of sheets _____
Estimated cost \$ 8. Fee \$.25

Description of Present Building to be Altered

Material wood No. stories 1 1/2 Heat stove Style of roof _____ Roofing _____
Last use Cottage No. families _____

General Description of New Work

To top out chimney from a point about a foot below the roof line

NOTIFICATION BEFORE LEAVING
OR CLOSING-IN IS WAIVED.
CERTIFICATE OF OCCUPANCY
REQUIREMENT IS WAIVED.

It is understood that this permit does not include installation of heating apparatus which is to be taken out separately by and in the name of the heating contractor.

Details of New Work

Size, front _____ depth _____ No. stories _____ Height average grade to top of plate _____
To be erected on solid or filled land? _____ earth or rock? _____
Material of foundation _____ Thickness, top _____ bottom _____
Material of underpinning _____ Height _____ Thickness _____
Kind of Roof _____ Rise per foot _____ Roof covering _____
No. of chimneys 1 Material of chimneys brick of lining tile
Kind of heat _____ Type of fuel _____ Is gas fitting involved? _____
Corner posts _____ Sills _____ Girt or ledger board? _____ Size _____
Material columns under girders _____ Size _____ Max. on centers _____
Studs (outside walls and carrying partitions) 2x4-16" C. C. Girders 6x8 or larger. Bridging in every floor and flat roof span over 8 feet. Sills and corner posts all one piece in cross section.
Joists and rafters: 1st floor _____, 2nd _____, 3rd _____, roof _____
On centers: 1st floor _____, 2nd _____, 3rd _____, roof _____
Maximum span: 1st floor _____, 2nd _____, 3rd _____, roof _____
If one story building with masonry walls, thickness of walls? _____ height? _____

If a Garage

No. cars now accommodated on same lot _____ to be accommodated _____
Total number commercial cars to be accommodated _____
Will automobile repair be done other than minor repairs to cars habitually stored in the proposed building? _____

Miscellaneous

Will above work require removal or disturbing of any shade tree on a public street? no
Will there be in charge of the above work a person competent to see that the State and City requirements pertaining thereto are observed? yes
Signature of owner: Harold W. Lockwood

INSPECTION COPY

1/3 28

Ward Dd. 1 Permit No. 34/834

Location Sargeant Rd. Peab.

Owner Harold Lockwood

Date of permit 6/23/34

Not closing-in _____

Ins. closing-in _____

Final Notif. _____

Final Inspn. 8/3/34

Cert. of Occupancy issued None

NOTES

8/3/34 Walden
alg

90
D R
6

