

B

APPLICATION FOR PERMIT

PERMIT ISSUED

B.O.C.A. USE GROUP
B.O.C.A. TYPE OF CONSTRUCTION 00460

MAY 24 1983

ZONING LOCATION PORTLAND, MAINE May 23, 1983

CITY of PORTLAND

To the CHIEF OF BUILDING & INSPECTION SERVICES, PORTLAND, MAINE

The undersigned hereby applies for a permit to erect, alter, repair, demolish, move or install the following building, structure, equipment or change use in accordance with the Laws of the State of Maine, the Portland B.O.C.A. Building Code and Zoning Ordinance of the City of Portland with plans and specifications, if any, submitted herewith and the following specifications:

LOCATION 82-A-5 Lyndon Avenue Peaks Island Fire District #1 #2 #3 Telephone 766-2567

- 1. Owner's name and address William Dunton - same Telephone
2. Lessee's name and address Telephone
3. Contractor's name and address Barry Shaw - Welch St. Peaks Isl. Telephone 766-2677

Proposed use of building Dwelling with fireplace and chimney for stove hookup families 1
Last use summer cottage No. families

Material No. stories Heat Style of roof Roofing
Other buildings on same lot

Estimated contractual cost \$3,000 Appeal Fees \$

FIELD INSPECTOR-Mr. @ 775-5451 Base Fee 25.00

Late Fee
TOTAL \$ 25.00

To construct fireplace and chimney, chimney to be used in connection with wood stove as per plans

Stamp of Special Conditions

send permit to # 3 04108

NOTE TO APPLICANT: Separate permits are required by the installers and subcontractors of heating, plumbing, electrical and mechanicals.

DETAILS OF NEW WORK

Is any plumbing involved in this work? no Is any electrical work involved in this work? no
Is connector to be made to public sewer? If not, what is proposed for sewage?
Has septic tank notice been sent? Form notice sent?
Height average grade to top of plate Height average grade to highest point of roof
Size, front depth No. stories solid or filled land? earth or rock?
Material of foundation Thickness, top bottom cellar
Kind of roof Rise per foot Roof covering
No. of chimneys Material of chimneys of lining Kind of heat fuel
Framing Lumber-Kind Dressed or full size? Corner posts Sills
Size Girder Columns under girders Size Max. on centers
Studs (outside walls and carrying partitions) 2x4-16" O. C. Bridging in every floor and flat roof span over 8 feet.
Joists and rafters: 1st floor 2nd 3rd roof
On centers: 1st floor 2nd 3rd roof
Maximum span: 1st floor 2nd 3rd roof
If one story building with masonry walls, thickness of walls? height?

IF A GARAGE

No. cars now accommodated on same lot to be accommodated number commercial cars to be accommodated
Will automobile repairing be done other than minor repairs to cars habitually stored in the proposed building?

APPROVALS BY: DATE MISCELLANEOUS no
BUILDING INSPECTION-PLAN EXAMINER Will work require disturbing of any tree on a public street?
ZONING:
BUILDING CODE: Will there be in charge of the above work a person competent to see that the State and City requirements pertaining thereto are observed? yes
Fire Dept.:
Health Dept.:
Others:

Signature of Applicant Barry Shaw for William Dunton Phone # name
Type Name of above 1 2 3 4

7

Other and Address

FIELD INSPECTOR'S COPY

APPLICANT'S COPY

OFFICE FILE COPY

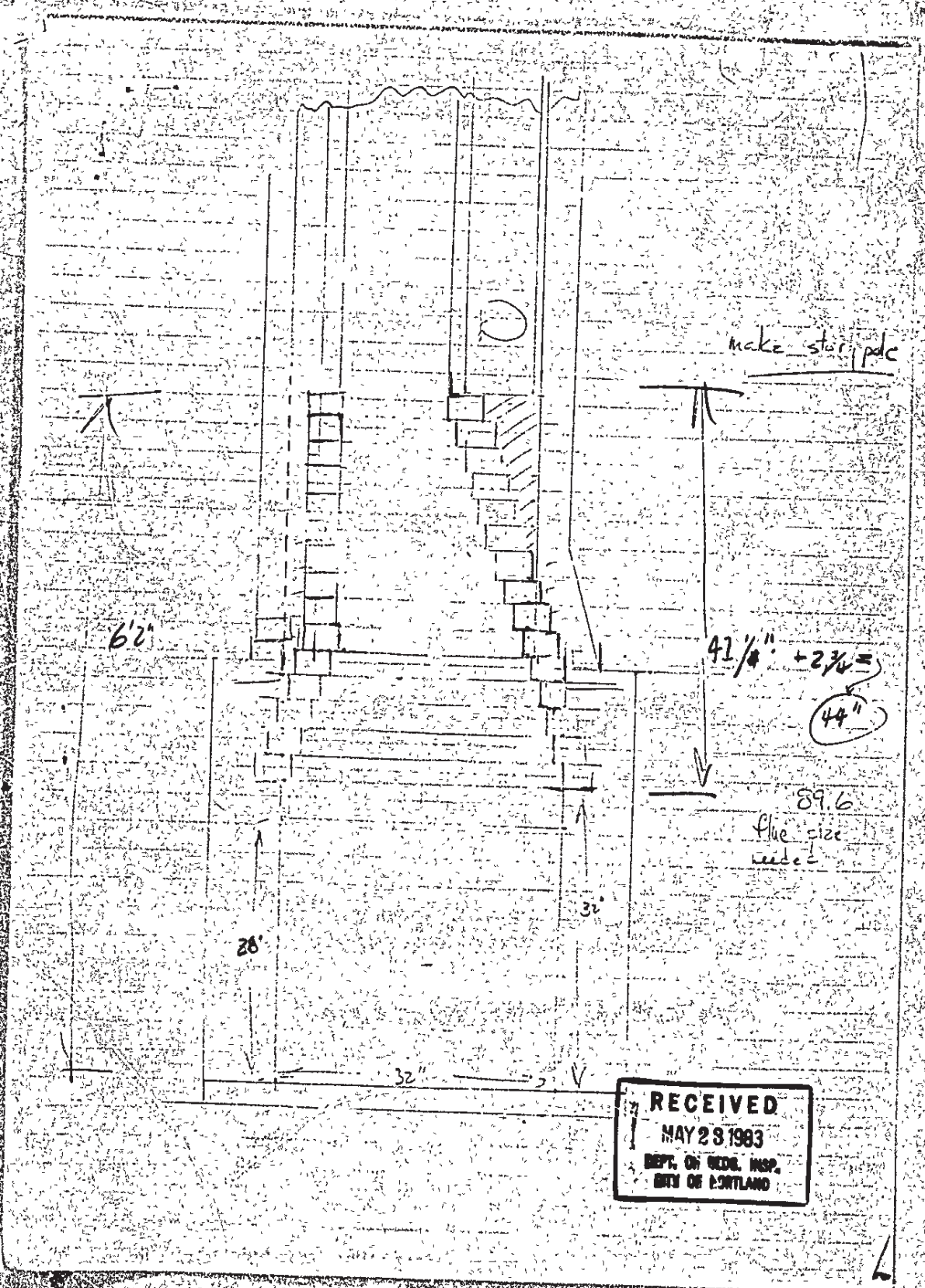

A) detail of chimney through ceiling

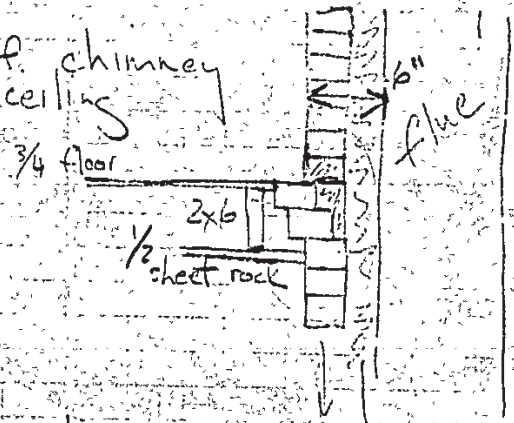

① open spaces in chimney to be filled w/vermiculite

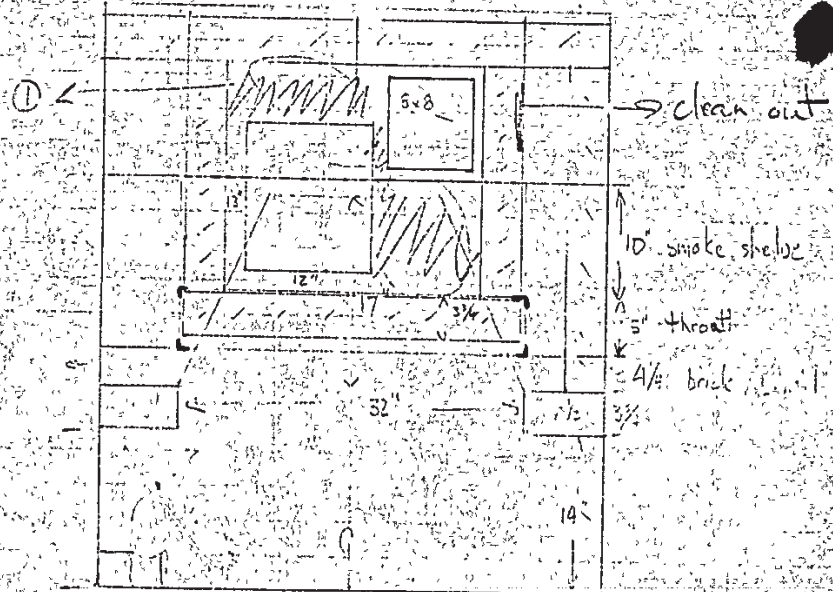

RECEIVED
 MAY 23 1983
 DEPT. OF BECS. HSP.
 CITY OF PORTLAND

Russian fireplace
no clearouts

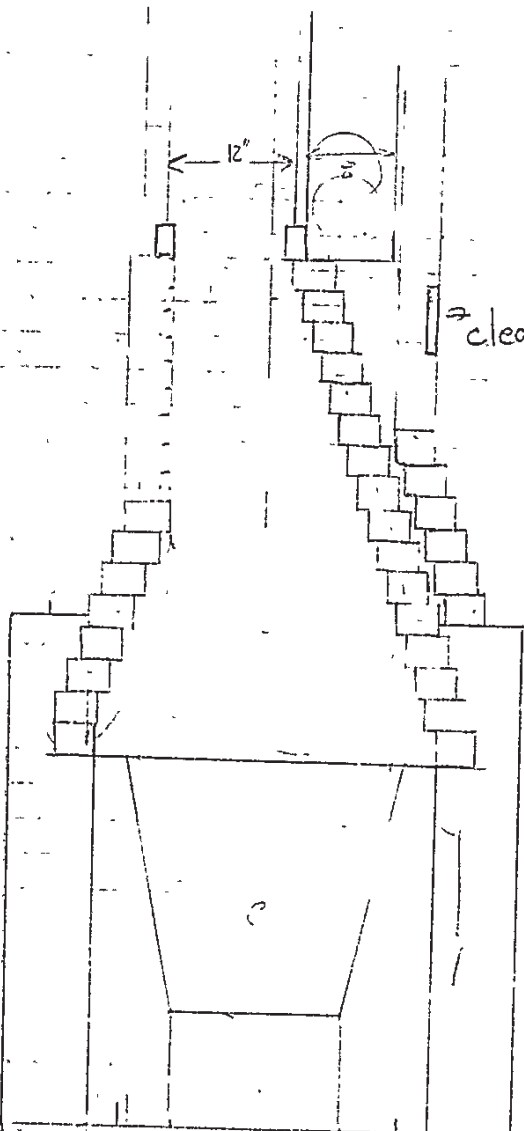

clean out 6 1/2 starts
flue

8x8x16 Block

RECEIVED
MAY 23 1983
DEPT. OF BLDG. INSB.
CITY OF PORTLAND

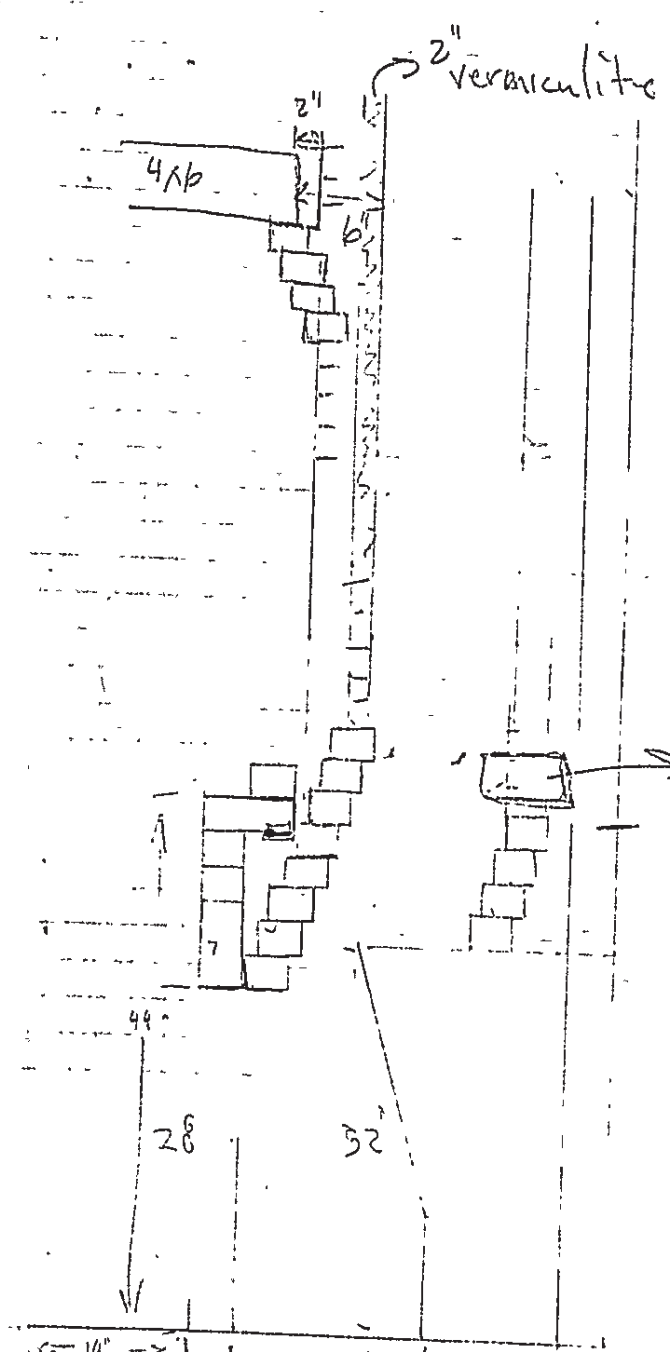

Side view
expansion chamber

clean out for
8x8 sleeves for
(8x8 door) damper chain

1) Step ladder

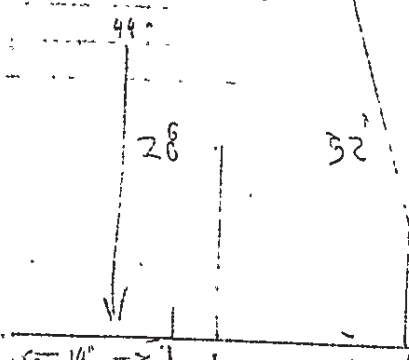

14" →
Building Block 48x48
8x8x16
down 4' to ledge

RECEIVED
MAY 23 1993
DEPT. OF BLDG. INSP.
CITY OF PORTLAND

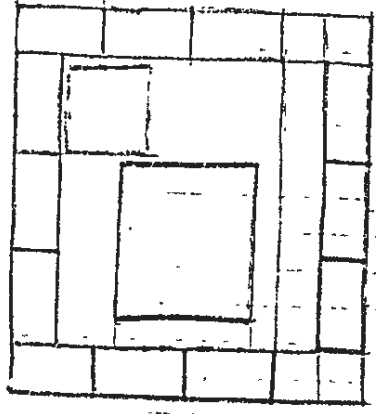

Can I start wall on corner?
ask David

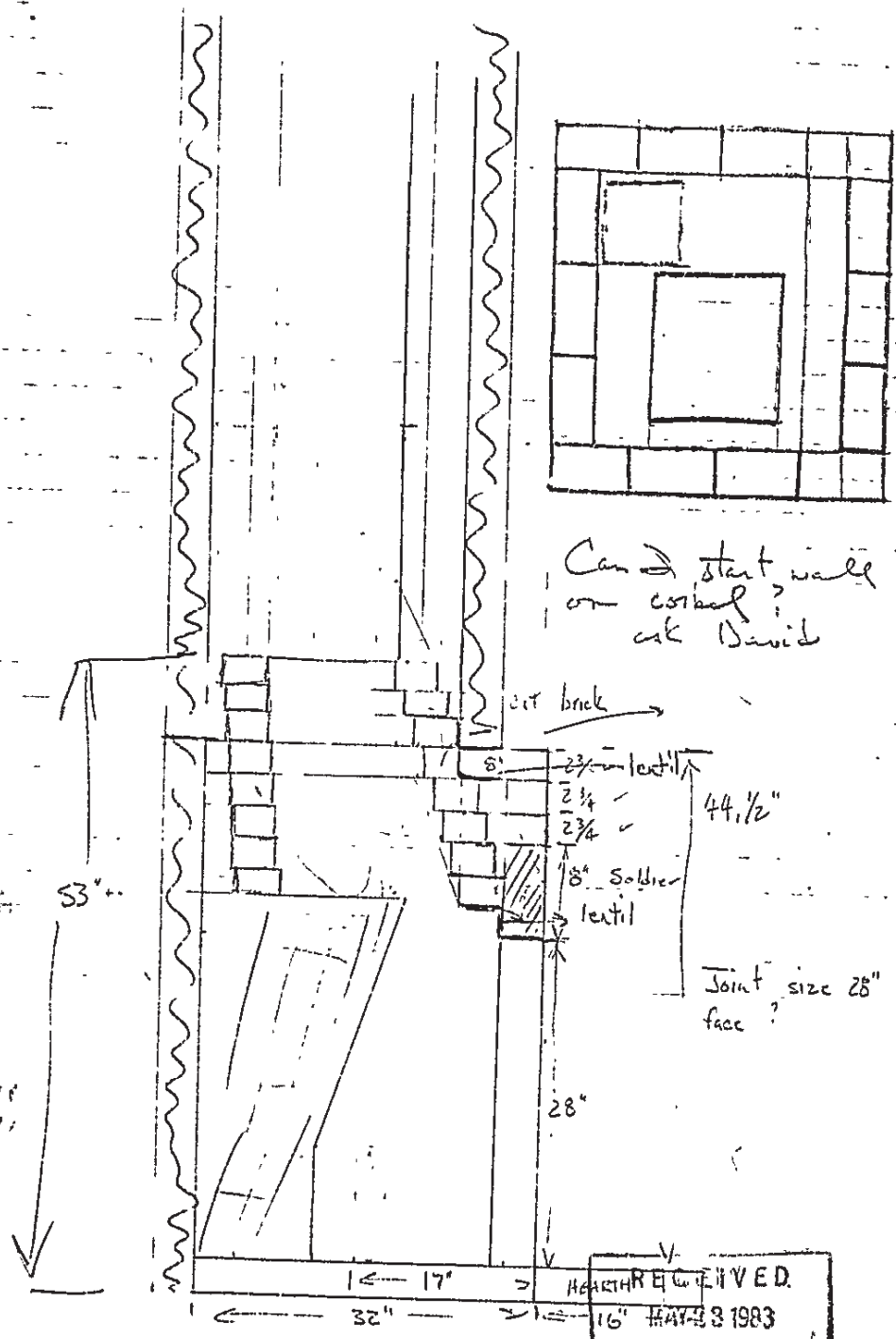

53"
1 1/2"
16" distance

RECEIVED
MAY 23 1983
DEPT. OF BLDG. INSP.
CITY OF PORTLAND

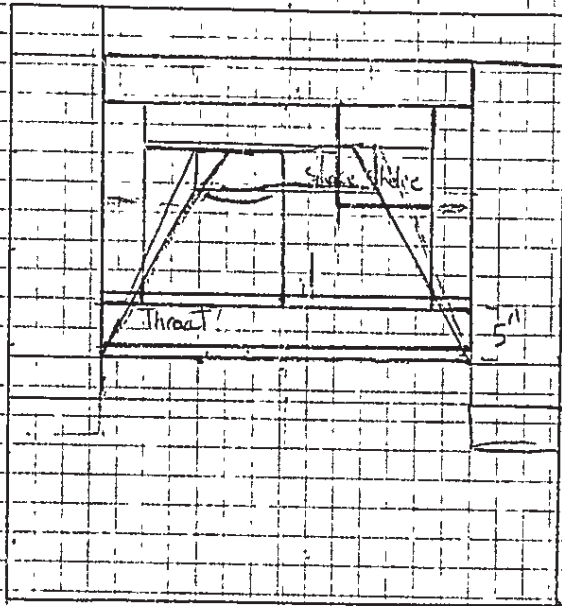

Step in 5" front
" " 3 1/2" L. side
" " 1 1/2" R. side
vermiculite 20' s

52.5
60
64
176.5

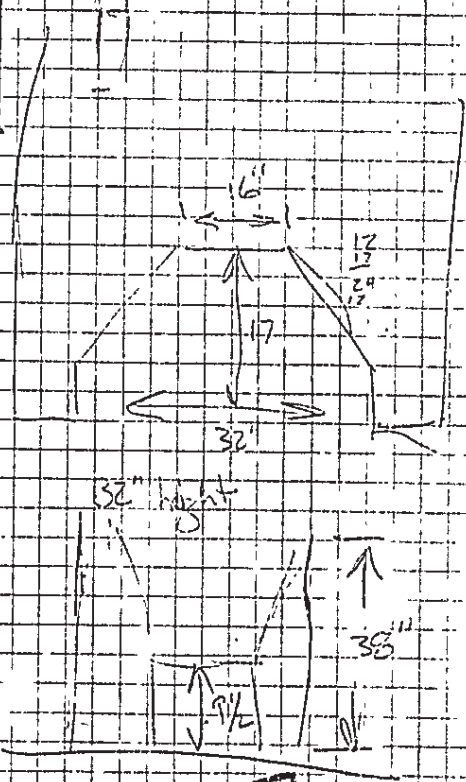
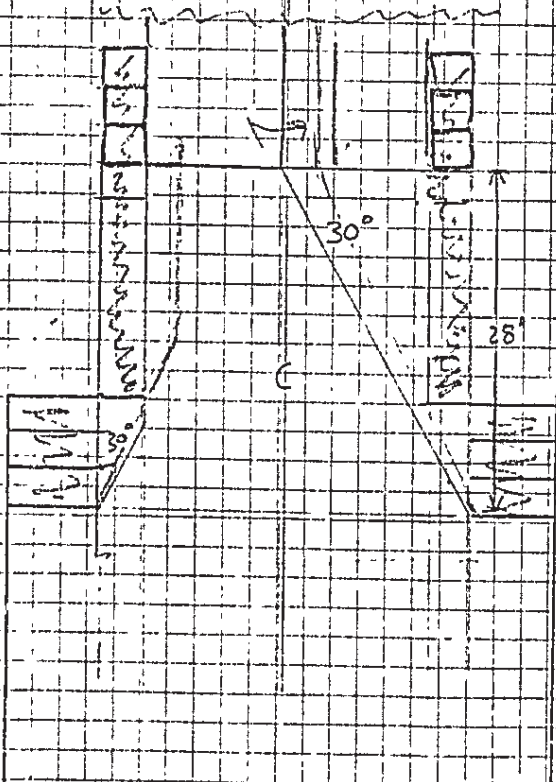

RECEIVED
MAY 23 1983
DEPT. OF BLDG. INSP.
CITY OF PORTLAND

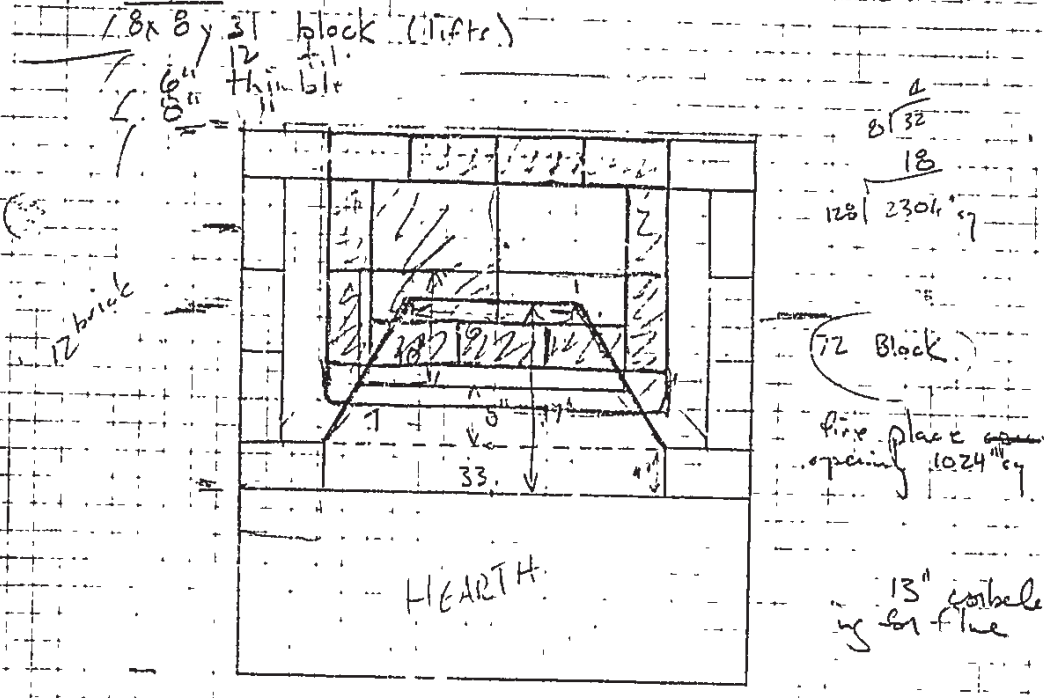
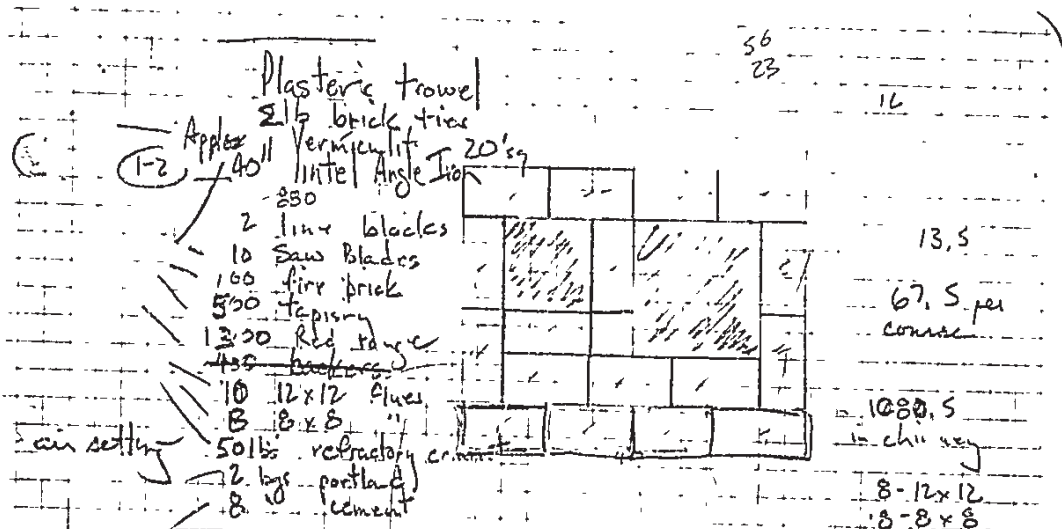

RECEIVED
 MAY 23 1933
 DEPT. OF BLDG INSP.
 CITY OF PORTLAND

1) Mat'l List

- 1300 - brick
- 800 - "
- 10 - 12x12 flues
- 12 - 8 - 8x8 flues
- 20 sq. Vermiculite
- 50 lbs Refractory Cement (air setting)
- 8 bags masonry "
- 2 bags Portland "
- 10 fire brick
- 10 Saw blades
- 2 lbs brick ties
- 31 8x8 chimney lifts
- 6" thimble
- 8" "
- 38" Intel Angle Iron
- line blocks
- Plaster's trowel
- office Supplies
- weight slip

16 3.15
 T 4.30
 6" 3.50
 8" 7
 164
 + 186

5/1

Yes Delivery

72 concrete blocks

- 54 8x8x16 Block
- 8 Corners
- 18 4x8x16 solids
- \$ 41.58
- 24x9
- 30x9
- 36x9
- 42x9
- 48
- 54
- 60
- 72

RECEIVED
 MAY 28 1983
 DEPT. OF P.D. - INSP.
 CITY OF PORTLAND

Bill Burton

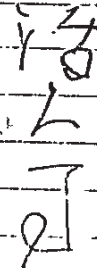

Measure Form (foundation)

⊙ " floor
" wall
" height

$\frac{12}{72}$ $\frac{3}{18}$

w
 $4\frac{1}{2}$ " x $4\frac{1}{2}$ "
32" to floor

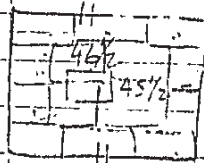

14" for Brick
Hearth

3 9' " 1st floor
7'6" 2nd "
5' attic

$16\frac{1}{2}$ x 28



$4\frac{1}{2}$ x 48 brick hearth for
stove

oil

4' roof
cap

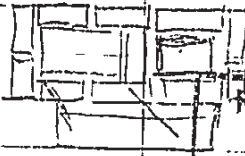

14

RECEIVED
MAY 23 1983
DEPT. OF BLDG. INSP.
CITY OF PORTLAND

Buntan's Fireplace

May 8

- (1) 5/9] Bill Bill to hold up framing 2nd floor ceiling
Le. change order matl - L.O.B.
delivery sch.
Plan unloading
* Matl in brick in truck to order
* Collect money for Diamond Matl

Gavel
Size

- 2) 5/10] a) Unload + pay for Matl -
b) Get ladder + hose from J+A
c) Placement of Matl - Bill work areas
* d) Matl from town - Ted's Van
1) wheelbarrow
2) Jacks and Vacuum
e) ~~Develop~~ Work Plans
Develop

- 3) 5/11] a) Lay block

RECEIVED
MAY 23 1983
DEPT. OF BLDG. INSP.
CITY OF PORTLAND

APPLICATION FOR PERMIT

B.O.C.A. USE GROUP
 B.O.C.A. TYPE OF CONSTRUCTION **00460**
 ZONING LOCATION PORTLAND, MAINE May 23, 1983

PERMIT ISSUED
 MAY 24 1983
 CITY OF PORTLAND

To the CHIEF OF BUILDING & INSPECTION SERVICES, PORTLAND, MAINE

The undersigned hereby applies for a permit to erect, alter, repair, demolish, move or install the following building, structure, equipment or change use in accordance with the Laws of the State of Maine, the Portland B.O. C.A. Building Code and Zoning Ordinance of the City of Portland with plans and specifications, if any, submitted herewith and the following specifications:

LOCATION **89-A-5 Lyndon Avenue, Peaks Island** Fire District #1 #2
 1. Owner's name and address **William Bunton - same** Telephone **766-2567**
 2. Lessee's name and address Telephone
 3. Contractor's name and address **Barry Shaw - Welch St. Peaks Isl.** Telephone **766-2677**
 Proposed use of building **dwelling with fireplace and chimney for stove hookup** No. of sheets
 Last use **(summer cottage)** No. families **1**
 Material No. stories Heat Style of roof Roofing
 Other buildings on same lot
 Estimated contractual cost \$ **3,000** Appeal Fees \$
 FIELD INSPECTOR—Mr. Base Fee **25.00**
 @ 775-5451 Late Fee
 TOTAL \$ **25.00**

To construct fireplace and chimney, chimney to be used in connection with wood stove as per plans
 send permit to # 3 04108

Stamp of Special Conditions

NOTE TO APPLICANT: Separate permits are required by the installers and subcontractors of heating, plumbing, electrical and mechanicals.

DETAILS OF NEW WORK

Is any plumbing involved in this work? **no** Is any electrical work involved in this work? **no**
 Is connection to be made to public sewer? If not, what is proposed for sewage?
 Has septic tank notice been sent? Form notice sent?
 Height average grade to top of plate Height average grade to highest point of roof
 Size, front depth No. stories solid or filled land? earth or rock?
 Material of foundation Thickness, top bottom cellar
 Kind of roof Rise per foot Roof covering
 No. of chimneys Material of chimneys of lining Kind of heat fuel
 Framing Lumber—Kind Dressed or full size? Corner posts Sills
 Size Girder Columns under girders Size Max. on centers
 Studs (outside walls and carrying partitions) 2x4-16" O. C. Bridging in every floor and flat roof span over 8 feet.
 Joists and rafters: 1st floor 2nd 3rd roof
 On centers: 1st floor 2nd 3rd roof
 Maximum span: 1st floor 2nd 3rd roof
 If one story building with masonry walls, thickness of walls? height?

IF A GARAGE

No. cars now accommodated on same lot to be accommodated number commercial cars to be accommodated
 Will automobile repairing be done other than minor repairs to cars habitually stored in the proposed building?

APPROVALS BY: **DATE** **MISCELLANEOUS**
 BUILDING INSPECTION—PLAN EXAMINER Will work require disturbing of any tree on a public street? **no**
 ZONING:
 BUILDING CODE: Will there be in charge of the above work a person competent
 Fire Dept.: to see that the State and City requirements pertaining thereto
 Health Dept.: are observed? **yes**.
 Others:

Signature of Applicant **Barry Shaw** Phone # **same**
 Type Name of above **Barry Shaw for William Bunton** 1 2 3 4
 Other
 and Address

FIELD INSPECTOR'S COPY APPLICANT'S COPY OFFICE FILE COPY
 [7] MA. Addg P

Permit No. 83 / 460

Location 89A-5 Lyndon Ave. Phelps, D.C.

Owner William Smater

Date of permit 5-23-83

Approved 5-24-83

Dwelling W/porch & chimney

Garage

Alteration

NOTES

*8-20-83 - Work allowed
completed within permit
taken in S. Park completed
C.H.*