

Permit # 900012 City of Portland BUILDING PERMIT APPLICATION Fee \$25.00 Zone \_\_\_\_\_ Map # \_\_\_\_\_ Lot# \_\_\_\_\_  
 Please fill out any part which applies to job. Proper plans must accompany form.

Owner: Catherine Plante (mail permit) Phone # 766-2508  
 Address: 93 Island Avenue Pezke Island, 04105  
 LOCATION OF CONSTRUCTION 98 Island Ave P.T. 87-00-31  
 Contractor: Self Sub: \_\_\_\_\_  
 Address: \_\_\_\_\_ Phone # \_\_\_\_\_  
 Est. Construction Cost: \_\_\_\_\_ Proposed Use: Single Family  
 Past Use: Single Family  
 # of Existing Res. Units \_\_\_\_\_ # of New Res. Units \_\_\_\_\_  
 Building Dimensions L \_\_\_\_\_ W \_\_\_\_\_ Total Sq. Ft. \_\_\_\_\_  
 # Stories: \_\_\_\_\_ # Bedrooms \_\_\_\_\_ Lot Size: \_\_\_\_\_  
 Is Proposed Use: Seasonal \_\_\_\_\_ Condominium \_\_\_\_\_ Conversion \_\_\_\_\_  
 Explain Conversion To erect fire escape and landing and stairway to

For Official Use Only	
Date: <u>January 3, 1990</u>	Subdiv. Name: _____
Insist. Fire Limit: _____	Lot: _____
Bldg Code: _____	Ownership: _____ Public _____ Private _____
Time Limit: _____	Estimated Cost: <u>\$500.00</u>

Zoning: IR  
 Street Frontage Provided: \_\_\_\_\_  
 Provided Setbacks: Front \_\_\_\_\_ Back \_\_\_\_\_ Side \_\_\_\_\_ Set \_\_\_\_\_  
 Ref. by Required: variance approved - see file  
 Zoning Board Approval: Yes \_\_\_\_\_ No \_\_\_\_\_ Date: \_\_\_\_\_  
 Planning Board Approval: Yes \_\_\_\_\_ No \_\_\_\_\_ Date: \_\_\_\_\_  
 Conditional Use: \_\_\_\_\_ Variance \_\_\_\_\_ Site Plan \_\_\_\_\_ Subdivision \_\_\_\_\_  
 Shoreland Zoning Yes \_\_\_\_\_ No \_\_\_\_\_ Floodplain Yes \_\_\_\_\_ No \_\_\_\_\_  
 Special Exception \_\_\_\_\_  
 Other (Explain): \_\_\_\_\_

Foundation: \_\_\_\_\_ as per plan

- Type of Soil: \_\_\_\_\_
- Set Backs - Front \_\_\_\_\_ Rear \_\_\_\_\_ Side(s) \_\_\_\_\_
- Footings Size: \_\_\_\_\_
- Foundation Size: \_\_\_\_\_
- Other: \_\_\_\_\_

Floors:

- Sills Size: \_\_\_\_\_ Sills must be anchored.
- Girders Size: \_\_\_\_\_
- Lally Column Spacing: \_\_\_\_\_ Size: \_\_\_\_\_
- Joists Size: \_\_\_\_\_ Spacing: 16" O.C.
- Bridging Type: \_\_\_\_\_ Size: \_\_\_\_\_
- Floor Sheathing Type: \_\_\_\_\_ Size: \_\_\_\_\_
- Other Material: \_\_\_\_\_

Exterior Walls:

- Studding Size \_\_\_\_\_ Spacing \_\_\_\_\_
- No. windows \_\_\_\_\_
- No. Doors \_\_\_\_\_
- Header Sizes \_\_\_\_\_ Span(s) \_\_\_\_\_
- Bracing: Yes \_\_\_\_\_ No \_\_\_\_\_
- Corner Posts Size \_\_\_\_\_
- Insulation Type \_\_\_\_\_ Size \_\_\_\_\_
- Sheathing Type \_\_\_\_\_ Size \_\_\_\_\_
- Siding Type \_\_\_\_\_ Weather Exposure \_\_\_\_\_
- Masonry Materials \_\_\_\_\_
- Metal Materials \_\_\_\_\_

Interior Walls:

- Studding Size \_\_\_\_\_ Spacing \_\_\_\_\_
- Header Sizes \_\_\_\_\_ Span(s) \_\_\_\_\_
- Wall Covering Type \_\_\_\_\_
- Fire Wall if required \_\_\_\_\_
- Other Materials \_\_\_\_\_

Ceiling:  
 1. Ceiling Joists Size: \_\_\_\_\_  
 2. Ceiling Strapping Size \_\_\_\_\_ Spacing: \_\_\_\_\_  
 3. Type Ceilings: \_\_\_\_\_  
 4. Insulation Type \_\_\_\_\_ Size \_\_\_\_\_  
 5. Ceiling Height: \_\_\_\_\_

Roof:  
 1. Truss or Rafter Size: \_\_\_\_\_  
 2. Sheathing Type: \_\_\_\_\_  
 3. Roof Covering Type: \_\_\_\_\_

Chimneys:  
 Type: \_\_\_\_\_ Number of Fire Places \_\_\_\_\_

Heating:  
 Type of Heat: \_\_\_\_\_

Electrical:  
 Service Entrance Size: \_\_\_\_\_ Smoke Detector Required Yes \_\_\_\_\_ No \_\_\_\_\_

Plumbing:  
 1. Approval of soil test if required \_\_\_\_\_  
 2. No. of Tubs or Showers \_\_\_\_\_  
 3. No. of Flushes \_\_\_\_\_  
 4. No. of Lavatories \_\_\_\_\_  
 5. No. of Other Fixtures \_\_\_\_\_

Swimming Pools:  
 1. Type: \_\_\_\_\_  
 2. Pool Size: \_\_\_\_\_ x \_\_\_\_\_ Square Footage \_\_\_\_\_  
 3. Must conform to National Electrical Code and State Law.

Permit Received By: Plante

Signature of Applicant: \_\_\_\_\_ Date: 1/4/90

Signature of CEO: \_\_\_\_\_ Date: \_\_\_\_\_

Inspection Dates: \_\_\_\_\_

**PERMIT ISSUED WITH LETTER**

PLOT PLAN

N



**FEES (Breakdown From Front)**  
Base Fee \$ 25.00  
Subdivision Fee \$ \_\_\_\_\_  
Site Plan Review Fee \$ \_\_\_\_\_  
Other Fees \$ \_\_\_\_\_  
(Explain) \_\_\_\_\_  
Lots Fee \$ \_\_\_\_\_

Type

Inspection Record

Date

Type	Inspection Record	Date
_____	_____	____/____/____
_____	_____	____/____/____
_____	_____	____/____/____
_____	_____	____/____/____

COMMENTS

As per plans

3-16-90 - checked site OK NP 02

Signature of Applicant

Catherine S. Plant

Date January 4, 1990



CITY OF PORTLAND, MAINE

389 CONGRESS STREET  
PORTLAND, MAINE 04101  
(207) 874-8300

DEPARTMENT OF PLANNING & URBAN DEVELOPMENT

P. SAMUEL HOFFSES, CHIEF  
INSPECTION SERVICES DIVISION

98 Island Avenue, Peaks Island

8 January 1990

Catherine Plante  
98 Island Avenue  
Peaks Island ME 04108

Dear Madam:

Your application to erect a fire escape has been reviewed and a permit is herewith issued subject to the following requirements:

1. The fire escape shall be designed to support a live load of 100 pounds per square foot. Fire escape to be constructed of wood not less than 4" thick.
2. Stairs shall be at least 22" wide with risers not more than 8" and treads not less than 8". Landings at the foot of the stairs shall not be less than 40" wide x 36" long and located not more than 8" below the access window or door.

NO CERTIFICATE OF OCCUPANCY CAN BE ISSUED UNTIL ALL REQUIREMENTS OF THIS LETTER ARE MET.

If you have any questions regarding these requirements please do not hesitate to contact this office.

Sincerely,

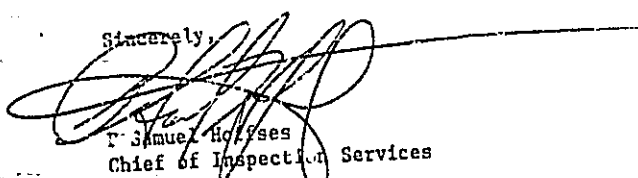
  
P. Samuel Hoffses  
Chief of Inspection Services

/s/

PLAN FOR LIVING ROOM  
ISLAND AVE. PEAK ISLAND

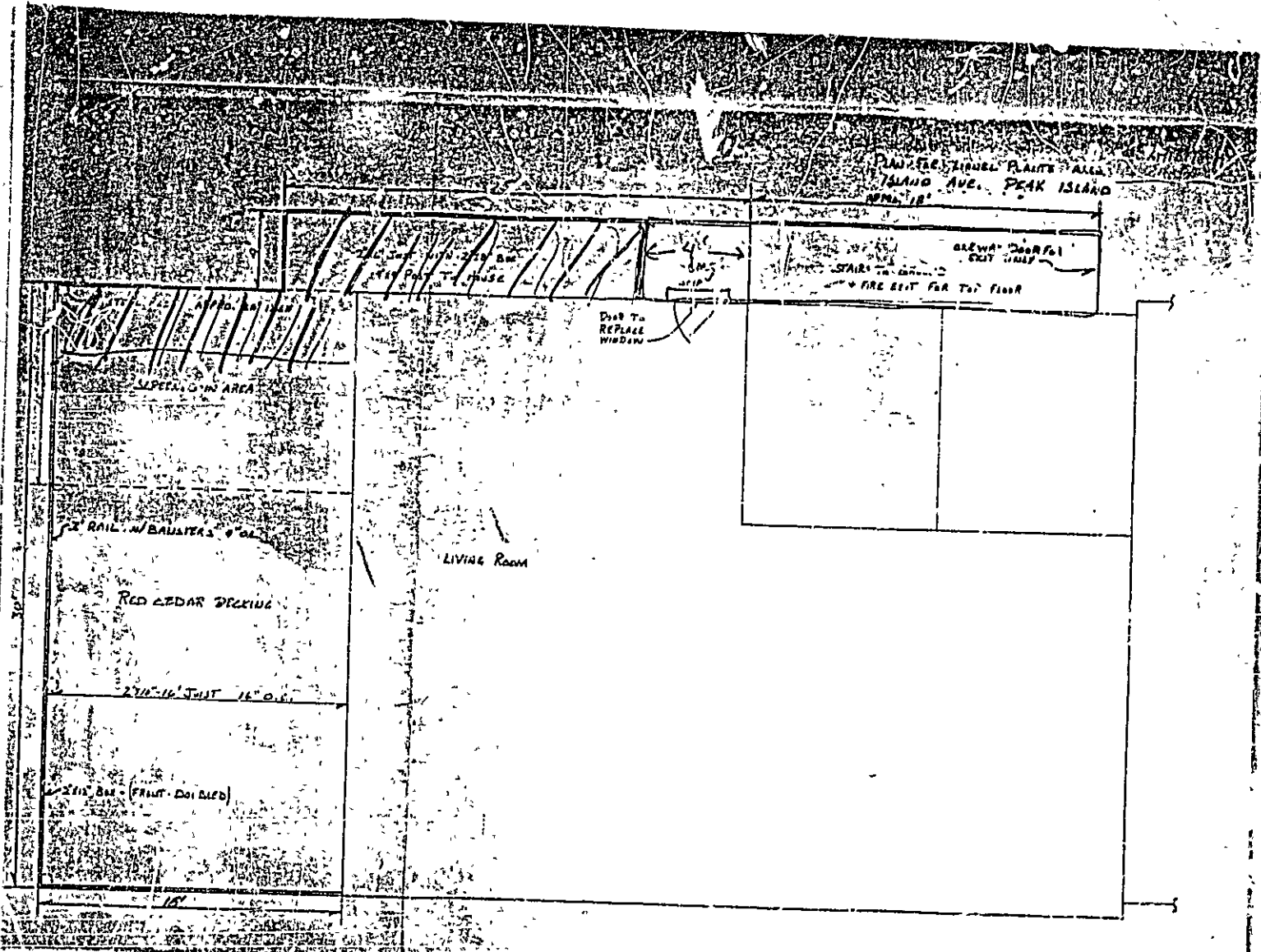

GLASS DOOR FOR  
EXIT ONLY

STAIRS TO GARAGE  
FIRE EXIT FOR TOP FLOOR

Door To  
REPLACE  
WINDOW

LIVING ROOM

RED CEDAR DINING

2x10' - 16' JUST 16" O.S.

2x10' BAR - (FRONT DOOR BLDG)

ALPESIAN OAK AREA

RAIL IN BAULTAS 4' ON

PERMIT TOWN OF Portland BUILDING PERMIT APPLICATION MAP # LOT#

Please fill out any part which applies to job. Proper plans must accompany form.

Permit # \_\_\_\_\_ Planter \_\_\_\_\_

Address 98 Island Avenue, P.I. 766-2507

LOCALITY OF CONSTRUCTION 98 Island Avenue, P.I. 87-00-31

CONTRACTOR Pradette Construction CONTRACTORS:

ADDRESS Biddeford, Maine

Construction Cost 2500.00 Type of Use R.F.

Use Room Finishing, Noncomb. hulf-laundrymat

Building Dimensions L 30' W 60' Sq. Ft. # Stories 1 Lot Size:

Is Proposed Use: Season 1 Condominium Apartment

Conversion Exply Variance Appeal

COMPLETE ONLY IF THE NUMBER OF UNITS WILL CHANGE

Residential Building Only

# Of Dwelling Units # Of New Dwelling Units

Foundation

1. Type of Soil
2. Set Backs - Front Rear Side(s)
3. Footings Size
4. Foundation Size
5. Other

Floor

1. Sill Size: Sills must be anchored.
2. Girder Size
3. Lally Column Spacing: Size:
4. Joist Size: Spacing 16" O.C.
5. Beaming Type: Size:
6. Floor Sheathing Type: Size:
7. Other Material:

Exterior Wall:

1. Studding Size Spacing
2. No. Windows
3. No. Doors
4. Header Size Spacing
5. Bracing: Yes No
6. Corner Posts Size
7. Insulation Type Size
8. Sheathing Type Size
9. Siding Type Weather Exposure
10. Masonry Material
11. Metal Materials

Interior Wall:

1. Studding Size Spacing
2. Header Size Spacing
3. Wall Covering Type
4. Fire Wall
- Other materials

**For Official Use Only**

Date 10/16/89 Subdivision: Yes / No

Inside Fire Limits Name

Blg Code Lot

Time Limit 2500.00 Block

Estimated Cost Permit Expiration

Value Structure 30.00 Ownership Public Private

Fees

**Ceiling:**

1. Ceiling Joists Size: Spacing
2. Ceiling Strapping Size Spacing
3. Type Ceiling:
4. Insulation Type Size
5. Ceiling Height

**Roof:**

1. Truss or Rafter Size Span
2. Sheathing Type Size
3. Roof Covering Type
4. Other

**Chimneys:**

Type: Number of Fire Places

**Heating:**

Type of Heat:

**Electrical:**

Service Entrance Size: Smoke Detector Required Yes No

**Plumbing:**

1. Approval of soil test if required Yes No
2. No. of Tubs or Showers
3. No. of Flushes
4. No. of Lavatories
5. No. of Other Fixtures

**Swimming Pool:**

1. Type:
2. Pool Size: x Square Footage
3. Must conform to National Electrical Code and State Law.

**Zoning:**

District: Street Frontage Req: Provided

Required Setbacks: Front Back Side Side

**Review Required:**

Zoning Board Approval: Yes No Date

Planning Board Approval: Yes No Date

Conditional Use: Variance Site Plan Subdivision

Shore and Floodplain Mgmt. Special Exception

Other (explain)

D to App val

Permit Received By F. Marquis

Signature of Applicant: Date 10-16-89

Signature of CEO: Date

Inspection Dates

Special sustained

PLOT PLAN



FEES (Break down From Front)

Base Fee \$ \_\_\_\_\_

Subdivision Fee \$ \_\_\_\_\_

Site Plan Review Fee \$ \_\_\_\_\_

Other Fees \$ \_\_\_\_\_

(Explain) \_\_\_\_\_

Late Fee \$ \_\_\_\_\_

Type	Inspection Record	Date
_____	_____	____/____/____
_____	_____	____/____/____
_____	_____	____/____/____
_____	_____	____/____/____

COMMENTS *3-26-91 completed all site plan*

\_\_\_\_\_  
 \_\_\_\_\_  
 \_\_\_\_\_  
 \_\_\_\_\_  
 \_\_\_\_\_

Signature of Applicant *[Signature]* Date *1-16-99*