

ISLAND AVE., PEAKS ISLAND

87-00-26

PERMIT TO INSTALL PLUMBING

87/00/26

13017
PERMIT NUMBER

Date Issued 7-12-63
PORTLAND PLUMBING INSPECTOR

Address Inland Avenue, P.I.

Installation For: Francis Haigney

Owner of Bldg: Francis Haigney

Owner's Address: Inland Avenue, P.I.

Plumbers: Harold F. Bent

Date: 7-12-63

By J. P. Welch

APPROVED FIRST INSPECTION

Date 7-22-63

By J. P. Welch
APPROVED FINAL INSPECTION

Date 7-22-63
By JOSEPH E. WELCH

- By TYPE OF BUILDING
- COMMERCIAL
 - RESIDENTIAL
 - SINGLE
 - MULTI FAMILY
 - NEW CONSTRUCTION
 - REMODELING

NEW		REPL	PROPOSED INSTALLATIONS	NUMBER	FEE
			SINKS		
			LAVATORIES		
			TOILETS		
			BATH TUBS		
			SHOWERS		
			DRAINS		
			HOT WATER TANKS		
			TANKLESS WATER HEATERS		
			GARBAGE GRINDERS		
			SEPTIC TANKS		
			HOUSE SEWERS		
			ROOF LEADERS (Conn. to house drain)	1	\$ 2.00
1			Washer		
TOTAL				1	\$ 2.00

PORTLAND HEALTH DEPT. PLUMBING INSPECTION TOTAL ▶ \$ 2.00

PORTLAND HEALTH DEPT. PLUMBING INSPECTION TOTAL ▶ \$ 4.00

PORTLAND HEALTH DEPT. PLUMBING INSPECTION TOTAL ▶ \$ 10.00

REMODELING

INSPECTION WORKING DRAWINGS
 PERMIT TO INSTALL PLUMBING
 307

PERMIT TO INSTALL PLUMBING

12574

Date Issued: 3-15-63
 PORTLAND PLUMBING INSPECTOR
 By: J. P. Welch
 APPROVED FIRST INSPECTION
 Date: 7-22-63
 By: [Signature]
 APPROVED FINAL INSPECTION
 Date: [Blank]
 By: JOSEPH P. WELCH
 TYPE OF BUILDING
 COMMERCIAL
 RESIDENTIAL
 SINGLE
 MULTI FAMILY
 NEW CONSTRUCTION
 REMODELING

Address: Island Avenue, Peake Island
 Installation For: Andrew Hoigney
 Owner of Bldg.: Andrew Hoigney
 Owner's Address: Washington D.C.
 Plumber: Harold F. Bent
 Date: 3-15-63

NEW	REPL	PROPOSED INSTALLATIONS	NUMBER	FEE
	1	SINKS	1	2.00
		LAVATORIES		
		TOILETS		
		BATH TUBS		
		SHOWERS		
		DRAINS		
		HOT WATER TANKS		
		TANKLESS WATER HEATERS	1	2.00
		GARBAGE CRINDERS		
		SEPTIC TANKS		
		HOUSE SEWERS		
		ROOF LEADERS (Conn. to house drain)		

PORTLAND HEALTH DEPT. PLUMBING INSPECTION TOTAL ▶ \$ 4.00
 PORTLAND HEALTH DEPT. PLUMBING INSPECTION TOTAL ▶ \$10.00

LOS ANGELES COUNTY DEPT. OF PUBLIC WORKS PLUMBING INSPECTION

100-11-10

LOS ANGELES COUNTY DEPT. OF PUBLIC WORKS PLUMBING INSPECTION

100-11-10

100-11-10

J. P. Welch

APPROVED FINAL INSPECTION

APPROVED FIRST INSPECTION

100-11-10

OWNER'S ADDRESS
Island Avenue, P. I.
Andrew Hainoy
Washington D. C.

12523

PERMIT NUMBER

PERMIT TO INSTALL PLUMBING

Date Issued 2-20-63

By J. P. Welch

Date 2-22-63

By *J. P. Welch*

Date JOSEPH E. WELCH

- COMMERCIAL
- RESIDENTIAL
- SINGLE
- MULTI FAMILY
- NEW CONSTRUCTION
- REMODELING

Address: Island Avenue, P. I.
 Application For: Andrew Hainoy
 Owner of Bldg.: Andrew Hainoy
 Owner's Address: Washington D. C.
 Plumber: Harold F. Bent
 Date: 2-20-63

NEW	REPL.	PROPOSED INSTALLATIONS	FEE	
			NUMBER	FEE
		SINKS	1	\$ 2.00
	1	LAVATORIES	2	4.00
	2	TOILETS	1	2.00
	1	BATH TUBS		
		SHOWERS		
		DRAINS		
	1	HOT WATER TANKS	1	2.00
		TANKLESS WATER HEATERS		
		GARBAGE GRINDERS		
		SEPTIC TANKS		
		HOUSE SEWERS		
		POOP LEADERS (Conn to house drain)		

TOTAL \$10.00

PORTLAND HEALTH DEPT. PLUMBING INSPECTION



APPLICATION FOR PERMIT

R3 RESIDENCE ZONE

PERMIT ISSUED
01536

NOV 20 1962

CITY of PORTLAND

Class of Building or Type of Structure Second Class
Portland, Maine, November 20, 1962

To the INSPECTOR OF BUILDINGS, PORTLAND, MAINE

The undersigned hereby applies for a permit to erect alter repair demolish install the following building structure equipment in accordance with the Laws of the State of Maine, the Building Code and Zoning Ordinance of the City of Portland, plans and specifications, if any, submitted herewith and the following specifications:

Location Island Ave. Peaks Island (87-00-26) Within Fire Limits? _____ Dist. No. _____
 Owner's name and address Mrs. Francis J. Haigney, 1920 South St. N.W., Washington 9 DC Telephone _____
 Lessee's name and address _____ Telephone _____
 Contractor's name and address Roland Hear, Island Ave. Peaks Island Telephone PO-62-86
 Architect _____ Specifications _____ Plans Yes No. of sheets 1
 Proposed use of building Dwelling No. families 1
 Last use _____ " _____ No. families 1
 Material Brick No. stories 2 Heat _____ Style of roof _____ Roofing _____
 Other buildings on same lot _____ Fee \$ 6.00
 Estimated cost \$ 1500.00

General Description of New Work

To demolish existing rear porch (6'x10') and front porch (6' x 22')
 To construct 6' x 18' rear platform and steps.
 Approx. over 100' to rear lot line.
 To provide new concrete floor (3") in callar in place of dirt floor.

It is understood that this permit does not include installation of heating apparatus which is to be taken out separately by and in the name of the heating contractor. PERMIT TO BE ISSUED TO contractor

Details of New Work

Is any plumbing involved in this work? _____ Is any electrical work involved in this work? _____
 Is connection to be made to public sewer? _____ If not, what is proposed for sewage? _____
 Has septic tank notice been sent? _____ Form notice sent? _____
 Height average grade to top of plate _____ Height average grade to highest point of roof _____
 Size, front _____ depth _____ No. stories _____ solid or filled land? _____ earth or rock? _____
 Material or foundation 10" concrete at least 4" below grade _____ Thickness, top _____ bottom _____ cellar _____
 Kind of roof none Rise per foot _____ Roof covering _____
 No. of chimneys _____ Material of chimneys _____ of lining _____ Kind of heat _____ fuel _____
 Framing Lumber—Kind Franklin Dressed or full size? used Corner posts _____ Sills 6x6
 Size Girder _____ Columns under girders _____ Size _____ Max. on centers _____
 Studs (outside walls and carrying partitions) 2x4-16" O. C. Bridging in every floor and flat roof span over 8 feet
 Joists and rafters: 1st floor 2x6, 2nd _____, 3rd _____, roof _____
 On centers: 1st floor 16", 2nd _____, 3rd _____, roof _____
 Maximum span: 1st floor 6', 2nd _____, 3rd _____, roof _____
 If one story building with masonry walls, thickness of walls? _____ height? _____

If a Garage

No. cars now accommodated on same lot _____, to be accommodated _____ number commercial cars to be accommodated _____
 Will automobile repairing be done other than minor repairs to cars habitually stored in the proposed building? _____

Miscellaneous

Will work require disturbing of any trees on a public street? no
 Will there be in charge of the above work a person competent to see that the State and City requirements pertaining thereto are observed? Yes

APPROVED:

[Signature]

Mrs. Francis J. Haigney
Roland Hear

by:

[Signature]

CS 301

INSPECTION COPY

Signature of owner

NOTES

4/14/63 - Work started

6/5/63 - Work complete

8.9.8

Work No. _____

Telephone _____

Address _____

City _____

State _____

Zip _____

Contractor _____

Contract No. _____

Permit No. _____

Location _____

Date of Permit _____

Notice closing-in _____

Lesson closing-in _____

Final Notice _____

Final Insp. _____

Cert. of Occupancy issued _____

Slaking-Out Notice _____

Form Check Notice _____

1) Permit No. 621/15867

Location: [illegible]

Date of Permit: 11/23/62

Notice closing-in: [illegible]

Lesson closing-in: [illegible]

Final Notice: [illegible]

Final Insp.: [illegible]

Cert. of Occupancy issued: [illegible]

Slaking-Out Notice: [illegible]

Form Check Notice: [illegible]

Work No. _____

Telephone _____

Address _____

City _____

State _____

Zip _____

Contractor _____

Contract No. _____

Permit No. _____

Location _____

Date of Permit _____

Notice closing-in _____

Lesson closing-in _____

Final Notice _____

Final Insp. _____

Cert. of Occupancy issued _____

Slaking-Out Notice _____

Form Check Notice _____

11/23/12
87-00-26

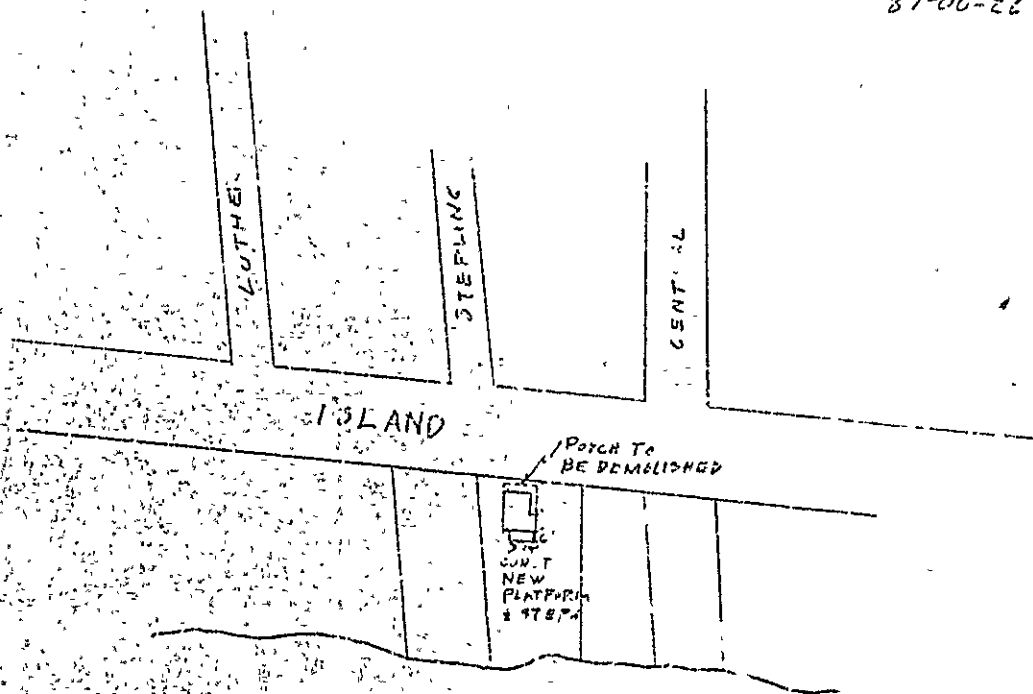

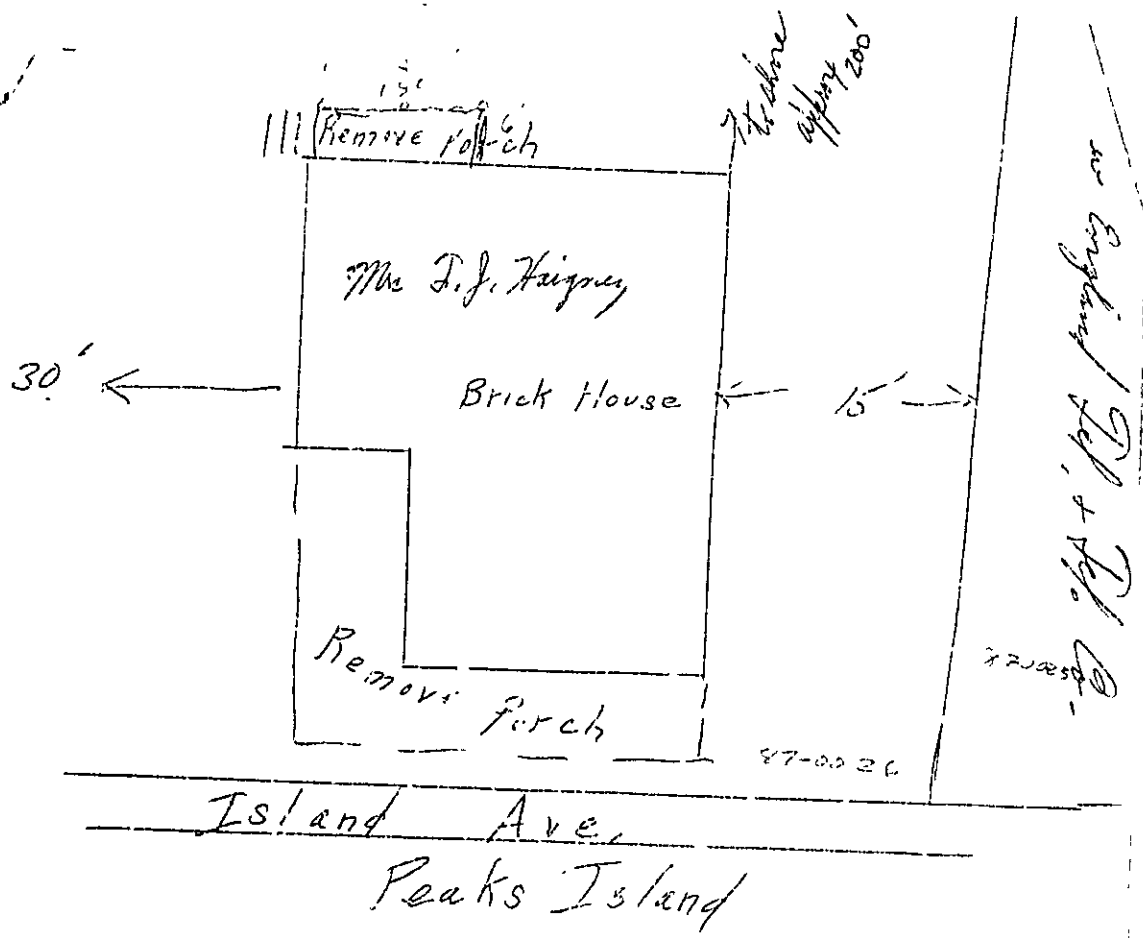



APPLICATION FOR PERMIT

PERMIT ISSUED

Class of Building or Type of Structure THIS CLASS

Portland, Maine June 9, 1912

To the INSPECTOR OF BUILDINGS, PORTLAND, ME.

The undersigned hereby apply for a permit to erect and install the following building structure equipment in accordance with the Laws of the State of Maine, the Building Code of the City of Portland, plans and specifications, if any, submitted herewith and the following specifications:

Location Island Avenue, Penikese Island Within Fire Limits? no Dist. No. _____
 Foot of Sterling St.
 Owner's or Lessee's name and address William J. Irwin, Island Ave. Penikese Telephone 192-3
 Contractor's name and address Owner Telephone _____
 Architect _____ Plans filed _____ No. of sheets _____
 Proposed use of building _____ No. families _____
 Other buildings on same lot _____
 Estimated cost \$ _____ Per \$ _____, 50

Description of Present Building to be Altered

Material wood No. stories 1 Heat _____ Style of roof _____ Roofing _____
 Last use Barn No. families _____

General Description of New Work

To demolish building app. 16' x 19' Rener 41/354

It is understood that this permit does not include installation of heating apparatus which is to be taken out separately by and in the name of the heating contractor.

Details of New Work

Is any plumbing work involved in this work? _____
 Is any electrical work involved in this work? _____ Height average grade to top of plate _____
 Size, from _____ depth _____ No. stories _____ Height average grade to highest point of roof _____
 To be erected on solid or filled land? _____ earth or rock? _____
 Material of foundation _____ Thickness, top _____ bottom _____ collar _____
 Material of underpinning _____ Height _____ Thickness _____
 Kind of roof _____ Rise per foot _____ Roof covering _____
 No. of chimneys _____ Material of chimneys _____ of lining _____
 Kind of heat _____ Type of fuel _____ Is gas fitting involved? _____
 Framing lumber Kind _____ Dressed on full size? _____
 Corner posts _____ Sills _____ Girt or ledger board? _____ Size _____
 Material column under girders _____ Size _____ Max. on centers _____
 Studs (outside walls and carrying partitions) 2x4-16" O. C. Girders 6x8 or larger Bridging in every floor and flat roof
 Span over 8 feet. Sills and corner posts all one piece in cross section.
 Joists and rafters: 1st floor _____ 2nd _____ 3rd _____ roof _____
 On centers: 1st floor _____ 2nd _____ 3rd _____ roof _____
 Maximum span: 1st floor _____ 2nd _____ 3rd _____ roof _____
 If one story building with masonry walls, thickness of walls? _____ eight? _____

If a Garage

No. cars now accommodated on same lot _____ to be accommodated _____
 Total number commercial cars to be accommodated _____
 Will automobile repairing be done other than minor repairs to cars habitually stored in the proposed building? _____

Miscellaneous

Will above work require removal or disturbing of any shade tree on a public street? _____
 Will there be in charge of the above work a person competent to see that the State and City requirements pertaining thereto are observed? _____

Signature of owner

W. J. Irwin

INSPECTION COPY

104D

Permit No. 42) 623.

Location 26th & Q Sts

Owner William J. Quinn

Date of permit 6/9/42

No. of closing-in

Impn. closing-in

Final Net f.

Final Inspn. 7/16/42, 623

Cert. of Occupancy issued NO

NOTES

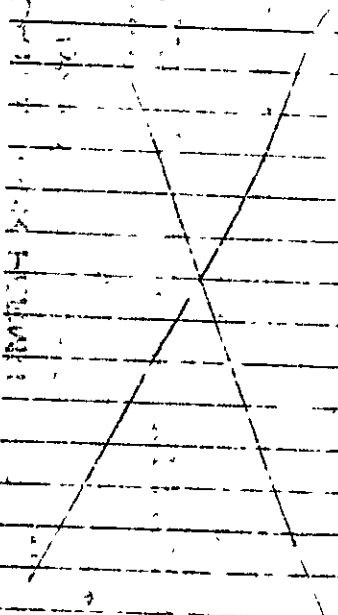

[Faint, illegible text and markings on the right side of the page, possibly bleed-through from the reverse side.]

41/354

May 27 1942

Mr. William J. Irwin,
Island Avenue,
Peaks Island, Maine

Subject: Building permit to
demolish former stable on Island
Avenue, Peaks Island near foot of
Central Avenue

Dear Sir:

A year ago last March, I issued a building permit to
cover demolition of the above stable.

A few days ago, our inspector reported that the only
work that has been done on this project is to remove some of the
roof boards.

Under these circumstances this permit to demolish has
lapsed, and if you really intend to demolish the building it will
be necessary for you to apply for and secure another permit. If
you do not intend to demolish the building the roof boards and roof-
ing should be put back to keep out the weather and to keep the build-
ing from rapid deterioration.

Very truly yours,

10/4

Inspector of Buildings



APPLICATION FOR PERMIT

Permit No. 7351

Class of Building or Type of Structure Third Class

Issued 1941

Portland, Maine, March 29, 1941

To the INSPECTOR OF BUILDINGS, PORTLAND, ME.

The undersigned hereby applies for a permit to erect, alter, install the following building structure equipment in accordance with the Laws of the State of Maine, the Building Code of the City of Portland, plans and specifications, if any, submitted herewith and the following specification:

Location Island Avenue, Pease Island Within Fire Limits? no Just. No. _____

Owner's or Lessee's name and address Forest City Landing, William J. Irvin, et al, Island Ave, Pease Telephone _____

Contractor's name and address Owner Telephone _____

Architect _____ Plans filed _____ No. of sheets _____

Proposed use of building _____ No. families _____

Other buildings on same lot _____ Fee \$ 2.00

Estimated cost \$ _____

Description of Present Building to be Altered

Material wood No. stories 1 Heat _____ Style of roof _____ Roofing _____

Last use Leisure No. families _____

General Description of New Work

To demolish building 16' x 19' no stair connection

It is understood that this permit does not include installation of heating apparatus which is to be taken up separately by and in the name of the heating contractor.

Details of New Work

Is any particular work involved in this work? _____

Is any electrical work involved in this work? _____ Height average grade to top of plate _____

Size front _____ depth _____ No. stories _____ Height average grade to highest point of roof _____

To be erected on solid or filled land? _____ earth or rock? _____

Material of foundation _____ Thickness, top _____ bottom _____ cellar _____

Material of underpinning _____ Height _____ Thickness _____

Kind of roof _____ Rise per foot _____ Roof covering _____ of lining _____

No. of chimneys _____ Material of chimney _____ Is gas fitting involved? _____

Kind of heat _____ Type of fuel _____

Framing lumber—Kind _____ Dressed or full size: _____ Size _____

Corner posts _____ Size _____ led or box _____

Material columns under girders _____ size _____ Max on centers _____

Studs (out side walls and carrying partitions) 2 x 16" U. C. Girders 6x6 or larger Bridging in every floor and flat roof _____

Joists and rafters: 1st floor _____, 2nd _____, 3rd _____, roof _____

Chimneys: 1st floor _____, 2nd _____, 3rd _____, roof _____

Maximum span _____ height: _____

If building with masonry walls _____ height of walls? _____

If a Garage

cars to be accommodated on same lot _____ to be accommodated _____

Will auto, to be repaired, be done other than auto repairs to cars habitually stored in the proposed building _____

Miscellaneous

Will above work require removal or disturbance of any shade tree on public street? no

Will there be in the course of the above work a person competent to see that the State and City requirements pertaining thereto are observed? yes

Signature of owner William J. Irvin
W. J. Irvin

INSPECTOR COPY

Permit No. 4:1354

Location 2nd Ave. Peaks

Owner William J. Ferrin

Date of permit 3/28/41

Both closing-in

Inspn. closing-in

Final Notif.

Final Inspn

Cert. of Occupancy issued

NOTES

3/28/41 - 1st inspection

3/28/41 - 2nd inspection

3/28/41 - 3rd inspection

3/28/41 - 4th inspection

3/28/41 - 5th inspection

3/28/41 - 6th inspection

3/28/41 - 7th inspection

3/28/41 - 8th inspection

3/28/41 - 9th inspection

3/28/41 - 10th inspection

3/28/41 - 11th inspection

3/28/41 - 12th inspection

3/28/41 - 13th inspection

3/28/41 - 14th inspection

3/28/41 - 15th inspection

3/28/41 - 16th inspection

3/28/41 - 17th inspection

3/28/41 - 18th inspection

3/28/41 - 19th inspection

3/28/41 - 20th inspection



FILL IN COMPLETELY AND GIVE WITH INK

PERMIT ISSUED

Permit No. 1288

APPLICATION FOR PERMIT FOR HEATING, COOKING OR POWER EQUIPMENT

Portland, Maine, September 5, 1910

To the INSPECTOR OF BUILDINGS, PORTLAND, ME.

The undersigned hereby applies for a permit to install the following heating, cooling or power equipment in accordance with the Laws of Maine, the Building Code of the City of Portland, and the following specifications:

Location: Island Avenue, Peaks Island of Building: dwelling house No. Stories: 1 1/2 Existing Building

Name and address of owner of appliance: William Irvin, Island Ave. Peaks Telephone: 8617

Installer's name and address: A. P. Strout, 16 Morning Street Telephone: 3-8167

General Description of Work

To install: warm air furnace in place of stove heat

INSPECTION NOT COMPLETED

IF HEATER, POWER BOILER OR COOKING DEVICE

Is appliance or source of heat to be in cellar? YES If not, which story: Kind of Fuel: coal

Material of supports of appliance (concrete floor or what kind): concrete

Minimum distance to wood or combustible material, from top of appliance or casing top of furnace: 15"

from top of smoke pipe: over 15" from front of appliance: over 4" from sides or back of appliance: over 4"

Size of chimney flue: 8x12 Other connections to same flue: none

IF OIL BURNER

Name and type of burner: Labeled and approved by Underwriters' Laboratories? Type of oil feed (gravity or pressure):

Will operator be always in attendance? No. and capacity of tanks:

Location oil storage: How many tanks fireproofed?:

Will all tanks be more than seven feet from any flame? Amount of fee enclosed? 1.00 (\$1.00 for one heater, etc., 50 cents additional for each additional heater, etc., in same building at same time.)

Signature of Installer: Arnold Strout

INSPECTION COPY

CERTIFICATE OF ACCURACY REQUIREMENT IS WAIVED OR CLASSED BY INSPECTOR

Permit No. 40/1283

Location Island Ave. Peaks

Owner William Irwin

Date of Permit 9/5/40

Post Card sent

Notif. for inspu.

Approval Tag issued

Oil-Burner Check List (date)

1. Kind of fuel Gas Oil Kerosene Other _____
2. Label _____
3. Anti-siphon _____
4. Oil storage _____
5. Tank distance _____
6. Vent Pipe _____
7. Fill pipe _____
8. Gauge _____
9. Rigidity _____
10. Feed safety _____
11. Pipe sizes and material _____
12. Control valve _____
13. Air pit vent _____
14. Temp. or pressure safety _____
15. Instruction _____

General Description of Work

NOTES

Work on burner and vent hood
and vent pipe installation
complete. etc.

Upper island etc.
 9/5/40
 10/2/40. draftable etc. complete
 but several matters need
 attention. You could give
 suitable has been made
 by a piece of pipe ital across
 the duct in order that
 it fits with the space
 but a connecting with
 the... leave if the work
 appeared. The vent pipe
 cannot be... lower entry
 since the work at could have
 protection. The level to
 is... in... of...
 to... not...
 in...
 was... through the...
 flow...
 of the...
 the... etc.