

- LEDGETOOD ROAD
87-0-2

PEAKS ISLAND

STAMPED MARK

CITY OF PORTLAND, MAINE

Application for Permit to Install Wires

Permit No. 54060

Issued ..
 Portland, Maine July 23 .. 1965

To the City Electrician, Portland, Maine:

The undersigned hereby applies for a permit to install wires for the purpose of conducting electric current, in accordance with the laws of Maine, the Electrical Ordinance of the City of Portland, and the following specifications:

(This form must be completely filled out — Minimum fee, \$1.00) (87-02)

Owner's Name and Address Richard Watson Seabrook Rd. Peaks Island
 Contractor's Name and Address E. P. Corcoran Peaks Island
 Location Seabrook Rd. Use of Building Dwelling
 Number of families Apartments Stores Number of Stories
 Description of Wiring: New Work Additions Alterations

Pipe Cable Metal Molding BX Cable Plug Molding (No. of feet)
 No. Light Outlets Plugs Light Circuits Plug Circuits
 FIXTURES: No. Light Switches Fluor. or Strip Lighting (No. feet)
 SERVICE: Pipe Cable Underground No. of Wires 3 Size 2-3-15
 METERS: Relocated Added Total No. Meters 1
 MOTORS: Number Phase H. P. Amps Volts Starter
 HEATING UNITS: Domestic (Oil) No. Motors Phase H.P.
 Commercial (Oil) No. Motors Phase H.P.
 Electric Heat (No. of Rooms)
 APPLIANCES: No. Ranges Watts Brand Feeds (Size and No.)
 Elec. Heaters Watts
 Miscellaneous Watts Extra Cabinets or Panels
 Transformers Air Conditioners (No. Units) Signs (No. Units)
 Will commence July 24 19 65 Ready to cover in 19 .. Inspection July 24 19 65
 Amount of Fee \$ 1.00

Signed E. P. Corcoran

DO NOT WRITE BELOW THIS LINE

SERVICE .. ✓ METER .. GROUND .. ✓
 VISITS: 1 2 3 4 5 6
 .. 7 8 9 10 11 12
 REMARKS:

INSPECTED BY D. Butterfield
 (OVER) J.W. Herbert

delgewood Rd. Pooks Is.

LOCATION 7/26/65

INSPECTION DATE 7/26/65

WORK COMPLETED

TOTAL NO INSPECTIONS: 1

REMARKS:

FEEES FOR WIRING PERMITS EFFECTIVE JULY 31, 1968

WIRING

1 to 30 Outlets	(including switches)	\$ 2.00
31 to 60 Outlets	(including switches)	3.00
Over 60 Outlets, each Outlet	(including switches)	.05
(Each twelve feet or fraction thereof of fluorescent lighting or any type of plug molding will be classed as one outlet).		

SERVICES

Single Phase		2.00
Three Phase		4.00

MOTORS

Not exceeding 50 H.P.		3.00
Over 50 H.P.		4.00

HEATING UNITS

Domestic (Oil)		2.00
Commercial (Oil)		4.00
Electric Heat (Each Room)		.75

APPLIANCES

Ranges, Cooking Tops, Ovens, Water Heaters, Disposals, Dishwashers, etc. — Each Unit

1.50

TEMPORARY WORK (limited to 6 months from date of permit)

Service, Single Phase		1.00
Service, Three Phase		2.00
Wiring, 1-50 Outlets		1.50
Wiring, each additional outlet over 50		.02
Circuses, Carnivals, Fairs, etc.		10.00

MISCELLANEOUS

Distribution Cabinet or Panel, per unit

1.00



APPLICATION FOR PERMIT

PERMIT ISSUED

B.O.C.A. USE GROUP
B.O.C.A. TYPE OF CONSTRUCTION 01333

OCT 23 1984

ZONING LOCATION PORTLAND, MAINE 10/19/84

CITY OF PORTLAND

To the CHIEF OF BUILDING & INSPECTION SERVICES, PORTLAND, MAINE

The undersigned hereby applies for a permit to erect, alter, repair, demolish, move or install the following building, structure, equipment or change use in accordance with the Laws of the State of Maine, the Portland B.O.C.A. Building Code and Zoning Ordinance of the City of Portland with plans and specifications, if any, submitted herewith and the following specifications:

LOCATION Lot #37-377, Ledgewood Road, Peaks Island Fire District #1 , #2
1. Owner's name and address Richard LaClair, same Telephone
2. Lessee's name and address Telephone
3. Contractor's name and address Jack Hutchins, A Street, Peaks Island Telephone

Proposed use of building No. of sheets
Last use No. families
Material No. stories Heat Style of roof Roofing
Other buildings on same lot
Estimated contractual cost \$ 2,000

FIELD INSPECTOR—Mr.
@ 775-5451

Appeal Fees \$
Base Fee
Late Fee
TOTAL \$ 55.00

to construct 12 x 24 addition to existing building
as per plan
send to #3

Stamp of Special Conditions

NOTE TO APPLICANT: Separate permits are required by the installers and subcontractors of heating, plumbing, electrical and mechanicals.

DETAILS OF NEW WORK

Is any plumbing involved in this work? Is any electrical work involved in this work?
Is connection to be made to public sewer? If not, what is proposed for sewage?
Has septic tank notice been sent? Form notice sent?
Height average grade to top of plate Height average grade to highest point of roof
Size, front depth No. stories solid or filled land? earth or rock?
Material of foundation Thickness, top bottom
Kind of roof Rise per foot Roof
No. of chimneys Material of chimneys of lining heat fuel
Framing Lumber—Kind Dressed or full size? Corner posts Sills
Size Girder Columns under girders Size Max. in centers
Studs (outside walls and carrying partitions) 2x4-16" O. C. Bridging in every floor and flat roof span over 8 feet.
Joists and rafters: 1st floor 2nd 3rd roof
On centers: 1st floor 2nd 3rd roof
Maximum span: 1st floor 2nd 3rd roof
If one story building with masonry walls, thickness of walls? height?

IF A GARAGE

No. cars now accommodated on same lot to be accommodated number commercial cars to be accommodated
Will automobile repairing be done other than minor repairs to cars habitually stored in the proposed building?

APPROVALS BY: DATE
BUILDING INSPECTION—PLAN EXAMINER:
ZONING:
BUILDING CODE:
Fire Dept.:
Health Dept.:
Others:

MISCELLANEOUS
Will work require disturbing of any tree on a public street?
Will there be in charge of the above work a person competent to see that the State and City requirements pertaining hereto are observed?

Signature of Applicant Phone # 766-4498
Type Name of above Jack Hutchins

Other
and Address

FIELD INSPECTOR'S COPY APPLICANT'S COPY OFFICE FILE COPY

871-G-2 LEDGEWOOD AVE., PEARS ISLAND

1

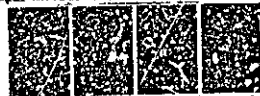

RECEIVED
OCT 19 1984
DIV. OF COMM. INSP.
CITY OF PORTLAND

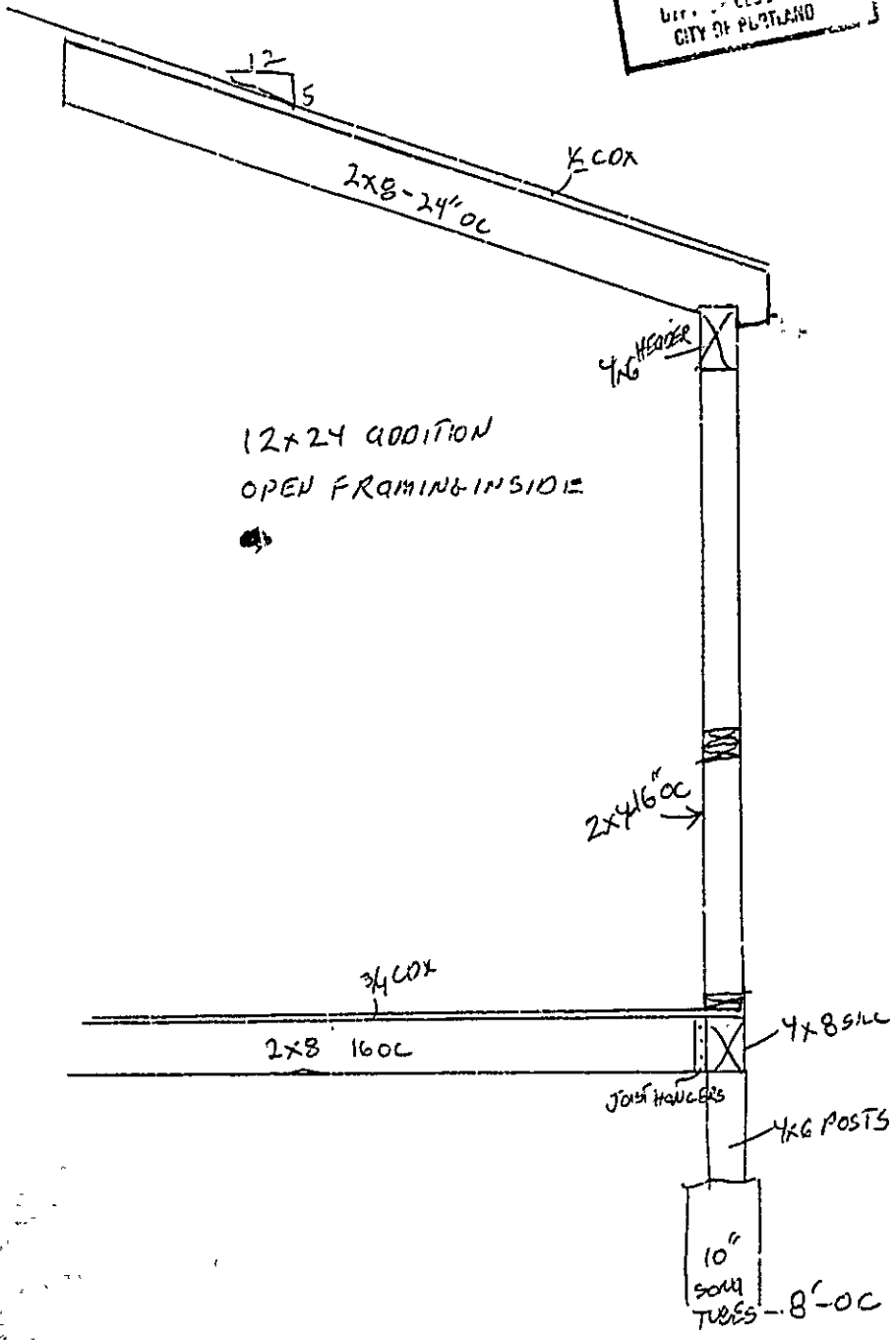

12x24 ADDITION
OPEN FRAMING INSIDE

MR RICHARD LACLAIR
LOT # 87--0-2
5220 SF

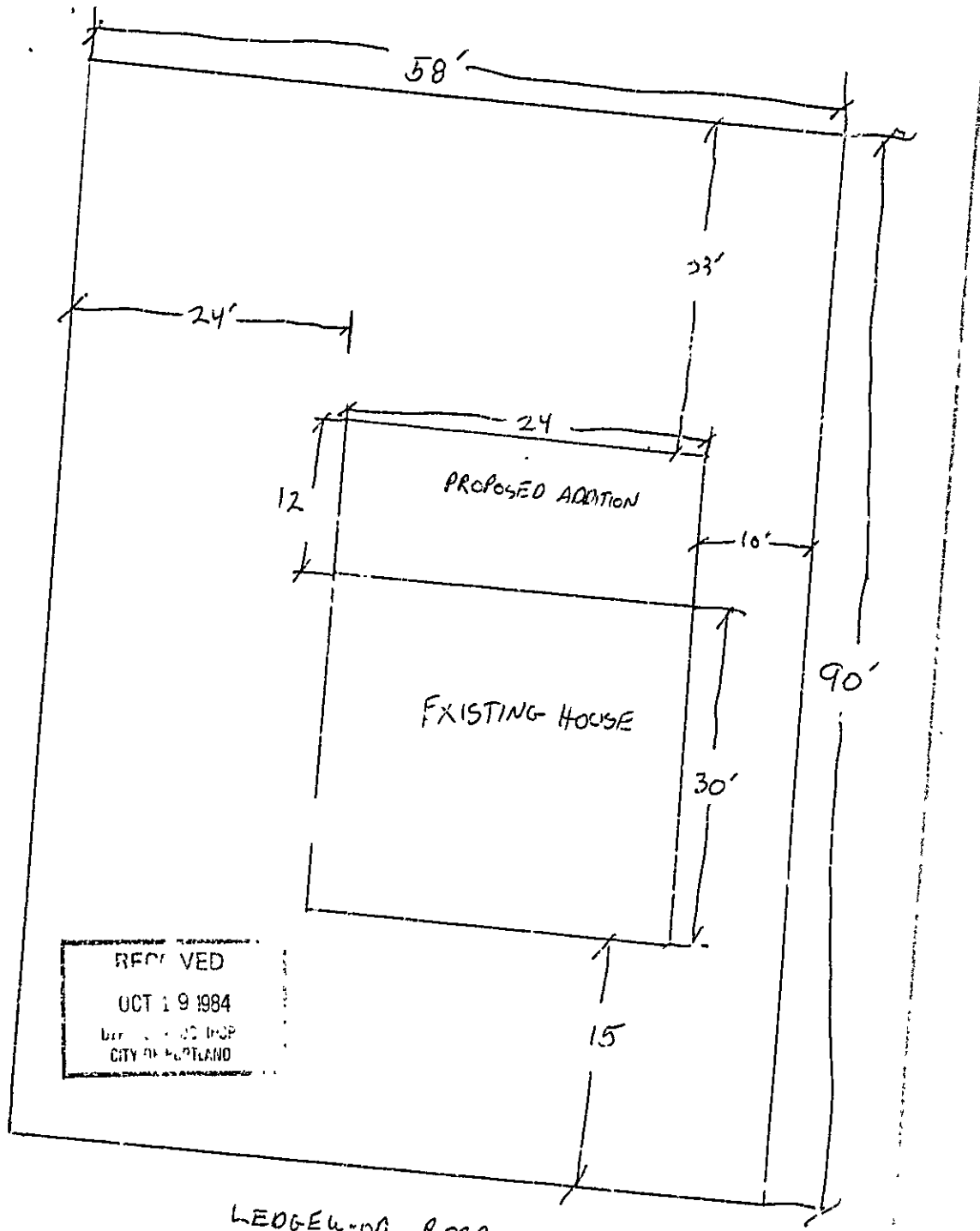

LEDGEWOOD ROAD

ESTIMATED COST
 \$9000

MR. RICHARD LACLAIR
 LOT # 87-0-2
 5220 SF

APPLICATION FOR PERMIT

PERMIT ISSUED

B.O.C.A. USE GROUP M 01333

B.O.C.A. TYPE OF CONSTRUCTION 4-A

ZONING LOCATION R-3 PORTLAND, MAINE 10/29/84

OCT 23 1984

CITY of PORTLAND

To the CHIEF OF BUILDING & INSPECTION SERVICES, PORTLAND, MAINE

The undersigned hereby applies for a permit to erect, alter, repair, demolish, move or install the following building, structure, equipment or change use in accordance with the Laws of the State of Maine, the Portland B.O.C.A. Building Code and Zoning Ordinance of the City of Portland with plans and specifications, if any, submitted herewith and the following specifications:

LOCATION ... Lot #87-G-2, Ledgewood Road, Peaks Island ... Fire District #1 , #2

1. Owner's name and address ... Richard LaClair, same as ... Telephone

2. Lessee's name and address ... Telephone

3. Contractor's name and address ... Jack Hutchins, A-Str ... Peaks Island ... Telephone

..... No. of sheets

Proposed use of building No. families

Last use No. families

Material No. stories Heat Style of roof Roofing

Other buildings on same lot

Estimated contractual cost \$ 9,000.....

FIELD INSPECTOR—Mr.

@ 775 5451

Appeal Fees \$

Base Fee

Late Fee

TOTAL \$ 55.00

to construct 12 x 24 addition to existing building as per plan

send to #3

Stamp of Special Conditions

NOTE TO APPLICANT: Separate permits are required by the installers and subcontractors of heating, plumbing, electrical and mechanicals.

DETAILS OF NEW WORK

Is any plumbing involved in this work? Is any electrical work involved in this work?

Is connection to be made to public sewer? If not, what is proposed for sewage?

Has septic tank notice been sent? Form notice sent?

Height average grade to top of plate Height average grade to highest point of roof

Size, front depth No. stories solid or filled land? earth or rock?

Material of foundation Thickness, top bottom cellar

Kind of roof Rise per foot Roof covering

No. of chimneys Material of chimneys of lining Kind of heat fuel

Framing Lumber—Kind Dressed or full size? Corner posts Sills

Size Girder Columns under girders Size Max. on centers

Studs (outside walls and carrying partitions) 2x4-16" O. C. Bridging in every floor and flat roof span over 8 feet.

Joists and rafters: 1st floor 2nd 3rd roof

On centers: 1st floor 2nd 3rd roof

Maximum span: 1st floor 2nd 3rd roof

If one story building with masonry walls, thickness of walls? height?

IF A GARAGE

No. cars now accommodated on same lot, to be accommodated number commercial cars to be accommodated

Will automobile repairing be done other than minor repairs to cars habitually stored in the proposed building?

APPROVALS BY: DATE MISCELLANEOUS

BUILDING INSPECTION—PLAN EXAMINER Will work require disturbing of any tree on a public street?

ZONING: Will there be in charge of the above work a person competent

BUILDING CODE: to see that the State and City requirements pertaining thereto

Fire Dept.: are observed?

Health Dept.:

Other:

Signature of Applicant Jack Hutchins Phone # 766-4498.....

Type Name of above Jack Hutchins 1 2 3 4

Other

and Address

FIELD INSPECTOR'S COPY

APPLICANT'S COPY

OFFICE FILE COPY

ma. add to

NOTES

11-30-84 - Checked in to *Ad*
 11-27-84 - Tubes, supports,
 frame, roof, BK. Closing *Ad*
 in w. P/OK
 5-20-85 - Complete *Ad*
 OK.

Permit No. 84/1392
 Location 829-2
 Owner Richard Johnson
 Date of permit 10-19-84
 Approved 10-23-84
 Dwelling Addition
 Garage
 Attention

Ad
Ad
Ad

~~Two large rectangular areas of the page are crossed out with diagonal lines, indicating they are unused or void.~~

Luther Street, fourth house on
right from Island Avenue.

~~CITY OF PORTLAND~~
~~RECEIVED~~
AUG 13 1982

RECEIVED
AUG 13 1982
DEPT. OF BLDG. INSP.
CITY OF PORTLAND

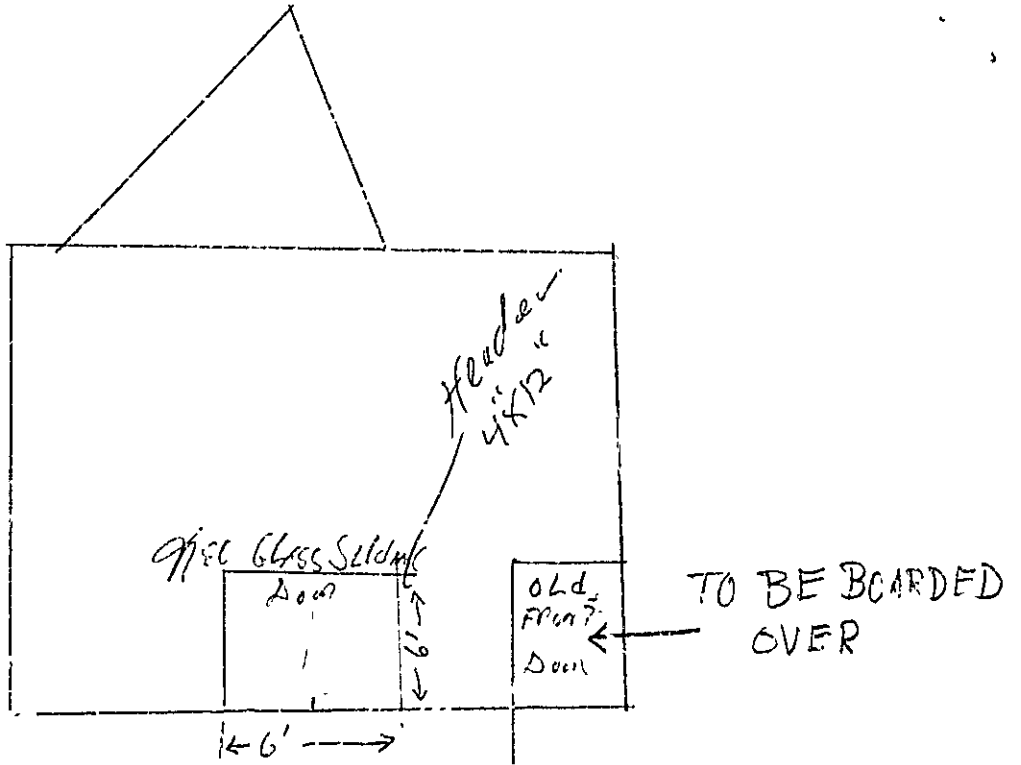

LUTHER ST.

4TH HOUSE UP ON RIGHT FROM ISLAND AVE.

APPLICATION FOR PERMIT

B.O.C.A. USE GROUP
 B.O.C.A. TYPE OF CONSTRUCTION *00063*

PERMIT ISSUED

AUG 13 1982

ZONING LOCATION PORTLAND, MAINE Aug. 13, 1982

To the CHIEF OF BUILDING & INSPECTION SERVICES, PORTLAND, MAINE

CITY of PORTLAND

The undersigned hereby applies for a permit to erect, alter, repair, demolish, move or install the following building, structure, equipment or change use in accordance with the Laws of the State of Maine, the Portland B.O.C.A. Building Code and Zoning Ordinance of the City of Portland with plans and specifications, if any, submitted herewith and the following specifications:

LOCATION Luther St., fourth house on right from Island Ave. Fire District #1 #2
 1. Owner's name and address John E. Hannigan, 9/ Edwards St., Portland Telephone 772-3647
 2. Lessee's name and address Telephone
 3. Contractor's name and address None Telephone
 Proposed use of building No. of sheets
 Material No. stories Heat Style of roof Roofing
 Other buildings on same lot
 Estimated contractual cost \$ 700

FIELD INSPECTOR—Mr. *Adelante*
 @ 775-5451

Appeal Fees \$
 Base Fee \$ 15.00
 Late Fee
 TOTAL \$ 15.00

Build 6 x 6 door in wall of existing bldg.
 Mail permit to # 1

Stamp of Special Conditions

NOTE TO APPLICANT: Separate permits are required by the installers and subcontractors of heating, plumbing, electrical and mechanicals.

DETAILS OF NEW WORK

Is any plumbing involved in this work? Is any electrical work involved in this work?
 Is connection to be made to public sewer? If not, what is proposal for sewage?
 Has septic tank notice been sent? Form notice sent?
 Height average grade to top of plate Height average grade to highest point of roof
 Size: front depth No. stories solid or filled land? earth or rock?
 Material of foundation? Thickness, top bottom cellar
 Kind of roof Rise per foot Roof covering
 No. of chimneys Material of chimneys of lining Kind of heat? fuel
 Framing Lumber—Kind Dressed or full size? Corner posts Sills
 Size Girder Columns under girders Size Max. on centers
 Studs (outside walls and carrying partitions) 2x4-16" O. C. Bridging in every floor and flat roof span over 8 feet.
 Joists and rafters: 1st floor 3rd roof
 On centers: 1st floor 3rd roof
 Maximum span: 1st floor 3rd roof
 One story building with masonry walls, thickness of walls? height?

IF A GARAGE

Will cars now accommodated on same lot to be accommodated number commercial cars to be accommodated
 Will automobile repairing be done other than oil or repairs to cars habitually stored in the proposed building?

APPROVED BY: *W.H.* E.A.T. MISCELLANEOUS
 BUILDING INSPECTION PLAN EXAMINER Will work require disturbing of any tree on a public street?
 ZONING: *W.H.*
 BUILDING CODE: Will there be in charge of the above work a person competent to see that the State and City requirements pertaining thereto are observed?
 Fire Dept.:
 Health Dept.:
 Others:

Signature of Applicant *John E. Hannigan* Phone # shown above
 Type Name of above John E. Hannigan 1 2 3 4
 Other
 and Address

NOTES

9-29-82 - NP *aa*
 3-16-83 " *aa*
 9-28-83 NP *aa*
 5-20-85 - Transferred
 to new owner. Permit
 cancelled replaced by
 permit # 9491475-11-26-84 *aa*

Permit No. 00663

Location *Ruther St. - D.I.*

Owner *John E. Finnigan*

Date of permit *13/2/83*

Approved

Dwelling

Garage

Alteration

[The main body of the form is crossed out with a large 'X' and contains no legible text.]

87-2-30 Luther Street

Peaks Island



FILL IN AND SIGN WITH INK

01520

APPLICATION FOR PERMIT FOR HEATING, COOKING OR POWER EQUIPMENT

PERMIT ISSUED

DEC 5 1984

CITY of PORTLAND

Portland, Maine, Dec. 4, 1984

To the INSPECTOR OF BUILDINGS, PORTLAND, ME.

The undersigned hereby applies for a permit to install the following heating, cooking or power equipment in accordance with the Laws of Maine, the Building Code of the City of Portland, and the following specifications:

Location 76-1/2 Luther St. Ekt. Isl Use of building dwelling- single No Stories 2 New Building Existing " x
Name and address of owner of appliance Cynthia Cole - same
Installer's name and address Jackson Service Center - Portland Telephone 766-2722

General Description of Work

To install warm air furnace - replacement

IF HEATER, OR POWER BOILER

Location of appliance Any burnable material in floor surface or beneath?
if so, how protected? Kind of fuel?
Minimum distance to burnable material, from top of appliance or casing top of furnace
From top of smoke pipe ... From front of appliance From sides or back of appliance ...
Size of chimney flue ... Other connections to same flue
If gas fired, how vented? Rated maximum demand per hour
Will sufficient fresh air be supplied to the appliance to insure proper and safe combustion?

IF OIL BURNER

Name and type of burner Beckett - gun Labelled by underwriters' laboratories? yes
Will operator be always in attendance? none Does oil supply line feed from top or bottom of tank? bottom
Type of floor beneath burner cement Size of vent pipe 1 1/2"
Location of oil storage basement Number and capacity of tanks 1-275 gal.
Low water shut off no Make No.
Will all tanks be more than five feet from any flame? yes How many tanks enclosed? none
Total capacity of any existing storage tanks for furnace burners 275 gal.

IF COOKING APPLIANCE

Location of appliance Any burnable material floor surface or beneath?
if so, how protected? Height of Legs, if any
Skirting at bottom of appliance? Distance to combustible material from top of appliance?
From front of appliance From sides and back From top of smokepipe
Size of chimney flue Other connections to same flue
Is hood to be provided? If so, how vented? Forced or gravity?
If gas fired, how vented? Rated maximum demand per hour

MISCELLANEOUS EQUIPMENT OR SPECIAL INFORMATION

[Empty space for miscellaneous information]

Amount of fee enclosed: \$5.00

APPROVED: [Signature area]

Will there be in charge of the above work a person competent to see that the State and City requirements pertaining thereto are observed? ...

CS 100
INSPECTION FILE APPLICANT'S ASSESSOR'S COPY
Signature of Installer [Signature] 1418

