

WILLOW STREET
87-KK-2

PEAKS ISLAND

MADE IN U.S.A.
1968

CITY OF PORTLAND, MAINE

Application for Permit to Install Wires

Permit No. **55923**

Issued
Portland, Maine **July 5** 19**67**

To the City Electrician, Portland, Maine

The undersigned hereby applies for a permit to install wires for the purpose of conducting electric current, in accordance with the laws of Maine, the Electrical Ordinance of the City of Portland, and the following specifications:

(This form must be completely filled out - Minimum Fee, \$1.00)

Owner's Name and Address **87-KK-2 Mrs Ethel Ward 38 Holyson Rd. Newton Mass**

Contractor's Name and Address **P.P. Corrigan Peaks Electric**

Location **Willow St Peaks Use of Building**

Number of Families **1** Apartments **0** Stores **0** Number of Stories **0**

Description of Wiring: **New Work** Additions Alterations

Pipe Cable Metal Molding BX Cable Plug Molding (No. of feet)

No. Light Outlets Plugs **3** Light Circuits Plug Circuits

FIXTURES: No. **5** Light Switches **2** Fluor. or Slip Lighting (No. feet)

SERVICE: Pipe Cable Underground No. of Wires **3** Size **No. 2**

METERS: Relocated Added Total No. Meters

MOTORS: Number Phase H. P. Amps Volts Starter

HEATING UNITS: Domestic (Oil) No. Motors Phase H.P.

Commercial (Oil) No. Motors Phase H.P.

Electric Heat (No. of Rooms)

APPLIANCES: No. Ranges Watts Brand Feeds (Size and No.)

Elec. Heaters Watts

Miscellaneous Watts Extra Cabinets or Panels

Transformers Air Conditioners (No. Units) Signs (No. Units)

Will commence **July 6 1967** Ready to cover in **July 7 1967** Inspection 19

Amount of Fee \$ **4.00**

Signed **P.P. Corrigan**

DO NOT WRITE BELOW THIS LINE

SERVICE	METER	GROUND
VISITS: 1	2	3
7	8	9
		10
		11
		12

REMARKS:

INSPECTED BY **J.W. Herndon** (OVER)

Eung

PEAKS Island
 LOCATION Willow ST
 INSPECTION DATE 7/12/67
 WORK COMPLETED 7/12/67
 TOTAL NO. INSPECTIONS 1
 REMARKS:

FEEES FOR WIRING PERMITS EFFECTIVE JULY 31, 1963

WIRING			
1 to 30 Outlets	(including switches)		\$ 2.00
31 to 60 Outlets	(including switches)		3.00
Over 60 Outlets, each Outlet	(including switches)		.05
(Each twelve feet of fraction thereof of fluorescent lighting or any type of plug molding will be classed as one outlet).			
SERVICES			2.00
Single Phase			3.00
Three Phase			4.00
MOTORS			2.00
Not exceeding 50 H.P.			2.00
Over 50 H.P.			4.00
HEATING UNITS			4.00
Domestic (Oil)			.75
Commercial (Oil)			
Electric Heat (Each Room)			
APPLIANCES			1.50
Ranges, Cooking Tops, Ovens, Water Heaters, Disposals, Dishwashers, etc. — Each Unit			1.00
TEMPORARY WORK (Limited to 6 months from date of permit)			2.00
Service, Single Phase			1.00
Service, Three Phase			.02
Wiring, 1-50 Outlets			10.00
Wiring, each additional outlet over 50			
Circuits, Carnivals, Fairs, etc.			



(A) APARTMENT HOUSE ZONE
APPLICATION FOR PERMIT

PERMIT ISSUED

1228

AUG 30 1934

Class of Building or Type of Structure Third Class

Portland, Maine, August 30, 1934

To the INSPECTOR OF BUILDINGS, PORTLAND, ME.

The undersigned hereby applies for a permit to erect alter install the following building structure equipment in accordance with the laws of the State of Maine, the Building Code of the City of Portland, plans and specifications, if any, submitted herewith and the following specifications:

Location Willow Street, Peaks Island Ward Isl. 2 Within Fire Limits? no Dist. No. _____

Owner's or Lessee's name and address Harry J. Ward, Willow St. Peaks Telephone 253-11

Contractor's name and address Geo. Kossing, Willow St. Telephone _____

Architect's name and address _____ Telephone _____

Proposed use of building dwelling house No. families 1

Other buildings on same lot _____ No. families 1

Plans filed as part of this application? no No. of sheets _____

Estimated cost \$ 100. Fee \$.50

Description of Present Building to be Altered

Material wood No. stories 1 1/2 Heat _____ Style of roof _____ Roofing _____

Last use dwelling house No. families 1

General Description of New Work

To construct concrete trench wall with brick underpinning under one side of building

NOTIFICATION BEFORE LATENCY
OR CLOSING-IN IS WAIVED

CERTIFICATE OF OCCUPANCY
REQUIREMENT IS WAIVED

It is understood that this permit does not cover the heating contractor.

Installation of heating apparatus which is to be taken _____ by and in the name of _____

Details of New Work

Size, front _____ depth _____ No. stories _____ Height average grade to top of plate _____

To be erected on solid or filled land? solid Height average grade to highest point of roof _____

Material of foundation concrete earth or rock? earth Thickness, top _____ bottom _____

Material of underpinning brick Height _____ Thickness _____

Kind of Roof _____ Rise per foot _____ Roof covering _____ Thickness _____

No. of chimneys _____ Material of chimneys _____ of lining _____

Kind of heat _____ Type of fuel _____ Is gas fitting involved? _____

Corner posts _____ Sills _____ Girt or ledger board? _____ Size _____

Material columns under girders _____ Size _____ Max. on centers _____

Studs (outside wall and carrying partitions) 2x4-16" O. C. Girders 6x8 or larger. Bridging in every floor and flat roof span over 8 feet. Sills and corner posts all one piece in cross section.

Joists and rafters: 1st floor _____, 2nd _____, 3rd _____, roof _____

On centers: 1st floor _____, 2nd _____, 3rd _____, roof _____

Maximum span: 1st floor _____, 2nd _____, 3rd _____, roof _____

If one story building with masonry walls, thickness of walls? _____ height? _____

If a Garage

No. cars now accommodated on same lot _____ to be accommodated _____

Total number commercial cars to be accommodated _____

Will automobile repairing be done other than minor repairs, or cars habitually stored in the proposed building? _____

Will above work require removal or disturbing of any shade tree on a public street? no

Will there be in charge of the above work a person competent to see that the State and City requirements pertaining thereto are observed? yes

INSPECTION COPY

Signature of owner

Harry J. Ward

25-118

Ward 2d 2 Permt No. 34/1228

Location Willow St. Peabody

Owner Harry J. Doran

Date of permit 8/30/34

Notif. c' lg-in

Inspn. closing-in

Final Notif.

Final Inspn. 9/20/34

Cert. of Occupancy issued None

NOTES

89
111

9/20/34 work done -
A. J.

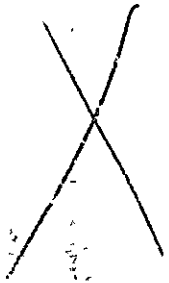

1863



APPLICATION FOR PERMIT TO REPAIR BUILDING

Third Class Building

Portland, Maine, Aug 29 1930

87-111-2

Permit No. _____

To the INSPECTOR OF BUILDINGS, PORTLAND, ME.

The undersigned hereby applies for a permit to repair the following described building in accordance with the Laws of Maine, the Building Code of the City of Portland, and the following specifications:

Location Willow Street, Peaks Island, No. Ward Within fire limits not Dist. No. _____

Owner's name and address Alexandrine Kard, Willow Street, Peaks Island, Me. Telephone _____

Contractor's name and address Tile Roofing System, 249 Commercial Street, Telephone 1623

Use of building Garaging

No. stories 2 Height _____ ft., Gross area _____ sq. ft., Style of roof Pitch

Type of present roof covering Good shingles

General Description of New Work

To recover entire roof.

If Roof Covering is to be Repaired or Renewed

When last repaired? _____, Area then repaired _____ sq. ft.

Are repairs or renewal due to damage by fire? no If so, what area damaged? _____ sq. ft.

Area of roof to be repaired now? entire roof _____ sq. ft.

Type of roofing to be used Asphalt shingles No. plies _____

Trade name and grade of roof covering to be used Class C Underwriters Lab. Tile

Estimated cost \$ _____ Fee \$.50

Alexandrine Kard

Signature of owner By Tile Roofing System

By A. Kard

INSPECTION COPY

(A) APARTMENT ZONE

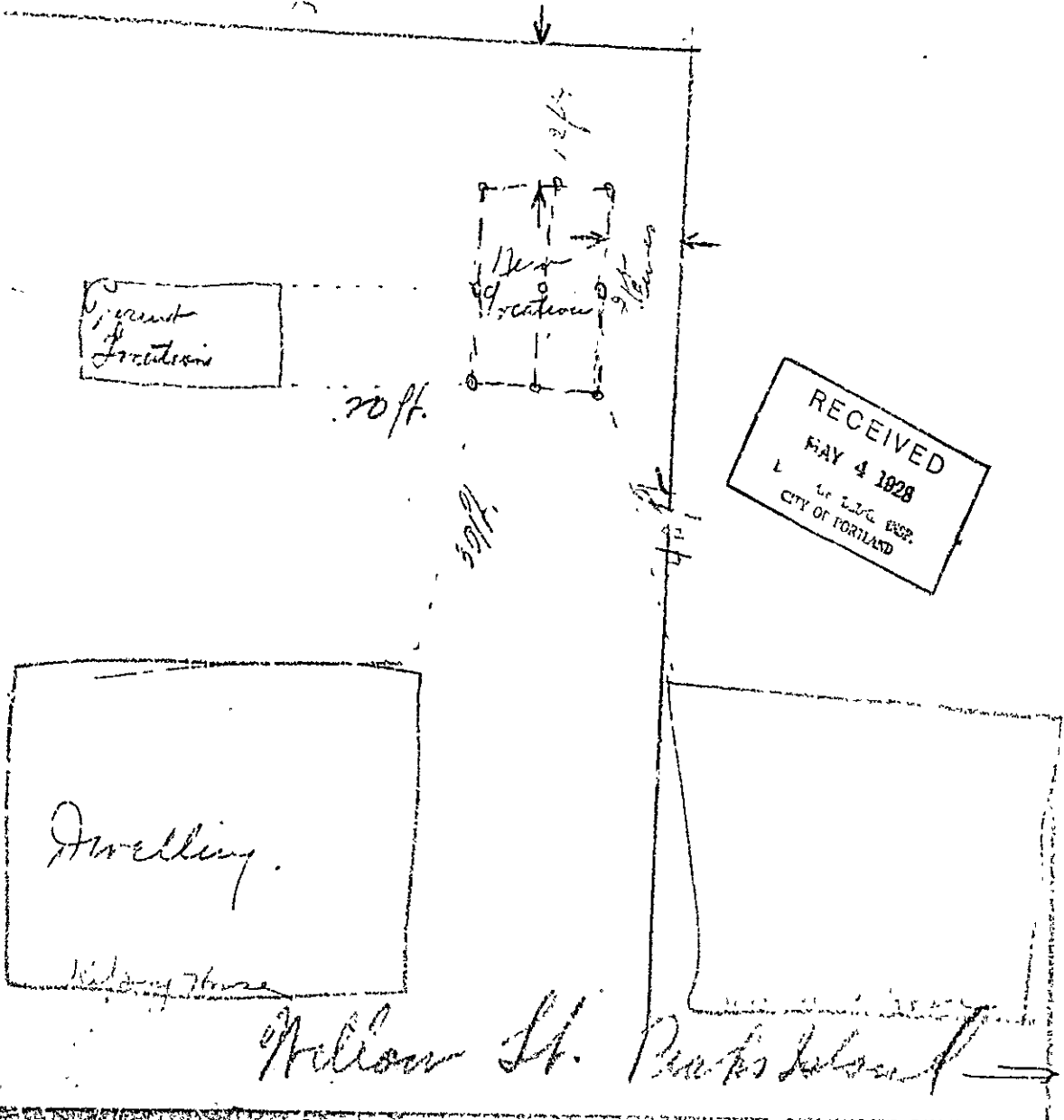

RECEIVED
MAY 4 1928
CITY OF PORTLAND



(A) APARTMENT HOUSE ZONE

Permit No. 1554 ISSUED 5/7/38

APPLICATION FOR PERMIT

Class of Building or Type of Structure 3rd

Portland, Maine, May 4 1938

To the INSPECTOR OF BUILDINGS, PORTLAND, ME.

The undersigned hereby applies for a permit to ~~erect~~ alter ~~the~~ following building ~~in accordance with the Laws of the State of Maine, the Building Code of the City of Portland, plans and specifications, if any, submitted herewith and the following specifications:~~

Location Willow St. P I Forest City Ldg. Ward 1 Within Fire Limit? no Dist. No. _____

Owner's or Lessee's name and address Mary D. Kelsoy Willow St. P.I. Telephone 221-3262

Contractor's name and address A. S. Brown Telephone _____

Architect's name and address _____

Proposed use of building 1 Car Garage No. families _____

Other buildings on same lot Dwelling House

Description of Present Building to be Altered

Material wood No. stories 1 Heat none Style of roof pitch Roofing wood

Last use 1 room cottage No. families _____

General Description of New Work

Have 1 room cottage about 20'-0" on same lot, to be used as 1 car garage
Cut one large door in front

NOTIFICATION BEFORE LAUNCHING OR CLOSING IS WAIVED

DETAILS OF OCCUPANCY OF THE PERMIT DOES NOT INCLUDE THE RIGHT TO MOVE ANY BUILDING THROUGH THE PUBLIC STREETS OF THE CITY

Size, front 22 depth 16 No. stories 1 average grade to highest point of roof 17

To be erected on solid or filled land? solid

Material of foundation concrete Thickness, top _____ bottom _____

Material of underpinning _____ Height _____ Thickness _____

Kind of roof _____ Roof covering _____

No. of chimneys none Material of chimney _____ of lining _____

Kind of heat none Type of fuel _____ Distance, heater to chimney _____

If oil burner, name and model _____

Capacity and location of oil tanks _____

Is gas fitting involved? present Size of service _____

Corner posts _____ Sills _____ Girt or ledger board? _____ Size _____

Material columns under girders _____ Max. on centers _____

Joists and rafters: 1st floor _____ 2nd _____ 3rd _____ roof _____

On centers: 1st floor _____ 2nd _____ 3rd _____ roof _____

Maximum span: 1st floor _____ 2nd _____ 3rd _____ roof _____

If one story building with masonry walls, thickness of walls? _____

If a Garage

No. cars now accommodated on same lot none to be accommodated 1

Total number commercial cars to be accommodated no

Will automobile repairing be done other than minor repairs to cars habitually stored in the proposed building? none

Miscellaneous

Will above work require removal or disturbing of any shade tree on a public street? no

Plans filed as part of this application? yes No. sheets 1

Estimated cost \$ 25.00 Fee \$ 5.00

Will there be in charge of the above work a person competent to see that the State and City requirements pertaining thereto are observed? yes

APPROVED
INSPECTION COPY
William J. Sanderson
CHIEF OF FIRE DEPT.

Signature of owner Mary D. Kelsoy

63-117

Ward 1 Permit No. 28/774
Location Willow St. Pearl Is
Owner Mary D. Kelsey
Date of permit 5/7/28
Notif. closing-in _____
In closing-in _____
Final Notif. _____
Final Inspn. _____
Cert. Occupancy issued 87

NOTES

~~3/1/29
P.T.F. X~~

87-KA-2 Willow Street

Peaks Isl.





APPLICATION FOR PERMIT

PERMIT ISSUED

B.O.C.A. USE GROUP

B.O.C.A. TYPE OF CONSTRUCTION

02232

NOV 9 1983

ZONING LOCATION

PORTLAND, MAINE

Nov. 8, 1983

CITY OF PORTLAND

To the CHIEF OF BUILDING & INSPECTION SERVICES, PORTLAND, MAINE

The undersigned hereby applies for a permit to erect, alter, repair, demolish, move or install the following building, structure, equipment or change use in accordance with the Laws of the State of Maine, the Portland B.O.C.A. Building Code and Zoning Ordinance of the City of Portland with plans and specifications, if any, submitted herewith and the following specifications:

LOCATION 87-71 4, 5, 6 & 7 POSE ST., POSE ISLAND

1. Owner's name and address Richard Ferri - 322 Pose Street Fire District #1 3068

2. Lessee's name and address Telephone 775-3068

3. Contractor's name and address Jack Hutchins - A St., Pks., Island Telephone 766-4490

Proposed use of building Ceiling with porch No. of sheets 1

Last use No. families 1

Material No stories Heat Style of roof Roofing

Other buildings on same lot

Estimated contractual cost \$ 500.00

FIELD INSPECTOR—Mr. Appeal Fees \$ 15.00

..... @ 775-5451 Base Fee 15.00

..... Late Fee 15.00

TOTAL \$ 15.00

To repair existing 10' x 20' porch and to replace with 10' x 9' porch as per plans. 1 sheet of plans.

send permit to # 1 04101

Stamp of special Conditions

NOTE TO APPLICANT: Separate permits are required by the installers and subcontractors of heating, plumbing, electrical and mechanicals.

DETAILS OF NEW WORK

Is any plumbing involved in this work? Is any electrical work involved in this work? NO

Is connection to be made to public sewer? If not, what is proposed for sewage?

Has septic tank notice been sent? Form notice sent?

Height average grade to top of plate Height average grade to highest point of roof

Size, front depth No. stories solid or filled land? earth or rock?

Material of foundation Thickness, top bottom cellar

Kind of roof Rise per foot Roof covering

No. of chimneys Material of chimneys of lining Kind of heat fuel

Framing Lumber—Kind Dressed or full size? Corner posts Sills

Size Girder Columns under girders Size Max. on centers

Studs (outside walls and carrying partitions) 2x4-16" O. C. Bridging in every floor and flat roof span over 8 feet.

Joists and rafters: 1st floor 2nd 3rd roof

On 1st floor 2nd 3rd roof

Maximum span: 1st floor 2nd 3rd roof

If one story building with masonry walls, thickness of walls? height?

IF A GARAGE

No. cars now accommodated on same lot to be accommodated number commercial cars to be accommodated

Will automobile repairing be done other than minor repairs to cars habitually stored in the proposed building? NO

APPROVALS BY: DATE

BUILDING INSPECTION—PLAN EXAMINER

MISCELLANEOUS

Will work require disturbing of any tree on a public street?

BUILDING CODE:

Fire Dept.:

Health Dept.:

Others:

Will there be in charge of the above work a person competent to see that the State and City requirements pertaining thereto are observed?

Signature of Applicant RICHARD FERRI Phone 775-3068

Type Name of above

Other: 1 2 3 4

and Address

FIELD INSPECTOR'S COPY

APPLICANT'S COPY

OFFICE FILE COPY