

PLATE 15121  
31-2-71 15121 15121

**Smead**  
No. 133c  
NASTING, NH  
LOS ANGELES, CHICAGO, LOGAN, OH  
MCGREGOR, TX-LOCUST GROVE, GA  
U.S.A.



FILL IN AND SIGN WITH INK

00344 PERMIT ISSUED

APPLICATION FOR PERMIT FOR HEATING, COOKING OR POWER EQUIPMENT

SEP 30 1982

Portland, Maine, .... Sept., 29, 1982..... CITY of PORTLAND

To the INSPECTOR OF BUILDINGS, PORTLAND, ME.

The undersigned hereby applies for a permit to install the following heating, cooking or power equipment in accordance with the Laws of Maine, the Building Code of the City of Portland, and the following specifications:

Location 87-K-22 Island Ave., P. Use of Building sin. fam. No Stories 2 New Building Existing 'x' Name and address of owner of appliance Jane Teft. - sams 04108 Installer's name and address Coleman Mulkern - Island Ave., Peaks Isl. Telephone 766-2508.

General Description of Work

To install Replacement furnace - Hot Air Johnson Air Ease

IF HEATER, OR POWER BOILER

Location of appliance Any burnable material in floor surface or beneath? If so, how protected? Kind of fuel? Minimum distance to burnable material, from top of appliance or casing top of furnace From top of smoke pipe From front of appliance From sides or back of appliance Size of chimney flue Other connections to same flue If gas fired, how vented? Rated maximum demand per hour Will sufficient fresh air be supplied to the appliance to insure proper and safe combustion?

IF OIL BURNER

Name and type of burner XXXXXXXXXXXXXXXX Beckett Labeled by underwriters' laboratories? yes Will operator be always in attendance? no Does oil supply line feed from top or bottom of tank? bottom Type of floor beneath burner concrete Size of vent pipe 1 1/2" Location of oil storage cellar Number and capacity of tanks 1 - 275 Low water shut off Make No Will all tanks be more than five feet from any flame? How many tanks enclosed? Total capacity of any existing storage tanks for furnace burners 1-275

IF COOKING APPLIANCE

Location of appliance Any burnable material in floor surface or beneath? If so, how protected? Height of Legs, if any Skirting at bottom of appliance? Distance to combustible material from top of appliance? From front of appliance From sides and back From top of smokepipe Size of chimney flue Other connections to same flue Is hood to be provided? If so, how vented? Forced or gravity? If gas fired, how vented? Rated maximum demand per hour

MISCELLANEOUS EQUIPMENT OR SPECIAL INFORMATION

Amount of fee enclosed? 15.00

APPROVED:

Will there be in charge of the above work a person competent to see that the State and City requirements pertaining thereto are observed? yes

Signature of Coleman A. Mulkern

Signature of Installer Coleman Mulkern

CS 300

INSPECTION COPY

7

Permit No. 00844

Location Island, Ill

Owner Janie Zell

Date of permit 9-30-82

Approved RT-Cis-Turn

NOTES

10-19-82 - completed  
OK. OC

1. 1 1/2" FILL PIPE
2. 1 1/4" VENT PIPE
3. Kind of Heat
4. Furner Rigidity & Support
5. Name & Label
6. Hi-h Label Control
7. Mech Cutoff Switch
8. Low Pressure Switch
9. Hi-h Limit Control
10. Valves in supply line
11. Tank in tanks
12. Control & Support
13. Ventilation
14. Control switch
15. Combustible
16. Control switch
17. Control switch
18. Control switch
19. Control switch
20. Control switch





**CERTIFICATE OF APPROVAL**

FOR WASTEWATER DISPOSAL FOR THE TOWN/CITY OF Portland

Town/City Code: 05170 LPI Number: 00123 Date Issued: 4/1/81  
 Month Day Year

RTAB, EC  
 Certificate of App. Number

Installer's Name: PLAMTE Last Name: PL F.I.M.I.

Owner: Jill Jones F.I.M.I.  
 Address: 87-4-221 Location where system was installed and inspected

Installer Code: 3  
 1. Owner  
 2. Builder  
 3. Installer  
 4. Developer  
 5. Realtor  
 6. Other

THE SUBSURFACE WASTEWATER DISPOSAL SYSTEM OR COMPONENT(S) INSTALLED PURSUANT TO THE ABOVE CERTIFICATE OF APPROVAL NUMBER HAS BEEN PERSONALLY EXAMINED AND HAS BEEN PROPERLY INSTALLED IN COMPLIANCE WITH THE MUNICIPAL AND STATE SUBSURFACE WASTEWATER DISPOSAL RULES AND THE HHE-203 FORM PERFORMED BY

3 ON 4/1/81  
 (LPI Evaluator Number) Month Day Year

**TOWN'S COPY**

Signature of LPI: Emilio J. Gordin  
 Date Inspected: APR 21 1981

**SUBSURFACE WASTEWATER DISPOSAL PERMIT**

Town/City Code: 05170 LPI Number: 00123 Date Issued: 4/1/81 Evaluator Number: 00003  
 Month Day Year

FOR THE TOWN/CITY OF Portland  
 PERMIT NUMBER: 00 EP

Address of System's Location: 87-4-221 (Lot Number Street, Road Name/Subdivision)

Name of Owner: PLAMTE Last Name: PL F.I.M.I. Mailing Address: 87-4-221 Zip Code: 04103

Issue Code: 3  
 1. Owner  
 2. Builder  
 3. Installer  
 4. Developer  
 5. Realtor  
 6. Other

Permit Issuance	1 No Variance Required	2 Replacement Variance	3 New System Variance	4 Local Site Evaluation Waiver Option	<u>2</u>	
Type of System	1 New	2 Replacement	3 Expansion	4 Experimental	5 Encroachment	<u>1</u>
Replacement or Malfunction	If system is being replaced or is a malfunction, enter year of original system installation					
System to Same	1. Single (Res)	3. Mobile Home	5. Commercial	7. Other (Specify)		
Complex System	1. Septic	2. Chamber	3. Special System (Includes one waterless toilet)	4. Other (Specify)	5. Trench	
Treatment Tank ONLY	1. Septic	2. Aerobic	3. Holding			
Disposal	1. Band	5. Trench	2. Chamber	3. Laundry Wastes	4. Other (Specify)	
Waterless Toilets	1. Pit Privy	2. Vault Privy	3. Compost Toilet	4. Other (Specify) (\$10. each)		

**TOWN'S COPY**

LPI to Insert Profile (a)  Soil Condition (L)  Total Fee: 30.00

**IMPORTANT. Note the following conditions:**  
 1 This Permit is non transferable to another person or party  
 2 If construction has not started within 6 months from the Date of Issue, this Permit becomes Invalid

If Double Fee Check (  ) Box

Signature of LPI

April 13, 1981

Jane Tefft  
Island Avenue  
Peaks Island, ME 04108

Subject: Replacement System; Variance to the Maine Subsurface Wastewater Disposal Rules, Tefft property, Lot #22, Peaks Island, Portland

Dear Sir:

This is to acknowledge receipt of the following items:

A completed HHE-200 Form by William Goodwin SE; a completed HHE-204 Form signed by Jane Tefft, property owner; William Goodwin, SE., and Errol Goodwin, LPI. The above was accepted as a complete application for variance to the Subsurface Wastewater Disposal Rules. A replacement subsurface disposal system cannot be installed on the subject property in full compliance with the Rules because of the installation of a 20'x35' bed system on category 4C soils with a seasonal high water table at 35 inches and the following reductions in setback distances:

1. Distance from disposal area to man-made drainage ditch from 25 feet to 5 feet;
2. Distance from disposal area to building with basement from 20 feet to 9 feet;
3. Distance from disposal area to property line from 10 feet to 2 feet.

In consideration of the HHE-200 Form dated April 6, 1981, along with the recommendations and justifications noted on the HHE-215 Form, this office hereby grants the responsible local plumbing inspector the authority to waive certain provisions of the Subsurface Wastewater Disposal Rules, for the following replacement disposal system under the authority of Section 15 B of the Rules.

The installation of a 20'x35' bed system to receive the effluent from an existing 750 gallon septic tank.

At least 14 (cut) inches and 7 inches of fill shall be applied on the uphill and downhill sides of the disposal field, respectively. The fill shall be of a texture similar to the original soil and will provide a 12 inch separation between the bottom of the disposal bed and the seasonal high water table and impervious layer. The fill must be extended in all directions as required by Section 11.D of the Subsurface Wastewater Disposal Rules.

Jane Tefft  
April 13, 1981  
Page 2

In all other respects the installation is to comply with the Subsurface Wastewater Disposal Rules and follow the plan submitted with this proposal.

Please be advised that this approval is in no way to be construed as a guarantee of the system's performance. You are reminded that the correction of any future nuisance conditions is the responsibility of the property owner.

Final approval of the sewage portion is subject to permit by the Local Plumbing Inspector before the construction of this system. A completed HHE-200 Form must be submitted to him for processing. The inspector is to be notified before covering the work, and the work is to be left uncovered until his inspection. He shall be supplied with copies of approved plans for his reference at inspection. Approval is also subject to any local ordinances and state laws.

Very truly yours,



David P. Breau  
Plans & Standards Review  
Division of Health Engineering

KLK/jh  
William Goodwin, SE  
Ernold Goodwin, LPI



April 13, 1981

Jane Tefft  
Island Avenue  
Peaks Island, ME 04108

Subject: Replacement System Variance to the Maine Subsurface Wastewater Disposal Rules, Tefft property, Lot #22 Peaks Island, Portland

Dear Sir:

This is to acknowledge receipt of the following items:

A completed HHE-200 Form by William Goodwin SE.; a completed HHE-204 Form signed by Jane Tefft, property owner; William Goodwin, SE., and Errol Goodwin, LPI. The above is accepted as a complete application for variance to the Subsurface Wastewater Disposal Rules. A replacement subsurface disposal system cannot be installed on the subject property in full compliance with the Rules because of the installation of a 20'x35' bed system on category 4C soils with a seasonal high water table at 35 inches and the following reductions in setback distances:

1. Distance from disposal area to man-made drainage ditch from 25 feet to 5 feet;
2. Distance from disposal area to building with basement from 20 feet to 9 feet;
3. Distance from disposal area to property line from 10 feet to 5 feet.

In consideration of the HHE-200 Form dated April 6, 1981, along with the recommendations and justifications noted on the HHE-210 Form, this office hereby grants the responsible local plumbing inspector the authority to waive certain provisions of the Subsurface Wastewater Disposal Rules, for the following replacement disposal system under the authority of Section 15.B of the Rules.

The installation of a 20'x35' bed system to receive the effluent from an existing 750 gallon septic tank.

At least 14 (cut) inches and 7 inches of fill shall be applied on the uphill and downhill sides of the disposal field, respectively. The fill shall be of a texture similar to the original soil and will provide a 12 inch separation between the bottom of the disposal bed and the seasonal high water table and impervious layer. The fill must be extended in all directions as required by Section 11.D of the Subsurface Wastewater Disposal Rules.

Jane Tefft  
April 13, 1981  
Page 2

In all other respects the installation is to comply with the Subsurface Wastewater Disposal Rules and follow the plan submitted with this proposal.

Please be advised that this approval is in no way to be construed as a guarantee of the system's performance. You are reminded that the correction of any future nuisance conditions is the responsibility of the property owner.

Final approval of the sewage portion is subject to permit by the Local Plumbing Inspector before the construction of this system. A completed HHE-200 Form must be submitted to him for processing. The inspector is to be notified before covering the work, and the work is to be left uncovered until his inspection. He shall be supplied with copies of approved plans for his reference at inspection. Approval is also subject to any local ordinances and state laws.

Very truly yours,

David P. Breaux  
Plans & Standards Review  
Division of Health Engineering

KLK/ih  
cc: William Goodwin, SE  
Ernold Goodwin, LPI

## Replacement System Variance Request

### THE LIMITATIONS OF THE REPLACEMENT SYSTEM VARIANCE REQUEST

This form shall be attached to an Application for the proposed replacement system which is in noncompliance with the Rules. The LPI shall review the Replacement System Variance Request and Application and may approve the Request if all of the following requirements with LPI approval limitations can be met.

1. The replacement system is correcting a malfunction or an unlicensed wastewater discharge system.
2. A replacement system cannot be designed and installed in total compliance with the Rules.
3. The design flow is less than 500 GPD.
4. There will be no change in use of the structure.
5. The replacement system does not conflict with Seasonal Conversion Permit (30 MDSA § 3223) or with Mandatory Shoreland Zoning (12 MRSA § 4811)
6. The replacement system is determined by the Site Evaluator and LPI to be the most practical method to treat and dispose of the wastewater.

#### GENERAL INFORMATION

Town of Portland

Town Code 05170

Permit No. 37940E

Date Permit Issued APR 17 1981  
month/day/yr.

Property Owner's Name: Jane Tefft

Tel No 766-5098

System's Location: Island Avenue Tax Map 87 Block K Lot 22  
Street

Peaks Island

Town

MAINE 04108

Zip

Property Owner's Address:  
(If different from above) same as above  
Street

Town

State

Zip

#### Specific Instructions to the:

**LPI:** If any of the variances exceed your approval authority and/or do not meet all of the requirements listed under the Limitations Section above, then you are to send this Replacement System Variance Request, along with the Application, to the Department for review and approval consideration before issuing a Permit. (See reverse side for Comments Section and your signature)

**Site Evaluator:** If after completing the Application, you find that a variance for the proposed replacement system is needed, then complete this Replacement System Variance Request with your signature on reverse side of form.

**Property Owner:** It has been determined by the Site Evaluator that a variance to the Rules is required for the proposed replacement system. This variance request is due to physical limitations of the site and/or soil conditions. Both the Site Evaluator and the LPI have considered the site/soil restrictions and have concluded that a replacement system in total compliance with the Rules is not possible.

The Owner shall sign this statement. Therefore, having read both this Replacement Variance Request and the attached Application, I understand that the proposed system is not in total compliance with the Rules and hereby release all those concerned with this Variance, provided they have performed their duties in a reasonable and proper manner.

  
Property Owner's Signature

April 6, 1981

Date

Variance Category	Variance Requested	Limit of LPI's Approval Authority		Variance Requested to:	
Soils Soil Profile Soil Condition from HHE-200	Ground Water Table	to 6'		N.A. inches	
	Restrictive Layer	to 6'		N.A. inches	
	Bedrock	to 10'		N.A. inches	
Setback Distances (in feet)	From:	Treatment Tank	Disposal Area	Treatment Tank	Disposal Area
Potable Water Supplies	1. Well > 2000 gal/day	100a	300a	EXISTING 750 GALLON SEPTIC TANK TO BE USED	N.A.
	2. Well < 2000 gal/day	100b	100b		N.A.
	a. Neighbor's	50'	60'		N.A.
b. Property Owner's	See Note 'a'		N.A.		
3. Water Supply Line					N.A.
Waterbodies	1. Perennial	60'	60'		N.A.
	2. Intermittent	25'	25'	N.A.	
	3. Manmade drainage ditch			N.A.	
Downhill Slope	Greater than 3:1 (33%)	15'	15'	N.A.	
Buildings	1. With basement	5'	10'	5'	
	2. Without basement	See Note 'a'	15'	N.A.	
Property Line		5'	5'	9'	
Other Specify:				2'	

Downhill fill extending over streetline of Island Ave. with an extension of the existing roadside culvert system to permit better site grading and to prevent road drainage from interfering with system.

- Footnotes:
- a. This setback distance cannot be reduced by variance. See Table 6-2.
  - b. A variance to reduce the 100 foot setback distance to a minimum of 60 feet may be granted only with the neighbor's written permission.
  - c. Sufficient distance shall be maintained to assure that the toe of the fill does not extend to the 3:1 slope.

William B. Goodwin  
Site Evaluator's Signature April 5, 1981  
Date

LPI Statement  
I, Ernie A. Goodwin, LPI for the City of Portland, have conducted an on-site inspection for the proposed replacement system and have determined, to the best of my knowledge, that it cannot be installed in total compliance with the Rules, applicable Municipal Ordinances, or the Local Shoreland Zoning Ordinance. As a result of my review of the Replacement System Variance Request, the Application, and my on-site investigation, I (check and complete either a or b):

- a. I approve,  do not approve) the variance request based on my authority to grant this variance. Note: If the LPI does not give his approval, he shall list his reasons for denial in Comments Section below and return to the applicant.
- b. find that one or more of the requested variances exceeds my approval authority as LPI I (X) recommend,  (do not recommend) the Department's approval of the variances. Note: If the LPI does not recommend the Department's approval, he shall state his reasons in Comments Section below as to why the proposed replacement system is not being recommended.

Comments: See attached letter to Fred E. Breau  
Ernie A. Goodwin R.S.  
Signature April 6, 1981  
Date

FOR USE BY THE DEPARTMENT ONLY:  
The Department has reviewed the variance(s) and  does,  does not) give its approval. Any additional requirements, recommendations, or reasons for the Variance denial, are given in the attached letter.

Signature of the Department Date



APPLICATION FOR SUBSURFACE WASTEWATER DISPOSAL PERMIT

Page 2 of 2

PROPERTY LOCATION <b>Portland- Peaks Island</b>	Island Ave. Street Road	Tax Map 07, Block K	Lot No. 22
PROPERTY OWNER OR APPLICANT <b>Jane Tefft</b>	DISPOSAL AREA ELEVATION Depth of Upslope Fill required <b>-14 (cut)</b> inches Depth of Downslope Fill required <b>7</b> inches	Reference Elevation Point established at <b>50.00</b> Elevation. Disposal Area Bottom to be established at <b>47.13</b> Elevation. Top of Distribution Lines or Top of Chamber at <b>48.21</b> Elevation.	

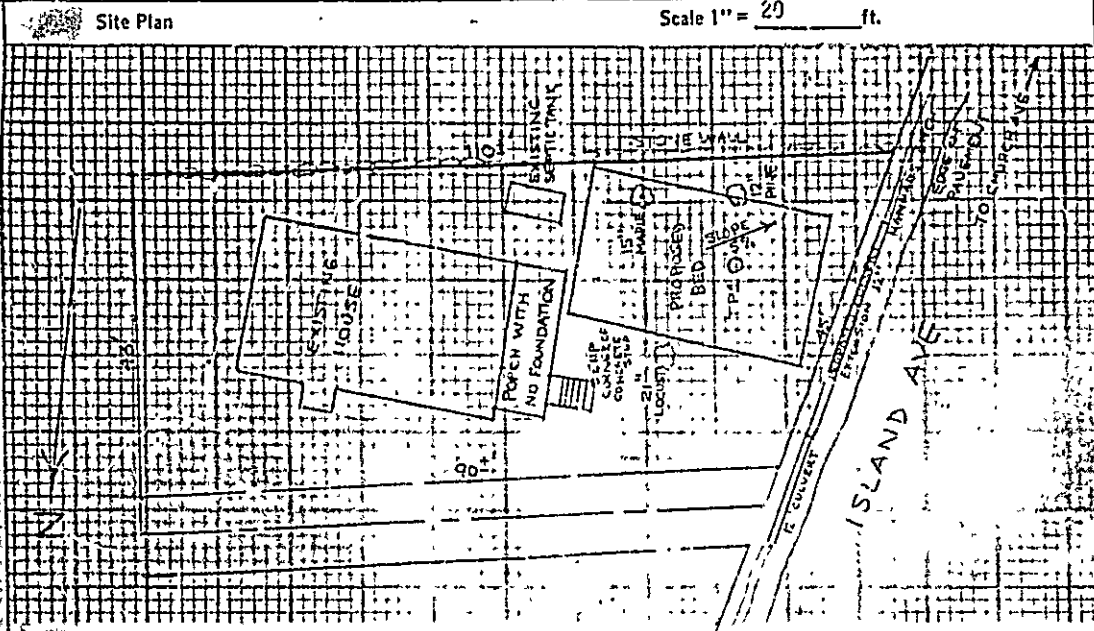

⊙ Designates Elevation Reference Point (ERP)  
○ Designates Observation Hole (TP or B)

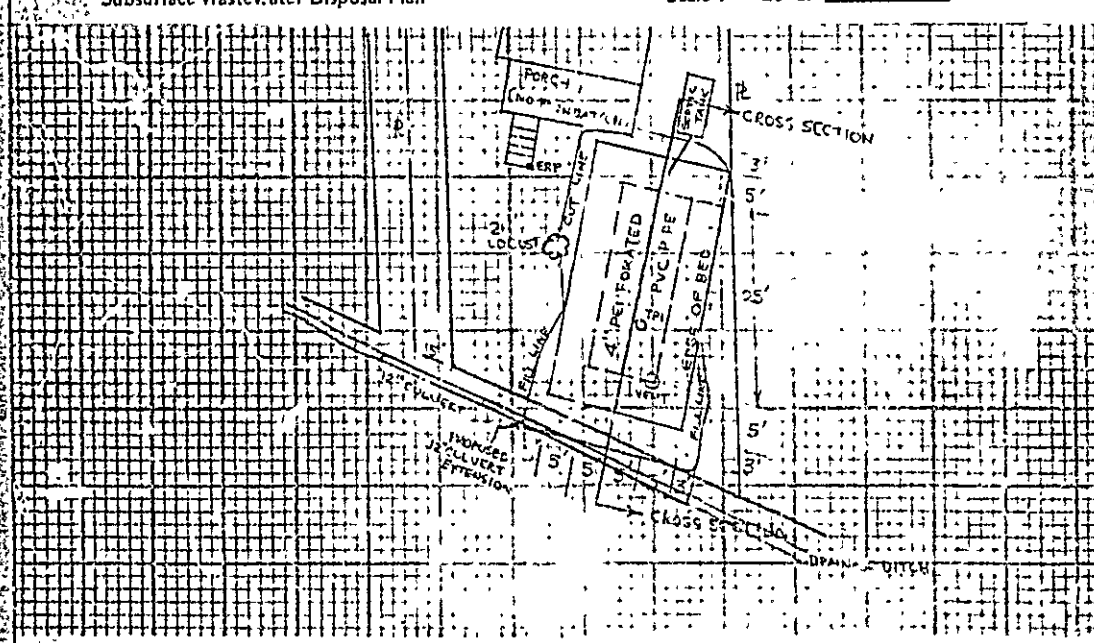

Subsurface Wastewater Disposal Area Cross-section  
Scale: Vertical: 1" = 5'  
Horizontal: 1" = 20'

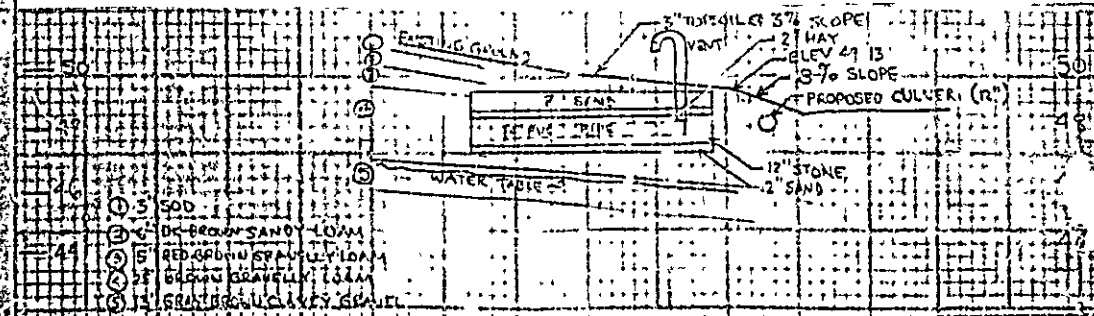

Site Evaluators Signature: **William B. Goodwin** Date: **4/6/81** License Number: **00003**