

BRACKETT AVE., PEAKS ISLAND

87-11-7



FILL IN AND SIGN WITH INK

APPLICATION FOR PERMIT FOR HEATING, COOKING OR POWER EQUIPMENT

Portland, Maine, Dec. 30, 1955

PERMIT ISSUED
02101
DEC 30 1955

To the INSPECTOR OF BUILDINGS, PORTLAND, ME.

The undersigned hereby applies for a permit to install the following heating, cooking or power equipment in accordance with the Laws of Maine, the Building Code of the City of Portland, and the following specifications:

37-13-7

Location Brackett Ave., Peaks Island of Building.. dwelling house... No. Stories ... New Building
Existing "
Name and address of owner of appliance ..Consumer Water Co., 95 Exchange St.
Installer's name and address ... Randall & McAllister, 84 Commercial St. Telephone 3-2941

General Description of Work

To install .. oil burning equipment in connection with existing steam heating system
..... (conversion)

IF HEATER, OR POWER BOILER

Location of appliance ... Any burnable material in floor surface or beneath?
If so, how protected? ... Kind of fuel?
Minimum distance to burnable material, from top of appliance or casing top of furnace
From top of smoke pipe From front of appliance From sides or back of appliance
Size of chimney flue Other connections to same flue
If gas fired, how vented? Rated maximum demand per hour
Will sufficient fresh air be supplied to the appliance to insure proper and safe combustion?

INSPECTION NOT COMPLETED
2/25/57

IF OIL BURNER

Name and type of burner .. Timken .. Labeled by underwriters' laboratories?
Will operator be always in attendance? .. Does oil supply line feed from top or bottom of tank? ..bottom.....
Type of floor beneath burner .. concrete .. Size of vent pipe .. 1 1/2"
Location of oil storage .. basement .. Number and capacity of tanks .. 1-275 gal.
Low water shut off .. yes .. Make .. McDonnell Miller .. No. 67
Will all tanks be more than five feet from any flame? .. yes .. How many tanks enclosed? ..
Total capacity of any existing storage tanks for furnace burners .. none ..

IF COOKING APPLIANCE

Location of appliance .. Any burnable material in floor surface or beneath? ..
If so, how protected? .. Height of Legs, if any ..
Skirting at bottom of appliance? .. Distance to combustible material from top of appliance? ..
From front of appliance .. From sides and back .. From top of smokepipe ..
Size of chimney flue .. Other connections to same flue ..
Is hood to be provided? .. If so, how vented? .. Forced or gravity? ..
If gas fired, how vented? .. Rated maximum demand per hour ..

MISCELLANEOUS EQUIPMENT OR SPECIAL INFORMATION

Amount of fee enclosed? .. 2.00 .. (\$2.00 for one heater, etc., 50 cents additional for each additional heater, etc., in same building at same time.)

APPROVED:
[Signature]

Will there be in charge of the above work a person competent to see that the State and City requirements pertaining thereto are observed? .. yes ..

Randall & McAllister

CITY OF PORTLAND, MAINE PRINTING CO.

INSPECTION COPY

Signature of Installer by: *J.C. [Signature]*

NOTES

- 1 Mill Pipe
- 2 Vent Pipe
- 3 Kind of Heat
- 4 Burner Regulation & Supports
- 5 Name & Label
- 6 Stack Control
- 7 High Limit Control
- 8 Remote Control
- 9 Piping Support & Protection
- 10 Valves
- 11 Connections
- 12 Tank & Pipe Supports
- 13 Tank Details
- 14 Oil Gauge
- 15 Instruction Manual
- 16 Low Water Switch

Permit No. 55/2404
Location Pinchett Ave, Park
Owner Commonwealth Co.
Date of permit 12/30/55

INSPECTION NOT COMPLETED

7/25/57
E. J. 88



FILL IN COMPLETELY AND SIGN WITH INK

PERMIT ISSUED

Permit No. _____
FEB 16 1934 0130

APPLICATION FOR PERMIT FOR HEATING, COOKING OR POWER EQUIPMENT

February 16, 1934

Portland, Maine, _____

To the INSPECTOR OF BUILDINGS, PORTLAND, ME.

The undersigned hereby applies for a permit to install the following heating, cooking or power equipment in accordance with the Laws of Maine, the Building Code of the City of Portland, and the following specifications:

Location Brackett Avenue, Peaks Island Use of Building dwelling house
Name and address of owner Portland Water District Ward Isl. 2
Contractor's name and address Halverson Bros. 9-15 Union St.

General Description of Work

To install warm air furnace

IF HEATER, POWER BOILER OR COOKING DEVICE

Is heater or source of heat to be in cellar? yes If not, which story _____ Kind of Fuel coal
Material of supports of heater or equipment (concrete floor or what kind) concrete
Minimum distance to wood or combustible material, from top of boiler or casing top of furnace, _____
from top of smoke pipe 5' from front of heater over 4' from sides or back of heater over 3'
as other connection to this chimney _____

IF OIL BURNER

Name and type of burner _____ Labeled and approved by Underwriters' Laboratories? _____
Will operator be always in attendance? _____ Type of oil feed (gravity or pressure) _____
Location oil storage _____ No. and capacity of tanks _____
Will all tanks be more than seven feet from any flame? _____ How many tanks fireproofed? _____
Amount of fee enclosed 1.00 (\$1.00 for one heater, etc., 50 cents additional for each additional heater, etc., in same building at same time.)
Halverson Bros.

INSPECTION COPY

Signature of contractor Oliver H. Halverson

REGISTRATION BEFORE LATHING OR CLOSING-IN IS WAIVED

CERTIFICATE OF OCCUPANCY REQUIREMENT IF WANTED

REC 2/16/34

3757

Ward D 2 Permit No. 34/30
 Location Brackell Ave Peaks
 Owner Peabody Water District
 Date of permit 2/16/34
 Notif. closing-in
 Insn. closing-in
 Final Notif.
 Final Insn. 5/14/34 - OIT
 Cert. of Occupancy issued None

NOTES
 5/14/34 - Installation
 OIT A.G.
~~PERMIT FOR HEATING COOKING OR POWER EQUIPMENT~~
 City of New York
 Department of Public Works
 Bureau of Steam Fitting

IF HEATER, BURNER, RANGE OR COOKING DEVICE

Heater, burner, range or cooking device shall not be placed in any building unless it is certified as safe by a duly authorized inspector of the Department of Public Works and shall be installed in accordance with the requirements of the Building Code of the City of New York and shall be installed in accordance with the rules and regulations of the Department of Public Works.

IN OIL BURNERS

Oil burner shall be installed in accordance with the requirements of the Building Code of the City of New York and shall be installed in accordance with the rules and regulations of the Department of Public Works.

INSTALLATION CONTRACT

Statement of Contractor

I, the undersigned, hereby certify that the installation of the above described heater, burner, range or cooking device was done in accordance with the requirements of the Building Code of the City of New York and the rules and regulations of the Department of Public Works.

 Signature of Contractor

 Date



(A) APARTMENT HOUSE ZONE **Permit No. ISSUED**
APPLICATION FOR PERMIT **0081**

Class of Building or Type of Structure Mill Construction **JAN 26 1934**

Portland, Maine, January, 28, 1934

To the INSPECTOR OF BUILDINGS, PORTLAND, ME.

The undersigned hereby applies for a permit to erect alter install the following building structure equipment in accordance with the laws of the State of Maine, the Building Code of the City of Portland, plans and specifications, if any, submitted herewith and the following specifications:

Location Brackett Avenue, Park Ward 1st.2 Within Fire Limits? no Dist. No. _____

Owner's or Lessee's name and address Portland Water District, 16 Casco St. Telephone _____

Contractor's name and address Owner Telephone _____

Architect's name and address _____

Proposed use of building dwelling house with garage attached, office No. families 1

Other buildings on same lot _____

Plans filed as part of this application? yes No. of sheets 1

Estimated cost \$ 1,100. Fee \$ 2.75

Description of Present Building to be Altered

Material brick No. stories 1 Hea. none Style of roof hip Roofing slate

Last use pumping station No. families _____

General Description of New Work

To put in plaster partitions to provide five rooms and bath, with office, and garage and frame (brick wall between garage and dwelling, door to be metal covered with self-closing device as required by Building Code)

To put in no new window at least three square feet in area for new bath room

To put triple mullion window in place of sliding door in front of building

It is understood that this permit does not include installation of heating apparatus which is to be taken out separately by and in the name of the heating contractor.

Details of New Work

Size, front _____ depth _____ No. stories _____ Height average grade to top of plat. _____
 Height average grade to highest point of roof _____

To be erected on solid or filled land? _____ earth or rock? _____

Material of foundation _____ Thickness, top _____ bottom _____

Material of underpinning _____ Height _____ Thickness _____

Kind of Roof _____ Rise per foot _____ Roof covering _____

No. of chimneys _____ Material of chimneys _____ of lining _____

Kind of heat war air furnace to be covered under separate permit Type of fuel _____ Is gas fitting involved? _____

Corner posts _____ Sills _____ Girt or ledger board? _____ Size _____

Material columns under girders _____ Size _____ Max. on centers _____

Studs (outside walls and carrying partitions) 2x4-16" O. C. Girders 6x8 or larger. Bridging in every floor and flat roof span over 8 feet. Sills and corner posts all one piece in cross section

Joists and rafters: 1st floor _____ 2nd _____ 3rd _____ roof _____

On centers: 1st floor _____ 2nd _____ 3rd _____ roof _____

Maximum span: 1st floor _____ 2nd _____ 3rd _____ roof _____

If one story building with masonry walls, thickness of walls? _____ height? _____

If a Garage

No. cars now accommodated on same lot 2 none to be accommodated 2

Total number commercial cars to be accommodated 1

Will automobile repairing be done other than minor repairs to cars habitually stored in the proposed building? no

Miscellaneous

Will above work require removal or disturbing of any sha. tree on a public street? no

Will there be in charge of the above work a person competent to see that the State and City requirements pertaining thereto are observed? yes Portland Water District

Signature of owner Er Lealie A. Libby

Oliver T. Sanborn

CHIEF OF FIRE DEPT.

INSPECTION COPY

132 923

Ward 22 Permi. No. 34/81
 Loc: Marshall Ave. Park
 Owner Portland Water District
 Date of permit 1/26/34
 Notif closing-in 1/31/34
 Inspn. closing-in 2/14/34 - 87
 Final No. 1. II
 Final insp. 5/14/34
 Cert. of Occupancy issued 5/15/34

NOTES:

1/26/33 - Mr. Dobby
 says that 6" raised
 curb around opening
 in metal covered hatch
 above will be provided
 opening in garage
 regarding the prominent
 stairs - D.G.B.
 2/1/34 - Final needed
 at floor - ceiling levels
 not to be broken in
 floor joists, a round
 chime in which pipe
 opening in ceiling only
 10" below timbers to be
 lowered if possible, if
 shield is to be pro-
 vided. Tag given to
 close in except where
 shown otherwise.

to bedones. No floor
 in attic. First floor
 timbers are 6x10 dressed
 with 6" x 6" span with
 plank floor. Watch for
 new joists over bath
 room also for joists
 from garage.

DEPARTMENT OF PERMITS
 CITY OF PORTLAND
 JOHN WOLF

87-11-7
Brackett
Ave.

Cross Bay Light & Water Company -

BRACKET Ave.

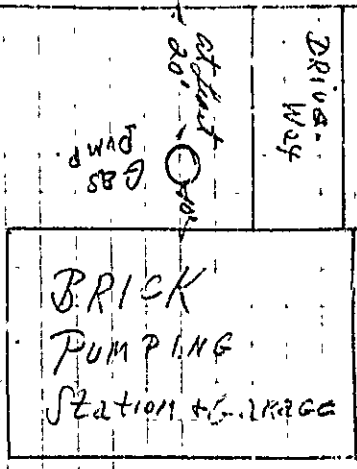



(2) APARTMENT HOUSE ZONE

PERMIT ISSUED
MAY 21 1930

APPLICATION FOR PERMIT

Class of Building or Type of Structure Gasoline Installation

Portland, Maine, May 20, 1930

To the INSPECTOR OF BUILDINGS, PORTLAND, ME.

The undersigned hereby applies for a permit to erect, alter or install the following building or equipment in accordance with the Laws of the State of Maine, the Building Code of the City of Portland, plans and specifications, if any, submitted herewith, and the following specifications:

Location Brackett Avenue, Peaks Island Ward 1 Within Fire Limits? No Dist. No. _____
 Owner's or Lessee's name and address Casco Bay Light & Water Co. Telephone 855
120 Exchange St.
 Contractor's name and address Owner Telephone _____
 Architect's name and address _____
 Proposed use of building _____ No. families _____
 Other buildings on same lot _____

Description of Present Building to be Altered

Material _____ No. stories _____ Heat _____ Style of roof _____ Roofing _____
 Last use _____ No. families _____

General Description of New Work

To install one 1000 gallon tank and one 5 gallon pump for gasolins, Private Use
 Tanks to be buried underground. New installation.

NOTIFICATION BEFORE LAYING
 OR CONCERN IS WAIVED.
 CERTIFICATE OF OCCUPANCY
 REQUIREMENT
 STORAGE APPLIED FOR

Details of New Work

Size, front _____ depth _____ No. stories _____ Height average grade to highest point of roof _____
 To be erected on solid or filled land? _____ earth or rock? _____
 Material of foundation _____ Thickness, top _____ bottom _____
 Material of underpinning _____ Height _____ Thickness _____
 Kind of roof _____ Roof covering _____
 No. of chimneys _____ Material of chimneys _____ of lining _____
 Kind of heat _____ Type of fuel _____ Distance, heater to chimney _____
 If oil burner, name and model _____
 Capacity and location of oil tanks _____
 Is gas fitting involved? _____ Size of service _____
 Corner posts _____ Sills _____ Girt or ledger board? _____ Size _____
 Material columns under girders _____ Size _____ Max. on centers _____
 Studs (outside walls and carrying partitions) 2x4-16" O.C. Girders 6x8 or larger. Bridging in every floor and flat roof
 span over 8 feet. Sills and corner posts all one piece in cross section.
 Joists and rafters: 1st floor _____, 2nd _____, 3rd _____, roof _____
 On centers: 1st floor _____, 2nd _____, 3rd _____, roof _____
 Maximum span: 1st floor _____, 2nd _____, 3rd _____, roof _____
 If one story building with masonry walls, thickness of walls? _____ height? _____

If a Garage

No. cars now accommodated on same lot _____, to be accommodated _____
 Total number commercial cars to be accommodated _____
 Will automobile repairing be done other than minor repairs to cars habitually stored in the proposed building? _____

Miscellaneous

Will above work require removal or disturbing of any shade tree on a public street? no
 Plans filed as part of this application? yes No. sheets 1
 Estimated cost \$ 50. Fee \$ 50

Will there be in charge of the above work a person competent to see that the State and City requirements pertaining thereto are observed? Yes
Casco Bay Light & Water Co.

Signature of owner _____

INSPECTION COPY

Oliver T. Sanborn

CHIEF OF FIRE DEPT.

1930

Ward 1 Permit No. 30/990

Location Bracket Ave, Oakland

Work Area Bay Light & Water

Date of Permit 5/21/30

off closing-in

Inspn. closing-in

Final Notif.

Final Inspn.

Cert. of Occupancy issued

NOTES

5/26/30 - P.I.I. - ags

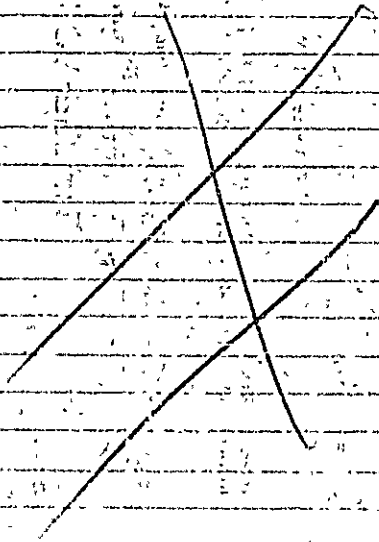

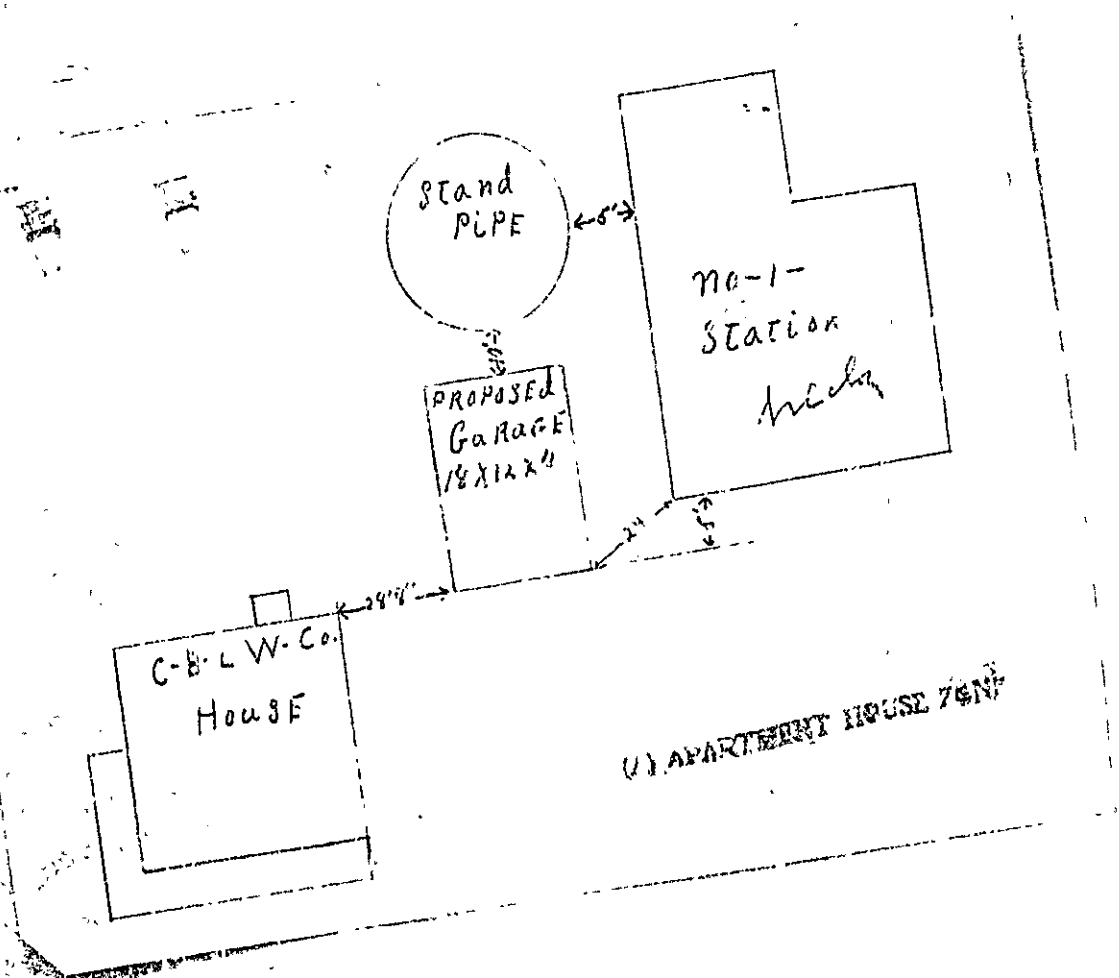

(1) APARTMENT HOUSE 70' x 70'



RECEIVED HOUSE PERMIT ISSUED

APPLICATION FOR PERMIT

Permit No. 6538
APR 16 1928

Class of Building or Type of Structure Third Class

Portland, Maine, April 15, 1928

To the INSPECTOR OF BUILDINGS, PORTLAND, ME.

The undersigned hereby applies for a permit to erect ~~and~~ all the following building structure or structures in accordance with the Laws of the State of Maine, the Building Code of the City of Portland, plans and specifications, if any, submitted herewith and the following specifications:

Location Brackett Avenue, Port Island Ward 1 Within Fire Limits? No Dist. No. _____
 Owner's or Lessee's name and address Cargo Bay Light & Water Co., 130 Exchange St Telephone 7 895
 Contractor's name and address C. A. C. Co. Telephone _____
 Architect's name and address _____
 Proposed use of building 1 car garage No. families _____
 Other buildings on same lot sept. house station, abandoned

Description of Present Building to be Altered

Material _____ No. stories _____ Heat _____ Style of roof _____ Roofing _____
 Last use _____ No. families _____

General Description of New Work

To erect one car frame garage

RECEIVED PERMIT ISSUED
APR 16 1928

Details of New Work

Size, front 12' depth 18' No. stories 1 Height average grade to top of plate 13'
 To be erected on solid or filled land? solid earth or rock? earth
 Material of foundation concrete Thickness, top _____ bottom _____
 Material of underpinning _____ Height _____ Thickness _____
 Kind of roof pitch Roof covering asphalt Virginia Cream C. Ure. Lab.
 No. of chimneys no Material of chimneys _____ of lining _____
 Kind of heat no Type of fuel _____ Distance, heater to chimney _____
 If oil burner, name and model _____
 Capacity and location of oil tanks _____
 Is gas fitting involved? no Size of service _____
 Corner posts no Girt or ledger board? _____ Size _____
 Material columns under girders _____ Size _____ Max. on centers _____
 Studs (outside walls and carrying partition) 2x4-16" O.C. Girders 6x8 or larger Bridging in every floor and flat roof span over 8 feet. Sill and corner _____ all one piece in cross section.
 Joists and rafters: 1st floor 2x4, 2nd _____, 3rd _____, roof 2x4
 On centers: 1st floor _____, 2nd _____, 3rd _____, roof 2x4
 Maximum span: 1st floor _____, 2nd _____, 3rd _____, roof _____
 If one story building with masonry walls, thickness of walls? _____ height? _____

If a Garage

No. cars now accommodated on same lot none, to be accommodated 1
 Total number commercial cars to be accommodated none
 Will automobile repairing be done other than minor repairs to cars habitually stored in the proposed building? no

Miscellaneous

Will above work require removal or disturbing of any shade tree on a public street? no
 Plans filed as part of this application? yes No. sheets 1
 Estimated cost \$ 500. Fee \$ 75

Will there be in charge of the above work a person competent to see that the State and City requirements pertaining thereto are observed? yes
 Signature of owner James W. Colburn
 Cargo Bay Light & Water Co.

INSPECTION COPY APPROVED
 Signature of Inspector William D. [unclear]
 CITY OF PORTLAND, ME.

4941

Ward 1 Permit No. J9/536

Location Brackett Ave., Peaks

Owner Cisco Bay H + Water Co

Date of permit 4/15/29

Notif. closing-in _____

Insp., closing-in _____

Final Notif. _____

Final Inspn. _____

Cert. of Occupancy issued _____

NOTES

87
II
7

10/16/29 Garage installed
C. J. S.

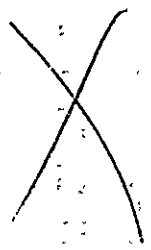

10/16/29 Garage installed

3214



City of Portland.

Peaks Island Apr 17th 1901.

To the Inspector of Buildings of the City of Portland:

The undersigned respectfully makes application for a permit to erect ~~enlarge~~ a building on _____ street, at number _____ to be *one* stories high *28* feet long, *26* feet wide; also an addition to be *one* stories high, *5* feet long, *5* feet wide, and to be used as a *Residence*.

The material to be used in the erection enlargement of said building is to be as follows:

Exterior walls to be made of *cedar shingles + sprouce*

Roof to be made of _____

Gutters to be made of _____

Cornices to be made of *wood*

Bay Windows to be made of _____

Dormer Windows to be made of _____

The builder is *J. A. Wiley* Address *Peaks Island*

The architect is _____ Address *Peaks Island*

The owner is *Peaks Island Corporation* Address *Peaks Island*

(Applicant to sign here) *J. A. Wiley*

OFFICE OF
INSPECTOR OF BUILDINGS,
FOR THE
CITY OF PORTLAND.

The above petition was granted the _____ day of _____ 190

APRIL, '11

Peaks Island.

Beaumont A.C.

Peaks
Camp

87-H-13125

87-D-7

(with
stamps)

87-H-26450
87-D-7585

4/17/11