

CENTRAL AVENUE PEAKS ISLAND
87-GG-17

CONSTRUCTED WITH 4x6 FRAMING
2x6 DECK
4x6 POST ON SOAP TUBES
2x4 RAILING

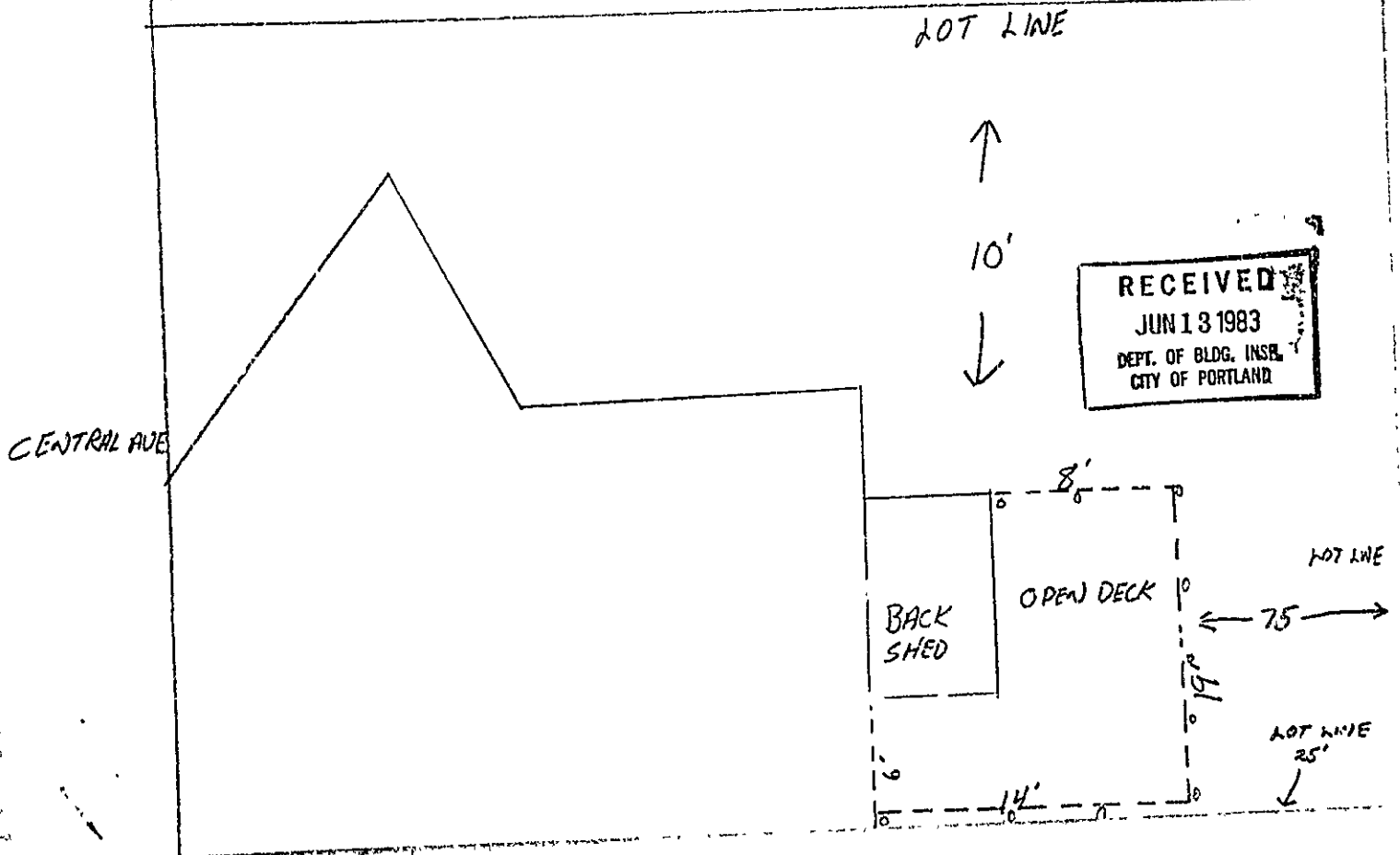

RECEIVED
JUN 13 1983
DEPT. OF BLDG. INSB.
CITY OF PORTLAND

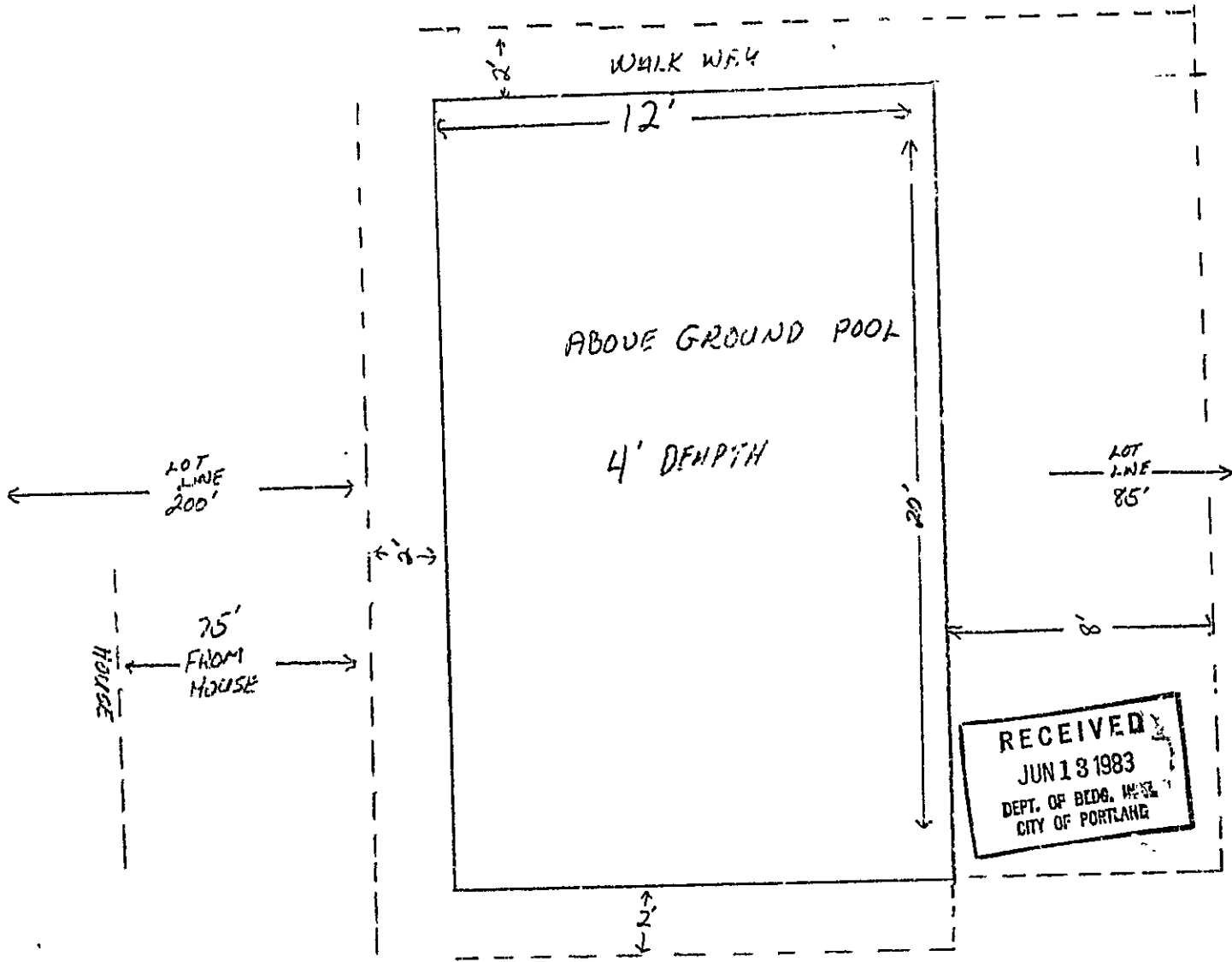

APPLICATION FOR PERMIT

PERMIT ISSUED

B.O.C.A. USE GROUP 00575

B.O.C.A. TYPE OF CONSTRUCTION

ZONING LOCATION R-3 PORTLAND, MAINE June 13, 1983

JUN 14 1983

CITY OF PORTLAND

To the CHIEF OF BUILDING & INSPECTION SERVICES, PORTLAND, MAINE

The undersigned hereby applies for a permit to erect, alter, repair, demolish, move or install the following building, structure, equipment or change use in accordance with the Laws of the State of Maine, the Portland B.O.C.A. Building Code and Zoning Ordinance of the City of Portland with plans and specifications, if any, submitted herewith and the following specifications:

- LOCATION ... 87-66-15 & 17 Central Avenue, Peaks Island ... Fire District #1 [], #2 []
1. Owner's name and address Donald Smith, the same ... Telephone .. 766-2241
2. Lessee's name and address ... Telephone ..
3. Contractor's name and address Owner ... Telephone ..

Proposed use of building above ground pool with deck and deck on existing dwelling No. of sheets ...
Last use ... No families ...
Material ... No. stories ... Heat ... Style of roof ... Roofing ...
Other buildings on same lot ...
Estimated contractual cost \$ 1,800

FIELD INSPECTOR—Mr. @ 775-5451
Appeal Fees \$
Base Fee \$ 20.00
Late Fee
TOTAL \$ 20.00

To construct 14'6" x 19'8" open deck on dwelling also to install above ground swimming pool, 12' x 20' as per plans. 2 sheets of plans. work has been completed and inspected.

Stamp of Special Conditions

NOTE TO APPLICANT: Separate permits are required by the installers and subcontractors of heating, plumbing, electrical and mechanicals.

DETAILS OF NEW WORK

- Is any plumbing involved in this work? YES NO
Is any electrical work involved in this work? YES NO
Is connection to be made to public sewer? If not, what is proposed for sewage?
Has septic tank notice been sent? Form notice sent?
Height average grade to top of plate ... Height average grade to highest point of roof ...
Size, front ... depth ... No. stories ... solid or filled land? ... earth or r...
Material of foundation ... thickness top ... bottom ... cellar ...
Kind of roof ... Rise per foot ... Roof covering ...
No. of chimneys ... Material of chimneys ... of lining ... Kind of heat ... fuel ...
Framing Lumber—Kind ... Dressed or full size? ... Corner posts ... Sills ...
Size Girder ... Columns under girders ... Size ... Max. on centers ...
Studs (outside walls and carrying partitions) 2x4-16" O. C. Bridging in every floor and flat roof spar over 8 feet.
Joists and rafters: 1st floor ... 2nd ... 3rd ... roof ...
On centers: 1st floor ... 2nd ... 3rd ... roof ...
Maximum span: 1st floor ... 2nd ... 3rd ... roof ...
If one story building with masonry walls, thickness of walls? height?

IF A GARAGE

- No cars now accommodated on same lot ... to be accommodated ... number commercial cars to be accommodated ...
Will automobile repairing be done other than minor repairs to cars habitually stored in the proposed building?

APPROVALS BY: DATE
BUILDING INSPECTION—PLAN EXAMINER
ZONING: D.R. M... 6/13/83
BUILDING CODE:
Fire Dept.:
Health Dept.:
Others:

MISCELLANEOUS
Will work require disturbing of any tree on a public street? NO
Will there be in charge of the above work a person competent to see that the State and City requirements pertaining thereto are observed? yes ...

Signature of Applicant [Signature] Phone # same
Type Name of above Donald Smith

Other [] 2 [] 3 [] 4 []
and Address

FIELD INSPECTOR'S COPY

APPLICANT'S COPY

OFFICE FILE COPY

[] MR. Addato

Permit No.

83/575

Location

87 616-15 417 Central Ave Okla-Del.

Owner

Vonald Smith

Date of permit

6-13-83

Approved

6-14-83

Dwelling

1 - 1/2 Story

Garage

Alterations

NOTES

6-20-83 - Deck completed
when payment received
Mark C. M.



CITY OF PORTLAND

JOSEPH E. GRAY, JR.
DIRECTOR OF PLANNING
AND URBAN DEVELOPMENT

Date: June 10, 1983

Donald E. Smith
87-G 17 Central Avenue
Pea, Island, Maine 04108

Subject: Constructed deck, pool and catwalk

Dear Mr. Smith:

A recent inspection at the above named address of which you are listed the present owner, showed that alterations have been completed, or are in the process of being completed, that require building permits from the City of Portland as defined in the 1981 BOCA Building Code and/or Portland Municipal Code.

It is therefore necessary for you to come to City Hall, 389 Congress Street, Room 317, to file an application for these required permits. This must be done within five (5) days of receipt of this letter. Failure to abide by this request could result in court action and a fine of up to \$50 to \$1,000 per day for each day this violation exists.

I look forward to your cooperation.

Yours truly,

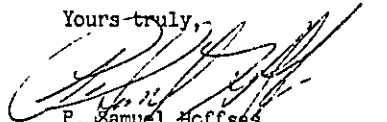

P. Samuel Mcffses
Chief of Inspection Services

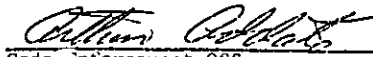

Code Enforcement Officer -

APPLICATION FOR PERMIT

PERMIT ISSUED

JUN 14 1983

③

B.O.C.A. USE GROUP

B.O.C.A. TYPE OF CONSTRUCTION

00575

ZONING LOCATION PORTLAND, MAINE June 13, 1983

CITY OF PORTLAND

To the CHIEF OF BUILDING & INSPECTION SERVICES, PORTLAND, MAINE

The undersigned hereby applies for a permit to erect, alter, repair, demolish, move or install the following building, structure, equipment or change use in accordance with the Laws of the State of Maine, the Portland P. O. C. A. Building Code and Zoning Ordinance of the City of Portland with plans and specifications, if any, submitted herewith and the following specification:

LOCATION 87-68-15 & 17 Central Avenue, Peaks Island Fire District #1 , #2

1. Owner's name and address Donald Smith & same Telephone .. 766-2241

2. Lessee's name and address Telephone

3. Contractor's name and address Owner Telephone

Proposed use of building above ground pool with deck and deck on a deck dwelling No. of sheets 1

Last use No. families

Material No. stories Heat Style of roof Roofing

Other buildings on same lot

Estimated contractual cost \$ 1,800 Appeal Fees \$

FIELD INSPECTOR—Mr. @ 775-5451 Base Fee 20.00

..... Late Fee

TOTAL \$ 20.00

To construct 14'6" x 19'8" open deck on dwelling also to install above ground swimming pool, 12' x 20' as per plans, 2 sheets of plans. work has been completed and inspected.

Stamp of Special Conditions

NOTE TO APPLICANT: Separate permits are required by the inspectors and subcontractors of heating, plumbing, electrical and mechanicals.

DETAILS OF NEW WORK

Is any plumbing involved in this work? ~~yes~~ no Is any electrical work involved in this work? ~~yes~~ no

Is connection to be made to public sewer? If not, what is proposed for sewage?

Has septic tank notice been sent? Form notice sent?

Height average grade to top of plate Height average grade to highest point of roof

Size, front depth No. stories solid or filled land? earth or rock?

Material of foundation Thickness, top bottom cell

Kind of roof Rise per foot Roof covering

No. of chimneys Material of chimneys of lining Kind of heat fuel

Framing Lumber—Kind Dressed or full size? Corner posts Sills

Size Girder Columns under girders Size Max on centers

Studs (outside walls and carrying partitions) 2x4-16" O. C. Bridging in every floor and flat roof span over 8 feet.

Joists and rafters: 1st floor 2nd 3rd roof

On centers: 1st floor 2nd 3rd roof

Maximum span: 1st floor 2nd 3rd roof

If one story building with masonry walls, thickness of walls? height?

IF A GARAGE

No. cars now accommodated on same lot to be accommodated number commercial cars to be accommodated

Will automobile repairing be done other than minor repairs to cars habitually stored in the proposed building?

APPROVALS BY: DATE MISCELLANEOUS no

BUILDING INSPECTION—PLAN EXAMINER Will work require disturbing of any tree on a public street?

ZONING:

BUILDING CODE: Will there be in charge of the above work a person competent

Fire Dept. to see that the State and City requirements pertaining thereto

Health Dept. are observed? yes

Others:

Signature of Applicant Donald Smith Phone # 828

Type Name of above 1 2 3 4

Other

and Address

②

FIELD INSPECTOR'S COPY

APPLICANT'S COPY

OFFICE FILE COPY



CITY OF PORTLAND

JOSEPH E. GRAY, JR.
DIRECTOR OF PLANNING
AND URBAN DEVELOPMENT

Date: June 10, 1983

Donald E Smith
87-GG-17 Central Avenue
Peaks Island, Maine 04108

OK
BY <i>Robb</i>
DATE 6-13-83

Subject: Constructed deck, pool and catwalk

Dear Mr. Smith:

A recent inspection at the above named address of which you are listed the present owner, showed that alterations have been completed, or are in the process of being completed, that require building permits from the City of Portland as defined in the 1981 BOCA Building Code and/or Portland Municipal Code.

It is therefore necessary for you to come to City Hall, 389 Congress Street, Room 317, to file an application for these required permits. This must be done within five (5) days of receipt of this letter. Failure to abide by this request could result in court action and a fine of up to \$50 to \$1,000 per day for each day this violation exists.

I look forward to your cooperation.

Yours-truly,

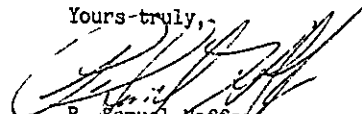
P. Samuel Hoffses
Chief of Inspection Services

Code Enforcement Officer -



APPLICATION FOR PERMIT
DEPARTMENT OF BUILDING INSPECTIONS SERVICES
ELECTRICAL INSTALLATIONS

Date Oct. 8, 1980, 19 5
 Receipt and Permit number A51774

To the CHIEF ELECTRICAL INSPECTOR, Portland, Maine:

The undersigned hereby applies for a permit to make electrical installations in accordance with the laws of Maine, the Portland Electrical Ordinance, the National Electrical Code and the following specifications:

LOCATION OF WORK: 87-GG-17 Central Ave.
 OWNER'S NAME: Donald Smith ADDRESS: _____

	FEES
OUTLETS:	
Receptacles <u>6</u> Switches <u>2</u> Plugmold _____ ft. TOTAL <u>30</u>	3.00
FIXTURES: (number of)	
Incandescent _____ Fluorescent _____ (not strip) TOTAL _____	
Strip Fluorescent _____ ft.	
SERVICES:	
Overhead _____ Underground _____ Temporary _____ TOTAL amperes <u>200</u>	3.00
METERS: (number of) <u>1</u>50
MOTORS: (number of)	
Fractional _____	
1 HP or over _____	
RESIDENTIAL HEATING:	
Oil or Gas (number of units) _____	
Electric (number of rooms) <u>1</u>	1.00
COMMERCIAL OR INDUSTRIAL HEATING:	
Oil or Gas (by a main boiler) _____	
Oil or Gas (by separate units) _____	
Electric Under 20 kws _____ Over 20 kws _____	
APPLIANCES: (number of)	
Ranges _____ Water Heaters _____	
Cook Tops _____ Disposals _____	
Wall Ovens _____ Dishwashers _____	
Dryers _____ Compactors _____	
Fans _____ Others (denote) _____	
TOTAL _____	
MISCELLANEOUS: (number of)	
Branch Panels _____	
Transformers _____	
Air Conditioners Central Unit _____	
Separate Units (windows) _____	
Signs 20 sq. ft. and under _____	
Over 20 sq. ft. _____	
Swimming Pools Above Ground _____	
In Ground _____	
Fire/Burglar Alarms Residential _____	
Commercial _____	
Heavy Duty Outlets, 220 Volt (such as welders) 30 amps and under _____	
over 30 amps _____	
Circus, Fairs, etc. _____	
Alterations to wires _____	
Repairs after fire _____	
Emergency Lights, battery _____	
Emergency Generators _____	
INSTALLATION FEE DUE:	7.50
FOR ADDITIONAL WORK NOT ON ORIGINAL PERMIT DOUBLE FEE DUE:	
FOR REMOVAL OF A "STOP ORDER" (304-16.b)	
TOTAL AMOUNT DUE:	7.50

INSPECTION:

Will be read on _____, 19__; or Will Call x
 CONTRACTOR'S NAME: Kenneth Clarke
 ADDRESS: 15 Adams St. Peaks Is.
 TEL.: 766-5005
 MASTER LICENSE NO.: 4471 SIGNATURE OF CONTRACTOR: Kenneth Clarke
 LIMITED LICENSE NO.: _____

INSPECTOR'S COPY — WHITE
 OFFICE COPY — CANARY
 CONTRACTOR'S COPY — GREEN

**CERTIFICATE OF APPROVAL
FOR INTERNAL PLUMBING**

THE TOWN/CITY OF Portland

TOWN/CITY CODE 05170 LPI NUMBER 00123 DATE ISSUED 723810
Month Day Year

44463 IC

Certificate of App Number

Installer's Name MOESLEFIV F I M I 011

- 1 Owner
- 2 Licensed Master Plumber
- 3 Licensed Oil Burnerman
- 4 Employee of Public Utility
- 5 Manufactured Housing Dealer
- 6 Manufactured Housing Mechanic
- 7 Limited License

Owner Donald P. Smith Installer Code 2

Address 87-66-1 Central Co. Dallas Delano
St./Lot Number Street, Road Name Subdivision
 (Location where plumbing was done and inspected)

THE INTERNAL PLUMBING INSTALLED PURSUANT TO THE ABOVE CERTIFICATE OF APPROVAL NUMBER HAS BEEN TESTED IN MY PRESENCE, FOUND TO BE FREE FROM LEAKS, AND WAS INSTALLED IN COMPLIANCE WITH THE MUNICIPAL AND STATE PLUMBING RULES.

Carroll R. Gordon

TOWN'S COPY

Signature of LPI _____
 Date Inspected JUL 24 1980

INTERNAL PLUMBING PERMIT FOR THE TOWN/CITY OF

Portland

Town/City Code 05170 LPI Number 00123 Date Issued 723810 INSTALLER'S License No. 20071
Month Day Year

44463 IP

PERMIT NUMBER

Address of Where Plumbing is Done 87-66-1 CENTRAL CO. DALLAS DELANO Installer Code 2
St./Lot Number Street/Road Name Subdivision

Name of Owner SMITH Last Name F I M I 011 Mailing Address Delano Zip Code _____

Type of Construction	1 New	3 Addition	5 Replacement of Hot Water Heater	7 Hook-up of Modular Home	Other (Specify): <input checked="" type="checkbox"/>
	2 Remodeling	4 Remodeling & Addition	6 Hook-up of Mobile Home		
Plumbing To Serve	1 Single (Res)	3 Mobile Home	5 Commercial	7 Other (Specify)	<input checked="" type="checkbox"/>
	2 Multi-Fam(Res)	4 Modular Home	6 School		
Number of Fixtures or Hook-Ups	Sink(s) <input type="checkbox"/>	Toilet(s) <input checked="" type="checkbox"/>	Bathtub(s) <input checked="" type="checkbox"/>	Lavatorie(s) <input checked="" type="checkbox"/>	Shower(s) <input type="checkbox"/>
	Urinal(s) <input type="checkbox"/>	Hot Water Heater(s) <input type="checkbox"/>	Floor Drain(s) <input type="checkbox"/>	Hook Ups(s) <input type="checkbox"/>	

TOWN'S COPY

IMPORTANT! Note the following conditions:
 1 This Permit is non-transferable to another person or party.
 2 If construction has not started within 6 months from the Date of Issue this Permit becomes invalid.

Fixture Fee 9.00
 Hook Up Fee 0.00
 Total Fee 9.00
 If Double Fee Check Box

Dept of Human Services
 Div of Health Engineering

Signature of LPI _____

87-GG-15+17 CENTRAL AVE
PEAKS ISLAND

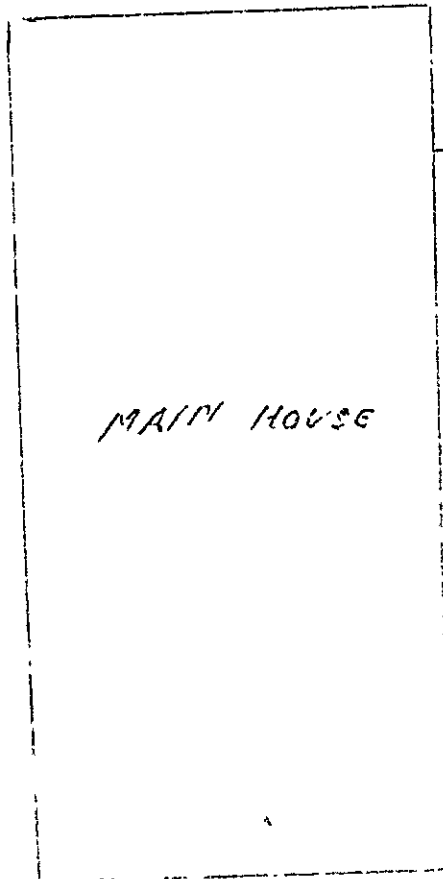

— 24' —
PROPOSED FOUNDATION
EXISTING ELL

MAIN HOUSE

RECEIVED
JUN 26 1980
DEPT. OF BLDG. INSP.
CITY OF PORTLAND



APPLICATION FOR PERMIT

PERMIT ISSUED

B.O.C.A. USE GROUP 00 461

B.O.C.A. TYPE OF CONSTRUCTION

JUN 27 1960

ZONING LOCATION _____ PORTLAND, MAINE, June 26, 1960 CITY of PORTLAND

To the DIRECTOR OF BUILDING & INSPECTION SERVICES, PORTLAND, MAINE

The undersigned hereby applies for a permit to erect, alter, repair, demolish, move or install the following building, structure, equipment or change use in accordance with the Laws of the State of Maine, the Portland B.O.C.A. Building Code and Zoning Ordinance of the City of Portland with plans and specifications, if any, submitted herewith and the following specifications:

LOCATION 87-GC-15 & 17 Central Ave., Peaks Is. Fire District #1 , #2

1. Owner's name and address Donald Smith Telephone

2. Lessee's name and address Telephone

3. Contractor's name and address Davis Bros. Box 4, Peaks Is. Telephone 766-2014

4. Architect Specifications Plans No. of sheets

Proposed use of building dwelling No. families

Last use No. families

Material No. stories Heat Style of roof Roofing

Other buildings on same lot

Estimated contractual cost \$ 3,000. Fee \$ 14.50

FIELD INSPECTOR—Mr. GENERAL DESCRIPTION

This application is for: @ 775-5451 To construct 12" block foundation under

Dwelling Ext. 234 ell of existing dwelling

Garage

Masonry Bldg. Stamp of Special Conditions

Metal Bldg.

Alterations

Demolitions

Change of Use

Other

NOTE TO APPLICANT: Separate permits are required by the installers and subcontractors of heating, plumbing, electrical and mechanicals.

PERMIT IS TO BE ISSUED TO 1 2 3 4

Other:

DETAILS OF NEW WORK

Is any plumbing involved in this work? Is any electrical work involved in this work?

Is connection to be made to public sewer? If not, what is proposed for sewage?

Has septic tank notice been sent? Form notice sent?

Height average grade to top of plate Height average grade to highest point of roof

Size, front depth No. stories solid or filled land? earth or rock?

Material of foundation Thickness, top bottom cellar

Kind of roof Rise per foot Roof covering

No. of chimneys Material of chimneys of lining Kind of heat fuel

Framing Lumber—Kind Dressed or full size? Corner posts Sills

Size Girder Columns under girders Size Max. on centers

Studs (outside walls and carrying partitions) 2x4-16" O. C. Bringing in every floor and flat roof span over 8 feet.

Joists and rafters: 1st floor, 2nd, 3rd, roof

On centers: 1st floor, 2nd, 3rd, roof

Maximum span: 1st floor, 2nd, 3rd, roof

If one story building with masonry walls, thickness of walls? height?

IF A GARAGE

No. cars now accommodated on same lot, to be accommodated ... number commercial cars to be accommodated ...

Will automobile repairing be done other than minor repairs to cars habitually stored in the proposed building?

APPROVALS BY: DATE

BUILDING INSPECTION—PLAN EXAMINER

ZONING:

BUILDING CODE:

Fire Dept.:

Health Dept.:

Others:

MISCELLANEOUS

Will work require disturbing of any tree on a public street? ..

Will there be in charge of the above work a person competent to see that the State and City requirements pertaining thereto are observed? YES

Signature of Applicant Frank L. Davis Phone # 766-2014

Type Name of above Frank Davis 1 2 3 4

FIELD INSPECTOR'S COPY

Other and Address

NOTES

1/16/81 - all work done in accord. with
plan and permit. C.R.

Permit No. 80/461
Location 87-66-15-17 Central Ave. Phoenix
Owner Donald Smith
Date of permit 6-26-80
Approved 6-27-80

Large area of the page is crossed out with a large 'X' drawn over the horizontal lines.

CITY OF PORTLAND, MAINE
Application for Permit to Install Wires

Permit No. 5-5547
 Issued 12/6/71
 Portland, Maine 12/6, 19 71

To the City Electrician, Portland, Maine

The undersigned hereby applies for a permit to install wires for the purpose of conducting electric current, in accordance with the laws of Maine, the Electrical Ordinance of the City of Portland, and the following specifications:

(This form must be completely filled out — Minimum Fee, \$1.00)

Owner's Name and Address ROBERT MCTIGUE, PEAK ISLAND
 Contractor's Name and Address BOY VIEW ELECTRIC CO, PEAK ISLAND
 Location CENTRAL AVE, PEAK IS Use of Building RESIDENCE

87-66-17

Number of Families _____ Apartments _____ Stores _____ Number of Stories _____
 Description of Wiring New Work _____ Additions _____ Alterations UPGRADE
INSTALL 100 AMP SINGLE PHASE SERVICE

Pipe _____ Cable _____ Metal Molding _____ BX Cable _____ Plug Molding (No. of feet) _____
 No. Light Outlets _____ Plugs _____ Light Circuits _____ Plug Circuits _____
 FIXTURES: No. _____ Fluor. or Strip Lighting (No. feet) _____
 SERVICE: Pipe _____ Cable _____ Underground _____ No. of Wires _____ Size _____
 METERS: Relocated _____ Added _____ Total No. Meters _____
 MOTORS: Number _____ Phase _____ H P _____ Amps _____ Volts _____ Starter _____
 HEATING UNITS: Domestic (Oil) _____ No Motor _____ Phase _____ H.P. _____
 Commercial (Oil) _____ No Motors _____ Phase _____ H.P. _____
 Electric Heat (No. of Rooms) _____

APPLIANCES: No Ranges _____ Watts _____ Brand _____ eels (Type and No) _____
 Elec. Heaters _____ Watts _____
 Miscellaneous _____ Watts _____ Extra Cabinets or Panels _____

Transformers _____ Air Conditioners (No. Units) _____ Signs (No. Units) _____
 Will commence _____ 19 _____ Ready to cover in _____ 19 _____ Inspection _____ 19 _____
 Amount of Fee \$ 2.00

Signed Richard G. Benoit

DO NOT WRITE BELOW THIS LINE

SERVICE	<input checked="" type="checkbox"/>	METER		GROUND	<input checked="" type="checkbox"/>
VISITS: 1	2	3	4	5	6
7	8	9	10	11	12

REMARKS:

INSPECTED BY [Signature]
 (OVER)

LOCATION *Central. Av.
Peaks Island*
INSPECTION DATE *12/28/71*
WORK COMPLETED *12/28/71*
TOTAL NO. INSPECTIONS
REMARKS

FEEES FOR WIRING PERMITS EFFECTIVE JULY 31, 1963

WIRING	
1 to 30 Outlets	2.00
31 to 60 Outlets	.00
Over 60 Outlets, each Outlet	.05
(Each twelve feet or fraction thereof of fluorescent lighting or any type of plug molding will be classed as one outlet).	
SERVICES	
Single Phase	2.00
Three Phase	4.00
MOTORS	
Not exceeding 50 H.P.	3.00
Over 50 H.P.	4.00
HEATING UNITS	
Domestic (Oil)	2.00
Commercial (Oil)	4.00
Electric Heat (Each Room)	.75
APPLIANCES	
Ranges, Cooking Tops, Ovens, Water Heaters, Disposals, Built-in Dishwashers, Dryers, and any permanent built-in appliance — each unit	1.50
MISCELLANEOUS	
Temporary Service, Single Phase	1.00
Temporary Service, Three Phase	2.00
Circuses, Carnivals, Fairs, etc.	10.00
Meters, relocate	1.00
istribution Cabinet or Panel, per unit	1.00
Transformers, per unit	2.00
	2.00



FILL IN AND SIGN WITH INK
APPLICATION FOR PERMIT FOR HEATING, COOKING OR POWER EQUIPMENT

Portland, Maine, October 21, 1965

PERMIT ISSUED

OCT 21 1965

CITY of PORTLAND

To the INSPECTOR OF BUILDINGS, PORTLAND, ME.

The undersigned hereby applies for a permit to install the following heating, cooking or power equipment in accordance with the Laws of Maine, the Building Code of the City of Portland, and the following specifications:

87-66-17
Location . . . Central Ave., Peaks Island Use of Building . . . Dwelling . . . No. Stories . . . New Building Existing . . .
Name and address of owner of appliance . . . Robert McTigue, Central Ave., Peaks Island
Installer's name and address . . . Roland Hoar, Island Ave., Peaks Island Telephone . . .

General Description of Work

To install oil-fired forced hot water heating system in place of stove heat

IF HEATER, OR POWER BOILER

Location of appliance . . . basement . . . Any burnable material in floor surface or beneath? . . . no
If so, how protected? . . . Kind of fuel? . . . oil
Minimum distance to burnable material, from top of appliance or casing top of furnace . . . 2' . . .
From top of smoke pipe . . . 18" . . . From front of appliance . . . 4' . . . From sides or back of appliance . . . 3' . . .
Size of chimney flue . . . 8x8 . . . Other connections to same flue . . . none
If gas fired, how vented? . . . Rated maximum demand per hour . . .
Will sufficient fresh air be supplied to the appliance to insure proper and safe combustion? . . . yes

IF OIL BURNER

Name and type of burner . . . Crane . . . Labelled by underwriters' laboratories? . . . yes
Will operator be always in attendance? . . . Does oil supply line feed from top or bottom of tank? . . . bottom
Type of floor beneath burner . . . concrete . . . Size of vent pipe . . . 1 1/2"
Location of oil storage . . . basement . . . Number and capacity of tanks . . . 1-275 gal.
Low water shut off . . . Make . . . No. . .
Will all tanks be more than five feet from any flame? . . . yes . . . How many tanks enclosed? . . .
Total capacity of any existing storage tanks for furnace burners . . . none

IF COOKING APPLIANCE

Location of appliance . . . Any burnable material in floor surface or beneath? . . .
If so, how protected? . . . Height of Legs, if any . . .
Skirting at bottom of appliance? . . . Distance to combustible material from top of appliance? . . .
From front of appliance . . . From sides and back . . . From top of smokepipe . . .
Size of chimney flue . . . Other connections to same flue . . .
Is hood to be provided? . . . If so, how vented? . . . Forced or gravity? . . .
If gas fired, how vented? . . . Rated maximum demand per hour . . .

MISCELLANEOUS EQUIPMENT OR SPECIAL INFORMATION

.....
.....
.....
.....

Amount of fee enclosed? . 2.00 (\$2.00 for one heater, etc., \$1.00 additional for each additional heater, etc., in same building at same time.)

APPROVED:
O.K. E.S.S. 10/21/65

Will there be in charge of the above work a person competent to see that the State and City requirements pertaining thereto are observed? . . . yes . . .

Signature of Installer . . . Roland L. Hoar . . .

P.H.

Permit No

65/1156

Location

Central Ave Rock Hill

Owner

Robert McInnis

Date of permit

10/21/65

Approved

11/1/65 - M. Goodman

NOTES

1	Fill Pipe	1 1/2" Dia	
2	Vent Pipe	1 1/4" Dia	
3	Kind of Heat	F.P.	
4	Burner Rigidity & Supports	OK	
5	Name & Label	M.H. on Gas	Control
6	Stack Control	✓	
7	High Air	✓	
8	Remote Control		
9	Piping Section	✓	
10	Valves	✓	
11	Capacity of Tank	1 - 275 gal	
12	Tank Rigidity & Supports	✓	
13	Tank Distance	7'	
14	Oil Gauge	✓	
15	Instruction Card		
16	Low Water Shut-off	M.H. Control	



APPLICATION FOR AMENDMENT TO PERMIT

Amendment No. #1

Portland, Maine, October 21, 1965

PERMIT ISSUED

OCT 21 1965

CITY of PORTLAND

To the INSPECTOR OF BUILDINGS, PORTLAND, MAINE

The undersigned hereby applies for amendment to Permit No. 65/1016 pertaining to the building or structure comprised in the original application in accordance with the Laws of the State of Maine, the Building Code and Zoning Ordinance of the City of Portland, plans and specifications, if any, submitted herewith, and the following specifications:

Location ... Central Ave., Peaks Island ... Within Fire Limits? ... Dist. No. ...
Owner's name and address ... Robert McTigue, Central Ave., Peaks Island ... Telephone ...
Lessee's name and address ... Telephone ...
Contractor's name and address ... Roland Hoar, Peaks Island ... Telephone ...
Architect ... Plans filed no. ... No. of sheets ...
Proposed use of building ... Dwelling ... No. families ...
Last use ... No. families ...
Increased cost of work 150. ... Additional fee 1.00

Description of Proposed Work

To close up three window, first floor, and cut in two new windows (regular size) 2'-2'6" x 5'
To partition off 3'x8' powder room, first floor. 2x4 studs, 16" O.C.
sheetrock - new window as above - 1 1/2, 3'

Details of New Work Hoar

Is any plumbing involved in this work? ... Is any electrical work involved in this work? ...
Height average grade to top of plate ... Height average grade to highest point of roof ...
Size, front ... depth ... No. stories ... solid or filled land? ... earth or rock? ...
Material of foundation ... Thickness, top ... bottom ... cellar ...
Material of underpinning ... Height ... Thickness ...
Kind of roof ... Rise per foot ... Roof covering ...
No. of chimneys ... Material of chimneys ... of lining ...
Framing lumber—Kind ... Dressed or full size? ...
Corner posts ... Sills ... Girt or ledger board? ... Size ...
Girders ... Size ... Max. on centers ...
Studs (outside walls and carrying partitions) 2x4-16" O. C. Bridging in every floor and flat roof span over 8 feet.
Joists and rafters: 1st floor ... 2nd ... 3rd ... roof ...
On centers: 1st floor ... 2nd ... 3rd ... roof ...
Maximum span: 1st floor ... 2nd ... 3rd ... roof ...

Approved:

J. E. M.
INSPECTION COPY

Signature of Owner BY: Robert McTigue

Approved: Inspector of Buildings

R3 RESIDENCE ZONE



APPLICATION FOR PERMIT

Class of Building or Type of Structure Third Class

Portland, Maine, Sept. 24, 1965

PERMIT ISSUED

01016
SEP 24 1965

CITY of PORTLAND

To the INSPECTOR OF BUILDINGS, PORTLAND, MAINE

The undersigned hereby applies for a permit to erect alter repair demolish install the following building structure equipment in accordance with the Laws of the State of Maine, the Building Code and Zoning Ordinance of the City of Portland, plans and specifications, if any, submitted herewith and the following specifications:

Location Central Ave., Peaks Island 87-GG-17 Within Fire Limits? _____ Dist. No. _____

Owner's name and address Robert McTigue, Central Ave., Peaks Island Telephone _____

Lessee's name and address _____ Telephone _____

Contractor's name and address Roland Hoar, Island Ave. Peaks Island Telephone 766-2861

Architect _____ Specifications _____ Plans _____ No. of sheets _____

Proposed use of building 1 fam. dwelling No. families _____

Last use _____ No. families _____

Material frame No. stories 1 1/2 Heat _____ Style of roof _____ Roofing _____

Other buildings on same lot _____

Estimated cost \$ 3000. Fee \$ 7.00

General Description of New Work

To repair after fire to former condition without alterations.

No structural damage.

Date of fire: 9-21-65

Cause: undetermined

It is understood that this permit does not include installation of heating apparatus which is to be taken out separately by and in the name of the heating contractor. PERMIT TO BE ISSUED TO contractor

Details of New Work

Is any plumbing involved in this work? _____ Is any electrical work involved in this work? _____

Is connection to be made to public sewer? _____ If not, what is proposed for sewage? _____

Has septic tank notice been sent? _____ Form notice sent? _____

Height average grade to top of plate _____ Height average grade to highest point of roof _____

Size, front _____ depth _____ No. stories _____ solid or filled land? _____ earth or rock? _____

Material of foundation _____ Thickness, top _____ bottom _____ cellar _____

Kind of roof _____ Rise per foot _____ Roof covering _____

No. of chimneys _____ Material of chimneys _____ of lining _____ Kind of heat _____ fuel _____

Framing Lumber—Kind _____ Dressed or full size? _____ Corner posts _____ Sills _____

Size Girder _____ Columns under girders _____ Size _____ Max. on centers _____

Studs (outside walls and carrying partitions) 2x4-16" O. C. Bridging in every floor and flat roof span over 8 feet.

Joists and rafters: 1st floor _____, 2nd _____, 3rd _____, roof _____

On centers: 1st floor _____, 2nd _____, 3rd _____, roof _____

Maximum span: 1st floor _____, 2nd _____, 3rd _____, roof _____

If one story building with masonry walls, thickness of walls? _____ height? _____

If a Garage

No. cars now accommodated on same lot _____, to be accommodated _____ number commercial cars to be accommodated _____

Will automobile repairing be done other than minor repairs to cars habitually stored in the proposed building? _____

APPROVED:

R. E. M.

Miscellaneous

Will work require disturbing of any tree on a public street? _____

Will there be in charge of the above work a person competent to see that the State and City requirements pertaining thereto are observed? yes

Roland Hoar

Roland S. Hoar

CS 361

INSPECTION COPY

Signature of owner By:

NOTES

9/27/65 - MD map mod.
E.S.S.
11/1/65 - MM & ...
map work is done
E.S.S.

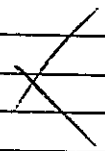

Permit No. 65/1016

Location Central Ave. Peabody, Pa.

Owner Robert M. Lewis

Date of permit 9/24/65

Notif. closing-in

Inspn. closing-in

Final Notif.

Final Inspn.

Cert. of Occupancy issued

Staking Out Notice

Form Check Notice

CITY OF PORTLAND, MAINE

Application for Permit to Install Wires

Permit No. 54227

Issued
Portland, Maine Sept. 24 ... , 1965

To the City Electrician, Portland, Maine:

The undersigned hereby applies for a permit to install wires for the purpose of conducting electric current, in accordance with the laws of Maine, the Electrical Ordinance of the City of Portland, and the following specifications:

87-111-1; (This form must be completely filled out) Minimum Fee, \$1.00

Owner's Name and Address Robert McJigue Tel.

Contractor's Name and Address Roland S. Horner Peaks Isl Tel. 766-2964

Location Central Ave Use of Building Dwelling

Number of Families 1 Apartments 0 Stores 0 Number of Stories 1 1/2

Description of Wiring: New Work Additions Alterations
Replacing wires + outlets after fire

Pipe Cable Metal Molding BX Cable Plug Molding (No. of feet)

No. Light Outlets 4 Plugs 6 Light Circuits Plug Circuits

FIXTURES: No. Light Switches Fluor. or Strip Lighting (No. feet)

SERVICE: Pipe Cable Underground No. of Wires Size

METERS: Relocated Added Total No. Meters

MOTORS: Number Phase H. P. aps Volts Starter

HEATING UNITS: Domestic (Oil) No. Motors Phase H.P.
Commercial (Oil) No. Motors Phase H.P.
Electric Heat (No. of Rooms)

APPLIANCES: No. Ranges Watts Brand Feeds (Size and No.)
Elec. Heaters Watts
Miscellaneous Watts Extra Cabinets or Panels

Transformers Air Conditioners (No. Units) Signs (No. Units)

Will commence Sept. 27 1965 Ready to cover in Oct. 15 1965 Inspection 19

Amount of Fee \$ 2.00

Signed Roland S. Horner

DO NOT WRITE BELOW THIS LINE

SERVICE	METER						GROUND	
VISITS: 1	2	3	4	5	6			
..... 7	8	9	10	11	12			
REMARKS:								

INSPECTED BY F. W. Hebert
Dana Butterfield (OVER)

Peaks Island.

LOCATION Central Av.

INSPECTION DATE 10/15/65

WORK COMPLETED 10/15/65

TOTAL NO. INSPECTIONS 1

REMARKS:

FEEs FOR WIRING PERMITS EFFECTIVE JULY 31, 1963

WIRING

1 to 30 Outlets	(including switches)	\$ 2.00
31 to 60 Outlets	(including switches)	3.00
Over 60 Outlets, each Outlet	(including switches)	.05
(Each twelve feet or fraction thereof of fluorescent lighting or any type of plug molding will be classed as one outlet).		

SERVICES

Single Phase		2.00
Three Phase		4.00

MOTORS

Not exceeding 59 H.P.		3.00
Over 50 H.P.		4.00

HEATING UNITS

Domestic (Oil)		2.00
Commercial (Oil)		4.00
Electric Heat (Each Room)		.75

APPLIANCES

Ranges, Cooking Tops, Ovens, Water Heaters, Disposals, Dishwashers, etc. — Each Unit		1.50
--	--	------

TEMPORARY WORK (limited to 6 months from date of permit)

Service, Single Phase		1.00
Service, Three Phase		2.00
Wiring, 1-50 Outlets		1.50
Wiring, each additional outlet over 50		.02
Circuses, Carnivals, Fairs, etc.		10.00

MISCELLANEOUS

Distribution Cabinet or Panel, per unit		1.50
---	--	------

2.00

March 28, 1928

Mr. T. G. Kenyon
Central Avenue
Peaks Island, Maine

Dear Sir:

A public hearing will be held before the Committee on Zoning and Building Ordinance Appeals in the Council Chamber, City Hall, Friday, March 30th at three o'clock in the afternoon upon your petition to the City Council for the establishment of a gasoline filling station at Central Avenue, Peaks Island.

Failure of an appellant to appear or send a representative for the purpose of supporting a petition will be deemed equivalent to withdrawal of petition and will be so reported to the City Council.

COMMITTEE ON ZONING AND BUILDING ORDINANCE
APPEALS.

WM/EF

March 28, 1928

To Whom It May Concern:

The Committee on Zoning and Building Ordinance Appeals will hold a public hearing in the Council Chamber, City Hall, Friday, March 30th at three o'clock in the afternoon upon the petition of T. C. Kenyon who seeks permission to establish a gasoline filling station at Central Avenue, Peaks Island.

All persons interested, either for granting or for denial of the above petition will be heard at the above time and place.

COMMITTEE ON ZONING AND BUILDING
ORDINANCE APPEALS.

March 29, 1928

Mr. S. S. Boyd
Committee on Zoning and Building Ordinance Appeals

Dear Sir:

The petition of T. C. Kenyon seeking to establish a gasoline filling station on the westerly side of Central Avenue on Peaks Island has been referred to your Committee by the City Council.

The permit for the establishment of this filling station was denied for the reason that the location is in an Apartment House Zone where this use is a non-conforming use.

The owner does not intend to erect any building but merely operate the station from existing buildings.

There is attached a plan and photograph illustrating the proposition.

Respectfully submitted,

Inspector of Buildings

VM/EP

To Forest City Ldg. ISLAND AVE.

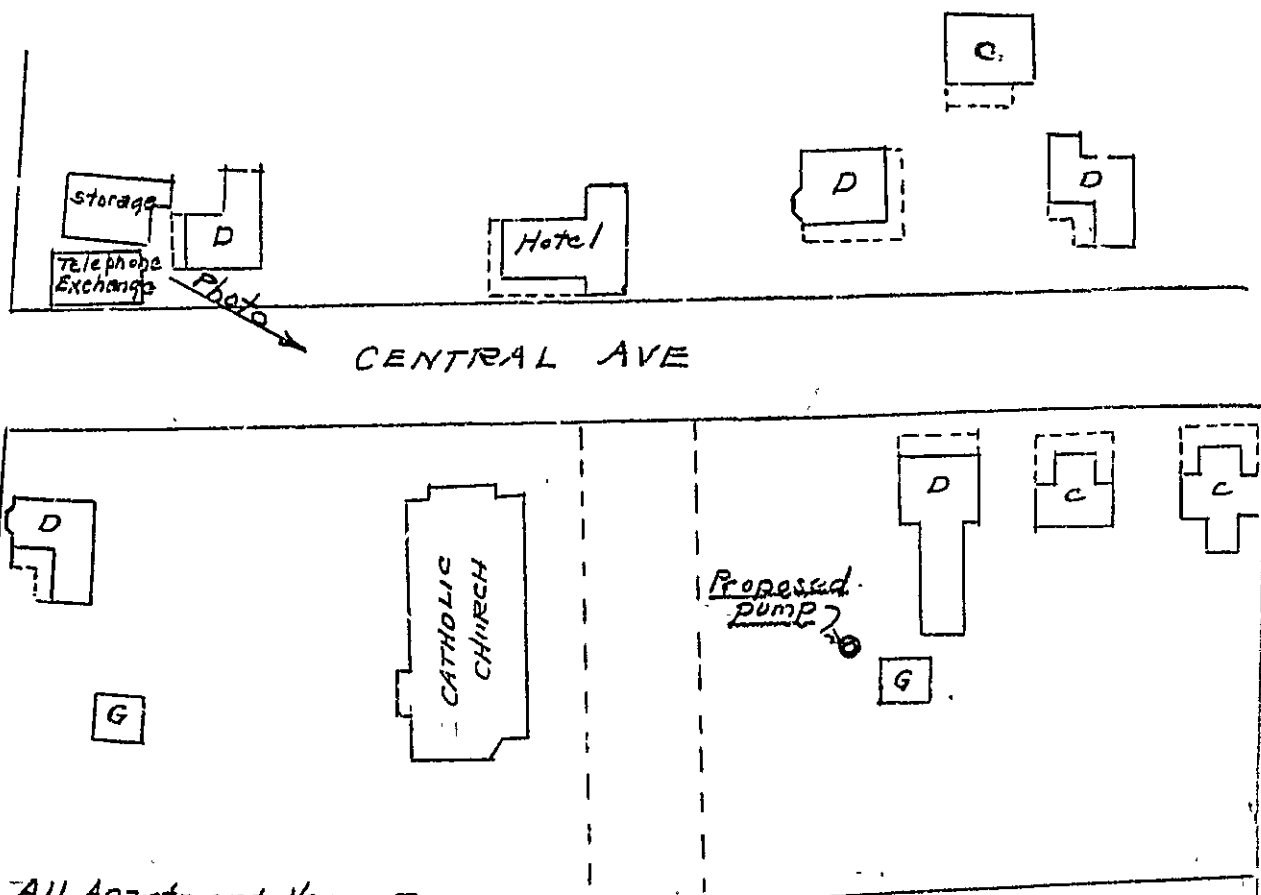

All Apartment House Zone.
D = Dwelling House
C = Cottage
G = Garage

HERMAN AVE.
PETITION OF T.C. KENYON
TO ESTABLISH
GASOLINE FILLING STA.
AT

CENTRAL AVE, PEAKS ISLD.
Scale: 1" = 50' MAR. 28, 1920

April 2, 1928

To the City Council:

The Committee on Zoning and Building Ordinance Appeals to whom was referred the petition of T. O. Kenyon seeking permission to establish a gasoline filling station in an Apartment House Zone on Central Avenue, Peaks Island, reports as follows:

The Commissioner of Public Works reports that the petitioner has secured the written consents of the owners of the required amount of neighboring property frontage. A public hearing has been held at which no opponent appeared.

Recommended that the petition be sustained and the permit granted.

Committee on Zoning and Building Ordinance Appeals.



City of Portland, Maine

IN CITY COUNCIL
IN THE BOARD OF MUNICIPAL OFFICERS

April 2, 1928

Ordered, that the appeal of T. C. Kenyon from the decision of the
Inspector of Buildings be sustained and that a building permit be
granted said - T. C. Kenyon as prayed for in h is
original appeal.

Read twice and passed

A true copy of report.

Attest:

A. B. Smith City Clerk.

5809-1

March 3, 1928

Faivoline Oil Company
Main Street
South Portland Maine

Attention Mr. H. W. Bailey

Gentlemen:

Referring to the application which you have made in the name of F. C. Kenyon for a building permit to install one 1,000 gallon tank and one 5 gallon pump for gasoline and one 550 gallon tank and one 1 gallon pump for kerosene for public sale on Central Avenue, Peaks Island, this location is in an Apartment House Zone where a gasoline filling station is a non-conforming use. It is therefore necessary to deny the permit.

Your attention is called to Section 10 Paragraph f of the Zoning Ordinance which states the procedure which may be followed in the case of a filling station otherwise excluded by the Zoning Ordinance.

If the owner decides to petition for the right to establish this station, forms for the petition will be furnished at this office. If he concludes to proceed no further, the fee for the permit will be refunded. If you will return the receipt for the same to this office promptly.

Very truly yours,

Copy to
F. C. Kenyon

Inspector of Buildings

SM/EP

(A) APARTMENT HOUSE ZONE

P. C. Church

Backlot

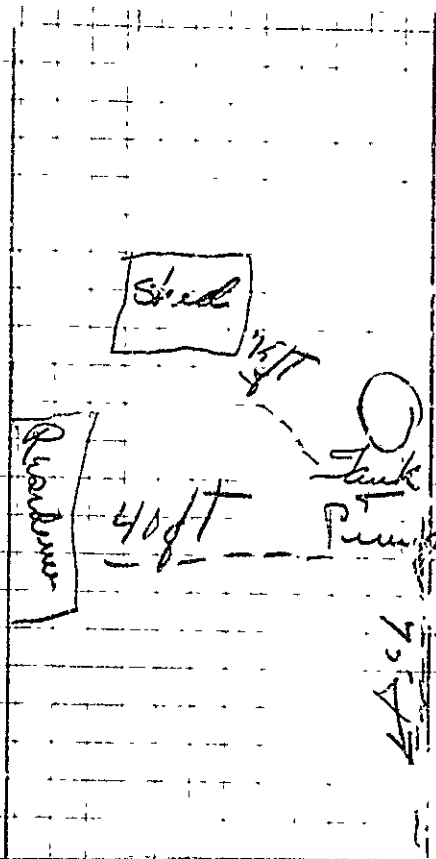

Central Avenue

J. C. Kenyon
Peaks Island



(A) APARTMENT HOUSE ZONE
APPLICATION FOR PERMIT

PERMIT ISSUED
APR 8 1938

Class of Building or Type of Structure Gasoline Installation

Portland, Maine, March 1, 1938

To the INSPECTOR OF BUILDINGS, PORTLAND, ME.

The undersigned hereby applies for a permit to erect and install the following building structure equipment in accordance with the Laws of the State of Maine, the Building Code of the City of Portland, plans and specifications, if any, submitted herewith and the following specifications:

Location Central Avenue, Peaks Island Ward 1 Within Fire Limits? No Dist. No. _____

(Vol. 2, page 45 Block 2)
Owner's or Lessee's name and address T. G. Kenyon, Peaks Island Telephone _____

Contractor's name and address Valvoline Oil Co., Box 644 Telephone 98877

Architect's name and address _____ Telephone _____

Proposed use of building _____ No. families _____

Other buildings on same lot _____

Description of Present Building to be Altered

Material _____ No. stories _____ Heat _____ Style of roof _____ Roofing _____

Last use _____ No. families _____

General Description of New Work

To install one 1000 gallon tank for gasoline, and one five gallon pump, for public use

To install 550 gallon tank for kerosene, 1 gallon pump.

Tanks to be buried underground. New Installation

Appeal sustained and permit granted by Special Permission of City Council 4/2/38

Details of New Work

Size, front _____ depth _____ No. stories _____ Height average grade to highest point of roof _____

To be erected on solid or filled land? _____ earth or rock? _____

Material of foundation _____ Thickness, top _____ bottom _____

Material of underpinning _____ Height _____ Thickness _____

Kind of roof _____ Roof covering _____

No. of chimneys _____ Material of chimneys _____ of lining _____

Kind of heat _____ Type of fuel _____ Distance, heater to chimney _____

If oil burner, name and model _____

Capacity and location of oil tanks _____

Is gas fitting involved? _____ Size of service _____

Corner posts _____ Sills _____ Girt or ledger board? _____ Size _____

Material columns under girders _____ Size _____ Max. on centers _____

Studs (outside walls and carrying partitions) 2x4-16" O. C. Girders 6x8 or larger. Bridging in every floor and flat roof span over 8 feet. Sills and corner posts all one piece in cross section.

Joists and rafters: 1st floor _____, 2nd _____, 3rd _____, roof _____

On centers: 1st floor _____, 2nd _____, 3rd _____, roof _____

Maximum span: 1st floor _____, 2nd _____, 3rd _____, roof _____

If one story building with masonry walls, thickness of walls? _____ height? _____

If a Garage

No. cars now accommodated on same lot _____, to be accommodated _____

Total number commercial cars to be accommodated _____

Will automobile repairing be done other than minor repairs to cars habitually stored in the proposed building? _____

Miscellaneous

Will above work require removal or disturbing of any shade tree on a public street? Yes

Plans filed as part of this application? Yes No. sheets 11

Estimated cost \$ 300. Fee \$ _____

Will there be in charge of the above work a person competent to see that the State and City requirements pertaining thereto are observed? Yes

By T. G. Kenyon Signature of owner

By Valvoline Oil Co.

By William P. Sabourin

By (Signature)

5809

Ward 1 Permit No. 28/463

Location Central Ave, Chicago, Ill.

Owner L.P. Kingan

Date of permit April 6, 1928

Notif. closing-in

Inspn. closing-in

Final Notif.

Final Inspn.

Cert. of Occupancy issued 87

NOTES

2/26/29 - Photo 12/12/28

P.T.F.

~~3/1/29~~