

87-E-52 Sterling St., Peaks Is.

REAR LINE

EXISTING HOUSE

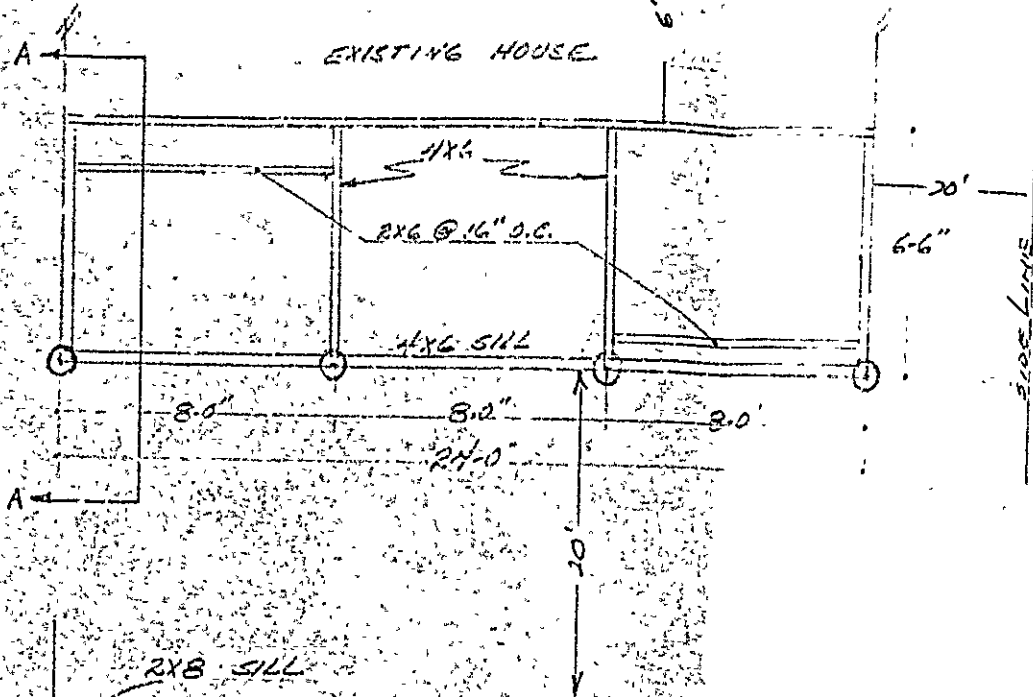

NOTES	
1.	4x6 SILLING DECK
2.	ALL FORMING TO BE TREATED W/CRUROL
3.	SILLS & POSTS TO BE FAS DMS
4.	1/2" A.B.'S FOR POST KEYS
5.	CONCRETE TO BE SACRETE CONC MIX

RECEIVED
 NOV 10 1975
 DEPT. OF BLDG. INSP.
 CITY OF PORTLAND

STERLING ST.

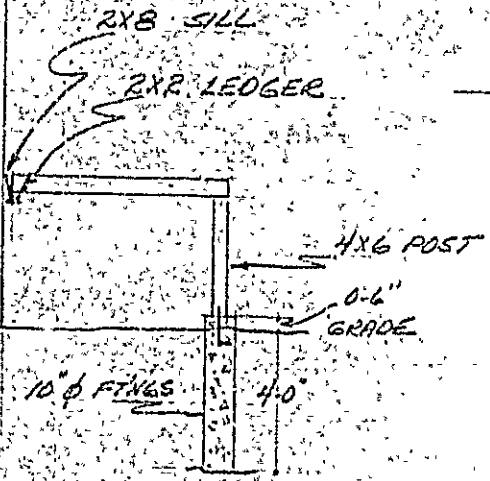

SECT A-A

WALT CRANDALL BUILDER	
JOB	PROP. Mc CONVILLE PARK
DATE	11/8/75
SCALE	1/4" = 1'-0"
DRAWN BY	WC



APPLICATION FOR PERMIT

B.O.C.A. USE GROUP
B.O.C.A. TYPE OF CONSTRUCTION

ZONING LOCATION PORTLAND, MAINE, Nov. 10, 1975.

PERMIT ISSUED

NOV 12 1975
1000

CITY of PORTLAND

To the DIRECTOR OF BUILDING & INSPECTION SERVICES, PORTLAND, MAINE

The undersigned hereby applies for a permit to erect, alter, repair, demolish, move or install the following building, structure, equipment or change use in accordance with the Laws of the State of Maine, the Portland B.O.C.A. Building Code and Zoning Ordinance of the City of Portland with plans and specifications, if any, submitted herewith and the following specifications:

LOCATION 17-2-52 Sterling St., Peaks Island
1. Owner's name and address Ruth McGonigle, same
2. Lessee's name and address
3. Contractor's name and address Walt Grandall, 323 Broadway S., Portland
4. Architect Specifications Plans x No. of sheets 1
Proposed use of building dwelling
Last use
Material No. stories Heat Style of roof Roofing
Other buildings on same lot
Estimated contractual cost \$.800 Fee \$ 5.00

FIELD INSPECTOR—Mr. Earle Smith
This application is for: @ 775-5451
Dwelling Ext. 234
Garage
Masonry Bldg.
Metal Bldg.
Alterations
Demolitions
Change of Use
Other porch

GENERAL DESCRIPTION
To replace existing porch as per plan.
same size—same location

Stamp of Special Conditions

NOTE TO APPLICANT: Separate permits are required by the installers and subcontractors of heating, plumbing, electrical and mechanicals.

PERMIT IS TO BE ISSUED TO 1 2 3 4
Other:

DETAILS OF NEW WORK

Is any plumbing involved in this work? Is any electrical work involved in this work?
Is connection to be made to public sewer? If not what is proposed for sewage?
Has septic tank notice been sent? Form notice sent?
Height average grade to top of plate Height average grade to highest point of roof
Size, front depth No. stories solid or filled land? earth or rock?
Material of foundation Thickness, top bottom cellar
Kind of roof Rise per foot Roof covering
No. of chimneys Material of chimneys of lining Kind of heat fuel
Framing Lumber—Kind Dressed or full size? Corner posts Sills
Size Girder Columns under girders Size Max. on centers
Studs (outside walls and carrying partitions) 2x4-16" O. C. Bridging in every floor and flat roof span over 8 feet.
Joists and rafters: 1st floor 2nd 3rd roof
On centers: 1st floor 2nd 3rd roof
Maximum span: 1st floor 2nd 3rd roof
If one story building with masonry walls, thickness of walls? height?

IF A GARAGE

No. cars now accommodated on same lot to be accommodated number commercial cars to be accommodated
Will automobile repairing be done other than minor repairs to cars habitually stored in the proposed building?

APPROVALS BY: DATE
BUILDING INSPECTION—PLAN EXAMINER
ZONING:
BUILDING CODE: O.K. E.S. 11/17/75
Fire Dept.:
Health Dept.:
Others:

MISCELLANEOUS
Will work require disturbing of any tree on a public street?
Will there be in charge of the above work a person competent to see that the State and City requirements pertaining thereto are observed? YES

Signature of Applicant Walter Grandall Phone #
Type Name of above Walter Grandall 1 2 3 4

Other and Address

FIELD INSPECTOR'S COPY
lak

NOTES

12/21/75 - Work done
C.H.B.

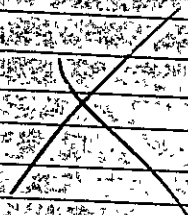

Approved

Date of permit

Permit No.

Location

Owner

75/1002
87 E. 52nd St. N.Y.C.
R.H.D. M. Kelly Co.
Nov. 21, 1975

R.H.D. Kelly Co.

CITY OF PORTLAND, MAINE
Application for Permit to Install Wires

Permit No. 54228

Issued Sept. 24, 1965
 Portland, Maine

To the City Electrician, Portland, Maine:

The undersigned hereby applies for a permit to install wires for the purpose of conducting electric current, in accordance with the laws of Maine, the Electrical Ordinance of the City of Portland, and the following specifications:

(This form must be completely filled out - Minimum Fee, \$1.00)

Owner's Name and Address Ruth K. McGonigle Peaks Isl.
 Contractor's Name and Address Roland S. Hoar Peaks Isl. Tel. 766-2864
 Location Sterling St. Use of Building Dwelling
 Number of Families 1 Apartments Stores Number of Stories 1 1/2
 Description of Wiring: New Work Additions ✓ Alterations ✓

Pipe Cable Meta' Molding BX Cable Plug Molding (No. of feet)
 No. Light Outlets 2 Plugs 10 Light Circuits Plug Circuits 1
 FIXTURES: No. Light Switches Fluor. or Strip Lighting (No. feet)
 SERVICE: Pipe Cable ✓ Underground No. of Wires 3 Size #3
 METERS: Relocated ✓ Added Total No. Meters 1
 MOTORS: Number Phase H. P. Amps Volts Starter
 HEATING UNITS: Domestic (Oil) ✓ No. Motors 1 Phase 1 H.P. 1/8
 Commercial (Oil) No. Motors Phase H.P.
 Electric Heat (No. of Rooms)

APPLIANCES: No. Ranges Watts Brand Fuses (Size and No.)
 Elec. Heaters Watts
 Miscellaneous Watts Extra Cabinets or Panels

Transformers Air Conditioners (No Units) Signs (No. Units)
 Will commence 19 Ready to cover in 19 Inspection Sept. 1 1965

Amount of Fee \$ 6.00
 Signed Roland S. Hoar

DO NOT WRITE BELOW THIS LINE

SERVICE ✓ METER GROUND ✓
 VISITS: 1 2 3 4 5 6
 7 8 9 10 11 12

REMARKS:

INSPECTED BY J.W. [Signature]
Dona Butterfield (OVER)

Peaks-Island

LOCATION Sterling St.

INSPECTION DATE 10/1/65

WORK COMPLETED 10/1/65

TOTAL NO. INSPECTIONS 1

REMARKS:

FEEES FOR WIRING PERMITS EFFECTIVE JULY 31, 1963

WIRING

1 to 30 Outlets	(including switches)	\$ 2.00
31 to 60 Outlets	(including switches)	3.00
Over 60 Outlets, each Outlet	(including switches)	.05

(Each twelve feet or fraction thereof of fluorescent lighting or any type of plug molung will be classed as one outlet).

SERVICES

Single Phase	2.00
Three Phase	4.00

MOTORS

Not exceeding 50 H.P.	3.00
Over 50 H.P.	4.00

HEATING UNITS

Domestic (Oil)	2.00
Commercial (Oil)	4.00
Electric Heat (Each Room)	.75

APPLIANCES

Ranges, Cooking Tops, Ovens, Water Heaters, Disposals, Dishwashers, etc. — Each Unit	1.50
--	------

TEMPORARY WORK (Limited to 6 months from date of permit)

Service, Single Phase	1.00
Service, Three Phase	2.00
Wiring, 1-50 Outlets	1.00
Wiring, each additional outlet over 50	.05

2.00
2.00
2.00



FILL IN AND SIGN WITH INK

APPLICATION FOR PERMIT FOR HEATING, COOKING OR POWER EQUIPMENT

Portland, Maine, Sept. 24, 1965

PERMIT ISSUED 01013 SEP 24 1965 CITY of PORTLAND

To the INSPECTOR OF BUILDINGS, PORTLAND, ME.

The undersigned hereby applies for a permit to install the following heating, cooking or power equipment in accordance with the Law of Maine, the Building Code of the City of Portland, and the following specifications:

Location Sterling St., Peaks Island Use of Building 1 fam. dwelling No. Stories 1 1/2
Name and address of owner of appliance Ruth K. Gonigle, Sterling St., Peaks Island
Installer's name and address Roland Hoar, Island Ave., Peaks Island Telephone

General Description of Work

To install forced hot water heating system and oil burning equipment (in place of stove heat)

IF HEATER, OR POWER BOILER

Location of appliance basement Any burnable material in floor surface or beneath? no
If so, how protected? Find of fuel? oil
Minimum distance to burnable material, from top of appliance or top of furnace 2'
From top of smoke pipe 2' From front of appliance over 4' From sides or back of appliance over 4'
Size of chimney flue 8x8 Other connections to same flue no
If gas fired, how vented? Rated maximum demand per hour
Will sufficient fresh air be supplied to the appliance to insure proper and safe combustion?

IF OIL BURNER

Name and type of burner Crane gun type Labelled by underwriters' laboratories? yes
Will operator be always in attendance? Does oil supply line lead from top or bottom of tank? bottom
Type of floor beneath burner cement Size of vent pipe 1 1/2"
Location of oil storage basement Number and capacity of tanks 275 gal.
Low water shut off Make No.
Will all tanks be more than five feet from any flame? yes How many tanks enclosed?
Total capacity of any existing storage tanks for furnace burners

IF COOKING APPLIANCE

Location of appliance Any burnable material in floor surface or beneath?
If so, how protected? Height of Legs, if any
Skirting at bottom of appliance? Distance to combustible material from top of appliance?
From front of appliance From sides and back From top of smokepipe
Size of chimney flue Other connections to same flue
Is hood to be provided? If so, how vented? Forced or gravity?
If gas fired, how vented? Rated maximum demand per hour

MISCELLANEOUS EQUIPMENT OR SPECIAL INFORMATION

Amount of fee enclosed? 2.00 (\$2.00 for one heater, etc., \$1.00 additional for each additional heater, etc., in same building at same time.)

APPROVED:

OK E. S. S. 9/24/65

Will there be in charge of the above work a person competent to see that the State and City requirements pertaining thereto are observed? yes

Roland Hoar

Signature of Installer

[Handwritten Signature]

A.P.-Sterling St., Peaks Island

Sept. 13, 1965

Roland Herr
Island Ave
Peaks Island

cc to: Ruth E. McCordle
Island Ave.
Peaks Island

Dear Mr. Herr:

Permit to construct an 8' dormer on side of dwelling and to close up five existing door openings and cut in five new door openings on first and second floors is being issued subject to Building Code restrictions as follows:

If any door openings are to be over three feet wide then a structural header will be needed. Before any work is started on such an opening, information must be given this office on the size of header to be used before work is started.

Very truly yours,

A. Allan Soule
Inspector

AAS:m



R3 RESIDENCE ZONE

APPLICATION FOR PERMIT

Class of Building or Type of Structure Third Class
September 10, 1965
Portland, Maine

PERMIT ISSUED

SEP 13 1965

CITY of PORTLAND

To the INSPECTOR OF BUILDINGS, PORTLAND, MAINE

The undersigned hereby applies for a permit to erect alter-repair demolish install the following building structure equipment in accordance with the Laws of the State of Maine, the Building Code and Zoning Ordinance of the City of Portland, plans and specifications, if any, submitted herewith as follows:

Location Sterling St. Peaks Island 27-E-52 Within Fire Limits? _____ Dist. No. _____
 Owner's name and address Ruth K McGonigle, Island Ave. Peaks Island Telephone _____
 Lessee's name and address _____ Telephone _____
 Contractor's name and address Roland Hoar, Island Ave. Peaks Island Telephone 766-2354
 Architect _____ Specifications _____ Plans no No. of sheets _____
 Proposed use of building Dwelling No. families 1
 Last use: _____ " _____ No. families 1
 Material frame No. stories 1 1/2 Heat _____ Style of roof _____ Roofing _____
 Other buildings on same lot _____
 Estimated cost \$ 1000.00 Fee \$ 5.00

General Description of New Work

construct 3' dormer on side of dwelling.
 Approx. 10' to side lot line.
 To close up (-) existing door openings and cutting in (5) new door openings (relocating) on first and second floors.

Permit Issued with Letter

It is understood that this permit does not include installation of heating apparatus which is to be taken out separately by and in the name of the heating contractor. PERMIT TO BE ISSUED TO contractor

Details of New Work

Is any plumbing involved in this work? _____ Is any electrical work involved in this work? _____
 Is connection to be made to public sewer? _____ If not, what is proposed for sewage? _____
 Has septic tank notice been sent? _____ Form notice sent? _____
 Height average grade to top of plate _____ Height average grade to highest point of roof _____
 Size, front _____ depth _____ No. stories _____ solid or filled and? _____ earth or rock? _____
 Material of foundation _____ Thickness, top _____ bottom _____ cellar _____
 Material of underpinning _____ Height _____ Thickness _____
 Kind of roof hip Rise per foot 3 1/2" Roof covering Asphalt Class C Unl. Label.
 No. of chimneys _____ Material of chimneys _____ of lining _____ Kind of heat _____ fuel _____
 Framing Lumber—Kind hard oak Dressed or full size? dressed Corner posts 3-2x4 Sills _____
 Size Girder _____ Columns under girders _____ Size _____ Max. on centers _____
 Kind and thickness of outside sheathing or exterior walls? _____
 Studs (outside walls and carrying partitions) 2x4-16" O. C. Bridging in every floor and flat roof span over 8 feet.
 Joists and rafters: 1st floor _____, 2nd _____, 3rd _____, roof 2x8
 On centers: 1st floor _____, 2nd _____, 3rd _____, roof 16"
 Maximum span: 1st floor _____, 2nd _____, 3rd _____, roof 10'
 If one story building with masonry walls, thickness of walls? _____ height? _____

If a Garage

No. cars now accommodated on same lot _____, to be accommodated _____ number commercial cars to be accommodated _____
 Will automobile repair be done other than minor repairs to cars habitually stored in the proposed building? _____

Miscellaneous

Will work require disturbing of any tree on a public street? no
 Will there be in charge of the above work a person competent to see that the State and City requirements pertaining thereto are observed? yes

APPROVED:
C.S. - 9/13/65 - Allen W. Miller

Ruth K McGonigle
 Roland Hoar

Signature of owner _____

INSPECTION COPY

NOTES

11-1-65 - Moore
 Home
 Mr Goodwin
 Child
 9-10-66 Completed
 D

Permit No. 65/957 D
 Location: Stevens Street 1100 St
 Owner: Rosell K. McAnville
 Date of permit: 9/13/67
 Notif. closing in: _____
 Inspn. closing in: _____
 Final Notif.: _____
 Final Inspn.: _____
 Cert. of Occupancy issued: _____
 Staking Out Notice: _____
 Form Check Notice: _____

(This section contains faint, mostly illegible text, possibly bleed-through from the reverse side of the page.)

(This section contains faint, mostly illegible text, possibly bleed-through from the reverse side of the page.)

77



FILL IN AND SIGN WITH INK

APPLICATION FOR PERMIT FOR HEATING, COOKING OR POWER EQUIPMENT

Portland, Maine, Sept. 6, 1949

PERMIT ISSUED 01424 SEP 7 1949 CITY of PORTLAND

To the INSPECTOR OF BUILDINGS, PORTLAND, MAINE

The undersigned hereby applies for a permit to install the following heating, cooking or power equipment in accordance with the Laws of Maine, the Building Code of the City of Portland, and the following specifications:

Location Sterling St., Peaks Island Use of Building Dwelling No. Stories 1 1/2 NEW Building Existing " Name and address of owner of appliance Howard Tracy, Sterland St., Peaks Island Installer's name and address Earl Hutchings, 17 Luther St., Peaks Island Telephone 44 ring 1.

General Description of Work

To install Oil burning equipment in connection with existing hot air heat.

IF HEATER, OR POWER BOILER

Location of appliance or source of heat Type of floor beneath appliance If wood, how protected? Kind of fuel Minimum distance to wood or combustible material, from top of appliance or casing top of furnace From top of smoke pipe From front of appliance From sides or back of appliance Size of chimney flue Other connections to same flue If gas fired, how vented? Rated maximum demand per hour

IF OIL BURNER

Name and type of burner burner conversion Labelled by underwriter's laboratories? Yes Will operator be always in attendance? Does oil supply line feed from top or bottom of tank? Bottom Type of floor beneath burner Concrete Location of oil storage Cellar Number and capacity of tanks 1-275 Gal. If two 275-gallon tanks, will three-way valve be provided? Will all tanks be more than five feet from any flame? Yes How many tanks fire proofed? Total capacity of any existing storage tanks for furnace burners None

IF COOKING APPLIANCE

Location of appliance Kind of fuel Type of floor beneath appliance If wood, how protected? Minimum distance to wood or combustible material from top of appliance From front of appliance From sides and back From top of smokepipe Size of chimney flue Other connections to same flue Is hood to be provided? If so, how vented? If gas fired, how vented? Rated maximum demand per hour

MISCELLANEOUS EQUIPMENT OR SPECIAL INFORMATION

[Blank lines for miscellaneous information]

Amount of fee enclosed? 2.00 (\$1.00 for one heater, etc., 50 cents additional for each additional heater, etc., in same building at same time.)

APPROVED:

[Signature]

Will there be in charge of the above work a person competent to see that the State and City requirements pertaining thereto are observed? Yes

Signature of Installer

[Signature]

INSPECTION COPY

Permit No 49/1424 11.23
Location Sterling St, Peaks Island
Owner Howard Tracy
Date of permit 9/7/49
Approved INSPECTION NOT COMPLETED

NOTES

- 1 Fill Pipe
- 2 Vent Pipe
- 3 Kind of fuel
- 4 Burner Rating & Supports
- 5 Fuel Control
- 6 High Fuel Control
- 7 Remote Control
- 8 Piping Support & Location
- 9 Valves in System
- 10 Capacity of Tanks
- 11 Tank Rating & Supports
- 12 Tank Location
- 13 Oil Gauge
- 14 Instruction Card
- 15
- 16
- 17
- 18
- 19
- 20