

WILEY STREET  
87-D-10

PLAKS ISLAND

CERTIFICATE OF APPROVAL  
FOR INTERNAL PLUMBING

THE TOWN/CITY OF Portland

TOWN/CITY CODE  
05170

LPI NUMBER  
00123

DATE ISSUED  
22387  
Month Day Year

5141 IC

Certificate of App. Number

Installer's Name: DUBEL F.I.M.I. Installer Code: 2

- 1. Owner
- 2. Licensed Master Plumber
- 3. Licensed Oil Burnerman
- 4. Employee of Public Utility
- 5. Manufactured Housing Dealer
- 6. Manufactured Housing Mechanic
- 7. Limited License

Owner: 87-D-10 WILEY AVE Peaks Is.  
Address: 87-D-10 St./Lot Number WILEY AVE Street, Road Name Peaks Is. Subdivision  
(Location where plumbing was done and inspected)

THE INTERNAL PLUMBING INSTALLED PURSUANT TO THE ABOVE CERTIFICATE OF APPROVAL NUMBER HAS BEEN TESTED IN MY PRESENCE, FOUND TO BE FREE FROM LEAKS, AND WAS INSTALLED IN COMPLIANCE WITH THE MUNICIPAL AND STATE PLUMBING RULES.

OWNER'S COPY

*Ernest D. Goodwin*

Signature of LPI: \_\_\_\_\_  
Date Inspected: MAR 11 1987

**CERTIFICATE OF APPROVAL  
FOR INTERNAL PLUMBING**

TOWN/CITY CODE: 05170      LPI NUMBER: 00123      DATE ISSUED: 223811  
 THE TOWN/CITY OF: Portland      51141      IC

Installer's Name: DUEE      F I M I      Certificate of App Number: \_\_\_\_\_  
 Owner: \_\_\_\_\_      Installer Code: 2  
 Address: 87-D-10 WILEY AVE      Park      Subdivision: \_\_\_\_\_  
 St./Lot Number      Street, Road Name      Location where plumbing was done and inspected

THE INTERNAL PLUMBING INSTALLED PURSUANT TO THE ABOVE CERTIFICATE OF APPROVAL NUMBER HAS BEEN TESTED IN MY PRESENCE, FOUND TO BE FREE FROM LEAKS, AND WAS INSTALLED IN COMPLIANCE WITH THE MUNICIPAL AND STATE PLUMBING RULES.

TOWN'S COPY

Signature of LPI: [Signature]  
 Date Inspected: MAR 11 1981

**INTERNAL PLUMBING PERMIT FOR THE TOWN/CITY OF**

Town/City Code: 05170      LPI Number: 00123      Date Issued: 223811      INSTALLER'S License No: 51141      IP

Address of Where Plumbing is Done: 87-D-10 WILEY AVE      Park      Subdivision: \_\_\_\_\_  
 St./Lot Number      Street/Road Name      Installer Code: 2

Name of Owner: PETERSON      F I M I      Mailing Address: \_\_\_\_\_      Zip Code: \_\_\_\_\_  
 Last Name

Type of Construction	1 New	2 Remodeling	3 Addition	4 Remodeling & Addition	5 Replacement of Hot Water Heater	6 Hook-up of Mobile Home	7 Hook-up of Modular Home	8 Other (Specify)
Plumbing To Serve	1 Single (Res)	2 Multi-Fam (Res)	3 Mobile Home	4 Modular Home	5 Commercial	6 School	7 Other (Specify)	
Number of Fixtures or Hook Ups	Sink(s) <input type="checkbox"/>	Toilet(s) <input checked="" type="checkbox"/>	Bathtub(s) <input checked="" type="checkbox"/>	Lavatories(s) <input checked="" type="checkbox"/>	Shower(s) <input type="checkbox"/>	Urinal(s) <input type="checkbox"/>		
	Clothes Washers <input type="checkbox"/>	Dish Washer(s) <input type="checkbox"/>	Hot Water Heater(s) <input checked="" type="checkbox"/>	Floor Drain(s) <input type="checkbox"/>	Hook Up(s) <input type="checkbox"/>			

TOWN'S COPY

**IMPORTANT. Note the following conditions.**  
 1 This Permit is non-transferable to another person or party.  
 2 If construction has not started within 6 months from the Date of Issue, this Permit becomes invalid.

Fixture Fee: 12.00  
 Hook Up Fee: 00.00  
 Total Fee: 12.00  
 If Double Fee Check Box

Dept. of Human Services  
 Div. of Health Engineering

Signature of LPI \_\_\_\_\_

**CITY OF PORTLAND, MAINE**  
**Application for Permit to Install Wires**

Permit No. *55160*

Issued  
 Portland, Maine *Sept 6*, 19*46*

To the City Electrician, Portland, Maine:

The undersigned hereby applies for a permit to install wires for the purpose of conducting electric current, in accordance with the laws of Maine, the Electrical Ordinance of the City of Portland, and the following specifications:

*(87-5-10)*  
 (This form must be completely filled out - Minimum Fee, \$1.00)

Owner's Name and Address *Mrs. Mitchell Bishop Miller, 201 Peaks Island*

Contractor's Name and Address *E. P. Corcoran, Peaks Island*

Location *Peaks Island, P. I.* Use of Building *Dwelling*

Number of Families *1* Apartments ..... Stores ..... Number of Stories .....

Description of Wiring: New Work ..... Additions ..... Alterations *✓* .....

Pipe ..... Cable  Metal Molding ..... BX Cable ..... Plug Molding (No. of feet) ..

No. Light Outlets ..... Plugs ..... Light Circuits ..... Plug Circuits .....

FIXTURES: No. .... Light Switches ..... Strip Lighting (No. feet) .....

SERVICE: Pipe .. Cable  Und. .... No. of Wires *3* Size *10-2*

METERS: Relocated  Added ..... Total No. Meters .....

MOTORS: Number .. Phase H. P. Amps .. Volts Starter ..

HEATING UNITS: Domestic (Oil) No. Motors Phase .. H.P. ..

Commercial (Oil) No. Motors Phase H.P. ..

Electric Heat (No. of Rooms) ..

APPLIANCES: No. Ranges *1* Watts *7500* Brand Feeds (Size and No.) *3 No. 6*

Elec. Heaters ..... Watts .....

Miscellaneous ..... Watts ..... Extra Cabinets or Panels .....

Transformers ..... Air Conditioners (No. Units) ..... Signs (No. Units) .....

Will commence *Sept 6 1946* Ready to cover in ..... 19 .. Inspection *Sept 6 1946*

Amount of Fee \$... *2.50* ..

Signed *E. P. Corcoran*

DO NOT WRITE BELOW THIS LINE

SERVICE ..... METER ..... GROUND .....

VISITS: 1 ..... 2 ..... 3 ..... 4 ..... 5 ..... 6 .....

..... 7 ..... 8 ..... 9 ..... 10 ..... 11 ..... 12 .....

REMARKS:

INSPECTED BY *Dw. Herbert*  
*Dana Butterfield*  
 (OVER)

Poaks Island

LOCATION *Wiley Av.*  
INSPECTION DATE *9/16/66*  
WORK COMPLETED *9/16/66*  
TOTAL NO. INSPECTIONS *1*

REMARKS:

FEES FOR WIRING PER ITS EFFECTIVE JULY 31, 1963

WIRING		
to 30 Outlets	(including switches)	\$ 2.00
31 to 60 Outlets	(including switches)	3.00
Over 60 Outlets, each Outlet	(including switches)	.05
(Each twelve feet or fraction thereof of fluorescent lighting or any type of plug molding will be classed as one outlet).		
SERVICES		
Single Phase		2.00
Three Phase		4.00
MOTORS		
Not exceeding 50 H.P.		3.00
Over 50 H.P.		4.00
HEATING UNITS		
Domestic (Oil)		2.00
Commercial (Oil)		4.00
Electric Heat (Each Room)		.75
APPLIANCES		
Ranges, Cooking Tops, Ovens, Water Heaters, Disposals, Dishwashers, etc. --- Each Unit		1.50
TEMPORARY WORK (limited to 6 months from date of permit)		
Service, Single Phase		1.00
Service, Three Phase		2.00
Wiring, 1-50 Outlets		1.00
Wiring, each additional outlet over 50		.02
Circuses, Carnivals, Fairs, etc.		10.00
MISCELLANEOUS		
Distribution Cabinet or Panel, per unit		1.00



0887

(A) APARTMENT HOUSE ZONE

Permit No.

APPLICATION FOR PERMIT PERMIT ISSUED

Class of Building or Type of Structure Brk

JUN 20 1927

Portland, Maine, June 13 1927

To the INSPECTOR OF BUILDINGS, PORTLAND, ME.

The undersigned hereby applies for a permit to ~~erect~~ alter ~~in~~ the following building ~~erect~~ in accordance with the Laws of the State of Maine, the Building Code of the City of Portland, plans and specifications, if any, submitted herewith and the following specifications:

Location: Willey Ave Peaks Isl. (Parsons City) Ward 1 Within Fire Limits? NO Dist. No. -  
Owner's or Lessee's name and address: Mildred E. Staples Sema Telephone -  
Contractor's name and address: Mr Staples Sema Telephone -  
Architect's name and address: -  
Proposed use of building: Dwelling House No. families: 1  
Other buildings on same lot: NO

Description of Present Building to be Altered

Material: wood No. stories: 1 1/2 Heat: stove Style of roof: pitch Roofing: asphalt shingles  
Last use: Dwelling House No. families: 1

General Description of New Work

Put in Temporary Foundation of stone for storage of coal about 15'-0 Sq. 7'-5 deep

This temporary wall is to be laid up of loose stones and is to be built at least two feet inside of the sills, and in no way interfere with or take the place of the present foundation of the buildings.

NOTIFICATION BEFORE LATHING CLOSING IN IS WAIVED.

Details of New Work

Size, front: 16 depth: 15 No. stories: - Height average grade to highest point of roof: -  
To be erected on solid or filled land? - earth or rock? -  
Material of foundation: Stone Thickness, top: - bottom: -  
Material of underpinning: - Height: - Thickness: -  
Kind of roof: - Roof covering: -  
No. of chimneys: - Material of chimneys: - of lining: -  
Kind of heat: - Type of fuel: - Distance, heater to chimney: -  
If oil burner, name and model: -  
Capacity and location of oil tanks: -  
Is gas fitting involved? - Size of service: -  
Corner posts: - Sills: - Girt or ledger board? - Size: -  
Material columns under girders: - Size: - Max. on centers: -  
Studs (outside walls and carrying partitions) 2x4-16" O.C. Girders 6x8 or larger. Bridging in every floor and flat roof span over 8 feet. Sills and corner posts all one piece in cross section.  
Joists and rafters: 1st fl c: -, 2nd: -, 3rd: -, roof: -  
On centers: 1st floor: -, 2nd: -, 3rd: -, roof: -  
Maximum span: 1st floor: -, 2nd: -, 3rd: -, roof: -  
If one story building with masonry walls, thickness of walls? - height? -

If a Garage

No. cars now accommodated on same lot: - to be accommodated: -  
Total number commercial cars to be accommodated: -  
Will automobile repairing be done other than minor repairs to cars habitually stored in the proposed building? -

Miscellaneous

Will above work require removal or disturbing of any shade tree on a public street? NO  
Plans filed as part of this application? NO No. sheets: -  
Estimated cost \$ 25 Fee \$ 25  
Will there be in charge of the above work a person competent to see that the State and City requirements pertaining thereto are observed? YES

Signature of owner: Mrs Mildred E. Staples

INSPECTION COPY

Walter A. Staples

3766

Permit No. 27881

Location Wiley Ave. Peabody

Owner Mildred Stalle

Date of permit June 27/29

Notif. closing-in \_\_\_\_\_

Inspn. closing-in \_\_\_\_\_

Final Notif. \_\_\_\_\_

Final Inspn. \_\_\_\_\_

Cert. of Occupancy issued 8/1/29

NOTES

D62

7/31/28  
~~\_\_\_\_\_~~



# APPLICATION FOR PERMIT TO BUILD

YOU!  
are responsible for complying  
with the law, whether you  
know it or not.

26/583

3rd CLASS BUILDING  
This is a 3rd Class Building  
Get All Questions Settled  
BEFORE Commencing Work.

To the INSPECTOR OF BUILDINGS, PORTLAND, MAINE, June 12, 1926

The undersigned hereby applies for a permit to build, according to the following specifications, the Laws of the State of Maine, and the Building Ordinance of the City of Portland.

Location Wiley St, Peaks Island Ward 1 Within Fire Limits? no

Owner's name and address? Mrs. Mildred Staples, Peaks Island

Contractor's name and address? Charles F Bishop, Peaks Island, Park Ave

Architect's name and address? \_\_\_\_\_

Proposed occupancy of building (purpose)? cottage

No. families? 1 apartments? \_\_\_\_\_ lodgers? \_\_\_\_\_

Size, front? 20, depth? 30 No. stories? 1 1/2, height, average grade to highest point of roof? 16ft

To be erected on solid or filled land? solid earth or rock? \_\_\_\_\_

Material of foundation? posts 4ft apart Thickness, top? \_\_\_\_\_ bottom? \_\_\_\_\_

Material of underpinning? \_\_\_\_\_ over 4 ft. high? \_\_\_\_\_ thickness? \_\_\_\_\_

Kind of roof (pitch, hip, etc.)? pitch Kind of roofing? shingle

Kind of heat? stove Material of chimney? brick, of lining? tile

### SIZE OF FRAMING MEMBERS

Corner posts? 4x6 Sills? 4x6 Rafters or roof beams? 2x6 on center? 24

Material and size of columns under girders? no on center? \_\_\_\_\_

Ledger board used? no Size? \_\_\_\_\_ Studs (outside walls and carrying partitions) 2 x 4 16" O. C.

Girders 6" x 8" or larger. Bridging in every floor and flat roof span over 8 feet. Sills and corner posts will be all one piece in cross section.

Floor timbers: 1st floor 2x8, 2nd 2x6, 3rd \_\_\_\_\_, 4th \_\_\_\_\_

On centers: 1st floor 16, 2nd 16, 3rd \_\_\_\_\_, 4th \_\_\_\_\_

Span: 1st floor 6ft, 2nd 6ft, 3rd \_\_\_\_\_, 4th \_\_\_\_\_

### IF 1ST OR 2ND CLASS BUILDING

External walls } thickness { 1st story \_\_\_\_\_, 2nd story \_\_\_\_\_

Party walls } thickness { 1st story \_\_\_\_\_, 2nd story \_\_\_\_\_

Material of cornice? \_\_\_\_\_ How fastened? \_\_\_\_\_

### IF APARTMENT, TENEMENT OR LODGING HOUSE

Dimensions of lot? \_\_\_\_\_

Descriptions of other buildings on lot? \_\_\_\_\_

Clear distance to rear lot line? \_\_\_\_\_, to one side lot line? \_\_\_\_\_, to other side lot line? \_\_\_\_\_

### IF A PRIVATE GARAGE

No. cars to be accommodated? \_\_\_\_\_

Other buildings on same lot? \_\_\_\_\_

Distance from nearest present building to proposed garage? \_\_\_\_\_

All parts of garage, including eaves, will be at least 2 ft. from all lot lines.

Garage will be at least \_\_\_\_\_ feet from nearest windows of adjoining property.

Will there be a heating plant within building? \_\_\_\_\_

If so, how protected? \_\_\_\_\_

### MISCELLANEOUS

Will the above construction require the removal or disturbing of any shade tree on the public street? no

Plans filed as part of this application? no No. of \_\_\_\_\_

Estimated total cost \$ 1,000. Fee? 1.00

Signature of owner or authorized representative? Mrs. Mildred Staples



✓  
Fr - 2

26/582

Wiley St, Park  
~~Montgomery St~~

June 12/26

87-D-10



APPLICATION FOR PERMIT

1252

PERMIT ISSUED  
OCT 20 1985  
City Of Portland

B.O.C.A. USE GROUP .....  
B.O.C.A. TYPE OF CONSTRUCTION .....

ZONING LOCATION ..... PORTLAND, MAINE Oct. 30, 1985

To the CHIEF OF BUILDING & INSPECTION SERVICES, PORTLAND, MAINE

The undersigned hereby applies for a permit to erect, alter, repair, demolish, move or install the following building, structure, equipment or change use in accordance with the Laws of the State of Maine, the Portland B.O.C.A. Building Code and Zoning Ordinance of the City of Portland with plans and specifications, if any, submitted herewith and the following specifications:

LOCATION ... 37-D-10 Wiley St., Peaks Island ... Fire District #1 , #2   
1. Owner's name and address ... Helen Vita - 1915 Mill Rd. So. ... Telephone .....  
2. Lessee's name and address ... Pasadena Cal ... Telephone .....  
3. Contractor's name and address ... Sam Powers - Peaks Island ... Telephone 766-3324

Proposed use of building ... Dwelling ... No. of sheets .....  
Last use ... same ... No. families ... 1 ...  
Material ... No. stories ... Heat ... Style of roof ... Roofing ...

Other buildings on same lot .....  
Estimated contractual cost \$... 1,000...

FIELD INSPECTOR—Mr. ....  
@ 775-5451  
Appeal Fees \$ .....  
Base Fee ..... 25.00  
Late Fee .....  
TOTAL \$ .....

To reframe two front windows, reframe stair  
wall to construct ell shaped stairs and  
fr opening in floor for floor furnace  
per plans. 1 sheet of plans.

Stamp of Special Conditions

send permit to # 3 04108 - Luther Street

NOTE TO APPLICANT: Separate permits are required by the installers and subcontractors of heating, plumbing, electrical and mechanicals.

DETAILS OF NEW WORK

Is any plumbing involved in this work? .. no ..... Is any electrical work involved in this work? .. no .....  
Is connection to be made to public sewer? ... If not, what is proposed for sewage? .....  
Has septic tank notice been sent? ..... Form notice sent? .....  
Height average grade to top of plate ..... Height average grade to highest point of roof .....  
Size, front ..... depth ..... No. stories ..... solid or filled land? ..... earth or rock? .....  
Material of foundation ..... Thickness, top ..... bottom ..... cellar .....  
Kind of roof ..... Rise per foot ..... Roof covering .....  
No. of chimneys ..... Material of chimneys ..... of lining ..... Kind of heat ..... fuel .....  
Framing Lumber—Kind ..... Dressed or full size? ..... Corner posts ..... Sills .....  
Size Girder ..... Columns under girders ..... Size ..... Max. on centers .....  
Studs (outside walls and carrying partitions) 2x4-16" O. C. Bridging in every floor and flat roof span over 8 feet.  
Joists and rafters: 1st floor ..... 2nd ..... 3rd ..... roof .....  
On centers: 1st floor ..... 2nd ..... 3rd ..... roof .....  
Maximum span: 1st floor ..... 2nd ..... 3rd ..... roof .....  
If one story building with masonry walls, thickness of walls? ..... height? .....

IF A GARAGE

No. cars now accommodated on same lot ..... to be accommodated ..... number commercial cars to be accommodated .....  
Will automobile repairing be done other than minor repairs to cars habitually stored in the proposed building? .....

APPROVALS BY: DATE  
BUILDING INSPECTION—PLAN EXAMINER .....  
ZONING: .....  
BUILDING CODE: .....  
Fire Dept.: .....  
Health Dept.: .....  
Others: .....

MISCELLANEOUS  
Will work require disturbing of any tree on a public street? .. no .....  
Will there be in charge of the above work a person competent to see that the State and City requirements pertaining thereto are observed? .....

Signature of Applicant Sam Powers  
Type Name of above Sam Powers for  
held with  
Phone # same  
Other       
and Address .....



FILL IN AND SIGN WITH INK

APPLICATION FOR PERMIT FOR HEATING, COOKING OR POWER EQUIPMENT

Portland, Maine, Dec. 26, 1985

PERMIT ISSUED

DEC 31 1985

City Of Portland

To the INSPECTOR OF BUILDINGS, PORTLAND, ME.

The undersigned hereby applies for a permit to install the following heating, cooking or power equipment in accordance with the Laws of Maine, the Building Code of the City of Portland, and the following specifications:

Location 87-D-10 Wiley St. Pks Isl. Use of Building dwelling - 1 No Stories 12 New Building Existing " X
Name and address of owner of appliance Helen Vita - 1915 Mill Rd. So. Pasadena, Calif
Installer's name and address Charles LeRoche - Upper A St. Pks Isl Telephone 766-2533

General Description of Work

To install replacement - ~~fire~~ floor furnace - oil - warm air

IF HEATER, OR POWER BOILER

Location of appliance basement Any burnable material in floor surface or beneath? no
If so, how protected? Kind of fuel? #2 fuel oil
Minimum distance to burnable material, from top of appliance or casing top of furnace 5' all around
From top of smoke pipe From front of appliance From sides or back of appliance
Size of chimney flue 8" x 8 Other connections to same flue none
If gas fired, how vented? Rated maximum demand per hour
Will sufficient fresh air be supplied to the appliance to insure proper and safe combustion yes

IF OIL BURNER

Name and type of burner Heil - guni Labelled by underwriters' laboratories? yes
Will operator be always in attendance? no Does oil supply line feed from top or bottom of tank?
Type of floor beneath burner dirt Size of vent pipe 1 1/2"
Location of oil storage basement Number and capacity of tanks 1-275 gal.
Low water shut off N/A Make No.
Will all tanks be more than five feet from any flame? none How many tanks enclosed?
Total capacity of any existing storage tanks for furnace burners 1-275 gal.

IF COOKING APPLIANCE

Location of appliance Any burnable material in floor surface or beneath?
If so, how protected? Height of Legs, if any
Skirting at bottom of appliance? Distance to combustible material from top of appliance?
From front of appliance From sides and back From top of smokepipe
Size of chimney flue Other connections to same flue
Is hood to be provided? If so, how vented? Forced or gravity?
If gas fired, how vented? Rated maximum demand per hour

MISCELLANEOUS EQUIPMENT OR SPECIAL INFORMATION

[Empty space for miscellaneous information]

Amount of fee enclosed? 25.00

APPROVED: [Signature line]

Will there be in charge of the above work a person competent to see that the State and City requirements pertaining thereto are observed?

CS 306

INSPECTION

FILE

APPLICANT'S

ASSESSOR'S COPY

Signature of Installer Charles LeRoche

[Handwritten signature]

# 02891

001491

FILL IN AND SIGN WITH INK

PERMIT ISSUED



APPLICATION FOR PERMIT FOR HEATING, COOKING OR POWER EQUIPMENT

DEC 31 1985

Portland, Maine, Dec. 26, 1985

City Of Portland

To the INSPECTOR OF BUILDINGS, PORTLAND, ME.

The undersigned hereby applies for a permit to install the following heating, cooking or power equipment in accordance with the Laws of Maine, the Building Code of the City of Portland, and the following specifications:

Location 87-D-10 Wiley St., Pkcs. Isl. Use of Building dwelling - 1 No. Stories 1 New Building Existing " X
Name and address of owner of appliance Helen V. Ca - 1915 Mill Rd. So. Pasadena, Calif
Installer's name and address Charles DeRoche - Upper A St. Pkcs Isl Telephone 766-1533

General Description of Work

To install replacement - ~~discontinue~~ floor furnace - oil - warm air

IF HEATER, OR POWER BOILER

Location of appliance basement Any burnable material in floor surface or beneath? no
If so, how protected? Kind of fuel? # 2 fuel oil
Minimum distance to burnable material, from top of appliance or casing top of furnace 5' all-around
Front top of smoke pipe From front of appliance From sides or back of appliance
Size of chimney flue 8x8 Other connections to same flue
If gas fired, how vented?
Will sufficient fresh air be supplied to the appliance to insure proper and safe combustion? yes

IF OIL BURNER

Name and type of burner Heil gun Labelled by underwriters' laboratories? yes
Will operator be always in attendance? no Does oil supply line feed from top or bottom of tank?
Type of floor beneath burner dirt Size of vent pipe 1 1/2"
Location of oil storage basement Number and capacity of tanks 1-275 gal.
Low water shut off N/A Make
Will all tanks be more than five feet from any flame? none How many tanks enclosed?
Total capacity of any existing storage tanks for furnace burners 1-275 gal.

IF COOKING APPLIANCE

Location of appliance Any burnable material in floor surface or beneath?
if so, how protected? Height of legs, if any
Skirting at bottom of appliance? Distance to combustible material from top of appliance?
From front of appliance From sides and back From top of smokepipe
Size of chimney flue Other connections to same flue
Is hood to be provided? If so, how vented? Forced or gravity?
If gas fired, how vented? Rated maximum demand per hour

MISCELLANEOUS EQUIPMENT OR SPECIAL INFORMATION

Amount of fec. enclosed? 25.00

APPROVED:

Will there be in charge of the above work a person competent to see that the State and City requirements pertaining thereto are observed?

INSPECTION FILE APPLICANT'S ASSESSOR'S COPY

Signature of Installer Charles DeRoche

# 02891

Handwritten signature/initials

NOTES

2-26-85 - Complete OK. *aa*

Permit No. 85/1191  
 Location SPD-10, Midway Rd, Chicago  
 Owner John J. ...  
 Date of permit 12-21-85  
 Approved 12-31-85

19. Thermal Control switch	
18. Snorkels to combustible	
17. Oil locks ventilation	
16. Instruction Card	
15. Oil gauge	
14. Tank H. Tank & support	
13. Capacity of tanks	
12. Valves to supply line	
11. Piping support & protection	
10. High limit Control	
9. Low Water Control	
8. Main Cutoff Switch	
7. High limit Control	
6. Remote Control	
5. Name & Label	
4. Burner in tank & support	
3. Kind of fuel	
2. 1/2" vent pipe	
1. 1/2" fill pipe	

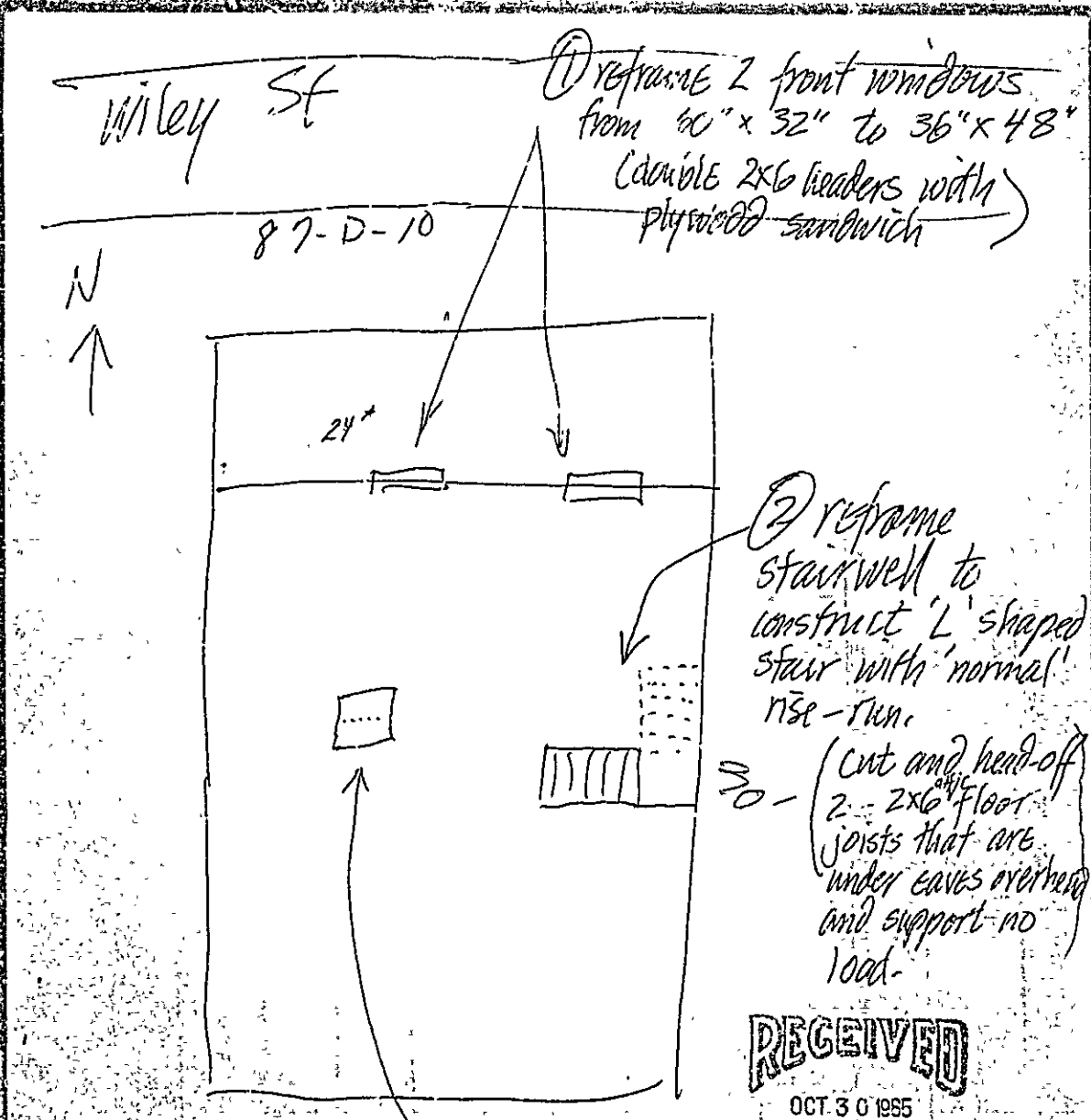

① reframe 2 front windows from 60" x 32" to 36" x 48" (double 2x6 headers with plywood sandwich)

② reframe stairwell to construct 'L' shaped stair with 'normal' rise-run.

30 - (cut and head-off 2 - 2x6 floor joists that are under eaves overhang and support no load.)

**RECEIVED**

OCT 30 1955

DEPT. OF BUILDING INSPECTIONS  
CITY OF PORTLAND

③ frame opening for floor furnace. (cut and head off one 2x4 floor joist. Support area with beams in cellar.)

36x36"

Helen Vita  
Wiley St  
Peaks Is.

APPLICATION FOR PERMIT

001252

PERMIT ISSUED

B.O.C.A. USE GROUP .....

B.O.C.A. TYPE OF CONSTRUCTION .....

ZONING LOCATION ..... PORTLAND, MAINE Oct. 30, 1985

001 30 1985

To the CHIEF OF BUILDING & INSPECTION SERVICES, PORTLAND, MAINE

City Of Portland

The undersigned hereby applies for a permit to erect, alter, repair, demolish, move or install the following building, structure, equipment or change use in accordance with the Laws of the State of Maine, the Portland B.O.C.A. Building Code and Zoning Ordinance of the City of Portland with plans and specifications, if any, submitted herewith and the following specifications:

LOCATION ... 87-D-10 Wiley St. Peaks Island ..... Fire District #1 , #2

1. Owner's name and address ... Helen Vita - 1915 Mill Rd. So. .... Telephone .....

2. Lessee's name and address ..... Pasadena Cal. Telephone .....

3. Contractor's name and address ... Sam Powers - Peaks Island ..... Telephone ... 766-3320

Proposed use of building ... dwelling ..... No. of sheets ..... No. families ... 1

Last use ... same ..... No. families .....

Material ..... No. stories ..... Heat ..... Style of roof ..... Roofing .....

Other buildings on same lot .....

Estimated contractual cost \$ ... 1,000 ...

FIELD INSPECTOR—Mr. .... Appeal Fees \$ .....

@ 775-5451

Base Fee ..... 25.00 .....

Late Fee .....

TOTAL \$ .....

To reframe two front windows, reframe stair well to construct ell shaped stairs and frame opening in floor for floor furnace as per plans. 1 sheet of plans.

Stamp of Special Conditions

send permit to # 3 04108 - Luther Street

NOTE TO APPLICANT: Separate permits are required by the installers and subcontractors of heating, plumbing, electrical and mechanicals.

DETAILS OF NEW WORK

Is any plumbing involved in this work? ... NO ..... is any electrical work involved in this work? ... NO .....

Is connection to be made to public sewer? ..... If not, what is proposed for sewage? .....

Has septic tank notice been sent? ..... Form notice sent? .....

Height average grade to top of plate ..... Height average grade to highest point of roof .....

Size, front ..... depth ..... No. stories ..... solid or filled land? ..... earth or rock? .....

Material of foundation ..... thickness, top ..... bottom ..... cellar .....

Kind of roof ..... Rise per foot ..... Roof covering .....

No. of chimneys ..... Material of chimneys ..... of lining ..... Kind of heat ..... fuel .....

Framing Lumber—Kind ..... Dressed or full size? ..... Corner posts ..... Sills .....

Size Girder ..... Columns under girders ..... Size ..... Max. on centers .....

Studs (outside walls and carrying partitions) 2x4-16" O. C Bridging in every floor and flat roof span over 8 feet.

Joists and rafters: 1st floor ..... 2nd ..... 3rd ..... roof .....

On centers: 1st floor ..... 2nd ..... 3rd ..... roof .....

Maximum span: 1st floor ..... 2nd ..... 3rd ..... roof .....

if one story building with masonry walls, thickness of walls? ..... height? .....

IF A GARAGE

No. cars now accommodated on same lot ..... to be accommodated ..... number commercial cars to be accommodated .....

Will automobile repairing be done other than minor repairs to cars habitually stored in the proposed building? .....

APPROVALS BY: ..... DATE ..... MISCELLANEOUS

BUILDING INSPECTION—PLAN EXAMINER ..... Will work require disturbing of any tree on a public street? ... NO

ZONING ..... Will there be in charge of the above work a person competent

BUILDING CODE: ..... to see that the State and City requirements pertaining thereto

Fire Dept. .... are observed? .....

Health Dept. ....

Others: .....

Signature of Applicant Samuel L. Powers Phone # same

Type Name of above Sam Powers for ..... -1  2  3  4

Helen Vita Other ..... and Address .....

FIELD INSPECTOR'S COPY APPLICANT'S COPY OFFICE FILE COPY

MA, Add to

NOTES

12-6-85-W18/OK. Needs  
fumice permit. All  
2-25-86 - Complete OK  
as per plan. AQ

Permit No. 1252/85-

Location 82-D-10 W. Leg St. P.I.

Owner V.T.A.

Date of permit OCT. 30/85

Approved OCT 30/85

Dwelling

Garage

Alteration

~~Large section of the page is crossed out with a large X.~~