

SUBSURFACE WASTEWATER DISPOSAL SYSTEM APPLICATION

Department of Human Services
Division of Health Engineering
(207) 289-3826

PROPERTY ADDRESS

Town Or Plantation: **PORTLAND PEAKS ISLAND**

Street: **PLEASANT AVENUE**

Subdivision Lot #: **TAX MAP 87 BLOCK C LOT 2,4**

PROPERTY OWNERS NAME

KOUSHAN JOHN P

Last: **JOHN P. KOUSHAN**
First: **JOHN P. KOUSHAN**

Mailing Address of Owner/Applicant (If Different): **PLEASANT AVENUE PEAKS ISLAND MAINE 04108**

PORTLAND PERMIT # 1,871 TOWN COPY

Date Permit Issued: **5/21/86**

Local Plumbing Inspector Signature: *[Signature]*

FEE: \$ **140**

L.P.I. # _____

Owner/Applicant Statement

I certify that the information submitted is correct to the best of my knowledge and understand that any falsification is a violation of the Local Plumbing Inspector's Code of Ethics.

Signature of Owner/Applicant: *[Signature]* Date: **5/21/86**

Caution: Inspection Required

I have inspected the installation authorized above and found it to be in compliance with the Subsurface Wastewater Disposal Rules.

Local Plumbing Inspector Signature: _____ Date Approved: **AUG 14 1986**

PERMIT INFORMATION

THIS APPLICATION IS FOR:

- NEW SYSTEM
- REPLACEMENT SYSTEM
- EXPANDED SYSTEM
- SEASONAL CONVERSION
- EXPERIMENTAL SYSTEM

THIS APPLICATION REQUIRES:

- NO RULE VARIANCE REQUIRED
- NEW SYSTEM VARIANCE (Attach New System Variance Form)
- REPLACEMENT SYSTEM VARIANCE (Attach Replacement System Variance Form)
- Requires only Local Plumbing Inspector Approval
- Requires both State and Local Plumbing Inspector Approval

INSTALLATION IS COMPLETE SYSTEM:

- NON-ENGINEERED SYSTEM
- PRIMITIVE SYSTEM (Includes Alternative Toilet)
- ENGINEERED (+2000 gpd)

INDIVIDUALLY INSTALLED COMPONENTS:

- TREATMENT TANK (ONLY)
- HOLDING TANK
- ALTERNATIVE TOILET (ONLY)
- NON ENGINEERED DISPOSAL AREA (ONLY)
- ENGINEERED DISPOSAL AREA (ONLY)
- SEPARATED LAUNDRY SYSTEM

IF REPLACEMENT SYSTEM:

YEAR FAILING SYSTEM: _____

THE FAILING SYSTEM IS:

- BED
- CHAMBER
- TRENCH
- OTHER: **CESSPOOL**

DISPOSAL SYSTEM TO SERVE:

- SINGLE FAMILY DWELLING
- MODULAR OR MOBILE HOME
- MULTIPLE FAMILY DWELLING
- OTHER: _____ SPECIFY _____

SIZE OF PROPERTY: **6650 SF** ZONING: **IR2**

TYPE OF WATER SUPPLY: PUBLIC WATER

DESIGN DETAILS (SYSTEM LAYOUT SHOWN ON PAGE 3)

TREATMENT TANK:

- SEPTIC: Regular Low Profile
- AERODIC

SIZE: **1000** GALS.

WATER CONSERVATION:

- NONE
- LOW VOLUME TOILET
- SEPARATED LAUNDRY SYSTEM
- ALTERNATIVE TOILET

SPECIFY: _____

PUMPING:

- NOT REQUIRED
- MAY BE REQUIRED (DEPENDS ON TREATMENT TANK LOCATION AND ELEVATION)
- REQUIRED

DOSE: _____ GALS.

CRITERIA USED FOR DESIGN FLOW (BEDROOMS, SEATING, EMPLOYEES, WATER RECORDS, ETC.): **3 BEDROOM CONSERVATIVE**

SOIL CONDITIONS USED FOR DESIGN PURPOSES:

PROFILE: **6** CONDITION: **B**

DEPTH TO LIMITING FACTOR: **48**

SIZE RATINGS USED FOR DESIGN PURPOSES:

- SMALL
- MEDIUM
- MEDIUM LARGE
- LARGE
- EXTRALARGE

DISPOSAL AREA TYPE/SIZE:

- BED: **600** Sq Ft
- CHAMBER: _____ Sq Ft
- REGULAR H-20
- TRENCH: _____ Linear Ft
- OTHER: _____

DESIGN FLOW: **450** (GALLONS/DAY)

SITE EVALUATOR STATEMENT

On **July 30, 1981** (date) I conducted a site evaluation for this project and certify that the data reported is accurate. The system I propose is in accordance with the Subsurface Wastewater Disposal Rules.

Site Evaluator or Professional Engineer's Signature: *[Signature]* License # **0002/4814** Date: **5/20/86**

Local Plumbing Inspector Signature: _____ Date Approved: _____

Page 1 of 3
HHE-200 Rev. 4-83

Town, City, Plantation PORTLAND PEAKS ISLAND	Street, Road, Subdivision PLEASANT AVE 87-C-2,4	Owners Name JOHN P KOUGHAN
SITE PLAN		Scale 1" = 50 FL

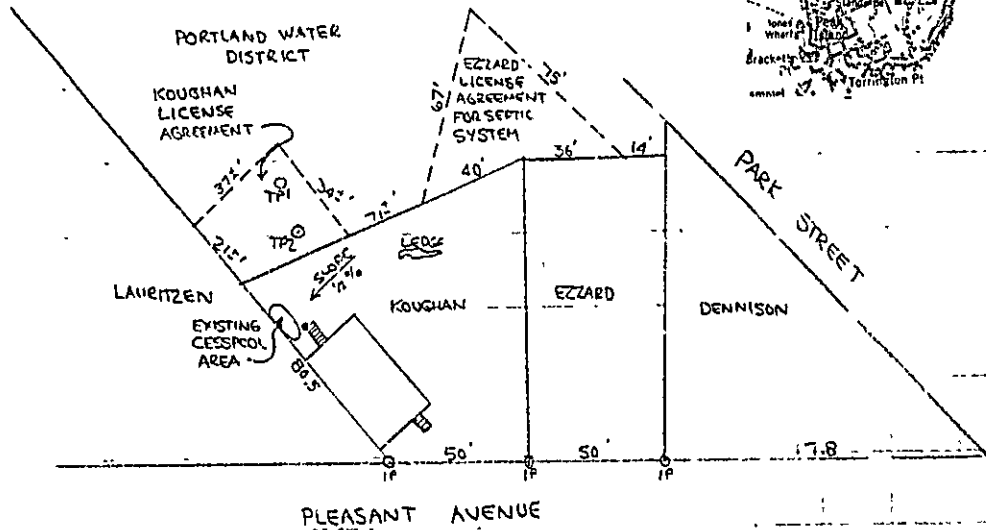
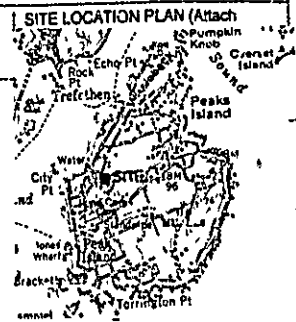

SOIL DESCRIPTION AND CLASSIFICATION (Location of Observation Holes Shown Above)				
Observation Hole <u>2</u>	<input checked="" type="checkbox"/> Test Pit	<input type="checkbox"/> Boring	Depth of Organic Horizon Above Mineral Soil	
Texture	Consistency	Color	Mottling	
GRAVELLY LOAM		DARK BROWN		
VERY STONY GRAVEL	LOOSE	RED YELLOW	NONE	
STRATIFIED SANDS AND GRAVEL			FEW	
Soil	Classification	Slope	Limiting Factor	<input checked="" type="checkbox"/> Ground Water <input type="checkbox"/> Rooting Layer <input type="checkbox"/> Bedrock
G	B	1/2 %	48	

SOIL DESCRIPTION AND CLASSIFICATION (Location of Observation Holes Shown Above)				
Observation Hole <u>2</u>	<input checked="" type="checkbox"/> Test Pit	<input type="checkbox"/> Boring	Depth of Organic Horizon Above Mineral Soil	
Texture	Consistency	Color	Mottling	
GRAVELLY LOAM		DARK BROWN		
VERY STONY GRAVEL	LOOSE	RED YELLOW	NONE	
STRATIFIED SANDS AND GRAVEL			FEW	
Soil	Classification	Slope	Limiting Factor	<input checked="" type="checkbox"/> Ground Water <input type="checkbox"/> Rooting Layer <input type="checkbox"/> Bedrock
G	B	1/2 %	48	

William B. Goodwin 003/4814 5/20/86 Page 2 of 3
 Site Evaluator or Professional Engineer's Signature SE# 11CA Date HHVS-200 Rev. 3/83

SUBSURFACE WASTEWATER DISPOSAL SYSTEM APPLICATION

Department of Human Services
Division of Health Engineering

Town, City, Planation	Street, Road, Subdivision	Owners Name
PORTLAND PEAKS ISLAND	PLEASANT AVE 87-C-2,4	JOHN P. KOUGHAN
SUBSURFACE WASTEWATER DISPOSAL PLAN		Scale 1" = 20' FL.

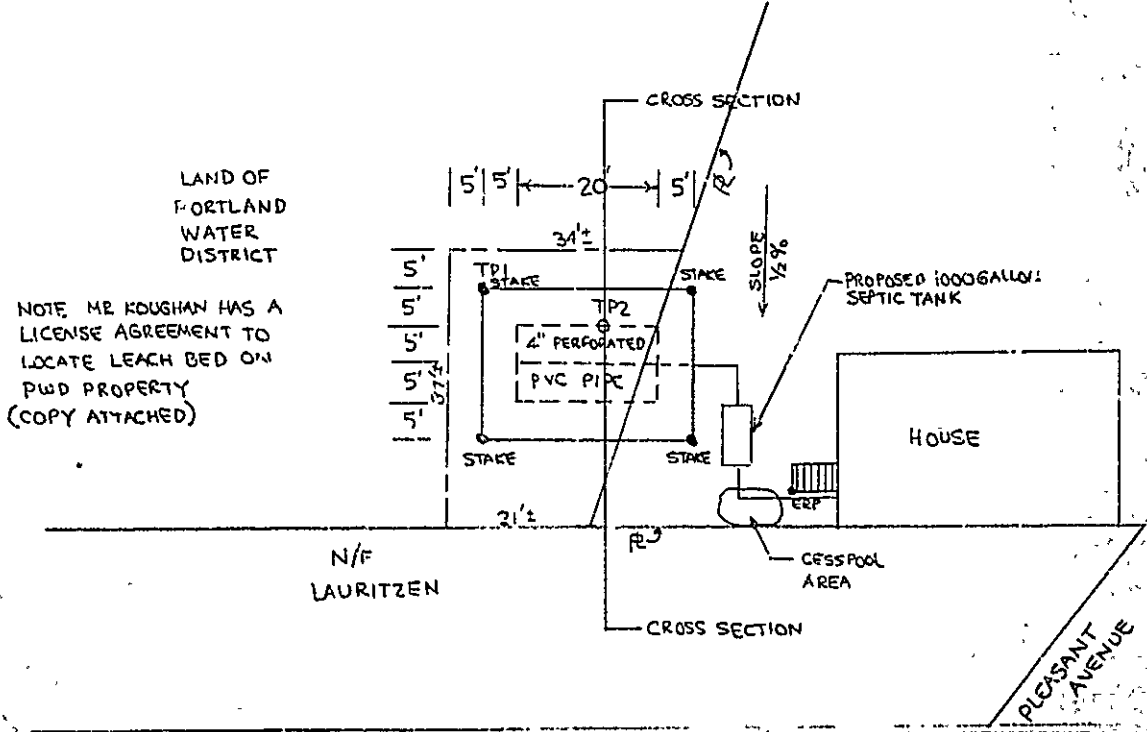

FILL REQUIREMENTS		CONSTRUCTION ELEVATIONS		ELEVATION REFERENCE POINT LOCATION & DESCRIPTION
Depth of Fill (Upslope)	0"	Reference Elevation Is	50.00	NORTHWEST CORNER OF BOTTOM CONCRETE STEP AT BACK DOOR
Depth of Fill (Downslope)	0"	Bottom of Disposal Area	47.40	
		Top of Distribution Lines or Chambers	48.18	
DISPOSAL AREA CROSS SECTION			Scale:	
			Vertical: 1 inch = 5' FL.	
			Horizontal: 1 inch = 20' FL.	

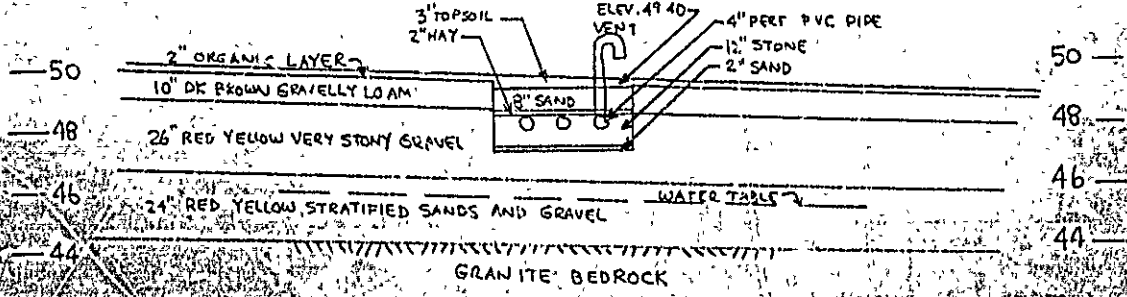

John P. Koughan
 Site Evaluator or Professional Engineer's Signature

0003/4814
 SE #/PE #

5/20/86
 Date

Page 3 of 3
 HHE-200 Rev. 4/83

LICENSE

87-C-314
Pleasant Ave.

KNOW ALL MEN BY THESE PRESENTS, that Portland Water District, a quasi-municipal corporation organized under the laws of the State of Maine and located at Portland, County of Cumberland and State of Maine, in consideration of the sum of twenty dollars, paid annually on the first day of November, and other valuable considerations paid by John P. Koughan, of Rio Rancho, New Mexico, the receipt whereof is hereby acknowledged, does hereby grant, sell, and convey unto the said John P. Koughan, his heirs and assigns, to construct, erect, rebuild, repair, operate, maintain and remove a subsurface waste disposal system, together with the necessary appurtenances connected thereto, over, along and across premises owned by the Licensor on Peak's Island in the City of Portland, in the County of Cumberland and State of Maine, said premises being described as follows:

Beginning at a stone on the division line between land of the Licensor and land now or formerly of Lauritzen, said stone being eighty and fifty hundredths (80.50) feet as measured along the dividing line between land of Koughan and land now or formerly of Lauritzen southeasterly from an iron pipe on the southerly sideline of Pleasant Avenue; thence southeasterly along said dividing line between land of the Licensor and land of Lauritzen twenty-three and no hundredths (23.00) feet to a point; thence southwesterly at a right angle to the previously described line a distance of forty and no hundredths (40.00) feet to a point; thence northwesterly at a right angle to the previously described line a distance of thirty-five and no hundredths (35.00) feet, more or less, to a point on the dividing line between land of the Licensor and land of Koughan; thence northeasterly along said dividing line forty-two (42) feet, more or less, to the point of beginning.

Described premises being a portion of the property formerly owned by Casco Bay Water and Light Company; and conveyed to the Licensor by deed dated December 1932, and recorded in Cumberland County Registry of Deeds in Book 1288, Page 322.

By acceptance of the License, the Licensee agrees that if a public sewer system becomes available into which the Licensee may connect into at reasonable cost, they will do so. In addition, if the Licensee, their heirs or assigns, sell the property, the Licensor, its successors or assigns shall have the right to revoke the License upon thirty (30) days notice in writing.

IN WITNESS WHEREOF, the said Portland Water District has caused this instrument to be signed by Joseph B. Taylor, its General Manager, and sealed with its corporate seal this 2nd day of October, 1981.

Signed, Sealed and Delivered
in the presence of

PORTLAND WATER DISTRICT

Norman N. Juddel

By Joseph B. Taylor
its General Manager

STATE OF MAINE
COUNTY OF CUMBERLAND

October 2, 1981

Personally appeared the above named Joseph B. Taylor, General Manager of said Portland Water District and acknowledged the foregoing instrument to be his free act and deed of said Portland Water District.

Before me,

Donald E. Kilgus
Notary Public
My commission expires
6/9/82

Recorded at the Cumberland County
Registry of Deeds on 10/5/81
in Book 4864 Page 147



APPLICATION FOR PERMIT
 DEPARTMENT OF BUILDING INSPECTIONS SERVICES
 ELECTRICAL INSTALLATIONS

Date October 15, 1991, 1P
 Receipt and Permi number 7362

To the CHIEF ELECTRICAL INSPECTOR, Portland, Maine:

The undersigned hereby applies for a permit to make electrical installations in accordance with the laws of Maine, the Portland Electrical Ordinance, the National Electrical Code and the following specifications:

LOCATION OF WORK: Pleasant Ave Peaks Island 87-C-4
 OWNER'S NAME: Martha Young ADDRESS: 53 Pleasant Ave

	FEES
OUTLETS:	
Receptacles <u>26</u> Switches <u>5</u> Plugmold _____ ft. TOTAL <u>31</u>	6.20
FIXTURES: (number of)	
Incandescent <u>7</u> Fluorescent _____ (not strip) TOTAL <u>7</u>	1.40
Strip Fluorescent _____ ft.	
SERVICES:	
Overhead _____ Underground _____ Temporary _____ TOTAL amperes _____ ..	
METERS: (number of)	
MOTORS: (number of)	
Fractional	
1 HP or over	
RESIDENTIAL HEATING:	
Oil or Gas (number of units) <u>1</u>	5.00
Electric (number of rooms)	
COMMERCIAL OR INDUSTRIAL HEATING:	
Oil or Gas (by a main boiler)	
Oil or Gas (by separate units)	
Electric Under 20 kws _____ Over 20 kws _____	
APPLIANCES: (number of)	
Ranges _____ Water Heaters _____	
Cook Tops _____ Disposals _____	
Wall Ovens _____ Dishwashers _____	
Dryers _____ Compactors _____	
Fans _____ Others (denote) _____	
TOTAL	
MISCELLANEOUS: (number of)	
Branch Panels <u>1</u>	4.00
Transformers	
Air Conditioners Central Unit	
Separate Units (windows)	
Signs 20 sq. ft. and under	
Over 20 sq. ft.	
Swimming Pools Above Ground	
In Ground	
Fire/Burglar Alarms Residential	
Commercial	
Heavy Duty Outlets, 220 Volt (such as welders) 30 amps and under	
over 30 amps	
Circus, Fairs, etc.	
Alterations to wires	
Repairs after fire	
Emergency Lights, battery	
Emergency Generators	
	INSTALLATION FEE DUE: _____
FOR ADDITIONAL WORK NOT ON ORIGINAL PERMIT	DOUBLE FEE DUE: _____
FOR REMOVAL OF A "STOP ORDER" (304-16.b)	16.60
	TOTAL AMOUNT DUE: _____

INSPECTION:

Will be ready on 10-15-91, 1991; or Will Call _____

CONTRACTOR'S NAME: Hockett's Plumbing Electric

ADDRESS: _____

TEL: 655-7129

MASTER LICENSE NO.: 7362 SIGNATURE OF CONTRACTOR: _____

LIMITED LICENSE NO.: _____

INSPECTOR'S COPY -- WHITE
 OFFICE COPY -- CANARY
 CONTRACTOR'S COPY -- GREEN

*Leave car 79, Turn Left, continue past school then Bare Left
 Go about 16 houses on the Right, its yellow with white fence all the
 way around it.*

PLUMBING APPLICATION

Department of Human Services
Division of Health Engineering
(207) 289-3326

PROPERTY ADDRESS
Town or Plantation: Poole Island
Siret Subdivision Lot: 54 Pleasant St 87-C-4

PROPERTY OWNERS NAME
First: Mia Tha
Last: Downs J Cole

Mailing Address of Owner/Applicant (if different): RR Box 461 Raymond Me

PERMIT # 4441 STATE COPY
Date Permitted: 10/24/92
FEE: \$1172.41
L.P.E. # 01241

Chief Plumbing Inspector
[Signature]

Owner/Applicant Statement
I certify that the information submitted is correct to the best of my knowledge and understand that any falsification is reason for the Local Plumbing Inspector to deny a Permit.
[Signature]
Signature of Owner/Applicant Date: 10/24/92

Caution: Inspection Required
I have inspected the installation authorized above and found it to be in compliance with the State Plumbing Rules.
[Signature]
Local Inspector Signature Date: 7/28/92

PERMIT INFORMATION

This Application is for:

- 1. NEW PLUMBING
- 2. RELOCATED PLUMBING

Type Of Structure To Be Served:

- 1. SINGLE FAMILY DWELLING
- 2. MODULAR OR MOBILE HOME
- 3. MULTIPLE FAMILY DWELLING
- 4. OTHER - SPECIFY _____

Plumbing To Be Installed By:

- 1. MASTER PLUMBER
- 2. OIL BURNERMAN
- 3. MFG'D. HOUSING DEALER/MECHANIC
- 4. PUBLIC UTILITY EMPLOYEE
- 5. PROPERTY OWNER

LICENSE # 1-7829

Hook-Up & Piping Relocation Maximum of 1 Hook-Up	Number	Column 2 Type of Fixture		Number	Column 1 Type of Fixture	
HOOK-UP: to public sewer in those cases where the connection is not regulated and inspected by the local Sanitary District OR HOOK-UP: to an existing subsurface wastewater disposal system.		1	to sabibb / Silcock		1	Bathtub (and Shower)
			Floor Drain			Shower (Separate)
			Urinal		2	Sink
			Drinking Fountain			Wash Basin
			Indirect Waste		1	Water Closet (Toilet)
			Water Treatment Container, Filter, etc.			Clothes Washer
			Grease/Oil Separator			Dish Washer
			Defunct Cistern			Garbage Disposal
			Bidet			Laundry Tub
			Other:			Water Heater
Number of Hook-Ups & Relocations		Fixtures (Subtotal) Column 2		4	Fixtures (Subtotal) Column 1	
Hook-Up & Relocation Fee				4	Fixtures (Subtotal) Column 2	

SEE PERMIT FEE SCHEDULE FOR CALCULATING FEE

STATE COPY