

PERMIT # **001033**

CITY OF Portland

**BUILDING PERMIT APPLICATION**

MAP #

LOT #

*89-A-2 88-I-20*

Please fill out any part which applies to job. Proper plans must accompany form.

Owner: Charles and Anne Murphy *766-2195*

Address: Pleasant Avenue, Peaks Island

LOCATION OF CONSTRUCTION: Pleasant Avenue, Peaks Island

CONTRACTOR: owner SUBCONTRACTORS: 766-2195

ADDRESS: \_\_\_\_\_

Est. Construction Cost: 12,500 Type of Use: Residential

Building Dimensions: 12 x 12 w 12 Sq. Ft. # Stories: 1 Lot Size: \_\_\_\_\_

Is Proposed Use: Seasonal Condominium Apartment

Conversion - Exp. To construct an addition as per plans.

**COMPLETE ONLY IF THE NUMBER OF UNITS WILL CHANGE**

Residential Buildings Only: # Of Dwelling Units: \_\_\_\_\_ # Of New Dwelling Units: \_\_\_\_\_

Foundation:  
 1. Type of Soil: \_\_\_\_\_ Side(s) \_\_\_\_\_  
 2. Set Backs - Front \_\_\_\_\_ Rear \_\_\_\_\_  
 3. Footings Size: \_\_\_\_\_  
 4. Foundation Size: \_\_\_\_\_  
 b. Other \_\_\_\_\_

Floors:  
 1. Sills Size: \_\_\_\_\_ Sills must be anchored.  
 2. Girder Size: \_\_\_\_\_ Size: \_\_\_\_\_  
 3. Lally Column Spacing: \_\_\_\_\_ Spacing 16" O.C.  
 4. Joists Size: \_\_\_\_\_ Size: \_\_\_\_\_  
 5. Bridging Type: \_\_\_\_\_ Size: \_\_\_\_\_  
 6. Floor Sheathing Type: \_\_\_\_\_ Size: \_\_\_\_\_  
 7. Other Material: \_\_\_\_\_

Exterior Walls:  
 1. Sudding Size \_\_\_\_\_ Spacing \_\_\_\_\_  
 2. No. windows \_\_\_\_\_  
 3. No. Doors \_\_\_\_\_ Span(s) \_\_\_\_\_  
 4. Header Sizes \_\_\_\_\_  
 5. Bracing Yes \_\_\_\_\_ No \_\_\_\_\_  
 6. Corner Posts Size \_\_\_\_\_ Size \_\_\_\_\_  
 7. Insulation Type \_\_\_\_\_ Size \_\_\_\_\_  
 8. Sheathing Type \_\_\_\_\_ Size \_\_\_\_\_  
 9. Siding Type \_\_\_\_\_ Weather Exposure \_\_\_\_\_  
 10. Masonry Materials \_\_\_\_\_  
 11. Metal Materials \_\_\_\_\_

Interior Walls:  
 1. Sudding Size \_\_\_\_\_ Spacing \_\_\_\_\_  
 2. Header Sizes \_\_\_\_\_ Span(s) \_\_\_\_\_  
 3. Wall Covering Type \_\_\_\_\_  
 4. Fire Wall if required \_\_\_\_\_  
 6. Other Materials \_\_\_\_\_

3aei III .2VA

White-Tax Assessor

Yellow-GPCOG

White Tag - GEC

© Copyright GPCOG 1987

**For Official Use Only**

Revisions: Yes / No \_\_\_\_\_

Date: Aug. 11, 1988

Name: \_\_\_\_\_

Inside Fire Limit: \_\_\_\_\_

Lot: \_\_\_\_\_

Block: \_\_\_\_\_

Plot Code: \_\_\_\_\_

Permit Expiration: \_\_\_\_\_

Time Limit: 12,000

Ownership: \_\_\_\_\_

Estimated Cost: \_\_\_\_\_

Value/Structure: \_\_\_\_\_

Fee: 80.00

Ceiling:  
 1. Ceiling Joists Size: \_\_\_\_\_ Spacing \_\_\_\_\_  
 2. Ceiling Strapping Size \_\_\_\_\_  
 3. Type Ceiling: \_\_\_\_\_  
 4. Insulation Type: \_\_\_\_\_  
 5. Ceiling Height: \_\_\_\_\_

Roof:  
 1. Truss or Rafter Size \_\_\_\_\_ Span AUG 18 1988  
 2. Sheathing Type \_\_\_\_\_ Size \_\_\_\_\_  
 3. Roof Covering Type: \_\_\_\_\_ CITY OF PORTLAND  
 4. Other \_\_\_\_\_

Chimneys:  
 Type: \_\_\_\_\_ Number of Fire Places: \_\_\_\_\_

Heating:  
 Type of Heat: \_\_\_\_\_

Electrical:  
 Service Entrance Size: \_\_\_\_\_ Smoke Detector Required Yes \_\_\_\_\_ No \_\_\_\_\_

Plumbing:  
 1. Approval of soil test if required 00.25 Yes \_\_\_\_\_ No \_\_\_\_\_  
 2. No. of Tubs or Showers \_\_\_\_\_  
 3. No. of Flushes \_\_\_\_\_  
 4. No. of Lavatories \_\_\_\_\_  
 5. No. of Other Fixtures: 00.22

Swimming Pools:  
 1. Type: \_\_\_\_\_ Square Footage \_\_\_\_\_  
 2. Pool Size: \_\_\_\_\_  
 3. Must conform to National Electrical Code and State Law.

Zoning:  
 District: IR-1 Street Frontage Req: \_\_\_\_\_ Provided \_\_\_\_\_  
 Required Setbacks: Front \_\_\_\_\_ Back \_\_\_\_\_ Side \_\_\_\_\_

Review Required: \_\_\_\_\_  
 Zoning Board Approval: Yes \_\_\_\_\_ No \_\_\_\_\_ Date: \_\_\_\_\_  
 Planning Board Approval: Yes \_\_\_\_\_ No \_\_\_\_\_ Date: \_\_\_\_\_  
 Conditional Use: \_\_\_\_\_ Variance: \_\_\_\_\_ Site Plan: \_\_\_\_\_ Subdivision: \_\_\_\_\_  
 Show and Floodplain Mgmt. \_\_\_\_\_ Special Exception: \_\_\_\_\_  
 Other: (Explain) \_\_\_\_\_  
 Date Approved: Aug 11 1988

Permit Received by: Lisa Cushman

Signature of Applicant: [Signature] Date: Aug. 11, 1988

Signature of C/O: \_\_\_\_\_ Date: \_\_\_\_\_

Inspection Dates: \_\_\_\_\_

PLOT PLAN

N



FEES (Breakdown From Front)

Base Fee \$ 25.00  
 Subdivision Fee \$ \_\_\_\_\_  
 Site Plan Review Fee \$ \_\_\_\_\_  
 Other Fees \$ 55.00  
 (Explain) \_\_\_\_\_  
 Late Fee \$ \_\_\_\_\_

Inspection Record

Type	Date
_____	____/____/____
_____	____/____/____
_____	____/____/____
_____	____/____/____

COMMENTS 5-19-89 - Review, OK. general work. OK. AQ  
 12-11-89 - OK. AQ

Signature of Applicant

*Charles Murphy*

Date

Aug. 11, 1988

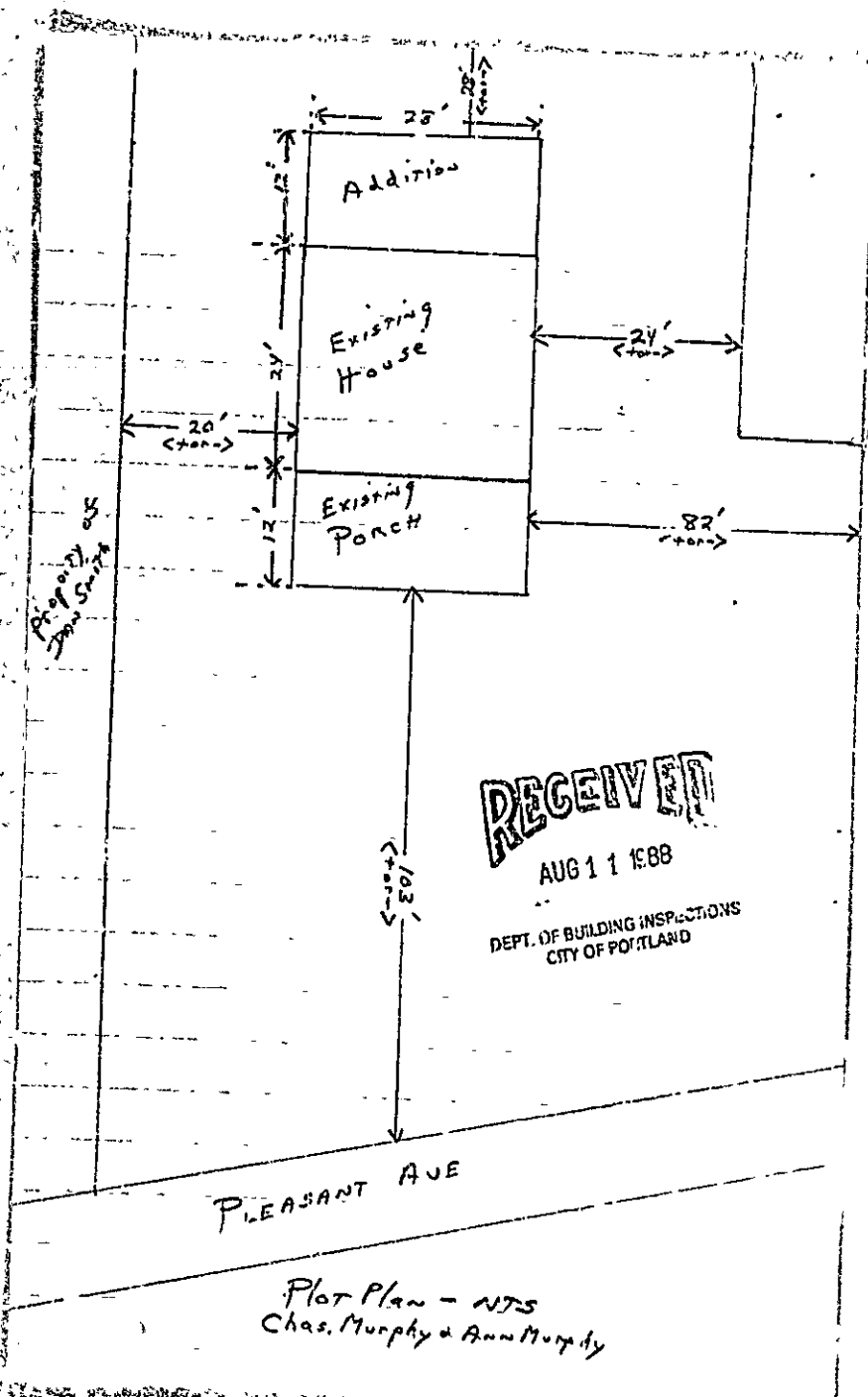

**RECEIVED**

AUG 11 1988

DEPT. OF BUILDING INSPECTIONS  
CITY OF PORTLAND

PLEASANT AVE

Plot Plan - NTS  
Chas. Murphy & Ann Murphy

Lot size!  
14,185  
5396  
19,500 sq ft

CITY OF PORTLAND, MAINE  
389 CONGRESS STREET  
PORTLAND, MAINE 04101



DEPARTMENT OF PLANNING & URBAN DEVELOPMENT

P. SAMUEL HOFFSES, CHIEF  
INSPECTION SERVICES DIVISION

CBK!  
Pleasant Avenue  
Peaks Island  
87-A 2  
88-I-20

August 12, 1988

Mr. and Mrs. Charles Murphy  
Pleasant Avenue  
Peaks Island, Maine 04108

See June Murphy  
(mother)

Dear Mr. and Mrs. Murphy:

This is in further reference to your application for a building permit for an addition to your residence on Pleasant Avenue, Peaks Island. There is no record in the City Assessor's Office of your property on Pleasant Avenue Peaks Island.

Before we can issue a building permit we must have a more definite address for your land and building, such as the size of the lot, for example. We can not determine from your sketch or plot plan as how large your lot is, how wide and how deep. We must have accurate details before we can proceed to process your building permit.

There is no record in the Assessor's Office that you own any property on Peaks Island. It is believed that this may have been a recent new deed which you have for the property. Please advise the more precise location.

Sincerely,

*Warren J. Turner*

Warren J. Turner  
Zoning Enforcement Inspector

cc: Joseph E. Gray, Jr., Director, Planning & Urban Development  
Alexander Jaegerman, Chief Planner  
P. Samuel Hoffses, Chief, Inspection Services  
Arthur Addato, Code Enforcement Officer

This land has been conveyed by June Murphy (mother) to George Murphy and then by George's deed to Charles Murphy just this year (1988).

Back of house

87-A-2  
87-I-20

28 feet wide

RECEIVED

AUG 11 1988

DEPT. OF BUILDING INSPECTIONS  
CITY OF PORTLAND

CB-

let's sign

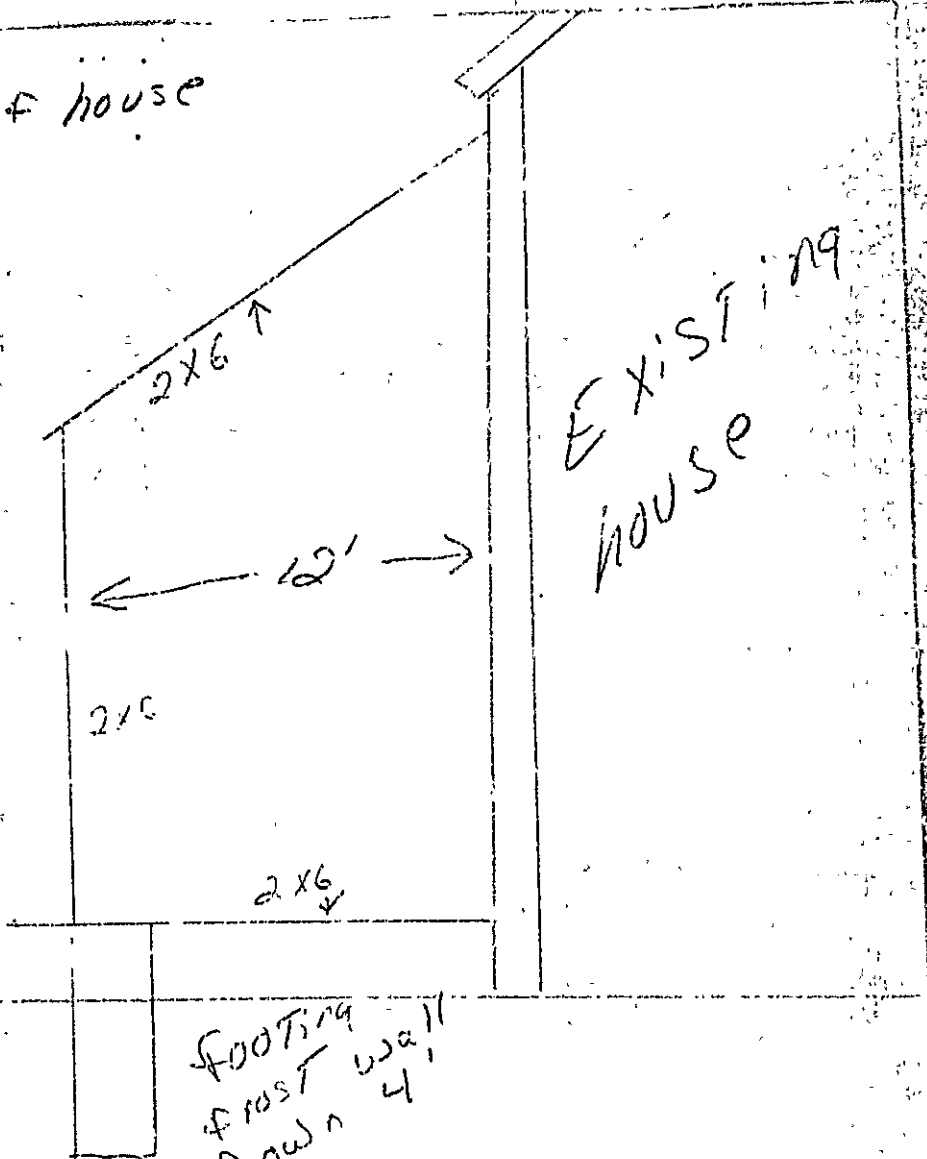



**APPLICATION FOR PERMIT**  
 DEPARTMENT OF BUILDING INSPECTIONS SERVICES  
 ELECTRICAL INSTALLATIONS

Date September 8, 1988

Receipt and Permit number 29544

To the CHIEF ELECTRICAL INSPECTOR, Portland, Maine:

The undersigned hereby applies for a permit to make electrical installations in accordance with the laws of Maine, the Portland Electrical Ordinance, the National Electrical Code and the following specifications:

LOCATION OF WORK: d7A2 and 88-I-20 Pleasant Avenue

OWNER'S NAME: Charles and Ann Murphy ADDRESS: same

OUTLETS:		FEE
Receptacles	Switches	Plugmold
TOTAL		
FIXTURES: (number of)		
Incarescent	Flourescent	(not strip) TOTAL
Strip Flourescent	ft.	
SERVICES:		
Overhead	X	Underground
Temporary		TOTAL amperes
100		3.00
METERS: (number of)		1
MOTORS: (number of)		
Fractional		
1 HP or over		
RESIDENTIAL HEATING:		
Oil or Gas (number of units)		
Electric (number of rooms)		
COMMERCIAL OR INDUSTRIAL HEATING:		
Oil or Gas (by a main boiler)		
Oil or Gas (by separate units)		
Electric Under 20 kws		Over 20 kws
APPLIANCES: (number of)		
Ranges		Water Heaters
Cook Tops		Disposals
Wall Ovens		Dishwashers
Dryers		Compactors
Fans		Others (denote)
TOTAL		
MISCELLANEOUS: (number of)		
Branch Panels		
Transformers		
Air Conditioners Central Unit		
Separate Units (windows)		
Signs 29 sq. ft. and under		
Over 20 sq. ft.		
Swimming Pools Above Ground		
in Ground		
Fire/Burglar Alarms Residential		
Commercial		
Heavy Duty Outlets, 220 Volt (such as welders) 30 amps and under		
over 30 amps		
Circus, Fairs, etc.		
Alterations to wires		
Repairs after fire		
Emergency Lights, battery		
Emergency Generators		

FOR ADDITIONAL WORK NOT ON ORIGINAL PERMIT ..... INSTALLATION FEE DUE:  
 FOR REMOVAL OF A "STOP-ORDER" (304-16.b) ..... DOUBLE FEE DUE.  
 TOTAL AMOUNT DUE: 5.00

INSPECTION:  
 Will be ready on Sept 8, 1988; or Will Call \_\_\_\_\_  
 CONTRACTOR'S NAME: William Flynn  
 ADDRESS: Centennial St., Portland  
 TEL.: 766-2780  
 MASTER LICENSE NO.: 04548 SIGNATURE OF CONTRACTOR  
 LIMITED LICENSE NO.: \_\_\_\_\_





**APPLICATION FOR PERMIT**  
 DEPARTMENT OF BUILDING INSPECTIONS SERVICES  
 ELECTRICAL INSTALLATIONS

Date Aug. 11 19 88  
 Receipt and Permit number 29039

To the CHIEF ELECTRICAL INSPECTOR, Portland, Maine:

The undersigned hereby applies for a permit to make electrical installations in accordance with the laws of Maine, the Portland Electrical Ordinance, the National Electrical Code and the following specifications:

LOCATION OF WORK: Pleasant Ave. Peaks Island 87-A-2  
 OWNER'S NAME: Charles Murphy ADDRESS: same

	FEES
<b>OUTLETS:</b>	
Receptacles _____ Switches _____ Plugmold _____ ft. TOTAL <u>50</u>	3.00
<b>FIXTURES:</b> (number of)	
Incandescent _____ Fluorescent _____ (not strip) TOTAL _____	
Strip Fluorescent _____ ft. _____	
<b>SERVICES:</b>	
Overhead _____ Underground _____ Temporary _____ TOTAL amperes _____	
<b>METERS:</b> (number of) _____	
<b>MOTORS:</b> (number of)	
Fractional _____	
1 HP or over _____	
<b>RESIDENTIAL HEATING:</b>	
Oil or Gas (number of units) _____	
Electric (number of rooms) _____	
<b>COMMERCIAL OR INDUSTRIAL HEATING:</b>	
Oil or Gas (by a main boiler) _____	
Oil or Gas (by separate units) _____	
Electric Under 20 kws _____ Over 20 kws _____	
<b>APPLIANCES:</b> (number of)	
Ranges _____	Water Heaters _____
Cook Tops _____	Disposals _____
Wall Ovens _____	Dishwashers _____
Dryers _____	Compactors _____
Fans _____	Others (denote) _____
<b>TOTAL</b> _____	
<b>MISCELLANEOUS:</b> (number of)	
Branch Panels _____	
Transformers _____	
Air Conditioners Central Unit _____	
Separate Units (windows) _____	
Signs 20 sq. ft. and under _____	
Over 20 sq. ft. _____	
Swimming Pools Above Ground _____	
In Ground _____	
Fire/Burglar Alarms Residential _____	
Commercial _____	
Heavy Duty Outlets, 220 Volt (such as welders) 30 amps and under _____	
over 30 amps _____	
Circus, Fairs, etc. _____	
Alterations to wires <u>2.00</u>	2.00
Repairs after fire _____	
Emergency Lights, battery _____	
Emergency Generators _____	
INSTALLATION DUE: _____	5.00
FOR ADDITIONAL WORK NOT ON ORIGINAL PERMIT ..... DOUBLE FEE DUE: _____	
FOR REMOVAL OF A "STOP ORDER" (304-16.b) _____	
<b>TOTAL AMOUNT DUE:</b> _____	5.00

**INSPECTION:**  
 Will be ready on \_\_\_\_\_, 19\_\_\_\_; or Will Call xxx  
**CONTRACTOR'S NAME:** owner  
**ADDRESS:** \_\_\_\_\_  
**TEL:** 766-2195  
**MASTER LICENSE NO.** \_\_\_\_\_ **SIGNATURE OF CONTRACTOR:** Charles Murphy  
**LIMITED LICENSE NO.:** \_\_\_\_\_



**ELECTRICAL INSTALLATIONS**

Permit Number: 288892

Location: 1011 1/2 St. N. W.

Owner: John L. Murphy

Date of Permit: 8/1/54

Final Inspection: 8/1/54

By Inspector: J. J. Jones

Permit Application Register Page No. 12

INSPECTIONS: Service \_\_\_\_\_ by \_\_\_\_\_

Service called in \_\_\_\_\_

Closing-in \_\_\_\_\_ by \_\_\_\_\_

PROGRESS INSPECTIONS: \_\_\_\_\_

DATE	REMARKS

*John L. Murphy*

PERMIT # 1033

Please fill out any part which applies to job. Proper plans must accompany form.

CITY OF Portland BUILDING PERMIT APPLICATION

Owner: Charles and Anna Murphy

Address: Pleasant Avenue, Peaks Island

CONTRACTOR: owner SUBCONTRACTORS: 766-2195

Estimated Cost: 12,000 Type of Use: Residential

Building Dimensions: ... Is Proposed: ...

COMPLETELY ONLY TO THIS NUMBER OF UNITS WILL CHANGE

Foundation: 1. Type of Soil: 2. Set Backs - Front 3. Footing Size: 4. Foundation Size: 5. Other

Floors: 1. Sills Size 2. Girder Size 3. Lally Column Spacing: 4. Joist Size 5. Bridging Type 6. Plyer Sheathing Type: 7. Other Material:

Exterior Walls: 1. Studding Size 2. No. windows 3. No. Doors 4. Header Size 5. Bracing 6. Corner Posts Size 7. Insulation Type 8. Sheathing Type 9. Siding Type 10. Masonry Materials 11. Metal Materials

Interior Walls: 1. Studding Size 2. Header Size 3. Wall Covering Type 4. Fire Wall if required 5. Other Materials

MAP # LOT#

For Official Use Only

Form with fields: Date (AUG 11 1988), Inside Finish, Bldg Code, Time Limit, Estimated Cost (12,000), Value Structure (80,00), Subdivision Name, Lot, Block, Permit Expiration, Ownership (Public/Private).

Ceiling: 1. Ceiling Joists Size: 2. Ceiling Strapping Size 3. Type Ceiling: Spacing 4. Insulation Type 5. Ceiling Height: Size

Roof: 1. Truss or Rafter Size 2. Sheathing Type 3. Roof Covering Type 4. Other: Span Size

Chimneys: Type: Number of Fire Places

Heating: Type of Heat: Service Entrance Size: Smoke Detector Required Yes No

Electrical: 1. Approval of soil test if re-use: 2. No. of Tubs or Showers 3. No. of Flushes 4. No. of Lavatories 5. No. of Other Fixtures

Plumbing: 1. Type: 2. Pot Size: 3. Max. conform to National Electrical Code and State Law. Square Footage

Swimming Pools: 1. Type: 2. Pot Size: 3. Max. conform to National Electrical Code and State Law. Square Footage

Zoning: District: Street Frontage Req. Provided Side Side

Permit Received By: Lisa Cushman

Signature of Applicant: Charles Murphy Date: Aug 11 1988

Signature of CEO: [Signature] Date: [Blank] Inspection Date: [Blank] White Tag - CEO