



CITY OF PORTLAND, MAINE
Department of Building Inspection

Certificate of Occupancy

LOCATION

85-S-7,8,9 & 10 Winding Way, Peaks Isl.

Issued to

John & Arnie Rowanysyn

Date of Issue

June 16, 1984

This is to certify that the building, premises, or part thereof, at the above location, built—altered—changed as to use under Building Permit No. 83-232, has had final inspection, has been found to conform substantially to requirements of Zoning Ordinance and Building Code of the City, and is hereby approved for occupancy or use, limited or otherwise, as indicated below.

PORTION OF BUILDING OR PREMISES

APPROVED OCCUPANCY

Limiting Conditions: Entire

Single Family Dwelling = Year Round

This certificate supersedes
certificate issued

Approved:

6-18-84

(Date)

Inspector

Inspector of Buildings

Notice: This certificate identifies lawful use of building or premises, and ought to be transferred from owner to owner when property changes hands. Copy will be furnished to owner or lessee for one dollar.

APPLICATION FOR PERMIT

PERMIT ISSUED

B.O.C.A. USE GROUP

B.O.C.A. TYPE OF CONSTRUCTION

00232

APR 24 1983

ZONING LOCATION

PORTLAND, MAINE

April 1, 1983

CITY OF PORTLAND

To the CHIEF OF BUILDING & INSPECTION SERVICES, PORTLAND, MAINE

The undersigned hereby applies for a permit to erect, alter, repair, demolish, move or install the following building, structure, equipment or change use in accordance with the Laws of the State of Maine, the Portland B.O.C.A. Building Code and Zoning Ordinance of the City of Portland with plans and specifications, if any, submitted herewith and the following specifications:

LOCATION: 85- S 7, 8, 9 & 10 Winding Way, Peaks Island

1. Owner's name and address: John & Annie Romanyszyn - Pleasant Ave. PKs Isl. Fire District #1 [] #2 [] Telephone: 766-2450

2. Lessee's name and address: Telephone:

3. Contractor's name and address: Omer Telephone:

Proposed use of building: Dwelling - year round with addition No. of sheets: 1

Last use: No. families: 1

Material: No. stories: Heat: Style of r: Roofing:

Other buildings on same lot:

Estimated construction cost \$25,000

FIELD INSPECTOR - Mr. @ 775-5451

Appeal Fees \$

Base Fee 135.00

Late Fee

TOTAL \$ 135.00

To construct 24' x 32' 2 story addition to existing dwelling as per plans, 1 sheet of plans.

Stamp of Special Conditions

send permit to # 1 04108

NOTE TO APPLICANT: Separate permits are required by the installers and subcontractors of heating, plumbing, electrical and mechanicals.

DETAILS OF NEW WORK

Is any plumbing involved in this work? yes Is any electrical work involved in this work? yes

Is connection to be made to public sewer? cess. pool - existing If not, what is proposed for sewage?

Has septic tank notice been sent? Form notice sent?

Height average grade to top of plate Height average grade to highest point of roof

Size front depth No. stories solid or filled land? earth or rock?

Material of foundation Thickness, top bottom cellar

Kind of roof Rise per foot Roof covering

No. of chimneys Material of chimneys of lining Kind of heat fuel

Framing L Kind Dressed or full size? Corner posts Sills

Size Girder Columns under girders Size Max. on centers

Studs (outside walls and carrying partitions) 2x4-16" O. C. Bridging in every floor and flat roof span over 8 feet.

Joists and rafters: 1st floor 2nd 3rd roof

On centers: 1st floor 2nd 3rd roof

Maximum span: 1st floor 2nd 3rd roof

If one story building with masonry walls, thickness of walls? height?

IF A GARAGE

No. cars now accommodated on same lot to be accommodated number commercial cars to be accommodated

Will automobile repairing be done other than minor repairs to cars habitually stored in the proposed building?

APPROVALS BY: DATE MISCELLANEOUS

BUILDING INSPECTION: IN EXAM. JER Will work require disturbing of any tree on a public street?

ZONING: O.M. M.A.C. 2/11/83

BUILDING CODE: Will there be in charge of the above work a person competent

Fire Dept.: to see that the State and City requirements pertaining thereto

Health Dept.: are observed?

Others:

Signature of Applicant John Romanyszyn Phone # same

Type Name of above John Romanyszyn 1 2 3 4

Other and Address

FIELD INSPECTOR'S COPY

APPLICANT'S COPY

OFFICE FILE COPY

MR. [Signature] Add 1/20

NOTES

5-4-83 - General preparation
in progress. OK. QA

6-20-83 - Lona tables OK.
Sills, joists and floor
OK. WIP/OK. Down. To
make some changes and
will notify me by mail
of changes. WIP/OK. AD

7-26-83 WIP/OK. QA

8-9-83 - Tacking in Lunda
and frame work.
OK. WIP/OK. QA

9-20-83 - Close in
interior. OK. QA

1-9-84 - Interior finish
in progress. Shut work
plates, etc. WIP/OK. QA

4-23-84 - All closed
in finish in the
in progress. OK. QA

1-15-84 - Done
P.O. OK

Permit No. 83/6238

Location 858-5409 Grand

Owner J. L. Lanna Jackson

Date of permit 4-1-83

Approved 4-4-83

Dwelling 2 story addition

Garage

Alteration

[Handwritten signature]

~~Empty table with 2 columns and 10 rows.~~

~~Empty table with 2 columns and 10 rows.~~

Romanyshyn
Peaks Island

Proposed Third Street

WINDING WAY

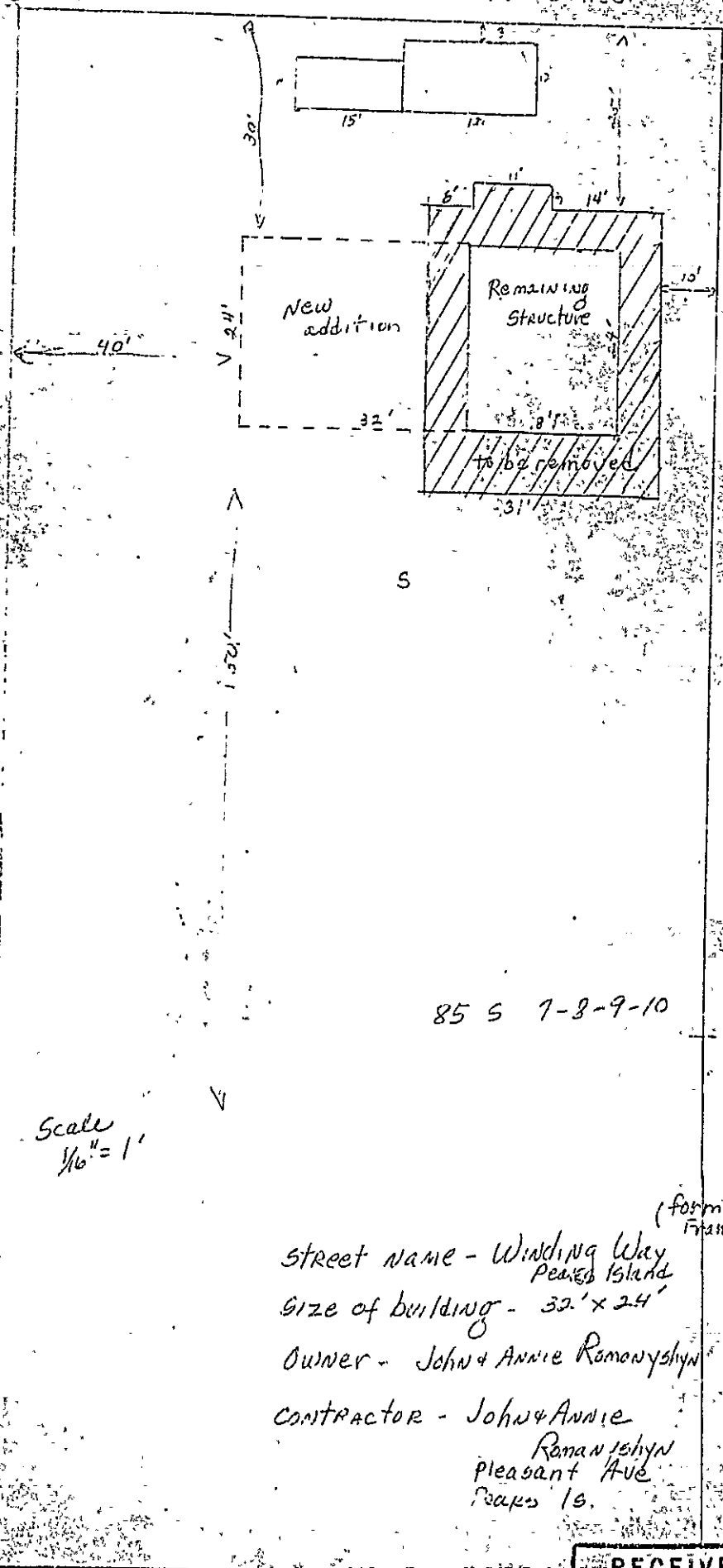

85 S 7-2-9-10

Scale
1/16" = 1'

(formerly Francis JORDAN)
 street name - Winding Way
 Peaks Island
 size of building - 32' x 24'
 Owner - John & Annie Romanyshyn
 Contractor - John & Annie
 Romanyshyn
 Pleasant Ave
 Peaks Is.

Proposed Fifth St

RECEIVED
 APR - 11 1983
 DEPT. OF BLDG. INSP.
 CITY OF PORTLAND

85-5-7, 8 WINDING WAY---PEAKS ISLAND

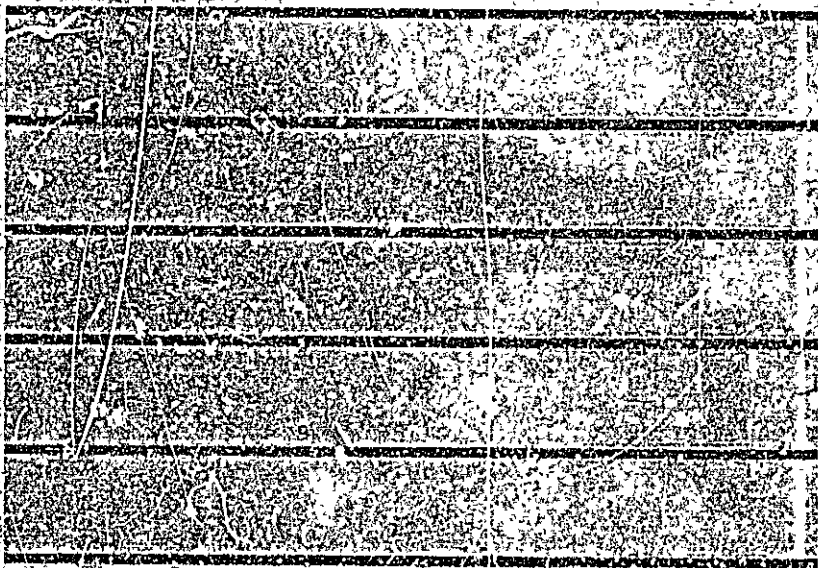



APPLICATION FOR PERMIT
DEPARTMENT OF BUILDING INSPECTIONS SERVICES
ELECTRICAL INSTALLATIONS

Date 7-7, 1983
 Receipt and Permit-number 08383

To the CHIEF ELECTRICAL INSPECTOR, Portland, Maine

The undersigned hereby applies for a permit to make electrical installations in accordance with the laws of Maine, the Portland Electrical Ordinance, the National Electrical Code and the following specifications:

LOCATION OF WORK: 85-S-7, 8 Winding Way, Peaks Island

OWNER'S NAME: John & Ann Romanyszyn ADDRESS: Peaks Island

OUTLETS: Receptacles Switches Plugmold _____ ft. TOTAL 1-30 FEES 3.00

FIXTURES: (number of) Incandescent _____ Fluorescent _____ (not strip) TOTAL _____
 Strip Fluorescent _____ ft. _____

SERVICES: Overhead Underground _____ Temporary _____ TOTAL amperes 200 FEES 3.00

METERS: (number of) 1 FEES .50

MOTORS: (number of) Fractional _____
 1 HP or over _____

RESIDENTIAL HEATING: Oil or Gas (number of units) _____
 Electric (number of rooms) _____

COMMERCIAL OR INDUSTRIAL HEATING: Oil or Gas (by a main boiler) _____
 Oil or Gas (by separate units) _____
 Electric Under 20 kws _____ Over 20 kws _____

APPLIANCE: (number of) Ranges _____ Water Heaters _____
 Cook Tops _____ Disposals _____
 Wall Ovens _____ Dishwashers _____
 Dryers _____ Compactors _____
 Fans _____ Others (denote) _____

MISCELLANEOUS: (number of) Branch Panels _____
 Transformers _____
 Air Conditioners Central Unit _____
 Separate Units (windows) _____
 Signs 20 sq. ft. and under _____
 Over 20 sq. ft. _____
 Swimming Pools Above Ground _____
 In Ground _____
 Fire/Burglar Alarms Residential _____
 Commercial _____
 Heavy Duty Outlets, 220 Volt (such as welders) 30 amps and under _____
 over 30 amps _____
 Circus, Fairs, etc. _____
 Alterations to wires _____
 Repairs after fire _____
 Emergency Lights, battery _____
 Emergency Generators _____

INSTALLATION FEE DUE: _____
 FOR ADDITIONAL WORK NOT ON ORIGINAL PERMIT DOUBLE FEE DUE: _____
 FOR REMOVAL OF A "STOP ORDER" (304-16.b)
 TOTAL AMOUNT DUE: 6.50

INSPECTION: Will be ready on _____, 19__; or Will Call

CONTRACTOR'S NAME: Frank Herbert
 ADDRESS: Peppingill Pond, Windham
 TEL.: _____

MASTER LICENSE NO.: 2576 SIGNATURE OF CONTRACTOR: _____
 LIMITED LICENSE NO.: _____

INSPECTOR'S COPY — WHITE
 OFFICE COPY — CANARY
 CONTRACTOR'S COPY — GREEN

ELECTRICAL INSTALLATIONS

Permit Number 8383

Location 85 25-718 W. Hwy

Owner J. R. Rasmussen

Date of Permit

Final Inspection 4-11-84

By Inspector E. L. Kelly

Permit Application Register Page No. 3

INSPECTIONS: Service _____ by Lilly
Service called in 9-12-83
Closing-in 10-7-83 by Lilly

PROGRESS INSPECTIONS:

<u>9-8-83</u>	1	1
<u>1-2-84</u>	1	1
<u>4-11-84</u>	1	1

CODE COMPLIANCE COMPLETED DATE 4-11-84

DATE	REMARKS:

Chris Paul
John G. Kelly