

FIRST PROPOSED ST. PEAKS ISLAND

85-0-25

CITY OF PORTLAND, MAINE  
DEPARTMENT OF BUILDING INSPECTION

Room 21, City Hall

RECEIVED  
OCT 31 1941  
DEPT. OF BLD'G. INSP.  
CITY OF PORTLAND

Gentlemen:

In connection with the installation of oil burning equipment as indicated in statement below, please sign this statement and return to this office as promptly as possible so that the permit may be issued if everything else is found in order, retaining the copy for your file.

Very truly yours,

(Signed) Warren McDonald  
Inspector of Buildings.

\*\*\*\*\*

1. This statement is to become as much a part of the application for a permit to cover installation of oil burning equipment for *Mr. U B Small* *Island View Inn at Peaks Island*, as though written on the application form.

2. A switch or other manual control capable of completely stopping flow of oil to the burner will be provided, such device to be so located as to be conveniently reached and operated without being exposed to danger that may exist at or near the burner. If feasible this switch or similar device will be located at or near the top of the cellar stairs. In case the burner is of a type without electrical controls, a quick-closing valve will be provided in the oil supply line so located and arranged that the valve may be manually closed from the top of the cellar stairs, or outside of the room where the burner is located or from outside the building.

3. A quick action, self-closing valve designed to close at 160 to 165 degrees Fahrenheit will be provided in oil supply line.

4. Readily accessible shut-off valves, one of which may be the self-closing valve indicated in No. 3 if capable of manual operation, will be installed in oil supply line near each burner and close to supply tank. Shut-off valves will be installed on each side of oil strainers which are not a part of the oil burner unit or which are connected to oil burner unit without intervening piping or tubing. Shut-off valves will be provided both on the discharge side and the suction side of oil pumps, if any, which pump directly to the burner but which are not a part of the burner unit.

5. If there is to be a shut-off valve in the discharge line of an oil pump, a suitable pressure relief valve will be connected into the discharge line between pump and shut-off valve and arranged to return surplus oil to the storage tank or to by-pass it around the pump.

*Read all Mr. Alhadi*  
Installer

(Date) *10/29/41*

By *W. J. Ketchum*



FILL IN COMPLETELY AND SIGN WITH INK

PERMIT ISSUED

Permit No. 1075  
OCT 31 1941

APPLICATION FOR PERMIT FOR HEATING, COOKING OR POWER EQUIPMENT

Portland, Maine, 10/29/41

To the INSPECTOR OF BUILDINGS, PORTLAND, ME.

The undersigned hereby applies for a permit to install the following heating, cooking or power equipment in accordance with the Laws of Maine, the Building Code of the City of Portland, and the following specifications:

Location Island View Terrace P2 Use of Building Res No. Stories New Building  
Existing 6  
Name and address of owner of appliance V. B. Small Island View Terrace P2  
Installer's name and address Randall McAlister Telephone 3-2011

General Description of Work

To install 1 B.C. Franklin Oil Burner on Existing  
Water Pipe Furnace

IF HEATER, POWER BOILER OR COOKING DEVICE

Is appliance or source of heat to be in cellar? yes If not, which story --- Kind of Fuel ---  
Material of supports of appliance (concrete floor or what kind) Stone Concrete  
Minimum distance to wood or combustible material, from top of appliance or casing top of furnace, ---  
from top of smoke pipe --- from front of appliance --- from sides or back of appliance ---  
Size of chimney flue --- Other connections to same flue ---

IF OIL BURNER

Name and type of burner B.C. Franklin Labeled and approved by Underwriters' Laboratories? yes  
Will operator be always in attendance? no Type of oil feed (gravity or pressure) Pressure  
Location oil storage Basement No. and capacity of tanks 1 - 27 1/2 gallon  
Will all tanks be more than seven feet from any flame? yes How many tanks fireproofed? no

Amount of fee enclosed? 1.00 (\$1.00 for one heater, etc., 50 cents additional for each additional heater, etc., in same building at same time.)

INSPECTION COPY

Signature of Installer Randall McAlister  
W. H. McAlister

NOT VALID UNLESS SIGNED BY THE INSPECTOR OF BUILDINGS BEFORE LEAVING OFFICE

PH





(A) APARTMENT HOUSE ZONE  
**APPLICATION FOR PERMIT**

**PERMIT ISSUED**

Permit No. \_\_\_\_\_

Class of Building or Type of Structure Third Class

Aug 25 1913

Portland, Maine, August 25, 1913

To the INSPECTOR OF BUILDINGS, PORTLAND, ME.

The undersigned hereby applies for a permit to erect alter instal the following building structure equipment in accordance with the laws of the State of Maine, the Building Code of the City of Portland, plans and specifications, if any, submitted herewith and the following specifications:

85-0-25

Location Peaks Island Within Fire Limits? no Dist. No. \_\_\_\_\_  
Owner's name and address Helena B. and Dunlop, Peaks Island Telephone \_\_\_\_\_  
Contractor's name and address A. P. Ross, Peaks Island Telephone no  
Architect \_\_\_\_\_ Plans filed no No. of sheets \_\_\_\_\_  
Proposed use of building Cottage No. families \_\_\_\_\_  
Other buildings on same lot \_\_\_\_\_  
Estimated cost \$ 35. Fee \$ 50

**Description of Present Building to be Altered**

Material frame No. stories 1 Heat \_\_\_\_\_ Style of roof \_\_\_\_\_ Roofing \_\_\_\_\_  
Last use Cottage No. families \_\_\_\_\_

**General Description of New Work**

To erect two new windows in gable ends of cottage for ventilation of attic.

CERTIFICATE OF OCCUPANCY  
REQUIREMENT IS WAIVED

85-0-28  
NOTIFICATION BEFORE LAST  
OR CLOSING-IN IS WAIVED

It is understood that this permit does not include installation of heating apparatus which is to be taken out separately by and in the name of the heating contractor.

**Details of New Work**

Is any plumbing work involved in this work? \_\_\_\_\_  
Is any electrical work involved in this work? \_\_\_\_\_ Height average grade to top of plate \_\_\_\_\_  
Site, front \_\_\_\_\_ depth \_\_\_\_\_ No. stories \_\_\_\_\_ Height average grade to highest point of roof \_\_\_\_\_  
To be erected on solid or filled land? \_\_\_\_\_ earth or rock? \_\_\_\_\_  
Material of foundation \_\_\_\_\_ Thickness, top \_\_\_\_\_ bottom \_\_\_\_\_ cellar \_\_\_\_\_  
Material of underpinning \_\_\_\_\_ Height \_\_\_\_\_ Thickness \_\_\_\_\_  
Kind of roof \_\_\_\_\_ Rise per foot \_\_\_\_\_ Roof covering \_\_\_\_\_  
No. of chimneys \_\_\_\_\_ Material of chimneys \_\_\_\_\_ of lining \_\_\_\_\_  
Kind of heat \_\_\_\_\_ Type of fuel \_\_\_\_\_ Is gas fitting involved? \_\_\_\_\_  
Framing lumber—Kind \_\_\_\_\_ Dressed or full size? \_\_\_\_\_  
Corner posts \_\_\_\_\_ Sills \_\_\_\_\_ Girt or ledger board? \_\_\_\_\_ Size \_\_\_\_\_  
Material columns, under girders \_\_\_\_\_ Size \_\_\_\_\_ Max. in centers \_\_\_\_\_  
Studs (outside walls and carrying partitions) 2x4-16' O. C. Girders 6x8 or larger. Bridging in every floor and flat roof span over 8 feet. Sills and corner posts all one piece in cross section.  
Joists and rafters: 1st floor \_\_\_\_\_, 2nd \_\_\_\_\_, 3rd \_\_\_\_\_, roof \_\_\_\_\_  
On centers: 1st floor \_\_\_\_\_, 2nd \_\_\_\_\_, 3rd \_\_\_\_\_, roof \_\_\_\_\_  
Maximum span: 1st floor \_\_\_\_\_, 2nd \_\_\_\_\_, 3rd \_\_\_\_\_, roof \_\_\_\_\_  
If one story building with masonry walls, thickness of walls? \_\_\_\_\_ height? \_\_\_\_\_

**If a Garage**

No. cars now accommodated on same lot \_\_\_\_\_, to be accommodated \_\_\_\_\_  
Total number commercial cars to be accommodated \_\_\_\_\_  
Will automobile repairing be done other than minor repairs to cars habitually stored in the proposed building? \_\_\_\_\_

**Miscellaneous**

Will above work require removal of disturbing or any shade tree or a public street? no  
Will there be in charge of the above work a person competent to see that the State and City requirements pertaining thereto are observed? \_\_\_\_\_  
Signature of owner by Helena Dunlop

INSPECTION COPY

834

Permit No. 411213  
Location Smith Rd, Peabody  
Owner Helene O. Wallace  
Date of permit 8/25/44  
Notif. closing-in \_\_\_\_\_  
Inspn. closing-in \_\_\_\_\_  
Final Notif. \_\_\_\_\_  
Final Inspn. \_\_\_\_\_  
Cert. of Occupancy issued \_\_\_\_\_

NOTES

85  
0  
25

Department of Forest and Fisheries, Bureau of Fish and Game

Permit at Department of Fish and Game

MASSACHUSETTS

*Mr. Wm. Small*

THE STANDARD FORM OF BOX BUILT TO ORDER FOR THE  
AND CAPABLE FOR CONTAINING

INSTRUCTIONS TO THE USER OF THE BOX  
FOR THE PURPOSE OF THE BOX BUILT TO ORDER FOR THE  
FOR THE PURPOSE OF THE BOX BUILT TO ORDER FOR THE

RECEIVED  
NOV 12 1934  
DEPT. OF  
CITY OF

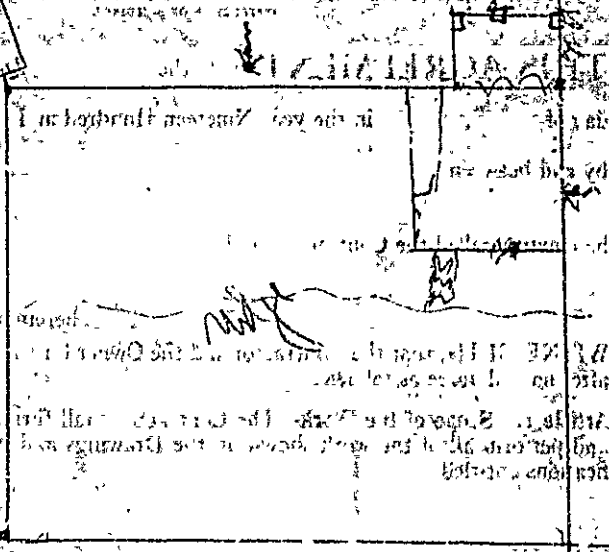

- 4 X 4 sill
- floor timbers
- 2 X 4
- padding
- 4 X 4
- cornel
- 4 X 4
- strong

*Pond Road*

Memorandum from Department of Building Inspection, Portland, Maine  
Fond Road, Peaks Island---One-story addition for Vivian Small by A. P. Foss, Builder  
11/12/41

To Owner and Builder:

Not enough information to check strength of 4x8 beam between main building and addition. If it does not check out heavy enough at time of "closing-in" inspection it will have to be made so, of course.

CC Vivian Small, Peaks Island

(Signed) Warren McDonald  
Inspector of Buildings





(A) APARTMENT HOUSE ZONE  
APPLICATION FOR PERMIT

PERMIT ISSUED

Class of Building or Type of Structure Third Class

Permit No. 2750  
NOV 12 1941

Portland, Maine, November 12, 1941

To the INSPECTOR OF BUILDINGS, PORTLAND, ME.

The undersigned hereby applies for a permit to erect alter install the following building structure-equipment in accordance with the Laws of the State of Maine, the Building Code of the City of Portland, plans and specifications, if any, submitted herewith and the following specifications:

Location Peaks Island Within Fire Limits? no Dist. No. \_\_\_\_\_  
Lot 111 First Street  
Owner's or Lessee's name and address Vivian Small, Peaks Island Telephone \_\_\_\_\_  
Contractor's name and address A. P. Foss, Pleasant Ave. Peaks Telephone \_\_\_\_\_  
Architect \_\_\_\_\_ Plans filed yes No. of sheets 1  
Proposed use of building Dwelling house No. families 1  
Other buildings on same lot \_\_\_\_\_  
Estimated cost \$ 100. Fee \$ 50

Description of Present Building to be Altered

Material wood No. stories 1 Heat \_\_\_\_\_ Style of roof pitch Roofing asphalt  
Last use dwelling house No. families 1

General Description of New Work

To build one story frame addition 8' x 4' on rear corner of building  
to remove 8' section of rear wall, putting in spruce dressed 4x2 under existing double 2x4 plate for support

It is understood that this permit does not include installation of heating apparatus which is to be taken out separately by and in the name of the heating contractor.

Details of New Work

CERTIFICATE OF OCCUPANCY  
REQUIREMENT IS WAIVED

Is any plumbing work involved in this work? \_\_\_\_\_  
Is any electrical work involved in this work? \_\_\_\_\_ Height average grade top of plate \_\_\_\_\_  
Size, front \_\_\_\_\_ depth \_\_\_\_\_ No. stories \_\_\_\_\_ Height average grade to highest point of roof \_\_\_\_\_  
To be erected on solid or filled land? solid earth or rock? earth  
Material of foundation concrete piers Thickness, top \_\_\_\_\_ bottom \_\_\_\_\_ cellar \_\_\_\_\_  
Material of underpinning \_\_\_\_\_ Height \_\_\_\_\_ Thickness \_\_\_\_\_  
Kind of roof flat Rise per foot 4" Roof covering Asphalt roofing Clas A Ind. Lab.  
No. of chimneys no Material of chimneys \_\_\_\_\_ of lining \_\_\_\_\_  
Kind of heat \_\_\_\_\_ Type of fuel \_\_\_\_\_ Is gas fitting involved? \_\_\_\_\_  
Framing lumber—Kind black Dressed or full size? ground  
Corner posts 4x4 Sills 4x6 Girt or ledger board? \_\_\_\_\_ Size \_\_\_\_\_  
Material columns under girders \_\_\_\_\_ Size \_\_\_\_\_ Max. on centers \_\_\_\_\_  
Studs (outside walls and carrying partitions) 2x4-16" O. C. Girders 6x8 or larger. Bridging in every floor and flat roof span over 8 feet. Sills and corner posts all one piece in cross section.  
Joists and rafters: 1st floor 2x6, 2nd \_\_\_\_\_, 3rd \_\_\_\_\_, roof 2x6  
On centers: 1st floor 16", 2nd \_\_\_\_\_, 3rd \_\_\_\_\_, roof 16"  
Maximum span: 1st floor 4', 2nd \_\_\_\_\_, 3rd \_\_\_\_\_, roof \_\_\_\_\_  
If one story building with masonry walls, thickness of walls? \_\_\_\_\_ height? \_\_\_\_\_

If a Garage

No. cars now accommodated on same lot \_\_\_\_\_ to be accommodated \_\_\_\_\_  
Total number commercial cars to be accommodated \_\_\_\_\_  
Will automobile repairing be done other than minor repairs to cars habitually stored in the proposed building? \_\_\_\_\_

Miscellaneous

Will above work require removal or disturbing of any shade tree on a public street? no  
Will there be in charge of the above work a person competent to see that the State and City requirements, pertaining thereto are observed? yes  
Signature of owner Vivian Small  
Signature of contractor A. P. Foss





Location, ownership and address to be correct, complete and legible. Separate application required for every building. Plans must be filed with this application.

## APPLICATION FOR PERMIT TO BUILD

(3D CLASS BUILDING)

Portland, Me., March 20, 1924 '19

TO THE  
INSPECTOR OF BUILDINGS

The undersigned hereby applies for a permit to build according to the following Specifications:—

Location Ocean-View Terrace Peaks Island Ward 1 Fire Limits? no  
 Name of owner is? S S Bradford Address Peaks Island  
 Name of mechanic is? owner Address \_\_\_\_\_  
 Name of architect is? \_\_\_\_\_ Address \_\_\_\_\_  
 Proposed occupancy of building (purpose)? cottage  
 If a dwelling or tenement house, for how many families? 1  
 Are there to be stores in lower story? \_\_\_\_\_  
 Size of lot, No. of feet front? \_\_\_\_\_; No. of feet rear? \_\_\_\_\_; No. of feet deep? \_\_\_\_\_  
 Size of building, No. of feet front? 27ft; No. of feet rear? 30ft; No. of feet deep? 30ft  
 No. of stories, front? 1; rear? \_\_\_\_\_  
 No. of feet in height from the mean grade of street to the highest part of the roof? 12ft  
 Distance from \_\_\_\_\_ lines, front? \_\_\_\_\_ feet; side? \_\_\_\_\_ feet; rear? \_\_\_\_\_ feet  
 Firestop to be used? yes  
 Will the building be erected on solid or filled land? solid  
 Will the foundation be laid on earth, rock or piles? \_\_\_\_\_  
 If on piles, No. of rows? \_\_\_\_\_ distance on centres? \_\_\_\_\_ length of \_\_\_\_\_  
 Diameter, top of? \_\_\_\_\_ diameter, bottom of? \_\_\_\_\_  
 Size of posts, 4 x 6 Studding 2 x 4 16 O. C. Sills 4 x 8 Roof Rafters 2 x 6 24 O. C. Girders 6 x 8  
 Size of girts 4 x 4 \_\_\_\_\_  
 Size of floor timbers? 1st floor 2x8, 2d \_\_\_\_\_, 3d \_\_\_\_\_, 4th \_\_\_\_\_  
 O. C. " " " " 16, 2d \_\_\_\_\_, 3d \_\_\_\_\_, 4th \_\_\_\_\_  
 Span " " " " not over 16ft, 2d \_\_\_\_\_, 3d \_\_\_\_\_, 4th \_\_\_\_\_  
 Will the building be properly braced? \_\_\_\_\_  
 Building, how framed? \_\_\_\_\_  
 Material of foundation? posts thickness of? \_\_\_\_\_ laid with mortar? \_\_\_\_\_  
 Underpinning, material of? \_\_\_\_\_ height of? \_\_\_\_\_ thickness of? \_\_\_\_\_  
 Will the roof be flat, pitch, mansard or hip? pitch Material of roofing? shingle  
 Will the building be heated by steam, furnaces, stoves or grates? stove Will the flues be lined? Yes  
 Will the building conform to the requirements of the law? yes  
 Means of egress? \_\_\_\_\_

Plans must be submitted in duplicate, one set to be filed with the Department and the duplicate set thereof (bearing the approval of the Inspector of Buildings) shall be kept on the work and exhibited on demand.

PERMIT MUST BE RECEIVED BEFORE BEGINNING WORK

If the building is to be occupied as a Tenement House, give the following particulars

What is the height of cellar or basement? \_\_\_\_\_  
 What will be the clear height of first story? \_\_\_\_\_ second? \_\_\_\_\_ third? \_\_\_\_\_  
 State what means of egress is to be provided \_\_\_\_\_  
 Scuttle and stepladder to roof? \_\_\_\_\_

Estimated Cost, \$1,000. Signature of owner or authorized representative, S. S. Bradford  
 Address, Peaks Island, Me.  
 Received by? \_\_\_\_\_  
 Plans submitted? \_\_\_\_\_

Ocean View Terrace, Peaks

192

No. 5658

APPLICATION FOR  
Permit to Build  
3rd CLASS BUILDING

LOCATION

Ocean View Peaks Island  
No. 510 Just St  
St 111

WARD 1

45-0-25

Inspector.

CONDITIONS

PERMIT GRANTED

Mar 20, 1924

Permit filled out by

Permit number

Plan number

FINAL REPORT

APPROVAL

Has the work been completed in accordance with this application and plans filed and approved?

Law been violated?

Nature of violation?

Violation removed when

Estimated cost of building, etc., \$

Building Inspector.