

85-N-7 Ryefield St., Peaks Is.

85-N-7

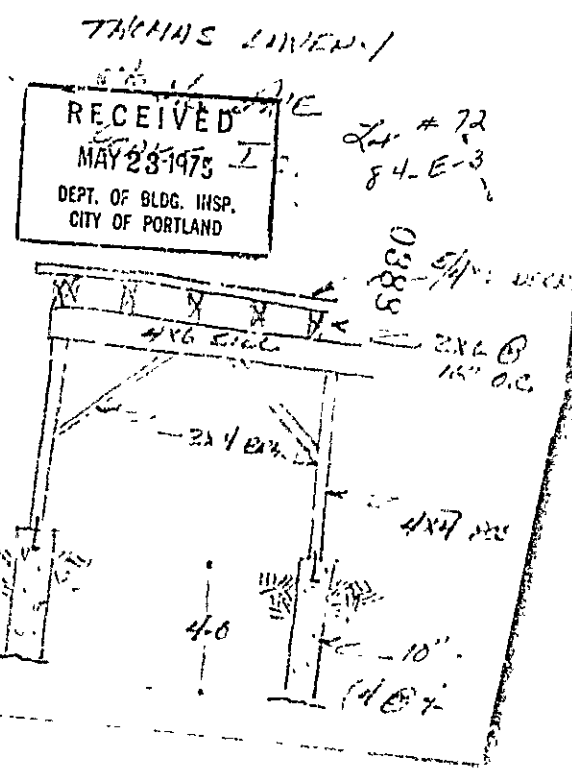

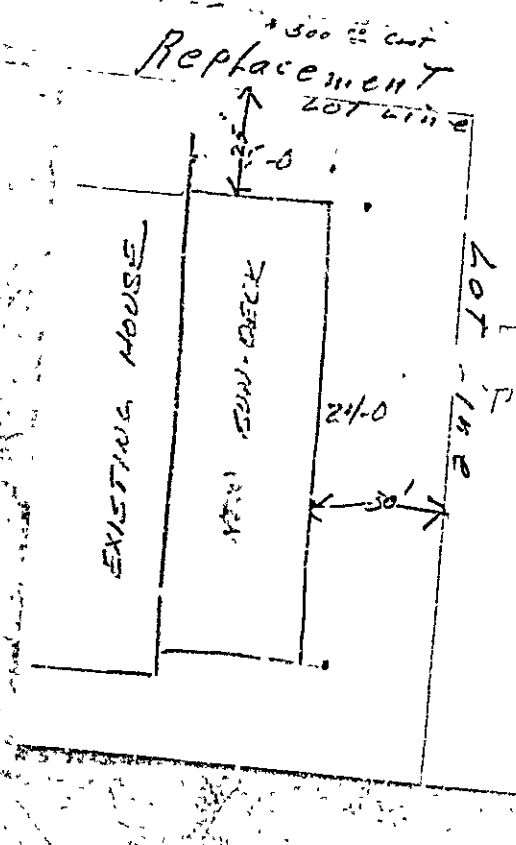

# APPLICATION FOR PERMIT

B.O.C.A. USE GROUP .....

B.O.C.A. TYPE OF CONSTRUCTION .....

ZONING LOCATION R-3 PORTLAND, MAINE, May 23, 1975

To the DIRECTOR OF BUILDING & INSPECTION SERVICES, PORTLAND, MAINE

The undersigned hereby applies for a permit to erect, alter, repair, demolish, move or install the following structure, equipment or change use in accordance with the Laws of the State of Maine, the Portland B.O.C.A. Building Code and Zoning Ordinance of the City of Portland with plans and specifications, if any, submitted herewith and the following specifications:

LOCATION 35-N-7 (8th Maine Ave.) Peaks Island Fire District #1  #2

1. Owner's name and address Thomas Lavery, same Telephone .....

2. Lessee's name and address .....

3. Contractor's name and address Jackson & Casey, Evergreen Ave., Peaks Island Telephone 766-2817

4. Architect .....

Proposed use of building attached sun deck Specifications .....

Last use .....

Material .....

No. stories .....

Heat .....

Style of roof .....

Roofing .....

Other buildings on same lot .....

Estimated contractual cost \$ 500.00 Fee \$ 5.00

FIELD INSPECTOR—Mr. Earle Smith GENERAL DESCRIPTION

This application is for: @ 775-5451 To construct a 8x24 sundeck as per plans

Dwelling Ext. 234

Garage .....

Masonry Bldg. .... Stamp of Special Conditions

Metal Bldg. ....

Alterations .....

Demolitions .....

Change of Use .....

Other .....

NOTE TO APPLICANT: Separate permits are required by the installers and subcontractors of heating, plumbing, electrical and mechanicals.

PERMIT IS TO BE ISSUED TO 1  2  3  4

Other: .....

DETAILS OF NEW WORK

Is any plumbing involved in this work? no Is any electrical work involved in this work? no

Is connection to be made to public sewer? .....

Has septic tank notice been sent? .....

Height average grade to top of plate .....

Size, front .....

Material of foundation .....

Kind of roof .....

No. of chimneys .....

Framing Lumber—Kind .....

Size Girder .....

Studs (outside walls and carrying partitions) 2x4-16" O. C. Bridging in every floor and flat roof span over 8 feet.

Joists and rafters: 1st floor .....

On centers: 1st floor .....

Maximum span: 1st floor .....

If one story building with masonry walls, thickness of walls? .....

IF A GARAGE

No. car now accommodated on same lot .....

Will automobile repairing be done other than minor repairs to cars habitually stored in the proposed building? .....

APPROVALS BY: DATE MISCELLANEOUS

BUILDING INSPECTION—PLAN EXAMINER .....

ZONING: O.K. M.G.W. 5/23/75 Will work require disturbing of any tree on a public street? .....

BUILDING CODE: O.K. E.S. 5/23/75 Will there be in charge of the above work a person competent to see that the State and City requirements pertaining thereto are observed? Yes

Fire Dept. ....

Health Dept. ....

Other .....

Signature of Applicant: Mrs. Edward Casey Phone # .....

Type Name of above: Mrs. Edward Casey 1  2  3  4

Other .....

and Address .....

FIELD INSPECTOR'S COPY

