

ISLAND AVENUE  
85-D-7

PEAKS ISLAND





R3 RESIDENCE ZONE  
APPLICATION FOR PERMIT

Class of Building or Type of Structure Third Class  
Portland, Maine, June 23, 1958

PERMIT ISSUED  
00773  
JUN 25 1958  
CITY OF PORTLAND

To the INSPECTOR OF BUILDINGS, PORTLAND, MAINE

The undersigned hereby applies for a permit to erect alter repair demolish install the following building structure equipment in accordance with the Laws of the State of Maine, the Building Code and Zoning Ordinance of the City of Portland, plans and specifications, if any, submitted herewith and the following specifications:

Location Rye Field St, Peaks Island (85-0-7) Within Fire Limits? no Dist. No. ....  
Owner's name and address Mrs. Francis Russell, Rye Field St, Peaks Island Me Telephone ..  
Lessee's name and address .. Telephone ..  
Contractor's name and address Earl Hutchins, New Island Ave, Peaks Island Telephone no phone  
Architect .. Specifications .. Plan, yes No. of sheets 2  
Proposed use of building Dwelling No. families 1  
Last use .. No. families 1  
Material frame No. stories 1 1/2 Heat .. Style of roof .. Roofing ..  
Other building on same lot ..  
Estimated cost \$ 100.00 Fee \$ 2.00

General Description of New Work

To remove front outside wall (gable end).  
To provide header 4x12 in place of partition.  
To provide new ceiling for existing porch, with sheetrock-2x8 ceiling timbers 24" o.c.  
porch has flat roof.

*Island Ave 85-0-7*

It is understood that this permit does not include installation of heating apparatus which is to be taken out separately by and in the name of the heating contractor. PERMIT TO BE ISSUED TO contractor

Details of New Work

Is any plumbing involved in this work? no Is any electrical work involved in this work? no  
Is connection to be made to public sewer? .. If not, what is proposed for sewage? ..  
Has septic tank notice been sent? .. Form notice sent? ..  
Height average grade to top of plate .. Height average grade to highest point of roof ..  
Size, front .. depth .. No. stories .. solid or filled land? .. earth or rock? ..  
Material of foundation .. Thickness, top .. bottom .. cellar ..  
Material of underpinning .. Height .. Thickness ..  
Kind of roof .. Rise per foot .. Roof covering ..  
No. of chimneys .. Material of chimneys .. of lining .. Kind of heat .. fuel ..  
Framing Lumber—Kind fir Dressed or full size? .. Corner posts .. Sills ..  
Size Girder .. Columns under girders .. Size .. Max. on centers ..  
Kind and thickness of outside sheathing of exterior walls: ..  
Studs (outside walls and carrying partitions) 2x4-16" O. C. Bridging in every floor and flat roof span over 8 feet.  
Joists and rafters: 1st floor .. 2nd .. 3rd .. roof ..  
On centers: 1st floor .. 2nd .. 3rd .. roof ..  
Maximum span: 1st floor .. 2nd .. 3rd .. roof ..  
If one story building with masonry walls, thickness of walls? .. height?

If a Garage

No. cars now accommodated on same lot .., to be accommodated .. number commercial cars to be accommodated ..  
Will automobile repairing be done other than minor repairs to cars habitually stored in the proposed building? ..

Miscellaneous

Will work require disturbing of any tree on a public street? no ..  
Will there be in charge of the above work a person competent to see that the State and City requirements pertaining thereto are observed? yes  
Mrs. Francis Russell  
Earl Hutchins.

APPROVED:  
.....  
.....  
.....

Signature of owner by: Earl Hutchins

FILE COPY



(A) APARTMENT HOUSE ZONE  
APPLICATION FOR PERMIT

PERMIT ISSUED  
724  
JUL 20 1945

Class of Building or Type of Structure Third Class  
Portland, Maine, July 9, 1945

To the INSPECTOR OF BUILDINGS, PORTLAND, ME.

The undersigned hereby applies for a permit to ~~erect~~ alter ~~repair~~ ~~demolish~~ ~~install~~ the following building structure equipment in accordance with the laws of the State of Maine, the Building Code and Zoning Ordinance of the City of Portland, plans and specifications, if any, submitted herewith and the following specifications:

Location Island Ave., Peaks Island Within Fire Limits? no Dist. No. \_\_\_\_\_  
Owner's name and address Frances Russell, Peaks Island Telephone \_\_\_\_\_  
Lessee's name and address \_\_\_\_\_ Telephone \_\_\_\_\_  
Contractor's name and address Owner Specifications \_\_\_\_\_ Plans no No. of sheets \_\_\_\_\_  
Architect \_\_\_\_\_ No. families 1  
Proposed use of building Dwelling No. families 1  
Last use \_\_\_\_\_ Style of roof \_\_\_\_\_ Roofing \_\_\_\_\_  
Material frame No. stories 1 Heat \_\_\_\_\_  
Other buildings on same lot \_\_\_\_\_  
Estimated cost \$ 10. Fee \$ .25

General Description of New Work

To cut in new window, first floor, in bedroom

CERTIFICATE OF OCCUPANCY  
REQUIREMENT IS WAIVED

It is understood that this permit does not include installation of heating apparatus which is to be taken out separately by and in the name of the heating contractor.

Details of New Work

Is any plumbing work involved in this work? \_\_\_\_\_ Is any electrical work involved in this work? \_\_\_\_\_  
Height average grade to top of plate \_\_\_\_\_ Height average grade to highest point of roof \_\_\_\_\_  
Size, front \_\_\_\_\_ depth \_\_\_\_\_ No. stories \_\_\_\_\_ solid or filled land? \_\_\_\_\_ earth or rock? \_\_\_\_\_  
Material of foundation \_\_\_\_\_ Thickness, top \_\_\_\_\_ bottom \_\_\_\_\_ cellar \_\_\_\_\_  
Material of underpinning \_\_\_\_\_ Height \_\_\_\_\_ Thickness \_\_\_\_\_  
Kind of roof \_\_\_\_\_ Rise per foot \_\_\_\_\_ Roof covering \_\_\_\_\_ Kind of heat \_\_\_\_\_ fuel \_\_\_\_\_  
No. of chimneys \_\_\_\_\_ Material of chimneys \_\_\_\_\_ of lining \_\_\_\_\_ Kind of heat \_\_\_\_\_ fuel \_\_\_\_\_  
Framing lumber—Kind \_\_\_\_\_ Sills \_\_\_\_\_ Girt or ledger board? \_\_\_\_\_ Size \_\_\_\_\_  
Corner posts \_\_\_\_\_ Columns under girders \_\_\_\_\_ Size \_\_\_\_\_ Max. on centers \_\_\_\_\_  
Girders \_\_\_\_\_ Studs (outside walls and carrying partitions) 2x4-16" O. C. Bridging in every floor and flat roof span over 8 feet.  
Joists and rafters: 1st floor \_\_\_\_\_, 2nd \_\_\_\_\_, 3rd \_\_\_\_\_, roof \_\_\_\_\_  
On centers: 1st floor \_\_\_\_\_, 2nd \_\_\_\_\_, 3rd \_\_\_\_\_, roof \_\_\_\_\_  
Maximum span: 1st floor \_\_\_\_\_, 2nd \_\_\_\_\_, 3rd \_\_\_\_\_, height? \_\_\_\_\_  
If one story building with masonry walls, thickness of walls? \_\_\_\_\_  
If a Garage  
No. cars now accommodated on same lot \_\_\_\_\_, to be accommodated \_\_\_\_\_ number commercial cars to be accommodated \_\_\_\_\_  
Will automobile repairing be done other than minor repairs to cars habitually stored in the proposed building? \_\_\_\_\_

APPROVED:

\_\_\_\_\_  
\_\_\_\_\_  
\_\_\_\_\_

Miscellaneous  
Will work require disturbing of any tree on a public street? no  
Will there be in charge of the above work a person competent to see that the State and City requirements pertaining thereto are observed? yes

Signature of owner

Frances A Russell

INSPECTION COPY

Permit No 45/724  
Location New Islands, Pa.'s  
Owner Francis Russell  
Date of permit 7/10/45  
Notif. closing-in \_\_\_\_\_  
Inspn. closing-in \_\_\_\_\_  
Final Notif \_\_\_\_\_  
Final Inspn \_\_\_\_\_  
Cert. of Occupancy issued 1

NOTES

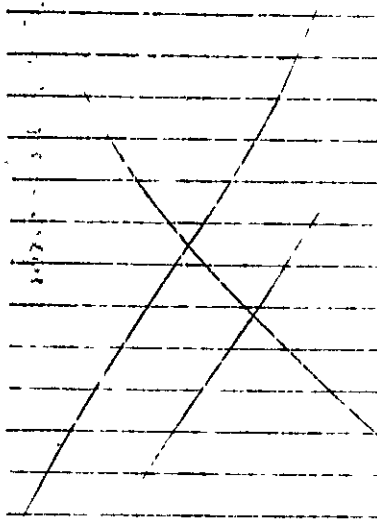



APARTMENT HOUSE ZONE  
APPLICATION FOR PERMIT

RECORDED  
155510

1858

OCT 26 1935

Class of Building or Type of Structure Third Class

Portland, Maine, October 29, 1935

To the INSPECTOR OF BUILDINGS, PORTLAND, ME.

The undersigned hereby applies for a permit to ~~erect~~ alter ~~install~~ the following building structure equipment in accordance with the Laws of the State of Maine, the Building Code of the City of Portland, plans and specifications, if any, submitted herewith and the following specifications:

Location Island Avenue, Peaks Island Ward Isl. 2 Within Fire Limits? no Dist. No. \_\_\_\_\_

Owner's or Lessee's name and address William T. Wade, Peaks Island Telephone \_\_\_\_\_

Contractor's name and address Walter Brackett, Peaks Telephone \_\_\_\_\_

Architect's name and address \_\_\_\_\_ Telephone \_\_\_\_\_

Proposed use of building dwelling house No families 1

Other buildings on same lot \_\_\_\_\_ No. of sheets \_\_\_\_\_

Plans filed as part of this application? no No. of sheets \_\_\_\_\_

Estimated cost \$ 125. Fee \$ .75

Description of Present Building to be Altered

Material wood No. stories 1 1/2 Heat Hot Water Style of roof pitch Roofing asphalt & wood

Last use dwelling house (former owner Harold Clark) No. families 2

General Description of New Work

no glass in one story front porch  
To cover portion of roof with asphalt roofing Class C

Plasma existing with roof over same prior to Dec. 8, '928

It is understood that this permit does not include installation of heating apparatus which is to be taken out separately by and in the name of the heating contractor.

Details of New Work

Size, front \_\_\_\_\_ depth \_\_\_\_\_ No. stories \_\_\_\_\_ Height average grade to top of plate \_\_\_\_\_  
To be erected on solid or filled earth or rock? \_\_\_\_\_ Height average grade to highest point of roof \_\_\_\_\_

Material of foundation \_\_\_\_\_ Thickness, top \_\_\_\_\_ bottom \_\_\_\_\_

Material of underpinning \_\_\_\_\_ Height \_\_\_\_\_ Thickness \_\_\_\_\_

Kind of Roof \_\_\_\_\_ Rise per foot \_\_\_\_\_ Roof covering asphalt roofing Class C bid. Luth.

No. of chimneys \_\_\_\_\_ Material of chimneys \_\_\_\_\_ of lining \_\_\_\_\_

Kind of heat \_\_\_\_\_ Type of fuel \_\_\_\_\_ Is gas fitting involved? \_\_\_\_\_

Corner posts \_\_\_\_\_ Sills \_\_\_\_\_ Girt or ledger board? \_\_\_\_\_ Size \_\_\_\_\_

Material columns under girders \_\_\_\_\_ Size \_\_\_\_\_ Max. on centers \_\_\_\_\_

Studs (outside walls and carrying partitions) 2x4-10" O. C. Girders 6x8 or larger. Bridging in every floor and flat roof span over 8 feet. Sills and corner posts all one piece in cross section.

Joists and rafters: 1st floor \_\_\_\_\_, 2nd \_\_\_\_\_, 3rd \_\_\_\_\_, roof \_\_\_\_\_

On centers: 1st floor \_\_\_\_\_, 2nd \_\_\_\_\_, 3rd \_\_\_\_\_, roof \_\_\_\_\_

Maximum span: 1st floor \_\_\_\_\_, 2nd \_\_\_\_\_, 3rd \_\_\_\_\_, roof \_\_\_\_\_

If one story building with masonry walls, thickness of walls? \_\_\_\_\_ height? \_\_\_\_\_

If a Garage

No. cars now accommodated on same lot \_\_\_\_\_, to be accommodated \_\_\_\_\_

Total number commercial cars to be accommodated \_\_\_\_\_

Will automobile repairing be done other than minor repairs to cars habitually stored in the proposed building? \_\_\_\_\_

Miscellaneous

Will above work require removal or disturbing of any shade tree on a public street no

Will there be in charge of the above work a person competent to see that the State and City requirements pertaining thereto are observed? yes

Signature of owner Wm T Wade

INSPECTION COPY

9713

Ward 2 Permit No. 35/7656

Location Island Ave. Peaks

Owner William T. Wade

Date of permit 10/29/35

Notif. closing-in

Inspn. closing-in

Final Inspection NOT COMPLETED

Final Inspr

Cert. of Occupancy issued

NOTES

Back side of island  
85  
D  
7

1956-7 ISLAND AVENUE PEAKS ISLAND





# APPLICATION FOR PERMIT

## PERMIT ISSUED

B.O.C.A. USE GROUP .....  
B.O.C.A. TYPE OF CONSTRUCTION ..... 724

JUN 22 1984

ZONING LOCATION ..... PORTLAND, MAINE June 22, 1984 CITY OF PORTLAND

To the CHIEF OF BUILDING & INSPECTION SERVICES, PORTLAND, MAINE  
The undersigned hereby applies for a permit to erect, alter, repair, demolish, move or install the following building, structure, equipment or change use in accordance with the Laws of the State of Maine, the Portland R.O.C.A. Building Code and Zoning Ordinance of the City of Portland with plans and specifications, if any, submitted herewith and the following specifications:

LOCATION ... 33-D-7 (Lot 104 on said file in previous) Island Ave., Portland, Maine, #2

1. Owner's name and address James & Wendy Hamon - 15 Hollington St., 04101 Telephone 775-7226

2. Lessee's name and address ..... Telephone .....

3. Contractor's name and address Owner ..... Telephone .....

Proposed use of building Renovations No. of sheets 1

Last use ..... No. families 1

Material ..... No. stories ..... Heat ..... Style of roof ..... Roofing .....

Other buildings on same lot .....

Estimated contractual cost \$ 6,000.00 Appeal Fees \$ .....

FIELD INSPECTOR - Mr. @ 775-5451 Base Fee .....

Late Fee .....

TOTAL \$ 40.10

Enclose existing porch and alterations to kitchen and re-support building, as per plans.

Stamp of Special Conditions

ISSUE PERMIT TO 1

NOTE TO APPLICANT: Separate permits are required by the installers and subcontractors of heating, plumbing, electrical and mechanicals.

### DETAILS OF NEW WORK

Is any plumbing involved in this work? ... Yes ... Is any electrical work involved in this work? ... Yes ...  
Is connection to be made to public sewer? ... If not, what is proposed? ...  
Has septic tank notice been sent? ... Form notice sent? ...  
Height average grade to top of plat? ... Height average grade to highest point of roof? ...  
Size front depth ..... No. stories ..... Solid or fill-d land? ..... earth or rock? .....  
Material of foundation ..... Thickness, top ..... bottom ..... cellar .....  
Kind of roof ..... Rise per foot ..... Roof covering .....  
No. of chimneys ..... Material of chimneys ..... of hearth ..... Kind of heat ..... fuel .....  
Framing Lumber - Kind ..... Dressed or full size? ..... Corner posts ..... Sills .....  
Size Girder ..... Columns under girders ..... Size ..... Max. on centers .....  
Joists (outside walls and carrying partitions) 2x4-16" O. C. Bridging in every floor and flat roof span over 8 feet.  
Joists and rafters: 1st floor ..... 2nd ..... 3rd ..... roof .....  
On centers: 1st floor ..... 2nd ..... 3rd ..... roof .....  
Maximum span: 1st floor ..... 2nd ..... 3rd ..... roof .....  
If one story building with masonry walls, thickness of walls? ..... height? .....

### IF A GARAGE

No. cars now accommodated on same lot ..... to be accommodated ..... number commercial cars to be accommodated .....  
Will automobile repairing be done other than minor repairs to cars habitually stored in the proposed building? .....

APPROVALS BY: DATE MISCELLANEOUS  
BUILDING INSPECTION - PLAN EXAMINER ..... Will work require disturbing of any tree on a public street? NO  
ZONING: .....  
BUILDING CODE: ..... Will there be in charge of the above work a person competent to see that the State and City requirements pertaining thereto are observed? YES  
Fire Dept. ....  
Health Dept. ....  
Others: .....

Signature of Applicant James Hamon Phone # 775-2024  
Type Name of above James Hamon 775-2024

Other and Address .....

FIELD INSPECTOR'S COPY APPLICANT'S COPY OFFICE FILE COPY





**APPLICATION FOR PERMIT**  
**DEPARTMENT OF BUILDING INSPECTIONS SERVICES**  
**ELECTRICAL INSTALLATIONS**

Date June 22, 1984  
 Receipt and Permit number B21461

To the CHIEF ELECTRICAL INSPECTOR, Portland, Maine:  
 The undersigned hereby applies for a permit to make electrical installations in accordance with the laws of  
 Maine, the Portland Electrical Ordinance, the National Electrical Code and the following specifications:  
 LOCATION OF WORK: 85-D-7 (Lot 104 on card file in Assessors) Island Ave., P.I.  
 OWNER'S NAME: James & Wendy Harmon ADDRESS: 15 Arlington St. - 775-2426

	FEES
OUTLETS: Receptacles _____ Switches _____ Plugmold _____ ft. TOTAL 1-30 .....	3.00
FIXTURES: (number of) Incandescent <u>x</u> Fluorescent _____ (not strip) TOTAL 1-10 .....	3.00
Strip Fluorescent _____ ft. ....	
SERVICES: Overhead _____ Underground _____ Temporary _____ TOTAL ampres _____	
METERS: (number of) _____	
MOTORS: (number of) Fractional _____ 1 HP or over _____	
RESIDENTIAL HEATING: Oil or Gas (number of units) _____ Electric (number of rooms) _____	
COMMERCIAL OR INDUSTRIAL HEATING: Oil or Gas (by a main boiler) _____ Oil or Gas (by separate units) _____ Electric Under 20 kws _____ Over 20 kws _____	
APPLIANCES: (number of)	
Ranges _____	
Cook Tops _____	
Wall Ovens _____	
Dryers _____	
Fans _____	
Water Heaters _____	
Disposals _____	
Dishwashers _____	
Compactors _____	
Others (denote) _____	
TOTAL <u>2</u> .....	3.00
MISCELLANEOUS: (number of)	
Branch Panels _____	
Transformers _____	
Air Conditioners Central Unit _____ Separate Units (windows) _____	
Signs 20 sq. ft. and under _____ Over 20 sq. ft. _____	
Swimming Pools Above Ground _____ In Ground _____	
Fire/Burglar Alarms Residential _____ Commercial _____	
Heavy Duty Outlets _____ 10 Volt (such as welders) 30 amps and under _____ over 30 amps _____	
Circus, Fairs, etc. _____	
Alterations to wires _____	
Repairs after fire _____	
Emergency Lights, battery _____	
Emergency Generators _____	
FOR ADDITIONAL WORK NOT ON ORIGINAL PERMIT ..... INSTALLATION FEE DUE:	
FOR REMOVAL OF A STOP ORDER" (304-16.b) ..... DOUBLE FEE DUE:	
TOTAL AMOUNT DUE:	9.00

INSPECTION:  
 Will be ready \_\_\_\_\_, 19\_\_; or Will Call \_\_\_\_\_ x \_\_\_\_\_  
 CONTRACTOR'S NAME: James Harmon - owner  
 ADDRESS: 15 Arlington St., Portland  
 TEL: 775-2426  
 MASTER LICENSE NO. \_\_\_\_\_  
 LIMITED LICENSE NO. \_\_\_\_\_

SIGNATURE OF CONTRACTOR:  
James Harmon

INSPECTOR'S COPY - WHITE  
 OFFICE COPY - CANARY  
 CONTRACTOR'S COPY - GREEN



APPLICATION FOR PERMIT

B.O.C.A. USE GROUP .....
B.O.C.A. TYPE OF CONSTRUCTION ..... 739
ZONING LOCATION ..... PORTLAND, MAINE ..June 22, 1984

PERMIT ISSUED

JUN 22 1984

To the CHIEF OF BUILDING & INSPECTION SERVICES, PORTLAND, MAINE

CITY of PORTLAND

The undersigned hereby applies for a permit to erect, alter, repair, demolish, move or install the following building, structure, equipment or change use in accordance with the Laws of the State of Maine, the Portland B.O.C.A. Building Code and the Ordinance of the City of Portland with plans and specifications, if any, submitted herewith and the following specifications

LOCATION ... 85-D-7 (Lot 104 on card file in Assessors) Island Ave, Fire District #1 C #2 R

- 1. Owner's name and address James & Wendy Harmon, 15 Arlington St., 04101 Telephone 775-2426
2. Lessor's name and address
3. Contractor's name and address

Proposed use of building Renovations
Last use
Material No. stories Heat Style of roof Roofing
Other buildings on same lot
Estimated contractual cost \$6,000.00

FIELD INSPECTOR--Mr. @ 775-5451
Enclose covering porch and alterations to kitchen and re-support building, as per plans.
Appeal Fees \$
Base Fee
Lat Fee
TOTAL \$6,000.

Stamp of Special Conditions

ISSUE PERMIT TO #1

NOTE TO APPLICANT: Separate permits are required by the installers and subcontractors of heating, plumbing, electrical and mechanicals.

DETAILS OF NEW WORK

Is any plumbing involved in this work? yes
Is any electrical work involved in this work? yes
Is connection to be made to public sewer? If not, what is proposed for sewage?
Has some work been done? Form notice sent?
Height average grade to top of plate Height average grade to highest point of roof
Size, front depth No. stories solid or filled land? earth or rock?
Material of foundation Thickness, top bottom cellar
Kind of roof Rafters Roof covering
No. of chimneys Material of chimneys of lining Kind of heat fuel
Framing Lumber--Kind Dressed or full size Corner posts Sills
Size Girder Columns under girders Size Mason centers
Studs (outside walls and carrying partitions) 2x4-16" O. C. Bridging in every floor and flat roof span over 6 feet
Joists and rafters: 1st floor 2nd 3rd roof
On centers: 1st floor 2nd 3rd roof
Maximum span: 1st floor 2nd 3rd roof
If two story building with masonry walls, thickness of walls? height?

IF A GARAGE

No. cars now accommodated on same lot: to be accommodated number currently to be accommodated
Will additional repairs be done other than repairs to cars habitually stored in the proposed building?

APPROVALS: BUILDING INSPECTOR PLAN EXAMINER
ZONING:
BUILDING CODE:
Fire Dept.:
Health Dept.:
Others:
MISCELLANEOUS: Will work require distubing of any tree on a public street?
Will there be a charge of the above work a person competent to see that the State and City requirements pertaining thereto are observed? YES

Signature of applicant James Harmon Phone # 775-2426
Type Name of above James Harmon
Other and Address

FIELD INSPECTOR'S COPY APPLICANT'S COPY OFFICE FILE COPY
1250A Address



1  
2  
3  
4  
5  
6  
7  
8  
9  
10

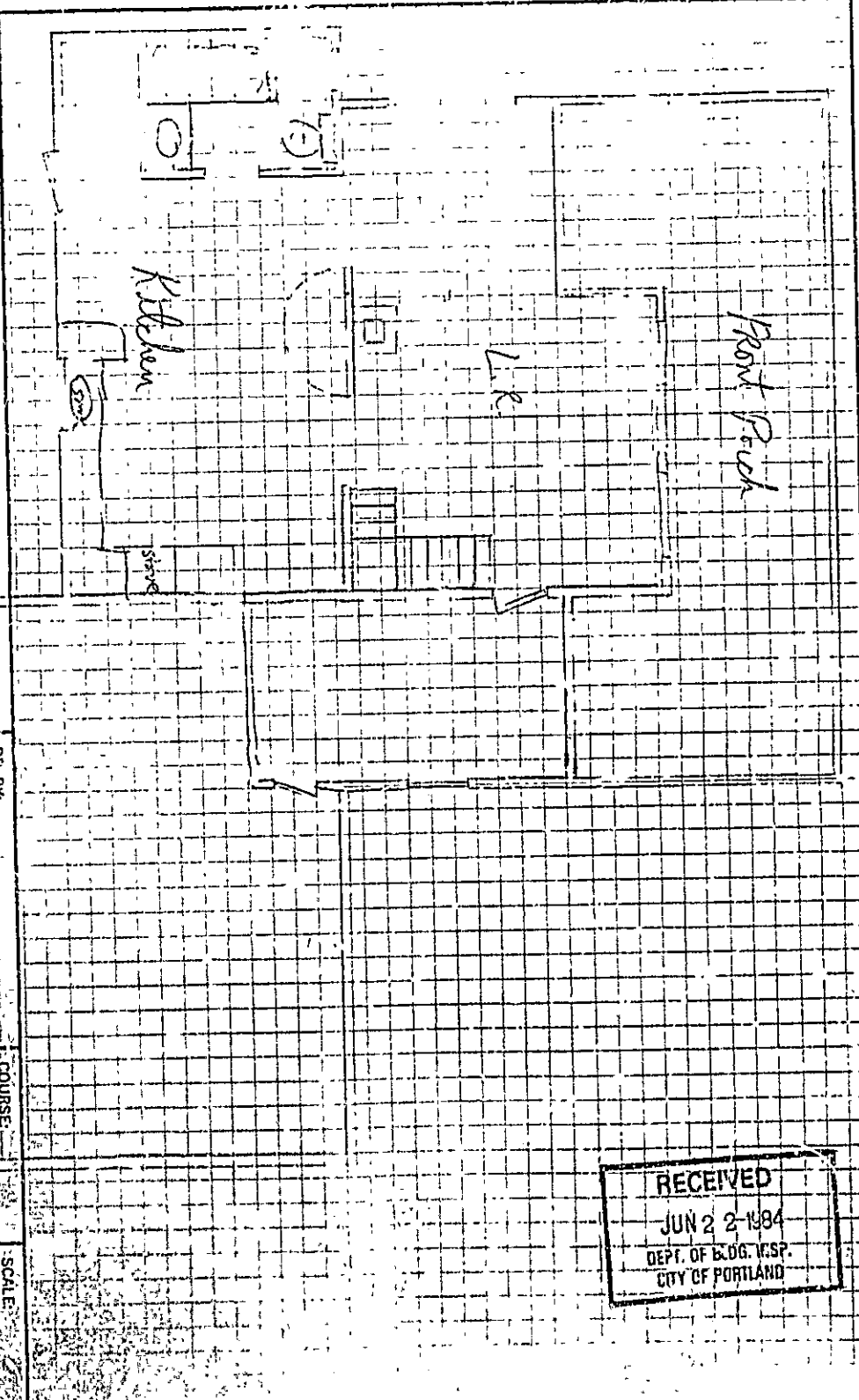

DR. BY:  
CK. BY:

COURSE:  
SECTION:

SCALE:  
DATE:

RECEIVED  
JUN 22 1984  
DEPT. OF B.D.G. W.SP.  
CITY OF PORTLAND

83-D-7  
[Signature]

# PLUMBING APPLICATION

Department of Human Services  
Division of Health Engineering  
(207) 289-3826

*Orchard + Kiteyons*  
*Local Plumbing Inspector Signature*

**PROPERTY ADDRESS**

Town Or Plantation: Portland

Street: 85-D-7 Union St.

Subdivision Lot #: 2000A Section 110

**PROPERTY OWNERS NAME**

Last: Harrison First: James

Applicant Name: Harrison

Mailing Address of Owner/Applicant (if different): 15 Union St. Portland ME 04101

PORTLAND U PERMIT # 516 TOWN COPY

Date Permitted: 6/22/84

James Harrison  
Local Plumbing Inspector Signature

L.P.I. # 123

FEE Charged: 6.11

**Owner/Applicant Statement**

I certify that the information submitted is correct to the best of my knowledge and understand that any falsification is reason for the Local Plumbing Inspector to deny a Permit.

Signature of Owner/Applicant: James Harrison Date: 6/22/84

**Caution: Inspection Required**

I have inspected the installation authorized above and found it to be in compliance with the Maine Plumbing Rules

James Harrison  
Local Plumbing Inspector Signature

APR 1986  
Date Approved

**PERMIT INFORMATION**

This Application is for:

1.  NEW PLUMBING

2.  RELOCATED PLUMBING

Type of Structure To Be Served:

1.  SINGLE FAMILY DWELLING

2.  MODULAR OR MOBILE HOME

3.  MULTIPLE FAMILY DWELLING

4.  OTHER - SPECIFY: \_\_\_\_\_

Plumbing To Be Installed By:

1.  MASTER PLUMBER

2.  OIL BURNER MAN

3.  MFG'D HOUSING DEALER/MECHANIC

4.  PUBLIC UTILITY EMPLOYEE

5.  PROPERTY OWNER

LICENSE # \_\_\_\_\_

Number	Hook-Ups And Piping Relocation	Number	Column 2 Type of Fixture	Number	Column 1 Type of Fixture
	HOOK-UP: to public sewer in those cases where the connection is not regulated and inspected by the local Sanitary District.		Hosebibb / Silcock		Bathtub (and Shower)
			Floor Drain		Shower (Separate)
			Unna!		Sink
	HOOK-UP: to an existing subsurface wastewater disposal system.		Drinking Fountain		Wash Basin
			Indirect Waste		Water Closet (Toilet)
			Water Treatment Softener, Filter, etc.		Clothes Washer
	PIPING RELOCATION of sanitary lines, drains, and piping without new fixtures.		Grease/Oil Separator		Dish Washer
			Dental Cuspidor		Hazardous Disposal
			Bidet		Laundry Tub
	Hook-Ups (Subtotal)		Other: _____		Water Heater
\$	Hook-Up Fee		Fixtures (Subtotal) Column 2		Fixtures (Subtotal) Column 1

SEE PERMIT FEE SCHEDULE FOR CALCULATING FEE

TOWN COPY

Page 1 of 1  
ME 211 Rev. 4/83