

MERIDIAN STREET PEAKS ISLAND

85-B-8

NO. 10020
NEW YORK



(A) APARTMENT HOUSE ZONE
APPLICATION FOR PERMIT

PERMIT ISSUED
01452
JUN 23 1947

Class of Building or Type of Structure Third Class
Portland, Maine, June 21, 1947

To the INSPECTOR OF BUILDINGS, PORTLAND, MAINE

The undersigned hereby applies for a permit to ~~erect~~ alter ~~repair~~ ~~demolish~~ ~~rebuild~~ all the following building structure equipment in accordance with the Laws of the State of Maine, the Building Code and Zoning Ordinance of the City of Portland plans and specifications, if any, submitted herewith and the following specifications:

Location Veteran Street, Peaks Island Within Fire Limits? no Dist. No. _____
Owner's name and address Fred McKeel, Peaks Island Telephone _____
Lessee's name and address _____ Telephone _____
Contractor's name and address George Keening, Willow St., Peaks Island Telephone _____
Architect _____ Specifications _____ Plans no No of sheets _____
Proposed use of building Dwelling No. families 2
Last use _____ " _____ No. families 1
Material frame No. stories 1 1/2 Heat _____ Style of roof pitch Roofing _____
Other buildings on same lot _____
Estimated cost \$ 75. Fee \$ 50

General Description of New Work

to rebuild existing inside brick chimney.

95-B-7

INSPECTION NOT COMPLETED

CERTIFICATE OF COMPLIANCE
REQUIREMENT IS WAIVED

It is understood that this permit does not include installation of heating apparatus which is to be taken out separately by and in the name of the heating contractor.

Details of New Work

Is any plumbing involved in this work? _____ Is any electrical work involved in this work? _____
Height average grade to top of plate _____ Height average grade to highest point of roof _____
Size, front _____ depth _____ No. stories _____ solid or filled land? _____ earth or rock? _____
Material of foundation concrete Thickness, top _____ bottom _____ cellar _____
Material of underpinning _____ Height _____ Thickness _____
Kind of roof _____ rise per foot _____ Roof covering _____
No. of chimneys 1 Material of chimneys brick of lining tile Kind of heat stove fuel _____
Framing lumber—Kind _____ Dressed or full size? _____
Corner posts _____ Sills _____ Girt or ledger board? _____ Size _____
Girders _____ Size _____ Columns under girders _____ Size _____ Max. on centers _____
Studs (outside walls and carrying partitions) 2x4-16" O. C. Bridging in every floor and flat roof span over 8 feet.
Joists and rafters: 1st floor _____, 2nd _____, 3rd _____, roof _____
On centers: 1st floor _____, 2nd _____, 3rd _____, roof _____
Maximum span: 1st floor _____, 2nd _____, 3rd _____, roof _____
If one story building with masonry walls, thickness of walls? _____ height? _____

If a Garage

No. cars now accommodated on same lot _____, to be accommodated _____ number commercial cars to be accommodated _____
Will automobile repairing be done other than minor repairs to cars habitually stored in the proposed building? _____

APPROVED:

Miscellaneous

Will work require disturbing of any tree on a public street? no
Will there be in charge of the above work a person competent to see that the State and City requirements pertaining thereto are observed? yes

Fred McKeel

Signature of owner By: _____

George Keening

INSPECTION COPY

Permit No. 47/1452

Location Veteran St, Peabody.

Owner Fred McKeel

Date permit 6/ 142

Notif. closing-in

Inspn. closing-in

Final Notif.

Final Inspn.

Cert. of Occupancy issued

NOTES

INSPECTION NOT COMPLETE



City of Portland.

May 16th '12
1912

To the Inspector of Buildings of the City of Portland:

The undersigned respectfully makes application for a permit to erect enlarge a building on Peak Island street, at number Merriden to be _____ stories high _____ feet long, _____ feet wide; also an addition to be 1 stories high, 40 feet long, 10 feet wide, and to be used as a Dwelling

The material to be used in the erection enlargement of said building is to be as follows:

Exterior walls to be made of Wood

Roof to be made of Wood

Gutters to be made of Wood

Cornices to be made of Wood

Bay windows to be made of _____

Dormer windows to be made of _____

The builder is Jas. E. Anderson Address 297 Brackett St.

The architect is _____ Address _____

The owner is Jas. L. & Jas. E. Anderson Address 297 Brackett St.

Estimated Cost. \$100

(Applicant to sign here)

Jas. L. Anderson.

OFFICE OF
INSPECTOR OF BUILDINGS,
FOR THE
CITY OF PORTLAND.

OFFICE HOURS:
10-11 A. M. 4-8 P. M.

The above petition was granted the 16th day of May, 1912.

PERMIT NO. *Rybaus* ✓
DATE OF ISSUE *8-16-12*

LOCATION
Peaked Island

McKeenan St
Lot 1324, Arroyo

95-13-4
Peaked Island

EX-1915
N R
F. W. White

X

City of Portland, Maine - Building or Use Permit Application 389 Congress Street, 04101, Tel: (207) 874-8703, FAX: 874-8716

Location of Construction: Meridian St- Peaks Island		Owner: Kevin & Nancy Clark	Phone:	Permit No: 960241
Owner Address: 85-B-8 143 Westford St-Chelmsford		Leasee/Buyer's Name: MA	Phone:	Business Name:
Contractor Name: Weigel Construction, Inc		Address: Two Glen Rd- Fa'mouth ME 04105		PERMIT ISSUED Permit Issued: APR - 9 1996 CITY OF PORTLAND
Fast Use: 1-fam dwig w porch		Proposed Use: 1-fam dwlg w enclosed porch		
Proposed Project Description: enclose existing perch		COST OF WORK: \$5800	PERMIT FEE: \$ 50	Zone: GBL: 85-B-008 TR-2 Zoning Approval: OK PM 17-436 Special Zoning or Reviews: <input type="checkbox"/> Shoreland <input checked="" type="checkbox"/> Wetland 4/8/96 <input type="checkbox"/> Flood Zone <input type="checkbox"/> Subdivision <input type="checkbox"/> Site Plan <input type="checkbox"/> major <input type="checkbox"/> minor <input type="checkbox"/> mm <input type="checkbox"/>
		FIRE DEPT. <input type="checkbox"/> Approved <input type="checkbox"/> Denied	INSPECTION: Use Group Type: Signature: [Signature]	
		PEDESTRIAN ACTIVITIES DISTRICT (P.A.D.) Action: <input type="checkbox"/> Approved <input type="checkbox"/> Approved with Conditions: <input type="checkbox"/> Denied		
Permit Taken By: 4/2/96		Date Applied For: L Chase		

- This permit application doesn't preclude the Applicant(s) from meeting applicable State and Federal rules.
- Building permits do not include plumbing, septic or electrical work.
- Building permits are void if work is not started within six (6) months of the date of issuance. False information may invalidate a building permit and stop all work.

CERTIFICATION

I hereby certify that I am the owner of record of the named property, or that the proposed work is authorized by the owner of record and that I have been authorized by the owner to make this application as his authorized agent and I agree to conform to all applicable laws of this jurisdiction. In addition, if a permit for work described in the application issued, I certify that the code official's authorized representative shall have the authority to enter all areas covered by such permit at any reasonable hour to enforce the provisions of the code(s) applicable to such permit

SIGNATURE OF APPLICANT [Signature]	ADDRESS: 4/2/96	DATE: 781-5569	PHONE: [Signature]
RESPONSIBLE PERSON IN CHARGE OF WORK, TITLE [Signature]		PHONE:	

Zoning Appeal

Variance
 Miscellaneous
 Conditional Use
 Interpretation
 Approved
 Denied

Historic Preservation

Not in District or Landmark
 Does Not Require Review
 Requires Review

Action:

Approved
 Approved with Conditions
 Denied
 Date: [Signature]

CEO DISTRICT [Signature]

White-Permit Desk Green-Assessor's Canary-D.P.W. Pink-Public File Ivory Card-Inspector

City of Portland, Maine -- Building or Use Permit Application 389 Congress Street, 04101, Tel: (207) 874-8703, FAX: 874-8716

Location of Construction: 14 Meridian St- Peaks Island		Owner: Kevin & Nancy Clark		Phone:		Permit No: 960241
Owner Address: 85-3-B 143 Westford St-Chelsea		Leasee/Buyer's Name: MA		Phone:		
Contractor Name: Heigel Construction, Inc		Address: Two Glen Rd- Falmouth ME 04105		Phone:		PERMIT ISSUED APR - 9 1996 CITY OF PORTLAND
Past Use: 1-fam dwlg w porch		Proposed Use: 1-fam dwlg w enclosed porch		Business Name:		
Proposed Project Description: enclose existing porch		COST OF WORK: \$ 5800		PERMIT FEE: \$ 50		Zone: LR-2 CBL: 85-0-058 Zoning Approval: D16-Per 14-436 Special Zone or Reviews: <input type="checkbox"/> Shoreland <input type="checkbox"/> Wetland <input type="checkbox"/> Flood Zone <input type="checkbox"/> Subdivision <input type="checkbox"/> Site Plan maj <input type="checkbox"/> minor <input type="checkbox"/> mm <input type="checkbox"/>
Signature:		FIRE DEPT. <input type="checkbox"/> Approved <input type="checkbox"/> Denied		INSPECTION: Use Group 2 Type 2 Signature: <i>[Signature]</i>		
Signature:		PEDESTRIAN ACTIVITIES DISTRICT Action: <input type="checkbox"/> Approved <input type="checkbox"/> Approved with Conditions <input type="checkbox"/> Denied		Signature:		Zoning Appeal <input type="checkbox"/> Variance <input type="checkbox"/> Miscellaneous <input type="checkbox"/> Conditional Use <input type="checkbox"/> Interpretation <input type="checkbox"/> Approved <input type="checkbox"/> Denied
Date Applied For: 4/2/96		Date: L Chase		Signature:		

- This permit application doesn't preclude the Applicant(s) from meeting applicable State and Federal rules.
- Building permits do not include plumbing, septic or electrical work.
- Building permits are void if work is not started within six (6) months of the date of issuance. False information may invalidate a building permit and stop all work.

CERTIFICATION

I hereby certify that I am the owner of record of the named property, or that the proposed work is authorized by the owner of record and that I have been authorized by the owner to make this application as his authorized agent and I agree to conform to all applicable laws of this jurisdiction. In addition, if a permit for work described in the application issued, I certify that the code official's authorized representative shall have the authority to enter all areas covered by such permit at any reasonable hour to enforce the provisions of the code(s) applicable to such permit

SIGNATURE OF APPLICANT: *[Signature]* ADDRESS: **4/2/96** DATE: **781-5569** PHONE:

RESPONSIBLE PERSON IN CHARGE OF WORK, TITLE: **Ben Wang** PHONE:

White-Permit Desk Green-Assessor's Canary-D.P.W. Pink-Public File Ivory Card-Inspector

Action:

Approved
 Approved with Conditions
 Denied

Date: **4/19/96**

CEO DISTRICT: **CB**

A. R. Noble

COMMENTS

8.8.96 Job locks completed no access, etc

Type	Inspection Record	Date
Foundation:	_____	_____
Framing:	_____	_____
Plumbing:	_____	_____
Final:	_____	_____
Other:	_____	_____

Kevin + Nancy Clark
Meridian ST
Peaks Island, Me
 $\frac{1}{4}'' = 1'0''$

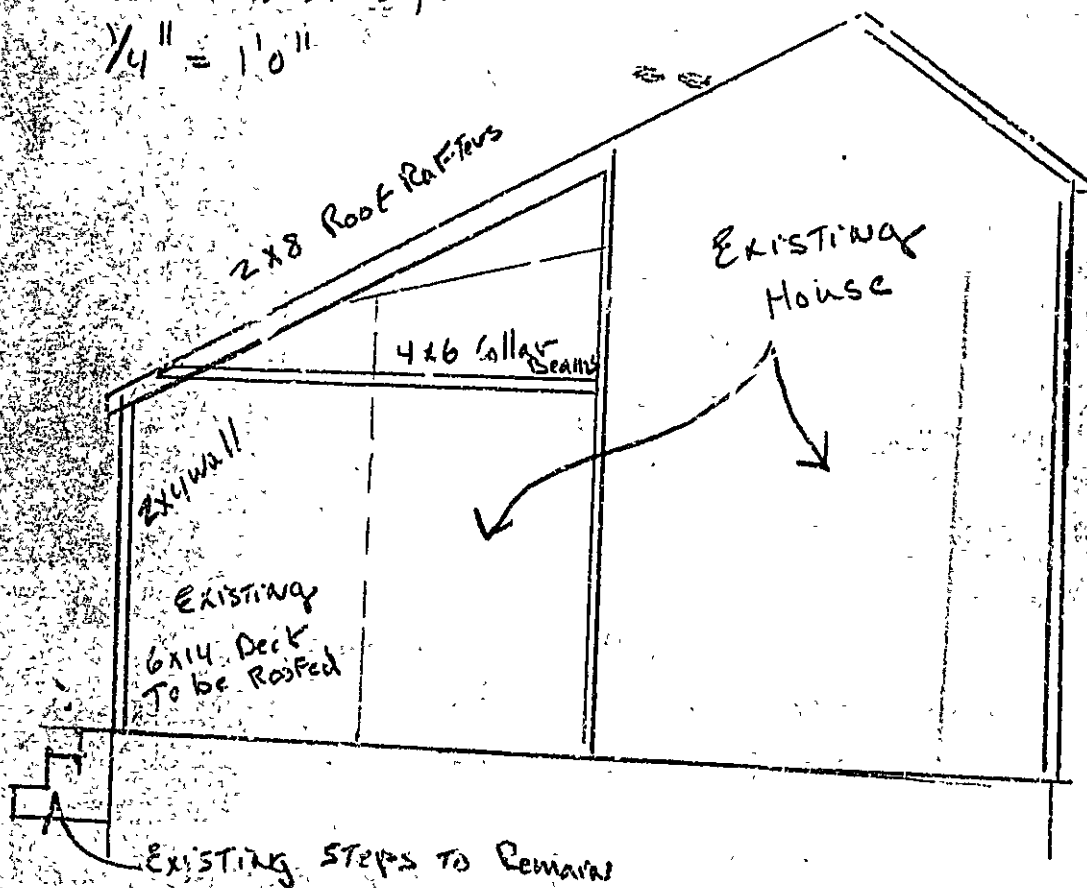

Floor Plan $\frac{1}{8}'' = 1'0''$

