

MERIDIAN STRLLT
85-B-6

PEAKS ISLAND

85-2028
CHAMBERLAIN



Permit No. **PERMIT IS 0645**

APPLICATION FOR PERMIT TO REPAIR BUILDING

Third Class Building

MAY 12 1937

Portland, Maine, May 12, 1937

To the INSPECTOR OF BUILDINGS, PORTLAND, ME.

The undersigned hereby applies for a permit to repair the following described building in accordance with the Laws of Maine, the Building Code of the City of Portland, and the following specifications:

Location Meridian & Veteran St., Peaks Island Within fire limits? no Dist. No. _____

Owner's name and address Mrs. Maudie MacNeil, Peaks Island Telephone _____

Contractor's name and address Owner Telephone no

Use of building Dwelling

No. stories 1 Height _____ ft., Gross area _____ sq. ft., Style of roof hip

Type of present roof covering Asphalt and wood shingles

General Description of New Work

To cover portion of roof

If Roof Covering is to be Repaired or Renewed

When last repaired? _____, Area then repaired _____ sq. ft.

Are repairs or renewal due to damage by fire? no If so, what area damaged? _____ sq. ft.

Area of roof to be repaired now? portion sq. ft.

Type of roofing to be used Asphalt No. plies _____

Trade name and grade of roof covering to be used Class C Und. Lab.

Estimated cost \$ _____ Fee \$.50

Mrs. Maudie MacNeil

Signature of owner by: Maudie MacNeil

INSPECTION COPY

93-573

Ward 2 Permit No. 39/645

Location Meridian + Wilson St. Parks

Owner Mrs. Maude Macfeil

Date of permit 6/12/39

Notif. closing-in

Inspn. closing-in

Final Notif.

Final Inspn.

Cert. of Occupancy issued None

NOTES

~~75~~

~~8~~

~~6~~

RECEIVED
MAY 3 1927
DEPT. OF U.L.D.C. INST.
CITY OF PORTLAND

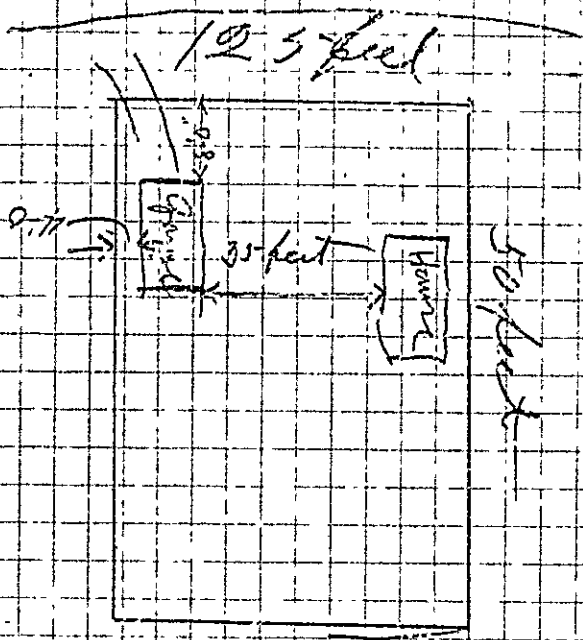

(A) APARTMENT HOUSE ZONE



(A) APARTMENT HOUSE ZONE
APPLICATION FOR PERMIT

Permit No. 0567

PERMIT ISSUED

Class of Building or Type of Structure 3rd

Portland, Maine, May 3 1927 MAY 6 1927

To the INSPECTOR OF BUILDINGS, PORTLAND, ME.

The undersigned hereby applies for a permit to erect ^{or alter} install the following building structure ^{equipment} in accordance with the Laws of the State of Maine, the Building Code of the City of Portland, plans and specifications, if any, submitted herewith and the following specifications:

Location Meridian St. Pears Island Ward 1 Within Fire Limits? no Dist. No. -

Owner's or Lessee's name and address Mr. and Mrs. A. F. Mackell Meridian St. Telephone 5E-2

Contractor's name and address _____ Telephone _____

Architect's name and address _____ No. families _____

Proposed use of building Garage 1 Car

Other building on same lot dwelling house

Description of Present Building to be Altered

Material _____ No. stories _____ Heat _____ Style of roof _____ Roofing _____

Last use _____ No. families _____

General Description of New Work

This is to be made of 2x3 ^{up} ~~through~~ ^{and} covered with canvas to protect car from weather

CERTIFICATE OF OCCUPANCY
REQUIREMENT IS WAIVED.
NOTIFICATION BEFORE LATHING
OR CLADDING IS NOT REQUIRED.

Details of New Work

Size, front 9 depth 16 No. stories 1 Height average grade to highest point of roof 8

To be erected on solid or filled land? solid earth or rock? earth

Material of foundation none Thickness, top _____ bottom _____

Material of underpinning _____ Height _____ Thickness _____

Kind of roof canvas Roof covering canvas

No. of chimneys _____ Material of chimneys _____ of lining _____

Kind of heat _____ Type of fuel _____ Distance, heater to chimney _____

If oil burner, name and model _____

Capacity and location of oil tanks _____

Is gas fitting involved? _____ Size of service _____

Corner posts 2x3 Sills none Girt or ledger board? _____ Size _____

Studs (outside walls and carrying partitions) 2x4-16" O.C. Girders 6x6 or larger. Bridging in every floor and flat roof span over 8 feet. Sills and corner posts all one piece in cross section.

Joists and rafters: 1st floor 3x4, 2nd _____, 3rd _____, roof 2x3

On centers: 1st floor _____, 2nd _____, 3rd _____, roof _____

Maximum span: 1st floor _____, 2nd _____, 3rd _____, roof _____

If one story building with masonry walls, thickness of walls? _____ height? _____

If a Garage

No. cars now accommodated on same lot no to be accommodated 1

Total number commercial cars to be accommodated no

Will automobile repairing be done other than minor repairs to cars habitually stored in the proposed building? no

Miscellaneous

Will above work require removal or disturbing of any shade tree on a public street? no

Plans filed as part of this application? yes No. sheets 1

Estimated cost \$ 10 Fee \$.25

Will there be in charge of the above work a person competent to see that the State and City requirements pertaining thereto are observed? yes

Signature of owner _____

INSPECTION COPY

William P. Sauton
CHIEF OF FIRE DEPT.

3452

Ward 1 Permit No. 271357 H

Location Mexican St. Kirk

On Mr. Maud Maud Kirk

Date of permit May 6/27

Notif. closing-in _____

If _____ing-in _____

Final Notif. _____

Final Insp. 6/11/27

Cert. of Occupancy issued _____

NOTES



APPLICATION FOR PERMIT TO REPAIR BUILDING

PERMIT ISSUED

Permit No. 05-1

4th Class Building

Portland, Maine, 11-27 5-3-27 MAY 3 1927

To the INSPECTOR OF BUILDINGS, PORTLAND, ME.
The undersigned hereby applies for a permit to repair the following described building in accordance with the
Laws of Maine, the Building Code of the City of Portland, and the following specifications:

Location Meridian St. E. I. Ward 1 Within fire limits? no Dist. No. -
Owner's name and address Mrs. Vera Mae Hall Meridian St. Telephone 65-8
Contractor's name and address A. F. MacKoll Sr. Telephone -

Use of building dwelling house sq. ft., Gross area - sq. ft., Style of roof gitar
No. stories 1 Height - ft.
Type of present roof covering wood

General Description of New Work

Recover portion of roof with asphalt shingles

If Roof-Covering is to be Repaired or Renewed

When last repaired? - Area then repaired - sq. ft.
Are repairs or renewal due to damage by fire? no If so, what area damaged? - sq. ft.
Area of roof to be repaired now? - sq. ft.
Type of roofing to be used asphalt shingles No. plies - sq. ft.
Trade name and grade of roof covering to be used Class # 0 # underwriters Fee \$.60
Estimated cost \$ - Signature of owner -

INSPECTION COPY

3457

Word 1 Permit No. 27/371
 Location Meridian St. Rd
 Owner Miss Maud W. Keil
 Date of permit 5/3/27
 Notif. closing-in _____
 Inspn. closing-in _____
 Final Notif. _____
 Final Inspn. 6/12/27
 Cert. of Occupancy issued _____

NOTES

ON FOR PERMIT TO REPAIR BUILDING
 DENY

INSPECTION CODE

27 made of water