

OAK AVE., PEAKS ISLAND

84-V-8-9

84-1-8-9



FILL IN AND SIGN WITH INK

APPLICATION FOR PERMIT FOR HEATING, COOKING OR POWER EQUIPMENT

Portland, Maine, June 24, 1948

PERMIT ISSUED 01070 CITY of PORTLAND

To the INSPECTOR OF BUILDINGS, PORTLAND, MAINE

The undersigned hereby applies for a permit to install the following heating, cooking or power equipment in accordance with the Laws of Maine, the Building Code of the City of Portland, and the following specifications:

Location Oak Ave., Peaks Island Use of Building Dwelling No. Stories New Building 84-1-8-9 Name and address of owner of appliance Mrs. Edith Stites, Peaks Island Installer's name and address The Paine Co., 411 Fore Street Telephone 3-6671

General Description of Work

To install forced warm air heating system and oil burner

IF HEATER, OR POWER BOILER

Location of appliance or source of heat basement Type of floor beneath appliance concrete If wood, how protected? Kind of fuel oil Minimum distance to wood or combustible material, from top of appliance or casing top of furnace 2' From top of smoke pipe 2' From front of appliance Over 4' From sides or back of appliance Over 3' Size of chimney flue 8x10 Other connections to same flue none If gas fired, how vented? Rated maximum demand per hour

IF OIL BURNER

Name and type of burner Mayflower Labelled by underwriter's laboratories? yes Will operator be always in attendance? Does oil supply line feed from top or bottom of tank? bottom Type of floor beneath burner concrete Location of oil storage basement Number and capacity of tanks 1-275 gal. If two 275-gallon tanks, will three-way valve be provided? Will all tanks be more than five feet from any flame? yes How many tanks fire proofed? Total capacity of any existing storage tanks for furnace burners none

IF COOKING APPLIANCE

Location of appliance Kind of fuel Type of floor beneath appliance If wood, how protected? Minimum distance to wood or combustible material from top of appliance From front of appliance From sides and back From top of smokepipe Size of chimney flue Other connections to same flue Is hood to be provided? If so, how vented? If gas fired, how vented? Rated maximum demand per hour

MISCELLANEOUS EQUIPMENT OR SPECIAL INFORMATION

Amount of fee enclosed? 1.00 (\$1.00 for one heater, etc., 50 cents additional for each additional heater, etc., in same building at same time.)

APPROVED:

[Signature]

Will there be in charge of the above work a person competent to see that the State and City requirements pertaining thereto are observed? yes

The Paine Co.

Signature of Installer By:

[Signature: James Wright]

INSPECTION COPY

Permit No. 48/1070
Location Oak Ave, Peaks Island
Owner Mrs Edith Stites
Date of permit 6/26/48
Approved 10/20/48, J. G.

NOTES

- 1. Fill Pipe
- 2. Vent Pipe
- 3. Kind of Heat forced warm air
- 4. Burner Rigidity & Support
- 5. Name & Label
- 6. Stack Control
- 7. High Limit Control
- 8. Remote Control
- 9. Piping Support & Protection
- 10. Valves in Supply Line
- 11. Cap of Tank
- 12. Tank Rigidity & Support
- 13. Tank Distance
- 14. Oil Gauge
- 15. Instruction Card
- 16.

2/3/48. Initial Rain coat that
should be provided over
plenum chamber, 4"
clearance, also separate
remote control switch,
non-exposed inside
guide, etc.
10/20/48. Remote control
reluctant to work on
stairway, should use
plenum chamber, etc.
If burner tank will permit
should have flow guide
etc.

4/8/48. Installation under
supper dit note on tag
regards plenum to clear
clearance, and 2" clearance
if fuel line to the
condensible material
J. G.

PEAKS ISLAND

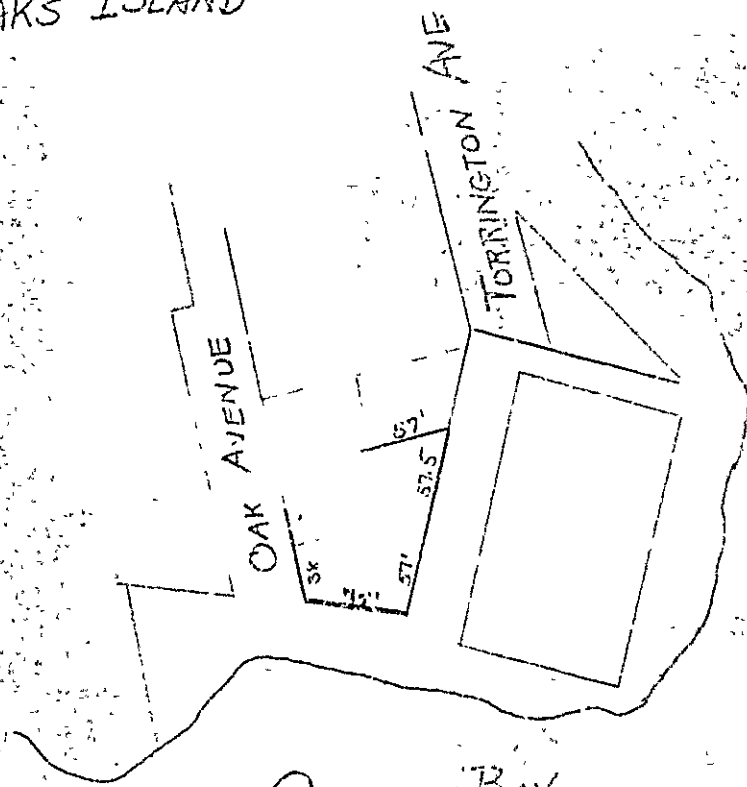

CASCO BAY

STATEMENT ACCOMPANYING APPLICATION FOR BUILDING PERMIT

for Dwelling house
at Peaks Island, Maine Date 4/10/48

1. In whose name is the title of the property now recorded? Mrs. Edith Stiles
2. Are the boundaries of the property in the vicinity of the proposed work shown clearly on the ground, and how? No
3. Is the outline of the proposed work now staked out upon the ground? No If not, will you notify the Inspection Office when the work is staked out and before any of the work is commenced? Yes
4. What is to be maximum projection or overhang of eaves or drip? 11"
5. Do you assume full responsibility for the correctness of the location plan or statement of location filed with this application, and does it show the complete outline of the proposed work on the ground, including bay windows, porches and other projections? Yes
6. Do you assume full responsibility for the correctness of all statements in the application concerning the size, design and use of the proposed building? Yes
7. Do you understand that in case changes are proposed in the location of the work or in any of the details specified in the application that a revised plan and application must be submitted to this office before the changes are made? Yes

W. B. Johnson

COPY
COPY



CITY OF PORTLAND, MAINE
Department of Building Inspection

Certificate of Occupancy

Issued to Mrs. Edith Stites

Date of Issue October 21, 1948

This is to certify that the building, premises, or part thereof, indicated below, and built under Building Permit No. 48/491 at Oak Avenue, Peaks Island (Assessors Lot No. 24-V-0-9) has had final inspection, has been found to conform substantially to requirements of Zoning Ordinance and Building Code of the City, and is hereby approved for occupancy, limited or otherwise, as indicated below.

PORTION OF BUILDING OR PREMISES
Entire Building

APPROVED OCCUPANCY
One-family Dwelling House

Limiting Conditions:

This certificate supersedes certificate issued

Inspector of Buildings

Notice: This certificate identifies lawful use of building or premises, and ought to be transferred from owner to owner when property changes hands. Cop. will be furnished to owner or lessee for one dollar.

AP Torrington Point-Peaks
Island-1

April 14, 1945

E. G. Johnson Company
3 Cliff Company
Portland, Maine

Subject: Re. It for construction of one-
story wood frame dwelling at Torrington
Point, Peaks Island

Gentlemen:

The permit for the above work is issued herewith subject to the following:

1. Whenever there is to be excavation inside the foundation wall or the wall will be called upon to withstand retaining action from the earth outside the wall, no less than 12" thick concrete blocks as given in application are required. A concrete footing no less than 12" in depth is required for the support of this wall. If a poured concrete wall is used, the minimum thickness allowable is 10" at the grade and 12" at the bottom.
2. No framing of porch floor is shown. Sills are required to be at least 4x6, all one piece in cross section with floor timbers resting on top of them or notched over 2x3 nailing strips nailed to the sides of them.
3. It is not clear whether there is to be more than one flue in the chimney. While not expressly forbidden by the Building Code, connection of a furnace to the same flue that serves a fireplace is considered bad practice, both from the standpoint of efficient operation and from the fire safety angle. If not already planned for, we strongly recommend that two flues be provided in this chimney.

Very truly yours,

Inspector of Buildings

AJ3/S

CC: Mrs. Leith Stiles
Peaks Island, Maine

P.S. With reference to Paragraph #1, only cement mortar is to be used below grade.



(A) APARTMENT HOUSE ZONE
APPLICATION FOR PERMIT

Class of Building or Type of Structure Third Class

PERMIT ISSUED
00491
APR 14 1948
CITY OF PORTLAND

Portland, Maine, April 10, 1948

To the INSPECTOR OF BUILDINGS, PORTLAND, ME.

The undersigned hereby applies for a permit to erect ~~and repair~~ ^{erect} the following building ~~and accessories~~ in accordance with the Laws of the State of Maine, the Building Code and Zoning Ordinance of the City of Portland, plans and specifications, if any, submitted herewith and the following specifications:

Location Farrington Point Pt. V-8-9 0th Avenue Within Fire Limits? _____ Dist. No. _____

Owner's name and address Mrs. Edith Stites, Peaks Island, Maine Telephone _____

Lessee's name and address _____ Telephone _____

Contractor's name and address E. G. Johnson's, 5 Cliff Street Telephone 3-1630

Architect _____ Specifications _____ Plans yes No. of sheets 3

Proposed use of building 2x Dwelling house No. families 2.1

Last use _____ No. families _____

Material _____ No. stories _____ Heat _____ Style of roof _____ Roofing _____

Other buildings on same lot _____

Estimated cost \$ 6,000 Fee \$ 4.00

General Description of New Work

To erect one-story frame dwelling 34' x 54'.
Sheetrock walls and ceiling.

Permit Issued with Letter

It is understood that this permit does not include installation of heating apparatus which is to be taken out separately by and in the name of the heating contractor.

Details of New Work

Is any plumbing work involved in this work? yes Is any electrical work involved in this work? yes

Height average grade to top of plate 18' Height average grade to highest point of roof 20'

Size, front 54' depth 34' No. stories 1 solid or filled land? solid earth or rock? rock

Material of foundation Concrete block Thickness, top 12" bottom 12" cellar yes

Material of underpinning concrete block Height at least 4' below grade Thickness 8"

Kind of roof Pitch Rise per foot 6" Roof covering Asphalt Class C Und. Lab.

No. of chimneys 1 Material of chimneys brick of lining tile Kind of heat hot air fuel oil

Framing lumber—Kind henlock Dressed or full size? dressed

Corner posts 4x6 Sills 4x6 Girt or ledger board? _____ Size _____

Girders yes Size 5x8 Columns under girders Lally Size 3 1/2" Max. on centers 24"

Studs (outside walls and carrying partitions) 2x4-16" O. C. Bridging in every floor and (flat roof span over 8 feet, ceiling)

Joists and rafters: 1st floor 2x10, 2nd _____, 3rd 2x6, roof 2x8

On centers: 1st floor 16", 2nd _____, 3rd 24", roof 24"

Maximum span: 1st floor 13', 2nd _____, 3rd 13', roof 13'

Is one story building with masonry walls, thickness of walls? _____ height? _____

If a Garage

No. cars now accommodated on same lot _____, to be accommodated _____ number commercial cars to be accommodated _____

Will automobile repairing be done other than minor repairs to cars habitually stored in the proposed building? _____

APPROVED:

[Signature Lines]

Miscellaneous

Will work require disturbing of any tree on a public street? no
Will there be in charge of the above work a person competent to see that the State and City requirements pertaining thereto are observed? yes

Mrs. Edith Stites

Signature of owner by: E. G. Johnson

INSPECTION COPY

Permit No 487 491
Location Torrington Point Beach
Owner Mass. Health Dept.
Date of permit 4/14/48
Notif. closing-in 7/7/48 (9.25)
Inspn. closing-in 7/14/48 B.T. M.
Final Notif. 10/14/48 Wash of Cottrell
Final Inspn 10/20/48 S.C.
Cert. of Occupancy issued 10/21/48

NOTES

~~7/14/48. Silt B.T. with water
removed following clean
only after pump and
electrical work a.k.
insulation around outside
walls of air parcel and
stock at floor and ceiling
Panel wall adjacent to
is removed 9" above outlet
8 1/2" x 4" wood along
further on floor etc.~~



APPLICATION FOR PERMIT

PERMIT ISSUED
0731

Permit No. _____
MAY 26 1911

Class of Building or Type of Structure _____

Portland, Maine, May 26, 1911

To the INSPECTOR OF BUILDINGS, PORTLAND, ME.

The undersigned hereby applies for a permit to erect alter install the following building structure equipment in accordance with the laws of the State of Maine, the Building Code of the City of Portland, plans and specifications, if any, submitted herewith and the following specifications:

Location Warrington Point, Peaks Island Within Fire Limits? no Dist. No. _____
 Owner's or Lessee's name and address Mrs. Frank Jewett, 54 West St. Telephone _____
 Contractor's name and address Henry Prockett, 88 West St. Telephone no. _____
 Architect _____ Plans filed _____ No. of sheets _____
 Proposed use of building _____ No. families _____
 Other buildings on same lot _____ Fed \$ _____ 50

Estimated cost \$ _____
 Description of Present building to be Altered
 Material wood N. stories 2 Heat _____ Style of roof _____ Roofing _____
 Last use 1 car garage No. families _____

General Description of New Work
To demolish building 12' x 15' no sewer connection

It is understood that this permit does not include installation of heating apparatus which is to be taken out separately by and in the name of the heating contractor.

Details of New Work

Is any plumbing work involved in this work? _____
 Is any electrical work involved in this work? _____ Height average grade to top of plate _____
 Size, front _____ depth _____ No. stories _____ Height average grade to highest point of roof _____
 To be erected on solid or filled land? _____ earth or rock? _____
 Material of foundation _____ Thickness, top _____ bottom _____ cellar _____
 Material of underpinning _____ Height _____ Thickness _____
 Kind of roof _____ Rise per foot _____ Roof covering _____
 No. of chimneys _____ Material of chimneys _____ of lining _____
 Kind of heat _____ Type of fuel _____ Gas fitting involved? _____
 Framing lumber Kind _____ Dressed or mill size? _____
 Corner posts _____ Sills _____ Girt or ledger board? _____ Size _____
 Material columns under girders _____ Size _____ Max. on centers _____
 Studs (outside walls and carrying partitions) 2 1/4" x 6" O.C. Girders 6x8 or larger. Bridging in every floor and flat roof span over 8 feet. Sills and corner posts all one piece in cross section.
 Joists and rafters: 1st floor _____, 2nd _____, 3rd _____, roof _____
 On centers: 1st floor _____, 2nd _____, 3rd _____, roof _____
 Maximum span: 1st floor _____, 2nd _____, 3rd _____, roof _____
 If one story building with masonry walls, thickness of walls? _____ height? _____

If a Garage

No. cars now accommodated on same lot _____ to be accommodated _____
 Total number commercial cars to be accommodated _____
 Will automobile repairing be done other than minor repairs to cars habitually stored in the proposed building? _____

Miscellaneous

Will above work require removal or disturbing of any shade tree on a public street? no
 Will there be in charge of the above work a person competent to see that the State and City requirements pertaining thereto are observed? yes
 Signature of owner Mrs. Frank Jewett

INSPECTION COPY

By _____

Henry Prockett

7519C

Permit No 41/731
Location Townington Pt. Peaks
Owner Mr. Hank Jewett
Date of permit 3/26/41
Notif. closing-in _____
Inspn closing-in _____
Final Notif. _____
Final Inspn: INSPECTION NOT COMPLETED
Cert. of Occupancy issued _____

NOTES



City of Portland.

July 1st, 1911

To the Inspector of Buildings of the City of Portland:

The undersigned respectfully makes application for a permit to erect enlarge a building on ~~Terrinton Point~~ street, at number **Peaks Island** to be **One** stories high **Sixteen** feet long, **Twelve** feet wide; also an addition to be stories high, feet long, feet wide, and to be used as a **Garage**

The material to be used in the erection enlargement of said building is to be as follows:

Exterior walls to be made of **Wood**
 Roof to be made of **Wood**
 Gutters to be made of **Wood**
 Cornices to be made of **Wood**

Bay windows to be made of

Dormer windows to be made of

The builder is **B. Howatt & Son** Address **Bracckett St.**

The architect is **F. W. Jewett** Address **City.**

The owner is Address

(Applicant to sign here) **B. Howatt & Son.**

OFFICE OF
 INSPECTOR OF BUILDINGS,
 FOR THE
 CITY OF PORTLAND.
 OFFICE HOURS:
 12:15 P.M. - 4 P.M.

The above petition was granted the... day of . . . 1911

Oak ^{Co.} Tarrington Pt. ✓
Peaks Is.
Jenett
84-1-8-9

W. Jenett

Peaks Island
Tarrington Point

PERMIT NO. 8748
DATE OF ISSUE 7-6-73
LOCATION
Peaks Island