

GREENWOOD ST., PEAKS ISL.

84-3-7



APPLICATION FOR PERMIT

PERMIT ISSUED

07-174

AUG 19 1960

Class of Building or Type of Structure

Third Class

Portland, Maine

August 19, 1960

CITY of PORTLAND

To the INSPECTOR OF BUILDINGS, PORTLAND, MAINE

The undersigned hereby applies for a permit to erect alter repair demolish install the following building structure equipment in accordance with the Laws of the State of Maine, the Building Code and Zoning Ordinance of the City of Portland, plans and specifications, if any, submitted herewith and the following specifications:

Location Greenwood St., Peaks Island Within Fire Limits? _____ Dist. No. _____
 Owner's name and address George Trueworthy, Peaks Island Telephone _____
 Lessee's name and address _____ Telephone _____
 Contractor's name and address Roland Hoar, Peaks Island Telephone _____
 Architect _____ Specifications _____ Plans no. _____ No. of sheets _____
 Proposed use of building Dwelling No. families 1
 Last use _____ " _____ No. families 1
 Material Frame No. stories 1 1/2 Heat _____ Style of roof _____ Roofing _____
 Other buildings on same lot _____ Fee \$ 50 --
 Estimated cost \$ 40 --

General Description of New Work

To cut in new window first floor for ventilation of new toilet room (room existing) - (1 1/2" x 22")

It is understood that this permit does not include installation of heating apparatus which is to be taken out separately by and in the name of the heating contractor. PERMIT TO BE ISSUED TO Roland Hoar

Details of New Work

Is any plumbing involved in this work? _____ Is any electrical work involved in this work? _____
 Is connection to be made to public sewer? _____ If not, what is proposed for sewage? _____
 Has septic tank notice been sent? _____ Form notice sent? _____
 Height average grade to top of plate _____ Height average grade to highest point of roof _____
 Size, front _____ depth _____ No. stories _____ solid or _____ 'ed land? _____ earth or rock? _____
 Material of foundation _____ Thickness, top _____ bottom _____ cellar _____
 Material of underpinning _____ Height _____ Thickness _____
 Kind of roof _____ Rise per foot _____ Roof covering _____
 No. of chimneys _____ Material of chimneys _____ of fluing _____ Kind of heat _____ fuel _____
 Framing Lumber--Kind _____ Dressed or full size? _____ Corner posts _____ Sills _____
 Size Girder _____ Columns under girders _____ Size _____ Max. on centers _____
 Kind and thickness of outside sheathing of exterior walls? _____
 Studs (outside walls and carrying partitions) 2x4-16" O. C. Bridging in every floor and flat roof span over 8 feet.
 Joists and rafters: 1st floor _____, 2nd _____, 3rd _____, roof _____
 On centers: 1st floor _____, 2nd _____, 3rd _____, roof _____
 Maximum span: 1st floor _____, 2nd _____, 3rd _____, roof _____
 If one story building with masonry walls, thickness of walls? _____ height? _____

If a Garage

No. cars now accommodated on same lot _____, to be accommodated _____ number commercial cars to be accommodated _____
 Will automobile repairing be done other than minor repairs to cars habitually stored in the proposed building? _____

Miscellaneous

Will work require disturbing of any tree on a public street? no
 Will there be in charge of the above work a person competent to see that the State and City requirements pertaining thereto are observed? yes George Trueworthy

APPROVED:

OK - 8/19/60 - ags

Signature of owner By: Roland Hoar

INSPECTION COPY

PW

Permit No. 601 1174
 Location Greenwood St. Park, Ill.
 Owner George Truonitly
 Date of permit 8/19/60
 Notif. closing-in _____
 Inspn. closing-in _____
 Final Notif. _____
 Final Inspn. _____
 Cert. of Occupancy issued _____
 Staking Out Notice _____
 Form Check Notice _____

NOTES

5/23/60 - Memo
made. JST

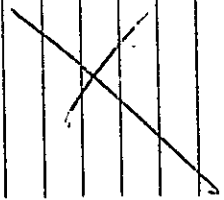



FILL IN AND SIGN WITH INK

APPLICATION FOR PERMIT FOR HEATING, COOKING OR POWER EQUIPMENT

Portland, Maine, Nov. 12, 1959

PERMIT 1551

NOV 13 1959

CITY of PORTLAND

To the INSPECTOR OF BUILDINGS, PORTLAND, ME.

The undersigned hereby applies for a permit to install the following heating, cooking or power equipment in accordance with the Laws of Maine, the Building Code of the City of Portland, and the following specifications:

Location Greenwood St. Peaks Island Use of Building dwelling No. Stories 1 New Building Existing
Name and address of owner of appliance Geo. R. Frueworthy, Warbling Rd. Cape Eliz.
Installer's name and address Gould Farmer Co., 70 Free St. Telephone 3-8187

General Description of Work

To install oil burner in connection to existing steam heat - replacement

IF HEATER, OR POWER BOILER

Location of appliance Any burnable material in floor surface or beneath?
If so, how protected? Kind of fuel?
Minimum distance to burnable material, from top of appliance or casing top of furnace
From top of smoke pipe From front of appliance From sides or back of appliance
Size of chimney flue Other connections to same flue
If gas fired, how vented? Rated maximum demand per hour
Will sufficient fresh air be supplied to the appliance to insure proper and safe combustion?

IF OIL BURNER

Name and type of burner Petro gun type Labeled by underwriters' laboratories? yes
Will operator be always in attendance? Does oil supply line feed from top or bottom of tank? bottom
Type of floor beneath burner cement Size of vent pipe 1 1/4"
Location of oil storage basement Number and capacity of tanks 1- 275 gal.
Low water shut off yes Male existing No
Will all tanks be more than five feet from any flame? yes How many tanks enclosed?
Total capacity of any existing storage tanks for furnace burners

IF COOKING APPLIANCE

Location of appliance Any burnable material in floor surface or beneath?
If so, how protected? Height of Legs, if any
Skirting at bottom of appliance? Distance to combustible material from top of appliance?
From front of appliance From sides and back From top of smokepipe
Size of chimney flue Other connections to same flue
Is hood to be provided? If so, how vented? Forced or gravity?
If gas fired, how vented? Rated maximum demand per hour

MISCELLANEOUS EQUIPMENT OR SPECIAL INFORMATION

.....
.....
.....
.....
.....

Amount of fee enclosed? 2.00 (\$2.00 for one heater, etc., 50 cents additional for each additional heater, etc., in same building at same time.)

APPROVED:
-OK E.S.S. 11/12/59

Will there be in charge of the above work a person competent to see that the State and City requirements pertaining thereto are observed? yes

Gould Farmer Co.

By: [Signature]

CS 300

INSPECTION COPY

Signature of Installer

1954
10000

NOTES

No.	Part	Description	Quantity	Remarks
1	13	13		
2	14	14		
3	15	15		
4	16	16		
5	17	17		
6	18	18		
7	19	19		
8	20	20		
9	21	21		
10	22	22		
11	23	23		
12	24	24		
13	25	25		
14	26	26		
15	27	27		
16	28	28		
17	29	29		
18	30	30		
19	31	31		
20	32	32		
21	33	33		
22	34	34		
23	35	35		
24	36	36		
25	37	37		
26	38	38		
27	39	39		
28	40	40		
29	41	41		
30	42	42		
31	43	43		
32	44	44		
33	45	45		
34	46	46		
35	47	47		
36	48	48		
37	49	49		
38	50	50		
39	51	51		
40	52	52		
41	53	53		
42	54	54		
43	55	55		
44	56	56		
45	57	57		
46	58	58		
47	59	59		
48	60	60		
49	61	61		
50	62	62		
51	63	63		
52	64	64		
53	65	65		
54	66	66		
55	67	67		
56	68	68		
57	69	69		
58	70	70		
59	71	71		
60	72	72		
61	73	73		
62	74	74		
63	75	75		
64	76	76		
65	77	77		
66	78	78		
67	79	79		
68	80	80		
69	81	81		
70	82	82		
71	83	83		
72	84	84		
73	85	85		
74	86	86		
75	87	87		
76	88	88		
77	89	89		
78	90	90		
79	91	91		
80	92	92		
81	93	93		
82	94	94		
83	95	95		
84	96	96		
85	97	97		
86	98	98		
87	99	99		
88	100	100		

Permit No. 57V 1707

Location Mexico City, D.F.

Owner Pea R. S. S. S. S. S.

Date of permit 11/13/59

Approved _____

4/11/60 - M. S. S. S. S.

Kind of fuel	
From front of appliance	
From top of smoke pipe	
Size of chimney	
Will appliance be used in a building in which it is intended to be used?	
Where and how to be used	
Will burning be done in accordance with instructions?	
Type of fuel	
How many times enclosed?	
APPLIANCE	
APPLIANCE	
APPLIANCE	



FILL IN AND SIGN WITH INK

APPLICATION FOR PERMIT FOR HEATING, COOKING OR POWER EQUIPMENT

PERMIT ISSUED

01530 SEP 22 1954

CITY of PORTLAND

Portland, Maine, Sept. 22, 1954

To the INSPECTOR OF BUILDINGS, PORTLAND, MAINE

The undersigned hereby applies for a permit to install the following heating, cooking or power equipment in accordance with the Laws of Maine, the Building Code of the City of Portland, and the following specifications:

Location Greenwood St., Peaks Island of Building dwelling house No. Stories 84-5-7 Building Existing
Name and address of owner of appliance Harry Wallace, 34 Ocean View Ave., So. Portland
Installer's name and address Harry Cary I Co., 386 Cumberland Ave. Telephone 2-7111

General Description of Work

To install steam boiler (replacement)

IF HEATER, OR POWER BOILER

Location of appliance basement Any burnable material in floor surface or beneath? no
If so, how protected? Kind of fuel? oil
Minimum distance to burnable material, from top of appliance or casing top of furnace 2'
From top of smoke pipe 15" From front of appliance over 4' From sides or back of appliance over 3'
Size of chimney flue 8x8 Other connections to same flue none
If gas fired, how vented? Rated maximum demand per hour
Will sufficient fresh air be supplied to the appliance to insure proper and safe combustion? yes

IF OIL BURNER by other

Name and type of burner Labeled by underwriter's laboratories?
Will operator be always in attendance? Does oil supply line feed from top or bottom of tank?
Type of floor beneath burner Size of vent pipe
Location of oil storage Number and capacity of tanks
Low water shut off yes Make McDonnell Miller No. 67
Will all tanks be more than five feet from any flame? How many tanks enclosed?
Total capacity of any existing storage tanks for furnace burners

IF COOKING APPLIANCE

Location of appliance Any burnable material in floor surface or beneath?
If so, how protected? Height of Legs, if any
Skirting at bottom of appliance? Distance to combustible material from top of appliance?
From front of appliance From sides and back From top of smokepipe
Size of chimney flue Other connections to same flue
Is hood to be provided? If so, how vented? Forced or gravity?
If gas fired, how vented? Rated maximum demand per hour

MISCELLANEOUS EQUIPMENT OR SPECIAL INFORMATION

Amount of fee enclosed? 2.00 (\$2.00 for one heater, etc., 50 cents additional for each additional heater, etc., in same building at same time.)

APPROVED: 9.22.54

Will there be in charge of the above work a person competent to see that the State and City requirements pertaining thereto are observed? yes

Harry Carvel Co.

Signature of Installer by: Harry Carvel Co. by D. Carvel

INSPECTION COPY

SETON

APPLICATION FOR PERMIT FOR

APPROVED

DATE OF PERMIT

OWNER

LOCATION

PERMIT NO.

TO

APPROVED

DATE OF PERMIT

OWNER

LOCATION

PERMIT NO.

TO

APPROVED

DATE OF PERMIT

OWNER

LOCATION

PERMIT NO.

TO

RECEIVED
 APPLICATIONS
 DIVISION
 COMPLETED

7-13
 77

1. Kind of fuel

2. In what top of furnace

3. From top of furnace

4. From side or back of furnace

5. Will sufficient fuel be supplied to the furnace

6. Will sufficient fuel be supplied to the furnace

7. Will sufficient fuel be supplied to the furnace

8. Will sufficient fuel be supplied to the furnace

9. Will sufficient fuel be supplied to the furnace

10. Will sufficient fuel be supplied to the furnace

11. Will sufficient fuel be supplied to the furnace

12. Will sufficient fuel be supplied to the furnace

13. Will sufficient fuel be supplied to the furnace

14. Will sufficient fuel be supplied to the furnace

15. Will sufficient fuel be supplied to the furnace

1. Kind of fuel

2. In what top of furnace

3. From top of furnace

4. From side or back of furnace

5. Will sufficient fuel be supplied to the furnace

6. Will sufficient fuel be supplied to the furnace

7. Will sufficient fuel be supplied to the furnace

8. Will sufficient fuel be supplied to the furnace

9. Will sufficient fuel be supplied to the furnace

10. Will sufficient fuel be supplied to the furnace

11. Will sufficient fuel be supplied to the furnace

12. Will sufficient fuel be supplied to the furnace

13. Will sufficient fuel be supplied to the furnace

14. Will sufficient fuel be supplied to the furnace

15. Will sufficient fuel be supplied to the furnace



APPLICATION FOR PERMIT PERMIT ISSUED

Class of Building or Type of Structure third class

Permit No. 1326
OCT 24 1942

Portland, Maine, October 21, 1942

To the INSPECTOR OF BUILDINGS, PORTLAND, ME.

The undersigned hereby applies for a permit to add alter install the following building structure in accordance with the Laws of the State of Maine, the Building Code of the City of Portland, plans and specifications, if any, and the following specifications:

Location Oregonwood Street, Peaks Island Within Fire Limits? no Dist. No. _____
 Owner's or Lessee's name and address Guy Coburn, Auburn, Me. Me. Telephone _____
 Contractor's name and address George Keening, Willow St. Telephone _____
 Architect _____ Plans filed _____ No. of sheets _____
 Proposed use of building Camp No. families _____
 Other buildings on same lot dwelling house
 Estimated cost \$ 50 Fee \$ 50

Description of Present Building to be Altered

Material wood No. stories 1 Heat stove Style of roof _____ Roofing _____
 Last use CAMP No. families _____

General Description of New Work

To build one outside brick chimney

The neckwork of this chimney is to be corbelled so as to pass through the outside wall of the building at the point where the smokepipe enters so as to obviate the need of carrying the smokepipe through the outside wall.

It is understood that this permit does not include installation of heating apparatus which is to be taken out separately by and in the name of the heating contractor.

Details of New Work

Is any plumbing work involved in this work? _____ CERTIFICATE OF OCCUPANCY
REQUIREMENT IS WAVED
 Is any electrical work involved in this work? _____ Height average grade to top of plate _____
 Size, front _____ depth _____ No. stories _____ Height average grade to highest point of roof _____
 To be erected on solid or filled land? _____ earth or rock? _____
 Material of foundation concrete Thickness, top _____ bottom _____ cellar _____
 Material of underpinning _____ Height _____ Thickness _____
 Kind of roof _____ Rise per foot _____ Roof covering _____
 No. of chimneys 1 Material of chimneys brick of lining tile
 Kind of heat stove Type of fuel _____ Is gas fitting involved? _____
 Framing lumber—Kind _____ Dressed or full size? _____
 Corner posts _____ Sills _____ Girt or ledger board? _____ Size _____
 Material columns under girders _____ Size _____ Max. on centers _____
 Studs (outside walls and carrying partitions) 2x4-16" O. C. Girders 6x8 or larger. Bridging in every floor and flat roof span over 8 feet. Sills and corner posts all one piece in cross section.
 Joists and rafters: 1st floor _____, 2nd _____, 3rd _____, roof _____
 On centers: 1st floor _____, 2nd _____, 3rd _____, roof _____
 Maximum span: 1st floor _____, 2nd _____, 3rd _____, roof _____
 If one story building with masonry walls, thickness of walls? _____ height? _____

If a Garage

No. cars now accommodated on same lot _____ to be accommodated _____
 Total number commercial cars to be accommodated _____
 Will automobile repairing be done other than minor repairs to cars habitually stored in the proposed building? _____

Miscellaneous

Will above work require removal or disturbing of any shade tree on a public street? no
 Will there be in charge of the above work a person competent to see that the State and City requirements pertaining thereto are observed? yes
 Guy Coburn

Signature of owner _____

INSPECTION COPY

Permit No 42/1974

Location Greenwood St. Park

Owner Guy Cohen

Date of permit 7/24/42

Notif. closing-in

Inspn. closing-in

Final Notif.

Final Inspection NOT COMPLETED

Cert. of Occupancy issued

NOTES

84
5
7

Division of Building

No.	Date	Description of Work	Inspector	Remarks
1	7/24/42	Permit issued for Greenwood St. Park		
2				
3				
4				
5				
6				
7				
8				
9				
10				
11				
12				
13				
14				
15				
16				
17				
18				
19				
20				
21				
22				
23				
24				
25				
26				
27				
28				
29				
30				
31				
32				
33				
34				
35				
36				
37				
38				
39				
40				
41				
42				
43				
44				
45				
46				
47				
48				
49				
50				
51				
52				
53				
54				
55				
56				
57				
58				
59				
60				
61				
62				
63				
64				
65				
66				
67				
68				
69				
70				
71				
72				
73				
74				
75				
76				
77				
78				
79				
80				
81				
82				
83				
84				
85				
86				
87				
88				
89				
90				
91				
92				
93				
94				
95				
96				
97				
98				
99				
100				



FILL IN COMPLETELY AND SIGN WITH INK

PERMIT ISSUED

Permit No. 7087

AUG 8 1934

APPLICATION FOR PERMIT FOR HEATING, COOKING OR POWER EQUIPMENT

Portland, Maine August 7, 1934

To the INSPECTOR OF BUILDINGS, PORTLAND, ME.

The undersigned hereby applies for a permit to install the following heating, cooking or power equipment in accordance with the Laws of Maine, the Building Code of the City of Portland, and the following specifications:

Location Greenwood Street, Peaks Island Use of Building Dwelling house

Name and address of owner Guy E. Colburn Peaks Island

Contractor's name and address B. P. Peers 55 Mabel St. Telephone 7-9787

General Description of Work

To install Oil Burning Equipment

IF HEATER, POWER BOILER OR COOKING DEVICE

Is heater or source of heat to be in cellar? 708 If not, which story Kind of Fuel oil

Material of supports of heater or equipment (concrete floor or what kind) concrete

Minimum distance to wood or combustible material, from top of boiler or casing top of furnace, from top of smoke pipe, from front of heater, from sides or back of heater.

Perfect Burner Co., 294 Broad St., Lynn, Mass. IF OIL BURNER

Name and type of burner Perfect Labeled and approved by Underwriters' Laboratories? yes

Will operator be always in attendance? in basement Type of oil feed (gravity or pressure) Gravity 1-275 gallon

Location oil storage in basement No. and capacity of tanks

Will all tanks be more than seven feet from any flame? yes How many tanks fireproofed? None

Amount of fee enclosed? 1.00 (\$1.00 for one heater, etc., 50 cents additional for each additional heater, etc., in same building at same time.)

Signature of contractor [Signature]

CERTIFICATE OF OCCUPANCY REQUIREMENT IS WAIVED

[Handwritten initials]

INSPECTION COPY

Ward 2 Permit No. 34/1087
 Location Greenwood St. Pecks
 Owner J. E. Coburn
 Date of permit 8/8/34
 Notif. closing-in _____
 Inspn. closing-in _____
 Final Notif. 8/14/34
 Final Inspn. 9/20/34 - OT
 Cert. of Occupancy issued None

NOTES

1. Kind of heat Gas
2. Label ✓
3. Anti-siphon ✓
4. Oil storage ✓
5. Tank distance ✓
6. Vent pipe ✓
7. Fill pipe ✓
8. Gauge ✓
9. Rigidity ✓
10. Wood safety ✓
11. Pipe sizes & material ✓
12. Control valve ✓
13. Ash pit vent ✓
14. Temp. or pressure safety ✓
15. Instruction card ✓
16. _____

9/20/34 - Smoke pipe
 only 3" below timbers.
 Spoke to Mrs. James
 about this work said
 she will have shield
 provided - A.J.S.

General Description of Work

REVIEWED BY THE BOARD OF GOVERNING OFFICERS



Location, Ownership and detail must be correct, complete and legible.
 Separate application required for every building.
 Plans must be filed with this application.

Application for Permit for Alterations, etc.

To the Portland, May 21, 1917
 INSPECTOR OF BUILDINGS:

The undersigned application for a permit to alter the following described building.

Location Greenwood St., Peabody Island Ward 1 in fire units? no
 Name of Owner or Lessee GUY E. COLBURN Address Peabody Island
 Contractor Not let

Description of Present Bldg.

Architect " "
 Material of Building wood Style of Roof pitch Material of Roofing asphalt
 Size of Building 16ft feet long; 14ft feet wide. No. of Stories 1
 Cellar Wall is constructed of posts is inches wide on bottom and batters to inches on top.
 Underpinning is is inches thick; feet in height.
 Height of Building 12ft Wall, if Brick; 1st 2d 3d ft. 5th
 What was Building last used for? private garage No. of families?
 What will Building now be used for? cottage (one family)

Detail of Proposed Work

Build addition 6x16 feet one story high with asphalt roof
cut in doors and window
all to comply with the building ordinance

Estimated Cost 150.

If Extended On Any Side

Size of Extension, No. of feet long 16ft; No. of feet wide 6ft; No. of feet high above sidewalk 12ft
 No. of Stories high? 1; Style of Roof pitch; Material of Roofing asphalt
 Of what material will the Extension be built? wood Foundation posts
 If of Brick, what will be the thickness of External Walls? inches; and Party Walls inches.
 How will extension be occupied? dwelling How connected with Main building? joined

When Moved, Raised or Built Upon

No. of Stories in height when Moved, Raised, or Built upon? Proposed Foundation
 No. of feet high from level of ground to highest part of Roof to be
 How many feet will the External Walls be increased in height? Party Walls

If Any Portion of the External or Party Walls Are Removed

Will an opening be made in the Party or External Walls? Story
 Size of the opening? How protected?
 How will the remaining portion of the wall be supported?

Signature of Owner or Authorized Representative

Address

Guy E. Colburn
Peabody Island

PERMIT MUST BE OBTAINED BEFORE BEGINNING WORK

Greenwood St. Peaks

8437

[Handwritten signature]

ADMISSION FOR ISLAND FOR VISITORS

PERMIT GRANTED
 May 21, 1923

Permit filled out by.....192.....

Permit number.....

Location..... Greenwood, Peaks Island

FINAL REPORT

Has the work been completed in accordance with this application and plans filed and approved?

Law been violated?.....Doc. No.....of 192.....

Nature of violation (.....

Violation removed, when (..... 192.....

Estimated cost of alterations, etc., \$.....

Inspector of Buildings.

PERMITS MUST BE OBTAINED BEFORE BEGINNING WORK

APPROVED AND ISSUED BY THE INSPECTOR OF BUILDINGS



Location, ownership and detail must be correct, complete and legible. Separate application required for every building. Plans must be filed with this application.

Application for Permit to Build

(3d CLASS BUILDING)

Portland, Me., — October 4, 1916/9

To THE INSPECTOR OF BUILDINGS:

The undersigned hereby applies for a permit to build, according to the following Specifications:—

Location, Greenwood St., Esaks Island Wd.
 Name of owner is? Charles Baker Address, Greenwood St., P. I.
 Name of mechanic is? Cobb & Webster Prable St.
 Name of architect is?
 Proposed occupancy of building (purpose)? garage (private)
 If a dwelling or tenement house, for how many families?
 Are there to be stores in lower story? No.
 Size of lot, No. of feet front?; No. of feet rear?; No. of feet deep?
 Size of building, No. of feet front? 14; No. of feet rear? 14; No. of feet deep? 16
 No. of stories, front? one; rear?
 No. of feet in height from the mean grade of street to the highest part of the roof? 8 1/2
 Distance from lot lines, front? 6 feet; side? 6 feet; rear? 6 feet
 Firestop to be used? and twelve from any other building
 Will the building be erected on solid or filled land?
 Will the foundation be laid on earth, rock, or piles?
 If on piles, No. of rows? distance on centres? length of?
 Diameter, top of? diameter, bottom of?
 Size of posts?
 " girts?
 " floor timbers? 1st floor 2d 3d 4th
 O. C. " " " "
 Span " " " "
 Braces, how put in?
 Building, how framed?
 Material of foundation? thickness of? laid with mortar?
 Underpinning, material of? height of? thickness of?
 Will the roof be flat, pitch, mansard, or hip? pitch Material of roofing? Asphalt roofing
 Will the building be heated by steam, furnaces, stoves or grates? Will the flues be lined?
 Will the building conform to the requirements of the law? Yes
 No. of brick walls? and where placed?
 Means of egress?

PERMIT MUST BE RECEIVED BEFORE BEGINNING WORK.

Plans must be submitted in duplicate, one set to be filed with the Department and the duplicate set thereof (bearing the approval of the Inspector of Buildings) shall be kept on the work and exhibited on demand

If the building is to be occupied as a Tenement House, give the following particulars:

What is the height of cellar or basement?
 What will be the clear height of first story? second? third?
 State what means of egress is to be provided?
 Scuttle and stepladder to roof?

Estimated Cost,
 \$125.00

Signature of owner or authorized representative,

Charles Baker
 Address, Prable Island

Plans submitted? Received by?

No. 4946... 191

APPLICATION FOR PERMIT TO BUILD 3d CLASS BUILDING

LOCATION No. Greenwood St. ... 8th St. ... 5th Ward ... 84A-4592 1916 Inspector

CONDITIONS

PERMIT GRANTED October 4, 1916 Permit filled out by ... Permit number ... Plan number

FINAL REPORT

Has the work been completed in accordance with this application and plans filed and approved? 191

Law been violated?

Nature of violation?

Violation removed when? 191

Estimated cost of building, etc., \$.

Building Inspector.

APPROVAL OF PLAN

Supervisor of

84-S-7 Greenwood Street

Peaks Isl.

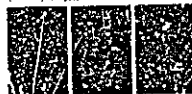
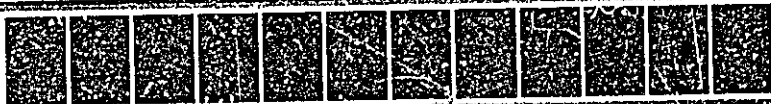



APPLICATION FOR PERMIT
DEPARTMENT OF BUILDING INSPECTIONS SERVICES
ELECTRICAL INSTALLATIONS

Date March 17 19 83
 Receipt and Permit number B09652

To the CHIEF ELECTRICAL INSPECTOR, Portland, Maine:

The undersigned hereby applies for a permit to make electrical installations in accordance with the laws of Maine, the Portland Electrical Ordinance, the National Electrical Code and the following specifications:

LOCATION OF WORK: 84-S-7 Greenwood St., Peaks Island
 OWNER'S NAME: Claire Fillie Staz ADDRESS: same

FEE\$

OUTLETS:

Receptacles _____ Switches _____ Plugmold _____ ft TOTAL _____

FIXTURES: (number of)

Incandescent _____ Fluorescent _____ (not strip) TOTAL _____

Strip Fluorescent _____ ft. _____

SERVICES:

Overhead Underground _____ Temporary _____ TOTAL amperes 100 .. 3.00

METERS: (number of) 1 .. .50

MOTORS: (number of)

Fractional _____

1 HP or over _____

RESIDENTIAL HEATING:

Oil or Gas (number of units) _____

Electric (number of rooms) _____

COMMERCIAL OR INDUSTRIAL HEATING:

Oil or Gas (by a main boiler) _____

Oil or Gas (by separate units) _____

Electric Under 20 kws _____ Over 20 kws _____

APPLIANCES: (number of)

Ranges _____ Water Heaters _____

Cook Tops _____ Disposals _____

Wall Ovens _____ Dishwashers _____

Dryers _____ Compactors _____

Fans _____ Others (denote) _____

TOTAL _____

MISCELLANEOUS: (number of)

Branch Panels _____

Transformers _____

Air Conditioners Central Unit _____

Separate Units (windows) _____

Signs 20 sq. ft. and under _____

Over 20 sq. ft. _____

Swimming Pools Above Ground _____

in Ground _____

Fire/Burglar Alarms Residential _____

Commercial _____

Heavy Duty Outlets, 220 Volt (such as welders) 30 amps and under _____

over 30 amps _____

Circus, Fairs, etc. _____

Alterations to wires _____

Repairs after fire _____

Emergency Lights, battery _____

Emergency Generators _____

INSTALLATION FEE DUE: _____

FOR ADDITIONAL WORK NOT ON ORIGINAL PERMIT DOUBLE FEE DUE: _____

FOR REMOVAL OF A "STOP ORDER" (304-16.b) _____

TOTAL AMOUNT DUE: 3.50

INSPECTION:

Will be ready on _____, 19__; or Will Call

CONTRACTOR'S NAME: Paul Erico

ADDRESS: Eliz. St., Peaks Island

TEL: 768-2316

MASTER LICENSE NO.: Limited 707 SIGNATURE OF CONTRACTOR: Paul Erico

LIMITED LICENSE NO.: _____

INSPECTOR'S COPY — WHITE

OFFICE COPY — CANARY

CONTRACTOR'S COPY — GREEN

APPLICATION FOR PERMIT **A**

PERMIT ISSUED

JUL 10 1984

B.O.C.A. USE GROUP

B.O.C.A. TYPE OF CONSTRUCTION 822

ZONING LOCATION PORTLAND, MAINE June 25, 1984

CITY OF PORTLAND

To the CHIEF OF BUILDING & INSPECTION SERVICES, PORTLAND, MAINE
The undersigned hereby applies for a permit to erect, alter, repair, demolish, move or install the following building, structure, equipment or change use in accordance with the Laws of the State of Maine, the Portland B.O.C.A. Building Code and Zoning Ordinance of the City of Portland with plans and specifications, if any, submitted herewith and the following specifications:

LOCATION 84-5-7 Greenwood Street, Peaks Island
1. Owner's name and address Claire Fillettez & Monique Levesque - Fire District #1 #2
2. Lessee's name and address 95 Swiner St., Lewiston, Me. 04240 Telephone 784-5968
3. Contractor's name and address ~~Walter Crowell - Luther St., Peaks Isl.~~ Telephone ~~786-2273~~
..... Roger Dorton - Torrington Ave., Peaks Isl. Telephone ~~786-2273~~

Proposed use of building Guest house No unskilled phone
1st use same No. families 1
No. stories Heat Style of roof Roofing

Other buildings on same lot
Estimated contractual cost \$ 1,000.00

FIELD INSPECTOR - Mr.
@ 775-5451
Appeal Fees \$
Base Fee
Late Fee
TOTAL \$ 165.00

To construct sun deck, 15' x 16', in rear of existing cottage, as per plan.

Stamp of Special Conditions

NOTE TO APPLICANT: Separate permits are required by the installers and subcontractors of heating, plumbing, electrical and mechanicals.

DETAILS OF NEW WORK

Is any plumbing involved in this work? no
Is any electrical work involved in this work? yes
Is connection to be made to public sewer? If not, what is proposed for sewage?
Has septic tank notice been sent? Form notice sent?
Height average grade to top of plate Height average grade to highest point of roof
Size, front depth No. stories solid or filled land? earth or rock?
Material of foundation Thickness, top bottom cellar
Kind of roof Rise per foot Roof covering
No. of chimneys Material of chimneys of lining Kind of heat fuel
Framing Lumber—Kind Dressed or full size? Corner posts Sills
Size Girder Columns under girders Size Max. on centers
Studs (outside walls and carrying partitions) 2x4-16" O. C. Bridging in every floor and flat roof span over 8 feet.
Joists and rafters: 1st floor , 2nd , 3rd , roof
On centers: 1st floor , 2nd , 3rd , roof
Maximum span: 1st floor , 2nd , 3rd , roof
If one story building with masonry walls, thickness of walls? height?

IF A GARAGE

No. cars now accommodated on same lot to be accommodated number commercial cars to be accommodated
Will automobile repairing be done other than minor repairs to cars habitually stored in the proposed building?

APPROVALS BY: DATE
BUILDING INSPECTION—PLAN EXAMINER
ZONING:
BUILDING CODE:
Fire Dept.:
Health Dept.:
Others:

MISCELLANEOUS
Will work require disturbing of any tree on a public street? no
Will there be in charge of the above work a person competent to see that the State and City requirements pertaining thereto are observed? yes

Signature of Applicant Claire M. Fillettez Phone # 766-2220
Type Name of above Claire Fillettez
Other
and Address

FIELD INSPECTOR'S COPY APPLICANT'S COPY OFFICE FILE COPY

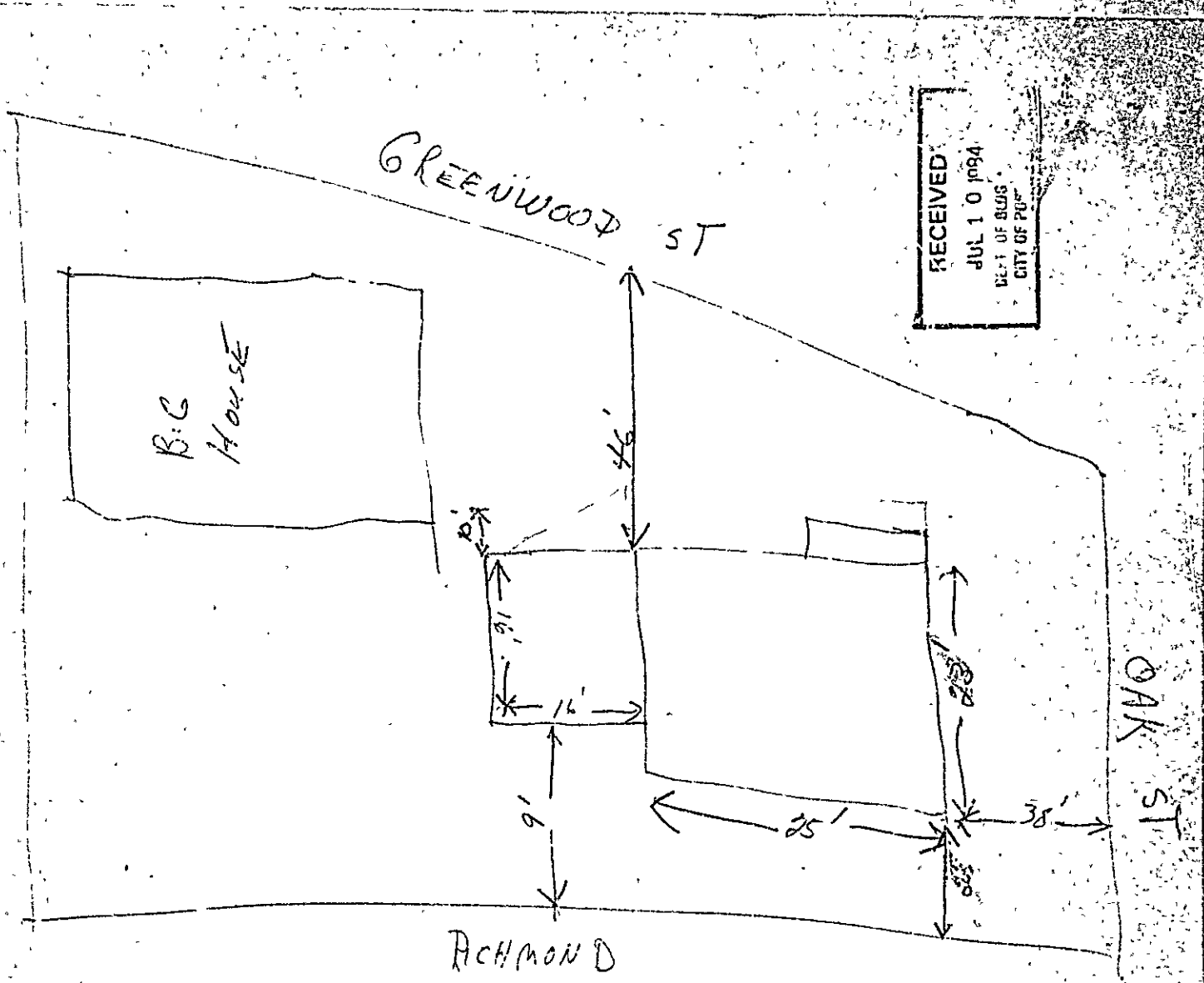

Applicant: *Claire Filhettay* Date: *7/2/84*
Address: *95 Summer St, Lewiston, Maine*
Assessors No.: *84-S-7 Greenwood St, Peaks Island*

CHECK LIST AGAINST ZONING ORDINANCE

Date -
Zone Location - *R-3*
Interior or corner lot - *Corner*
Use -
Sewage Disposal -
Rear Yards - *25' required*
Side Yards - *8' required*
Front Yards - *25' required*
Projections -
Height -
Lot Area - *4196 sf*
Building Area - *Proposed deck encroaches on ^{side or Rear} ~~front~~ yard setback requirements*
Area per Family -
Width of Lot -
Lot Frontage -
Off-street Parking -
Loading Bays -
Site Plan -
Shoreland Zoning -
Flood Plains -

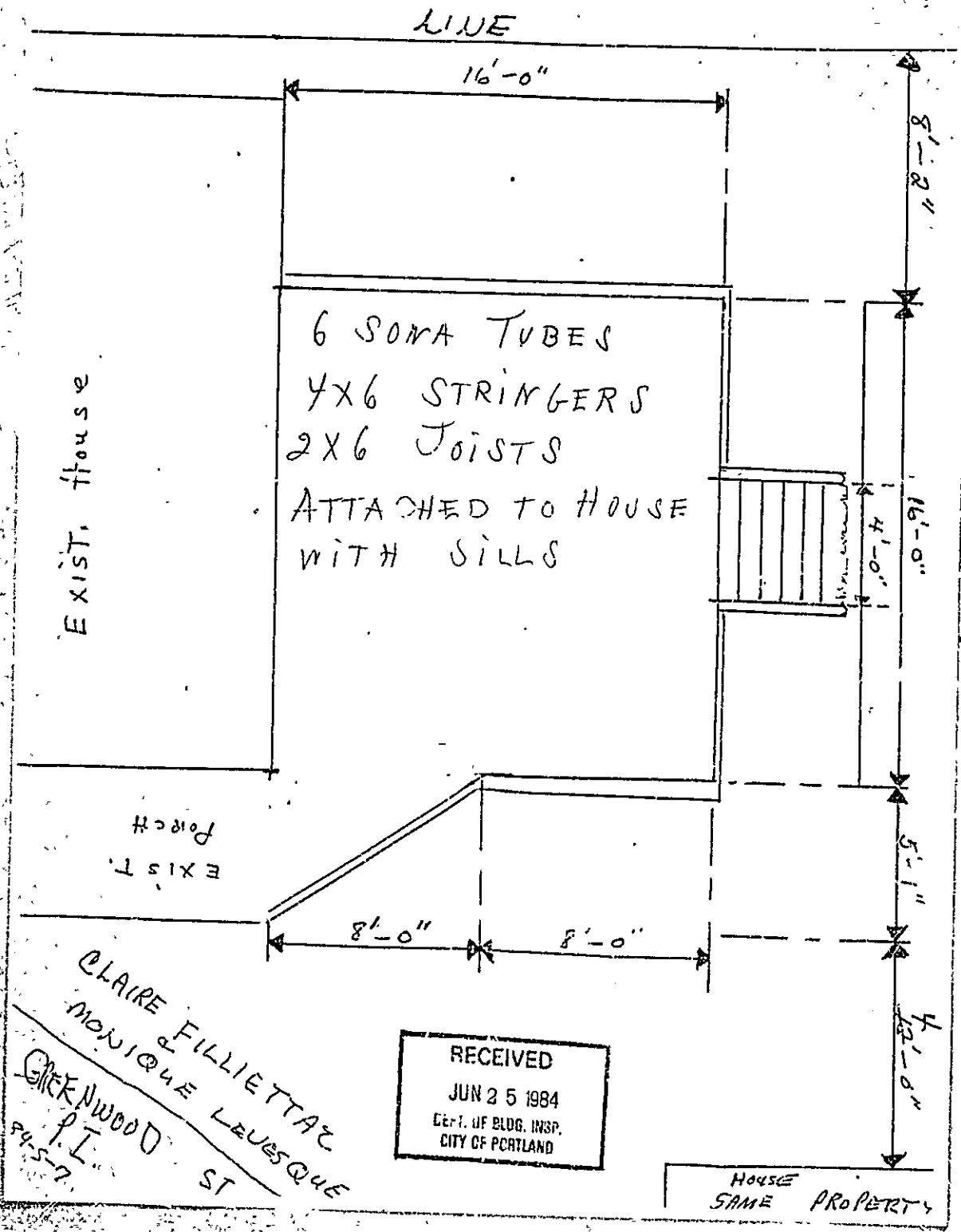

APPLICATION FOR PERMIT

PERMIT ISSUED

B.O.C.A. USE GROUP
B.O.C.A. TYPE OF CONSTRUCTION 822

JUL 10 1984

ZONING LOCATION ... R-3 ... PORTLAND, MAINE . June. 25, 1984.

CITY OF PORTLAND

To the CHIEF OF BUILDING & INSPECTION SERVICES, PORTLAND, MAINE

The undersigned hereby applies for a permit to erect, alter, repair, demolish, move or install the following building, structure, equipment or change use in accordance with the Laws of the State of Maine, the Portland B.O.C.A. Building Code and Zoning Ordinance of the City of Portland with plans and specifications, if any, submitted herewith and the following specifications.

LOCATION 84-S-7 Greenwood Street, Peaks Island Fire District #1 , #2

1. Owner's name and address Claire Filiettaz & Monique Levesque Telephone 784-5868...

2. Lessee's name and address 95 Summer St., Lewiston, Me. 04240 Telephone

3. Contractor's name and address ~~Walter Grandall - Luther St., Peaks Isl.~~ Roger Enerton - Torrington Ave. Pks Isl. Telephone ~~766-2273~~ No Unlisted phone #

Proposed use of building ... Guest house No. families ... 1

Last use ... same No. families ... 1

Water ... No stories Heat Style of roof Roofing

Other buildings on same lot

Estimated structural cost \$ 1,000.00

Appeal Fees \$

Base Fee

Late Fee

TOTAL \$ 15.00

struct. sun deck, 16' x 16', in rear of existing cottage, as per plan.

Stamp of Special Conditions

NOTE TO APPLICANT: Separate permits are required by the installers and subcontractors of heating, plumbing, electrical and mechanicals.

DETAILS OF NEW WORK

Is any plumbing involved in this work? ... NO Is any electrical work involved in this work? ... NO
Is connection to be made to public sewer? If not, what is proposed for sewage?
Has septic tank notice been sent? Form notice sent?
Height average grade to top of plate Height average grade to highest point of roof
Size, front depth No. stories solid or filled land? ... earth or rock?
Material of foundation Thickness, top bottom cellar
Kind of roof Rise per foot Roof covering
No. of chimneys Material of chimneys of lining Kind of heat fuel
Framing Lumber—Kind Dressed or full size? Corner posts Sills
Size Girder Columns under girders Size Max. on centers
Studs (outside walls and carrying partitions) 2x4-16" O. C. Bridging in every floor and flat roof span over 6 feet.
Joists and rafters: 1st floor 2nd 3rd roof
On centers: 1st floor 2nd 3rd roof
Maximum span: 1st floor 2nd 3rd roof
If one story building with masonry walls, thickness of walls? height?

IF A GARAGE

No. cars now accommodated on same lot, to be accommodated number commercial cars to be accommodated
Will automobile repairing be done other than minor repairs to cars habitually stored in the proposed building?

APPROVALS BY: DATE

BUILDING INSPECTION—PLAN EXAMINER

ZONING: C.A. M.A.D. 7/10/84

BUILDING CODE:

Fire Dept.:

Health Dept.:

Others:

MISCELLANEOUS

Will work require disturbing of any tree on a public street?

Will there be in charge of the above work a person competent to see that the State and City requirements pertaining thereto are observed? ..yes ...

Signature of Applicant Claire M. Filiettaz Phone # 766-2270

Type Name of above Claire Filiettaz .. 1 2 3 4

Other
and Address

FIELD INSPECTOR'S COPY

APPLICANT'S COPY

OFFICE FILE COPY

17 mg, addat

NOTES

8-17-84. All work complete
as per plan and permit.
OK

Permit No.

84/622

Location

S 27th Street

Owner

Clara Stille

Date of permit

6-25-84

Approved

P-1-84

Dwelling

1 story clad.

Garage

Alteration

(This section of the form is crossed out with a large diagonal line.)

M. E. [Signature]