

100 CH STREET, PARKS ISLAND

84-1-8

Roland S. Hoar
Welch St.

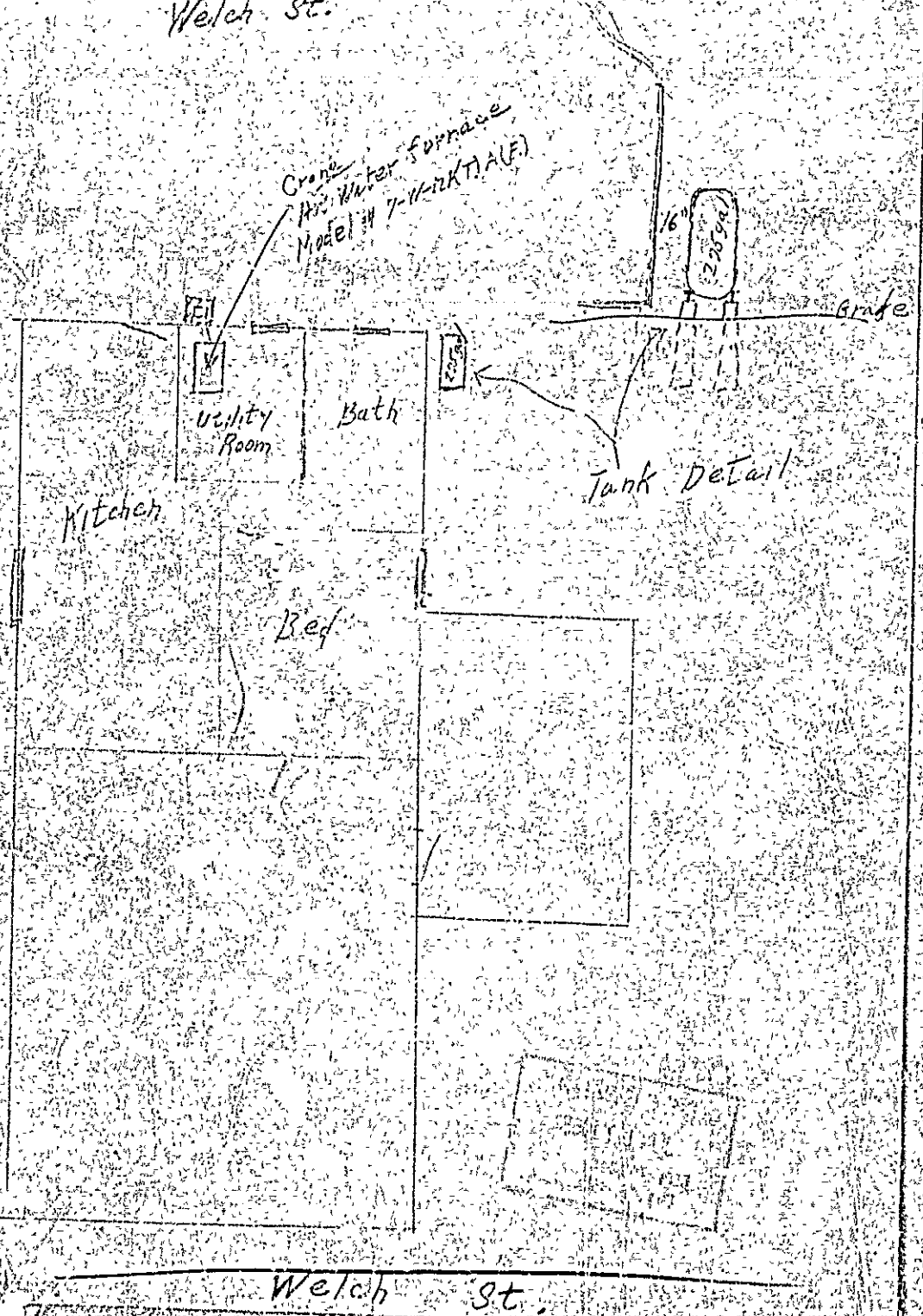



FILL IN AND SIGN WITH INK

APPLICATION FOR PERMIT FOR HEATING, COOKING OR POWER EQUIPMENT

Portland, Maine, July 7 1968

PERMIT ISSUED 581

JUN 14 1968

CITY OF PORTLAND

To the INSPECTOR OF BUILDINGS, PORTLAND, ME.

The undersigned hereby applies for a permit to install the following heating, cooking or power equipment in accordance with the Laws of Maine, the Building Code of the City of Portland, and the following specifications:

Location Welch St. Peaks Island Use of Building Dwelling *(84-1-8)* No Stories 1 New Building Existing " Existing
 Name and address of owner of appliance Roland S. Hoar, Island Ave. Peaks Island
 Installer's name and address " " " " "Telephone " " " "

General Description of Work Master's Elec. #77

To install Oil-fired forced hot water heating system in place of space heaters.
Crane-- Model #7-11-12F(T)A(E)

IF HEATER, OR POWER BOILER

Location of appliance Utility Room Any burnable material in floor surface or beneath? Yes-wood floor
first floor Underwriter's Approval Kind of fuel? oil
 If so, how protected? Underwriter's Approval Minimum distance to burnable material, from top of appliance or casing top of furnace 4'
 From top of smoke pipe 4' From front of appliance 36" From sides or back of appliance 14" for both
 Size of chimney flue 8x8 Other connections to same flue none
 If gas fired, how vented? Yes Rated maximum demand per hour _____
 Will sufficient fresh air be supplied to the appliance to insure proper and safe combustion? Yes

IF OIL BURNER

Name and type of burner Crane-guntoyo Labeled by underwriters' laboratories? Yes
 Will operator be always in attendance? _____ Does oil supply line feed from top or bottom of tank? bottom
 Type of floor beneath burner wood Size of vent pipe 1.5"
 Location of oil storage outside above ground low prec. building Number and capacity of tanks 275 gal.
 Low water shut off _____ Make _____ No. _____
 Will all tanks be more than five feet from any flame? Yes How many tanks enclosed? _____
 Total capacity of any existing storage tanks for furnace burners _____ Sent to Fire Dept. 6/10/68
 Rec'd from Fire Dept. 6/14/68

IF COOKING APPLIANCE

Location of appliance _____ Any burnable material in floor surface or beneath? _____
 If so, how protected? _____ Height of Legs, if any _____
 Skirting at bottom of appliance? _____ Distance to combustible material from top of appliance? _____
 From front of appliance _____ From sides and back _____ From top of smokepipe _____
 Size of chimney flue _____ Other connections to same flue _____
 Is hood to be provided? _____ If so, how vented? _____ Forced or gravity? _____
 If gas fired, how vented? _____ Rated maximum demand per hour _____

MISCELLANEOUS EQUIPMENT OR SPECIAL INFORMATION

with two layers hollow tile or wood floor
OR R. Hoar

Amount of fee enclosed? 2.00 (\$2.00 for one heater, etc., \$1.00 additional for each additional heater, etc., in same building at same time.)

APPROVED:

6/14/68 J. P. Romano-Trust
OK 6-14-68 DR

Will there be in charge of the above work a person competent to see that the State and City requirements pertaining thereto are observed? Yes

Roland S. Hoar

Roland S. Hoar

Signature of Installer

INSPECTION COPY

CS 300

Permit No: 68/5811
 Location: W. 1st St. & 1st St.
 Owner: Ed. A. Keady
 Date of Permit: 6/14/68
 Approved: _____

NOTES

1. Full Page	
2. Vent Pipe	
3. Kind of Hat	
4. Erection, Ribs, etc.	Surround
5. Frame & L.P.	
6. Stack Cover	
7. Height from Ground	
8. Spacing of Columns	
9. Kind of Soil	
10. Wind Direction	
11. Wind Velocity	
12. Direction of Travel	
13. Kind of Material	
14. Kind of Work	
15. Kind of Work	
16. Kind of Work	

7/10/68
Nothing started yet
High
8/5/68
Same
High
12-19-68
Completed
High

[Empty lined area for additional notes, crossed out with a large X]



(A) APARTMENT HOUSE ONE
APPLICATION FOR PERMIT

PERMIT ISSUED
01826
SEP 25 1951
CITY of PORTLAND

Class of Building or Type of Structure Third Class

Portland, Maine, Sept. 21, 1951

To the INSPECTOR OF BUILDINGS, PORTLAND, MAINE

The undersigned hereby applies for a permit to erect alter ~~or reconstruct~~ the following building ~~structure~~ ~~in accordance with the Laws of the State of Maine, the Building Code and Zoning Ordinance of the City of Portland; plans and specifications, if any, submitted herewith and the following specifications:~~

Location Welch Street, Peaks Island 94-K-1 Within Fire Limits? no Dist. No. _____
Owner's name and address May Goldberg, Peaks Island and New York Telephone _____
Lesse's name and address (former owner, Russell Preston) Telephone _____
Contractor's name and address W. E. Brackett, Island Avenue, Peaks Island Telephone none
Architect _____ Specifications _____ Plans no No. of sheets _____
Proposed use of building cottage Last use _____ No. families _____
Material wood No. stories 1 1/2 Heat _____ Style of roof _____ Roofing _____
Other buildings on same lot _____
Estimated cost \$ 25 Fee \$ 50

INSPECTION NOT COMPLETED

General Description of New Work

To change existing cedar post foundation to concrete piers at front piazza 6' x 32'.

CERTIFICATE OF OCCUPANCY
REQUIREMENT IS WAIVED
PERMIT TO BE ISSUED TO W. E. Brackett

It is understood that this permit does not include installation of heating apparatus which is to be taken out separately by and in the name of the heating contractor.

Details of New Work

Is any plumbing involved in this work? _____ Is any electrical work involved in this work? _____
Height average grade to top of plate _____ Height average grade to highest point of roof _____
Size, front _____ depth _____ No. stories _____ solid or filled land? _____ earth or rock? _____
Material of foundation concrete piers at least 1' below grade Thickness, top 16" bottom 22" cellar _____
Material of underpinning cedar posts 8" on centers Height _____ Thickness _____
Kind of roof _____ Rise per foot _____ Roof covering _____
No. of chimneys _____ Material of chimneys _____ of lining _____ Kind of heat _____ fuel _____
Framing lumber—Kind _____ Dressed or full size? _____
Corner posts _____ Sills 6x6 existing Girt or ledger board? _____ Size _____
Girders _____ Size _____ Columns under girders _____ Size _____ Max. on centers _____
Studs (outside walls and carrying partitions) 2x4-16" O. C. Bridging in every floor and flat roof span over 8 feet.
Joists and rafters: 1st floor _____, 2nd _____, 3rd _____, roof _____
On centers: 1st floor _____, 2nd _____, 3rd _____, roof _____
Maximum span: 1st floor _____, 2nd _____, 3rd _____, roof _____
If one story building with masonry walls, thickness of walls? _____ height? _____

If a Garage

cars now accommodated on same lot _____, to be accommodated _____ number commercial cars to be accommodated _____
Will automobile repairing be done other than minor repairs to cars habitually stored in the proposed building? _____

APPROVED:
OK-9/24/51-AGJ

Miscellaneous

Will work require disturbing of any tree on a public street? no
Will there be in charge of the above work a person competent to see that the State and City requirements pertaining thereto are observed? yes

May Goldberg

Signature of owner by: W. E. Brackett

INSPECTION COPY

Permit No. 511826

Location *Hotel McCarry Blvd*

Owner *May E. Galding*

Date of permit *1915/5/31*

Notif. closing-in

Inspn. closing-in

Final Notif.

Final Inspn.

Cert. of Occupancy issued

NOTES

FORM FOR PERMIT

Form with multiple lines for notes and details, including a large shaded area at the bottom.