

OAKLAND AVENUE
84-F-22

PEAKS ISLAND

U.S. GOVERNMENT
PRINTING OFFICE

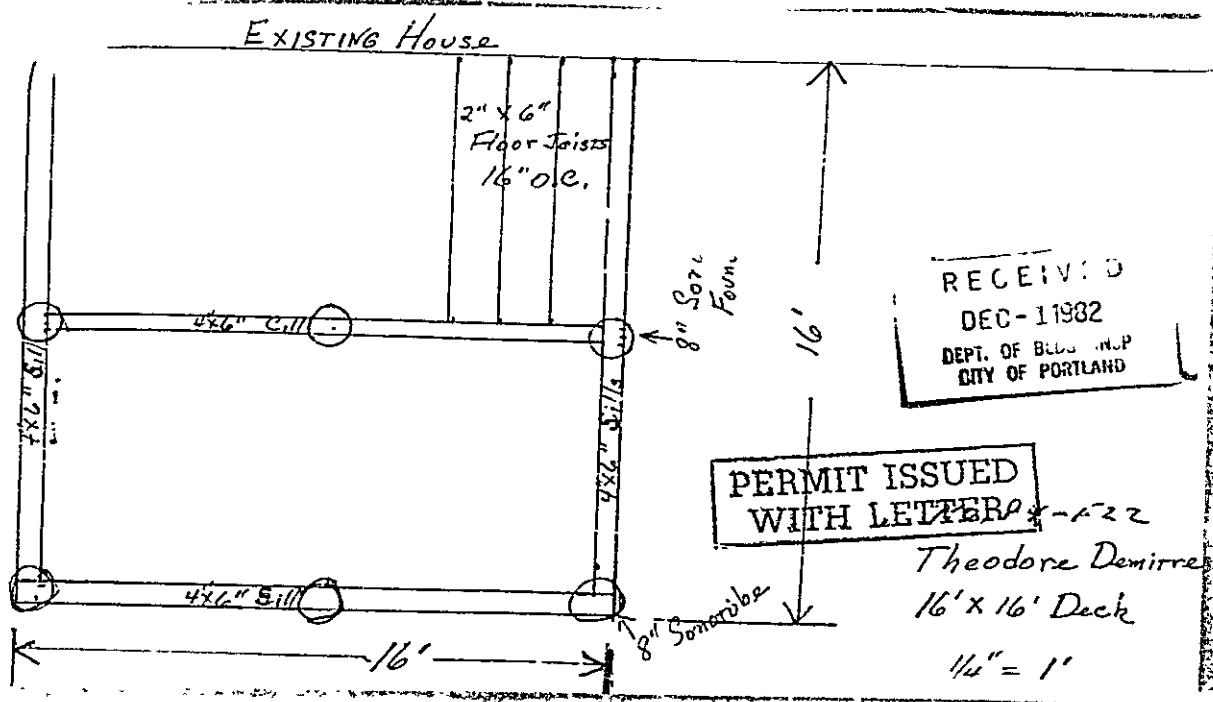

RECEIVED
 DEC-11982
 DEPT. OF BLDG. INSP.
 CITY OF PORTLAND

PERMIT ISSUED
 WITH LETTER # 4-122

Theodore Demiree
 16' x 16' Deck

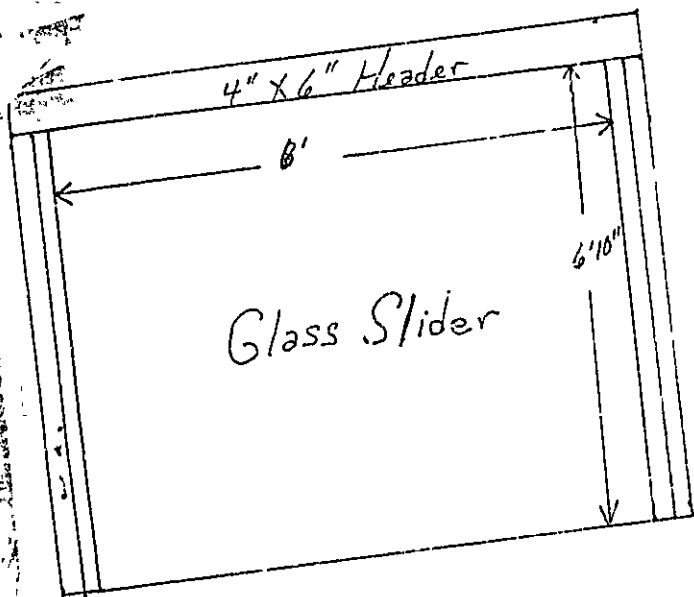

RECEIVED
DEC-1 1902
DEPT. OF BLDG. INSP.
CITY OF PORTLAND

84-F-22
Oakland Ave. &
Oakland Ave.
Theodore Demitree
Glass Slider
1/4" = 1'

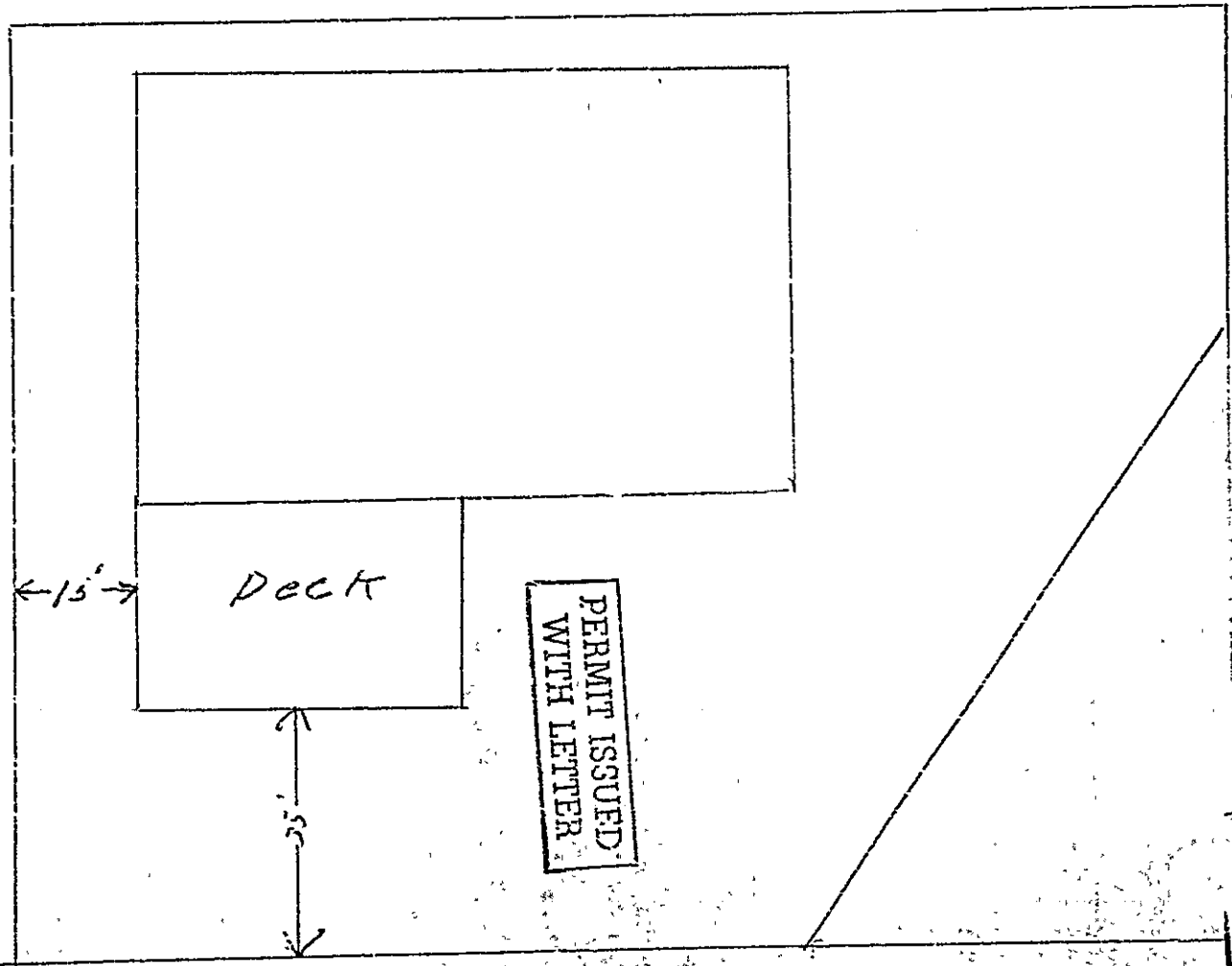

PERMIT ISSUED
WITH LETTER

84-F-22
Oakland ave.
+ Island ave.
P.H.

RECEIVED
DEC-1982
DEPT. OF BLDG. INSP.
CITY OF PORTLAND

Island Ave

Oakland Ave





CITY OF PORTLAND

JOSEPH E. GRAY, JR.
DIRECTOR OF PLANNING
AND URBAN DEVELOPMENT

December 2, 1982

Jackson & Casey Corp.
Island Avenue
Peaks Island, Maine

Dear Sir:

Your application to construct a sun-deck at 84-F-22
Oakland Avenue & Island Avenue, Peaks Island for Mr.
Theodore DeMitre is being issued subject to the following
conditions.

Guardrail & a continuous guardrail shall be provided
with a min. height of 42 inches, or other approved protective
measure.

If you have any questions on this condition please call
this office.

Sincerely,

P. Samuel Hoffses
Chief of Inspection Services

PSH/ulb

APPLICATION FOR PERMIT

PERMIT ISSUED

B.O.C.A. USE GROUP 31082

B.O.C.A. TYPE OF CONSTRUCTION

ZONING LOCATION .. B-3 .. PORTLAND, MAINE Dec. 1, 1982 ..

DEC 5 1982

CITY OF PORTLAND

To the CHIEF OF BUILDING & INSPECTION SERVICES, PORTLAND, MAINE

The undersigned hereby applies for a permit to erect, alter, repair, demolish, move or install the following building, structure, equipment or change use in accordance with the Laws of the State of Maine, the Portland B.O.C.A. Building Code and Zoning Ordinance of the City of Portland with plans and specifications, if any, submitted herewith and the following specifications:

LOCATION .. 84-F-22 Oakland Ave. & Island Ave., Peaks Island, Malden, Mass. Fire District #1 #2

- 1. Owner's name and address Theodore Lemitre - 26 Main St. Park, Malden, Mass. Telephone ..
2. Lessee's name and address .. Telephone ..
3. Contractor's name and address Jackson & Casey Corp. - Island Ave., P.O. Telephone 766-2817

Proposed use of building single fam. No. of sheets ..
Last use same No. families ..
Material .. No. stories .. Heat .. Style of roof .. Roofing ..

Other buildings on same lot ..
Estimated contractual cost \$ 2,000.00... Appeal Fees \$..

FIELD INSPECTOR - Mr. @ 775-515; Bare Fee ..
Late Fee ..
TOTAL \$ 20.00

To construct sun deck attached to building, 16'x16', as per plan, open deck.

Stamp of Special Conditions

SEND PERMIT TO #3

NOTE TO APPLICANT: Separate permits are required by the installers and subcontractors of heating, plumbing, electrical and mechanicals.

DETAILS OF NEW WORK

Is any plumbing involved in this work? Is any electrical work involved in this work?
Is connection to be made to public sewer? If not, what is proposed for sewage?
Has septic tank notice been sent? Forr. notice sent?
Height average grade to top of plate .. Height average grade to highest point of roof ..
Size, front .. depth .. No. stories .. solid or filled land? .. earth or rock? ..
Material of foundation .. Thickness, top .. bottom .. cellar ..
Kind of roof .. Rise per foot .. Roof covering ..
No. of chimneys .. Material of chimneys .. of lining .. Kind of heat .. fuel ..
Framing Lumber - Kind .. Dressed or full size? .. Corner posts .. Sills ..
Size Girder .. Columns under girders .. Size .. Max. on centers ..
Studs (outside walls and carrying partitions) 2x4-16" O. C. Bridging in every floor and flat roof span over 8 feet.
Joists and rafters. 1st floor .. 2nd .. 3rd .. roof ..
Girders .. 1st floor .. 2nd .. 3rd .. roof ..
Minimum span. 1st floor .. 2nd .. 3rd .. roof ..
If one story building with masonry walls, thickness of walls? .. height? ..

IF A GARAGE

No. cars now accommodated on same lot .. to be accommodated .. number commercial cars to be accommodated ..
Will automobile repairing be done other than minor repairs to cars habitually stored in the proposed building? ..

APPROVALS BY: DATE MISCELLANEOUS
BUILDING INSPECTION - PLAN EXAMINER Will work require disturbing of any tree on a public street? NO.
ZONING O.R. M.C.C. 12/1/82
BUILDING CODE: Will there be in charge of the above work a person competent
Fire Dept.: to see that the State and City requirements pertaining thereto
Health Dept.: are observed? .. YES ..
Others: ..

Signature of Applicant Edward L. Casey Phone # ..
Type Name of above Edward L. Casey for Theodore Lemitre 2 3 4
Other ..
and Address ..

PERMIT ISSUED WITH FEES PAID

APPLICANT'S COPY OFFICE FILE COPY

NOTES

72-8-82 - *Be in table*
AK Prince etc. complete
OK

Permit No. 82/1082

Location: 817 22 Oakland Ave

Owner: Shirley C. White

Date of permit 12-1-82

Approved: 12-3-82

Dwelling: Sum. Deck

Garage: 1

Alteration

~~Multiple horizontal lines for notes, all crossed out with a large diagonal line.~~



APPLICATION FOR PERMIT

Class of Building or Type of Structure

Portland, Maine, July 19 1973

PERMIT 130080

0075906 19 1973

CITY OF PORTLAND

To the INSPECTOR OF BUILDINGS, PORTLAND, MAINE

The undersigned hereby applies for a permit to erect alter repair... of the following building structure equipment in accordance with the Laws of the State of Maine, the Building Code and Zoning Ordinance of the City of Portland; plans and specifications, if any, submitted herewith and the following specifications: (1) 1-22

Location Oakland Ave. (across from 83) Peaks Isl. Within Fire Limits? Dist. No.

Owner's name and address T. Demitra, same Telephone

Lessee's name and address Telephone

Contractor's name and address Phillip Lockwood, 82 Oakland Ave, Peaks Isl. Telephone 766-2638

Architect Specifications Plans No. of sheets

Proposed use of building No. families

Last use No families

Material wood frame No. stories 1 Heat Style of roof Roofing

Other buildings on same lot

Estimated cost \$ 400.00 Fee \$ 3.00

General Description of New Work

Construct extension to front porch according to plan.

It is understood that this permit does not include installation of heating apparatus which is to be taken out separately by and in the name of the heating contractor. PERMIT TO BE ISSUED TO

Details of New Work

Is any plumbing involved in this work? Is any electrical work involved in this work?

Is connection to be made to public sewer? If not, what is proposed for sewage?

Has septic tank notice been sent? Form notice sent?

Height average grade to top of plate Height average grade to highest point of roof

Size, front depth No. stories solid or filled land? earth or rock?

Material of foundation Thickness, top bottom cellar

Kind of roof Rise per foot Roof covering

No. of chimneys Material of chimneys of lining Kind of heat fuel

Framing Lumber-Kind Dressed or full size? Corner posts Sills

Size Girder Columns under girders Size Max. on centers

Studs (outside walls and carrying partitions) 2x4-16" C. C. Bridging in every floor and flat roof span over 3 feet.

Joists and rafters: 1st floor, 2nd, 3rd, roof

On centers: 1st floor, 2nd, 3rd, roof

Maximum span: 1st floor, 2nd, 3rd, roof

If one story building with masonry walls, thickness of walls? height?

If a Garage

No. cars now accommodated on same lot, to be accommodated number commercial cars to be accommodated

Will automobile repairing be done other than minor repairs to cars habitually stored in the proposed building?

APPROVED:

64-7/14/73- All

Miscellaneous

Will work require disturbing of any tree on a public street?

Will there be in charge of the above work a person competent to see that the State and City requirements pertaining thereto are observed? Yes

CS 301

INSPECTION COPY

Signature of owner by:

Phillip L. Lockwood

Permit No. 73 / 756

Location DARLTON AVE, PEAKS ISL

Owner DEMIRE

Date of permit 7/19/73

Notif. closing in _____

Inspn. closing in _____

Final Notif. _____

Final Inspn. _____

Cert. of Occupancy issued _____

Staking Out Notice _____

Form Check Notice _____

NOTES

7-20-73

Framed

AD

8-10-73

Completed

AD

7