

ADAMS ST. PEAKS ISLAND

04-F-11

Date 4/25/74
Issued

Portland Plumbing Inspector
By ERNOLD R GOODWIN

App. First Insp.

Date

By

App. Final Insp.

Date

By

Type of Building

- Commercial
 Residential
 Single
 Multi Family
 New Construction
 Remodeling

PERMIT TO INSTALL PLUMBING 84-F-11-12 PERMIT NUMBER 3630

Address 1 Adams St, Peaks Island

Installation For

Owner of Bldg Dermisco

Owner's Address same

Date 4/25/74

Plumber Roger Paromora

NO

FEE

NEW	REPL			
	1	SINKS		
	1	LAVATORIES		
	1	TOILETS		
		BATH TUBS		
	1	SHOWERS		
		DRAINS	FLOOR SURFACE	
		HOT WATER TANKS		
		TANKLESS WATER HEATERS		
		GARBAGE DISPOSALS		
		SEPTIC TANKS		
		HOUSE SEWERS		
		ROOF LEADINGS		
		AUTOMATIC WASHERS		
		DISHWASHERS		
		OTHER		
	1	bat tub		
	1	w/m hook-up		
			TOTAL	13.60

Building and Inspection Services Dept.: Plumbing Inspection

84-F-11 ADAMS ST.

4/18/54 M.G.W.

CHECK LIST AGAINST ZONING ORDINANCE

✓ Date - EXISTING

✓ Zone Location - R-3

✓ Interior or corner lot -

✓ 40 ft. setback area (Section 21) - N/D

✓ Use - ~~ENCLOSE~~ EXISTING PORT

~~Sewage Disposal -~~

~~Rear Yards -~~

✓ Side Yards - 8' ± 8' MIN.

✓ Front Yards - 30' - 15' MIN.

~~Projections -~~

Height - 15 TO 24

~~Lot Area -~~

~~Building Area -~~

~~Area per Family -~~

~~Width of Lot -~~

~~Lot Frontage -~~

~~Off-street Parking -~~

~~Loading Bays -~~

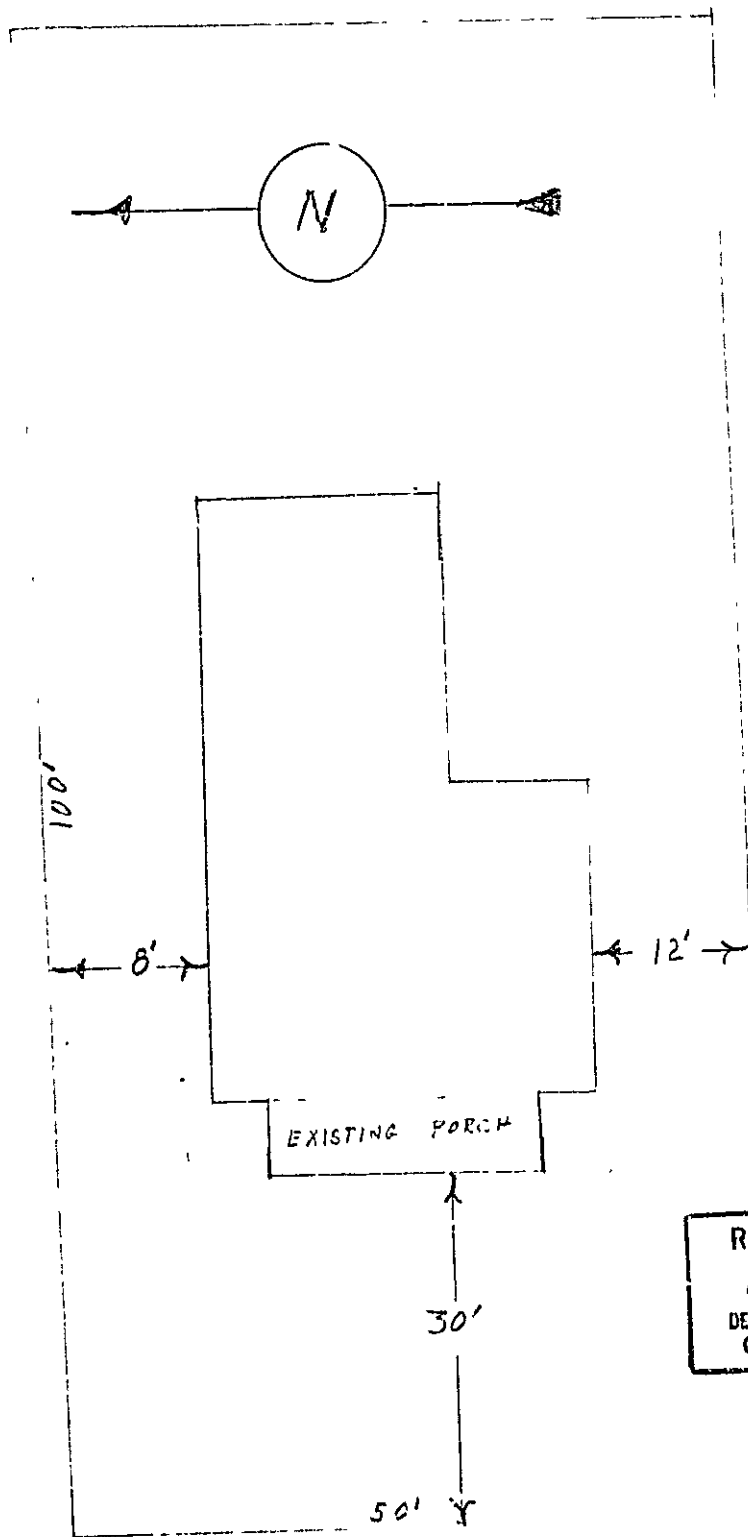

84-F-12

5000 SQUARE
FEET

EXISTING PORCH

RECEIVED

APR 18 1974

DEPT. OF BLDG. INSP.
CITY OF PORTLAND

50' Y

ADAMS STREET

SCALE 1" = 10'



APPLICATION FOR PERMIT

PERMIT ISSUED

B.O.C.A. USE GROUP 00309

APR 18 1974

B.O.C.A. TYPE OF CONSTRUCTION

ZONING LOCATION _____ PORTLAND, MAINE, April 12, 1974

CITY OF PORTLAND

To the DIRECTOR OF BUILDING & INSPECTION SERVICES, PORTLAND, MAINE

The undersigned hereby applies for a permit to erect, alter, repair, demolish, move or install the following building, structure, equipment or change use in accordance with the Laws of the State of Maine, the Portland B.O.C.A. Building Code and Zoning Ordinance of the City of Portland with plans and specifications, if any, submitted herewith and the following specifications: 84-F-11

LOCATION Adams St., Peaks Island Fire District #1 #2

1. Owner's name and address Mrs. Perrison Telephone

2. Lessee's name and address Telephone

3. Contractor's name and address Charles Franco, Winding Way, Peaks Isl Telephone 766-4403

4. Architect Specifications Plans No. of sheets

Proposed use of building 1. Family house No. families

Last use No. families

Material frame No. stories ..1... Heat Style of roof Roofing

Other buildings on same lot

Estimated contractual cost \$. 350.00 Fee \$. 3.00

FIELD INSPECTOR—Mr. _____ GENERAL DESCRIPTION

This application is for: @ 775-5451

Dwelling Ext. 234 to enclose an existing 5'x25' porch, majority to be glazed.

Garage

Masonry Bldg.

Metal B'dg.

Alterations

Demolitions

Change of Use

Other

Stamp of Special Conditions

NOTE TO APPLICANT: Separate permits are required by the installers and subcontractors of heating, plumbing, electrical and mechanicals.

PERMIT IS TO BE ISSUED TO 1 2 3 4

Other:

DETAILS OF NEW WORK

Is any plumbing involved in this work? Is any electrical work involved in this work?

Is connection to be made to public sewer? If not, what is proposed for sewage?

Has septic tank notice been sent? Form notice sent?

Height average grade to top of plate Height average grade to highest point of roof

Size, front No. stories solid or filled land? earth or rock?

Material of foundation Thickness, top bottom cellar

Kind of roof Rise per foot Roof covering

No. of chimneys Material of chimneys of lining Kind of heat fuel

Framing Lumber—Kind Dressed or full size? Corner posts Sills

Size Girder Columns under girders Size Max. on centers

Studs (outside walls and carrying partitions) 2x4-16" O. C. Bridging in every floor and flat roof span over 8 feet.

Joists and rafters: 1st floor 2nd 3rd roof

On centers: 1st floor 2nd 3rd roof

Maximum span: 1st floor 2nd 3rd roof

If one story building with masonry walls, thickness of walls? height?

IF A GARAGE

No. cars now accommodated on same lot to be accommodated ... number commercial cars to be accommodated ...

Will automobile repairing be done other than minor repairs to cars habitually stored in the proposed building?

APPROVALS BY: _____ DATE _____ MISCELLANEOUS

BUILDING INSPECTION—PLAN EXAMINER Will work require disturbing of any tree on a public street? ..

ZONING: OK 4/15/74

BUILDING CODE: OK 4/11/74

Fire Dept.:

Health Dept.:

Others:

Will there be in charge of the above work a person competent to see that the State and City requirements pertaining thereto are observed? yes

Signature of Applicant Phone # 766-2809

Type Name of above Richard Bemis

1 2 3 4

Other and Address

FIELD INSPECTOR'S COPY

BRIDGE DIVISION

PERMIT NO. 60800

NOTES

5-25-74

Completed

[Signature]

Permit No. 74/309 *Nelson*

Location 84-F-11 Adams St, Pearl River

Owner Mrs. Denison

Date of permit 4/18/74

Approved _____

[Large handwritten scribble or signature across the middle of the page]

[Faint vertical text on the right side of the page, possibly a date or reference number]

CITY OF PORTLAND, MAINE
Application for Permit to Install Wires

Permit No. **995**
 Issued
 Portland, Maine November 28, 19 73

To the City Electrician, Portland, Maine:

The undersigned hereby applies for a permit to install wires for the purpose of conducting electric current, in accordance with the laws of Maine, the Electrical Ordinance of the City of Portland, and the following specifications:

(This form must be completely filled out — Minimum Fee, \$1 00)

Owner's Name and Address Mrs. James B. Dennison, Peaks Island Tel. 766-4479

Contractor's Name and Address Richard Bemis, Peaks Island Tel. 766-2809

Location 84-F-11 Adams St Peaks Island of Building Residence

Number of Families 1 Apartments Stores Number of Stories

Description of Wiring: New Work Additions Alterations XX

Install 100 Amp Single Phase Service

Pipe .. Cable Metal Molding BX Cable Plug Molding (No. of feet)

No. Light Outlets Plugs Light Circuits Plug Circuits

FIXTURES: No. Fluor. or Strip Lighting (No feet)

SERVICE: Pipe 1-b/4 Cable Underground No. of Wires 3 Size 2/2 & 1/4

METERS: Relocated Added Total No. Meters

MOTORS: Number Phase H. P. Amps Volts Starter

HEATING UNITS: Domestic (Oil) No. Motors Phase H.P.

Commercial (Oil) No. Motors Phase H.P.

Electric Heat (No. of Rooms)

APPLIANCES: No. Ranges Watts Brand Feeds (Size and No.)

Elec. Heaters Watts

Miscellaneous Watts Extra Cabinets or Panels

Transformers Air Conditioners (No. Units) Signs (No. Units)

Will commence 19 Ready to cover in 19 Inspection 19

Amount of Fee \$ 2.00

Signed *Richard Bemis*
 #2971

DO NOT WRITE BELOW THIS LINE

SERVICE	METER			GROUND		
VISITS: 1 2 3 4 5 6						
7 8 9 10 11 12						

REMARKS:

INSPECTED BY *[Signature]*
 (OVER)

Peaks

LOCATION ADAMS ST
INSPECTION DATE 12/14/73
WORK COMPLETED
TOTAL NO. INSPECTIONS
REMARKS:

FEEES FOR WIRING PERMITS EFFECTIVE JULY 31, 1968

WIRING

1 to 30 Outlets
31 to 60 Outlets, each Outlet
Over 60 Outlets, each Outlet
(Each twelve feet or fraction thereof will be classed as one outlet).
any type of plug molding will be classed as one outlet).

\$ 2.00
3.00
.00

SERVICES

Single Phase
Three Phase
MOTORS
Not exceeding 50 H.P.
Over 50 H.P.

3.00
4.00
2.00
4.00
.75

HEATING UNITS

Domestic (Oil)
Commercial (Oil)
Electric Heat (Each Room)

1.50

APPLIANCES

Ranges, Cooking Units, Ovens, Water Heaters, Disposals, Built-in Dishwashers, Dryers, and any permanent built-in appliance — each unit

1.00
2.00
10.00
1.00

MISCELLANEOUS

Service, Single Phase

1.00



APPLICATION FOR PERMIT

PERMIT ISSUED
01046

OCT 18 1966

Class of Building or Type of Structure Third Class
Portland, Maine, October 14, 1966

CITY OF PORTLAND

To the INSPECTOR OF BUILDINGS, PORTLAND, MAINE

The undersigned hereby applies for a permit to erect alter repair demolish install the following building structure equipment in accordance with the Laws of the State of Maine, the Building Code and Zoning Ordinance of the City of Portland, plans and specifications, if any, submitted herewith and the following specifications:

Location Adams St. Peaks Island (64-7-11) Within Fire Limits? _____ Dist. No. _____
 Owner's name and address Mrs. Mary Dennison, Adams St. Peaks Island Telephone _____
 Lessee's name and address _____ Telephone _____
 Contractor's name and address Charles Franco, Winding Way Peaks Island Telephone 766-4403
 Architect _____ Specifications _____ Plans yes No. of sheets 1
 Proposed use of building Dwelling No. families 1
 Last use _____ " _____ No. families 1
 Material frame No. stories 1 1/2 Heat _____ Style of roof _____ Roofing _____
 Other buildings on same lot _____
 Estimated cost \$ 500.00 Fee \$ 3.00

General Description of New Work

To enclose (glass-in) existing front porch. 22' x 7'. Piazza existing with roof prior to June 5, 1957.
 More than half of the area of the vertical enclosing walls will consist of window sash or glass area of doors.
 28' to front lot line. (see plan)

It is understood that this permit does not include installation of heating apparatus which is to be taken out separately by and in the name of the heating contractor. **PERMIT TO BE ISSUED TO** contractor

Details of New Work

Is any plumbing involved in this work? _____ Is any electrical work involved in this work? _____
 Is connection to be made to public sewer? _____ If not, what is proposed for sewage? _____
 Has septic tank notice been sent? _____ Form notice sent? _____
 Height average grade to top of plate _____ Height average grade to highest point of roof _____
 Size, front _____ depth _____ No. stories _____ solid or filled land? _____ earth or rock? _____
 Material of foundation _____ Thickness, top _____ bottom _____ cellar _____
 Kind of roof _____ Rise per foot _____ Roof covering _____
 No. of chimneys _____ Material of chimneys _____ of lining _____ Kind of heat _____ fuel _____
 Framing Lumber—Kind _____ Dressed or full size? _____ Corner posts _____ Sills _____
 Size Girder _____ Columns under girders _____ Size _____ Max. on centers _____
 Studs (outside walls and carrying partitions) 2x4-16" O. C. Bridging in every floor and flat roof span over 8 feet.
 Joists and rafters: 1st floor _____, 2nd _____, 3rd _____, roof _____
 On centers: 1st floor _____, 2nd _____, 3rd _____, roof _____
 Maximum span: 1st floor _____, 2nd _____, 3rd _____, roof _____
 If one story building with masonry walls, thickness of walls? _____ height? _____

If a Garage

No. cars now accommodated on same lot _____, to be accommodated _____ number commercial cars to be accommodated _____
 Will automobile repairing be done other than minor repairs to cars habitually stored in the proposed building? _____

Miscellaneous

Will work require disturbing of any trees on a public street? no
 Will there be in charge of the above work a person competent to see that the State and City requirements pertaining thereto are observed? yes

APPROVED:
OK-10117166. Cde

Mrs. Mary Dennison
 Charles Franco

Signature of owner by: Charles Franco

Permit No. 66/1046 D

Location Adams St. 12th St. Island

Owner Mrs. Mary Depina

Date of permit 10/18/66

Notif. closing-in _____

Inspn. closing-in _____

Final Notn. _____

Final Inspn. _____

Cert. of Occupancy issued _____

Staking Out Notice _____

Form Check Notice _____

NOTES

6-10-67 Completed

X

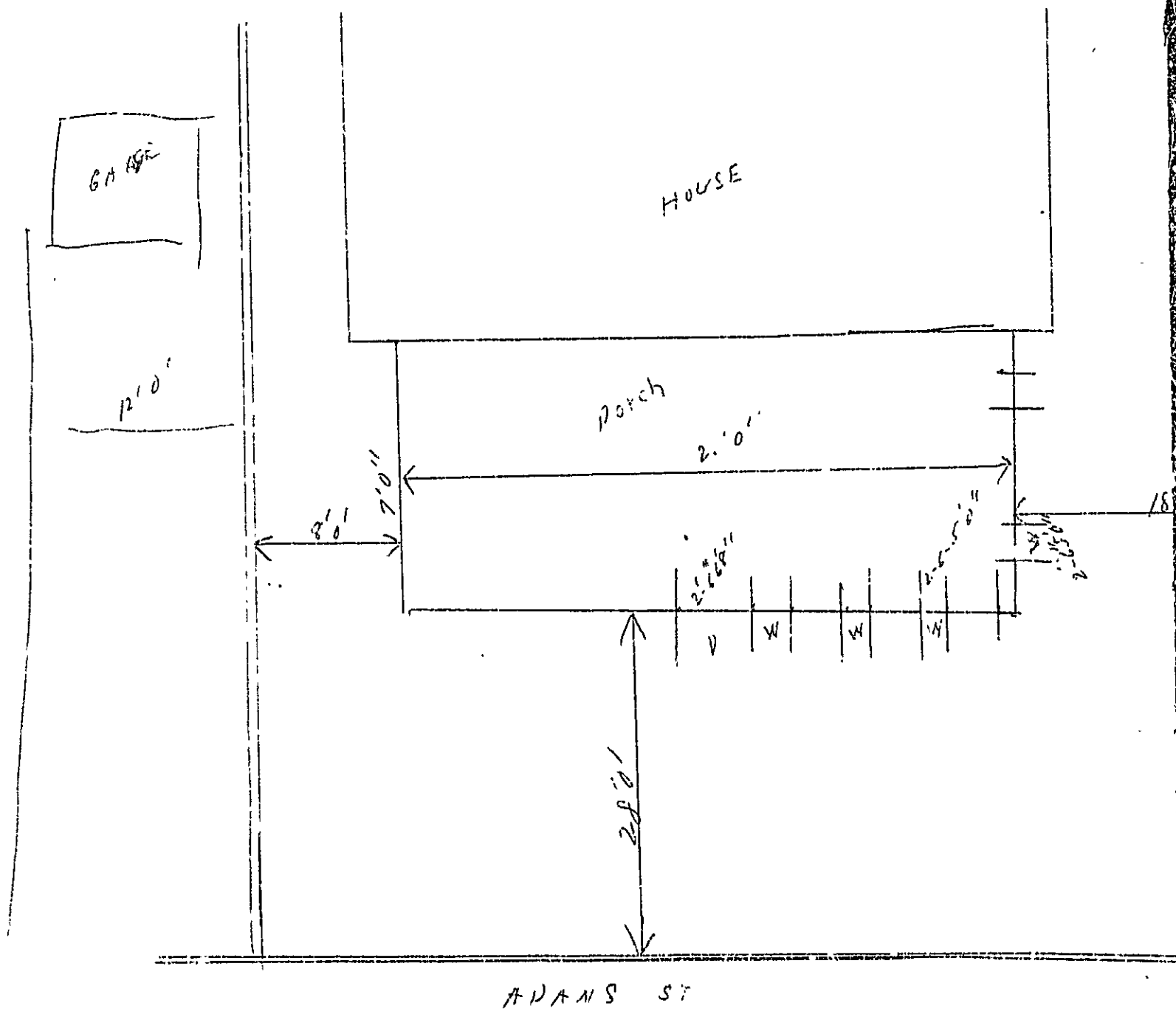

ADAMS ST

HOUSE

porch

22' 0"

18' 0"

ISLAND AVE

2' 0"

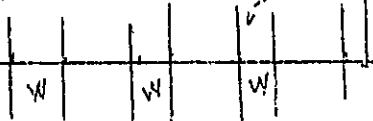

2' 0"

22' 0"

411 S ST

RECEIVED
APR 16 1974
DEPT. OF BLDG. INSP.
CITY OF PORTLAND

RECEIVED
JUN 16 1987
DEPT. OF BLDG. INSP.
CITY OF PORTLAND

APARTMENT HOUSE 70

