

OAKLAND AVE. ...
84-F-8



APPLICATION FOR PERMIT

PERMIT ISSUE

B.O.C.A. USE GROUP 000430

B.O.C.A. TYPE OF CONSTRUCTION

JUN 7 1979

ZONING LOCATION PORTLAND, MAINE, June 6, 1979

CITY OF PORTLAND

To the DIRECTOR OF BUILDING & INSPECTION SERVICES, PORTLAND, MAINE

The undersigned hereby applies for a permit to erect, alter, repair, demolish, move or install the following building, structure, equipment or change use in accordance with the Laws of the State of Maine, the Portland B.O.C.A. Building Code and Zoning Ordinance of the City of Portland with plans and specifications, if any, submitted herewith and the following specifications:

LOCATION 84-2-3 Welch & Adams St. Peaks Island 84-F-8 OAKLAND AVE. Fire District #1 [] #2 []
1. Owner's name and address John Horton - 40 St. James St. Telephone 766-2072
2. Lessee's name and address Roxbury, Mass Telephone
3. Contractor's name and address Owner Telephone
4. Architect Specifications Plans No. of sheets
Proposed use of building cottage - summer No. families
Last use No. families
Material No. stories Heat Style of roof Roofing
Other buildings on same lot
Estimated contractual cost \$ 5,000 Fee \$.23.50

FIELD INSPECTOR - Mr. GENERAL DESCRIPTION
This application is for: @ 775-5451
Dwelling Ext. 234
Garage To make repairs to cottage after fire with following
Masonry Bldg. Enclose porch, build chimney with 7 x 12 lin.
Metal Bldg. replace burned
Alterations floor joists, replace carrying beams with larger dimensions.
Demolitions
Change of Use Send permit to Oakland Ave. Pks. Island 04101
Other

NOTE TO APPLICANT: Separate permits are required by the installers and subcontractors of heating, plumbing, electrical and mechanicals.

PERMIT IS TO BE ISSUED TO 1 [] 2 [] 3 [] 4 []
Other:

DETAILS OF NEW WORK

Is any plumbing involved in this work? Is any electrical work involved in this work?
Is connection to be made to public sewer? If not, what is proposed for sewage?
Has septic tank notice been sent? Form notice sent?
Height average grade to top of plate Height average grade to highest point of roof
Size, front depth No. stories solid or filled land? earth or rock?
Material of foundation Thickness, top bottom cellar
Kind of roof Rise per foot Roof covering
No. of chimneys Material of chimneys of lining Kind of heat fuel
Framing Lumber—Kind Dressed or full size? Corner posts Sills
Size Girder Columns under girders Size Max. on centers
Studs (outside walls and carrying partitions) 2x4-16" O. C. Bridging in every floor and flat roof span over 8 feet.
Joist and rafters: 1st floor 2nd 3rd roof
On centers: 1st floor 2nd 3rd roof
Maximum span 1st floor 2nd 3rd roof
If one story building with masonry walls, thickness of walls? height?

IF A GARAGE

No. cars now accommodated on same lot to be accommodated number commercial cars to be accommodated
Will a room be repairing be done other than minor repairs to cars habitually stored in the proposed building?

APPROVALS BY: DATE MISCELLANEOUS
BUILDING INSPECTION: JAN EXAMINER Will work require disturbing of any tree on a public street?
ZONING:
BUILDING CODE: Will there be in charge of the above work a person competent to see that the State and City requirements pertaining thereto are observed?
Fire Dept.:
Health Dept.:
Others:

Signature of Applicant John Horton Phone
Type Name of above John Horton [X] 2 [] 3 [] 4 []

OFFICE FILE COPY

Other and Address



R3 RESIDENCE ZONE APPLICATION FOR PERMIT

Class of Building or Type of Structure Third Class
Portland, Maine, August 10, 1959

PERMIT ISSUED

01041

AUG 10 1959

CITY OF PORTLAND

To the INSPECTOR OF BUILDINGS, PORTLAND, MAINE

The undersigned hereby applies for a permit to erect alter repair demolish or install the following building structure equipment in accordance with the Laws of the Stat. of Me., the Building Code and Zoning Ordinance of the City of Portland, plans and specifications, if any, submitted herewith and the following specifications:

Location Cekland Ave., Peaks Island Within Fire Limits? _____ Dist. No. _____
 Owner's name and address Mrs. Charles E. Gili, Peaks Island Telephone _____
 Lessee's name and address _____ Telephone _____
 Contractor's name and address Roland Hoar, Peaks Island Telephone PO-62864
 Architect _____ Specifications _____ Plans _____ No. of sheets _____
 Proposed use of building Dwelling No. families 1
 Last use _____ No. families _____
 Materials frame No. stories 1 1/2 Heat _____ Style of roof _____ Roofing _____
 Other buildings on same lot _____
 Estimated cost \$ 500. Fee \$ 2.00

General Description of New Work

To Repair after fire to former condition without alterations and without change of use but if conditions in the areas of repair are found to be dangerously sub-standard of Building Code requirements, both Bldg. Dept. and owner will be notified immediately.

Cause - unknown
Fire occurred week of August 3rd, 1959
No structural damage

Roof damage - asphalt roofing Class C Und. Lab.
To rebuild outside brick chimney

It is understood that this permit does not include installation of heating apparatus which is to be taken out separately by and in the name of the heating contractor. PERMIT TO BE ISSUED TO

Details of New Work

Is any plumbing involved in this work? _____ Is any electrical work involved in this work? _____
 Is connection to be made to public sewer? _____ If not, what is proposed for sewage? _____
 Has septic tank notice been sent? _____ Form notice sent? Yes
 Height average grade to top of pipe _____ Height average grade to highest point of roof _____
 Size, front _____ depth _____ No. stories _____ solid or filled land? _____ earth or rock? _____
 Material of foundation concrete at least 4' below grade Thickness, top _____ bottom _____ cellar _____
 Material of underpinning _____ Height _____ Thickness _____
 Kind of roof _____ Rise per foot _____ Roof covering _____
 No. of chimneys 1 Material of chimneys brick of lining tile Kind of heat _____ fuel _____
 Framing Lumber-Kind _____ Dressed or full size? _____ Corner posts _____ Sills _____
 Size Girder _____ Columns under girders _____ Size _____ Max. on centers _____
 Kind and thickness of outside sheathing of exterior walls? _____
 Studs (outside walls and carrying partitions) 2x4-16" O. C. Bridging in every floor and flat roof span over 8 feet.
 Joists and rafters: 1st floor _____, 2nd _____, 3rd _____, roof _____
 On centers: 1st floor _____, 2nd _____, 3rd _____, roof _____
 Maximum span: 1st floor _____, 2nd _____, 3rd _____, roof _____
 If one story building with masonry walls, thickness of walls? _____ height? _____

If a Garage

No. cars now accommodated on same lot _____, to be accommodated _____ number commercial cars to be accommodated _____
Will automobile repairing be done other than minor repairs to _____ habitually stored in the proposed building? _____

APPROVED:

C.E. - 8/10/59 - ags

Miscellaneous

Will work require disturbing of any tree on a public street? no
Will there be in charge of the above work a person competent to see that the State and City requirements pertaining thereto are observed? yes

Mrs. Charles Gili

By:

Signature of owner

Roland Hoar

INSPECTION COPY

NOTES

11/18/74 - P. L. I.
2.8.74

1. Description of work to be done by permittee.

2. Location of work to be done.

3. Name of contractor or person doing the work.

4. Name of owner.

5. Name of person applying for permit.

6. Name of person inspecting the work.

7. Name of person issuing the permit.

8. Name of person receiving the permit.

9. Name of person giving notice.

10. Name of person receiving notice.

11. Name of person giving out notice.

12. Name of person receiving out notice.

13. Name of person giving Form Check Notice.

14. Name of person receiving Form Check Notice.

15. Name of person giving Cert. of Occupancy issued.

16. Name of person receiving Cert. of Occupancy issued.

17. Name of person giving Staking Out Notice.

18. Name of person receiving Staking Out Notice.

19. Name of person giving Final Inspn.

20. Name of person receiving Final Inspn.

21. Name of person giving Final Notif.

22. Name of person receiving Final Notif.

23. Name of person giving Inspn. closing-in.

24. Name of person receiving Inspn. closing-in.

25. Name of person giving Notif. closing-in.

26. Name of person receiving Notif. closing-in.

27. Name of person giving Date of Permit.

28. Name of person receiving Date of Permit.

29. Name of person giving Owner.

30. Name of person receiving Owner.

31. Name of person giving Location.

32. Name of person receiving Location.

33. Name of person giving Permit No.

34. Name of person receiving Permit No.

Permit No.	<u>59 / 1041</u>
Location	<u>100 N. 1st St.</u>
Owner	<u>Pho. Chalk Co. Inc.</u>
Date of Permit	<u>11/18/74</u>
Notif. closing-in	<u>11/18/74</u>
Inspn. closing-in	<u>11/18/74</u>
Final Notif.	<u>11/18/74</u>
Final Inspn.	<u>11/18/74</u>
Cert. of Occupancy issued	<u>11/18/74</u>
Staking Out Notice	<u>11/18/74</u>
Form Check Notice	<u>11/18/74</u>

1. Description of work to be done by permittee.

2. Location of work to be done.

3. Name of contractor or person doing the work.

4. Name of owner.

5. Name of person applying for permit.

6. Name of person inspecting the work.

7. Name of person issuing the permit.

8. Name of person receiving the permit.

9. Name of person giving notice.

10. Name of person receiving notice.

11. Name of person giving out notice.

12. Name of person receiving out notice.

13. Name of person giving Form Check Notice.

14. Name of person receiving Form Check Notice.

15. Name of person giving Cert. of Occupancy issued.

16. Name of person receiving Cert. of Occupancy issued.

17. Name of person giving Staking Out Notice.

18. Name of person receiving Staking Out Notice.

19. Name of person giving Final Inspn.

20. Name of person receiving Final Inspn.

21. Name of person giving Final Notif.

22. Name of person receiving Final Notif.

23. Name of person giving Inspn. closing-in.

24. Name of person receiving Inspn. closing-in.

25. Name of person giving Notif. closing-in.

26. Name of person receiving Notif. closing-in.

27. Name of person giving Date of Permit.

28. Name of person receiving Date of Permit.

29. Name of person giving Owner.

30. Name of person receiving Owner.

31. Name of person giving Location.

32. Name of person receiving Location.

33. Name of person giving Permit No.

34. Name of person receiving Permit No.

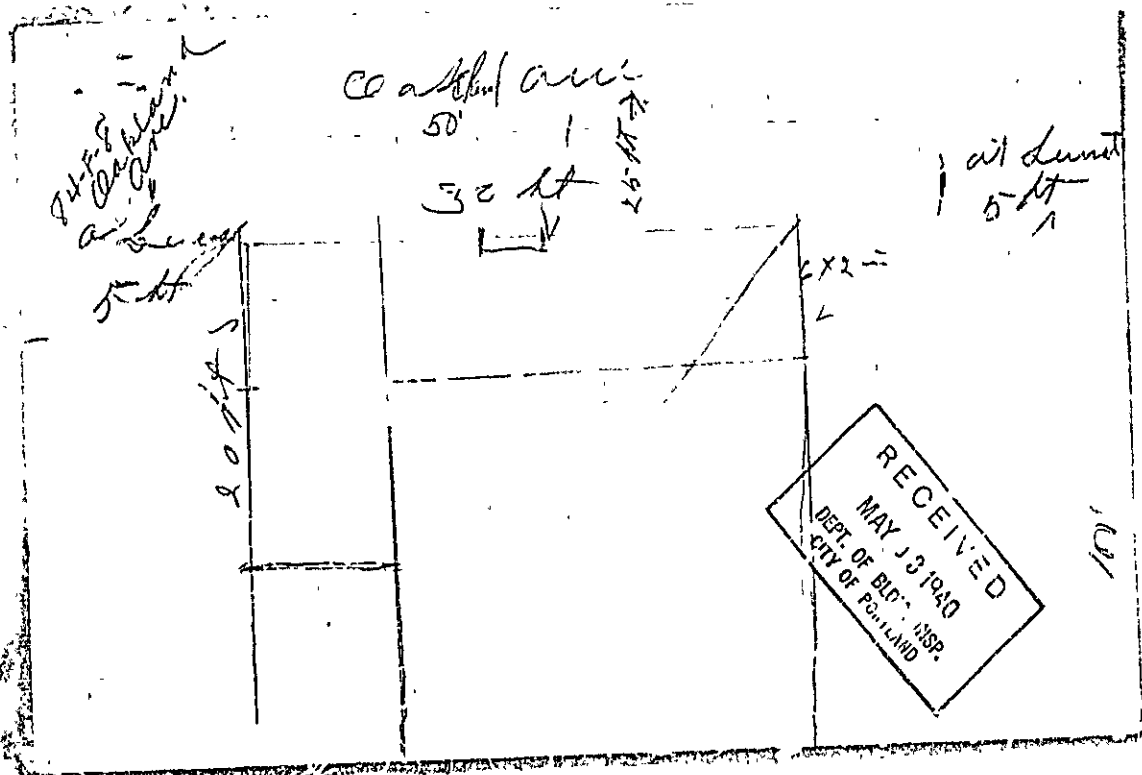

RECEIVED
MAY 13 1940
DEPT. OF BLDG. INSP.
CITY OF PORTLAND

107



HOUSE ZONING PERMIT ISSUED

APPLICATION FOR PERMIT Class of Building or Type of Structure First Class

Portland, Maine, May 13, 1940

MAY 13 1940

To the INSPECTOR OF BUILDINGS, PORTLAND, ME.

The undersigned hereby applies for a permit to erect, alter, enlarge, or demolish the following building structure... in accordance with the Laws of the State of Maine, the Building Code of the City of Portland, Maine, and the following specifications:

Location: ORCHARD AVENUE, ROCK ISLAND Within Fire Limits? NO. Dist. No.
Owner's or Lessee's name and address: MRS. CHARLES GILL, 1 ARCADE Telephone:
Contractor's name and address: GEORGE J. JARVIS, ISLAND AVE., PORTS Telephone: 66-11
Architect:
Proposed use of building: Cottage No. families:
Other buildings on same lot:
Estimated cost \$ 100. Per. \$.50

Description of Present Building to be Altered

Material: wood No. stories: 1 1/2 Heat: Style of roof: Roofing:
Last use: Cottage No. inches:

General Description of New Work

To glass in existing front piazza and 3/4 of side piazza in cottage. More than half of the area of the vertical enclosing walls will consist of window sash or glass area of doors.

It is understood that this permit does not include installation of heating apparatus which is to be taken out separately by and at the expense of the heating contractor.

Details of New Work

PERMIT REQUIRED FOR THIS WORK. CERTIFICATE OF JUDICIAL DEPARTMENT IS WAIVED.

Is any plumbing work involved in this work?
Is any electrical work involved in this work? Height average grade to top of plate
Size, front depth No. stories Height average grade to highest point of roof
To be erected on solid or filled land? earth or rock?
Material of foundation Thickness, top bottom cellar
Material of underpinning Height Thickness
Kind of Roof Rise per foot Roof covering
No. of chimneys Material of chimneys of lining
Kind of heat Type of fuel Is gas fitting involved?
Framing Lumber Kind Dressed or Full Size?
Corner posts Sills Girt or ledger board? Size
Material columns or girders Size Max. on centers
Studs (outside walls and carrying partitions) 2x4-16" O. C. Girders 6x8 or larger. Bridging in every floor and 6" at roof span over 8 feet. Sills and corner posts all one piece in cross section.
Joists and rafters: 1st floor, 2nd, 3rd, roof
On centers: 1st floor, 2nd, 3rd, roof
Maximum span: 1st floor, 2nd, 3rd, roof
If one story building with masonry walls, thickness of walls? height?

If a Garage

No. cars now accommodated on same lot, to be accommodated
Total number commercial cars to be accommodated
Will automobile repairing be done other than minor repairs to cars habitually stored in the proposed building?

Miscellaneous

Will above work require removal or disturbing of any shade tree on a public street? no
Will there be in charge of the above work a person competent to see that the State and City requirements pertaining thereto are observed? YES
Signature of owner: Mrs. Charles Gill

INSTRUCTION COPY

Permit No. 40/534

Location Outlets, Peaks

Owner Miss Chas. Hall

Date of permit 5/13/40

Notif. closing-in _____

Insp'n closing-in _____

Final Notif. _____

Final Insp. 6/3/40

Cert. of Occupancy issued 6/7/40

NOTES

6/7/40. Part started.

