

CRESCENT AVENUE
84-D-5-6-7 PEAKS ISLAND

Sills 6x6'
Floor timbers 2x6-16" o.c.
Rafters 2x6-16" o.c.

Remove Present Door + sidelight
+ Install Window

Remove Present Stairs.

6'x8' New Entrance

For Mrs Harold Conley Sr.
Seashore Ave.

Scale $\frac{1}{4}'' = 1'$

R.S. Hoar

3-9" smooth tube
4' below grade

Approx.
75'

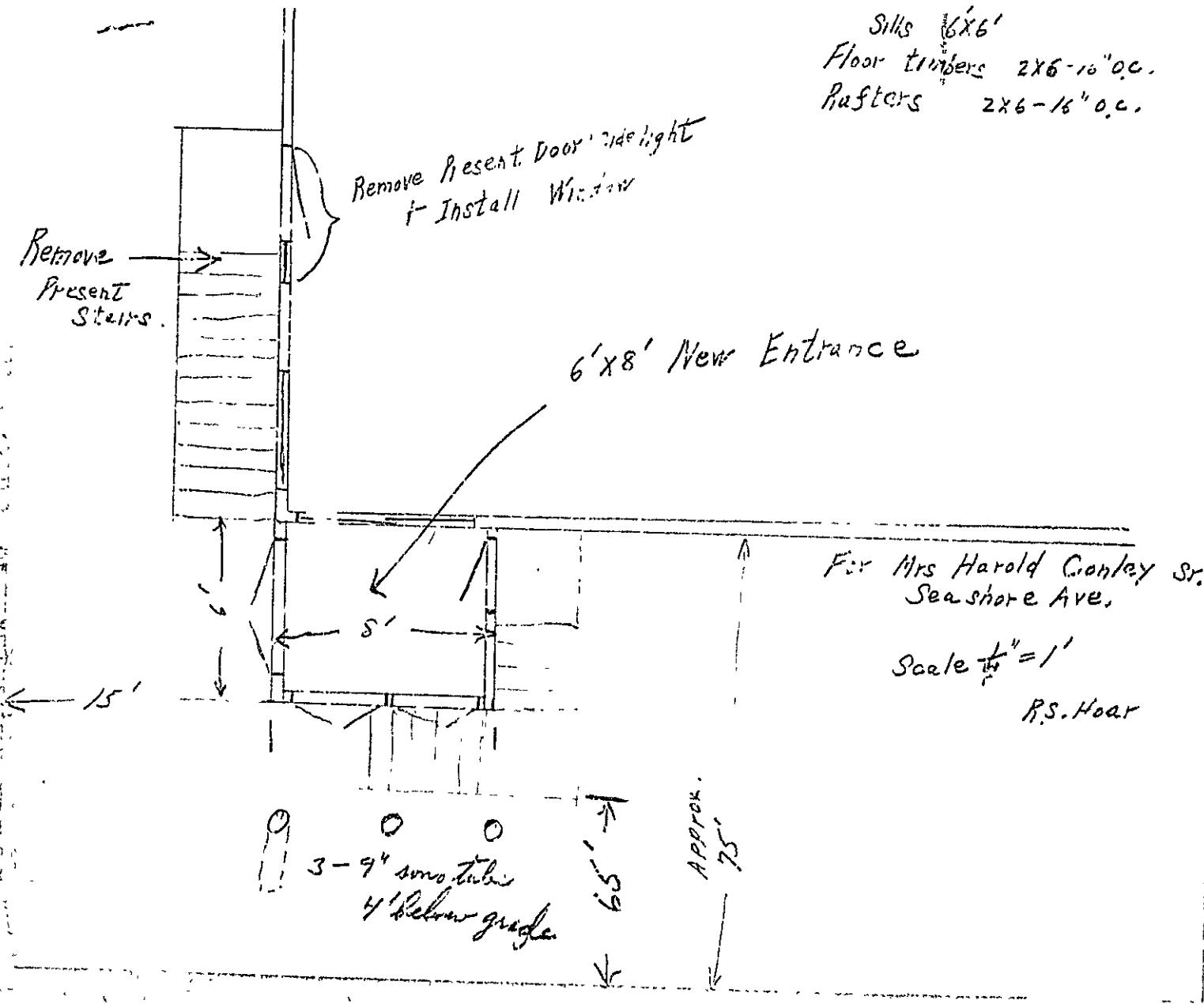



RESIDENCE ZONE PERMIT ISSUED
 00771
 JUL 2 1964
 CITY OF PORTLAND

APPLICATION FOR PERMIT

Class of Building or Type of Structure Third Class
 Portland, Maine, July 1, 1964

To the INSPECTOR OF BUILDINGS, PORTLAND, MAINE

The undersigned hereby applies for a permit to erect alter repair demolish install the following building structure equipment in accordance with the Laws of the State of Maine, the Building Code and Zoning Ordinances of the City of Portland, plans and specifications, if any, submitted herewith and the following specifications: 84-D-5 to 7

Location Seashore Ave. Peaks Island Crescent Ave. Within Fire Limits? _____ Dist. No. _____
 Owner's name and address Mrs. Harold Conley Sr. Seashore Ave. Peaks Island Telephone _____
 Lessee's name and address _____ Telephone _____
 Contractor's name and address Roland Hoar, Island Ave. Peaks Island Telephone 766-2864
 Architect _____ Specifications _____ Plans yes No. of sheets 1
 Proposed use of building Dwelling No. families 1
 Last use _____ " _____ No. families 1
 Material frame No. stories 2 Heat _____ Style of roof _____ Roofing _____
 Other buildings on same lot _____
 Estimated cost \$ 1500.00 Fee \$ 6.00

General Description of New Work

To remove existing side platform approx. 4' x 4' and steps.
 To change door to window, same location.
 To construct 6' x 8' front addition (entranceway) with 4' x 4' platforms and steps.
 see plan.

It is understood that this permit does not include installation of heating apparatus which is to be taken out separately by and in the name of the heating contractor. PERMIT TO BE ISSUED TO contractor

Details of New Work

Is any plumbing involved in this work? no Is any electrical work involved in this work? yes
 Is connection to be made to public sewer? _____ If not, what is proposed for sewage? _____
 Has septic tank notice been sent? _____ Form notice sent? yes
 Height average grade to top of plate 14' Height average grade to highest point of roof 14' 3"
 Size, front 8' depth 6' No. stories 1 solid or filled land? solid earth or rock? earth
 Material of foundation 4" apart at least 4" below grade _____ bottom _____ cellar _____
 Kind of roof flat Rise per foot 2" Roof covering Asphalt Glass C Und Label
 No. of chimneys _____ Material of chimneys _____ of lining _____ Kind of heat _____ fuel 6x6
 Framing Lumber - Kind hemlock Dressed or full size? dressed Corner posts 3-2x4 Sills _____
 Size Girder _____ Columns under girders _____ Size _____ Max. on centers _____
 Studs (outside walls and carrying partitions) 2x4-16" O. C. Bridging in every floor and flat roof span over 8 feet.
 Joists and rafters: 1st floor 2x6, 2nd _____, 3rd _____, roof 2x6
 On centers: 1st floor 16", 2nd _____, 3rd _____, roof 16"
 Maximum span: 1st floor 5', 2nd _____, 3rd _____, roof 6'
 If one story building, with masonry walls, thickness of walls? _____ height? _____

If a Garage

No. cars now accommodated on same lot _____, to be accommodated _____ number commercial cars to be accommodated _____
 Will automobile repairing be done other than minor repairs to cars habitually stored in the proposed building? _____

APPROVED:
O.K. - 7/2/64 - agd

Miscellaneous

Will work require disturbing of any tree on a public street? no
 Will there be in charge of the above work a person competent to see that the State and City requirements pertaining thereto are observed? yes

Mrs. Harold Conley Sr.
 Roland Hoar

CS 301

INSPECTION COPY

Signature of owner by: Roland Hoar

7M



FILL IN COMPLETELY AND SIGN WITH INK

PERMIT ISSUED
1219

Permit No. _____
AUG 30 1933

APPLICATION FOR PERMIT FOR HEATING, COOKING OR POWER EQUIPMENT

August 30, 1933

Portland, Maine

to the INSPECTOR OF BUILDINGS, PORTLAND, ME.

The undersigned hereby applies for a permit to install the following heating, cooking or power equipment in accordance with the Laws of Maine, the Building Code of the City of Portland, and the following specifications:
dwelling house.

Location Seashore Avenue, Peaks Use of Building Seashore Ave. Peaks Tel. # _____
Name and address of owner Harold H. Conley, Ward 2-4952
Contractor's name and address Cutler & Cutler, Inc. 186 Federal St. Telephone _____

General Description of Work

To install Oil Burning Equipment

IF HEATER, POWER BOILER OR COOKING DEVICE

Is heater or source of heat to be in cellar? yes If not, which story concrete Kind of Fuel _____
Material of supports of heater or equipment (concrete floor or what kind) _____
Minimum distance to wood or combustible material, from top of boiler or casing top of furnace, _____
from top of smoke pipe _____, from front of heater _____, from sides or back of heater _____

IF OIL BURNER

Name and type of burner Oil-O-Matic Labeled and approved by Underwriters' Laboratories? yes
Will operator be always in attendance? basement Type of oil feed (gravity or pressure) gravity
Location oil storage _____ No. and capacity of tanks _____
Will all tanks be more than seven feet from any flame? yes How many tanks fireproofed? _____
Amount of fee enclosed? 1.00 (\$1.00 for one heater, etc., 50 cents for each additional heater, etc., in same building at same time.)

Signature of contractor

Shepard A. Cutler

INSPECTION COPY

NOTIFICATION SERVICE LAWYER OR CLOSING-IN IS WARRANTED

CERTIFICATE OF OCCUPANCY REQUIRED IS WARRANTED

P.C. sent 8/31/33

Ward 23 Permit No. 33/1219

Location Quincy
San Pedro San Pedro

Owner Harold M. Linley

Date of permit 8/30/33

Notif. closing-in

Inspn. closing-in

Final Noti. 9/1/33

Final Inspn. 9/7/33 - O.T.

Cert. of Occupancy issued None

NOTES

84
D
5-67

1. Kind of heat Hot Air
2. Label ✓
3. Anti-siphon ✓
4. Oil storage ✓
5. Tank distance ✓
6. Vent pipe ✓
7. Fill pipe ✓
8. Gauge ✓
9. Rigidity Stiffened w/ Wood
10. Feed safety ✓
11. Pipe sizes & material ✓
12. Control valves ✓
13. Ash pit vent ✓
14. Temp. or pressure safety ✓
15. Instruction card ✓
16. _____

9/6/33 - Mrs. S. Cutler

for tank will be supplied - A.J.S.